

1+19 SIR JOHN A MACDONALD PKY CONCEPT PLAN

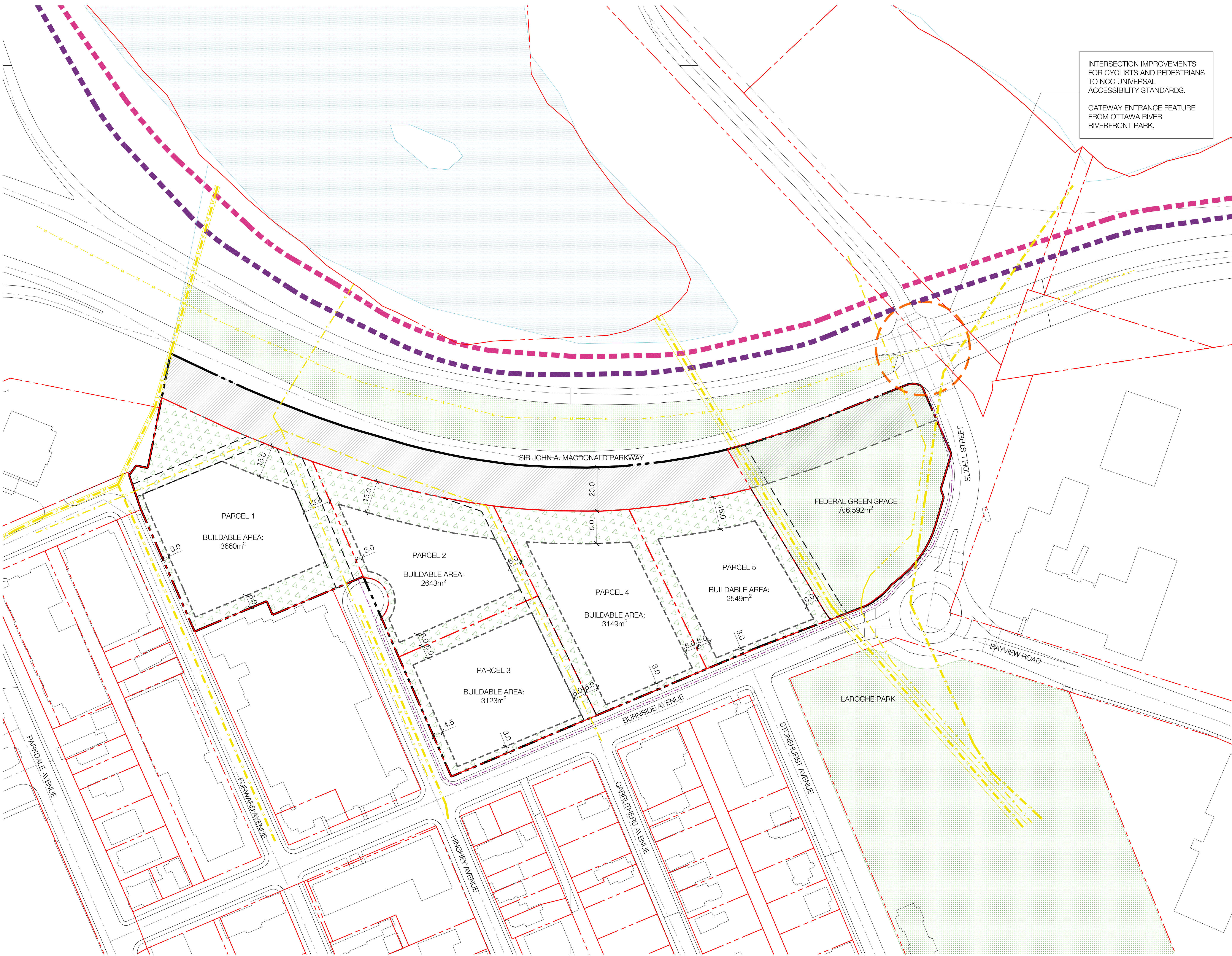

INTERSECTION IMPROVEMENTS FOR CYCLISTS AND PEDESTRIANS TO NCC UNIVERSAL ACCESSIBILITY STANDARDS.

GATEWAY ENTRANCE FEATURE FROM OTTAWA RIVER RIVERFRONT PARK.



- LEGEND**
- 20m LANDSCAPE BUFFER FROM SIR JOHN A. MACDONALD PARKWAY
 - PUBLIC LANDSCAPE/ PARK
 - PRIVATE LANDSCAPE
 - OTTAWA RIVER
 - PROPERTY BOUNDARY
 - STUDY AREA
 - SETBACKS
 - ROW CENTERLINE
 - STORM SEWER LINE
 - SANITARY SEWER LINE
 - INTERSECTION/ GATEWAY IMPROVEMENTS
 - SEGREGATED PEDESTRIAN PATH
 - SEGREGATED CYCLING PATH
 - STREETSCAPE IMPROVEMENTS

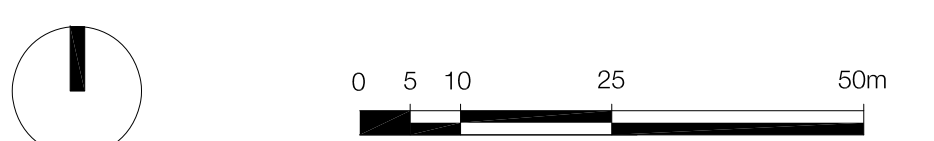

No.	REVISION	DATE	BY
5	REVISED CONCEPT PLAN	2021.04.28	TK
4	REVISED CONCEPT PLAN	2021.04.26	RP
3	CONCEPT PLAN	2021.04.21	TK
2	CONCEPT PLAN	2018.07.06	RP
1	BASE PLAN	2018.06.20	RP

CLIENT
NATIONAL CAPITAL COMMISSION

National Capital Commission / Commission de la capitale nationale

FOTENN
Planning + Design

223 McLeod Street, Ottawa ON K2P 0Z8
613.730.5709 www.fotenn.com

DESIGNED	TK
REVIEWED	RP
DATE	2018.06.05

P1