

**PROJECT TEAM**

**ARCHITECT**  
HOBIN ARCHITECTURE  
PATRICK BISSON  
T 613-238-7200

**PLANNING**  
FOTENNI CONSULTANTS INC.  
STEPHANIE MORRIS  
T 613-730-5709

**CIVIL**  
J.L. RICHARDS  
LUCIE DALRYMPLE  
T 613-913-4368

**LANDSCAPE ARCHITECT**  
LASHLEY & ASSOCIATES LANDSCAPE ARCHITECT  
DANIELA CORREA  
T 613-233-8579

**TRANSPORTATION**  
PARSONS  
MATT MANTLE  
T 613-222-8234

**ENVIRONMENTAL**  
GRADIENT WIND ENGINEERING  
JOSHUA FOSTER  
T 613-836-0634

**SURVEYOR**  
ANNIS O'SULLIVAN VOLLEBEK LTD.  
ED HERWEYER  
T 613-727-0850

no.	date	revision
1	21.09.02	ISSUED FOR REZONING

It is the responsibility of the appropriate contractor to check and verify all dimensions on site and report all errors and/or omissions to the architect.

All contractors must comply with all pertinent codes and by-laws.

Do not scale drawings.

This drawing may not be used for construction until signed.

Copyright reserved.

Hobin Architecture  
Incorporated

63 Parnell Street  
Ottawa, Ontario  
Canada K1S 3K7

T: 613-238-7200

F: 613-235-2005

E: mail@hobinarc.com

hobinarc.com

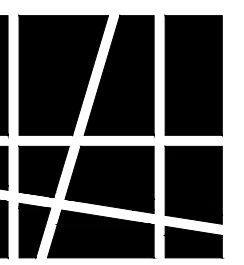

**HOBIN**  
ARCHITECTURE

PROJECT/LOCATION:  
359 KENT STREET

DRAWING TITLE:  
FLOOR PLAN  
GROUND LEVEL

DRAWN BY: PB

DATE: 21-08-27

SCALE: 1:150

PROJECT: 2027

DRAWING NO.:

**A206**

REVISION NO.:

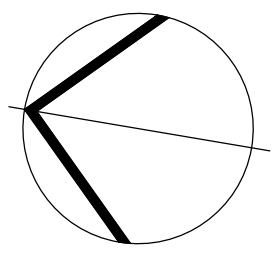
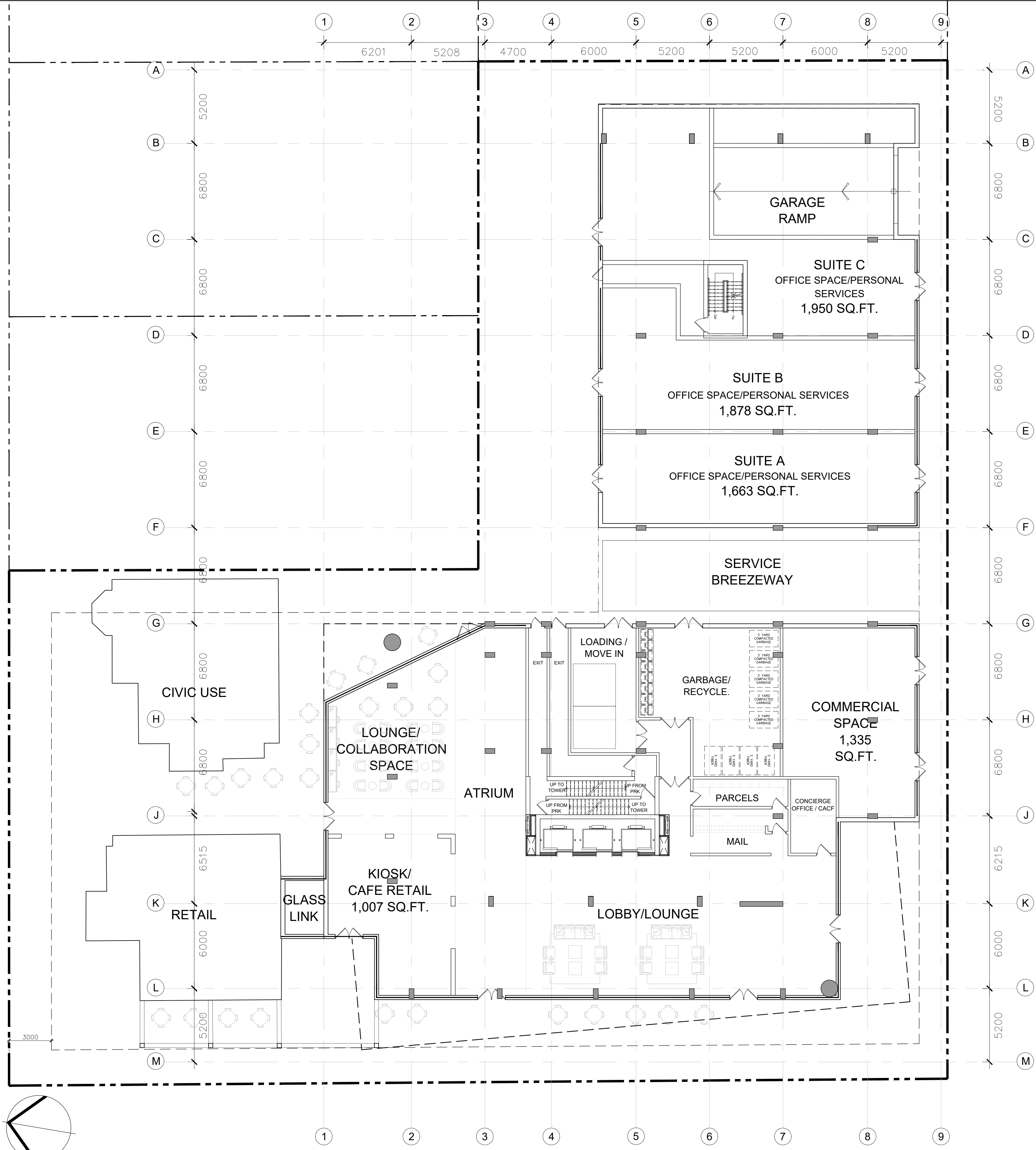

1 GROUND FLOOR PLAN  
A2.06 1:150