

| DEVELOPMENT STATISTICS: | | | | |
|---|--|-------------------------------------|---|----------------|
| Total Site Area = 95,882.125 sq m (23.69 acres) (as per survey drawing) | | | | |
| Total Developable Land = 63,563 sq m (15.71 acres) (including parkland) | | | | |
| Public Roads, M.U.P. & Open Space = 21,473 sq m (5.31 acres) (to be ceded to N.C.C.) | | | | |
| PLOT ID | PROPOSED DEVELOPMENT | GROSS CONSTRUCTION AREA | COMMERCIAL AREA ON GR. LVL. (m ² /sq. ft.) | DWELLING UNITS |
| Plot 'A' Phase - 1 | A1 30-STORY TOWER WITH 6-STORY POOLUM | 257,688 sq. ft. | --- | 258 |
| | A2 33-STORY TOWER WITH 6-STORY POOLUM | 253,855 sq. ft. | 4,844 sq. ft. | 249 |
| | A3 24-STORY TOWER WITH 6-STORY POOLUM | 255,169 sq. ft. | 8,573 sq. ft. | 246 |
| Plot 'B' Phase - 2 | B1 28-STORY TOWER WITH 6-STORY POOLUM | 363,325 sq. ft. | 2,152 sq. ft. | 361 |
| | B2 20-STORY TOWER WITH 6-STORY POOLUM | 213,384 sq. ft. | 6,038 sq. ft. | 217 |
| | B3 6-STORY BUILDING | 56,015 sq. ft. | --- | 56 |
| Plot 'C' Phase - 3 | C1 24-STORY TOWER WITH 6-STORY POOLUM | 256,898 sq. ft. | --- | 257 |
| | C2 18-STORY TOWER WITH 6-STORY POOLUM | 161,976 sq. ft. | --- | 162 |
| Plot 'D' Phase - 4 | D 6-STORY BUILDING | 61,290 sq. ft. | --- | 61 |
| Plot 'E' Phase - 5 | E1 6-STORY BUILDING | 81,424 sq. ft. | 5,278 sq. ft. | 76 |
| | E2 6-STORY BUILDING | 73,063 sq. ft. | --- | 73 |
| Plot 'F' Phase - 6 | F1 6-STORY BUILDING | 64,584 sq. ft. | 5,382 sq. ft. | 59 |
| | F2 4-STORY BUILDING | 54,078 sq. ft. | --- | 54 |
| TOTAL | | 2,152,749 sq. ft. 199,997 sq. m. | 32,267 sq. ft. 2,998 sq. m. | 2,062 |

Tower Floor Plate = 792 sq m (8,525 sq ft)
 Average Dwelling Unit Size = 92.9 sq m (1,000 sq ft)
 Total Parking Spaces = 1,631 (0.85 per DU)
 (2 levels underground + on-street surface parking)

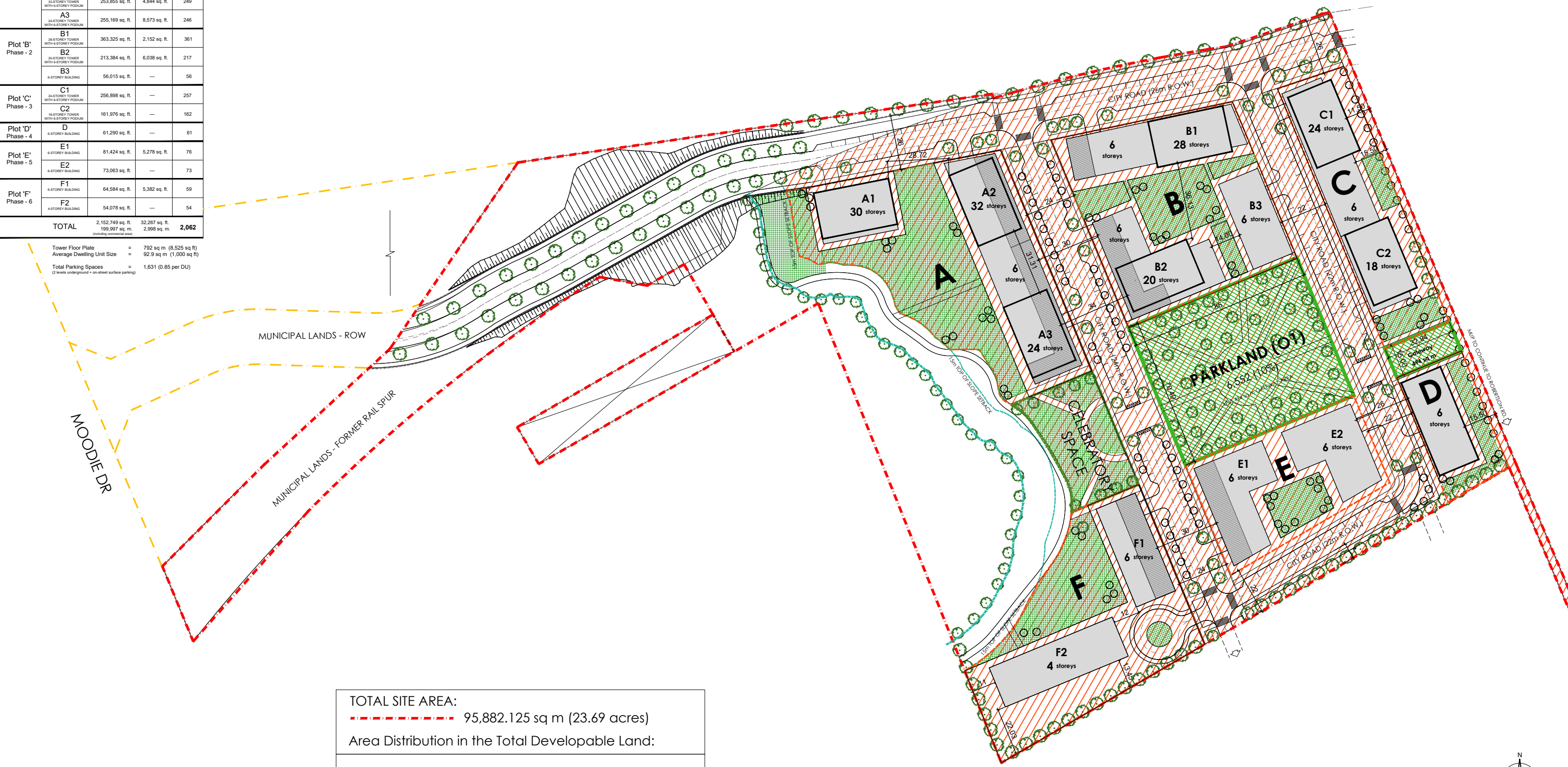

TOTAL SITE AREA:
 - - - - - 95,882.125 sq m (23.69 acres)

Area Distribution in the Total Developable Land:

PARKLAND DEDICATION (@ 10% OF DEVELOPABLE LAND)
 [Green Hatched Box] = 6,552 sq m (1.62 acres) (PARKLAND AREA+GATEWAY)

AREA OF MUNICIPAL ROADS and M.U.P.
 [White Box] = 21,473 sq m (5.31 acres) 34%

TOTAL DEVELOPABLE LAND (INCLUDING PARKLAND, MUP, PUBLIC ROAD)
 [Red Hatched Box] = 63,563 sq m (15.71 acres)

March 16, 2023

STILLWATER STATION
 1987 Robertson Road, Ottawa ON



DEVELOPABLE LAND - AREA DISTRIBUTION

MASTER PLAN

March 16, 2023

STILLWATER STATION

1987 Robertson Road, Ottawa ON

-  BUILDING HARDSCAPES & ACTIVE BUILDING FRONTAGES
-  COMMUNAL HARDSCAPE PATHWAYS / SURFACES

DEVELOPABLE LAND
HARDSCAPES & ACTIVE FRONTAGES

MASTER PLAN

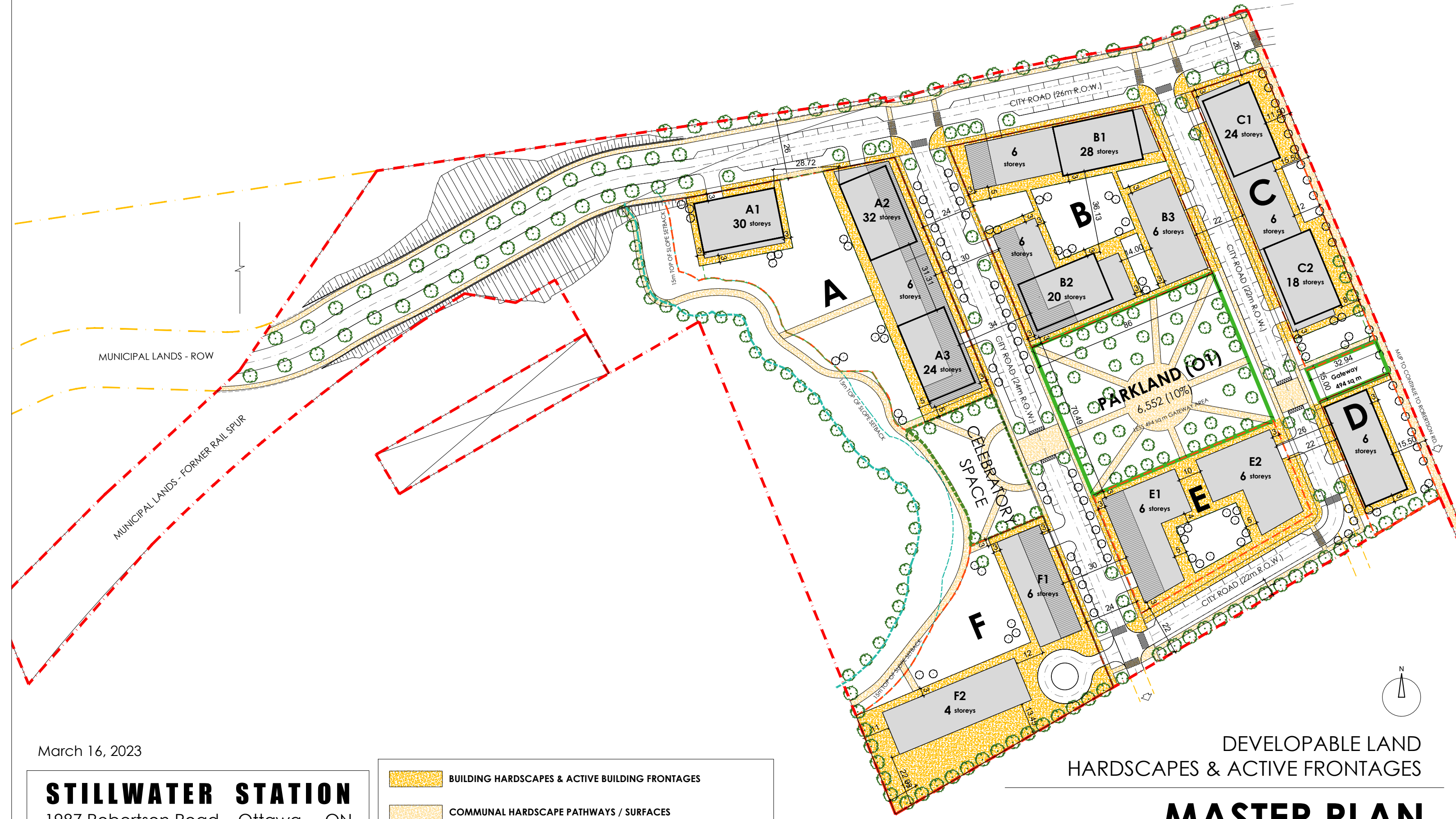

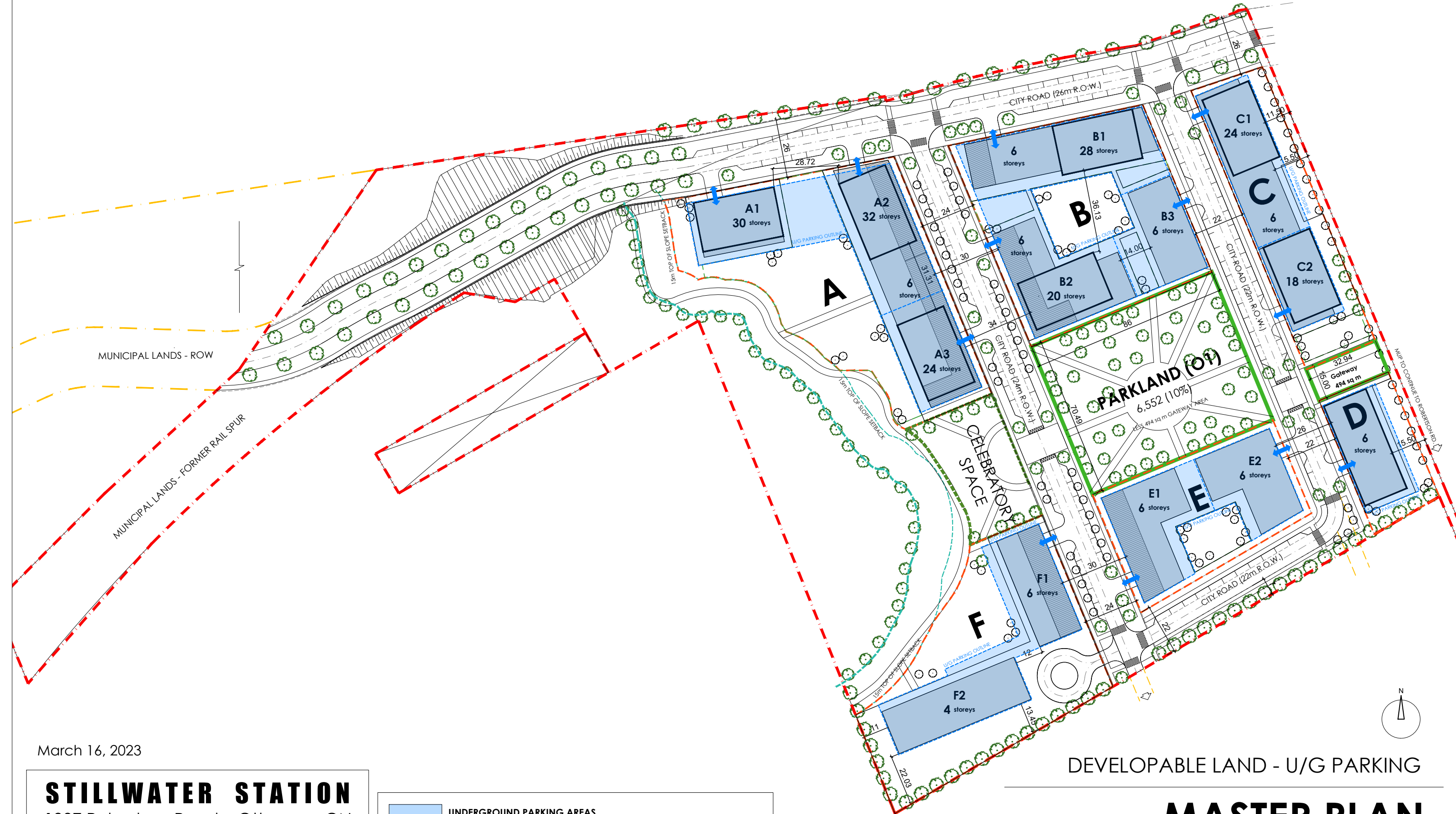

March 16, 2023

STILLWATER STATION

1987 Robertson Road, Ottawa ON

 UNDERGROUND PARKING AREAS

DEVELOPABLE LAND - U/G PARKING

MASTER PLAN

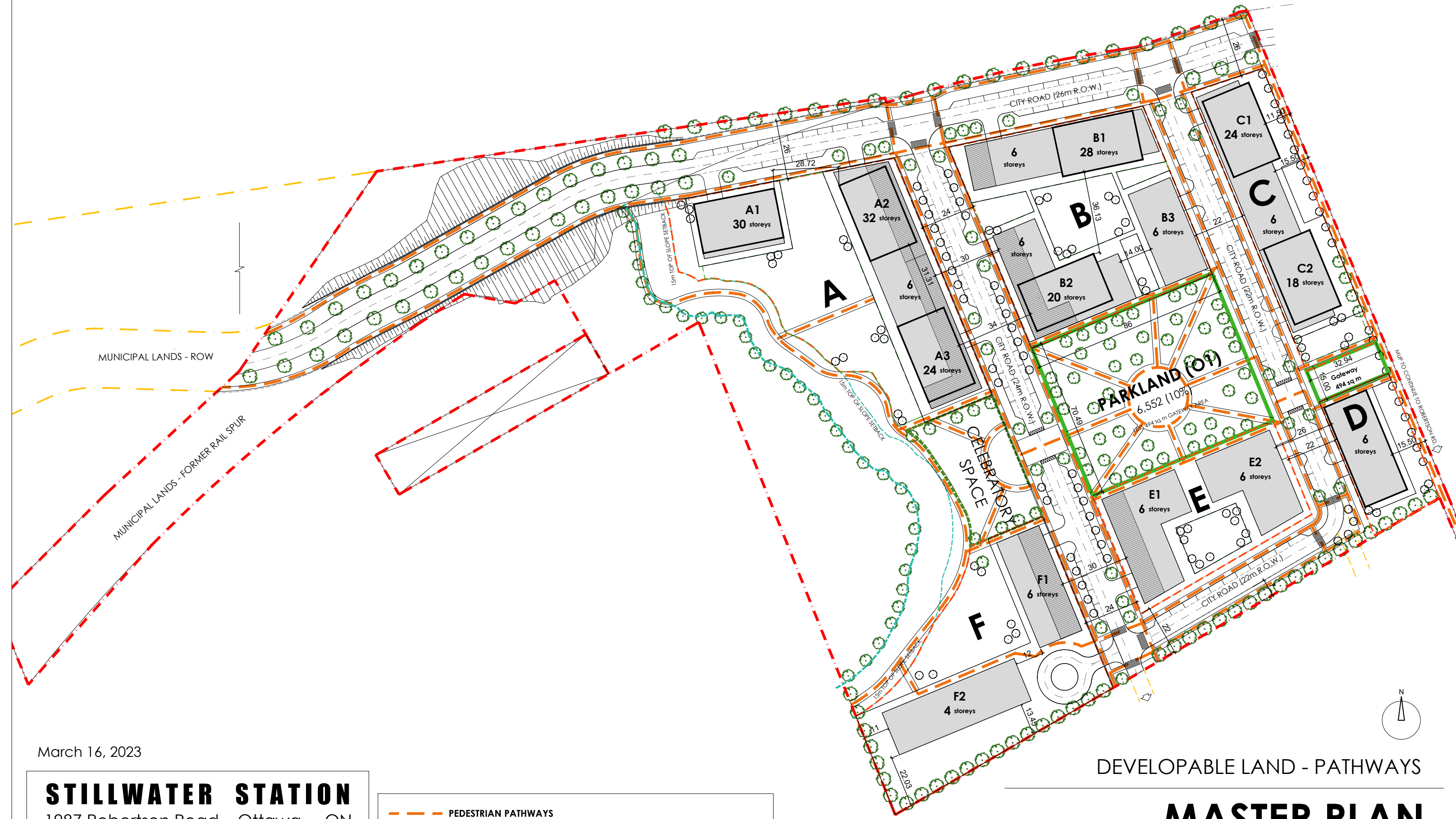

March 16, 2023

STILLWATER STATION

1987 Robertson Road, Ottawa ON

PEDESTRIAN PATHWAYS

DEVELOPABLE LAND - PATHWAYS

MASTER PLAN