









**NOTES:**

1. ALL TREATMENT UNITS AND LEACHING BED ARE TO BE INSTALLED IN ACCORDANCE WITH MINIMUM OBC CLEARANCE DISTANCES. ANY OMISSIONS OR INACCURACIES SHALL BE BROUGHT TO THE ATTENTION OF GVE AND OSSO.
2. CARE IS TO BE EXERCISED DURING CONSTRUCTION ACTIVITIES NEAR OVERHEAD HYDRO WIRES.
3. EXISTING ELEVATIONS ARE APPROXIMATE. CONTRACTOR MUST VERIFY ALL ELEVATIONS AND DIMENSIONS PRIOR TO CONSTRUCTION.
4. SOIL CONDITIONS ARE ACCURATE FOR THE LOCATIONS SHOWN. CONTRACTOR MUST CONTACT THE DESIGN ENGINEER OR REGULATORY AUTHORITY SHOULD SOIL CONDITIONS DIFFER.
5. ALL DIMENSIONS AND CONDITIONS TO BE VERIFIED ON SITE, FIGURED DIMENSIONS TAKE PRECEDENCE OVER SCALE.
6. UTILITY LOCATES SHALL BE COMPLETED PRIOR TO ANY EXCAVATION.
7. THIS IS NOT A PLAN OF SURVEY AND SHALL NOT BE USED EXCEPT FOR THE PURPOSE INDICATED IN THE TITLE BLOCK.
8. THIS DOCUMENT IS COPYRIGHT PROTECTED AND IS THE SOLE PROPERTY OF GVE GROUP. THIS DRAWING SHALL NOT BE ALTERED IN ANY MANNER.
9. EXISTING LOT SERVICED WITH A DRILLED WELL.

**METRIC:**

DISTANCES AND ELEVATIONS SHOWN ON THIS PLAN ARE IN METERS AND MAY BE CONVERTED TO FEET BY DIVIDING BY 0.3048.

**LEGEND:**

-  PROPOSED ELEVATION
-  EXISTING ELEVATION
-  EXISTING WORKS
-  PROPOSED SEWAGE WORKS
-  FENCE LINE
-  PROPERTY LINE
-  TBM  
TEMPORARY BENCH MARK  
(DESCRIPTION: UNDERSIDE OF SIDING)
-  TEST PIT LOCATION

**SEPARATION DISTANCES:**

1. MINIMUM CLEARANCE FROM SEPTIC PIPE TO:  
 LOT LINE = 3.0m  
 HOUSE = 5.0m  
 DRILLED WELL = 15.0m
2. MINIMUM CLEARANCE FROM TREATMENT UNITS TO:  
 LOT LINE = 3.0m  
 HOUSE = 1.5m  
 DRILLED WELL = 15.0m

|   |                                  |                |              |     |
|---|----------------------------------|----------------|--------------|-----|
| Drawn by: DP  | Designed by: DP                  | Checked by: WS |              |     |
| Rev.  | Description                      | Date           | Approved     |     |
| Township  | Plan#                            | Lot            | Sublot       | Con |
| Drawg. No.: SP7075-23   |                                  |                |              |     |
| County: METCALFE  | City: Address: 2545 9TH LINE RD. | Date: 16/06/23 | Scale: 1:300 |     |
| GREEN VALLEY ENVIRONMENTAL  |                                  |                |              |     |
| On-Site Sewage Treatment Plan for the Residence of:<br>ASB GREENWORLD |                                  |                |              |     |

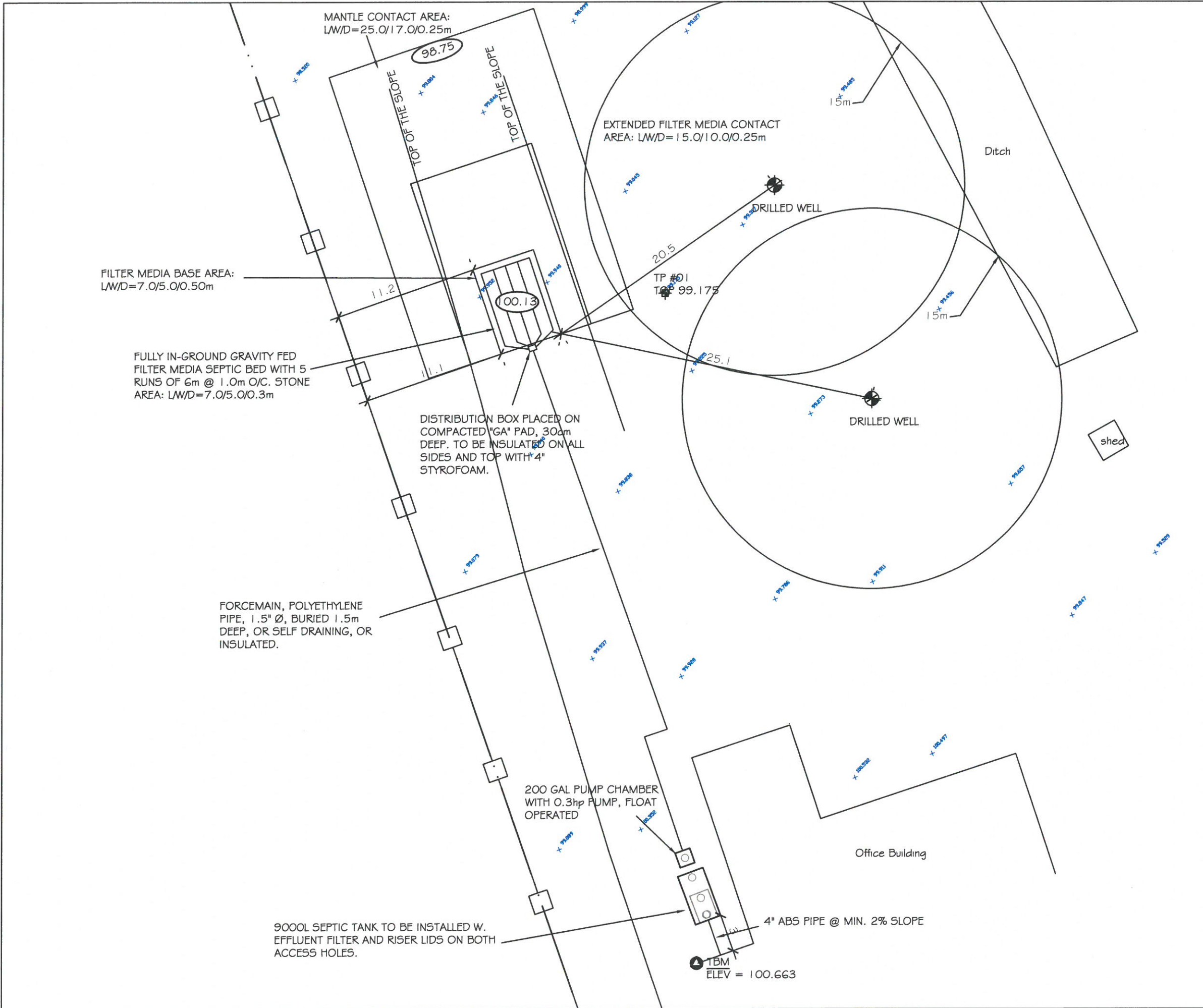

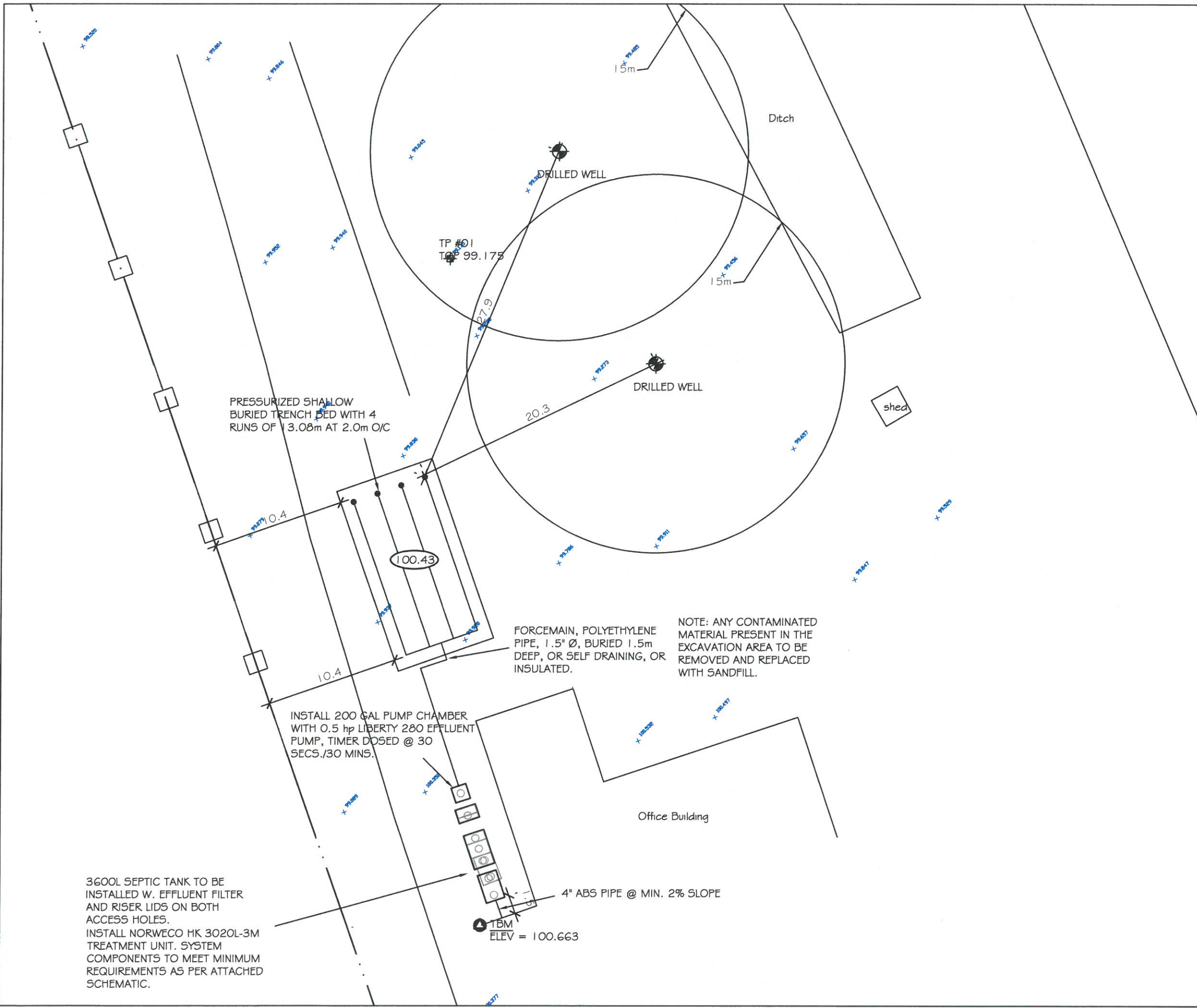

**NOTES:**

1. ALL TREATMENT UNITS AND LEACHING BED ARE TO BE INSTALLED IN ACCORDANCE WITH MINIMUM OBC CLEARANCE DISTANCES. ANY OMISSIONS OR INACCURACIES SHALL BE BROUGHT TO THE ATTENTION OF GVE AND OSSO.
2. CARE IS TO BE EXERCISED DURING CONSTRUCTION ACTIVITIES NEAR OVERHEAD HYDRO WIRES.
3. EXISTING ELEVATIONS ARE APPROXIMATE. CONTRACTOR MUST VERIFY ALL ELEVATIONS AND DIMENSIONS PRIOR TO CONSTRUCTION.
4. SOIL CONDITIONS ARE ACCURATE FOR THE LOCATIONS SHOWN. CONTRACTOR MUST CONTACT THE DESIGN ENGINEER OR REGULATORY AUTHORITY SHOULD SOIL CONDITIONS DIFFER.
5. ALL DIMENSIONS AND CONDITIONS TO BE VERIFIED ON SITE, FIGURED DIMENSIONS TAKE PRECEDENCE OVER SCALE.
6. UTILITY LOCATES SHALL BE COMPLETED PRIOR TO ANY EXCAVATION.
7. THIS IS NOT A PLAN OF SURVEY AND SHALL NOT BE USED EXCEPT FOR THE PURPOSE INDICATED IN THE TITLE BLOCK.
8. THIS DOCUMENT IS COPYRIGHT PROTECTED AND IS THE SOLE PROPERTY OF GVE GROUP. THIS DRAWING SHALL NOT BE ALTERED IN ANY MANNER.
9. EXISTING LOT SERVICED WITH A DRILLED WELL.

**METRIC:**  
 DISTANCES AND ELEVATIONS SHOWN ON THIS PLAN ARE IN METERS AND MAY BE CONVERTED TO FEET BY DIVIDING BY 0.3048.

**LEGEND:**

- PROPOSED ELEVATION
- x EXISTING ELEVATION
- EXISTING WORKS
- PROPOSED SEWAGE WORKS
- FENCE LINE
- PROPERTY LINE
- TBM TEMPORARY BENCH MARK (DESCRIPTION: UNDERSIDE OF SIDING)
- TEST PIT LOCATION

**SEPARATION DISTANCES:**

1. MINIMUM CLEARANCE FROM SEPTIC PIPE TO:
  - LOT LINE = 3.0m
  - HOUSE = 5.0m
  - DRILLED WELL = 15.0m
2. MINIMUM CLEARANCE FROM TREATMENT UNITS TO:
  - LOT LINE = 3.0m
  - HOUSE = 1.5m
  - DRILLED WELL = 15.0m

3600L SEPTIC TANK TO BE INSTALLED W. EFFLUENT FILTER AND RISER LIDS ON BOTH ACCESS HOLES. INSTALL NORWECO HK 3020L-3M TREATMENT UNIT. SYSTEM COMPONENTS TO MEET MINIMUM REQUIREMENTS AS PER ATTACHED SCHEMATIC.

INSTALL 200 GAL PUMP CHAMBER WITH 0.5 hp LIBERTY 280 EFFLUENT PUMP, TIMER DOSED @ 30 SECS./30 MINS.

FORCEMAIN, POLYETHYLENE PIPE, 1.5" Ø, BURIED 1.5m DEEP, OR SELF DRAINING, OR INSULATED. NOTE: ANY CONTAMINATED MATERIAL PRESENT IN THE EXCAVATION AREA TO BE REMOVED AND REPLACED WITH SANDFILL.

4" ABS PIPE @ MIN. 2% SLOPE

|  |                   |              |          |             |                     |
|--|-------------------|--------------|----------|-------------|---------------------|
| Drawn by:  | DP                | Designed by: | DP       | Checked by: | WS                  |
| Rev.   | Description       | Date         | Approved |             |                     |
| Township   | Plan#             | Lot          | Sublot   | Con         |                     |
|  |                   |              |          |             | Draw. No. SF7075-23 |
| County:  | Civic Address:    | Date:        | Scale:   |             |                     |
| METCALFE   | 2545 9TH LINE RD. | 24/05/23     | 1:200    |             |                     |
| GREEN VALLEY ENVIRONMENTAL   |                   |              |          |             |                     |
| On Site Sewage Treatment Plan for the Residence of: ASB GREENWORLD |                   |              |          |             |                     |