

1 TREE CONSERVATION REPORT & LANDSCAPE PLAN
L.1 SCALE 1:300

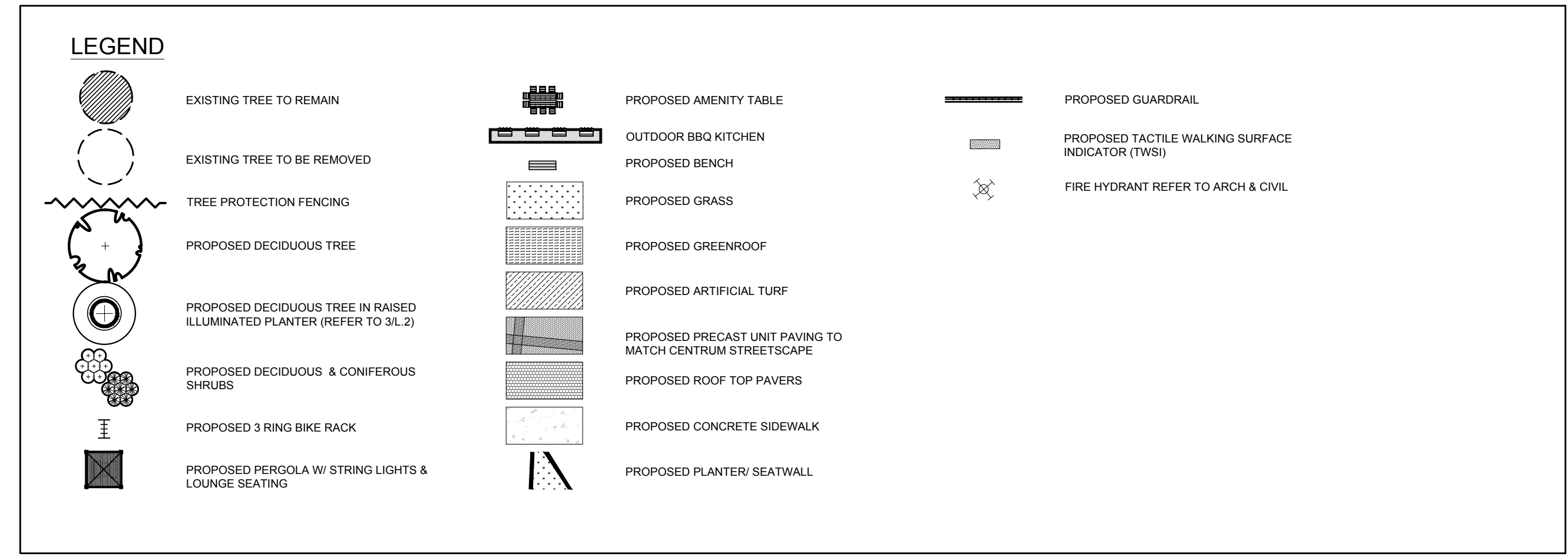

GENERAL NOTES

- IT IS THE RESPONSIBILITY OF THE APPROPRIATE CONTRACTOR OR OFFICIAL TO REPORT ANY ERRORS, OMISSIONS OR DISCREPANCIES ON THIS PLAN WITH ACTUAL SITE CONDITIONS TO THE LANDSCAPE ARCHITECT BEFORE PROCEEDING WITH CONSTRUCTION.
- THE CONTRACTOR IS TO NOTIFY ALL UTILITY COMPANIES AND AUTHORITIES PRIOR TO ANY EXCAVATION AND ASCERTAIN LOCATIONS OF UNDERGROUND SERVICES.
- THE CONTRACTOR IS TO REINSTATE ALL AREAS AND ITEMS DAMAGED AS A RESULT OF CONSTRUCTION ACTIVITY.
- THE CONTRACTOR IS TO COMPLY WITH ALL PERTINENT CODES AND BY-LAWS.
- THE CONTRACTOR IS TO MAINTAIN A POSITIVE SURFACE RUN-OFF THROUGHOUT THE ENTIRE CONSTRUCTION PERIOD.
- THE LANDSCAPE ARCHITECT IS NOT RESPONSIBLE FOR SUBSURFACE CONDITIONS.
- THE CONTRACTOR IS TO IDENTIFY ALL EXISTING TREES TO REMAIN ON SITE WITH THE LANDSCAPE ARCHITECT PRIOR TO CONSTRUCTION.
- THE CONTRACTOR IS TO STAKE THE PROPOSED LOCATION OF ALL PLANT MATERIAL IN CONJUNCTION WITH THE LANDSCAPE ARCHITECT PRIOR TO EXCAVATION.
- MINIMUM DISTANCES FOR SELECTED DECIDUOUS TREES ARE AS FOLLOWS:
 - BUILDING FOUNDATIONS - 7.5M
 - SIDEWALKS - 1.5M
 - PUBLIC STREETS - 2.5M
 - UNDERGROUND INFRASTRUCTURE - 2.0M
- ALL TREES WITHIN 1M OF UNDERGROUND UTILITY TRENCHES ARE TO BE EXCAVATED BY HAND.
- REMOVE ALL PROTECTIVE WRAPPING FROM TREE TRUNKS AFTER INSTALLATION.
- STAKING OF TREES SHALL ONLY BE PERFORMED IF NECESSARY.
- ENSURE THAT MULCH IS PULLED BACK A MINIMUM DISTANCE OF 75MM FROM BASE OF TREE TRUNK.

EXISTING TREE LIST

KEY	QTY	BOTANICAL NAME	COMMON NAME	SIZE	CONDITION	REMARKS	OWNERSHIP	COMMENTS
DECIDUOUS TREES								
1	1	Gleditsia triacanthos	Honey Locust	280mm DBH	Good	To remain	City of Ottawa	
2	1	Gleditsia triacanthos	Honey Locust	250mm DBH	Good	To be removed	265 Centrum	conflicts with excavation
3	1	Gleditsia triacanthos	Honey Locust	240mm DBH	Good	To be removed	265 Centrum	conflicts with excavation
4	1	Gleditsia triacanthos	Honey Locust	280mm DBH	Good	To be removed	265 Centrum	conflicts with excavation
5	1	Gleditsia triacanthos	Honey Locust	280mm DBH	Good	To be removed	265 Centrum	conflicts with excavation
6	1	Gleditsia triacanthos	Honey Locust	280mm DBH	Good	To be removed	265 Centrum	conflicts with excavation
7	1	Gleditsia triacanthos	Honey Locust	280mm DBH	Good	To be removed	265 Centrum	conflicts with excavation
8	1	Gleditsia triacanthos	Honey Locust	250mm DBH	Good	To remain	City of Ottawa	
9	1	Gleditsia triacanthos	Honey Locust	280mm DBH	Good	To be removed	265 Centrum	conflicts with excavation
10	1	Gleditsia triacanthos	Honey Locust	250mm DBH	Good	To be removed	265 Centrum	conflicts with excavation
11	1	Gleditsia triacanthos	Honey Locust	300mm DBH	Good	To be removed	265 Centrum	conflicts with excavation
12	1	Gleditsia triacanthos	Honey Locust	300mm DBH	Good	To be removed	265 Centrum	conflicts with utilities
13	1	Gleditsia triacanthos	Honey Locust	300mm DBH	Good	To remain	265 Centrum	
14	1	Gleditsia triacanthos	Honey Locust	250mm DBH	Good	To be removed	265 Centrum	conflicts with excavation
15	1	Gleditsia triacanthos	Honey Locust	250mm DBH	Good	To remain	265 Centrum	
16	1	Populus deltoides	Eastern Cottonwood	300mm DBH	Good	To remain	City of Ottawa	
17	1	Gleditsia triacanthos	Honey Locust	350mm DBH	Good	To be removed	265 Centrum	conflicts with excavation
18	1	Picea pungens	Colorado Spruce	300mm DBH	Good	To remain	City of Ottawa	
19	1	Picea pungens	Colorado Spruce	250mm DBH	Good	To remain	City of Ottawa	
20	1	Picea pungens	Colorado Spruce	250mm DBH	Good	To remain	City of Ottawa	
21	1	Picea pungens	Colorado Spruce	250mm DBH	Good	To remain	City of Ottawa	
22	1	Acer platanoides	Columnar Norway Maple	200mm DBH	Good	To be removed	265 Centrum	conflicts with excavation
23	1	Acer platanoides	Columnar Norway Maple	200mm DBH	Good	To be removed	265 Centrum	conflicts with excavation
24	1	Acer platanoides	Columnar Norway Maple	200mm DBH	Good	To be removed	265 Centrum	conflicts with excavation
25	1	Acer platanoides	Columnar Norway Maple	230mm DBH	Good	To be removed	265 Centrum	conflicts with excavation
26	1	Acer platanoides	Columnar Norway Maple	200mm DBH	Good	To be removed	265 Centrum	conflicts with excavation
27	1	Picea pungens	Colorado Spruce	200mm DBH	Good	To be removed	265 Centrum	conflicts with excavation
28	1	Picea pungens	Colorado Spruce	250mm DBH	Good	To be removed	265 Centrum	conflicts with excavation
29	1	Picea pungens	Colorado Spruce	200mm DBH	Good	To be removed	265 Centrum	conflicts with excavation
30	1	Gleditsia triacanthos	Honey Locust	350mm DBH	Good	To be removed	265 Centrum	conflicts with excavation
31	1	Acer negundo	Manitoba Maple	4x250-300mm DBH	Fair	To be removed	265 Centrum	conflicts with excavation
32	1	Acer ginnala	Amur Maple	100mm DBH	Good	To be removed	265 Centrum	conflicts with excavation
33	1	Acer ginnala	Amur Maple	100mm DBH	Good	To be removed	265 Centrum	conflicts with excavation
34	1	Acer ginnala	Amur Maple	100mm DBH	Good	To be removed	265 Centrum	conflicts with excavation
35	1	Fraxinus spp. 'Multi-Stem'	Multistem Ash	100-200mm DBH	Good	To be removed	265 Centrum	conflicts with excavation
36	1	Syringa reticulata	Japanese Tree Lilac	100mm DBH	Good	To be removed	265 Centrum	conflicts with excavation
37	1	Syringa reticulata	Japanese Tree Lilac	100mm DBH	Good	To be removed	265 Centrum	conflicts with excavation
38	1	Quercus macrocarpa	Bar Oak	260mm DBH	Good	To be removed	265 Centrum	conflicts with excavation
39	1	Thuja occidentalis 'Fastigiata'	Columnar White Cedar	100mm DBH	Fair	To remain	City of Ottawa	
40	1	Thuja occidentalis 'Fastigiata'	Columnar White Cedar	100mm DBH	Fair	To remain	City of Ottawa	
41	1	Thuja occidentalis 'Fastigiata'	Columnar White Cedar	100mm DBH	Fair	To remain	City of Ottawa	
42	1	Gleditsia triacanthos	Honey Locust	2x350-400mm DBH	Good	To remain	City of Ottawa	
43	1	Picea pungens	Colorado Spruce	300mm DBH	Good	To remain	City of Ottawa	
44	1	Picea pungens	Colorado Spruce	300mm DBH	Good	To remain	City of Ottawa	
45	1	Picea pungens	Colorado Spruce	300mm DBH	Good	To remain	City of Ottawa	
46	1	Picea pungens	Colorado Spruce	300mm DBH	Good	To remain	City of Ottawa	
47	1	Picea pungens	Colorado Spruce	300mm DBH	Good	To remain	City of Ottawa	

NOTE: 27 TREES TO BE REMOVED

PROPOSED PLANT LIST

KEY	QTY	BOTANICAL NAME	COMMON NAME	SIZE	CONDITION	REMARKS	ORIGIN
TREES							
BP	3	Betula populifolia 'Multi-stem'	Multi-stem Gray Birch	60mm cal.	B&B		Native
CC	2	Crataegus crus-galli var. inermis	Thornless Cockspur Hawthorn	60mm cal.	B&B		Native
GT	7	Gleditsia triacanthos 'Skyline'	Skyline Honey Locust	60mm cal.	B&B		Native
PG	3	Picea glauca	White Spruce	1800 mm ht.	B&B		Native
SHRUBS							
Cs	20	Cornus sericea	Red Osier Dogwood	800mm ht.	Potted	1200 mm o.c.	Native
Ha	55	Hydrangea arborescens 'Annabelle'	Annabelle Hydrangea	3 gal. pot	Potted	800 mm o.c.	Native
Jh	26	Juniperus horizontalis 'Bar Harbor'	Bar Harbor Juniper	600 mm spr.	Potted	800 mm o.c.	Native
Pm	23	Pinus mugo 'Pumilio'	Dwarf Mugo Pine	600mm spr.	Potted	1200 mm o.c.	Non-native
Ra	191	Rhus aromatica	Fragrant Sumac	600mm ht.	Potted	800 mm o.c.	Native
Rt	23	Rosa rugosa	Rugosa Rose	800mm ht.	Potted	800 mm o.c.	Non-native
Sg	15	Spiraea x arguta	Garland Spiraea	800mm spr.	Potted	1000 mm o.c.	Non-native
Tm	39	Taxus media 'Hickii'	Hick's Yew	1000 mm ht.	Potted	1500 mm o.c.	Non-native
Tr	39	Taxus x media 'Densiflora'	Dense Spreading Yew	500 mm spr.	Potted	800 mm o.c.	Non-native
PERENNIALS							
ca	21	Calamagrostis x acutiflora 'Karl Foerster'	Karl Foerster Grass	250mm pot	Potted	800 mm o.c.	Non-native
ef	45	Euonymus fortunei 'Coloratus'	Wintercreeper	2 gal pot	Potted	600 mm o.c.	Native
la	401	Leymus arenarius	Blue Lyme Grass	1 gal pot	Potted	300 mm o.c.	Non-native
pv	145	Panicum virgatum 'Prairie Fire'	Prairie Fire Red Switch Grass	100mm pot	Potted	800 mm o.c.	Native
st	42	Sedum telephium 'Autumn Joy'	Autumn Joy Sedum	150mm pot	Potted	400 mm o.c.	Non-native

TREE CANOPY CALCULATION CHART

PROPOSED TREE CANOPY COVERAGE TOTAL	400m ²
EXISTING TREE CANOPY COVERAGE TOTAL	29.7m ²
SITE AREA (EXCL. BUILDING FOOTPRINT & OVERHANGS)	3,753m ²
SITE AREA COVER	13.7%
CANOPY COVER TARGET	40%

NOTE: PROPOSED TREES SHOWN AT 40-YEAR CANOPY PROJECTIONS:
 - 3m CANOPY DIAMETER FOR SMALL TREES
 - 10m CANOPY DIAMETER FOR MEDIUM TREES
 - 14m CANOPY DIAMETER FOR LARGE TREES



CLIENT
BAYVIEW ORLEANS INC.

CONSULTANTS
ARCHITECTS
B+H
320 Bay St. #200
Toronto, ON M5H 4A6
Tel: (416) 596-2299

SURVEYORS:
ANNIS, O'SULLIVAN, VOLLEBEK LTD.
14 Concourse Gate, Suite 500
Newport, ON K7E 7E6
Phone: (613) 727-0850 / Fax: (613) 727-1079

CIVIL ENGINEERS:
McINTOSH PERRY
115 Walgreen Rd.
Carp, ON K0A 1L0
Tel: (613) 836-2184

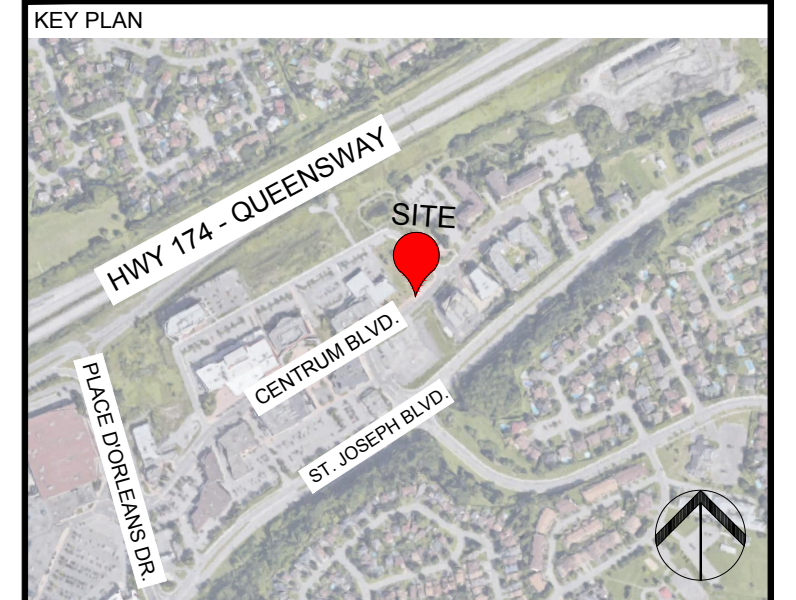

No.	Issue	Date	By	Checked
10	ISSUED FOR COMMENTS AND REVIEW	07/30/2024	WF	JL
9	ISSUED FOR COMMENTS AND REVIEW	07/11/2024	WF	JL
8	ISSUED FOR COMMENTS AND REVIEW	03/06/2024	WF	JL
7	ISSUED FOR COMMENTS AND REVIEW	02/05/2024	WF	JL
6	ISSUED FOR COMMENTS AND REVIEW	01/29/2024	WF	JL
5	ISSUED FOR COMMENTS AND REVIEW	01/17/2024	WF	JL
4	ISSUED FOR SPA	03/24/2023	SL	JL
3	ISSUED FOR REVIEW & COMMENT	03/21/2023	SL	JL
2	ISSUED FOR REVIEW & COMMENT	03/15/2023	SL	JL
1	ISSUED FOR PROGRESS REVIEW	03/10/2023	SL	JL

No. Issue Date By Checked
DR CK

JAMES B. LENNOX & ASSOCIATES INC.
LANDSCAPE ARCHITECTS
3332 CARLING AVE. OTTAWA, ONTARIO K2H 5A8
Tel: (613) 722-5168 Fax: (866) 343-9942

PROJECT
265 CENTRUM, OTTAWA ON

DRAWING
TREE CONSERVATION REPORT & LANDSCAPE PLAN

STAMP
SCALE AS SHOWN
START DATE FEBRUARY 2023
PROJECT NO. 23MIS2323

PROJECT NORTH
DRAWING NO. L.1
PLOT SIZE ARCH-D

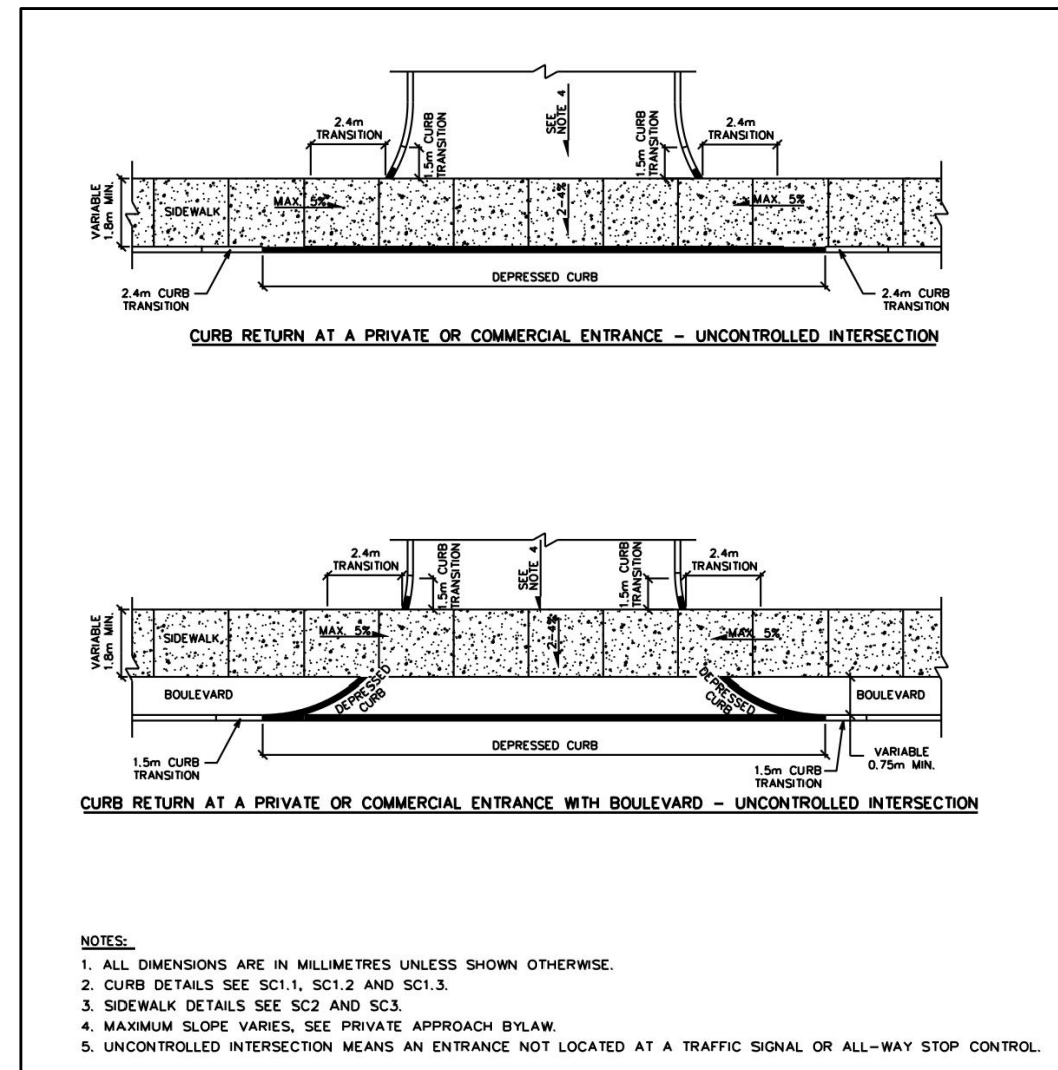

NOTES:
 1. ALL DIMENSIONS ARE IN MILLIMETRES UNLESS SHOWN OTHERWISE.
 2. CURB DETAILS SEE SC1.1, SC1.2 AND SC1.3
 3. SIDEWALK DETAILS SEE SC2 AND SC3
 4. MAXIMUM SLOPE VARIES, SEE PRIVATE APPROACH BY-LAW
 5. UNCONTROLLED INTERSECTION MEANS AN ENTRANCE NOT LOCATED AT A TRAFFIC SIGNAL OR ALL-WAY STOP CONTROL.

	DATE: MARCH 2007
	DATE: MARCH 2021
CURB RETURN ENTRANCES - UNCONTROLLED INTERSECTIONS	DWG. NO.: SC7.1

6 CONTINUOUS SIDEWALK
 SCALE NTS

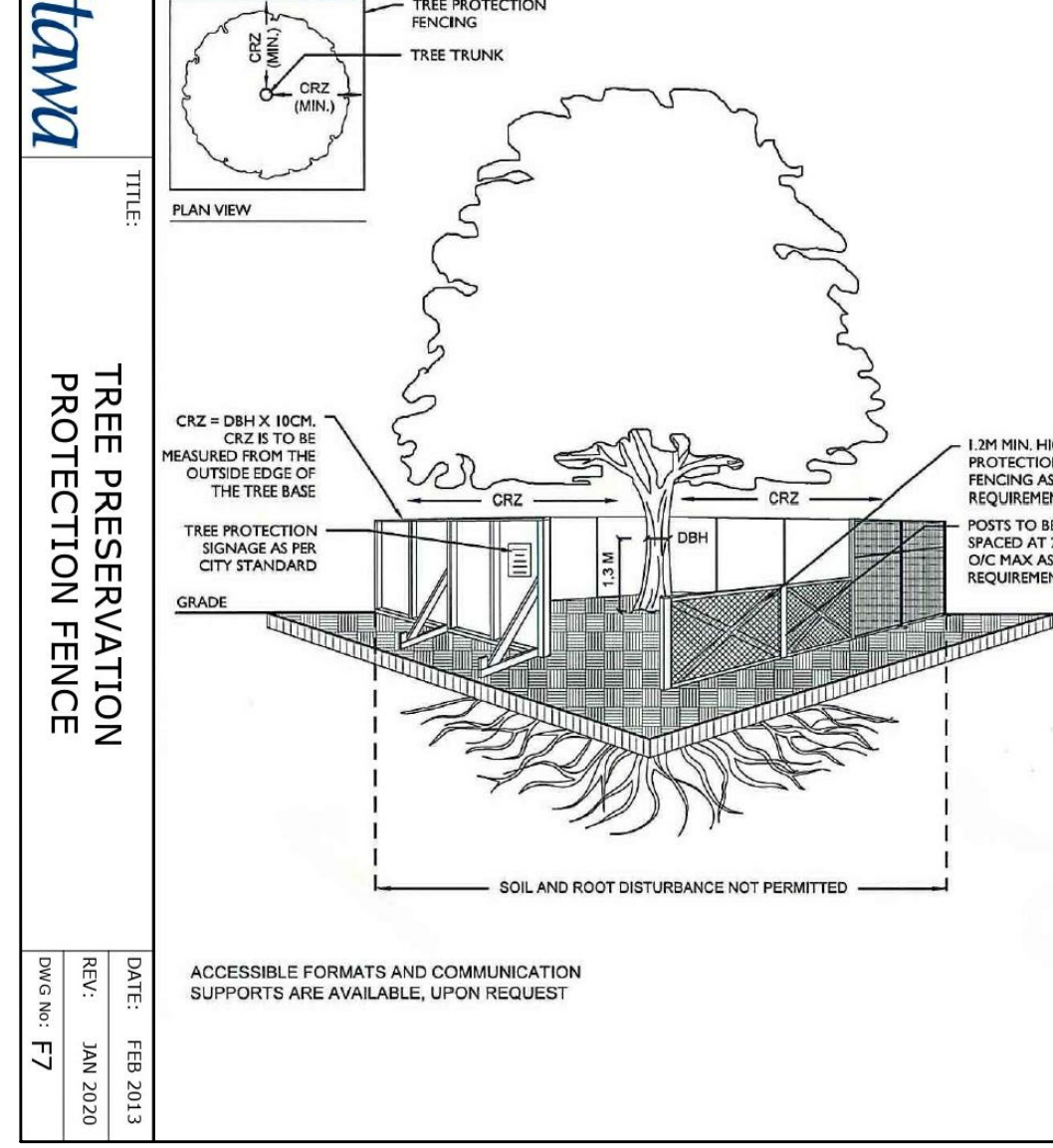

1 TREE PROTECTION FENCE
 SCALE NTS

TREE PROTECTION REQUIREMENTS:

- PRIOR TO ANY WORK ACTIVITY WITHIN THE CRITICAL ROOT ZONE (CRZ - 10 X DIAMETER OF A TREE, TREE PROTECTION FENCING MUST BE INSTALLED SURROUNDING THE CRITICAL ROOT ZONE, AND REMAIN IN PLACE UNTIL THE WORK IS COMPLETE.
- UNLESS PLANS ARE APPROVED BY CITY FORESTRY STAFF, FOR WORK WITHIN THE CRZ:
 - DO NOT PLACE ANY MATERIAL OR EQUIPMENT - INCLUDING OUTRIGGERS,
 - DO NOT ATTACH ANY SIGNS, NOTICES OR POSTERS TO ANY TREE;
 - DO NOT BASE OR LOWER THE EXISTING GRADE;
 - TUNNEL OR BORE WHEN DIGGING;
 - DO NOT DAMAGE THE ROOT SYSTEM, TRUNK, OR BRANCHES OR ANY TREE;
 - INSURE THAT SHARpest EDGES FROM ALL EQUIPMENT ARE NOT DIRECTED TOWARD ANY TREE CANOPY;
 - DO NOT EXTEND HARD SURFACE OR SIGNIFICANTLY CHANGE LANDSCAPING.
- TREE PROTECTION FENCING MUST BE AT LEAST 1.2M IN HEIGHT, AND CONSTRUCTED OF RIGID OR FRAMED MATERIALS (E.G. KOSOLAKE, STEEL, PLYWOOD HOARDING, OR SHOWN FRAME) ON A 2"x4" WOOD FRAME WITH POSTS 2.4M APART, SUCH THAT THE FENCE LOCATION CANNOT BE ALTERED. ALL SUPPORTS AND BRACING MUST BE PLACED OUTSIDE OF THE CRZ, AND INSTALLATION MUST MINIMIZE DAMAGE TO EXISTING ROOTS. (SEE DETAIL)
- THE LOCATION OF THE TREE PROTECTION FENCING MUST BE DETERMINED BY AN ARBORIST AND DETAILED ON ANY ASSOCIATED PLANS FOR THE SITE (E.G. TREE CONSERVATION REPORT, TREE DISCLOSURE REPORT, ETC.). THE PLAN AND CONSTRUCTION FENCING MUST BE APPROVED BY CITY FORESTRY STAFF PRIOR TO THE COMMENCEMENT OF WORK.
- IF THE FENCING TREE PROTECTION AREA MUST BE REDUCED TO FACILITATE CONSTRUCTION, MITIGATION MEASURES MUST BE PRESCRIBED BY AN ARBORIST AND APPROVED BY CITY FORESTRY STAFF. THESE MAY INCLUDE THE PLACEMENT OF PLYWOOD, WOOD CHIPS, OR STEEL PLATING OVER THE ROOTS FOR PROTECTION OF THE PROPER PRUNING AND CARE OF ROOTS WHERE ENDOLETERED.

BY-LAWS:
 ALL CITY-OWNED TREES ARE PROTECTED UNDER THE MUNICIPAL TREES AND NATURAL AREAS PROTECTION BY-LAW (2006-270). WITHIN THE URBAN AREA, PRIVATELY OWNED TREES GREATER THAN 150MM DIAMETER ON LOTS 1-5A IN SIZE OR 150MM AND TREES GREATER THAN 150MM DIAMETER ON LOTS 1-5HA, ARE PROTECTED UNDER THE URBAN TREE CONSERVATION BY-LAW (2009-205).

2 TREE PLANTING IN CURBED PLANTING PIT
 SCALE NTS

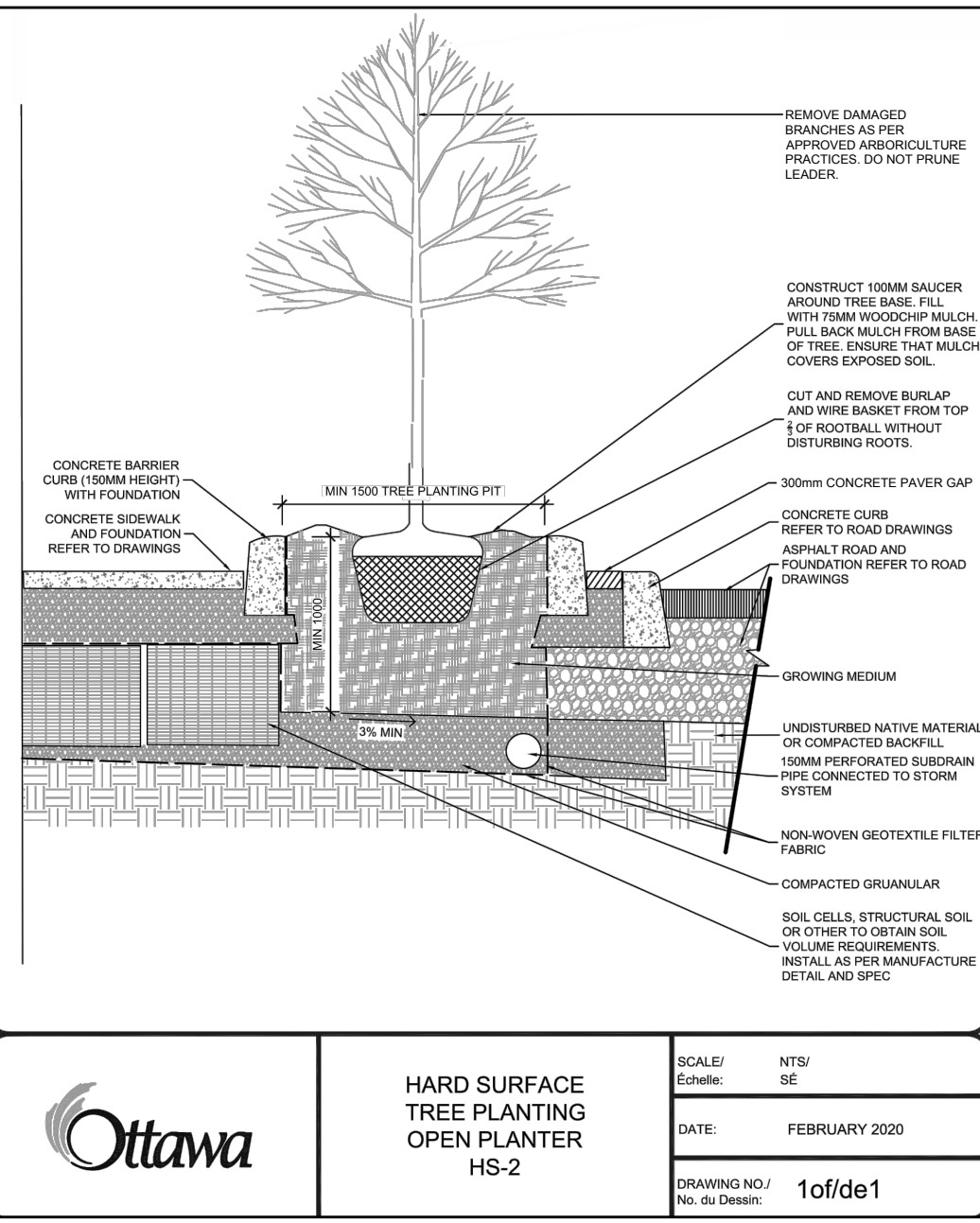

3 RAISED PLANTER & ILLUMINATED TREE PIT DETAIL
 SCALE 1:25

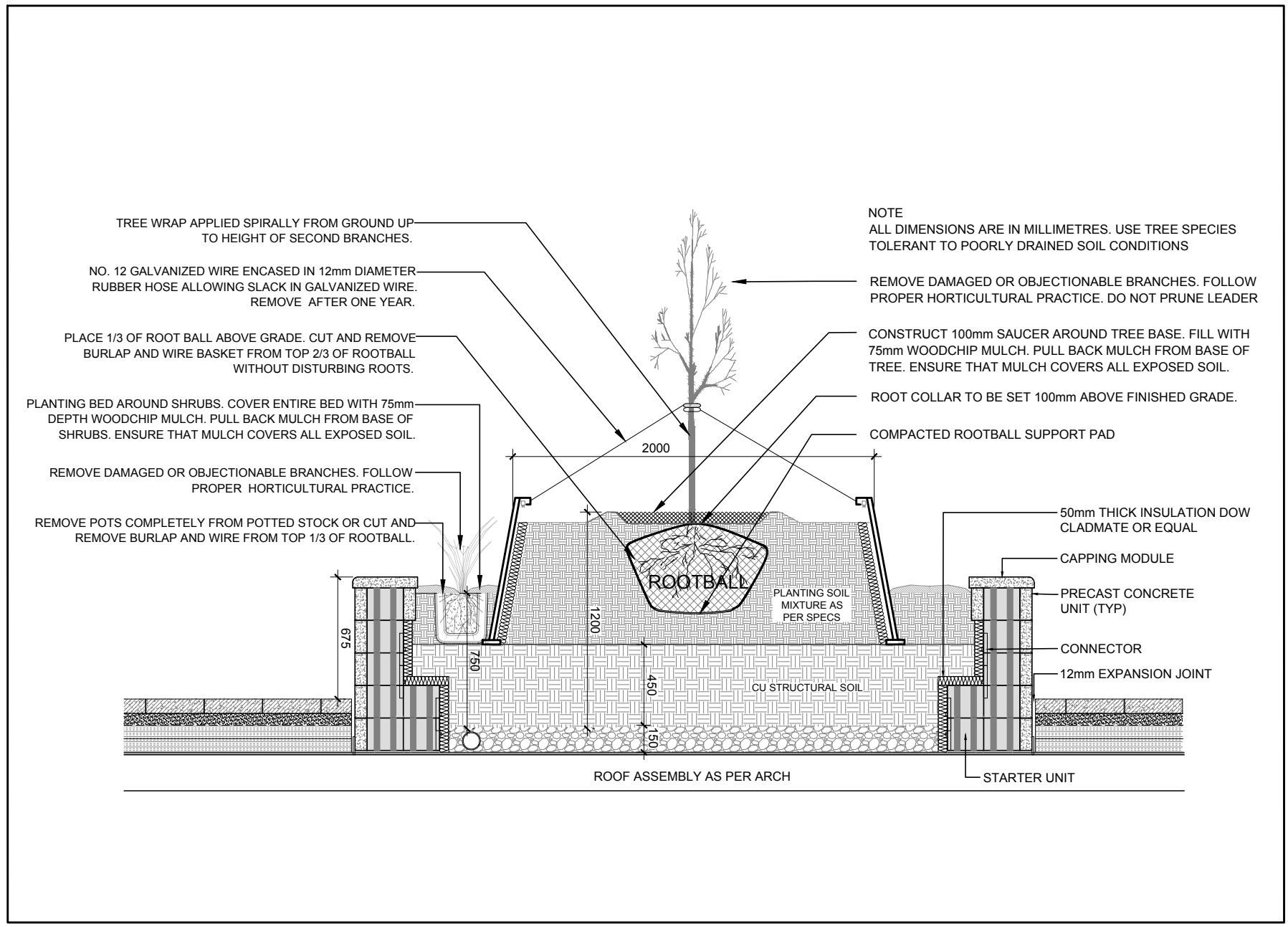

4 DOUBLESIDED PRECAST SEATED WALL
 SCALE NTS

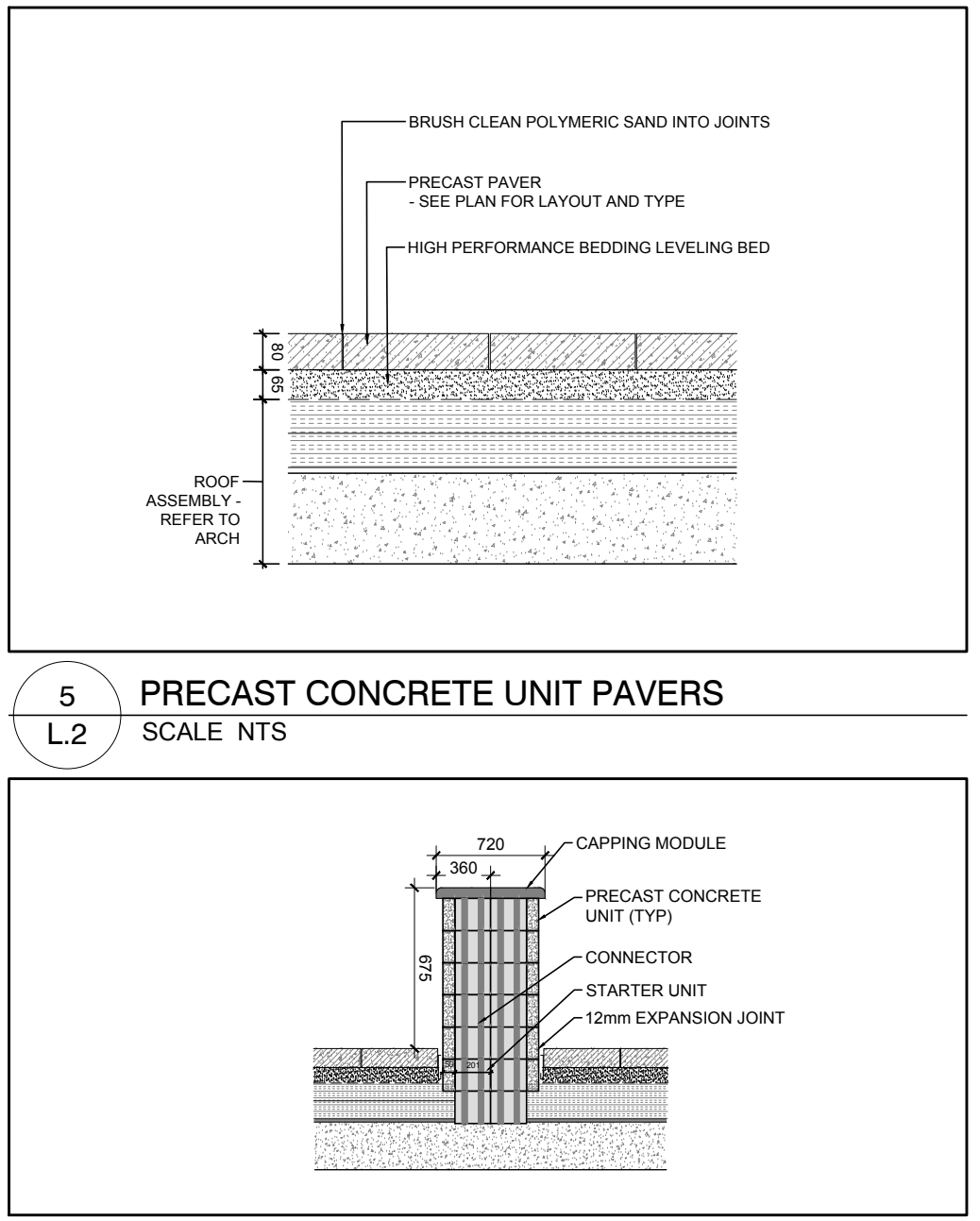

5 PRECAST CONCRETE UNIT PAVERS
 SCALE NTS

CLIENT
 BAYVIEW ORLEANS INC.

CONSULTANTS
 ARCHITECTS: **B+H**
 320 Bay St. #200
 Toronto, ON M5H 4A6
 Tel.: (416) 596-2299

SURVEYORS:
 ANNIS, O'SULLIVAN, VOLLEBECK LTD.
 14 Concourse Gate, Suite 500
 Niagara, ON K2H 7J6
 Phone: (813) 727-0850 / Fax: (813) 727-1079

CIVIL ENGINEERS:
McINTOSH PERRY
 115 Walgreen Rd,
 Carp, ON K0A 1L0
 Tel.: (613) 836-2184

10	ISSUED FOR COMMENTS AND REVIEW	07/30/2024	WF	JL
9	ISSUED FOR COMMENTS AND REVIEW	07/11/2024	WF	JL
8	ISSUED FOR COMMENTS AND REVIEW	03/06/2024	WF	JL
7	ISSUED FOR COMMENTS AND REVIEW	02/05/2024	WF	JL
6	ISSUED FOR COMMENTS AND REVIEW	01/29/2024	WF	JL
5	ISSUED FOR COMMENTS AND REVIEW	01/17/2024	WF	JL
4	ISSUED FOR SPA	03/24/2023	SL	JL
3	ISSUED FOR REVIEW & COMMENT	03/21/2023	SL	JL
2	ISSUED FOR REVIEW & COMMENT	03/15/2023	SL	JL
1	ISSUED FOR PROGRESS REVIEW	03/10/2023	SL	JL

No.	Issue	Date	DR	CK
		MM/DD/YYYY		

JAMES B. LENNOX & ASSOCIATES INC.
 LANDSCAPE ARCHITECTS
 3332 CARLING AVE. OTTAWA, ONTARIO K2H 5A8
 Tel: (613) 722-5168 Fax: (866) 343-3942

PROJECT
 265 CENTRUM, OTTAWA ON

DRAWING
 DETAILS

STAMP
 ASSOCIATION OF LANDSCAPE ARCHITECTS
 MEMBER
 SCALE AS SHOWN
 START DATE FEBRUARY 2023
 PROJECT NO. 23MIS2323

PROJECT NORTH
 DRAWING NO. **L.2**

PLOT SIZE ARCH-D