

SAN STRUCTURE TABLE				
NAME	RIM ELEV.	INVERT IN	INVERT OUT	DESCRIPTION
MH2A	75.79	S673.520	N73.278	STRUC. OPSD 701.011 COVER CITY 524 FRAME CITY 525
MH2B	75.25	S73.111	N71.194	STRUC. OPSD 701.011 COVER CITY 524 FRAME CITY 525 CW EXTERNAL DITCH STRUCTURE PER OPSD 1003.010
MH2C	71.16	S68.710	NW68.650	STRUC. OPSD 701.011 COVER CITY 524 FRAME CITY 525
MH2D	70.11	S67.200	SW66.440	STRUC. OPSD 701.011 COVER CITY 524 FRAME CITY 525 CW EXTERNAL DITCH STRUCTURE PER OPSD 1003.010
MH2E	69.45	N665.500	NW65.000	STRUC. OPSD 701.011 COVER CITY 524 FRAME CITY 525

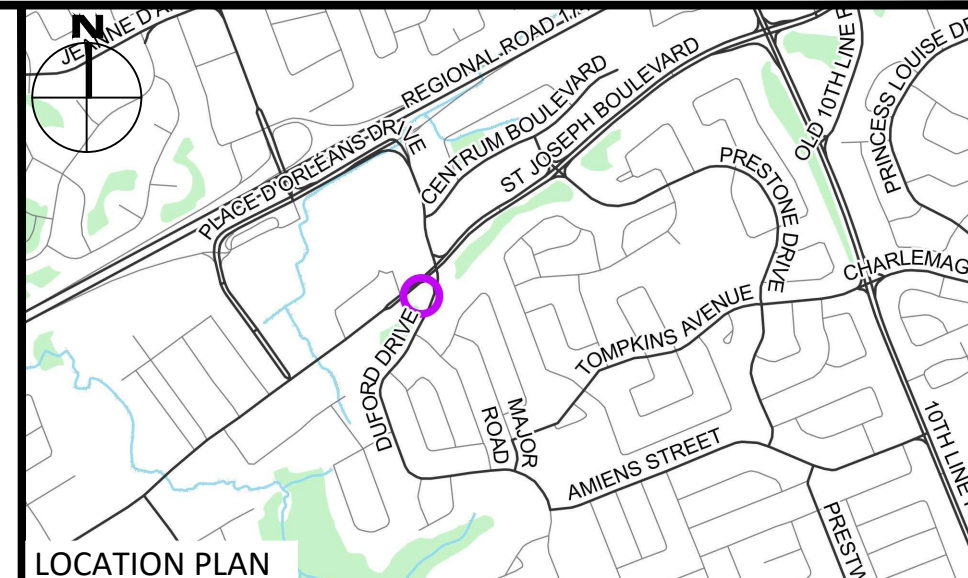

LEGEND	
UC	BARRIER CURB & CURB DEPRESSION
PROPOSED CONCRETE PAVERS	SLOPING AT 3:1 UNLESS SPECIFIED
MH	STORM MANHOLE
CB	CATCH-BASIN, CURB INLET OR DITCH INLET
MHRA	SANITARY MANHOLE
PROPERTY LINE	PRE AND POST-DEVELOPMENT DRAINAGE DIRECTIONS
EX. WATER VALVE/CHAMBER	HEAVY DUTY SILT FENCE BARRIER PER OPSD 219.130
PROP. VALVE PER CITY W24	BUILDING ENTRANCE
FIRE HYDRANT	PROPOSED GRASS
PROPOSED WALL	CENTRELINE OF SWALE
PROPOSED SIAMASE CONNECTION	PROPOSED ROAD/CUT AND RESTAURATION PER CITY R10
PROPOSED WATER METER AND REMOTE METER	CB SILT SACK PER C101 DETAIL
PROPOSED CONCRETE SIDEWALK	SERVICE/SEWER CROSSING
PROP AND EX. REDUCER	EX. UG STREET LIGHT
U/G HYDRO DUCT PER ELEC.	EX. TRAFFIC LINE
EX. STM SEWER	EX. WATERMAIN
EX. SAN SEWER	EX. GAS
	EX. OHW
	EX. TRAFFIC CABLE
	BELL
	EX. BELL
	EX. ROGERS

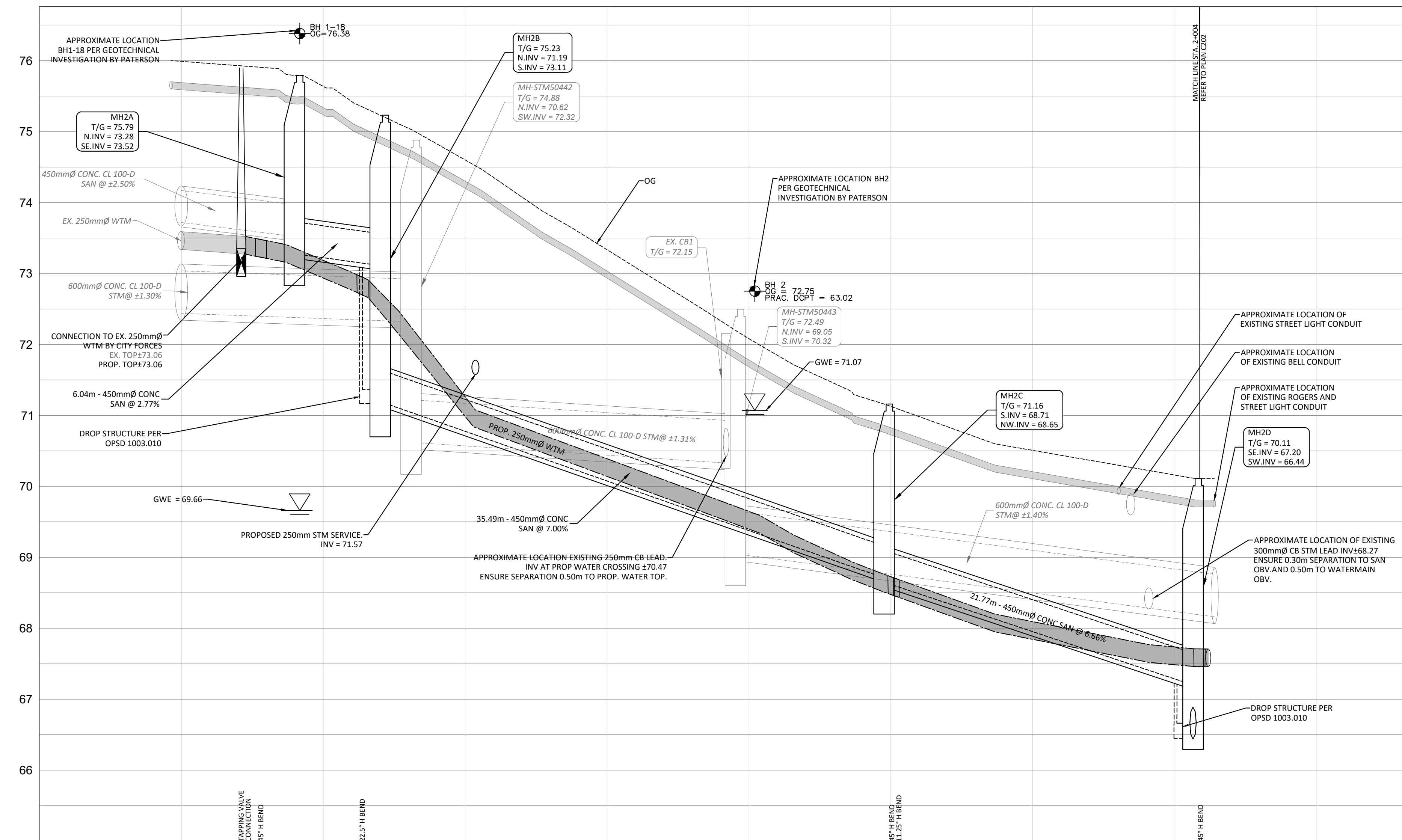

ELEVATIONS PROPOSED		NOTE: CONTRACTOR IS TO PREPARE A SEWER FLOW MANAGEMENT PLAN TO THE SATISFACTION OF THE CITY PRIOR TO CONSTRUCTION.													
TOP OF WATERMAIN	STATION	1+000	1+004	1+006	1+013	1+020	1+021	1+038	1+040	1+050	1+050	1+060	1+062	1+072	1+080
73.53	1+000	73.53	73.48	73.38	72.95	71.05	69.75	68.70	68.70	67.71	67.71	67.20	67.20	67.71	67.71
73.48	1+004	73.38	73.38	73.38	72.95	71.05	69.75	68.70	68.70	67.71	67.71	67.20	67.20	67.71	67.71
73.48	1+006	73.38	73.38	73.38	72.95	71.05	69.75	68.70	68.70	67.71	67.71	67.20	67.20	67.71	67.71
73.38	1+013	73.38	73.38	73.38	72.95	71.05	69.75	68.70	68.70	67.71	67.71	67.20	67.20	67.71	67.71
71.05	1+020	71.05	71.05	71.05	72.95	71.05	69.75	68.70	68.70	67.71	67.71	67.20	67.20	67.71	67.71
69.75	1+038	69.75	69.75	69.75	72.95	71.05	69.75	68.70	68.70	67.71	67.71	67.20	67.20	67.71	67.71
68.70	1+040	68.70	68.70	68.70	72.95	71.05	69.75	68.70	68.70	67.71	67.71	67.20	67.20	67.71	67.71
67.71	1+050	67.71	67.71	67.71	72.95	71.05	69.75	68.70	68.70	67.71	67.71	67.20	67.20	67.71	67.71
67.20	1+060	67.20	67.20	67.20	72.95	71.05	69.75	68.70	68.70	67.71	67.71	67.20	67.20	67.71	67.71
67.20	1+062	67.20	67.20	67.20	72.95	71.05	69.75	68.70	68.70	67.71	67.71	67.20	67.20	67.71	67.71
67.71	1+072	67.71	67.71	67.71	72.95	71.05	69.75	68.70	68.70	67.71	67.71	67.20	67.20	67.71	67.71
67.71	1+080	67.71	67.71	67.71	72.95	71.05	69.75	68.70	68.70	67.71	67.71	67.20	67.20	67.71	67.71

SUBJECT TO APPROVAL

2	ISSUED FOR REVIEW	JUL 31, 2024
1	ISSUED FOR SITE PLAN CONTROL	MAR 07, 2024
No.	Revisions	Date

Check and verify all dimensions before proceeding with the work. Do not scale drawings.

SCALE 1 : 200

115 Walgreen Road, R.R.3  
Carp, ON K0A 1L0  
Tel: 613-836-2184  
Fax: 613-836-3742  
www.egis-group.com

Client: **THEBERGE DEVELOPMENTS LTD**  
1600 LAPERRIERE AVE  
OTTAWA, ON K1Z 8P5

Project: **3030 ST. JOSEPH BOULEVARD**  
OTTAWA ON

Drawing Title: **PLAN & PROFILE STA. 1+000 TO 1+063**

Scale: 1:200 Project Number: CCO-24-0142

Drawn By: RRR

Checked By: AM

Designed By: RRR

Drawing Number: C201

FILENAME: I:\Information\2024\CCO-24-0142\Theberge - 2024-09-10\3030 St. Joseph Blvd\12 - Drawing\CCO-24-0142 - PRESENTATION.dwg  
LAST SAVED: Wednesday, July 31, 2024, 10:51:51 AM  
LAST PLOTTED: Wednesday, July 31, 2024, 10:51:51 AM  
C:\Users\jmacleod\AppData\Local\Temp\CCO-24-0142.dwg

D07-12-23-0090