

STRUCTURE	100 YEAR PONDING ELEVATION	100 YEAR PONDING DEPTH (m)	100 YEAR +20% PONDING ELEVATION	100 YEAR +20% PONDING DEPTH (m)	MAX STATIC PONDING ELEVATION	MAX STATIC PONDING DEPTH (m)
CB01	83.43	0.11	83.48	0.16	83.45	0.13
CBMH01	85.85	0.30	85.86	0.31	85.90	0.35
CBMH02	85.85	0.30	85.86	0.31	85.85	0.30
RY01	82.84	0.09	82.92	0.17	82.84	0.09
RY02	82.84	0.00	82.92	0.00	83.45	0.00
RY03	82.84	0.00	82.92	0.02	83.25	0.35
RY04	82.84	0.00	82.92	0.00	83.26	0.10
RY05	83.97	0.22	84.00	0.25	83.88	0.23
RY06	83.97	0.22	84.00	0.25	83.88	0.23
RY07	83.97	0.00	84.00	0.02	83.88	0.00
RY08	83.96	0.00	84.00	0.00	85.40	0.00

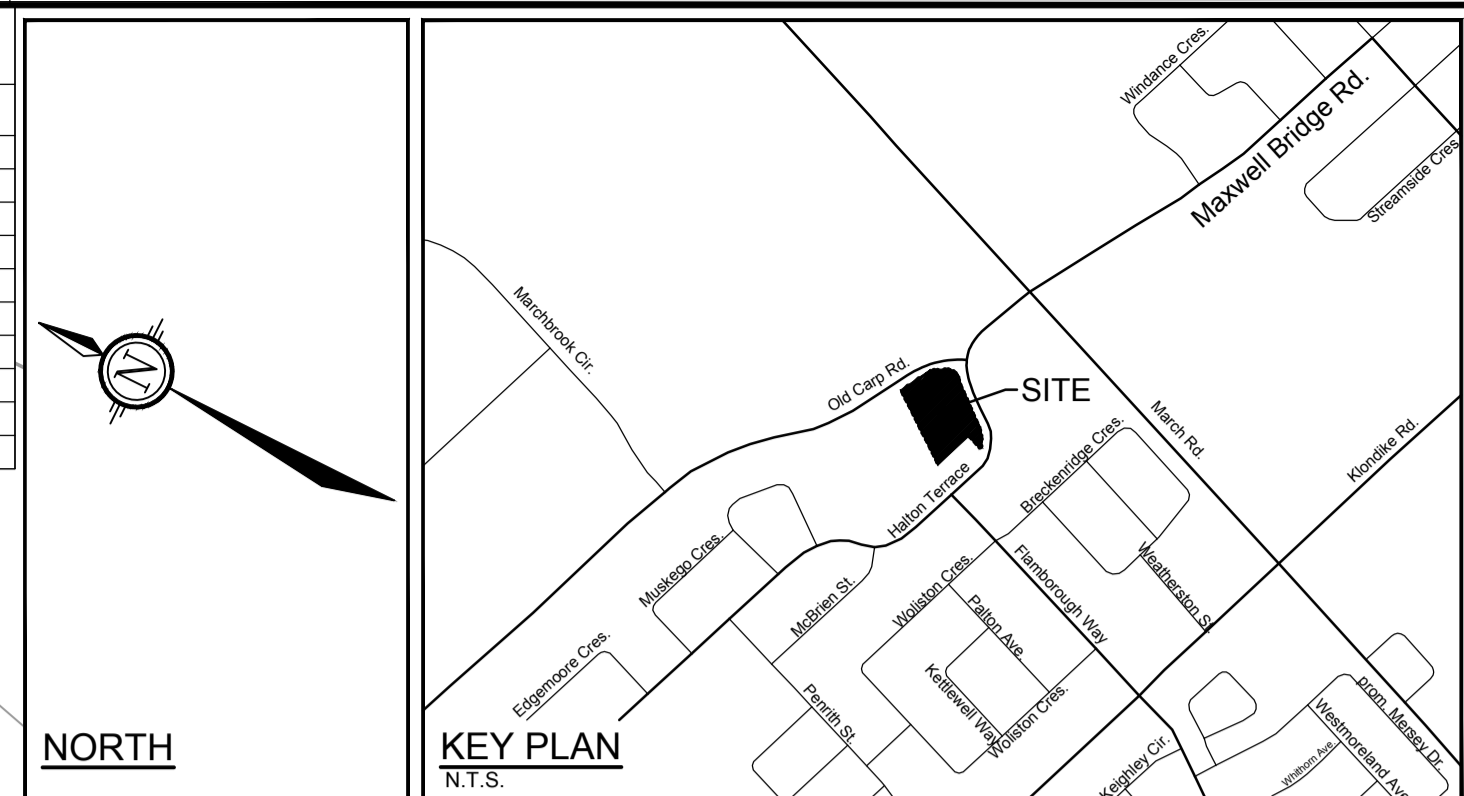

MORGAN'S GRANT SWMF

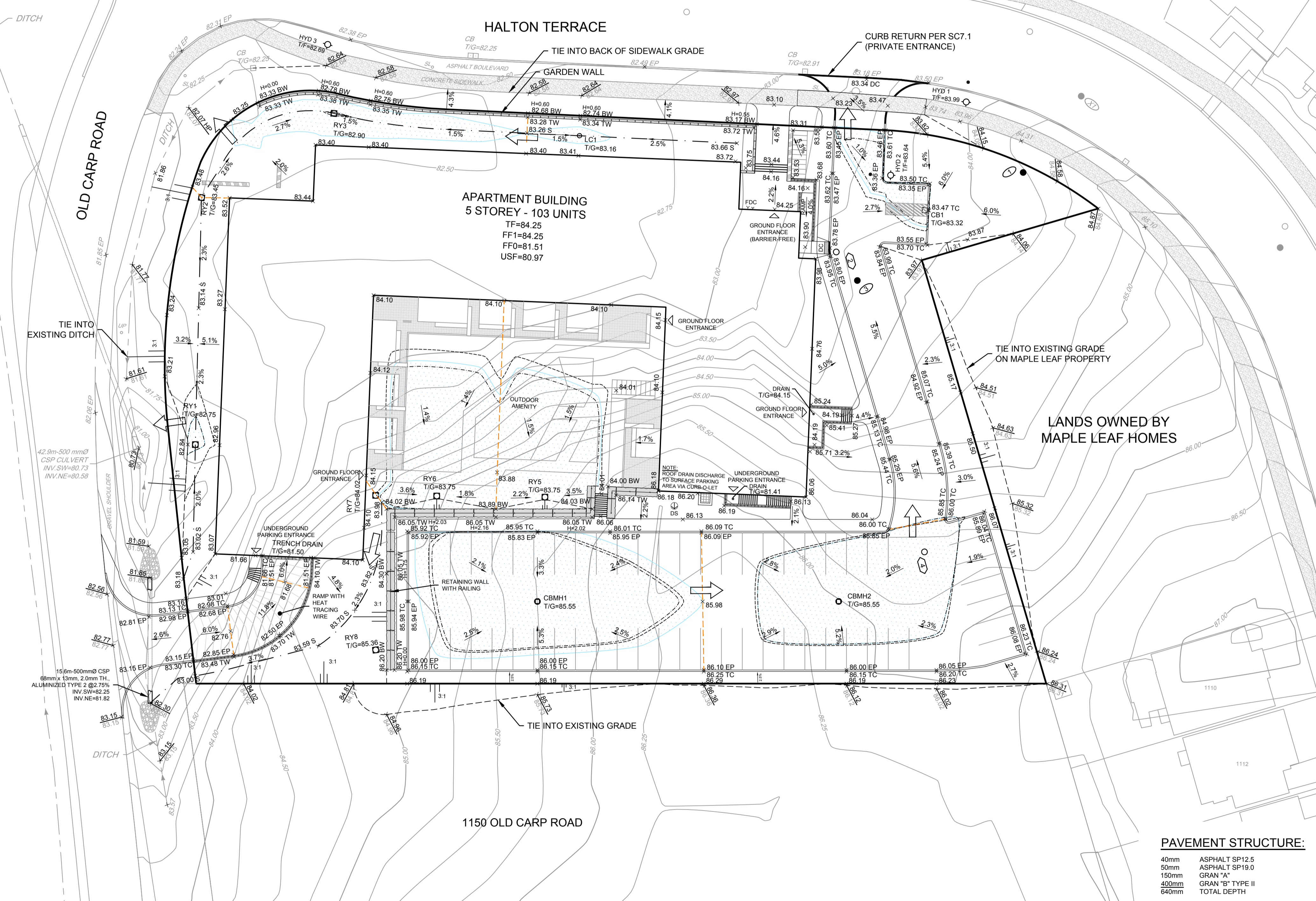

**LEGEND**

	PROPOSED GRADE AND DIRECTION OF FLOW		HYDRANT WITH TOP OF FLANGE ELEVATION
	PROPOSED ELEVATION		SANITARY MANHOLE
	EXISTING ELEVATION		STORM MANHOLE
	EXISTING SPOT ELEVATION		CATCHBASIN WITH TOP OF GRATE ELEVATION CB WITH ICD
	EXISTING ELEVATION AT BACK OF SIDEWALK		LANDSCAPE TYPE CATCHBASIN WITH TOP OF GRATE ELEVATION
	EXISTING CONTOUR ELEVATION		VALVE & VALVE BOX LOCATION
	MAJOR OVERLAND FLOW DIRECTION		FF= FINISHED FLOOR
	TERRACE GRADE (3:1 MAX)		TF= TOP OF FOUNDATION
	SWALE AND TERRACE		USF= UNDERSIDE OF FOOTING
	MAX STATIC PONDING LIMITS		EP EDGE OF PAVEMENT
	100-YR PONDING LIMITS		TC TOP OF CURB
	100-YR +20% PONDING LIMITS		FDC FIRE DEPARTMENT CONNECTION
	FEATURE WALL		DS ROOFTOP DOWNSPOUT LOCATION

- GENERAL NOTES:**
- DIMENSIONS AND LAYOUT INFORMATION SHALL BE CONFIRMED PRIOR TO COMMENCEMENT OF CONSTRUCTION.
  - THE ORIGINAL TOPOGRAPHY AND GROUND ELEVATIONS, SERVICING AND SURVEY INFORMATION SHOWN ON THIS PLAN ARE SUPPLIED FOR INFORMATION PURPOSES ONLY. IT SHALL BE THE RESPONSIBILITY OF THE CONTRACTOR TO VERIFY THE ACCURACY OF ALL INFORMATION OBTAINED FROM THIS PLAN.
  - CO-ORDINATE AND SCHEDULE ALL WORK WITH OTHER TRADES AND CONTRACTORS.
  - BEFORE COMMENCING CONSTRUCTION, PROVIDE PROOF OF COMPREHENSIVE ALL RISK AND OPERATIONAL LIABILITY INSURANCE INCLUDING BLASTING. INSURANCE POLICY TO NAME THE OWNER, ENGINEER AND THE CITY AS CO-INSURED. AMOUNT OF INSURANCE TO BE SPECIFIED BY OWNER'S AGENT.
  - CONNECT TO EXISTING SYSTEMS AS DETAILED, INCLUDING ALL RESTORATION WORK NECESSARY TO REINSTATE SURFACES TO EXISTING CONDITIONS OR BETTER.
  - DETERMINE THE EXACT LOCATION, SIZE, MATERIAL AND ELEVATION OF ALL EXISTING UTILITIES PRIOR TO COMMENCING CONSTRUCTION. PROTECT AND ASSUME ALL RESPONSIBILITY FOR ALL EXISTING UTILITIES WHETHER OR NOT SHOWN ON THESE DRAWINGS.
  - OBTAIN AND PAY FOR ALL NECESSARY PERMITS AND APPROVALS BEFORE COMMENCING CONSTRUCTION.
  - RESTORE ALL TRENCHES AND SURFACE FEATURES TO EXISTING CONDITIONS OR BETTER AND TO THE SATISFACTION OF CITY OF OTTAWA AUTHORITIES.
    - ASPHALT RESTORATION SHALL BE IN ACCORDANCE WITH CITY OF OTTAWA DETAIL R-10.
    - THICKNESS OF GRANULAR MATERIAL AND ASPHALT LAYERS TO MATCH EXISTING.
    - BOULEVARDS SHALL BE REINSTATED WITH 100mm OF TOPSOIL, SEED AND MULCH.
  - REMOVE FROM SITE ALL EXCESS EXCAVATED MATERIAL UNLESS OTHERWISE INSTRUCTED BY ENGINEER.
  - ALL ELEVATIONS ARE GEODETIC AND UTILIZE METRIC UNITS.
  - REFER TO GEOTECHNICAL INVESTIGATION PG4872-1 (DATED MAY 3, 2019), PREPARED BY PATERSON GROUP FOR SUBSURFACE CONDITIONS AND CONSTRUCTION RECOMMENDATIONS.
  - PERFORATED PIPE SUB-DRAINS TO BE PROVIDED AT SUBGRADE LEVEL EXTENDING FROM THE ROADSIDE CATCHBASIN FOR A DISTANCE OF 3.0m, PARALLEL TO THE CURB IN TWO DIRECTIONS.

- GRADING AND PAVEMENT NOTES:**
- ALL TOPSOIL, ORGANIC OR DELETERIOUS MATERIAL MUST BE ENTIRELY REMOVED FROM BENEATH THE PROPOSED HARD SURFACE (i.e. PAVEMENT, CURB, SIDEWALK, ETC.) AREAS AS DIRECTED BY THE SITE ENGINEER OR GEOTECHNICAL ENGINEER.
  - EXPOSED SUBGRADES IN PROPOSED PAVED AREAS SHOULD BE HEAVILY PROOF ROLLED WITH A LARGE (10 TON) VIBRATORY STEEL DRUM ROLLER UNDER DRY CONDITIONS AND INSPECTED BY THE GEOTECHNICAL ENGINEER PRIOR TO THE PLACEMENT OF GRANULARS.
  - ANY SOFT AREAS EVIDENT FROM THE PROOF ROLLING SHOULD BE SUB-EXCAVATED AND REPLACED WITH SUITABLE MATERIAL THAT IS FROST COMPATIBLE WITH THE EXISTING SOILS AS RECOMMENDED BY THE GEOTECHNICAL ENGINEER.
  - THE GRANULAR BASE SHOULD BE PLACED IN MAXIMUM 300mm LIFTS AND COMPACTED TO AT LEAST 100% OF THE STANDARD PROCTOR MAXIMUM DRY DENSITY VALUE. ANY ADDITIONAL GRANULAR FILL USED BELOW THE PROPOSED PAVEMENT SHOULD BE PLACED IN MAXIMUM 300mm LIFTS AND COMPACTED TO AT LEAST 95% OF THE STANDARD PROCTOR MAXIMUM DRY DENSITY VALUE.
  - ROADWAY SUBGRADE TO BE INSPECTED BY THE GEOTECHNICAL ENGINEER AT THE TIME OF CONSTRUCTION TO REVIEW IF A WOVEN GEOTEXTILE IS REQUIRED BELOW THE GRANULAR MATERIALS, AND TO CONFIRM THE DEPTH AND COMPACTION OF GRANULAR 'B'.
  - PRIOR TO PLACEMENT OF TOPLIFT, THE CONTRACTOR SHALL ADJUST ALL STRUCTURES TO FINAL GRADE PER CITY OF OTTAWA STANDARDS.
  - MINIMUM OF 2% GRADE FOR ALL GRASS AREAS UNLESS OTHERWISE NOTED.
  - MAXIMUM TERRACING GRADE TO BE 3:1 UNLESS OTHERWISE NOTED.
  - ALL GRADES BY CURBS ARE EDGE OF PAVEMENT GRADES UNLESS OTHERWISE INDICATED.
  - ALL CURBS SHALL BE BARRIER CURB UNLESS OTHERWISE NOTED AND CONSTRUCTED PER CITY OF OTTAWA STANDARD (SC-1).
  - REFER TO LANDSCAPE PLAN FOR PLANTING AND OTHER LANDSCAPE FEATURE DETAILS.

**PAVEMENT STRUCTURE:**

40mm	ASPHALT SP12.5
50mm	ASPHALT SP19.0
150mm	GRAN "A"
400mm	GRAN "B" TYPE II
640mm	TOTAL DEPTH

**NOTE:**  
THE POSITION OF ALL POLE LINES, CONDUITS, WATERMANS, SEWERS AND OTHER UNDERGROUND AND OVERGROUND UTILITIES AND STRUCTURES IS NOT NECESSARILY SHOWN ON THE CONTRACT DRAWINGS, AND WHERE SHOWN, THE ACCURACY OF THE POSITION OF SUCH UTILITIES AND STRUCTURES IS NOT GUARANTEED. BEFORE STARTING WORK, DETERMINE THE EXACT LOCATION OF ALL SUCH UTILITIES AND STRUCTURES AND ASSUME ALL LIABILITY FOR DAMAGE TO THEM.

No.	REVISION	DATE	BY
2.	CITY SUBMISSION	NOV 3/23	MAB
1.	CITY SUBMISSION	OCT 19/21	MAB

SCALE			
1:300			

DESIGN	
DTD	CHECKED
LWR	DRAWN
DTD	CHECKED
MAB	APPROVED
JGR	APPROVED

**FOR REVIEW ONLY**

**NOVATECH**  
Engineers, Planners & Landscape Architects  
Suite 200, 240 Michael Cowpland Drive  
Ottawa, Ontario, Canada K2M 1P6  
Telephone: (613) 254-9643  
Facsimile: (613) 254-5867  
Website: www.novatech-eng.com

CITY OF OTTAWA  
1104 HALTON TERRACE

**GRADING PLAN**

PROJECT No: 119024  
REV # 2  
DRAWING No: 119024-GR

M:\2019\119024\CAD\Drawings\119024-GR.dwg, PLANS-A1, Nov. 02, 2023 - 4:00pm, d.mullin

PLAN #18654 D07-12-21-0186