

**PART OF LOT 15
CONCESSION JUNCTION
GORE**
GEOGRAPHIC TOWNSHIP OF GLOUCESTER
CITY OF OTTAWA
Surveyed by Annis, O'Sullivan, Vollebek Ltd.
Scale 1:200

Scale 1:200
DISTANCES SHOWN ON THIS PLAN ARE IN METRES AND
CAN BE CONVERTED TO FEET BY DIVIDING BY 0.3048

Surveyor's Certificate

- I CERTIFY THAT:
- The survey and plan are correct and in accordance with the Survey Act and the Surveyors Act and the regulations made under them.
 - The survey was completed on the 28th day of June, 2025.

Date _____
D. S. McMoran
Ontario Land Surveyor

ASSOCIATION OF ONTARIO
LAND SURVEYORS
PLAN SUBMISSION FORM
V-110830

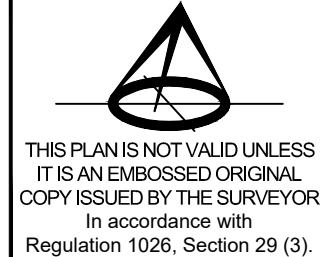

Notes & Legend

- Denotes**
- SB Survey Monument Found
 - WH1 Witness
 - Meas. Measured
 - (ADG) Annis, O'Sullivan, Vollebek Ltd.
 - (P1) (857) Plan dated October 3, 1985
 - (P2) (857) Plan dated April 19, 1985
 - (P3) (857) Plan dated December 13, 1984
 - (P4) (1287) Plan dated April 26, 2018
 - (P5) Plan 4R-1994.1
 - (DI) Inst. N561625
 - TOS Top of Slope
 - BOS Bottom of Slope
 - C/L Centreline
 - CP Corrugated Steel Pipe
 - CPP Corrugated Plastic Pipe
 - CCP Concrete Pipe
 - T/P Top of Pipe
 - T/G Top of Grate
 - Inv. Invert
 - CS Catch Basin
 - OH-ST Maintenance Hole (Storm)
 - OH-S Maintenance Hole (Sanitary)
 - OH-B Maintenance Hole (Bell)
 - OH-H Maintenance Hole (Hydro)
 - OH-U Maintenance Hole (Underside)
 - VC Valve Chamber (Waterman)
 - WV Water Valve
 - TH Fire Hydrant
 - ST Undergound Storm Sewer
 - S Undergound Sanitary Sewer
 - W Undergound Water
 - P Undergound Power
 - B Undergound Bell
 - U Undergound Allstream
 - G Undergound Gas
 - TO Telecom Cables
 - C Undergound Rogers Cable
 - LS Light Standard
 - LS Edge of Asphalt
 - HH Handhole
 - TB-B Bell Terminal Box
 - TB-C Cable Terminal Box
 - AS Sign
 - BH Bore Hole
 - OW Monitoring Well
 - DT Deciduous Tree
 - CT Coniferous Tree
 - D Diameter
 - E Location of Elevations
 - EL Location of Top of Curb Elevations

Bearings are grid, derived from Can-Net 2016 Real Time Network GPS observations and are referenced to Specified Control Points 01919680105 and 019196434761, MTM Zone 5 (78°30' West Longitude / NAD-83 (original)).

ELEVATION NOTES

- Elevations shown are geoid, derived from City of Ottawa Vertical Control Monument No. 3841 (Index No. 329), having a published elevation of 68.78 metres, and are referred to the CGVD28 geoid datum.
- It is the responsibility of the user of this information to verify that the job benchmark has not been altered or disturbed and that its relative elevation and description agrees with the information shown on this drawing.

UTILITY NOTES

- This drawing cannot be accepted as acknowledging all of the utilities and it will be the responsibility of the user to contact the respective utility authorities for confirmation.
- Only visible surface utilities were located.
- Underground utility data derived from City of Ottawa utility sheet reference: Drawings 15-15-05, 15-15-06, 15-15-11 (all with a revision date of Nov. 2021) and Plan No. 3089 (Sheets 3 & 4 of 13 with a revision date of Aug. 28, 1997).
- A field location of underground plant by the pertinent utility authority is mandatory before any work involving breaking ground, probing, excavating etc.

