

KEY PLAN NTS

LEGEND

- PROPOSED DIRECTION OF DRAINAGE
- ⇨ DIRECTION OF OVERLAND FLOW
- CB CATCHBASIN
- STORM MANHOLE
- SANITARY MANHOLE
- ⊕ V&B WATER VALVE AND BOX
- ⊕ HYDRANT
- CB/MH CATCHBASIN / MANHOLE
- OIL/WATER SEPARATOR
- EX STORM MANHOLE
- EX SANITARY MANHOLE
- ⊕ EX WATER VALVE AND BOX
- ⊕ EX HYDRANT
- 98.00 PROPOSED GRADES
- 98.55 EX EXISTING GRADES
- PROPERTY LIMIT
- /// REMOVAL
- CATCHBASIN SEDIMENT CONTROL DEVICE

CONTRACTOR TO PROTECT EX. TREES. SEE LANDSCAPING PLAN FOR DETAILS.

CONTRACTOR TO BE RESPONSIBLE FOR INSPECTING AND MAINTAINING ALL EROSION AND SEDIMENT CONTROL DEVICES UNTIL THE SITE IS STABILIZED

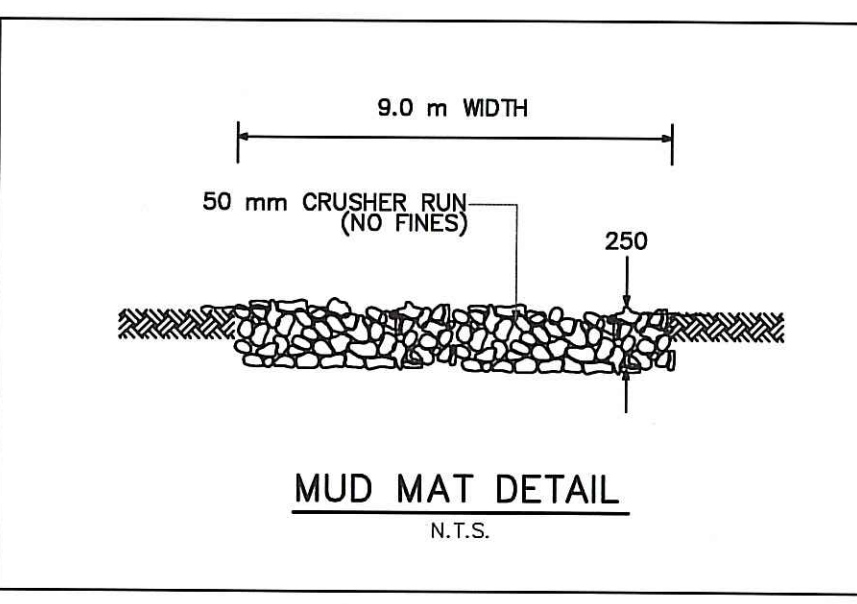
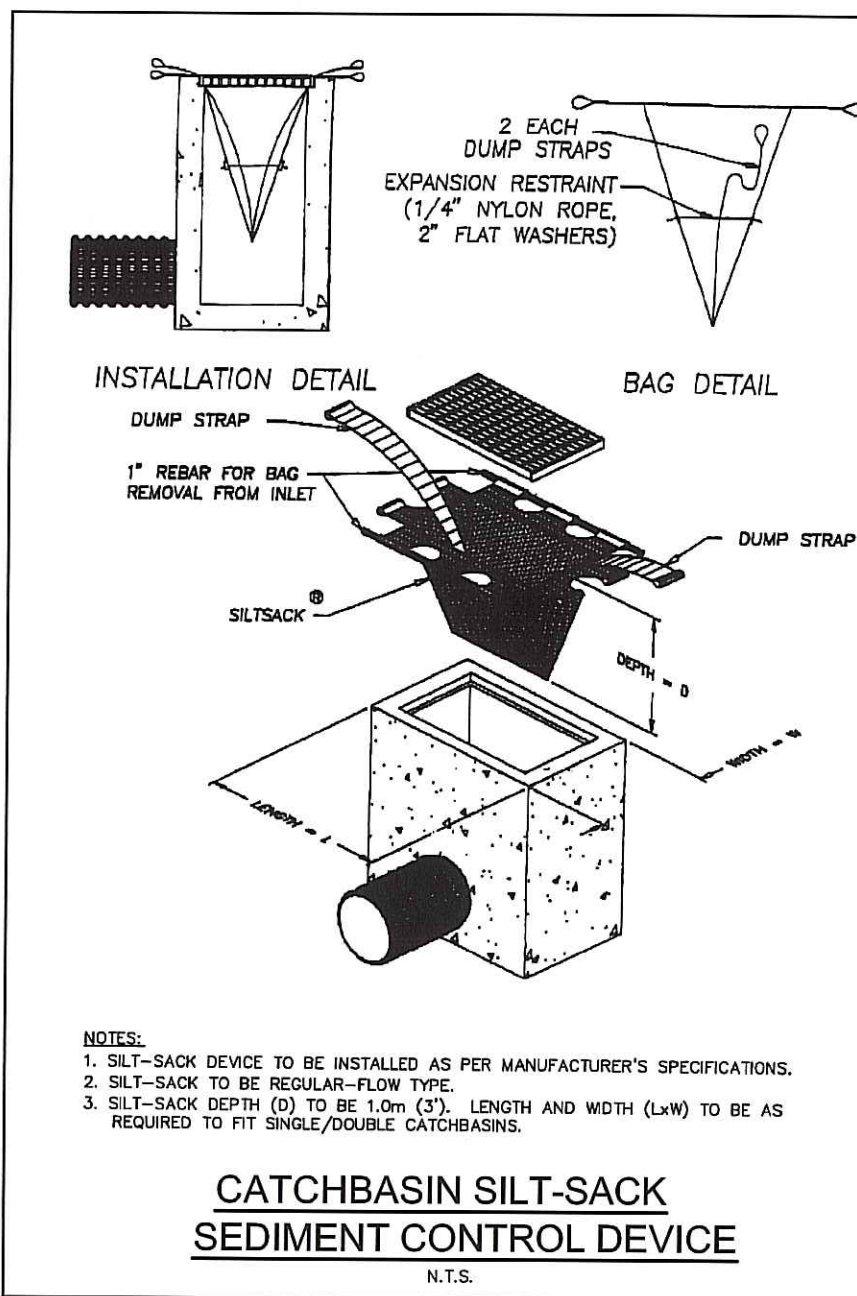

FOR BENCHMARKS, GENERAL NOTES AND LIST OF DRAWINGS SEE PROJECT DRAWING NT1

No.	REVISIONS TO DRAWING	BY	DATE	APPR.
1.	ISSUED FOR SITE PLAN APPROVAL	S.M.	FEB 13/2012	

CLIENT **COSTCO WHOLESALE**

MUNICIPALITY **CITY OF KANATA**

PROJECT TITLE **COSTCO KANATA GAS BAR**

SHEET TITLE **EROSION AND SEDIMENT CONTROL PLAN**

MMM GROUP
 100 Commerce Valley Dr. West, Thornhill, ON Canada L3T 0A1
 T: 905.882.1100 F: 905.882.0055 www.mmm.ca



DESIGNED S.M.	DRAWN 10/12 CAD	CHECKED R.R.
SCALE 1:250	DATE MAY 2010	DWG. NUMBER ER1
PROJECT NUMBER 10-10021		

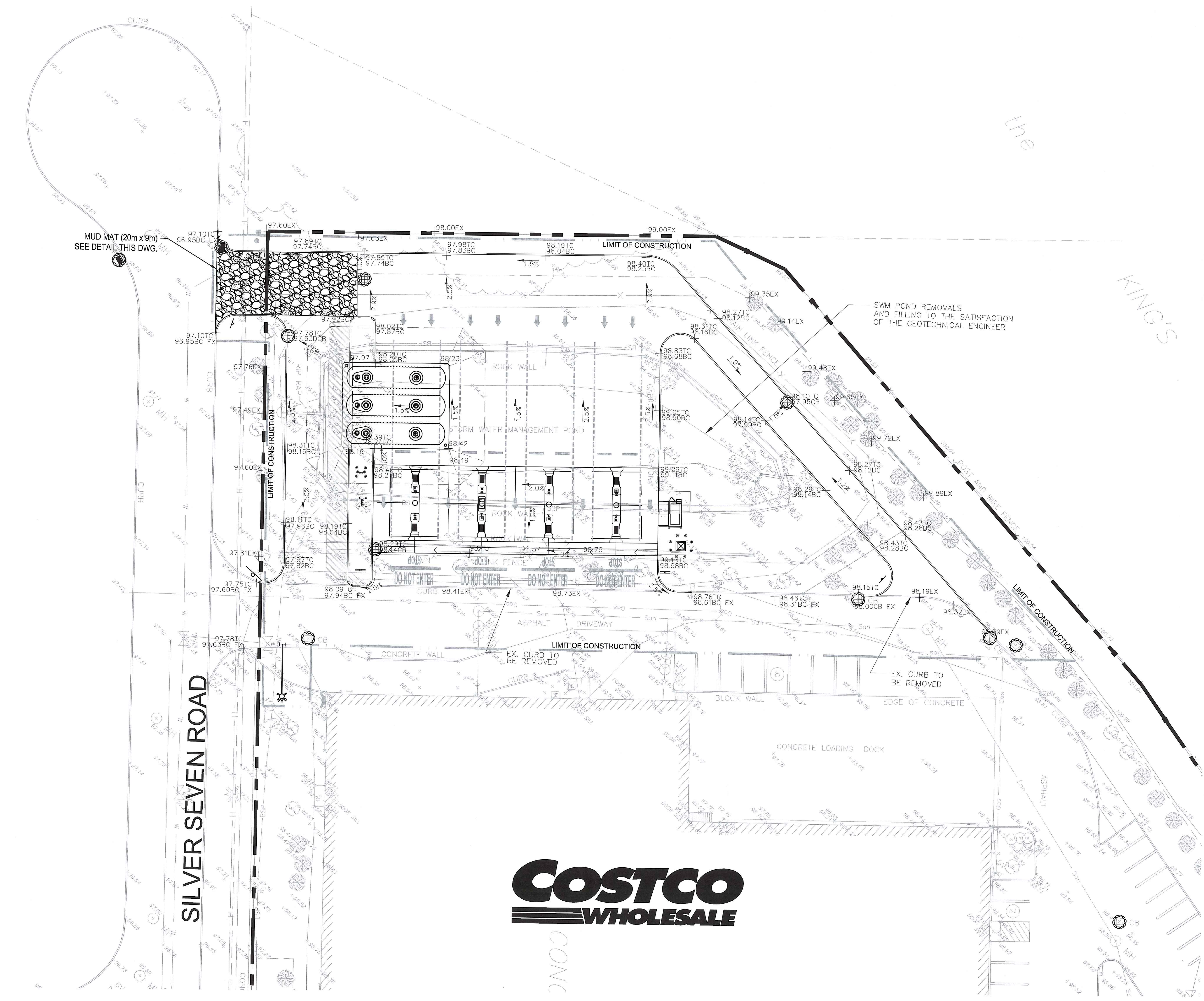

FILE NAME: C:\Users\mckoya\My Documents\Projects\Temp\10021\10021_SST_Are_Eri