

**Stage 1 and 2 Archaeological Assessment for
Kanata Highlands – Richcraft Huntmar Lands,
Part of Lot 8, Concession 1,
Geographic Township of March,
City of Ottawa**



Prepared by

Licensee: Keith Powers
Archaeological Consulting Licence P052
Project Information Number P052-345-2011

THE ARCHAEOLOGISTS INC.

Original Report
Report Filed: February 7, 2012

EXECUTIVE SUMMARY

The Archaeologists Inc. was contracted to conduct a Stage 1 and 2 archaeological assessment for Kanata Highlands – Richcraft Huntmar Lands, Part of Lot 8, Concession 1, Geographic Township of March, City of Ottawa. The archaeological assessment was triggered by the Planning Act and the assessment was conducted in advance of a subdivision development project.

A Stage 1 background study of the subject property was conducted to provide information about the property's geography, history, previous archaeological fieldwork and current land condition in order to evaluate and document in detail the property's archaeological potential and to recommend appropriate strategies for Stage 2 survey. A Stage 2 property assessment was conducted to document all archaeological resources on the property, to determine whether the property contains archaeological resources requiring further assessment, and to recommend next steps. The characteristics of the property dictated that the Stage 2 survey be conducted by test pit survey.

The Stage 1 background study found that the subject property exhibits potential for the recovery of archaeological resources of cultural heritage value and concluded that the property requires a Stage 2 assessment. The Stage 2 property assessment, which consisted of a systematic test pit survey, did not result in the identification of archaeological resources.

The Stage 1 background study concluded that the property exhibits archaeological potential. The Stage 2 property assessment did not identify any archaeological resources within the subject property. The report recommends that no further archaeological assessment of the property is required.

TABLE OF CONTENTS

Executive Summary	i
Table of Contents	ii
Project Personnel	iii
1.0 Project Context	1
1.1 Development Context	1
1.2 Historical Context	1
1.3 Archaeological Context	4
2.0 Field Methods	7
3.0 Record of Finds	9
4.0 Analysis and Conclusions	9
5.0 Recommendations	9
6.0 Advice on Compliance with Legislation	10
7.0 Bibliography and Sources	11
8.0 Images	12
9.0 Maps	15

PROJECT PERSONNEL

Project/Field Director:	Mr. T. Keith Powers (P052)
Field Archaeologists	Mr. T. Keith Powers Ms. Karen Powers Mr. Barclay Powers Mr. John Rivalo Mr. Casey Johnston Mr. Jason Delacarsa Mr. Misha Stecyk Mr. Henry Windsor Mr. Peter Barrington
Report Preparation:	Mrs. Karen Powers
Graphics	Mrs. Karen Powers

INTRODUCTION

The *Ontario Heritage Act*, R.S.O. 1990 c. O.18, requires anyone wishing to carry out archaeological fieldwork in Ontario to have a license from the Ministry of Tourism and Culture (MTC). All licensees are to file a report with the MTC containing details of the fieldwork that has been done for each project. Following standards and guidelines set out by the MTC is a condition of a licence to conduct archaeological fieldwork in Ontario. *The Archaeologists Inc.* confirms that this report meets ministry report requirements as set out in the *2011 Standards and Guidelines for Consultant Archaeologists*, and is filed in fulfillment of the terms and conditions an archaeological license.

1.0 PROJECT CONTEXT (Section 7.5.5)

This section of the report will provide the context for the archaeological fieldwork, including the development, historical and archaeological context.

1.1 Development Context (Section 7.5.6, Standards 1-3)

Section 7.5.6, Standard 1

The Archaeologists Inc. was contracted to conduct a Stage 1 and 2 archaeological assessment for Kanata Highlands – Richcraft Huntmar Lands, Part of Lot 8, Concession 1, Geographic Township of March, City of Ottawa. The background study and assessment was conducted to address draft plan conditions in advance of a proposed subdivision development and was triggered by the Planning Act. The subject property is approximately 27.4 hectares in size and is bordered on the west-northwest by Terry Fox Drive. The property lies approximately 700 metres east of Huntmar Road.

Section 7.5.6, Standard 2

There is no additional development-related information relevant to understanding the choice of fieldwork strategy or recommendations made in the report.

Section 7.5.6, Standard 3

Permission to access the study area to conduct all required archaeological fieldwork activities, including the recovery of artifacts was given by the landowner and their representative.

1.2 Historical Context (Section 7.5.7, Standards 1-2)

Section 7.5.7, Standard 1

In advance of the Stage 2 assessment, a Stage 1 background study of the subject property was conducted in order to document the property archaeological and land use history and present condition. Several sources were referenced to determine if features or characteristics indicating archaeological potential for pre-contact and post-contact resources exist.

Characteristics indicating archaeological potential include the near-by presence of previously identified archaeological sites, primary and secondary water sources, features indicating past water sources, accessible or inaccessible shoreline, pockets of well-drained sandy soil, distinctive land formations that might have been special or spiritual places, such as waterfalls, rock outcrops, caverns, mounds, and promontories and their bases, resource areas, (including food or medicinal plants, scarce raw materials, early Euro-Canadian industry), areas of early Euro-Canadian settlement, early historical transportation routes, property listed on a municipal register or designated under the *Ontario Heritage Act* or that is a federal, provincial or municipal historic landmark or site, and property that local histories or informants have identified with possible archaeological sites, historical events, activities, or occupations.

Archaeological potential can be determined not to be present for either the entire property or a part of it when the area under consideration has been subject to extensive and deep land alterations that have severely damaged the integrity of any archaeological resources. This is commonly referred to as ‘disturbed’ or ‘disturbance’, and may include: quarrying, major landscaping involving grading below topsoil, building footprints, and sewage and infrastructure development. Archaeological potential is not removed where there is documented potential for deeply buried intact archaeological resources beneath land alterations, or where it cannot be clearly demonstrated through background research and property inspection that there has been complete and intensive disturbance of an area. Where complete disturbance cannot be demonstrated in Stage 1, it will be necessary to undertake Stage 2 assessment.

The background study determined that the following features or characteristics indicate potential for the recovery of precontact and post-contact period archaeological resources within the subject property:

- There are 5 known archaeological sites within a 1 km radius of the subject property, including three precontact and two post-contact sites. One site, the Wilson (BhFx-41) archaeological site, is located immediately adjacent to the current subject property.
- the Carp River is a primary water source that runs just west of the subject property
- Glacial Champlain Sea once inundated the area and its shorelines and islands may have attracted Palaeo-Indian and Early Archaic peoples to the area
- the 1879 historical atlas depicts two structures on Lot 8 within close proximity to the subject property

A detailed historical review of the subject property was incorporated in a Stage 1 archaeological assessment report by the Cultrual Resource Management Group of Halifax, Nova Scotia (CRMG 2009a). The following represents a summary of their research. We also summarize historical research of Carleton County as presented in a Stage 2 and 3 archaeological assessment report by the Northeastern Archaeological Associates (NAA 2009).

In 1800, Carleton County was created from the former counties of Dundas and Grenville and included much of what are today Lanark County and the Ottawa area west of the Rideau River. March Township was incorporated into Carleton County in 1850. The Euro-Canadian settlement of March township began in 1819 when Colonel Lloyd and a number of half-pay officers (among them Captains Laudel, Monk, Street, and Weatherley, and Lieutenant Thomas) were influenced to settle the Ottawa River front between Torbolton Township and Point running into Nepean Bay. Settlement of March Township followed the 1819 Ferguson Treaty, in which a Mississauga band living on Bay of Quinte released their lands to the British Crown. March Township was part of these released lands.

The township had not been surveyed when these initial settlements had occurred. Formal survey of March was completed in 1820 and the Belden 1879 historical atlas describes the County of Carleton as:

The Township of March is of irregular form, and is bounded north-easterly by the Ottawa River and the Township of Napean; south-easterly by the Township of Goulbourn; south-westerly by the Township of Huntley; and north-westerly, by the Township of Torbolton. It is laid out in concessions seven-eighths of a mile wide running nearly north-west and south-east, or approximately parallel with that part of the River Ottawa which fronts it on the southward...It is beyond dispute the poorest Township on the County in point of the average of its soil, although there are some localities where the land is good, and there are quite a large number of really excellent farms. In places, however, one can travel for miles without ever putting foot upon a particle of soil, where scanty vegetation struggles forth from crevices of the rock, only to make the general aspect more desolate.

The majority of initial settlers were primarily of Irish descent. They established dispersed farm communities within the township. Archival research conducted by W. Bruce Steward (CRMG 2009a) indicates that Lot 8, Concession 1 was initially granted to George Burke by the Crown on May 31, 1824. In 1831 the property was sold to Alex Thom and H. Graham who in turn sold the entire lot to Peter Cassidy in 1835. Cassidy then divided the lot and sold the south half to John Wilson in 1836. In 1862, Wilson sold the property to his son, John Wilson Jr., who retained the property throughout the 19th century.

The north half of Lot 8, Concession 1 was sold in 1836 to John Sparrow by Peter Cassidy. Sparrow held on to the property from 1837 until 1853 when he sold his 100 acre parcel to a James Cowan. Cowan appears to have been the owner of the entire property until 1880 when he defaulted on a mortgage and lost the land to a John Richardson.

The *1879 Atlas* depicts two structures within Lot 8, one of which is located in proximity to the current subject property.

In summary, the Stage 1 background study indicates that there is potential for the recovery of pre-contact and post-contact Euro-Canadian archaeological resources within the subject property. As it cannot be clearly demonstrated through the background study

that there has been complete and intensive disturbance of the area, archaeological potential is not removed. There are areas within the subject property that have the potential for the recovery of archaeological resources.

Section 7.5.7, Standard 2

The Stage 2 property assessment of the subject property will employ the strategy of test pit survey, following the standards listed in Section 2.1.1 and 2.1.2 of the *2011 Standards and Guidelines for Consultant Archaeologists*. This is the appropriate strategy based on Stage 1 background study. To our knowledge there are no other reports containing relevant background information related to this development project.

1.3 Archaeological Context (Section 7.5.8, Standards 1-7)

Section 7.5.8, Standard 1

In order that an inventory of archaeological resources could be compiled for the study area, three sources of information were consulted: the site forms for registered sites housed at the Ministry of Tourism and Culture; published and unpublished documentary sources; and the files of *The Archaeologists Inc.*

In Ontario, information concerning archaeological sites is stored in the Ontario Archaeological Sites Database (O.A.S.D.), an inventory of the documented archaeological record in Ontario.

Information on the known archaeological sites in the vicinity of the study area was obtained from the Ministry of Tourism and Culture site database. There are 5 known archaeological sites located within a one kilometre radius of the subject property (Table 1). These include two Early Archaic sites and four Euro-Canadian sites. One of these, the Wilson Farm (BhFx-41) site, was located in Lot 8, Concession 1 immediately adjacent to the current subject property. The site was located during the Stage 1-2 archaeological assessment conducted in advance of the construction of Terry Fox Drive. The Wilson Farm site has been subject to a Stage 3 assessment by W. Bruce Stewart of Cultural Resource Management Group.

TABLE 1: Registered Archaeological Sites Within 1 km of the Study Area

Borden #	Site Name	Cultural Affiliation	Site Type	Researcher(s)
BhFx-21	Feldspar Mine	Euro-Canadian	Feldspar mine	K. Swayze 2001
BhFx-29		Early Archaic	Quarry	K. Swayze 2005
BhFx-30	Richarson Farm	Euro-Canadian	Homestead	CRMG, 2002
BhFx-31		Early Archaic	Quarry	K. Swayze, 2005
BhFx-41	Wilson Farm	Euro-Canadian	Homestead	CRMG, 2002

The Wilson Farm site was identified on the eastern edge of pasture overlooking the Carp River floodplain. The site is described as existing on the western edge of the Carp Ridge. The site consisted of an existing masonry house foundation, deep cellar and cistern, as well as a concrete barn foundation and three other stone foundations. The site was

discovered during a Stage 2 test pit survey and subject to a Stage 3 assessment by W. Bruce Stewart (CRMG 2009b,c). The assessment of the site resulted in the recovery of several glass, metal and ceramic artifacts typical of a mid to late 19th homestead. It was not recommended for Stage 4 mitigation and the Ministry of Tourism, Culture and Sport concurred with the recommendation of no further concern for the site.

Section 7.5.8, Standard 2

The subject property consists of areas of bedrock outcrop, agricultural pasture lands, overgrown fields/scrub, and wooded areas. A portion of the Carp Ridge is also present within the property. The ridge is a shallow Precambrian till and rock ridge that runs along the east bank of the Carp River. It is dominated by felsic intrusive rocks including granite, granophyre, granodiorite, calcareous sandstone and siltstone and derived metamorphic rock. The ridge itself is surrounded by clastic metasediments including conglomerate, greywacke, arkose, calcareous sandstone and siltstone, shale, and derived metamorphic rocks (Freeman 1979).

The subject property is located within the Ottawa Valley Clay Plain physiographic region, which is characterized by relatively thick deposits of marine silty clay that was deposited within the Champlain Sea basin following the last glaciation. These deposits, known as the Champlain Sea clay or Leda clay, overlie glacial till, that in turn overlies bedrock. Most of this physiographic region is underlain by a series of sedimentary rocks, consisting of sandstones, dolostones, limestones and shales that are, in turn, underlain by igneous and metamorphic bedrock of the Precambrian Shield. More recent deposits of alluvial sand locally overlie the Champlain Sea clay. Organic soils (such as peat) have also developed in some poorly drained areas (Chapman and Putnam 1984).

The Carp River is the primary source of water and lies just west-northwest of the subject property. Much of the river appears to have been channelized in the past (CRMG 2009a). Soils within the subject property reflect a mixture of North Gower silty clay loam and Dalhousie silty clay loam soils. These soils developed under a forest of elm, ash, red maple and other hardwood trees. (Chapman and Putnam 1984: 207). The Carp Ridge is dominated by exposed Precambrian bedrock overlain in areas by Anstruther sandy loam.

Section 7.5.8, Standard 3

The Stage 2 archaeological fieldwork of the subject property was undertaken on December 2, 3 and 4, 2011.

Section 7.5.8, Standard 4

Although no previous archaeological fieldwork has taken place within the current limits of the project area, a Stage 1, 2 and 3 assessment has occurred within Lot 8, Concession 1 within a 50 metre radius of the subject property. As indicated above, W. Bruce Stewart conducted Stage 1, 2 and 3 assessments in advance of construction to extend Terry Fox Drive.

Section 7.5.8, Standard 5

The Stage 1 assessment conducted by W. Bruce Stewart (CRMG 2009a) in advance of the extension of Terry Fox Drive, indicated that Lot 8, Concession 1 exhibited potential for the recovery of archaeological resources and it was recommended that any development be proceeded by a Stage 2 assessment. This report summarizes the results of the Stage 2 survey of the current subject property. Although the Stewart report did not deal directly with the current subject property, we conducted our survey as per recommendations made by Stewart (CRMG 2009a) given the high potential for archaeological resources within the current subject property.

Section 7.5.8, Standard 6

There are no unusual physical features that may have affected fieldwork strategy decisions or the identification of artifacts or cultural features.

Section 7.5.8, Standard 7

There is no additional archaeological information that may be relevant to understanding the choice of fieldwork techniques or the recommendations of this report.

2.0 FIELD METHODS (Section 7.8.1, Standards 1-3)

This section of the report addresses Section 7.8.1 of the 2011 Standards and Guidelines for Consultant Archaeologists. It does not address Section 7.7.2 because no property inspection was done as a separate Stage 1.

Section 7.8.1, Standard 1

The entire project area was surveyed.

Section 7.8.1, Standard 2

As relevant, we provide detailed and explicit descriptions addressing Standards 2a, b and c. Standard 2d is not relevant.

Section 7.8.1, Standard 2a - The general standards for property survey under Section 2.1 of the 2011 Standards and Guidelines for Consultant Archaeologists were addressed as follows:

- Section 2.1, S1 - The entire property was surveyed. There were no existing built structures.
- Section 2.1, S2a (land of no or low potential due to physical features such as permanently wet areas, exposed bedrock, and steep slopes) – There were several areas of exposed bedrock that were not subject to survey.
- Section 2.1, S2b (no or low potential due to extensive and deep land alterations) – There was an area of disturbance, consisting of the removal of trees and scrub resulting in topsoil removal. This area was visible by the number of ‘wood chip’ piles. No potential.
- Section 2.1, S2c (lands recommended not to require Stage 2 assessment by a previous Stage 1 report where the ministry has accepted that Stage 1 into the register) - n/a
- Section 2.1, S2d (lands designated for forest management activity w/o potential for impacts to archaeological sites, as determined through Stage 1 forest management plans process) - n/a
- Section 2.1, S2e (lands formally prohibited from alterations) - n/a
- Section 2.1, S2f (lands confirmed to be transferred to a public land holding body, etc) - n/a
- Section 2.1, S3 - The Stage 2 survey was conducted when weather and lighting conditions permitted excellent visibility of features. Although it snowed during the course of fieldwork, at no times was there frozen ground and the snow did not affect the identification of disturbed areas. We judgmentally test pitted the area identified as disturbed to ensure that it was even though it was still clearly disturbed despite the small amount of snow covering areas of the property.
- Section 2.1, S4 - No GPS recordings were taken as no artifacts were found during the Stage 2 assessment.

- Section 2.1, S5 - All field activities were mapped in reference to either fixed landmarks, survey stakes and development markers as appropriate. See report section 9.0 *Maps*.
- Section 2.1, S6 - See report section 8.0 *Images* for photo documentation of examples of field conditions encountered.
- Section 2.1, S7 - n/a

Section 7.8.1, Standard 2b -The subject property was subject to a systematic test pit survey appropriate to the characteristics of the property.

The test pit survey of the property followed the standards within Section 2.1.2 and 2.1.6 of the *2011 Standards and Guidelines for Consultant Archaeologists*. Test pit survey was only conducted where ploughing was not possible or viable, as per Standard 1. Test pits were spaced at maximum intervals of five metres in those areas where standard survey grids could be maintained. All test pits were at least 30 cm in diameter. Each test pit was excavated by hand to bedrock. No stratigraphy or cultural features were noted. Soils were screened through 6mm mesh. All test pits were backfilled.

Section 7.8.1, Standard 2c - All areas of the subject property were surveyed at five metre intervals with the exception of an area identified as disturbed. This was judgementally surveyed.

Section 7.8.1, Standard 2d – The subject property exhibits areas of exposed bedrock associated with the Carp Ridge. There were areas of archaeological potential within areas of low potential, e.g. smaller pockets of soil scattered throughout a broader bedrock bare plain. At times it was not possible to maintain a regular test pit grid. As such we surveyed as per these special conditions. Where test pit survey could be conducted we ensured that spacing intervals were a maximum of 5 metres. We surveyed all parts of those areas that were determined to have archaeological potential using standard test pit survey intervals. We recorded these surveyed areas and areas of low potential to the greatest degree of precision possible given available base mapping.

Section 7.8.1, Standard 3

Approximately 50% of the property consists of exposed bedrock. These areas were not surveyed. An additional 10% of the property was visibly disturbed due to more recent removal, i.e. grubbing, of trees and woodlot. The remaining 40% of the property was test pit surveyed at five metre intervals.

3.0 RECORD OF FINDS (Section 7.8.2, Standards 1-3)

This section documents all finds discovered as a result of the Stage 1 and 2 archaeological assessment of the subject property.

Section 7.8.2, Standard 1

No archaeological resources or sites were identified in the Stage 2.

Section 7.8.2, Standard 2

An inventory of the documentary record generated in the field is provided in Table 1.

Table 1: Inventory of Documentary Record	
Document Type	Description
Field Notes	<ul style="list-style-type: none">• 5 pages of field notes for this project
Photographs	<ul style="list-style-type: none">• 14 digital photographs
Maps	<ul style="list-style-type: none">• the report figures represent all of the maps generated in the field.

Section 7.8.2, Standard 3

Information detailing exact site locations on the property is not submitted because no sites or archaeological resources were identified in the Stage 2 assessment.

4.0 ANALYSIS AND CONCLUSIONS (Section 7.8.3, Standards 1-2)

Section 7.8.3, Standard 1

No archaeological sites were identified. Standard 2 is not addressed because no sites were identified.

5.0 RECOMMENDATIONS (Section 7.8.4, Standards 1-3)

Section 7.8.4, Standard 1

This standard is not applicable as no sites were identified.

Section 7.8.4, Standard 2

The report makes recommendations only regarding archaeological matters.

Section 7.8.4, Standard 3

The Stage 2 survey did not identify any archaeological sites requiring further assessment or mitigation of impacts and it is recommended that no further archaeological assessment of the property be required.

6.0 ADVICE ON COMPLIANCE WITH LEGISLATION (Section 7.5.9, Standards 1-2)

Section 7.5.9, Standard 1a

This report is submitted to the Minister of Tourism and Culture as a condition of licensing in accordance with Part VI of the *Ontario Heritage Act*, R.S.O. 1990, c 0.18. The report is reviewed to ensure that it complies with the standards and guidelines that are issued by the Minister, and that the archaeological fieldwork and report recommendations ensure the conservation, protection and preservation of the cultural heritage of Ontario. When all matters relating to archaeological sites within the project area of a development proposal have been addressed to the satisfaction of the Ministry of Tourism and Culture, a letter will be issued by the ministry stating that there are no further concerns with regard to alterations to archaeological sites by the proposed development.

Section 7.5.9, Standard 1b

It is an offence under Sections 48 and 69 of the *Ontario Heritage Act* for any party other than a licensed archaeologist to make any alteration to a known archaeological site or to remove any artifact or other physical evidence of past human use or activity from the site, until such time as a licensed archaeologist has completed archaeological fieldwork on the site, submitted a report to the Minister stating that the site has no further cultural heritage value or interest, and the report has been filed in the Ontario Public Register of Archaeological Reports referred to in Section 65.1 of the *Ontario Heritage Act*.

Section 7.5.9, Standard 1c

Should previously undocumented archaeological resources be discovered, they may be a new archaeological site and therefore subject to Section 48 (1) of the *Ontario Heritage Act*. The proponent or person discovering the archaeological resources must cease alteration of the site immediately and engage a licensed consultant archaeologist to carry out archaeological fieldwork, in compliance with Section 48 (1) of the *Ontario Heritage Act*.

Section 7.5.9, Standard 1d

The *Cemeteries Act*, R.S.O, 1990 c. C.4 and the *Funeral, Burial and Cremation Services Act*, 2002, S.O. 2002, c.33 (when proclaimed in force) require that any person discovering human remains must notify the police or coroner and the Registrar of Cemeteries at the Ministry of Consumer Services.

Section 7.5.9, Standard 2

Not applicable

7.0 BIBLIOGRAPHY AND SOURCES (Section 7.5.10, Standards 1)

Belden, H.

1879 *Illustrated Historical Atlas of Carleton County*. H. Belden & Company,
Toronto.

Chapman, L.J. and F. Putnam

1984 *The Physiography of Southern Ontario, Ontario Geological Survey
Special Volume 2*. Toronto: Government of Ontario, Ministry of Natural
Resources.

Cultural Resource Management Group

2009a Stage 1 Archaeological Assessment Report, Terry Fox Drive Extension,
Floodplain Compensatino Plan. Kanata, City of Ottawa (PIF P109-033-
2009).

2009b Stage 2 Archaeological Assessment Report Terry Fox Drive Extension
Richardson Side Road to the Carp Ridge, Kanata, City of Ottawa. Report
on file with the Ontario Ministry of Culture (PIF P109-024-2009).

2009d Stage 3 Archaeological Testing Report Wilson Farm Site (BhFx-41) Terry
Fox Drive Extension, Kanata, City of Ottawa. Report on file with the
Ontario Ministry of Culture (PIF P109-027-2009).

Freeman, E.B.

1979 Geological Highway Map. Southern Ontario. Ontario Geological Survey,
Map 2441.

Ministry of Tourism and Culture

2011 Standards and Guidelines for Consultant Archaeologists.

Northeastern Archaeological Associates

2009 Stage 2&3 Archaeological Assessment of Richardson Ridge Property, Part
Lots 5, 6 and 7 and Part of the Road Allowance Between Lots 5 and 6,
Concession 1, Geographic Township of March, City of Kanata (PIF P025-
153-2007).

8.0 IMAGES (Sections 7.5.11, 7.7.5, 7.8.6)

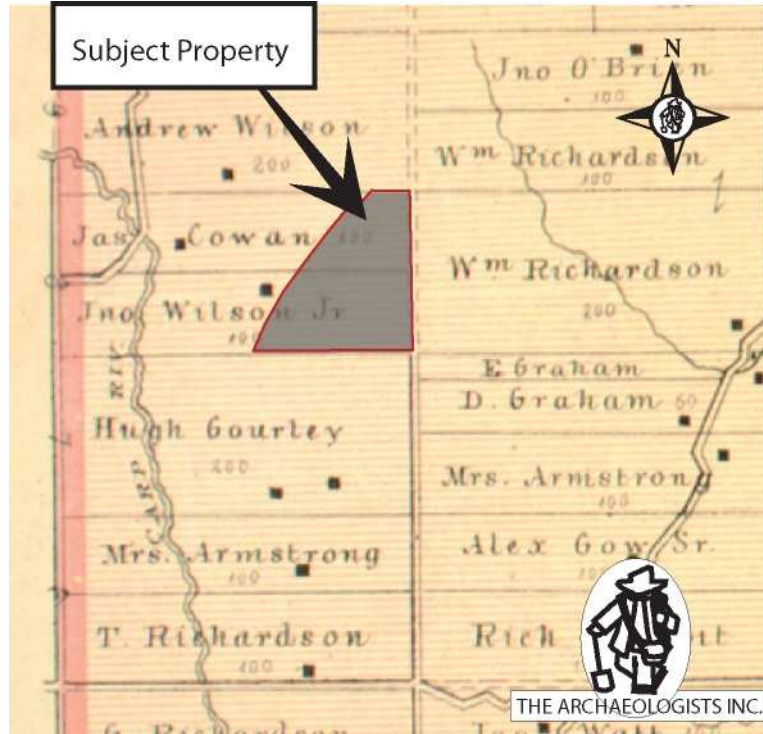

Image 1: The subject property overlain on the 1879 Atlas demonstrates potential.



Plate 1: Photo shows land conditions – note bedrock outcropping.



Plate 2: Photo shows bedrock outcrop and wooded scrub conditions within subject property.



Plate 3: Photo shows systematic test pitting of pasture areas around scrub.

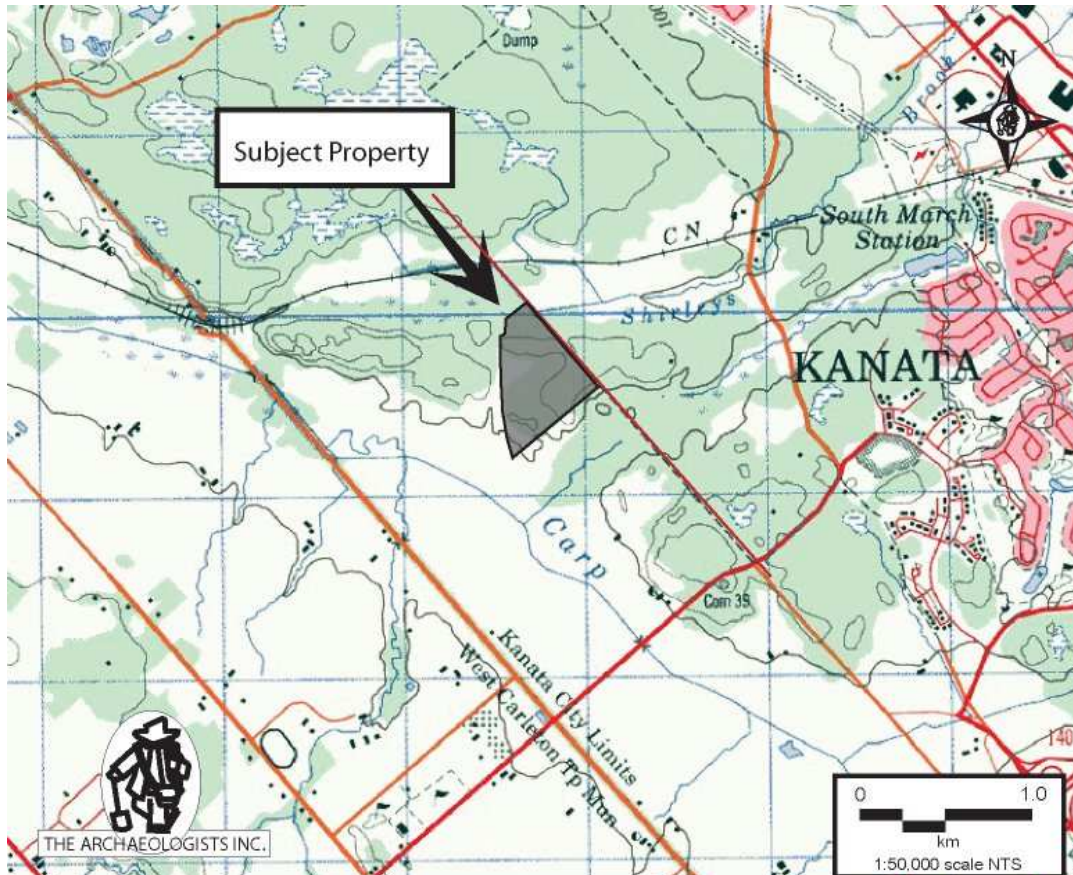

Plate 4: Photo shows test pitting of pasturelands. Note piles of wood chips in background as a result of disturbance.



Plate 5: Test pitting; note pile of wood chips as a result of disturbance related to grubbing of wooded areas.

9.0 MAPS (Section 7.5.12, 7.7.6, 7.8.7)



Map 1: Regional location of the subject property.

Stage 1 and 2 Archaeological Assessment for Kanata Highlands – Richcraft Huntmar Lands,
 Part of Lot 8, Concession 1, Geographic Township of March, City of Ottawa

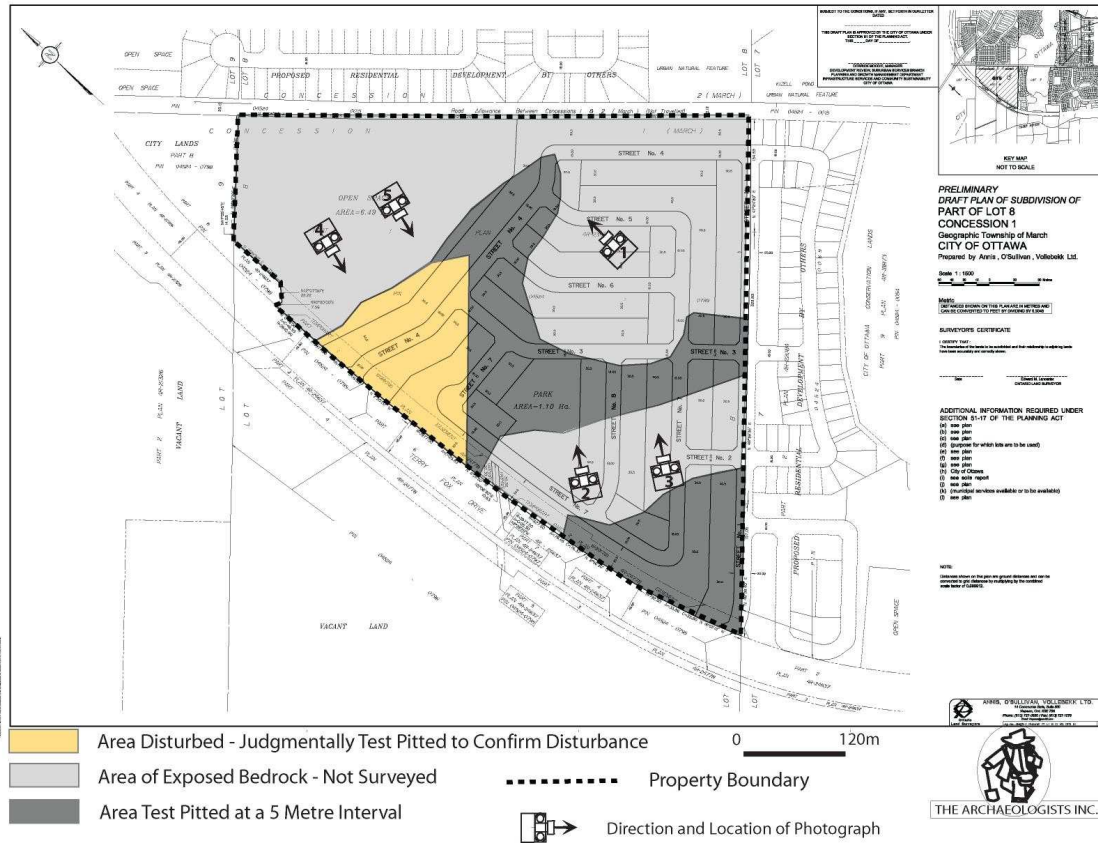

Map 2: Results of the Stage 1-2 archaeological assessment.