

**PROJECT  
AREA**



TRANSPORTATION  
PLANNING DEPT.

**LEPINE  
910 MARCH ROAD**

**KEY PLAN**

**Transportation Engineering Services**

Approved By:  
N/A

Completed By:  
CGH

Scale:  
N.T.S.

Date:  
JAN.  
2024

Drawing No.:

**RMA-2023  
-TPD-060-A**

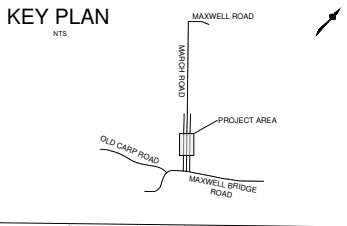

LIMIT OF PROJECT

0.9km MAXWELL ROAD



SOLID WHITE EDGE OF LANE MARKING

PROPERTY LINE

ASPHALT FROM INTERIM WIDENING TO ACCOMMODATE SBLTL TO REMAIN - SOUTHBOUND LANE MARKED WITH SOLID WHITE EDGE LINE

PROPERTY LINE

MARCH ROAD MEDIAN EXTENSION

REFER TO ATTACHMENT 3



TRANSPORTATION PLANNING DEPT.

LEPINE  
910 MARCH ROAD

MARCH ROAD  
MODIFICATIONS  
ULTIMATE CONDITION

Transportation Engineering Services

Approved By:  
N/A

Completed By:  
CGH

Scale:  
1:1000

Date:  
JAN.  
2024

Drawing No.:

RMA-2023  
-TPD-060-B

KEY PLAN

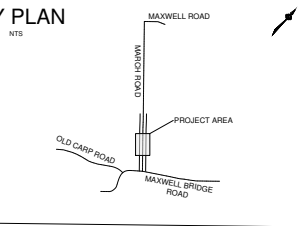

ATTACHMENT 3

REFER TO ATTACHMENT 2

RIGHT-IN RIGHT-OUT CONTROLLED ACCESS

PROPERTY LINE

GRASS TURF MEDIAN EXTENSION

0.1km MAXWELL BRIDGE ROAD

CONCRETE MEDIAN EXTENSION

MATCH EXISTING CONCRETE MEDIAN

LIMIT OF PROJECT

PROPERTY LINE



TRANSPORTATION PLANNING DEPT.

LEPINE  
910 MARCH ROAD

MARCH ROAD  
MODIFICATIONS  
ULTIMATE CONDITION

Transportation Engineering Services

Approved By:  
N/A

Completed By:  
CGH

Scale:  
1:1000

Date:  
JAN.  
2024

Drawing No.:

RMA-2023  
-TPD-060-B



# INFRASTRUCTURE SERVICES DEPARTMENT

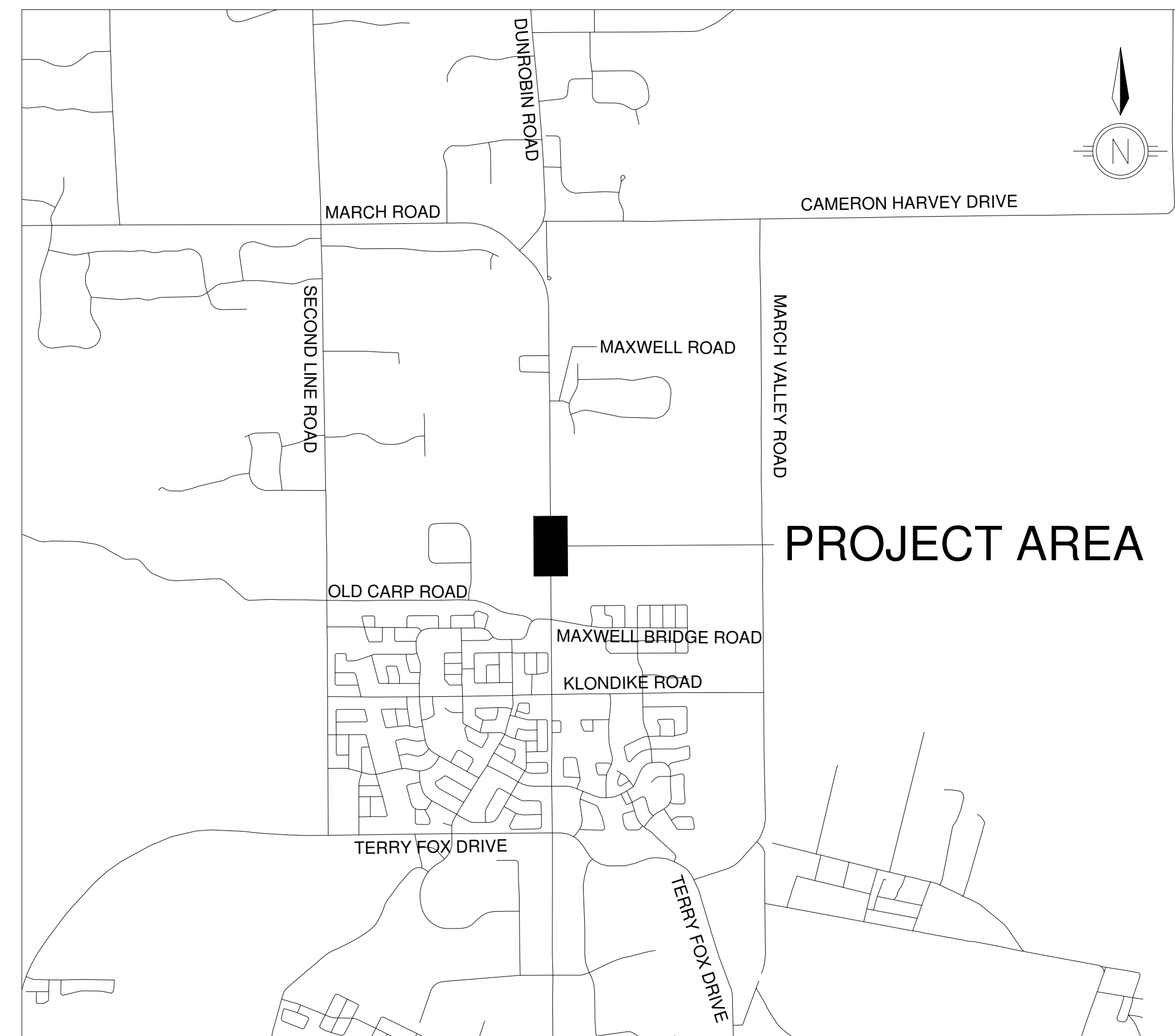

## 910 MARCH ROAD ROADWAY MODIFICATION ULTIMATE CONFIGURATION

CONTRACT NO. D07-12-22-0050

FUNCTIONAL DESIGN  
NOT FOR CONSTRUCTION  
JANUARY, 2024



# KEY PLAN

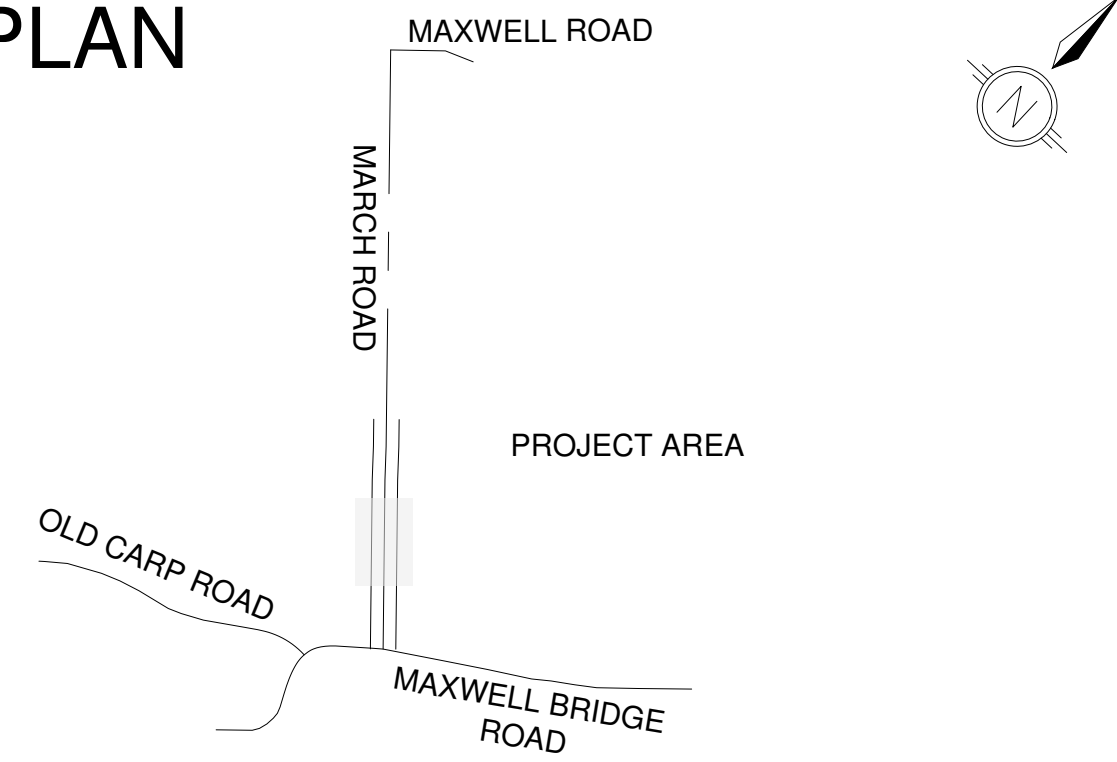

## LEGEND

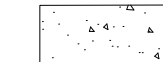
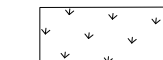
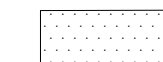
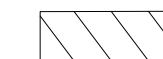
-  CONCRETE MEDIAN
-  GRASS TURN MEDIAN
-  FULL DEPTH ASPHALT REINSTATEMENT
-  PARTIAL DEPTH ASPHALT REINSTATEMENT

# 910 MARCH ROAD ROADWAY MODIFICATION ULTIMATE CONFIGURATION

GEOMETRY & GENERAL LAYOUT  
MARCH ROAD  
STA 9+950 TO 10+125

Contract No. D07-12-22-0050 Dwg. No. G01

Sheet - of -

Asset No.

Asset Group



Des. B.B Chk'd. M.C

Dwn. B.B Chk'd. M.C

Utility Circ. No. Index No.

Const. Inspector

Scale: HORIZONTAL

0m 5 10

NOTE: The location of utilities is approximate only, the exact location should be determined by consulting the municipal authorities and utility companies concerned. The contractor shall prove the location of utilities and shall be responsible for adequate protection from damage.

REVISIONS	No.	Description	By	Date (dd/mm/yy)
	1.	ISSUED FOR FUNCTIONAL DESIGN REVIEW	M.C	25/01/23
	2.	ISSUED FOR FUNCTIONAL DESIGN REVIEW	M.C	27/07/23
	3.	ISSUED FOR FUNCTIONAL DESIGN REVIEW	M.C	20/10/23
	4.	ISSUED FOR FUNCTIONAL DESIGN REVIEW	M.C	17/01/24

FUNCTIONAL DESIGN  
NOT FOR CONSTRUCTION

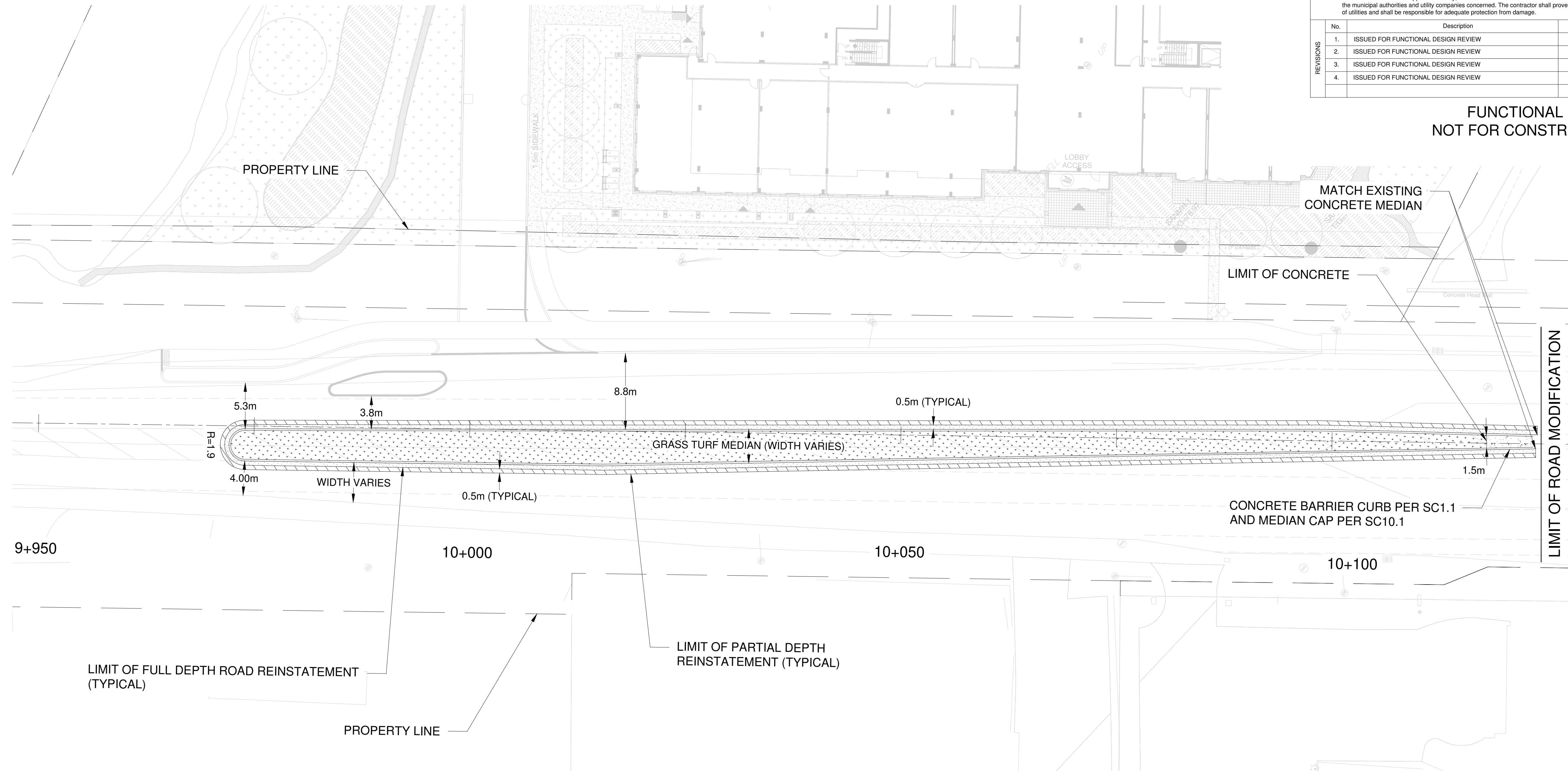

# KEY PLAN

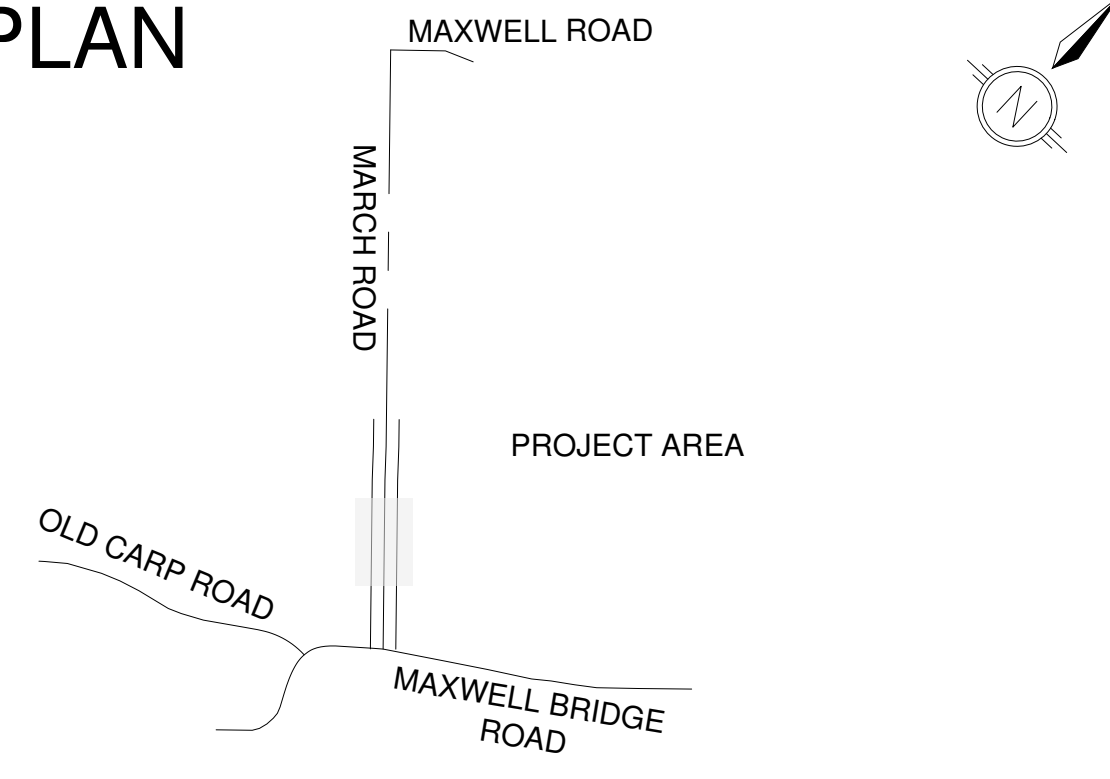

# SIGN LEGEND

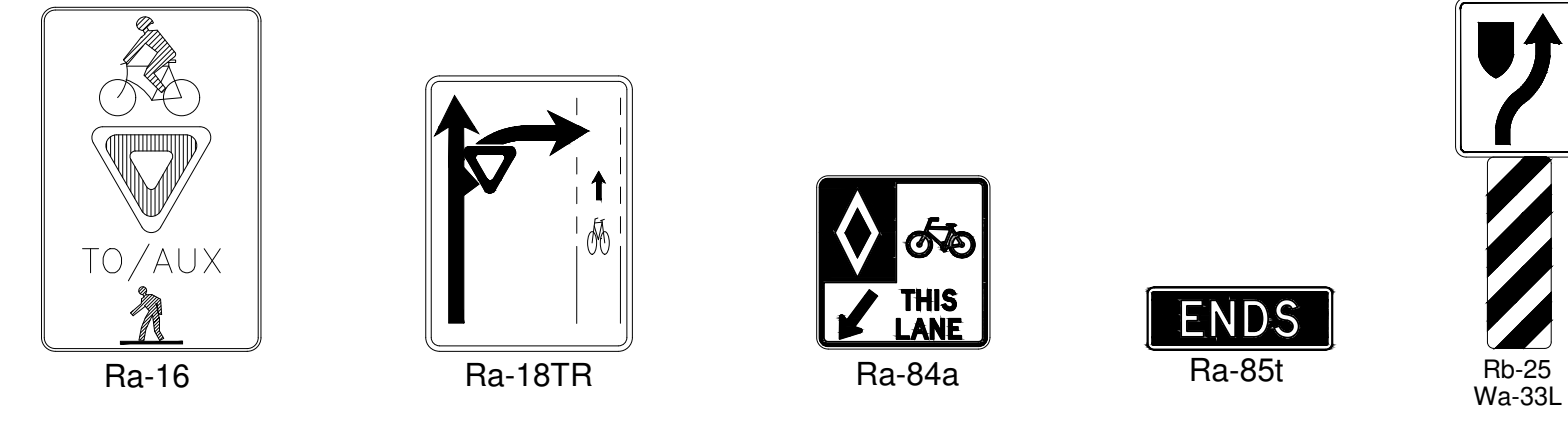

NOTES:  
ANY PROPOSED SIGNAGE FROM INTERIM RMA PACKAGE TO REMAIN UNLESS NOTED.

910 MARCH ROAD  
ROADWAY MODIFICATION  
ULTIMATE CONFIGURATION

PAVEMENT MARKING AND SIGNAGE  
MARCH ROAD  
9+775 TO 9+935



Contract No. D07-12-22-0050	Dwg. No. PMK01
Sheet - of -	
Asset No.	
Asset Group	
Des. B.B	Chk'd. M.C
Dwn. B.B	Chk'd. M.C
Utility Circ. No.	Index No.
Const. Inspector	
Scale: 0m 5 10	HORIZONTAL

NOTE: The location of utilities is approximate only, the exact location should be determined by consulting the municipal authorities and utility companies concerned. The contractor shall prove the location of utilities and shall be responsible for adequate protection from damage.

No.	Description	By	Date (dd/mm/yy)
1.	ISSUED FOR FUNCTIONAL DESIGN REVIEW	M.C	25/01/23
2.	ISSUED FOR FUNCTIONAL DESIGN REVIEW	M.C	27/07/23
3.	ISSUED FOR FUNCTIONAL DESIGN REVIEW	M.C	20/10/23
4.	ISSUED FOR FUNCTIONAL DESIGN REVIEW	M.C	17/01/24

FUNCTIONAL DESIGN  
NOT FOR CONSTRUCTION

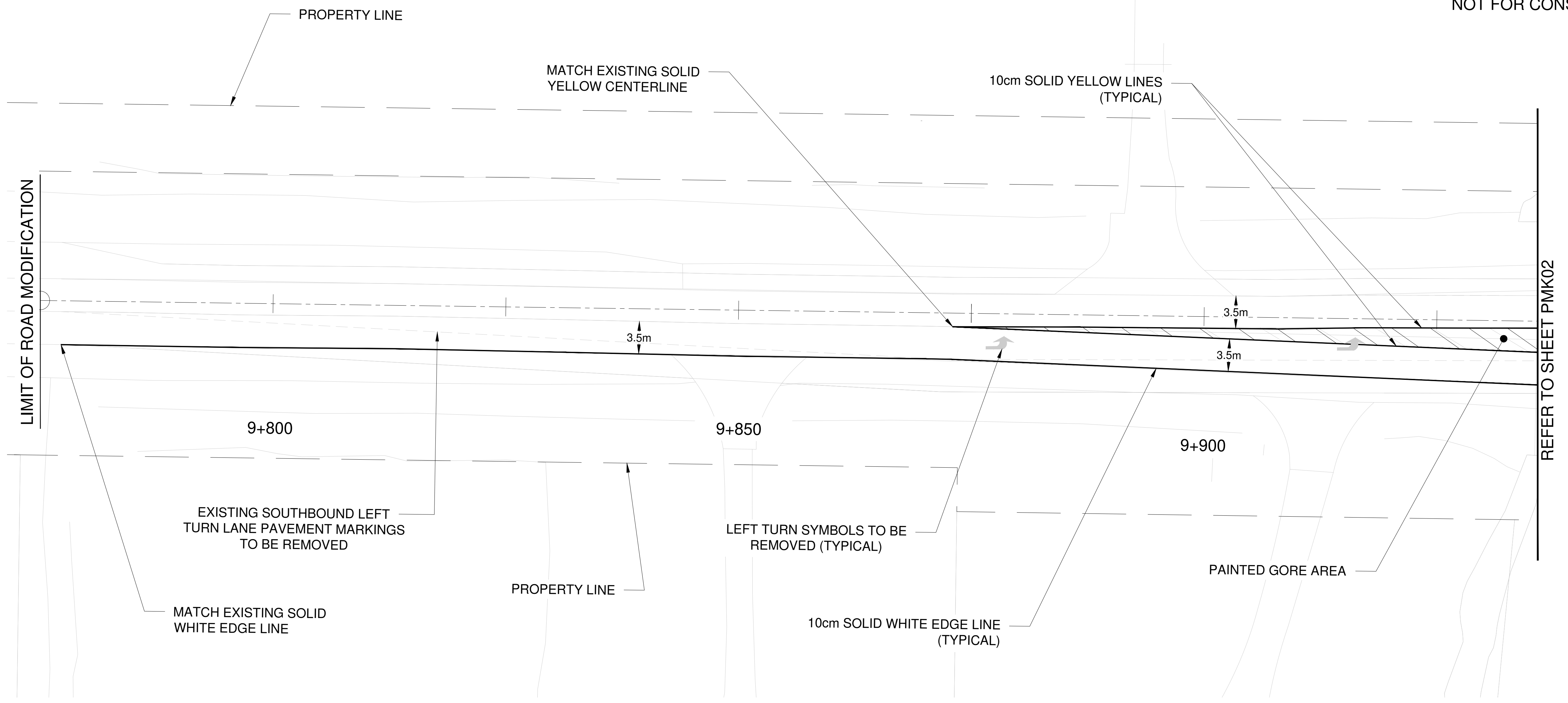



910 MARCH ROAD  
ROADWAY MODIFICATION  
ULTIMATE CONFIGURATION

PAVEMENT MARKING AND SIGNAGE  
MARCH ROAD  
STA 9+935 TO 10+125



Contract No. D07-12-22-0050	Dwg. No. PMK02
Sheet - of -	
Asset No.	
Asset Group	
Des. B.B	Chk'd. M.C
Dwn. B.B	Chk'd. M.C
Utility Circ. No.	Index No.
Const. Inspector	
Scale: 0m 5 10	HORIZONTAL

NOTE: The location of utilities is approximate only, the exact location should be determined by consulting the municipal authorities and utility companies concerned. The contractor shall prove the location of utilities and shall be responsible for adequate protection from damage.

REVISIONS	No.	Description	By	Date (dd/mm/yy)
	1.	ISSUED FOR FUNCTIONAL DESIGN REVIEW	M.C	25/01/23
	2.	ISSUED FOR FUNCTIONAL DESIGN REVIEW	M.C	27/07/23
	3.	ISSUED FOR FUNCTIONAL DESIGN REVIEW	M.C	20/10/23
	4.	ISSUED FOR FUNCTIONAL DESIGN REVIEW	M.C	17/01/24

FUNCTIONAL DESIGN  
NOT FOR CONSTRUCTION

KEY PLAN

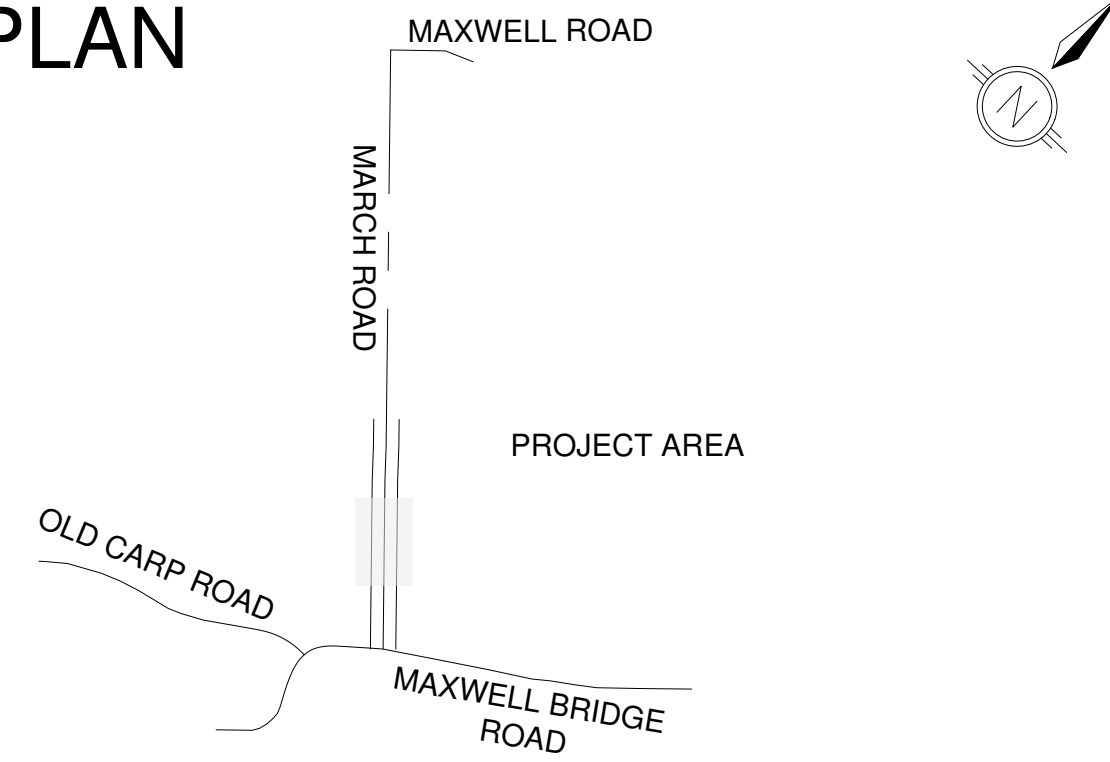

SIGN LEGEND

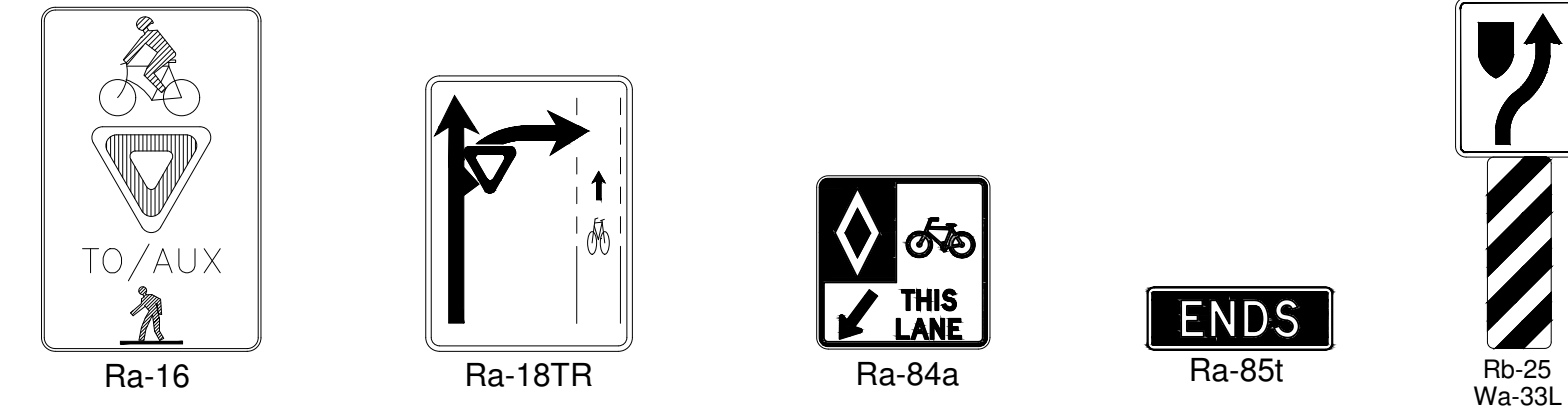

NOTES:  
ANY PROPOSED SIGNAGE FROM INTERIM RMA PACKAGE TO REMAIN UNLESS NOTED.

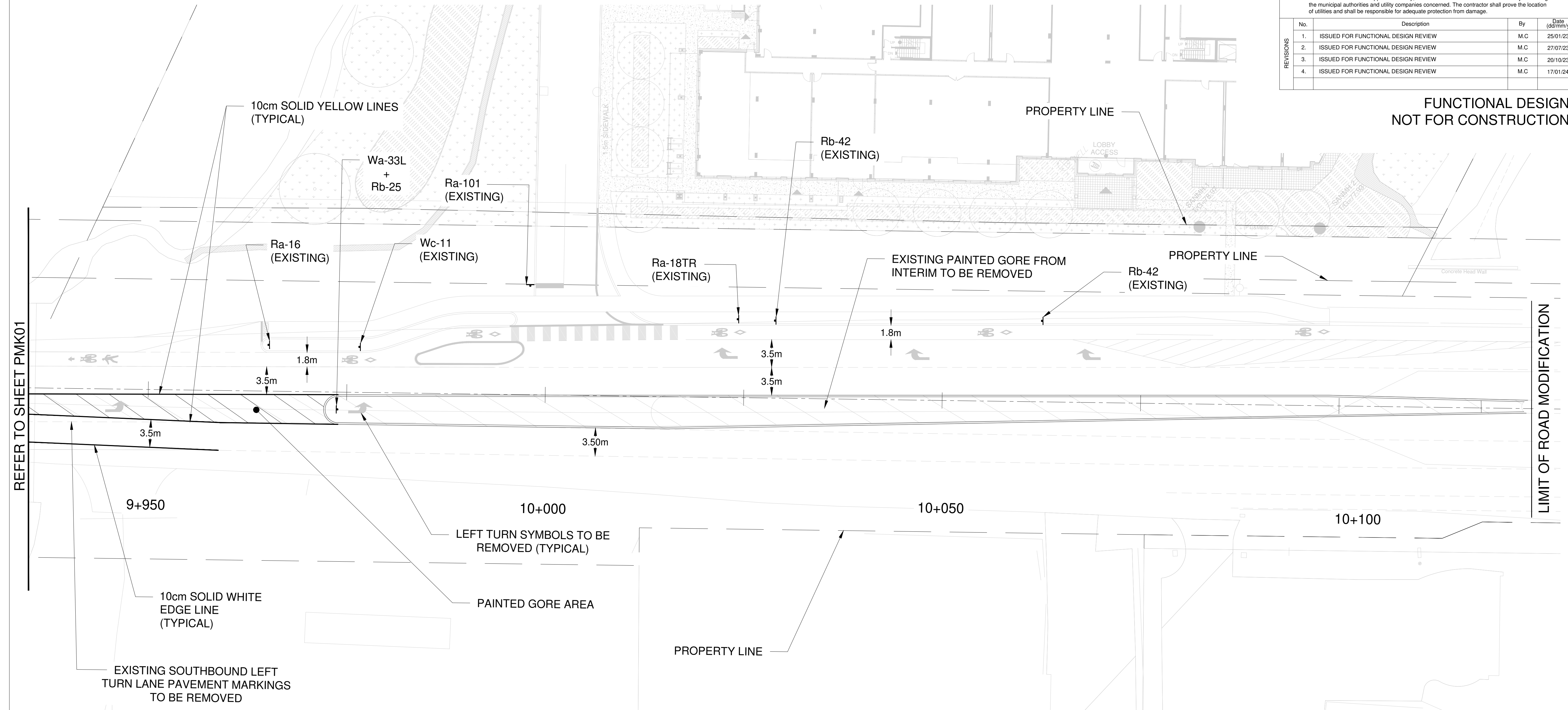



# KEY PLAN

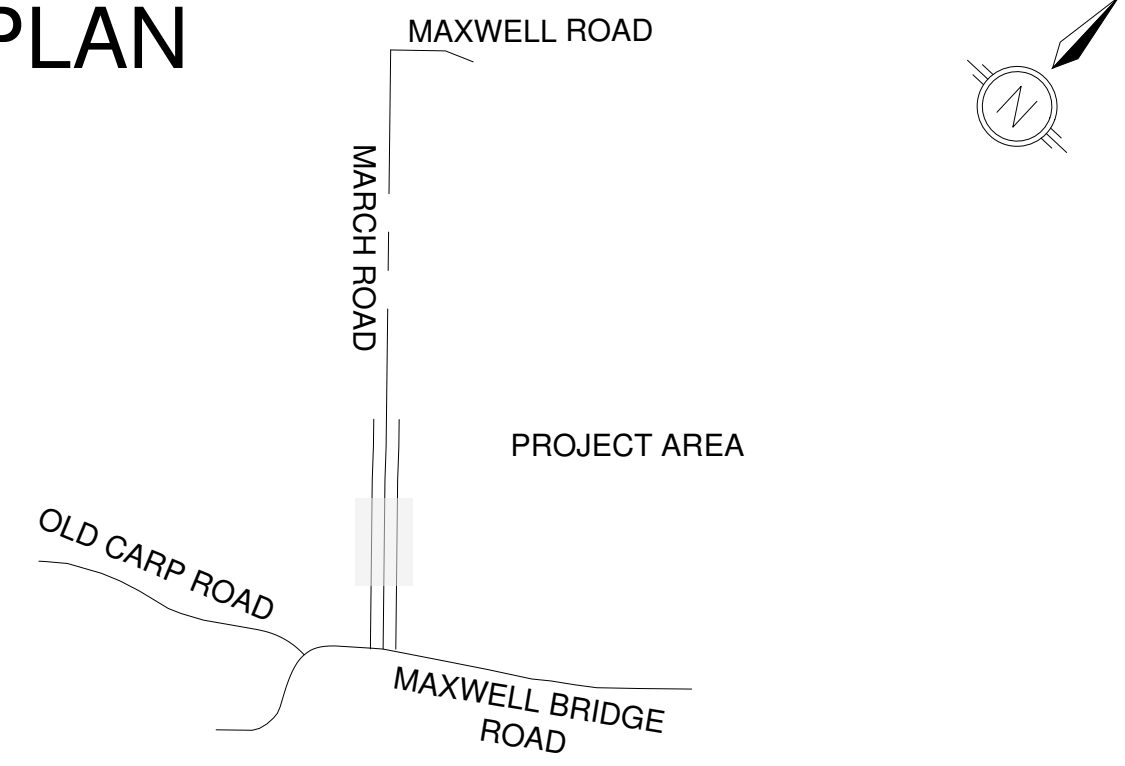

## 910 MARCH ROAD ROADWAY MODIFICATION ULTIMATE CONFIGURATION

TURNING MOVEMENT ANALYSIS  
MARCH ROAD  
STA 9+950 TO 10+125



Contract No. D07-12-22-0050	Dwg. No. TT01
Sheet - of -	
Asset No.	
Asset Group	
Des. B.B	Chk'd. M.C
Dwn. B.B	Chk'd. M.C
Utility Circ. No.	Index No.
Const. Inspector	
Scale: 0m 5 10	HORIZONTAL

NOTE: The location of utilities is approximate only, the exact location should be determined by consulting the municipal authorities and utility companies concerned. The contractor shall prove the location of utilities and shall be responsible for adequate protection from damage.

No.	Description	By	Date (dd/mm/yy)
1.	ISSUED FOR FUNCTIONAL DESIGN REVIEW	M.C	25/01/23
2.	ISSUED FOR FUNCTIONAL DESIGN REVIEW	M.C	27/07/23
3.	ISSUED FOR FUNCTIONAL DESIGN REVIEW	M.C	20/10/23
4.	ISSUED FOR FUNCTIONAL DESIGN REVIEW	M.C	17/01/24

**FUNCTIONAL DESIGN  
NOT FOR CONSTRUCTION**

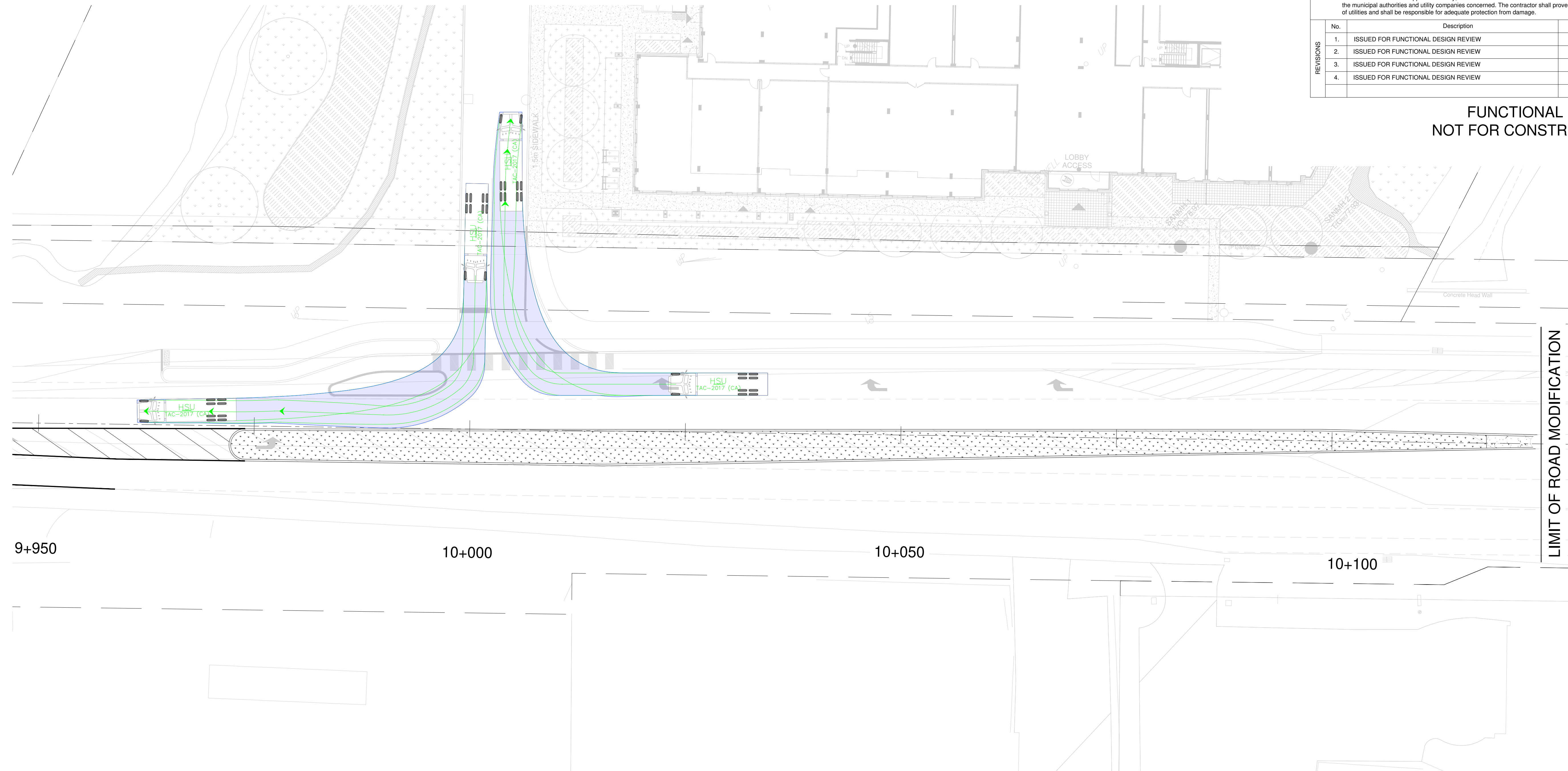

9+950

10+000

10+050

10+100

LIMIT OF ROAD MODIFICATION



**910 March Road  
Intersection Modification Construction Costs  
Ultimate Condition  
Class 'D' Cost Estimate  
2024-01-17**



Item	Description		Amount
<b>10</b>	<b>Construction</b>		<b>\$ 110,744.65</b>
10.00	Construction - General		\$ 2,500.00
10.01	Excavation and Removals		\$ 52,859.34
10.02	Concrete		\$ 50,852.82
10.03	Pavement Structure		\$ 2,232.49
10.05	Pavement Marking		\$ 1,500.00
10.07	Signage		\$ 800.00
20	Engineering and Architectural Services	15%	\$ 16,611.70
30	Contract Administration Fees (If Required)	10%	\$ 11,074.46
	<b>Sub Total</b>		<b>\$ 138,430.81</b>
40	Contingency	15%	\$ 16,611.70
	<b>GRAND TOTAL</b>		<b>\$ 155,042.51</b>

**910 March Road**  
**Intersection Modification Construction Costs**  
**Ultimate Condition**  
**Class 'D' Cost Estimate**  
**2024-01-17**



Item No.	Item Code	Description	Quantity	Units	Unit Price	Amount
<b>10.00</b>		<b>Construction General</b>				
	A020.01	Traffic Control Plan (includes Police assistance)	1	LS	\$ 1,500.00	\$ 1,500.00
	A030.01	Construction Site Pedestrian Control Plan	1	LS	\$ 1,000.00	\$ 1,000.00
<b>10.01</b>		<b>Excavation and Removals</b>				
	L040.35	Saw Cutting of Asphalt	618	m	\$ 13.63	\$ 8,423.34
	L040.37	Remove Asphalt Pavement by Dry Grinding	154	m <sup>2</sup>	\$ 103.17	\$ 15,898.50
	L040.38	Remove Asphalt Pavement - Full Depth (Stripping)	668	m <sup>2</sup>	\$ 42.74	\$ 28,537.50
<b>10.02</b>		<b>Concrete</b>				
	L260.01	Concrete Barrier Curb as per SC1.1	306	m	\$ 160.65	\$ 49,158.90
	L250.06	Concrete Sidewalks, Boulevards and Islands	8	m <sup>2</sup>	\$ 211.74	\$ 1,693.92
<b>10.03</b>		<b>Pavement Structure</b>				
	L380.20	Superpave 12.5mm (50mm Depth)	5	t	\$ 341.39	\$ 1,553.32
	L390.05	Superpave 19.0mm (70mm Depth)	3	t	\$ 226.39	\$ 679.17
<b>10.04</b>		<b>Landscaping</b>				
	T020.03	Top Soil, Imported (150mm Thick)	67	m <sup>3</sup>	\$ 91.84	\$ 6,157.87
	T030.05	Sod, Including Watering	447	m <sup>2</sup>	\$ 23.60	\$ 10,549.20
<b>10.05</b>		<b>Pavement Markings</b>				
	-	Pavement Markings [Provisional]	1	LS	\$ 1,500.00	\$ 1,500.00
<b>10.07</b>		<b>Signage</b>				
		Wa-33L	1	ea	\$ 400.00	\$ 400.00
		Rb-25	1	ea	\$ 400.00	\$ 400.00
<b>Total</b>						<b>\$ 127,451.72</b>