

GENERAL NOTES

- 1. ALL WORKS AND MATERIALS SHALL CONFORM TO THE LATEST REVISION OF THE STANDARDS AND SPECIFICATIONS FOR THE CITY OF OTTAWA, ONTARIO PROVINCIAL STANDARD DRAWINGS (OPSD) AND SPECIFICATIONS (OPSS), WHERE APPLICABLE. LOCAL UTILITY STANDARDS AND MINISTRY OF TRANSPORTATION STANDARD DRAWINGS WILL APPLY WHERE REQUIRED.

WATERMAIN NOTES

- 1. ALL WATERMAIN INSTALLATION SHALL CONFORM TO THE LATEST REVISIONS OF THE CITY OF OTTAWA AND THE ONTARIO PROVINCIAL STANDARD DRAWINGS (OPSD) AND SPECIFICATIONS (OPSS).

SANITARY AND STORM SEWER NOTES

- 1. LASER ALIGNMENT CONTROL TO BE UTILIZED ON ALL SEWER INSTALLATIONS.

- 1. ALL SANITARY SEWER INSTALLATION SHALL CONFORM TO THE LATEST REVISIONS OF THE CITY OF OTTAWA AND THE ONTARIO PROVINCIAL STANDARD DRAWINGS (OPSD) AND SPECIFICATIONS (OPSS).

- 17. ALL REINFORCED CONCRETE STORM SEWER PIPE SHALL BE IN ACCORDANCE WITH CSA A257.2, OR LATEST AMENDMENT. ALL NON-REINFORCED CONCRETE STORM SEWER PIPE SHALL BE IN ACCORDANCE WITH CSA A257.1, OR LATEST AMENDMENT.

- 18. ALL STORM SEWER TRENCH AND BEDDING SHALL BE IN ACCORDANCE WITH CITY OF OTTAWA STD. 56 AND 57 CLASS 'B' BEDDING UNLESS SPECIFIED OTHERWISE.

- 19. ALL PVC STORM SEWERS ARE TO BE SDR 35 APPROVED PER C.S.A. B182.2 OR LATEST AMENDMENT, UNLESS OTHERWISE SPECIFIED.

- 20. CATCH BASINS SHALL BE IN ACCORDANCE WITH OPSD 705.010.

- 21. CATCH BASIN LEADS SHALL BE 200MM DIA. AT 1% SLOPE (MIN) UNLESS SPECIFIED OTHERWISE.

- 22. ALL CATCH BASINS SHALL HAVE 600MM SLOPS, UNLESS SPECIFIED OTHERWISE.

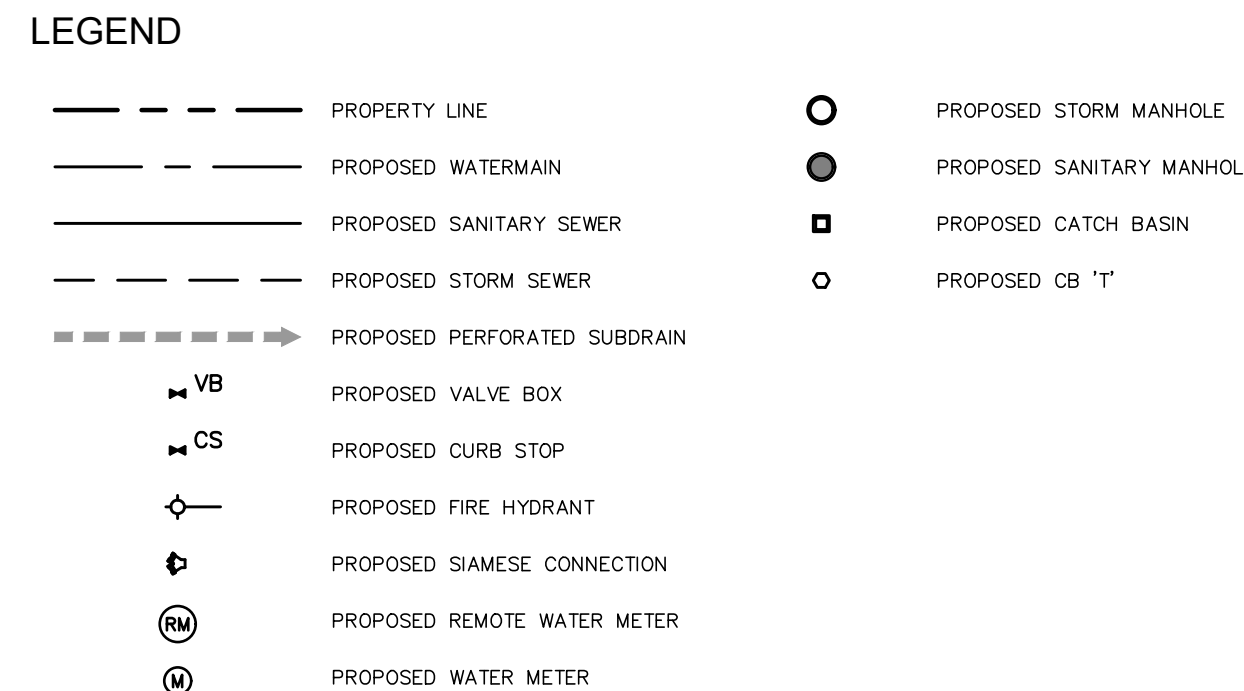
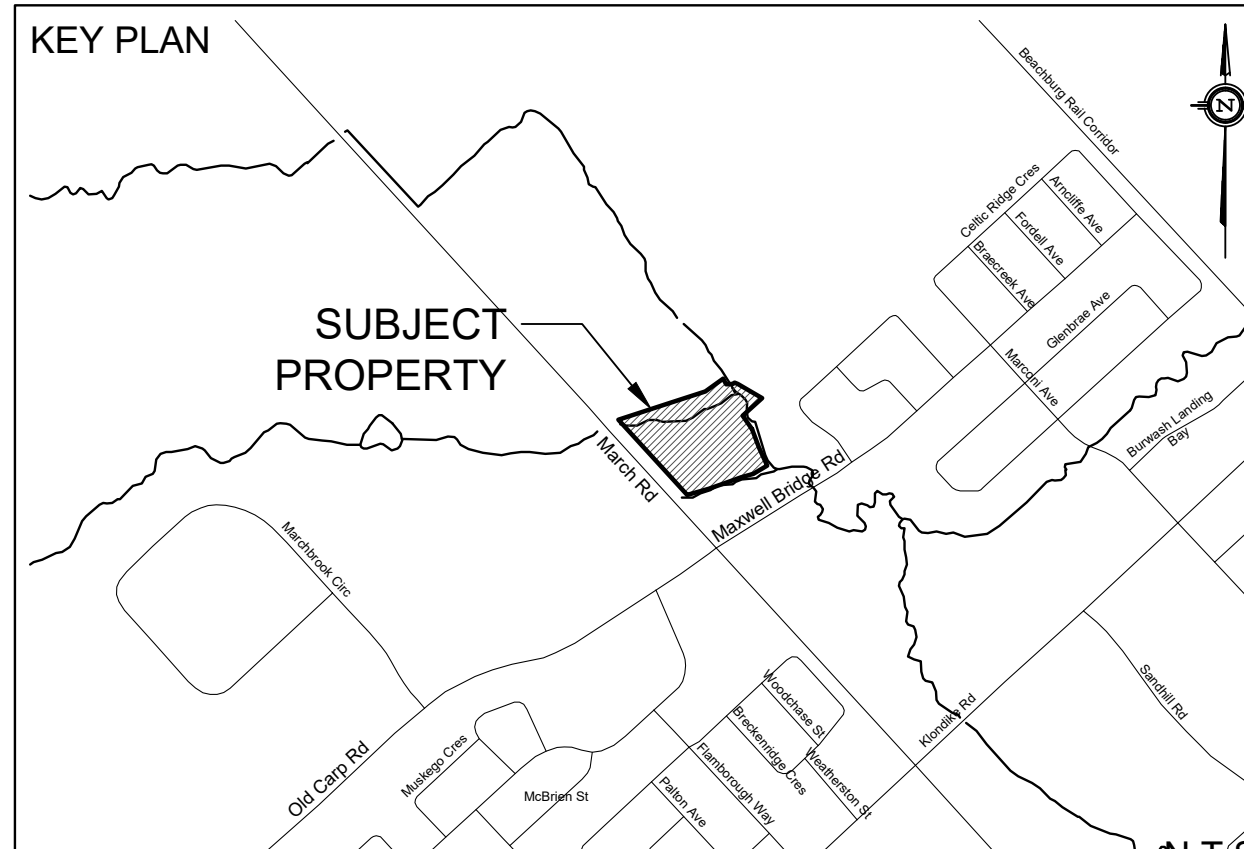
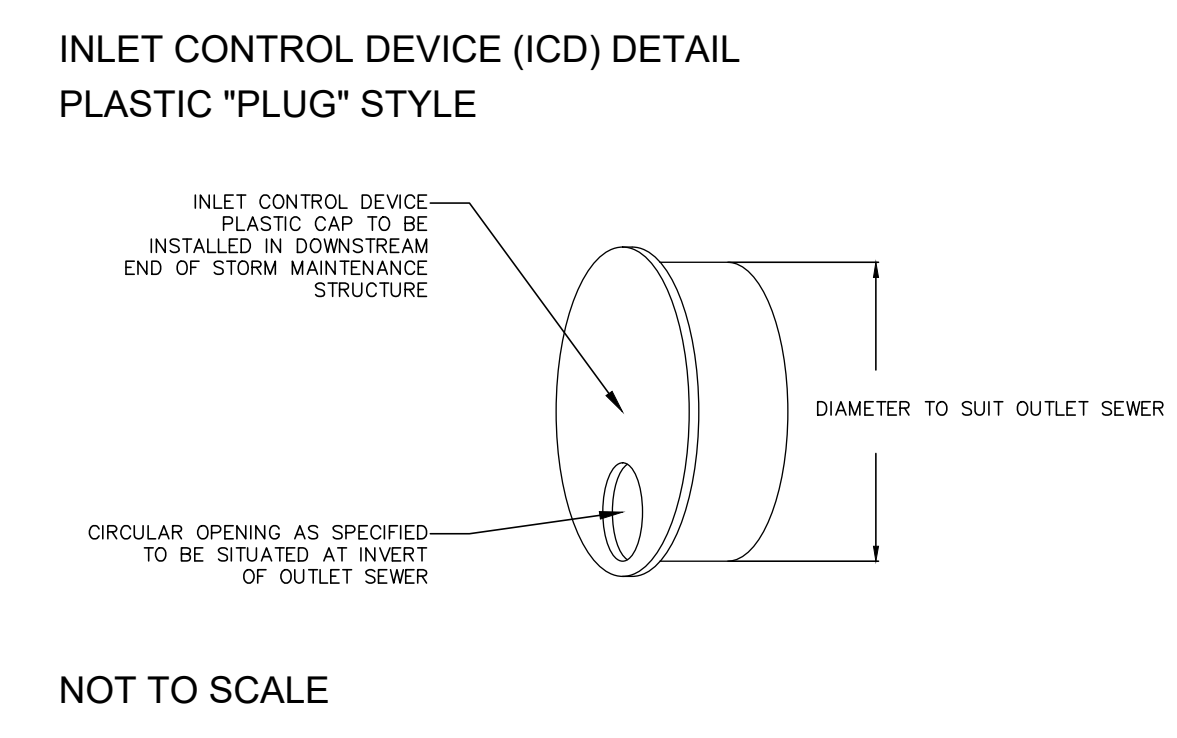

EXISTING UNDERGROUND SERVICES AND UTILITY LOCATIONS DERIVED FROM THE BEST AVAILABLE DATA. AS-CONSTRUCTED DRAWINGS, UTILITY DRAWINGS AND INFRASTRUCTURE MAPPING PROVIDED BY THE CITY OF OTTAWA.

CONTRACTOR TO CONFIRM ELEVATIONS AND LOCATIONS OF EXISTING UNDERGROUND SERVICES AND UTILITIES WITHIN THE RIGHT OF WAY PRIOR TO INSTALLATION OF SITE SERVICING INFRASTRUCTURE.

THE CONTRACTOR SHALL IMPLEMENT BEST MANAGEMENT PRACTICES, TO PROVIDE FOR PROTECTION OF THE AREA DRAINAGE SYSTEM AND THE RECEIVING WATERCOURSE, DURING CONSTRUCTION ACTIVITIES. THE CONTRACTOR ACKNOWLEDGES THAT THE FAILURE TO IMPLEMENT APPROPRIATE EROSION AND SEDIMENT CONTROL MEASURES MAY BE SUBJECT TO PENALTIES IMPOSED BY ANY APPLICABLE REGULATORY AGENCY.

NOT FOR CONSTRUCTION

TOPOGRAPHIC INFORMATION  
TOPOGRAPHIC INFORMATION PROVIDED BY STATTEC GEOMATICS LTD.  
PROJ. NO. 161813685-111  
DATED JULY 10, 2017

SITE PLAN INFORMATION  
SITE PLAN PROVIDED BY GREYSTONE  
PROJ. NO. 17300  
DATED JUNE 26, 2020

GEOTECHNICAL STUDY  
GEOTECHNICAL RECOMMENDATIONS PROVIDED BY PATERSON GROUP  
PROJ. NO. PG5119-1  
DATED NOVEMBER 13, 2019

SITE SERVICING AND STORMWATER MANAGEMENT STUDY  
SERVICING AND STORMWATER MANAGEMENT RECOMMENDATIONS PROVIDED BY DSEL  
PROJ. NO. 17-962  
DATED JUNE 2020

BENCH MARK  
TOP OF SPINDLE OF FIRE HYDRANT LOCATED AT MARCH ROAD AND MAXWELL BRIDGE ROAD INTERSECTION  
ELEV=79.35

Table with 3 columns: No., BY, DESCRIPTION. Row 1: 1 B.N.C. 20.06.26 ISSUED FOR MUNICIPAL REVIEW. Row 2: No. BY YY.MM.DD DESCRIPTION.

Professional Engineer seal for A.D. FOBERT, License No. 10090626, Province of Ontario. Includes 'PROJECT No. 17-962' and 'REVIEWED BY'.

SITE SERVICING PLAN 910 MARCH ROAD © DSEL. WEXFORD COMMERCIAL DEVELOPMENTS LTD. 6 Malabar Court, Hamilton, Ontario, L9C 2B9. Tel. (289) 680-7711. DSEL david schaeffer engineering ltd. 120 Iber Road Unit 103, Stittsville, Ontario, K2S 1E9. Tel. (613) 836-0856. Fax. (613) 836-7183. www.DSEL.ca. DRAWN BY: B.N.C. CHECKED BY: A.D.F. DRAWING NO. SHEET NO. DESIGNED BY: B.N.C. CHECKED BY: A.D.F. SCALE: 1:500 DATE: JUNE 2020 SSP-1 3 of 4