

KEY PLAN

STREET TREE REQUIREMENT:
 1 TREE PER INTERIOR (NON-CORNER) LOTS
 2 TREES PER EXTERIOR (CORNER) LOTS
 2 TREES PER 3-4 MULTIPLE-UNITS TOWNHOUSE
 3 TREES PER 5-6 MULTIPLE-UNITS TOWNHOUSE
 5 TREES PER 8-10 MULTIPLE-UNITS TOWNHOUSE
 7 TREES PER 12-14 MULTIPLE-UNITS TOWNHOUSE

TREES PER EXTERIOR (CORNER) LOTS (12): 12 TREES
3 MULTIPLE-UNITS TOWNHOUSE (6): 12 TREES
4 MULTIPLE-UNITS TOWNHOUSE (6): 12 TREES
5 MULTIPLE-UNITS TOWNHOUSE (15): 45 TREES
6 MULTIPLE-UNITS TOWNHOUSE (1): 3 TREES

TOTAL NUMBER OF TREES REQUIRED: 84
NUMBER OF STREET TREES SHOWN ON PLAN: 81
DIFFERENCE: -3

LEGEND

- PROPERTY LINE
- PHASE LINE

FENCING

- 1.8m PRIVACY FENCE LOCATED 0.15M ON PRIVATE PROPERTY

PLANTING

- XX MEDIUM DECIDUOUS STREET TREE
- SODDING

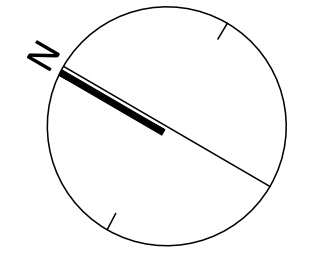

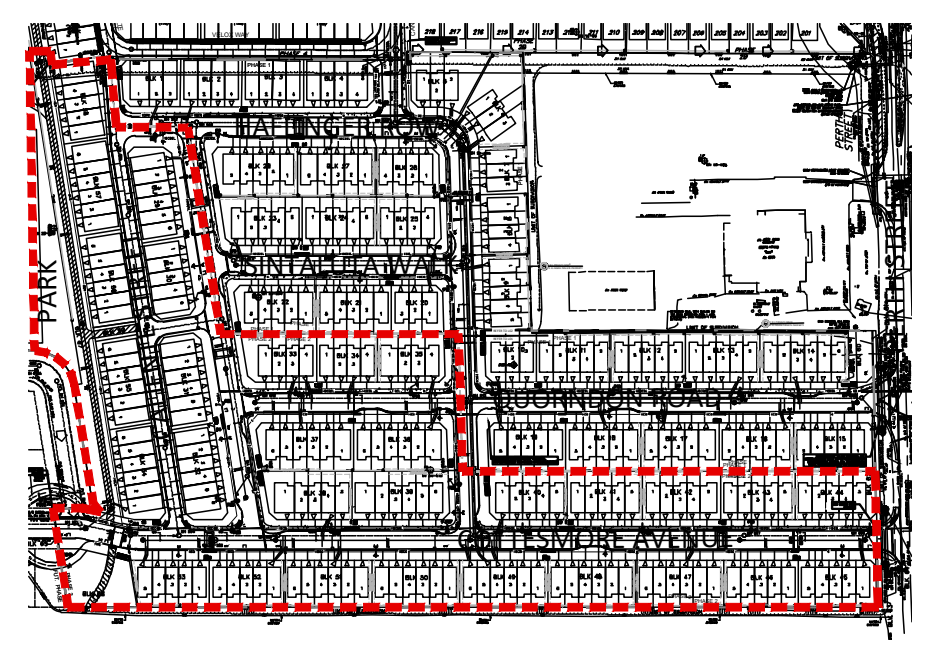

KEY PLAN

STREET TREE REQUIREMENT:
 1 TREE PER INTERIOR (NON-CORNER) LOTS
 2 TREES PER EXTERIOR (CORNER) LOTS
 2 TREES PER 3-4 MULTIPLE-UNITS TOWNHOUSE
 3 TREES PER 5-6 MULTIPLE-UNITS TOWNHOUSE
 5 TREES PER 8-10 MULTIPLE-UNITS TOWNHOUSE
 7 TREES PER 12-14 MULTIPLE-UNITS TOWNHOUSE

TREES PER EXTERIOR (CORNER) LOTS (14): 14 TREES
4 MULTIPLE-UNITS TOWNHOUSE (3): 6 TREES
5 MULTIPLE-UNITS TOWNHOUSE (13): 39 TREES
6 MULTIPLE-UNITS TOWNHOUSE (14): 42 TREES

TOTAL NUMBER OF TREES REQUIRED: 101
NUMBER OF STREET TREES SHOWN ON PLAN: 111
DIFFERENCE: +10

LEGEND

- PROPERTY LINE
- PHASE LINE

FENCING

- PRIVACY FENCE LOCATED 0.15M ON PRIVATE PROPERTY

PLANTING

- XX MEDIUM DECIDUOUS STREET TREE
- SODDING

