

6171 HAZELDEAN ROAD  
OTTAWA, ONTARIO.

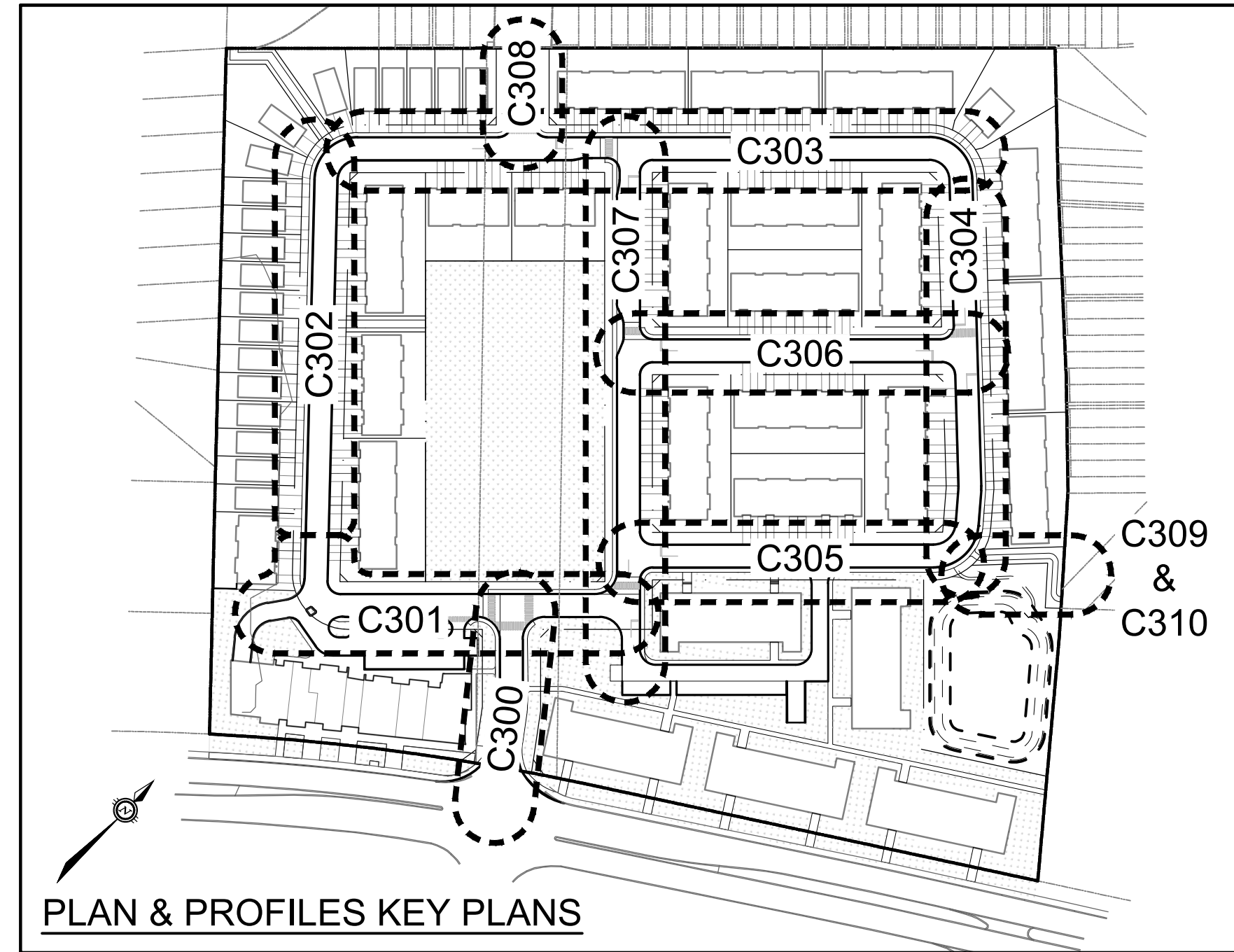
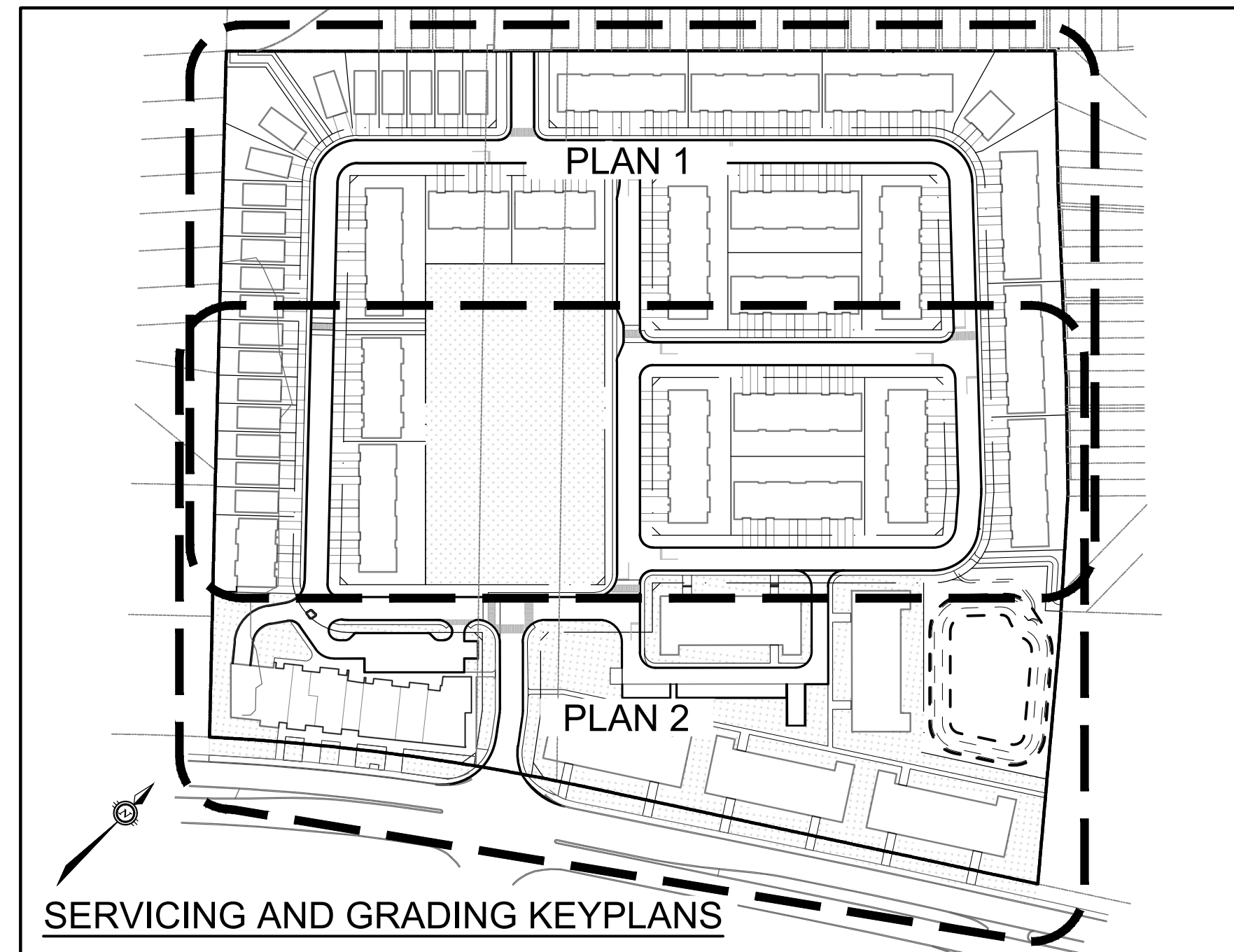
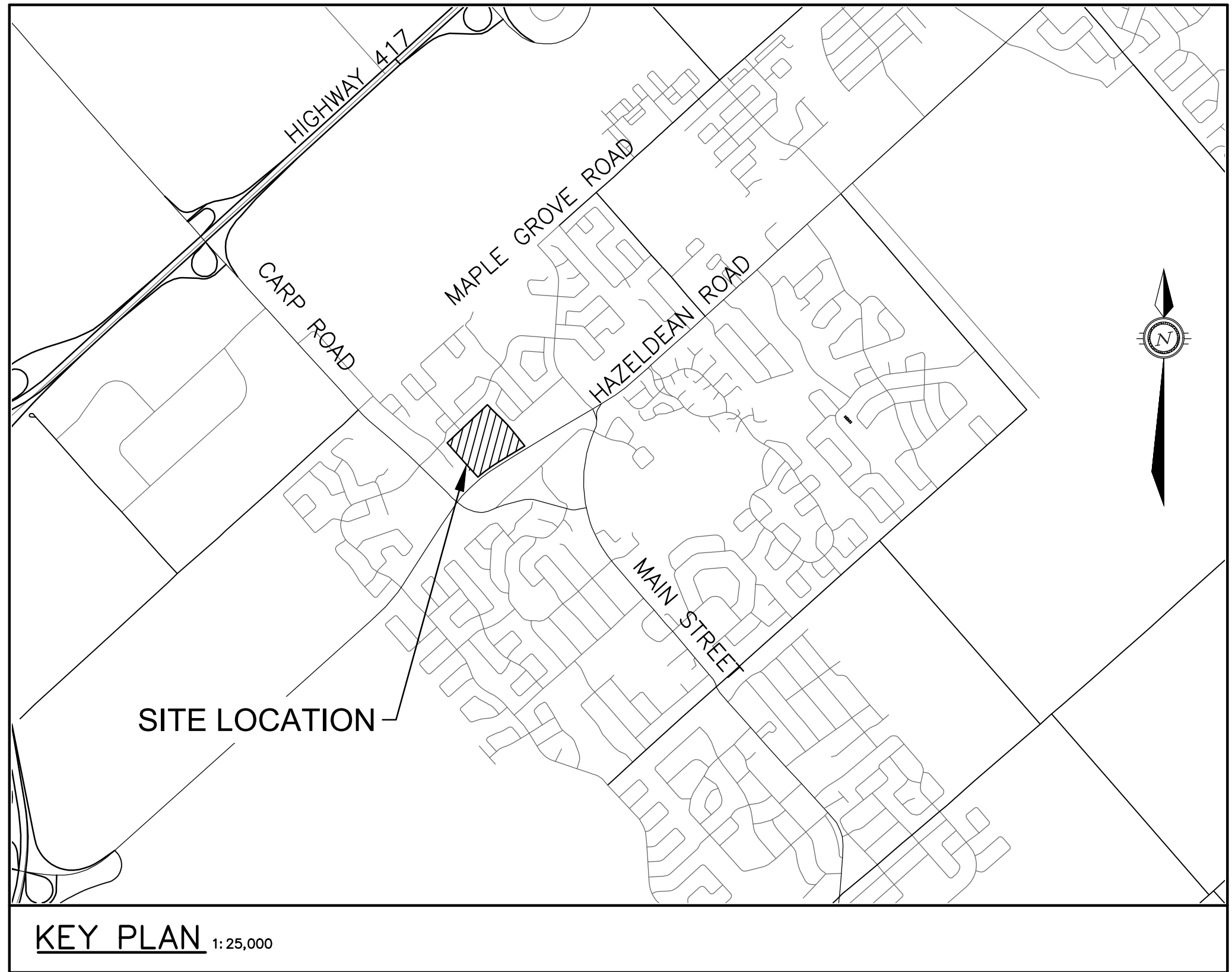

LIST OF DRAWINGS		
DWG NO.	DWG TITLE	REVISION NO.
	COVER SHEET	1
C001	LEGENDS AND NOTES	1
C002	TABLES	1
C100	SERVICING PLAN - PLAN 1	5
C101	SERVICING PLAN - PLAN 2	5
C200	GRADING PLAN - PLAN 1	4
C201	GRADING PLAN - PLAN 1	4
C300	PLAN AND PROFILE, STREET 1, STA.1+000 TO STA.1+125	2
C301	PLAN AND PROFILE, STREET 2, STA.0+000 TO STA.0+150	2
C302	PLAN AND PROFILE, STREET 2, STA.0+150 TO STA.0+300	2
C303	PLAN AND PROFILE, STREET 2, STA.0+300 TO STA.0+550	2
C304	PLAN AND PROFILE, STREET 2, STA.0+550 TO STA.0+700	2
C305	PLAN AND PROFILE, STREET 2, STA.0+700 TO STA.0+810	2
C306	PLAN AND PROFILE, STREET 4, STA.4+000 TO STA.4+150	2
C307	PLAN AND PROFILE, STREET 5, STA.5+000 TO STA.5+00	2
C308	PLAN AND PROFILE, SAMANTHA EASTOP, STA.7+000 TO STA.7+075	2
C309	PLAN AND PROFILE, SANITARY CONN. TO EXIST., STA.0+000 TO STA.0+125	2
C310	PLAN AND PROFILE, STORM CONN. TO EXIST., STA.0+000 TO STA.0+125	2
C400	POST DEVELOPMENT STORM DRAINAGE PLAN	4
C401	POST DEVELOPMENT PONDING PLAN	1
C500	SANITARY DRAINAGE PLAN	4
C600	EROSION AND SEDIMENT CONTROL PLAN	3
C700	DETAIL SHEET 1 - ROADWAY SECTIONS	1
C701	DETAIL SHEET 2 - TYPICAL SECTIONS	1
C702	DETAIL SHEET 3	1
C703	DETAIL SHEET 4 - STORMWATER MANAGEMENT FACILITY	1
C704	DETAIL SHEET 5 - STORMWATER MANAGEMENT FACILITY DETAILS 1	1
C705	DETAIL SHEET 6 - STORMWATER MANAGEMENT FACILITY DETAILS 2	1

**exp Services Inc.**  
 T: +1.613.688.1899 | F: +1.613.225.7330  
 2650 Queensview Drive, Unit 100  
 Ottawa, ON K2B 8H6  
 Canada  
 www.exp.com

• BUILDINGS • EARTH & ENVIRONMENT • ENERGY •  
 • INDUSTRIAL • INFRASTRUCTURE • SUSTAINABILITY •

PROJECT No.OTT-00258780-A0  
MAY 2022

1202 CARP ROAD  
STITTSVILLE, ON. K2S 1B9

ISSUED FOR APPROVAL - MAY 12, 2022

Filepath: \\exp\back\proj\ott-00258780-a0\100\execution\05\drawings\c000\cover.dwg  
 User: jsmith  
 Last Printed: 5/12/2022 10:33:31 AM  
 Plotted by: bulmer  
 Reference: \_ref-FRM\_Topo.dwg; \_ref-FRM\_Top.dwg