



1202, CARP ROAD, STITTSVILLE, ON K2S 1B9



4383 651 8854
INFO@PMAARCHITECTS.COM
2505, CHEMIN DES QUATRE-BORDEURS
QUÉBEC (QC) G1W 2X4
PMAARCHITECTS.COM



ARCHITECTES / ASSOCIÉS
53, SAINT-RAYMOND BOULEVARD,
GATINEAU, QC J8Y 1R9



2650, QUEENSWAY DRIVE, SUITE 100,
OTTAWA, ON K2B 8H6



286 Colton Street, Suite 300, Ottawa ON K1P 2H7
613 726-3700 www.fotenn.com



98, BLANCHARD STREET, SUITE 123,
SAINTE-THERÈSE, QC J7E 4R9



600, TERRY FOX DRIVE, SUITE 100,
KANATA, ON K2L 4K6

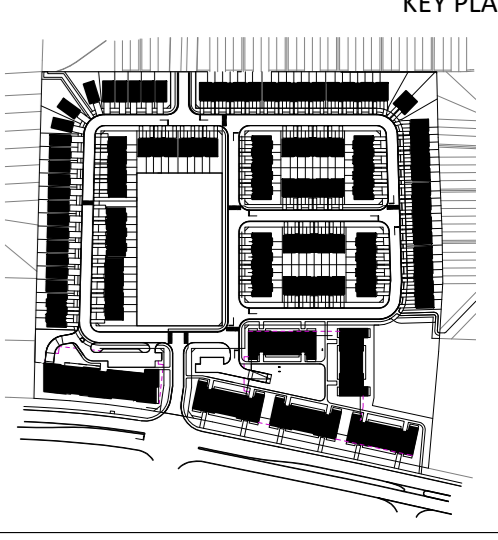

ARCHITECT SEAL

REVISIONS			
NO	DESCRIPTION	DATE	BY
1	FOR COORDINATION	2022-04-20	
2	FOR COORDINATION	2022-04-20	
3	FOR COORDINATION	2022-04-20	
4	FOR COORDINATION	2022-04-20	
5	FOR COORDINATION	2022-04-20	
6	FOR COORDINATION	2022-04-20	

NOTE
IT IS THE RESPONSIBILITY OF THE APPROPRIATE CONTRACTOR TO CHECK AND VERIFY ALL DIMENSIONS ON THE SITE AND TO REPORT ALL ERRORS AND/OR OMISSIONS TO THE ARCHITECT. ALL CONTRACTORS MUST COMPLY WITH ALL PERTINENT CODES AND BY-LAWS. DO NOT SCALE DRAWINGS.

THIS DOCUMENT AND ITS CONTENT IS COPYRIGHTED. ANY REPRODUCTION IS PROHIBITED UNLESS GRANTED BY THE ARCHITECT.

**FOR COORDINATION
DO NOT USE FOR
CONSTRUCTION
2022-04-20**

DATE	DESIGNED
2022-04-20	PM
	DRAWN
	PP
	CHECKED
	PM
	SHEET TITLE

SITE PLAN

SHEET NO
A100

SITE PLAN LEGEND

- [Symbol] EXISTING BUILDING
- [Symbol] NEW BUILDING
- [Symbol] NEW BUILDING WITH COMMERCIAL SPACE AT-GRADE
- [Symbol] GRASS
- [Symbol] ASPHALT
- [Symbol] LOT LINE
- [Symbol] SETBACKS
- [Symbol] NEW TREE, SEE LANDSCAPE
- [Symbol] FIREWALL
- [Symbol] SIDEWALK

LOTS AREAS

NAME	AREAS (sq m)	NAME	AREAS (sq m)
B01	367	B34-5	176
B02	306	B34-6	173
B03	306	B34-7	173
B04	306	B34-8	312
B05	332	B35-1	218
B06	534	B35-2	169
B07	315	B35-3	179
B08	728	B35-4	173
B09	461	B35-5	173
B10	316	B35-6	179
B11	316	B35-7	169
B12	316	B35-8	218
B13	316	B35-9	218
B14	316	B36-2	169
B15	316	B36-3	179
B16	316	B36-4	173
B17	316	B36-5	173
B18	316	B36-6	179
B19	317	B36-7	169
B20	317	B36-8	218
B21	316	B37-1	328
B22-1	272	B37-2	180
B22-2	181	B37-3	179
B22-3	181	B37-4	181
B23-1	180	B37-5	180
B23-2	172	B37-6	175
B23-3	172	B37-7	174
B23-4	172	B37-8	312
B23-5	173	B37-9	342
B23-6	180	B38-3	179
B23-7	172	B38-4	183
B23-8	222	B38-5	183
B24	180	B38-6	179
B25-1	242	B38-7	179
B25-2	183	B38-8	342
B25-3	184	B39-3	222
B25-4	185	B39-2	173
B25-5	186	B39-3	183
B25-6	248	B39-4	176
B26-1	232	B39-5	176
B26-2	181	B39-6	183
B26-3	192	B39-7	173
B26-4	187	B39-8	222
B26-5	188	B40-1	222
B26-6	195	B40-2	173
B26-7	186	B40-3	183
B26-8	357	B40-4	176
B27	5,056	B40-5	176
B28-1	249	B40-6	183
B28-2	194	B40-7	173
B28-3	205	B40-8	222
B28-4	194	B41-1	345
B28-5	249	B41-2	185
B29-1	332	B41-3	186
B29-2	194	B41-4	188
B29-3	205	B41-5	187
B29-4	194	B41-6	182
B29-5	249	B41-7	181
B30-1	274	B41-8	343
B30-2	168	B42-1	424
B30-3	178	B42-2	162
B30-4	171	B42-3	170
B30-5	171	B42-4	164
B30-6	178	B42-5	165
B30-7	168	B42-6	171
B30-8	216	B42-7	162
B31-1	216	B42-8	209
B31-2	168	B43-1	210
B31-3	178	B43-2	164
B31-4	171	B43-3	173
B31-5	171	B43-4	168
B31-6	178	B43-5	168
B31-7	168	B43-6	175
B31-8	216	B43-7	166
B31-9	216	B43-8	212
B32-2	168	B44-1	211
B32-3	178	B44-2	164
B32-4	171	B44-3	173
B32-5	172	B44-4	166
B32-6	178	B44-5	166
B32-7	168	B44-6	173
B32-8	419	B44-7	164
B33-1	479	B44-8	226
B33-2	503	B45	296
B34-1	312	B46	3,596
B34-2	173	B47	13,937
B34-3	172	PARK	8,209
B34-4	177		



6171 HAZELDEAN ROAD - SITE PLAN
1:500

BIM 360://HAZELDEAN-KANATA/20019_HAZELDEAN_SITE_PLN_B21.rvt