

LEGEND

---	PROPERTY LINE	VC	EXISTING WATERMAIN VALVE CHAMBER
---	PROPOSED WATERMAIN	VB	EXISTING WATERMAIN SHUT-OFF VALVE BOX
---	PROPOSED VALVE BOX	400mm Ø WM	EXISTING WATERMAIN
---	PROPOSED STORM MANHOLE	VS	EXISTING HYDRANT C/W LEAD & SHUT OFF VALVE BOX
---	PROPOSED SAN MANHOLE	GV	EXISTING GAS VALVE
---	PROPOSED AREA DRAIN	---	EXISTING GAS MAIN
---	PROPOSED SANITARY SEWER	---	EXISTING ABANDONED GAS MAIN
---	UNDERGROUND PARKING LIMITS	---	EXISTING BELL CONDUIT
---	PROPOSED STORM SEWER	---	EXISTING OVER HEAD WIRE
---	PROPOSED CAP	---	EXISTING HYDROUTILITY POLE
---	EXISTING LEGAL ADJACENT LINE	---	EXISTING GUY WIRE
---	EXISTING STANDARD IRON BAR / CONTROL POINT	---	EXISTING TRAFFIC MANHOLE
---	EXISTING FLOW DIRECTION OF SEWERS	---	EXISTING JOINT USE STREET LIGHT
---	EXISTING SANITARY MANHOLE & SEWER	---	EXISTING STREET LIGHT
---	EXISTING STORM MANHOLE & SEWER	---	EXISTING TRAFFIC HAND HOLE
---	EXISTING CATCH BASIN	---	EXISTING TRAFFIC SIGN
---	EXISTING BUILDING ENVELOPE	---	EXISTING DITCH INLET CATCH BASIN
---		---	EXISTING HYDRANT

- GENERAL NOTES:**
- COORDINATE AND SCHEDULE ALL WORK WITH OTHER TRADES AND CONTRACTORS.
 - DETERMINE THE EXACT LOCATION, SIZE, MATERIAL AND ELEVATION OF ALL EXISTING UTILITIES PRIOR TO COMMENCING CONSTRUCTION. PROTECT AND ASSUME RESPONSIBILITY FOR ALL EXISTING UTILITIES WHETHER OR NOT SHOWN ON THIS DRAWING.
 - OBTAIN ALL NECESSARY PERMITS AND APPROVALS FROM THE CITY OF OTTAWA BEFORE COMMENCING CONSTRUCTION.
 - BEFORE COMMENCING CONSTRUCTION OBTAIN AND PROVIDE PROOF OF COMPREHENSIVE, ALL RISK AND OPERATIONAL LIABILITY INSURANCE FOR \$5,000,000.00, INSURANCE POLICY TO NAME OWNERS, ENGINEERS AND ARCHITECTS AS CO-INSURED.
 - RESTORE ALL DISTURBED AREAS ON-SITE AND OFF-SITE, INCLUDING TRENCHES AND SURFACES ON PUBLIC ROAD ALLOWANCES TO EXISTING CONDITIONS OR BETTER TO THE SATISFACTION OF THE CITY OF OTTAWA AND ENGINEER.
 - REMOVE FROM SITE ALL EXCESS EXCAVATED MATERIAL, ORGANIC MATERIAL AND DEBRIS UNLESS OTHERWISE INSTRUCTED BY ENGINEER. EXCAVATE AND REMOVE FROM SITE ANY CONTAMINATED MATERIAL. ALL CONTAMINATED MATERIAL SHALL BE DISPOSED OF AT A LICENSED LANDFILL FACILITY.
 - ALL ELEVATIONS ARE GEODETIC. CITY OF OTTAWA DENOTED AS PART OF LOTS 1554, 1555, 1556, AND 1557, REGISTERED PLAN 38, CITY OF OTTAWA.
 - REFER TO GEOTECHNICAL REPORT (No. PB281-1, DATED JUL 16TH, 2020), PREPARED BY PATERSON, FOR SUBSURFACE CONDITIONS, CONSTRUCTION RECOMMENDATIONS, AND GEOTECHNICAL INSPECTION REQUIREMENTS. THE GEOTECHNICAL CONSULTANT IS TO REVIEW ON-SITE CONDITIONS AFTER EXCAVATION PRIOR TO PLACEMENT OF THE GRANULAR MATERIAL.
 - REFER TO ARCHITECTS AND LANDSCAPE ARCHITECTS DRAWINGS FOR BUILDING AND HARDSURFACE AREAS AND DIMENSIONS.
 - REFER TO STORMWATER MANAGEMENT REPORT PREPARED BY NOVATECH ENGINEERING CONSULTANTS LTD. R-2021-055- DATED APRIL 21, 2023.
 - SAW CUT AND KEY GRIND ASPHALT AT ALL ROAD CUTS AND ASPHALT TIE IN POINTS AS PER CITY OF OTTAWA STANDARDS (R10).
 - CONTRACTOR TO PROVIDE THE CONSULTANT WITH A GENERAL PLAN OF SERVICES INDICATING ALL SERVICING AS-BUILT INFORMATION SHOWN ON THIS PLAN. AS-BUILT INFORMATION MUST INCLUDE: PIPE MATERIAL, SIZES, LENGTHS, SLOPES, INVERT AND T/O ELEVATIONS, STRUCTURE LOCATIONS, VALVE AND HYDRANT LOCATIONS, TWM ELEVATIONS AND ANY ALIGNMENT CHANGES, ETC.

- SEWER NOTES:**
- SPECIFICATIONS:

ITEM	SPEC. No.	REFERENCE
CATCH-BASIN (600x600mm)	705.010	OPSD
STORM / SANITARY MANHOLE (12000)	701.010	OPSD
CB, FRAME & COVER	480.000	OPSD
STORM / SANITARY MH FRAME & COVER	401.010	OPSD
SEWER TRENCH - BEDDING (GRANULAR A)	S6, S7, W17	CITY OF OTTAWA / OPSD
COVER (GRANULAR A OR GRANULAR B TYPE 1, WITH MAXIMUM PARTICLE SIZE=25mm)		
STORM SEWER	PVC DR 35	CITY OF OTTAWA
SANITARY SEWER	PVC DR 35	CITY OF OTTAWA
CATCH-BASIN LEAD	PVC DR 35	CITY OF OTTAWA
SEWER SERVICE CONNECTION - RIGID PIPE	S11	CITY OF OTTAWA
SEWER SERVICE ABANDONMENT	S11.4	CITY OF OTTAWA
 - INSULATE ALL PIPES (SAN/STM) THAT HAVE LESS THAN 2.0m COVER WITH 50mmx1200mm H-40 INSULATION. PROVIDE 150mm CLEARANCE BETWEEN PIPE AND INSULATION.
 - SERVICES ARE TO BE CONSTRUCTED TO 1.0m FROM FACE OF BUILDING AT A MINIMUM SLOPE OF 1.0%.
 - PIPE BEDDING, COVER AND BACKFILL ARE TO BE COMPACTED TO AT LEAST 98% OF THE STANDARD PROCTOR MAXIMUM DRY DENSITY. THE USE OF CLEAR CRUSHED STONE AS A BEDDING LAYER SHALL NOT BE PERMITTED.
 - FLEXIBLE CONNECTIONS ARE REQUIRED FOR CONNECTING PIPES TO MANHOLES (FOR EXAMPLE KOR-N-SEAL, PSX POSITIVE SEAL AND DURASEAL). THE CONCRETE CRADLE FOR THE PIPE CAN BE ELIMINATED.
 - THE OWNER SHALL REQUIRE THAT THE SITE SERVICING CONTRACTOR PERFORM FIELD TESTS FOR QUALITY CONTROL OF ALL SANITARY SEWERS. LEAKAGE TESTING SHALL BE COMPLETED IN ACCORDANCE WITH OPSS 410.07.16, 410.07.16.04 AND 407.07.24. DYE TESTING IS TO BE COMPLETED ON ALL SANITARY SERVICES TO CONFIRM PROPER CONNECTION TO THE SANITARY SEWER MAIN. THE FIELD TESTS SHALL BE PERFORMED IN THE PRESENCE OF A CERTIFIED PROFESSIONAL ENGINEER WHO SHALL SUBMIT A CERTIFIED COPY OF THE TEST RESULTS.
 - STORM MANHOLES AND CBHMS ARE TO HAVE 300mm BUMPS UNLESS OTHERWISE INDICATED.
 - CONTRACTOR TO TELEPHONE (CCTV) ALL PROPOSED SEWERS, 200mm OR GREATER PRIOR TO BASE COURSE ASPHALT. UPON COMPLETION OF CONTRACT, THE CONTRACTOR IS RESPONSIBLE TO FLUSH AND CLEAN ALL SEWERS & APPURTENANCES.
 - FULL PORT BACKWATER VALVES ARE REQUIRED ON THE SANITARY SERVICES, INSTALLED AS PER THE MANUFACTURERS RECOMMENDATIONS AND A BACKWATER VALVE IS REQUIRED ON THE STORM SERVICES / FOUNDATION DRAINS FOR EACH BUILDING, INSTALLED AS PER STD. DWG514
 - REINSTATE ALL EXISTING PAVEMENT, CURBS AND BOULEVARDS AS PER CITY OF OTTAWA R10.
 - ALL EXISTING SANITARY AND STORM SERVICES ARE TO BE CAPPED AT THE PROPERTY LINE TO THE SATISFACTION OF THE CITY OF OTTAWA'S SEWER OPERATION.
 - MONITORING TEST PORTS FOR BUILDING SERVICES TO BE INSTALLED IN PARKING GARAGE.

WATERMAIN TABLE (150mmØ)

STATION	SURFACE ELEVATION	TOP OF WM ELEVATION	DESCRIPTION
0+000.0	62.04	59.64	CONNECT TO EXISTING 150mmØ WATERMAIN
0+003.9	62.13	59.64	W&VB
0+004.0	62.13	59.64	WATERMAIN CAP

WATERMAIN TABLE (150mmØ)

STATION	SURFACE ELEVATION	TOP OF WM ELEVATION	DESCRIPTION
1+000.0	62.31	59.64	CONNECT TO EXISTING 400mmØ WATERMAIN
1+003.0	62.17	59.64	CROSS ABOVE EXISTING 150mmØ COMB
1+013.9	62.38	59.64	W&VB
1+014.0	62.38	59.64	WATERMAIN CAP

*EXACT DEPTH OF EXISTING WATERMAIN TO BE DETERMINED AT TIME OF EXCAVATION. CONTRACTOR TO CONFIRM TOP OF WATERMAIN. PROVIDE THERMAL INSULATION AS PER CITY OF OTTAWA DETAIL W23 WHERE COVER IS LESS THAN 2.4m

PIPE CROSSING TABLE

ID	LOWER PIPE	UPPER PIPE	CLEARANCE
1	150mmØ WM TWM = 59.58	300mmØ SAN INV = 59.68	+0.30m
2	150mmØ WM TWM = 59.60	300mmØ STM INV = 59.90	+0.30m
3	150mmØ WM TWM = 59.55	300mmØ STM INV = 59.85	+0.30m
4	150mmØ COMB. OBV = 59.37	150mmØ WM BWM = 59.70	+0.33m

- WATERMAIN NOTES:**
- SPECIFICATIONS:

ITEM	SPEC. No.	REFERENCE
WATERMAIN TRENCHING	W22	CITY OF OTTAWA
THERMAL INSULATION IN SHALLOW TRENCHES	W24	CITY OF OTTAWA
VALVE BOX ASSEMBLY	W25.1	CITY OF OTTAWA
CONNECTION DETAIL FROM EXISTING TO NEW WM	W25.2	CITY OF OTTAWA
WATERMAIN CROSSING BELOW SEWER	W26.2	CITY OF OTTAWA
WATERMAIN CROSSING OVER SEWER	W23	CITY OF OTTAWA
THERMAL INSULATED AT OPEN STRUCTURE	W38	CITY OF OTTAWA
WATER SERVICE INSTALLATION AT SEWER CROSSING		
 - SUPPLY AND CONSTRUCT ALL WATERMANS AND APPURTENANCES IN ACCORDANCE WITH THE CITY OF OTTAWA STANDARDS AND SPECIFICATIONS. EXCAVATION, INSTALLATION, BACKFILL AND RESTORATION OF ALL WATERMANS BY THE CONTRACTOR. CONNECTIONS AND SHUT-OFFS AT THE MAIN AND CHLORINATION OF THE WATER SYSTEM SHALL BE PERFORMED BY CITY OFFICIALS.
 - WATERMAIN SHALL BE MINIMUM 2.4m DEPTH BELOW GRADE UNLESS OTHERWISE INDICATED. OTHERWISE THERMAL INSULATION IS REQUIRED AS PER STD. DWG22.
 - PROVIDE MINIMUM 0.50m CLEARANCE BETWEEN OUTSIDE OF PIPES AT ALL CROSSINGS WHEN WATERMAIN IS BELOW AND MINIMUM 0.25m CLEARANCE WHEN WATERMAIN IS ABOVE.
 - WATER SERVICE IS TO BE CONSTRUCTED TO WITHIN 1.0m OF FOUNDATION WALL AND CAPPED, UNLESS OTHERWISE INDICATED.
 - ALL EXISTING WATER SERVICES TO BE BLANKED AT MAIN BY CITY FORCES. EXCAVATION AND REINSTATEMENT BY CONTRACTOR.

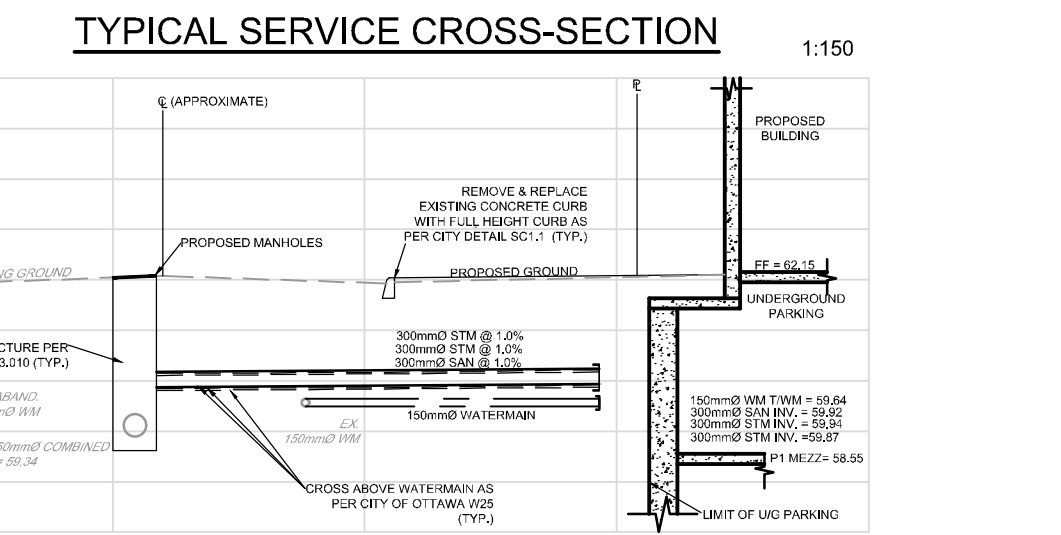

NOTE:
THE POSITION OF ALL POLE LINES, CONDUITS, WATERMANS, SEWERS AND OTHER UNDERGROUND AND OVERGROUND UTILITIES AND STRUCTURES IS NOT NECESSARILY SHOWN ON THE CONTRACT DRAWINGS, AND WHERE SHOWN, THE ACCURACY OF THE POSITION OF SUCH UTILITIES AND STRUCTURES IS NOT GUARANTEED. BEFORE STARTING WORK, DETERMINE THE EXACT LOCATION OF ALL SUCH UTILITIES AND STRUCTURES AND ASSUME ALL LIABILITY FOR DAMAGE TO THEM.

NOT FOR CONSTRUCTION

CLARIDGE HOMES
CLARIDGE HOMES
505 PRESTON STREET,
OTTAWA, ONTARIO
K1S 4N7.



No.	REVISION	DATE	BY
3	ISSUED FOR ZBA AND SPA	APRIL 21/23	GJM
2	ISSUED WITH SITE PLAN APPLICATION	APR 15/21	JAG
1	ISSUED FOR PRELIMINARY CONSTRUCTION	FEB 22/21	JAG

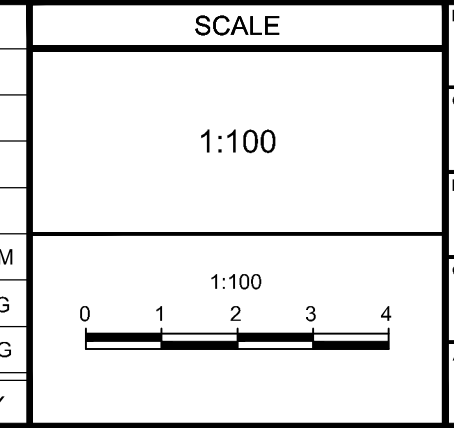

FOR REVIEW ONLY

DESIGN	C/JF
CHECKED	GJM
DRAWN	C/JF
CHECKED	GJM
APPROVED	GJM



NOVATECH
Engineers, Planners & Landscape Architects
Suite 200, 240 Michael Cowland Drive
Ottawa, Ontario, Canada K2M 1P6
Telephone: (613) 254-9543
Facsimile: (613) 254-5867
Website: www.novatech-eng.com

LOCATION
CITY OF OTTAWA
1CON2 - 829 CARLING AVE.

DRAWING NAME
GENERAL PLAN OF SERVICING

PROJECT No. 121008
REV # 3
DRAWING No. 121008-GP

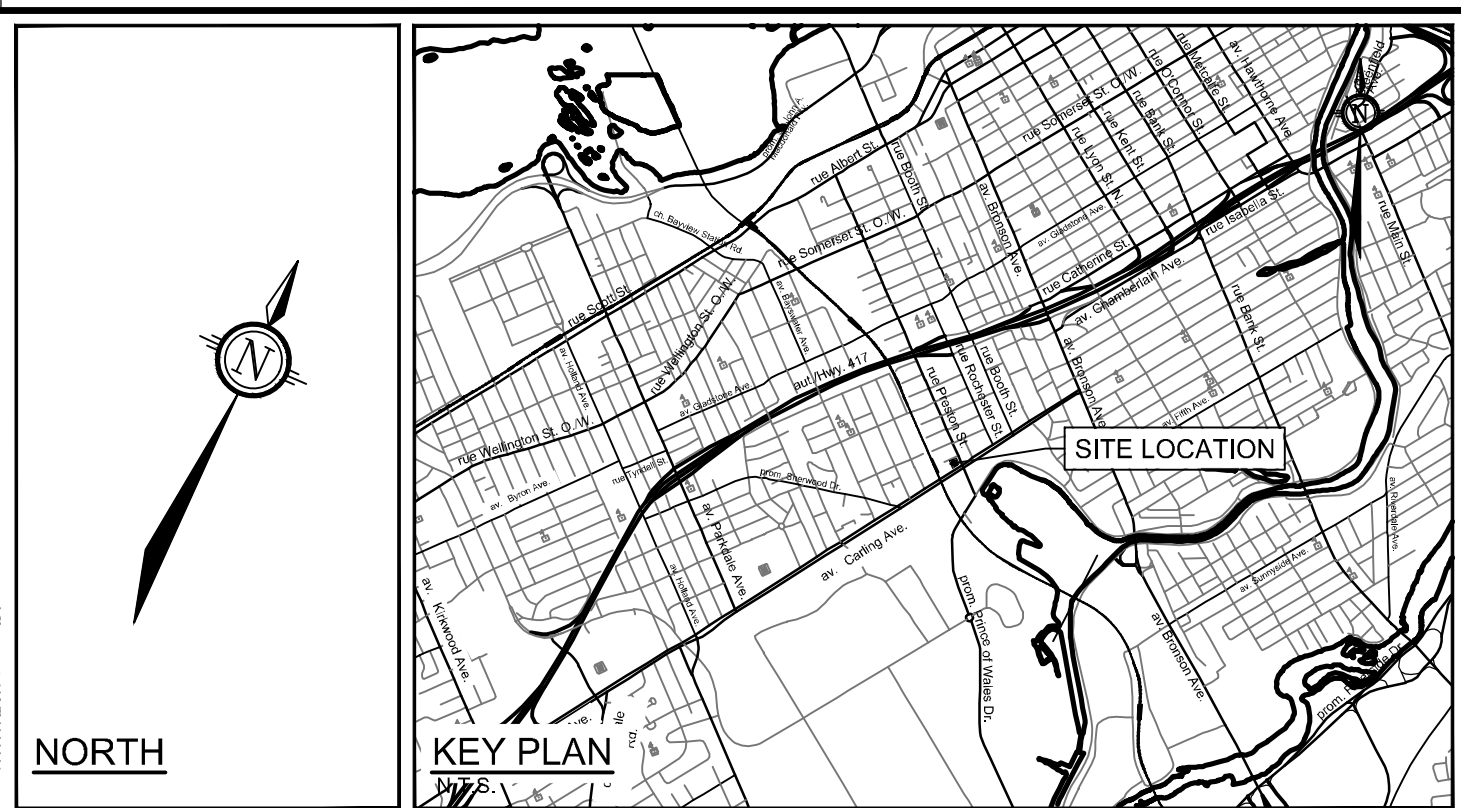
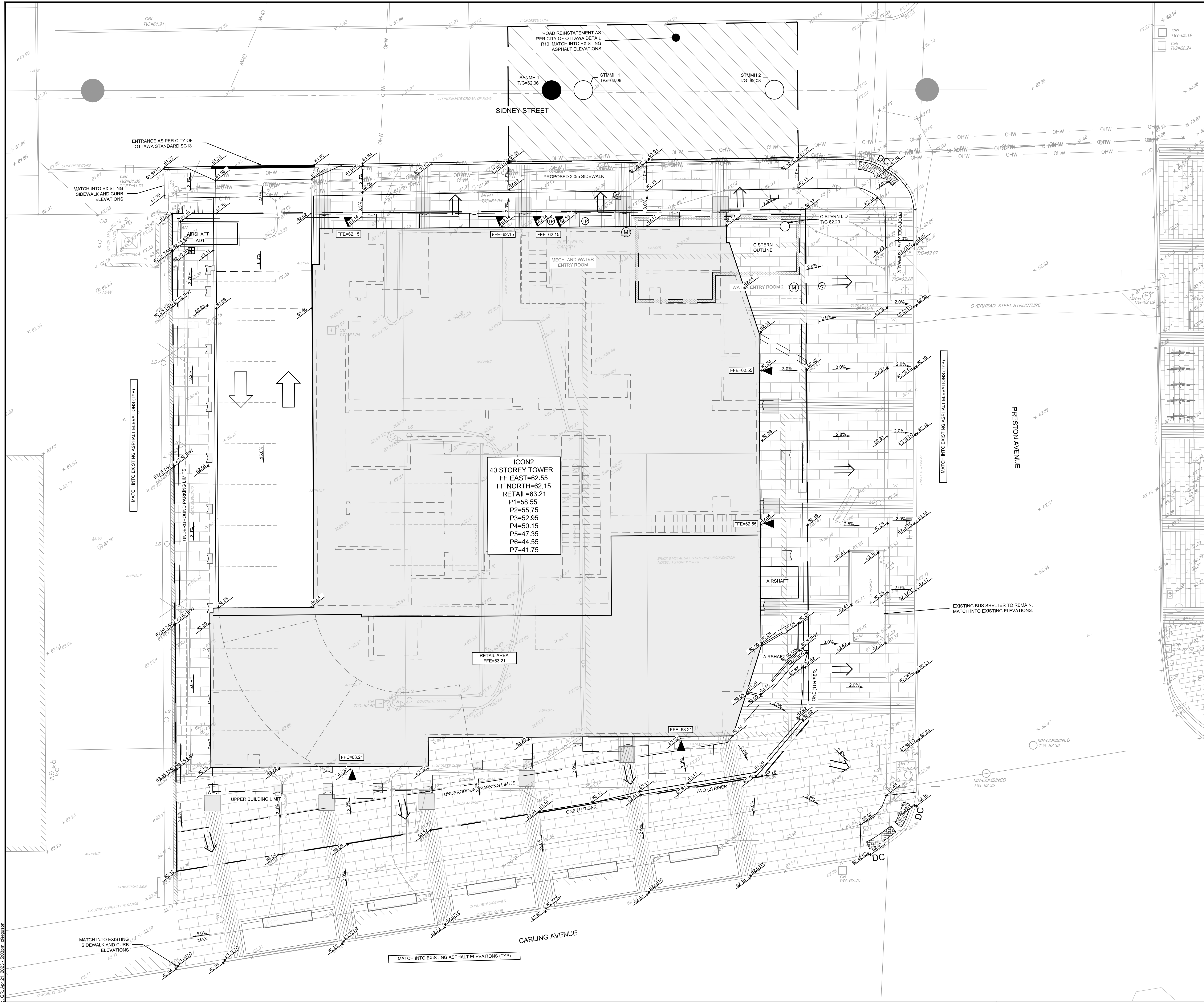

LEGEND

---	PROPERTY LINE	○	PROPOSED SANITARY MANHOLE
DC	PROPOSED DEPRESSION CURB	○	PROPOSED VALVE AND VALVE BOX
96.40	PROPOSED TACTILE WALKING SURFACE INDICATOR (TWS)	○	EXISTING VALVE & VALVE BOX
96.40	PROPOSED ELEVATION	○	EXISTING VALVE & LEAD
97.78AD	PROPOSED AREA DRAIN ELEVATION	○	EXISTING SANITARY MANHOLE
97.78B	PROPOSED TOP OF WALL ELEVATION	○	EXISTING STORM MANHOLE
97.78C	PROPOSED BOTTOM OF WALL ELEVATION	○	EXISTING CATCHBASIN
97.80C	PROPOSED TOP OF CURB ELEVATION	○	EXISTING DITCH CENTERLINE
○	PROPOSED VALVE AND VALVE BOX	○	EXISTING UTILITY POLE
FDSCY	FIRE DEPARTMENT SIAMSE CONNECTION	○	EXISTING UTILITY POLE ANCHORS
▽	PROPOSED BUILDING ENTRANCE	○	EXISTING STREETLIGHT
H.P.	PROPOSED HIGH POINT		
3:1	TERRACING 3:1 SLOPE MAX (UNLESS OTHERWISE INDICATED)		
2.0%	SLOPE AND DIRECTION		
→	DIRECTION OF MAJOR OVERLAND FLOW		
▬	PROPOSED AREA DRAIN		

- GENERAL NOTES:**
- COORDINATE AND SCHEDULE ALL WORK WITH OTHER TRADES AND CONTRACTORS.
 - DETERMINE THE EXACT LOCATION, SIZE, MATERIAL AND ELEVATION OF ALL EXISTING UTILITIES PRIOR TO COMMENCING CONSTRUCTION, PROTECT AND ASSUME RESPONSIBILITY FOR ALL EXISTING UTILITIES WHETHER OR NOT SHOWN ON THIS DRAWING.
 - OBTAIN ALL NECESSARY PERMITS AND APPROVALS FROM THE CITY OF OTTAWA BEFORE COMMENCING CONSTRUCTION.
 - BEFORE COMMENCING CONSTRUCTION OBTAIN AND PROVIDE PROOF OF COMPREHENSIVE, ALL RISK AND OPERATIONAL LIABILITY INSURANCE FOR \$5,000,000.00. INSURANCE POLICY TO NAME OWNERS, ENGINEERS AND ARCHITECTS AS COINSURED.
 - RESTORE ALL DISTURBED AREAS ON-SITE AND OFF-SITE, INCLUDING TRENCHES AND SURFACES ON PUBLIC ROAD ALLOWANCES TO EXISTING CONDITIONS OR BETTER TO THE SATISFACTION OF THE CITY OF OTTAWA AND ENGINEER.
 - REMOVE FROM SITE ALL EXCESS EXCAVATED MATERIAL, ORGANIC MATERIAL AND DEBRIS UNLESS OTHERWISE INSTRUCTED BY ENGINEER. EXCAVATE AND REMOVE FROM SITE ANY CONTAMINATED MATERIAL. ALL CONTAMINATED MATERIAL SHALL BE DISPOSED OF AT A LICENSED LANDFILL FACILITY.
 - ALL ELEVATIONS ARE GEODETIC, CITY OF OTTAWA DENOTED AS PART OF LOTS 1554, 1555, 1556, AND 1557, REGISTERED PLAN 38, CITY OF OTTAWA.
 - REFER TO GEOTECHNICAL REPORT (No. PG5744-1, DATED MAY 12TH, 2021) PREPARED BY PATERSON FOR SUBSURFACE CONDITIONS, CONSTRUCTION RECOMMENDATIONS, AND GEOTECHNICAL INSPECTION REQUIREMENTS. THE GEOTECHNICAL CONSULTANT IS TO REVIEW ON-SITE CONDITIONS AFTER EXCAVATION PRIOR TO PLACEMENT OF THE GRANULAR MATERIAL.
 - REFER TO ARCHITECT'S AND LANDSCAPE ARCHITECT'S DRAWINGS FOR BUILDING AND HARDSURFACE AREAS AND DIMENSIONS.
 - REFER TO SERVICEABILITY AND STORMWATER MANAGEMENT REPORT PREPARED BY NOVATECH ENGINEERING CONSULTANTS LTD. R-2021-055 DATED APRIL 21, 2023.
 - SAW CUT AND KEY GRIND ASPHALT AT ALL ROAD CUTS AND ASPHALT TIE IN POINTS AS PER CITY OF OTTAWA STANDARDS (R10).
 - PROVIDE LINE-PARKING PAINTING.
 - ALL MATERIALS AND CONSTRUCTION METHODS SHALL BE IN ACCORDANCE WITH THE CITY OF OTTAWA STANDARDS AND SPECIFICATIONS AND ONTARIO PROVINCIAL STANDARDS AND SPECIFICATIONS. ONTARIO PROVINCIAL STANDARDS AND SPECIFICATIONS WILL APPLY WHERE NO CITY STANDARDS ARE AVAILABLE.
 - ALL PRIVATE APPROACHES MUST BE CONSTRUCTED AS PER CITY SPECIFICATION SCS13.
 - ALL EXISTING INFRASTRUCTURE (STORM AND SANITARY NETWORK & MANHOLES) ON-SITE TO BE REMOVED.

- GRADING NOTES:**
- ALL TOPSOIL, ORGANIC OR DELETERIOUS MATERIAL MUST BE ENTIRELY REMOVED FROM BENEATH THE PROPOSED PAVED AREAS AS DIRECTED BY THE SITE ENGINEER OR GEOTECHNICAL ENGINEER.
 - EXPOSED SUBGRADES IN PROPOSED PAVED AREAS SHOULD BE PROOF ROLLED WITH A LARGE STEEL DRUM ROLLER AND INSPECTED BY THE GEOTECHNICAL ENGINEER PRIOR TO THE PLACEMENT OF GRANULARS.
 - ANY SOFT AREAS EVIDENT FROM THE PROOF ROLLING SHOULD BE SUB-EXCAVATED AND REPLACED WITH SUITABLE MATERIAL THAT IS FROST COMPATIBLE WITH THE EXISTING SOILS AS RECOMMENDED BY THE GEOTECHNICAL ENGINEER.
 - THE GRANULAR BASE SHOULD BE COMPACTED TO AT LEAST 100% OF THE STANDARD PROCTOR MAXIMUM DRY DENSITY VALUE. ANY ADDITIONAL GRANULAR FILL USED BELOW THE PROPOSED PAVEMENT SHOULD BE COMPACTED TO AT LEAST 98% OF THE STANDARD PROCTOR MAXIMUM DRY DENSITY VALUE.
 - MINIMUM OF 2% GRADE FOR ALL GRASS AREAS UNLESS OTHERWISE NOTED.
 - MAXIMUM TERRACING GRADE TO BE 3:1 UNLESS OTHERWISE NOTED.
 - ALL GRADES BY CURBS ARE EDGE OF PAVEMENT GRADES UNLESS OTHERWISE INDICATED.
 - ALL CURBS SHALL BE BARRIER CURB (150mm) UNLESS OTHERWISE NOTED AND CONSTRUCTED AS PER CITY OF OTTAWA STANDARDS (SC11).
 - REFER TO LANDSCAPE PLAN FOR PLANTING AND OTHER LANDSCAPE FEATURE DETAILS.
 - CONTRACTOR TO PROVIDE THE CONSULTANT WITH A GRADING PLAN INDICATING AS-BUILT ELEVATIONS OF ALL DESIGN GRADES SHOWN ON THIS PLAN.

**ICON2
40 STOREY TOWER**
 FF EAST=62.55
 FF NORTH=62.15
 RETAIL=63.21
 P1=58.55
 P2=55.75
 P3=52.95
 P4=50.15
 P5=47.35
 P6=44.55
 P7=41.75

NOTE:
 THE POSITION OF ALL POLE LINES, CONDUITS, WATERMANS, SEWERS AND OTHER UNDERGROUND AND OVERGROUND UTILITIES AND STRUCTURES IS NOT NECESSARILY SHOWN ON THE CONTRACT DRAWINGS, AND WHERE SHOWN, THE ACCURACY OF THE POSITION OF SUCH UTILITIES AND STRUCTURES IS NOT GUARANTEED. BEFORE STARTING WORK, DETERMINE THE EXACT LOCATION OF ALL SUCH UTILITIES AND STRUCTURES AND ASSUME ALL LIABILITY FOR DAMAGE TO THEM.

**NOT FOR
CONSTRUCTION**

CLARIDGE HOMES
 CLARIDGE HOMES
 505 PRESTON STREET,
 OTTAWA, ONTARIO
 K1S 4N7.

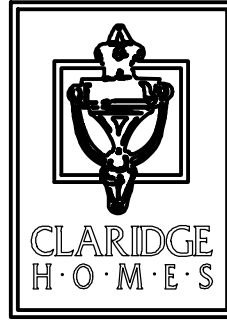

No.	REVISION	DATE	BY
4.	ISSUED FOR ZBA AND SPA	APRIL 21/23	GJM
3.	ISSUED FOR COORDINATION	JUL 13/22	CJF
2.	ISSUED WITH SITE PLAN APPLICATION	APR 15/21	JAG
1.	ISSUED FOR PRELIMINARY COORDINATION	FEB 9/21	JAG

SCALE

1:100

FOR REVIEW ONLY	
CHECKED	CJF
DRAWN	GJM
CHECKED	CJF
DRAWN	GJM
APPROVED	GJM

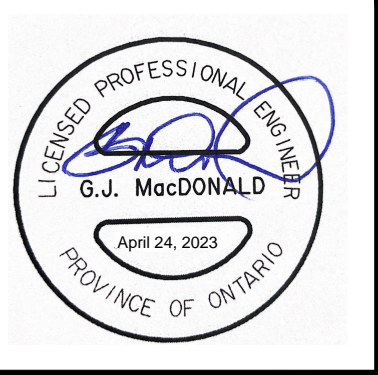

NOVATECH
 Engineers, Planners & Landscape Architects
 Suite 200, 240 Michael Cowpland Drive
 Ottawa, Ontario, Canada K2M 1P6
 Telephone: (613) 254-9643
 Facsimile: (613) 254-5867
 Website: www.novatech-eng.com

LOCATION CITY OF OTTAWA ICON2 - 829 CARLING AVE.	PROJECT No. 121008
DRAWING NAME GRADING PLAN	REV # 4
	DRAWING No. 121008-GR

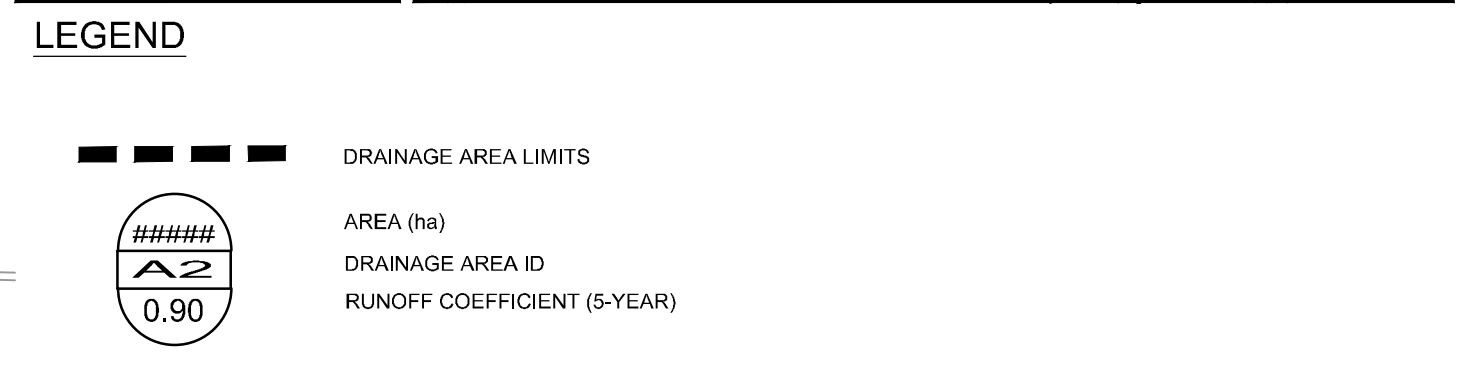
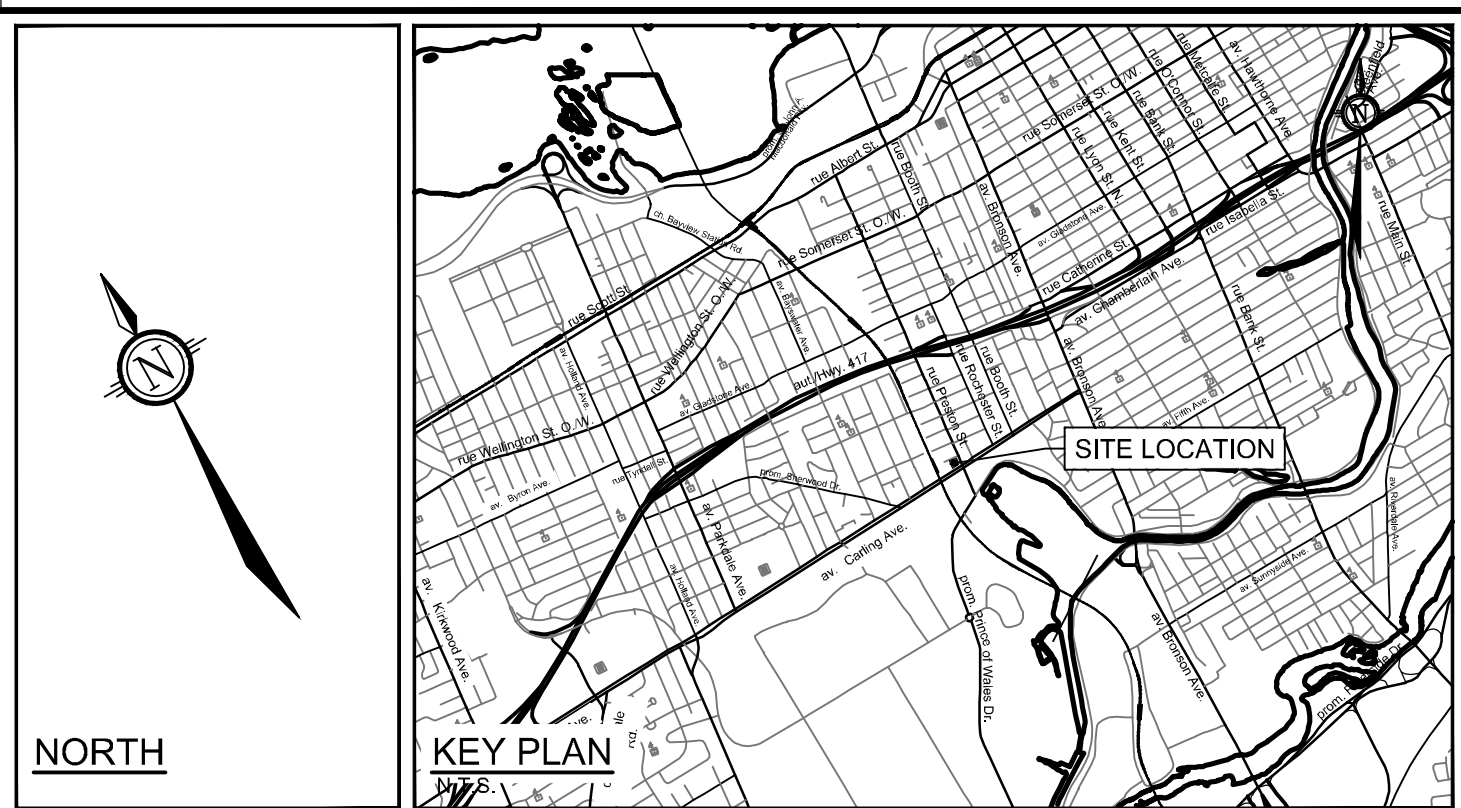
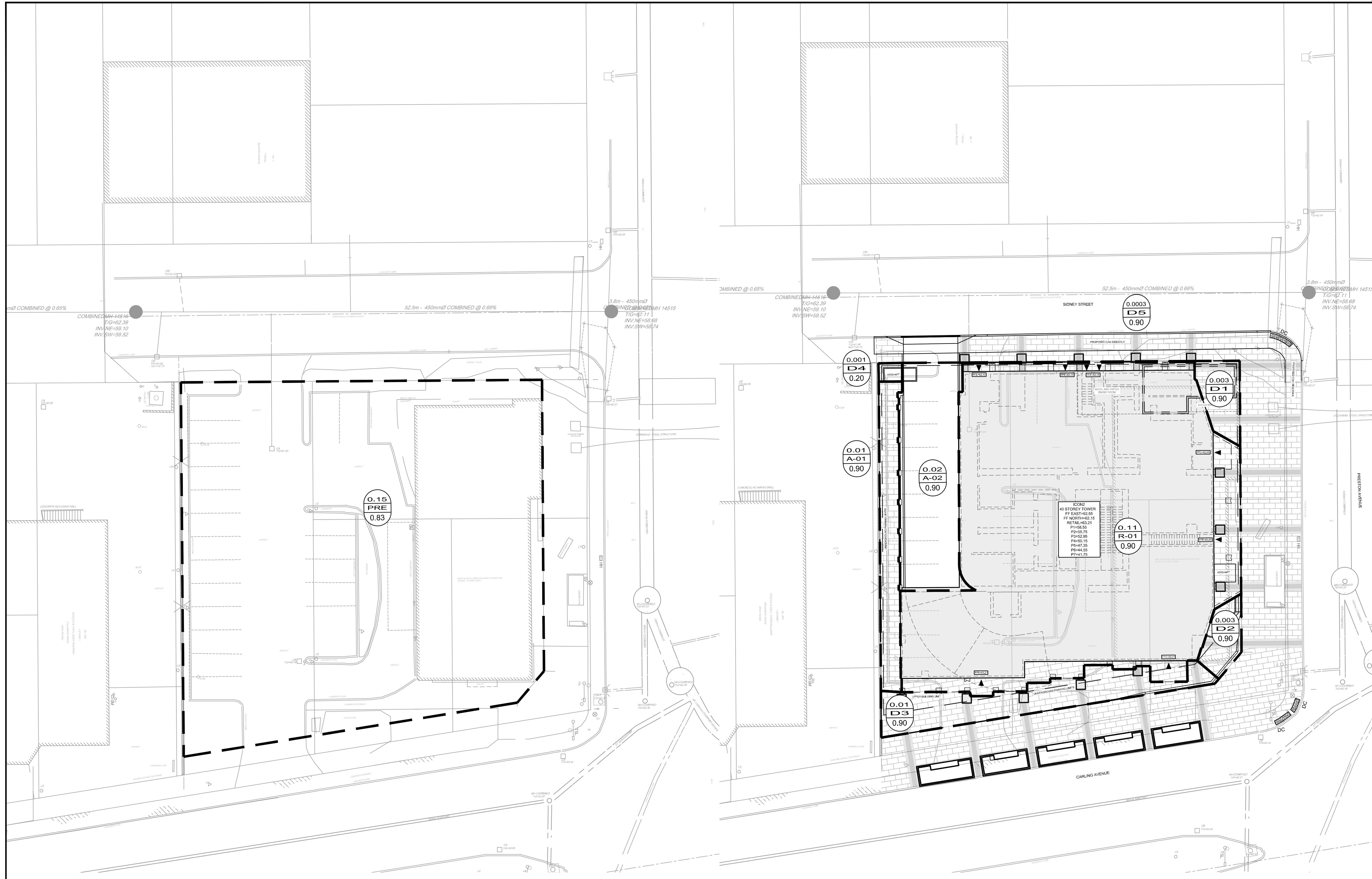

NOTES

STORMWATER MANAGEMENT NOTES:

- REFER TO 'SERVICEABILITY AND STORMWATER MANAGEMENT REPORT' PREPARED BY NOVATECH ENGINEERING CONSULTANTS LTD (DATED APRIL, 21 2023)
- NO ROOF TOP CONTROL ACCOUNTED FOR.

PRE-DEVELOPMENT STORMWATER PLAN

POST-DEVELOPMENT STORMWATER PLAN

NOTE:
THE POSITION OF ALL POLE LINES, CONDUITS, WATERMANS, SEWERS AND OTHER UNDERGROUND AND OVERGROUND UTILITIES AND STRUCTURES IS NOT NECESSARILY SHOWN ON THE CONTRACT DRAWINGS, AND WHERE SHOWN, THE ACCURACY OF THE POSITION OF SUCH UTILITIES AND STRUCTURES IS NOT GUARANTEED. BEFORE STARTING WORK, DETERMINE THE EXACT LOCATION OF ALL SUCH UTILITIES AND STRUCTURES AND ASSUME ALL LIABILITY FOR DAMAGE TO THEM.

CLARIDGE HOMES
CLARIDGE HOMES
SUITE 2001,
210 GLADSTONE AVENUE,
OTTAWA, ONTARIO
K2P 0Y6.



No.	REVISION	DATE	BY
3	ISSUED FOR ZBA AND SPA	APRIL 21/23	GJM
2	ISSUED FOR COORDINATION	JUL 13/22	CJF
1	ISSUED WITH SITE PLAN APPLICATION	APR 15/21	GJM

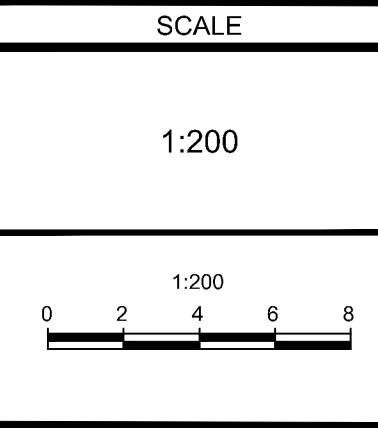

FOR REVIEW ONLY	FOR REVIEW ONLY
DESIGN: CJF	DESIGN: CJF
CHECKED: GJM	CHECKED: GJM
DRAWN: CJF	DRAWN: GJM
APPROVED: GJM	APPROVED: GJM

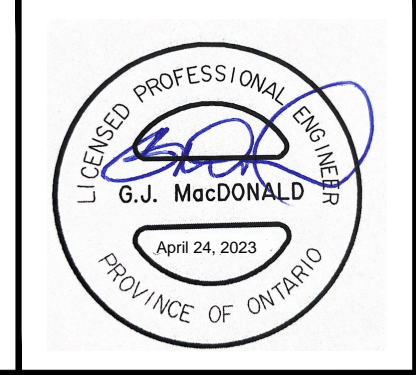

NOVATECH
Engineers, Planners & Landscape Architects
Suite 200, 240 Michael Cowpland Drive
Ottawa, Ontario, Canada K2M 1P6
Telephone: (613) 254-9643
Facsimile: (613) 254-5867
Website: www.novatech-eng.com

LOCATION CITY OF OTTAWA 1CON2 - 829 CARLING AVE.	DRAWING NAME STORMWATER MANAGEMENT PLAN	PROJECT No. 121008
		REV # 3
		DRAWING No. 121008-STM

C:\0201\121008\02\Design\121008-STM.dwg, STM, Apr 24, 2023, 10:22am, claridge

DOT-12-21-0087 # 18581

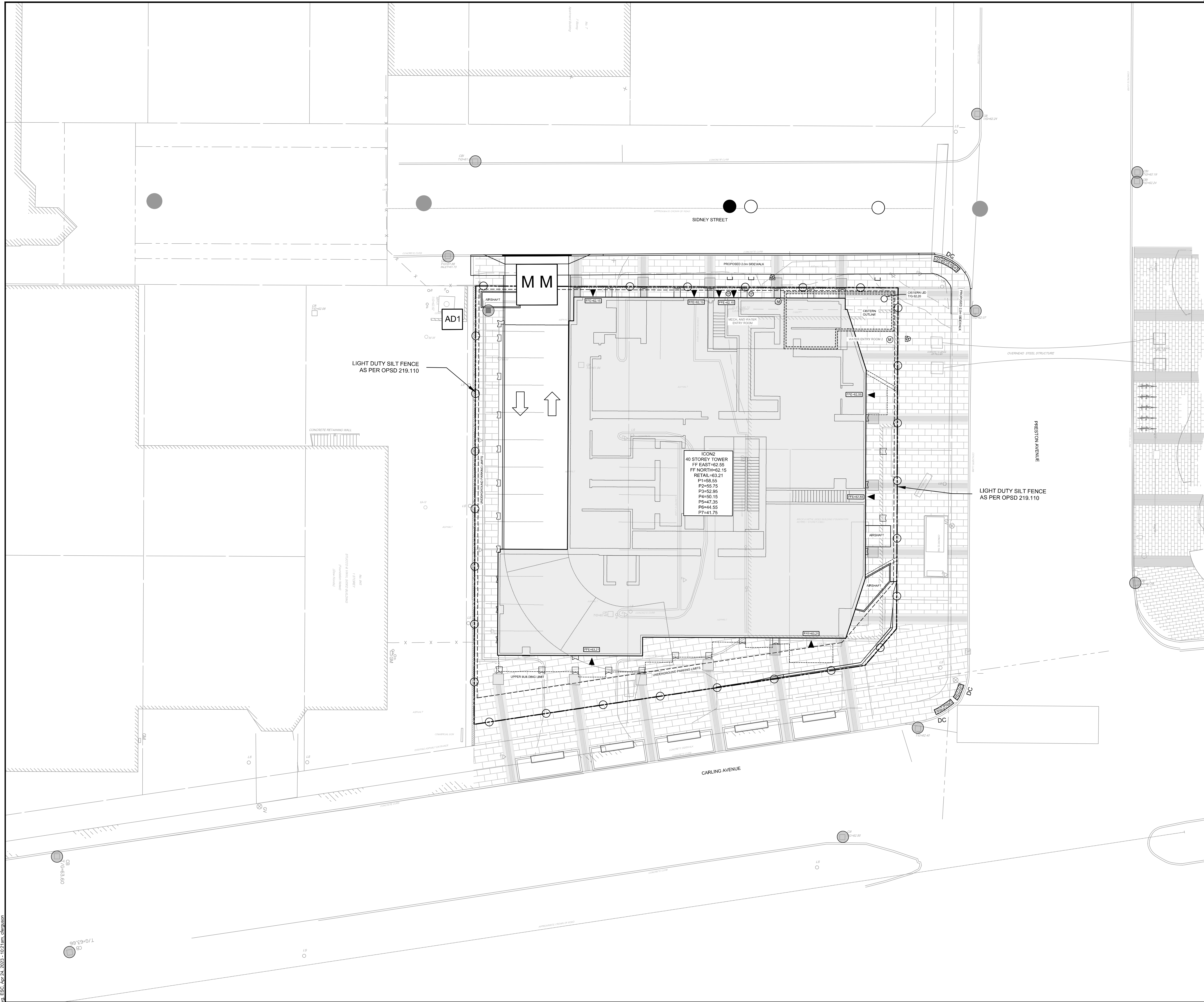

ICON2
40 STOREY TOWER
FF EAST=62.55
FF NORTH=62.15
RETAIL=63.21
P1=50.55
P2=53.75
P3=52.96
P4=50.16
P5=47.35
P6=44.55
P7=41.75

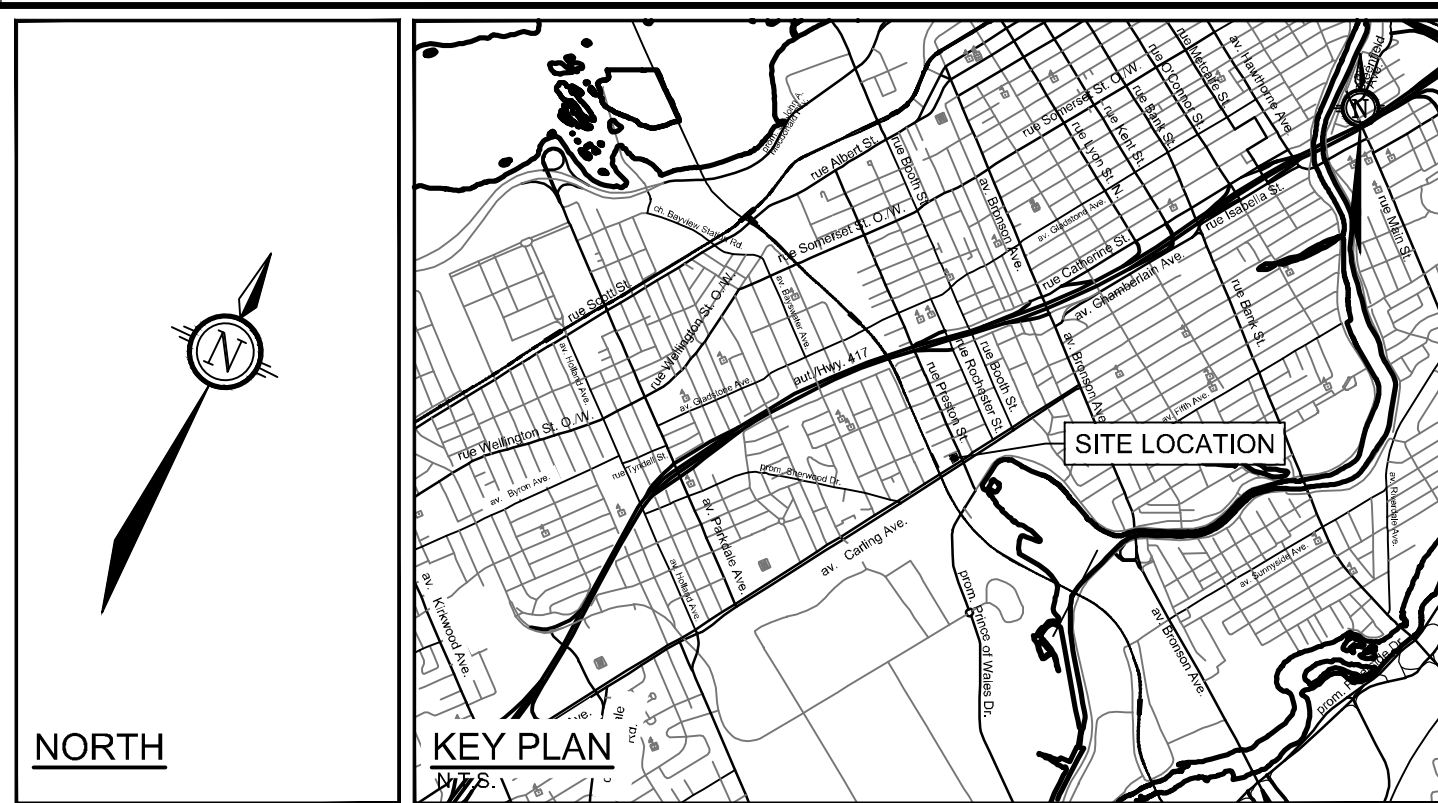

- LEGEND**
- PROPERTY LINE
 - PROPOSED CURB
 - DC PROPOSED DEPRESSED CURB
 - TACTILE WALKING SURFACE INDICATOR (TWSI) PER CITY DETAIL SCT.3
 - MM PROPOSED MUD MAT
 - LIGHT DUTY SILT FENCE (OPSD 219.110)
 - PROPOSED FILTER BAGS AT CATCHBASINS, CATCHBASIN MANHOLES AND TRENCHDRAINS
 - PROPOSED CAP
 - PROPOSED STORM SEWER AND MANHOLE
 - PROPOSED AREA DRAIN
 - PROPOSED TRENCH DRAIN
 - PROPOSED BUILDING ENTRANCE
 - EXISTING STORM MANHOLE
 - EXISTING CATCHBASIN
 - EXISTING LIGHT STANDARD
 - EXISTING FENCE

- EROSION AND SEDIMENT CONTROL NOTES:**
- THE CONTRACTOR SHALL IMPLEMENT BEST MANAGEMENT PRACTICES, TO PROVIDE FOR PROTECTION OF THE AREA DRAINAGE SYSTEM AND THE RECEIVING WATERCOURSE. DURING CONSTRUCTION ACTIVITIES, THE CONTRACTOR ACKNOWLEDGES THAT FAILURE TO IMPLEMENT APPROPRIATE EROSION AND SEDIMENT CONTROL MEASURES MAY BE SUBJECT TO PENALTIES IMPOSED BY ANY APPLICABLE REGULATORY AGENCY.
- 1) THE OWNER AGREES TO PREPARE AND IMPLEMENT AN EROSION AND SEDIMENT CONTROL PLAN TO THE SATISFACTION OF THE CITY OF OTTAWA, APPROPRIATE TO THE SITE CONDITIONS, PRIOR TO UNDERTAKING ANY SITE ALTERATIONS (FILLING, GRADING, REMOVAL OF VEGETATION, ETC.) AND DURING ALL PHASES OF SITE PREPARATION AND CONSTRUCTION IN ACCORDANCE WITH THE CURRENT BEST MANAGEMENT PRACTICES FOR EROSION AND SEDIMENT CONTROL SUCH AS BUT NOT LIMITED TO INSTALLING FILTER CLOTHS ACROSS MANHOLE/CATCHBASIN LIDS TO PREVENT SEDIMENTS FROM ENTERING STRUCTURES AND INSTALL AND MAINTAIN A LIGHT DUTY SILT FENCE BARRIER AS REQUIRED.
 - 2) THE CONTRACTOR SHALL PLACE FILTER BAGS UNDER THE CATCHBASIN AND MANHOLE GRATES FOR THE DURATION OF CONSTRUCTION AND WILL REMAIN IN PLACE DURING ALL PHASES OF CONSTRUCTION.
 - 3) SILT FENCING FOR ENTIRE PERIMETER OF SITE, SHALL BE UTILIZED TO CONTROL EROSION FROM THE SITE DURING CONSTRUCTION.
 - 4) THE CONTRACTOR ACKNOWLEDGES THAT FAILURE TO IMPLEMENT EROSION AND SEDIMENT CONTROL MEASURES MAY BE SUBJECT TO PENALTIES IMPOSED BY ANY APPLICABLE REGULATORY AGENCY.
 - 5) PROVIDE MUD MATS AT ALL CONSTRUCTION ACCESS POINTS TO MINIMIZE SEDIMENT TRANSPORT OFFSITE.
 - 6) EROSION AND SEDIMENT CONTROL MEASURES MAY BE MODIFIED IN THE FIELD AT THE DISCRETION OF THE CITY OF OTTAWA SITE INSPECTOR OR CONSERVATION AUTHORITY.

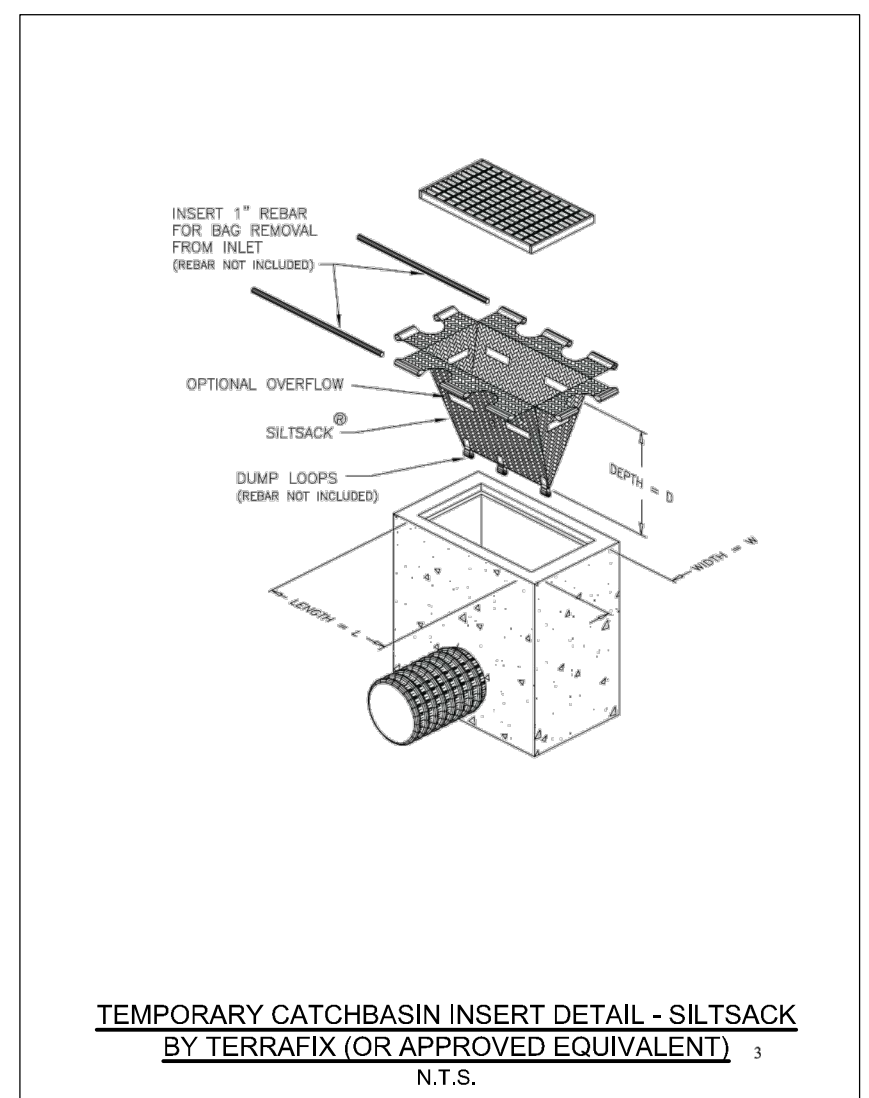
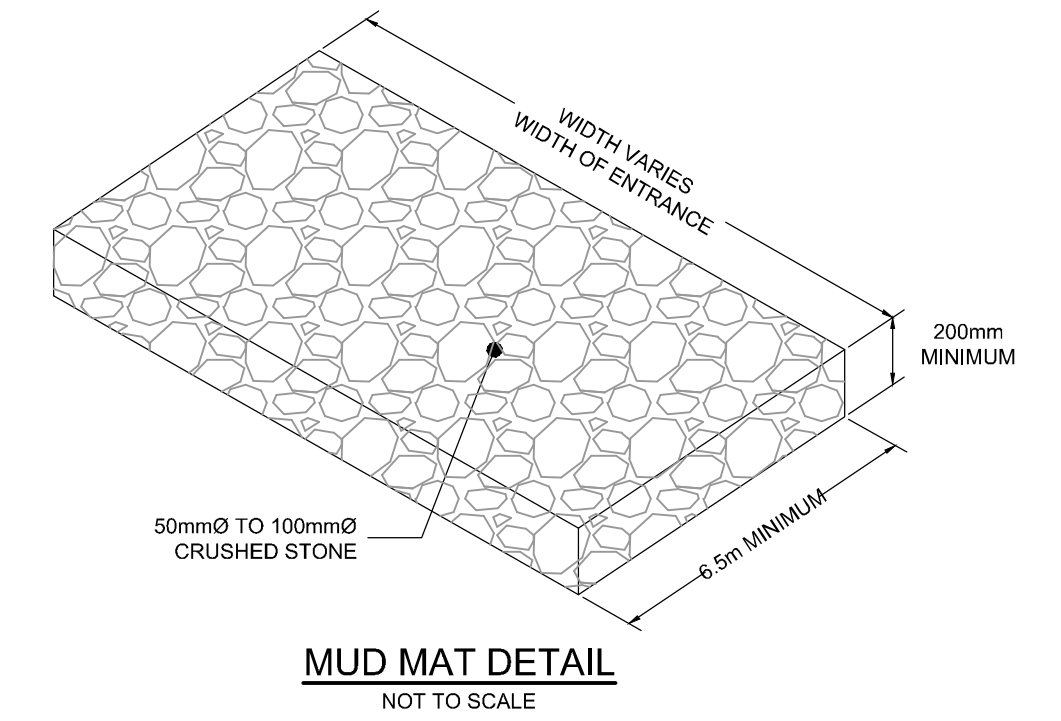

NOTE:
THE POSITION OF ALL POLE LINES, CONDUITS, WATERMANS, SEWERS AND OTHER UNDERGROUND AND OVERGROUND UTILITIES AND STRUCTURES IS NOT NECESSARILY SHOWN ON THE CONTRACT DRAWINGS, AND WHERE SHOWN, THE ACCURACY OF THE POSITION OF SUCH UTILITIES AND STRUCTURES IS NOT GUARANTEED. BEFORE STARTING WORK, DETERMINE THE EXACT LOCATION OF ALL SUCH UTILITIES AND STRUCTURES AND ASSUME ALL LIABILITY FOR DAMAGE TO THEM.

CLARIDGE HOMES
CLARIDGE HOMES
505 PRESTON STREET,
OTTAWA, ONTARIO
K1S 4N7.

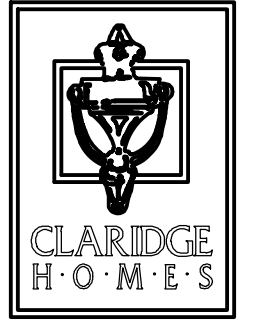

No.	REVISION	DATE	BY
1.	ISSUED FOR ZBA AND SPA	APRIL 21/23	GJM

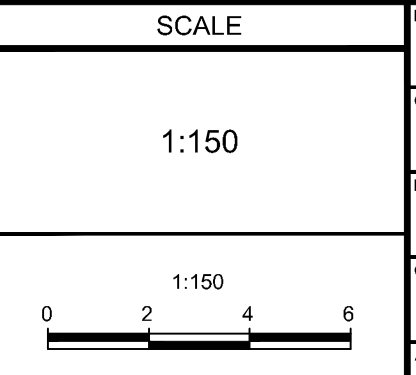

DESIGN	FOR REVIEW ONLY
CHECKED C.J.F.	
DRAWN G.J.M.	
CHECKED C.J.F.	
APPROVED G.J.M.	
APPROVED G.J.M.	



NOVATECH
Engineers, Planners & Landscape Architects
Suite 200, 240 Michael Cowpland Drive
Ottawa, Ontario, Canada K2M 1P6
Telephone: (613) 254-9643
Facsimile: (613) 254-5867
Website: www.novatech-eng.com

LOCATION
CITY OF OTTAWA
ICON2 - 829 CARLING AVE.
DRAWING NAME
EROSION AND SEDIMENT CONTROL PLAN

PROJECT No.	REV	REV #	DRAWING No.
121008		1	121008-ESC

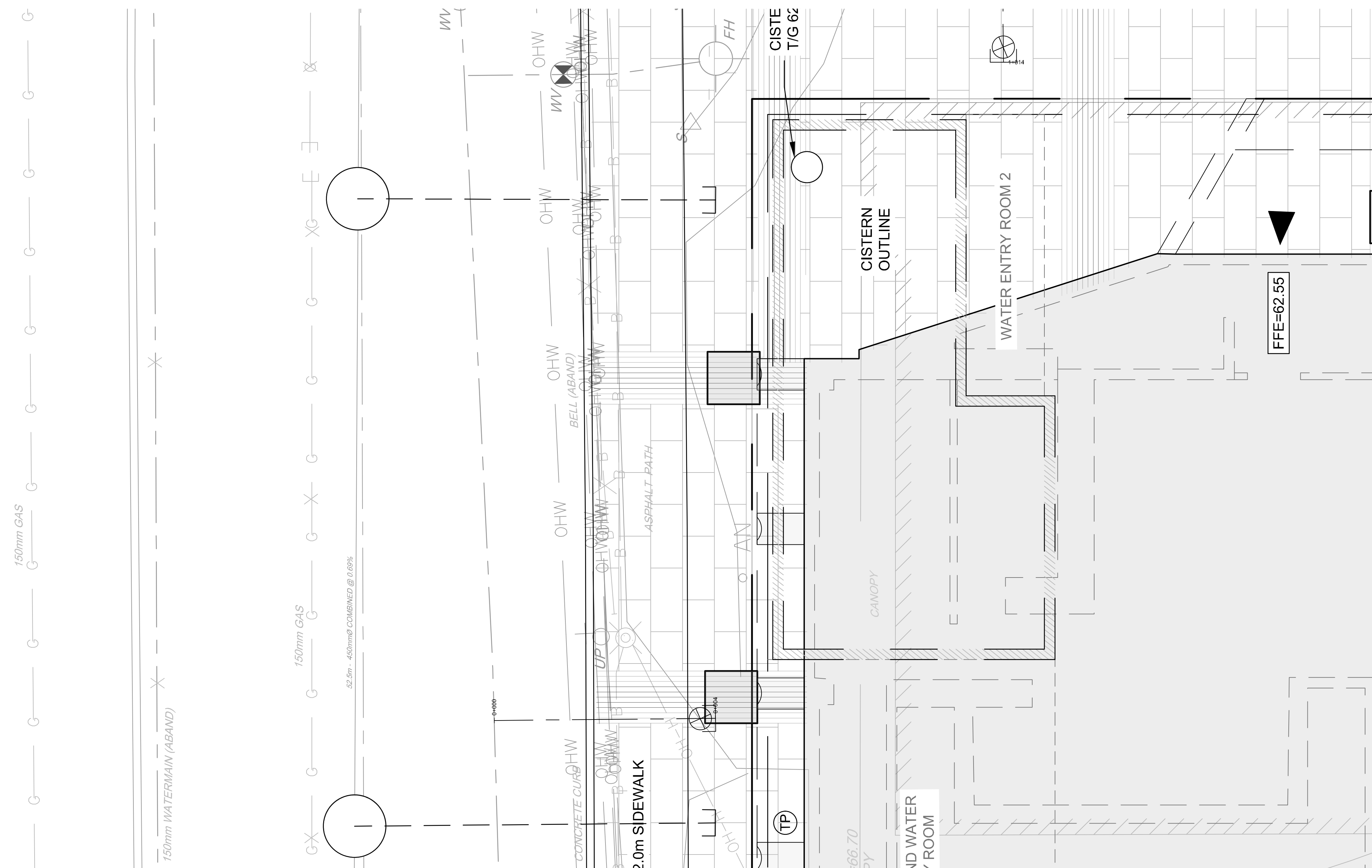
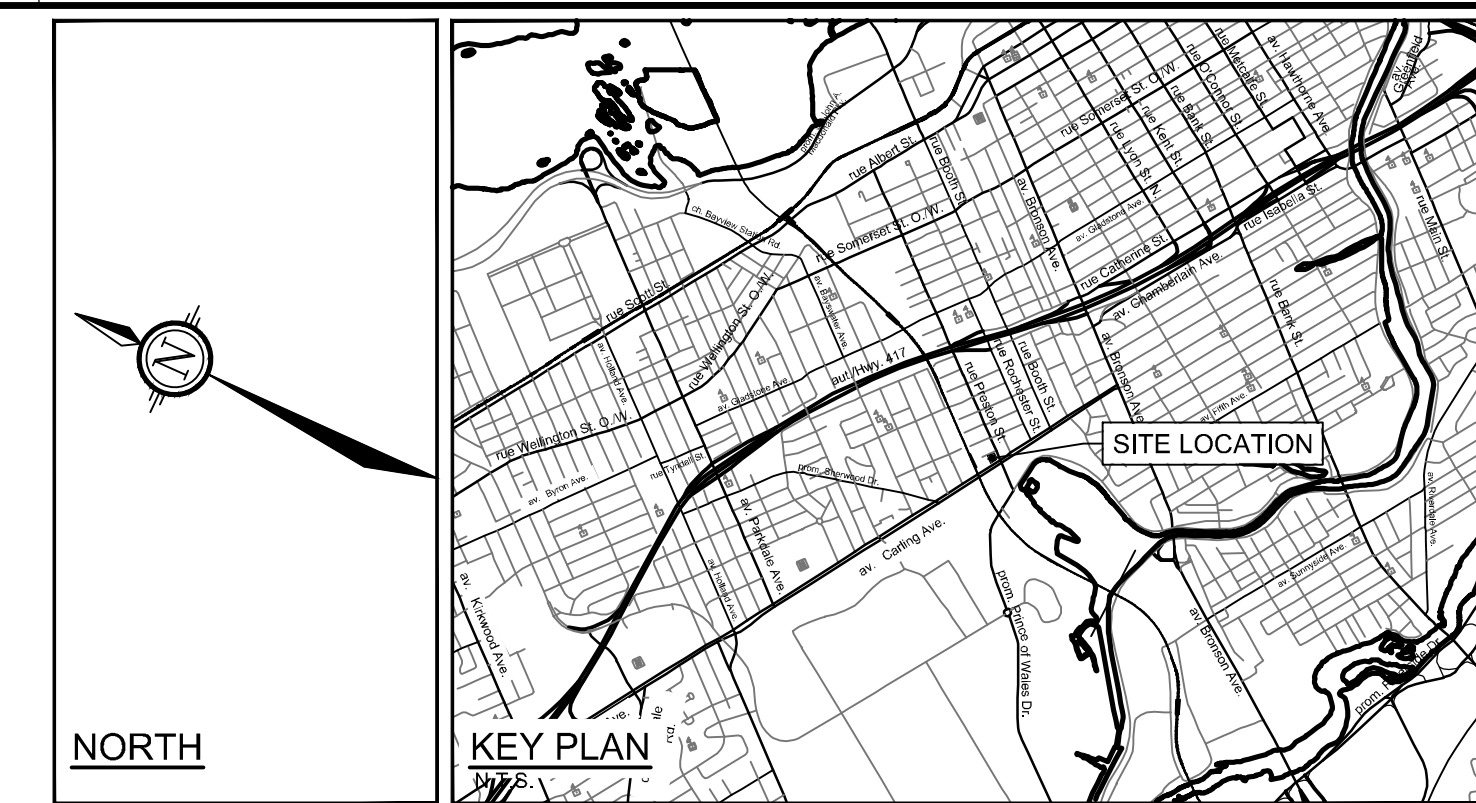

GP CISTERN PLAN 1:50

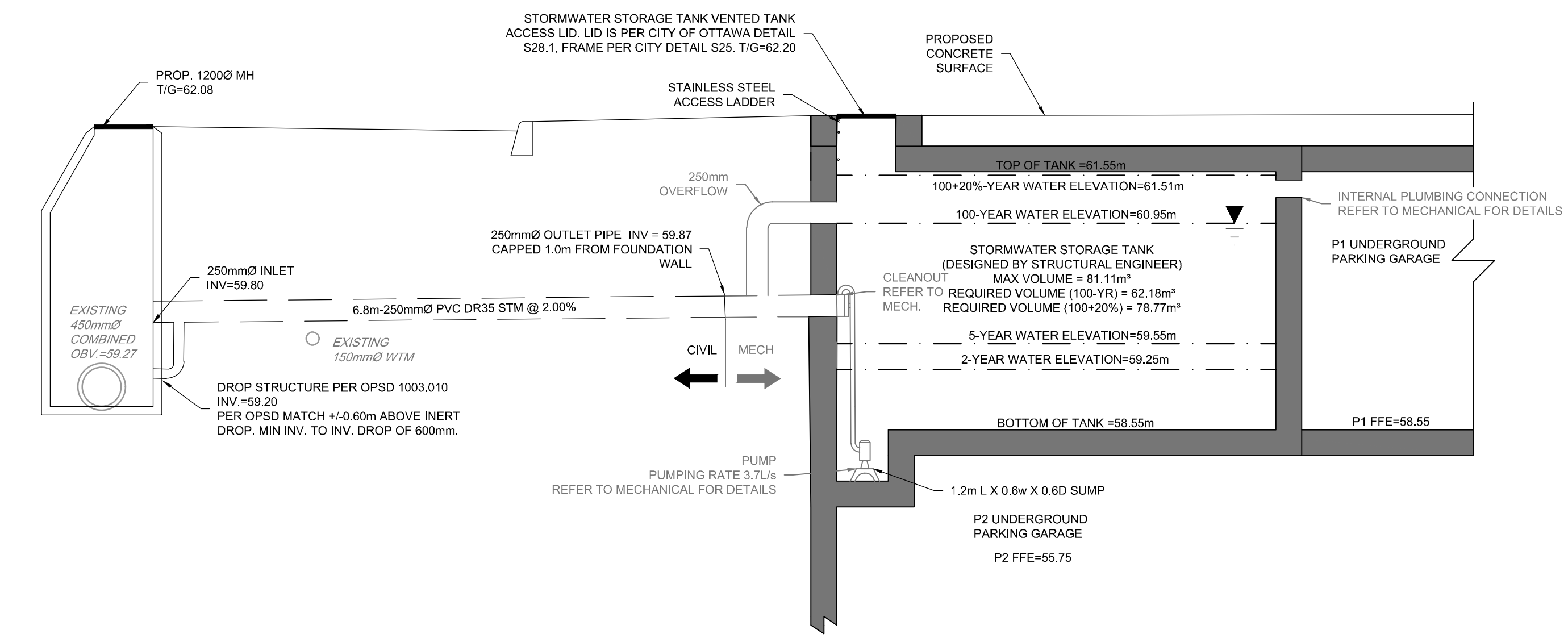

GP CISTERN PROFILE NTS

NOTE:
THE POSITION OF ALL POLE LINES, CONDUITS,
WATERMANS, SEWERS AND OTHER
UNDERGROUND AND OVERGROUND UTILITIES AND
STRUCTURES IS NOT NECESSARILY SHOWN ON
THE CONTRACT DRAWINGS, AND WHERE SHOWN,
THE ACCURACY OF THE POSITION OF SUCH
UTILITIES AND STRUCTURES IS NOT GUARANTEED.
BEFORE STARTING WORK, DETERMINE THE EXACT
LOCATION OF ALL SUCH UTILITIES AND
STRUCTURES AND ASSUME ALL LIABILITY FOR
DAMAGE TO THEM.

**NOT FOR
CONSTRUCTION**

CLARIDGE HOMES
CLARIDGE HOMES
505 PRESTON STREET,
OTTAWA, ONTARIO
K1S 4N7.



No.	REVISION	DATE	BY
1.	ISSUED FOR ZBA AND SPA	APRIL 21/23	GJM

SCALE	DESIGN
AS SHOWN	CJF
	GJM
	CJF
	GJM
	GJM

FOR REVIEW ONLY	
DESIGN	CJF
CHECKED	GJM
DRAWN	CJF
CHECKED	GJM
APPROVED	GJM

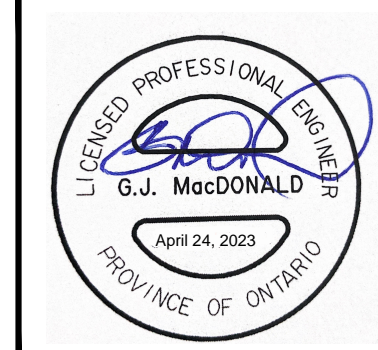

NOVATECH
Engineers, Planners & Landscape Architects
Suite 200, 240 Michael Cowpland Drive
Ottawa, Ontario, Canada K2M 1P6
Telephone (613) 254-9643
Facsimile (613) 254-5867
Website www.novatech-eng.com

LOCATION
CITY OF OTTAWA
ICON2 - 829 CARLING AVE.
DRAWING NAME
CISTERN DETAIL PLAN

PROJECT No.	REV	REV # 1	DRAWING No.
121008			121008-CIS

C:\Users\121008\OneDrive\121008\GP - 121008-CIS - Apr 24, 2023 - 11:38am - dmp.dwg

DOT-12-21-0087