



RICHCRAFT TRAILEDGE PHASE 5



LIST OF DRAWINGS:

- ST1 - PRELIMINARY STREETScape PLAN
- ST2 - PRELIMINARY STREETScape PLAN
- ST3 - PRELIMINARY STREETScape PLAN
- ST4 - PRELIMINARY STREETScape PLAN
- ST5 - PRELIMINARY STREETScape PLAN
- ST6 - PRELIMINARY STREETScape PLAN
- ST7 - PRELIMINARY STREETScape PLAN

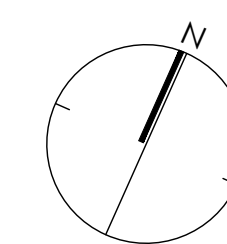
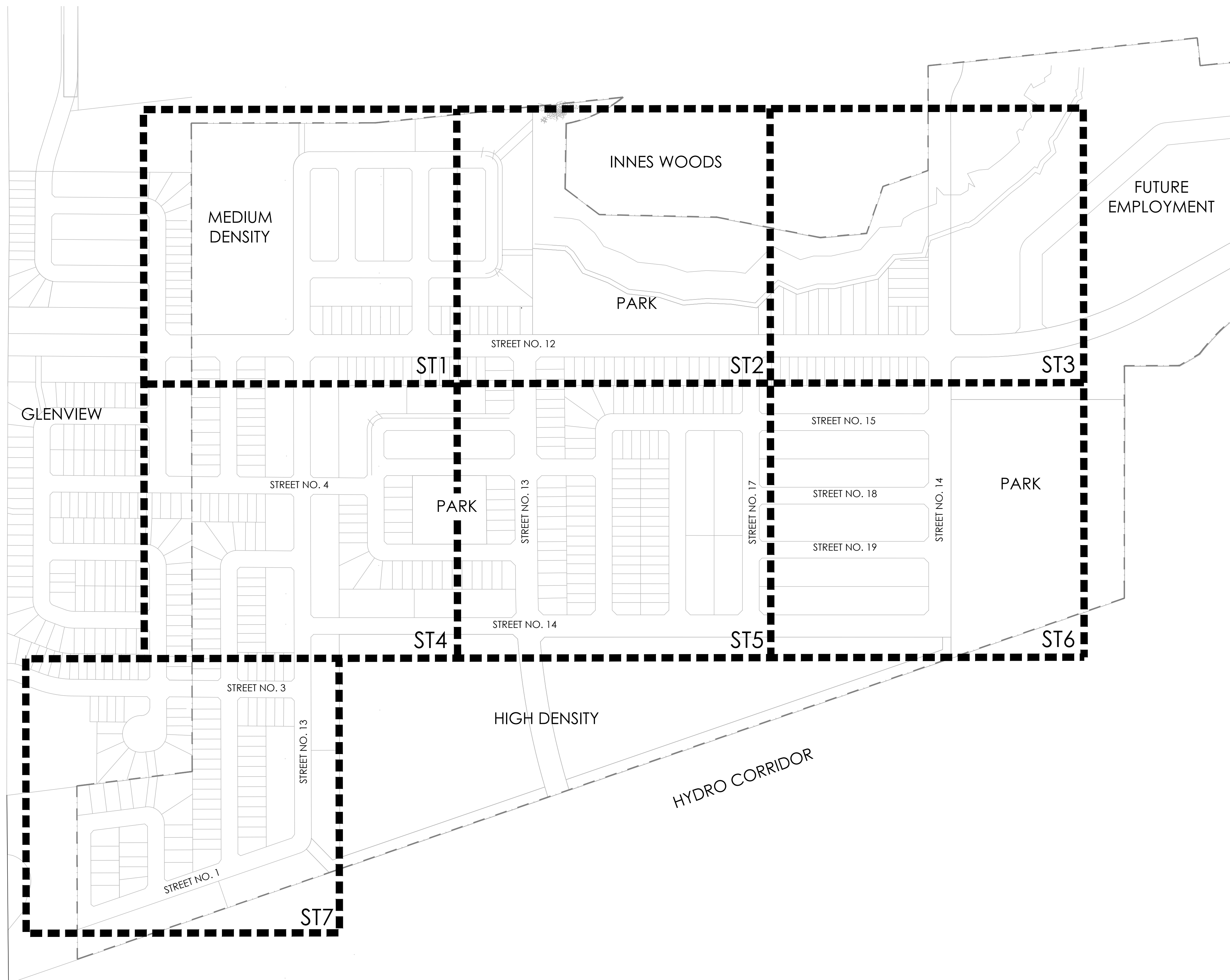

KEYMAP
NTS

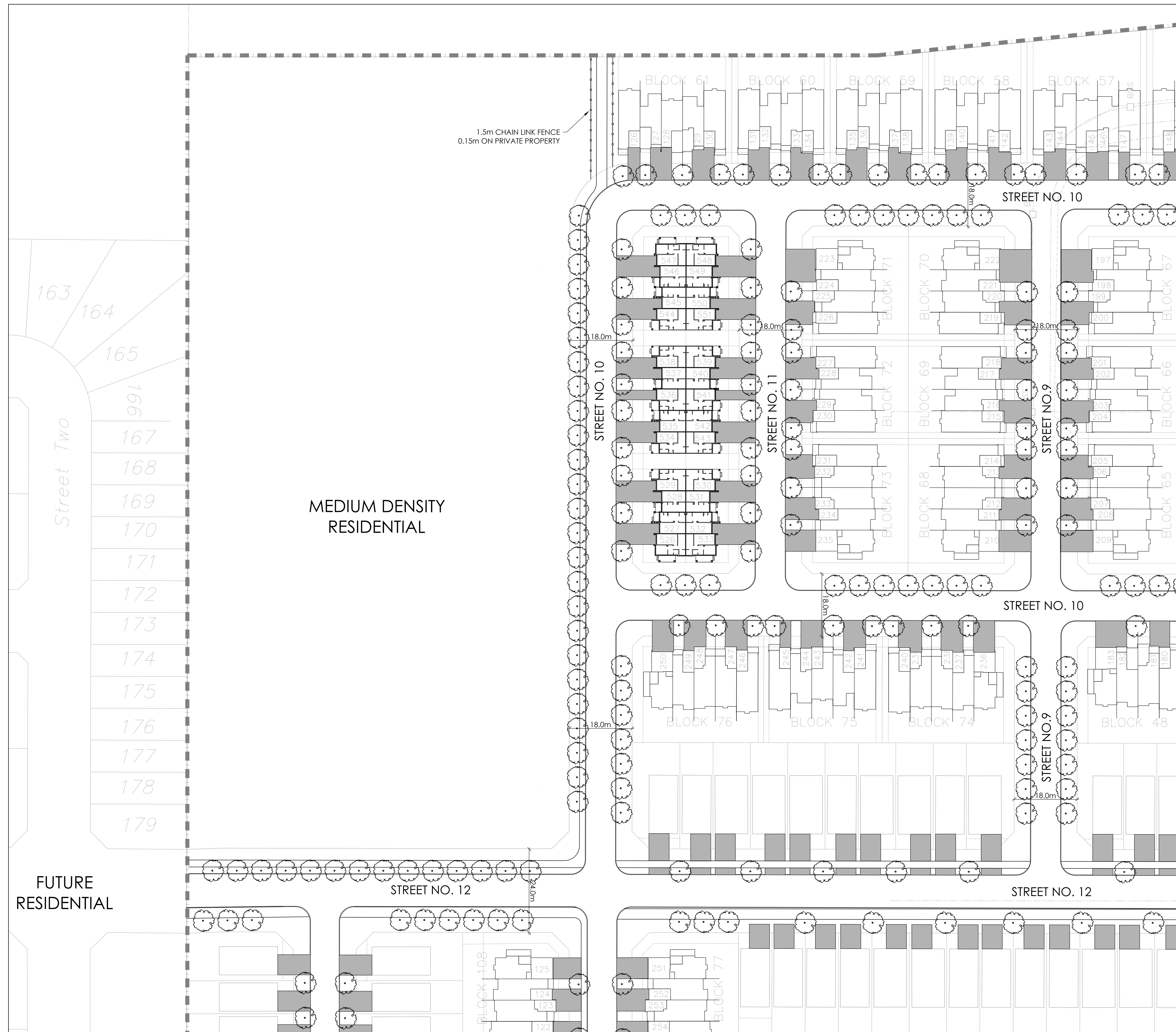

STREET TREE REQUIREMENT:

1 TREE PER INTERIOR (NON-CORNER) LOTS
2 TREES PER EXTERIOR (CORNER) LOTS

INTERIOR (NON-CORNERS) SINGLE LOTS (888): 888 TREES
EXTERIOR (CORNERS) SINGLE LOTS (95): 190 TREES

TOTAL NUMBER OF TREES REQUIRED: 1078
NUMBER OF STREET TREES SHOWN ON PLAN: 1078
NUMBER OF WALKWAY BLOCK TREES: 0
TOTAL ROW TREES SHOWN IN AREA PARKS PLAN: 61
TOTAL NUMBER OF TREES ON PLAN: 1078

* PRELIMINARY - SUBJECT TO CHANGE DURING DETAILED DESIGN AND SITE PLAN CONTROL APPLICATIONS.

No.	Description	Date
2	Revised as per city comments	SEPT, 08/22
1	Issued for Client Review	MAY 07/21

Revision

City Approval Stamp

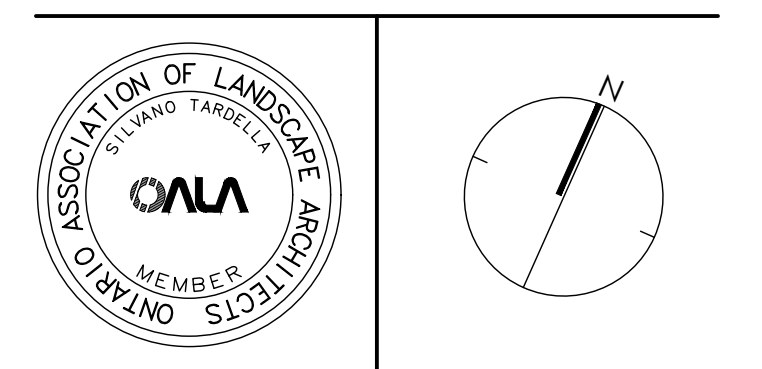

NAK design strategies

1285 WELLINGTON STREET, OTTAWA, ON K1Y 3A8 CANADA
T 613.237.2345 F 613.237.4423 NAKDESIGNSTRATEGIES.COM

Trailsedge Phase 5
Orleans, ON

Title
Preliminary Streetscape Plan

Date	May 2021	Sheet	ST1
Scale	1:500		
Drawn	CP		
Checked	LS		
Job No.	21-116		

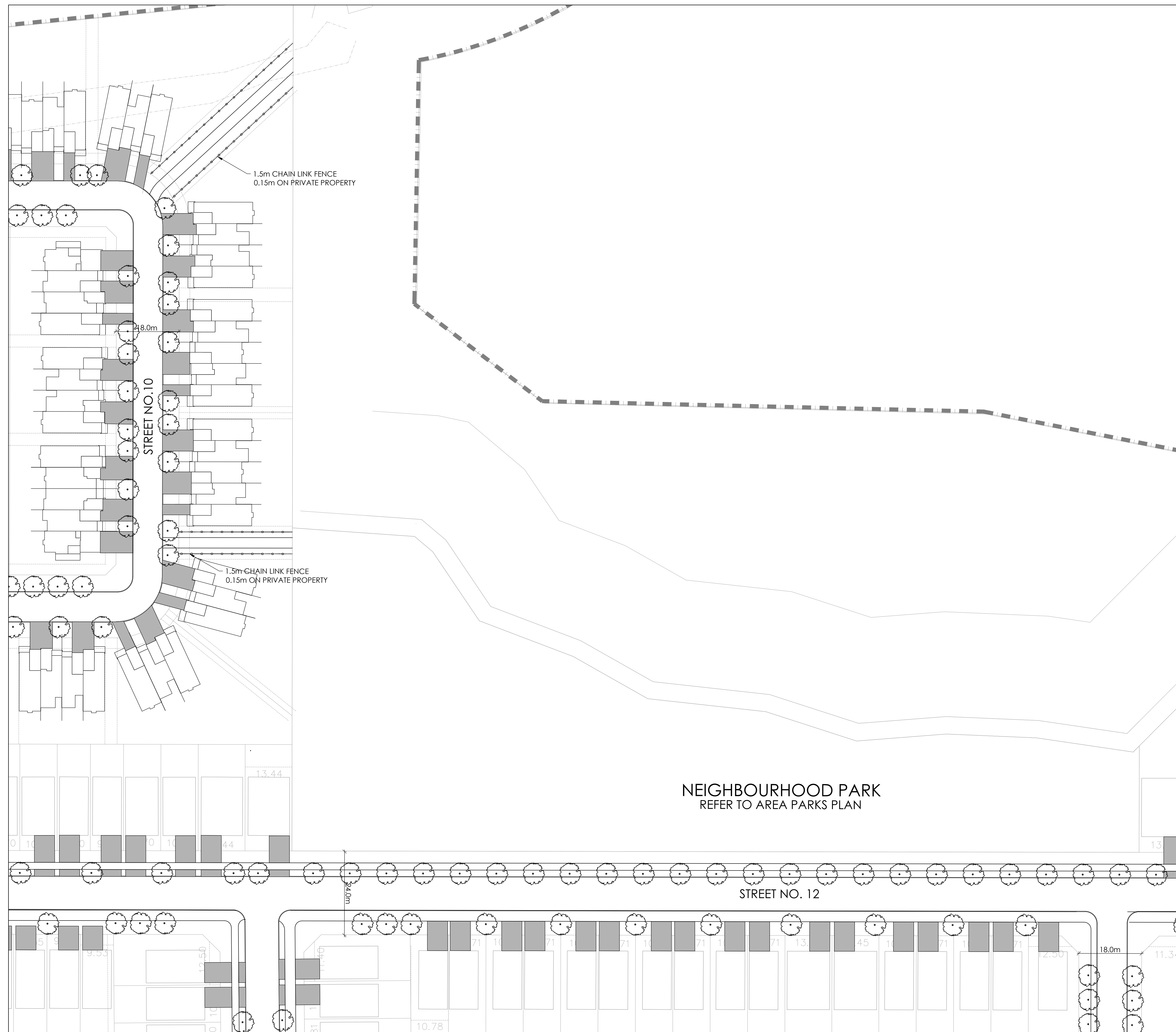

STREET TREE REQUIREMENT:

1 TREE PER INTERIOR (NON-CORNER) LOTS
 2 TREES PER EXTERIOR (CORNER) LOTS

INTERIOR (NON- CORNERS) SINGLE LOTS (888): 888 TREES
 EXTERIOR (CORNERS) SINGLE LOTS (95): 190 TREES

TOTAL NUMBER OF TREES REQUIRED: 1078
 NUMBER OF STREET TREES SHOWN ON PLAN: 1078
 NUMBER OF WALKWAY BLOCK TREES: 0
 TOTAL ROW TREES SHOWN IN AREA PARKS PLAN: 61
 TOTAL NUMBER OF TREES ON PLAN: 1078

* PRELIMINARY - SUBJECT TO CHANGE DURING DETAILED DESIGN AND SITE PLAN CONTROL APPLICATIONS.

No.	Description	Date
2	Revised as per city comments	SEPT, 08/22
1	Issued for Client Review	MAY 07/21
Revision		
City Approval Stamp		

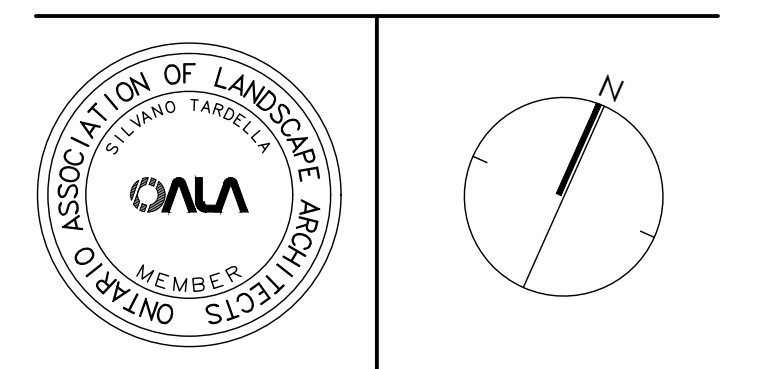

NAK design strategies

1285 WELLINGTON STREET, OTTAWA, ON K1Y 3A8 CANADA
 T 613.237.2345 F 613.237.4423 NAKDESIGNSTRATEGIES.COM

Trailside Phase 5
 Orleans, ON

Title
 Preliminary Streetscape Plan

Date	May 2021	Sheet	ST2
Scale	1:500		
Drawn	CP		
Checked	LS		
Job No.	21-116		



STREET TREE REQUIREMENT:

1 TREE PER INTERIOR (NON-CORNER) LOTS
 2 TREES PER EXTERIOR (CORNER) LOTS

INTERIOR (NON-CORNERS) SINGLE LOTS (888): 888 TREES
 EXTERIOR (CORNERS) SINGLE LOTS (95): 190 TREES

TOTAL NUMBER OF TREES REQUIRED:	1078
NUMBER OF STREET TREES SHOWN ON PLAN:	1078
NUMBER OF WALKWAY BLOCK TREES:	0
TOTAL ROW TREES SHOWN IN AREA PARKS PLAN:	61
TOTAL NUMBER OF TREES ON PLAN:	1078

* PRELIMINARY - SUBJECT TO CHANGE DURING DETAILED DESIGN AND SITE PLAN CONTROL APPLICATIONS.

No.	Description	Date
2	Revised as per city comments	SEPT, 08/22
1	Issued for Client Review	MAY 07/21

Revision

City Approval Stamp

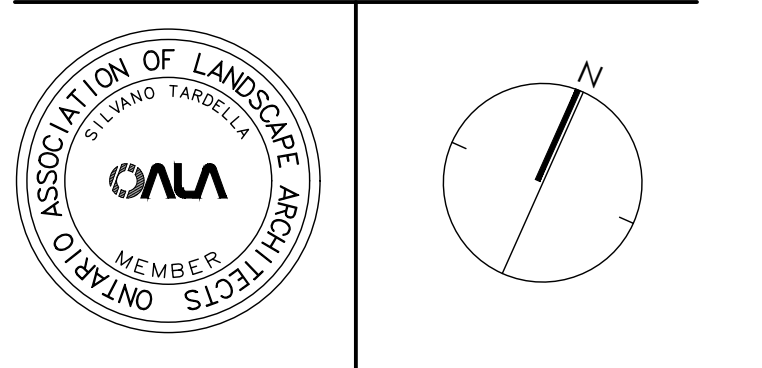

NAK design strategies

1285 WELLINGTON STREET, OTTAWA, ON K1Y 3A8 CANADA
 T 613.237.2345 F 613.237.4423 NAKDESIGNSTRATEGIES.COM

Project

Trailsedge Phase 5
 Orleans, ON

Title

Preliminary Streetscape Plan

Date	May 2021	Sheet	ST3
Scale	1:500		
Drawn	CP		
Checked	LS		
Job No.	21-116		

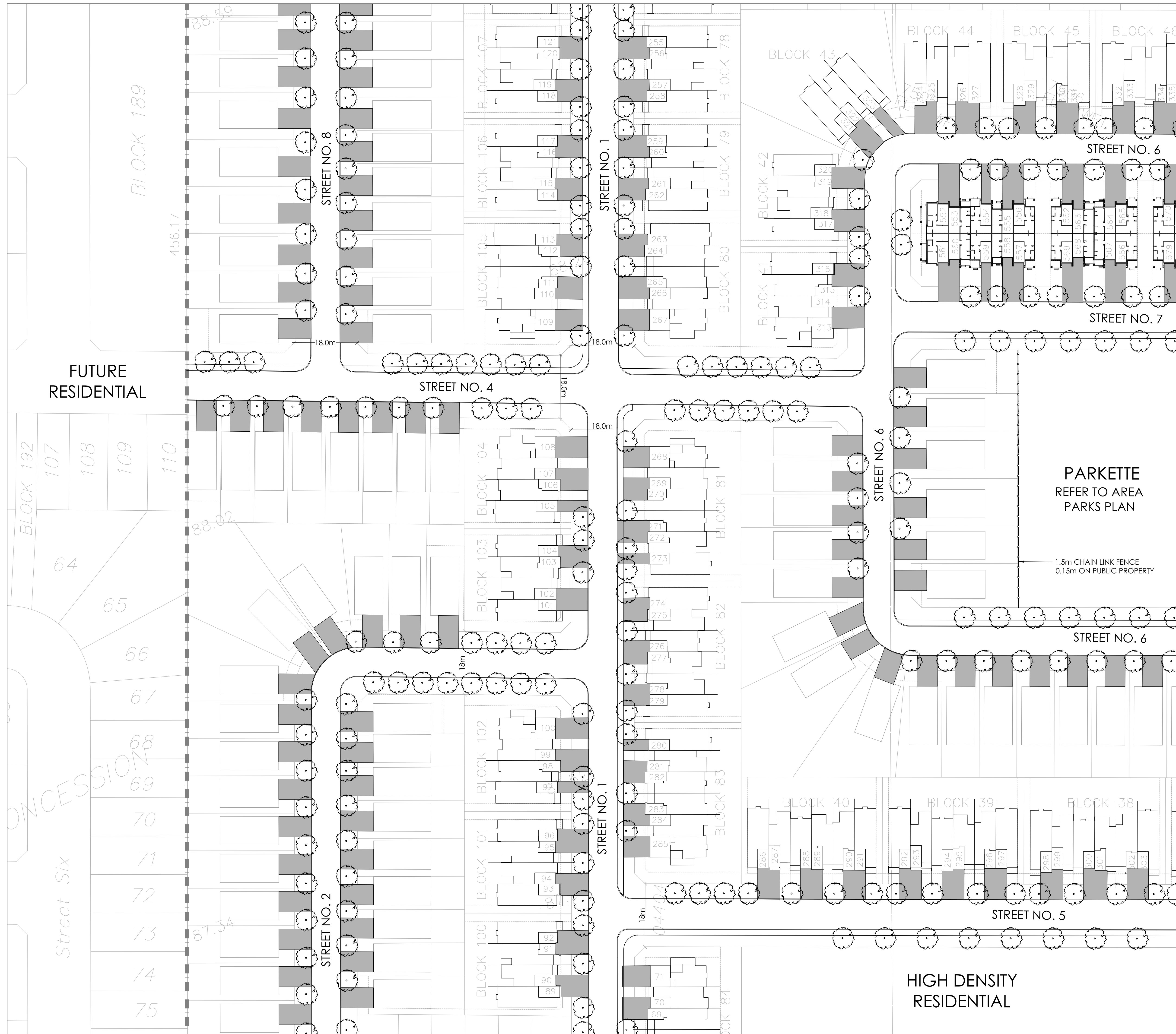

STREET TREE REQUIREMENT:

1 TREE PER INTERIOR (NON-CORNER) LOTS
 2 TREES PER EXTERIOR (CORNER) LOTS

INTERIOR (NON-CORNERS) SINGLE LOTS (888): 888 TREES
 EXTERIOR (CORNERS) SINGLE LOTS (95): 190 TREES

TOTAL NUMBER OF TREES REQUIRED: 1078
 NUMBER OF STREET TREES SHOWN ON PLAN: 1078
 NUMBER OF WALKWAY BLOCK TREES: 0
 TOTAL ROW TREES SHOWN IN AREA PARKS PLAN: 61
 TOTAL NUMBER OF TREES ON PLAN: 1078

* PRELIMINARY - SUBJECT TO CHANGE DURING DETAILED DESIGN AND SITE PLAN CONTROL APPLICATIONS.

No.	Description	Date
2	Revised as per city comments	SEPT, 08/22
1	Issued for Client Review	MAY 07/21

Revision
 City Approval Stamp

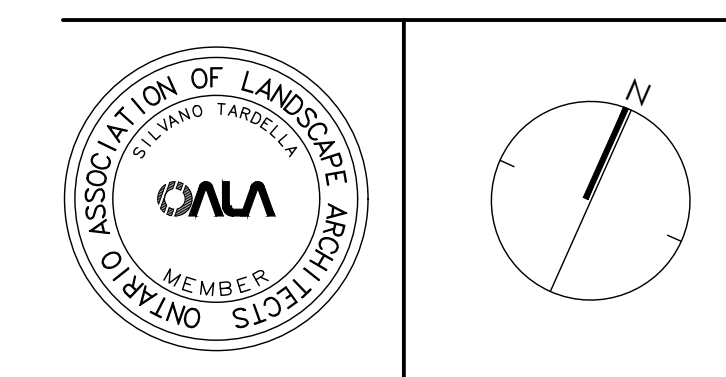

NAK design strategies
 1285 WELLINGTON STREET, OTTAWA, ON K1Y 3A8 CANADA
 T 613.237.2345 F 613.237.6423 NAKDESIGNSTRATEGIES.COM

Trailside Phase 5
 Orleans, ON

Title
 Preliminary Streetscape Plan

Date	May 2021	Sheet	ST4
Scale	1:500		
Drawn	CP		
Checked	LS		
Job No.	21-116		

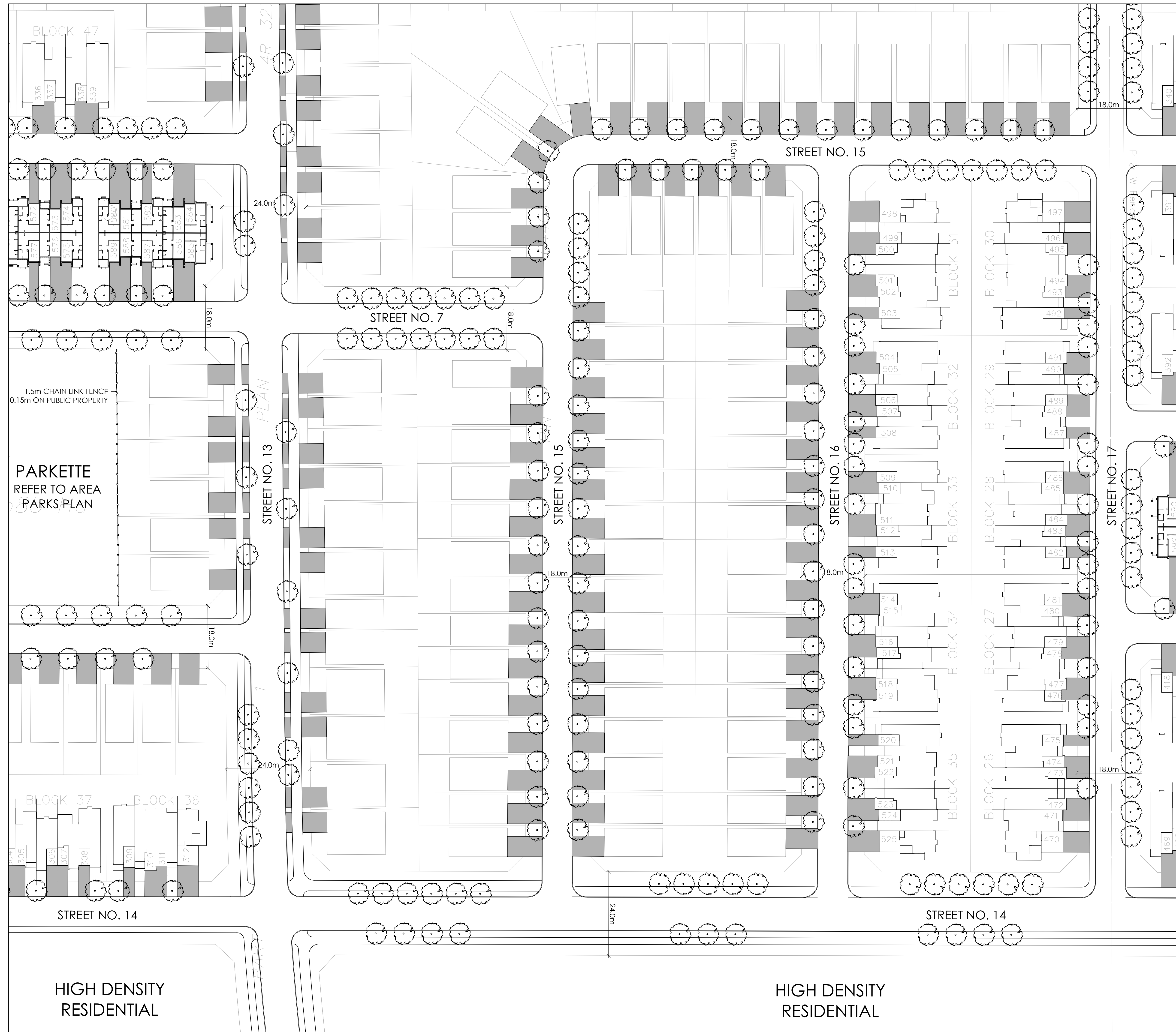

STREET TREE REQUIREMENT:

1 TREE PER INTERIOR (NON-CORNER) LOTS
 2 TREES PER EXTERIOR (CORNER) LOTS

INTERIOR (NON-CORNERS) SINGLE LOTS (888): 888 TREES
 EXTERIOR (CORNERS) SINGLE LOTS (95): 190 TREES

TOTAL NUMBER OF TREES REQUIRED: 1078
 NUMBER OF STREET TREES SHOWN ON PLAN: 1078
 NUMBER OF WALKWAY BLOCK TREES: 0
 TOTAL ROW TREES SHOWN IN AREA PARKS PLAN: 61
 TOTAL NUMBER OF TREES ON PLAN: 1078

* PRELIMINARY - SUBJECT TO CHANGE DURING DETAILED DESIGN AND SITE PLAN CONTROL APPLICATIONS.

1.5m CHAIN LINK FENCE
 0.15m ON PUBLIC PROPERTY

PARKETTE
 REFER TO AREA
 PARKS PLAN

BLOCK 37 BLOCK 36

HIGH DENSITY
 RESIDENTIAL

HIGH DENSITY
 RESIDENTIAL

No.	Description	Date
2	Revised as per city comments	SEPT, 08/22
1	Issued for Client Review	MAY 07/21

Revision

City Approval Stamp

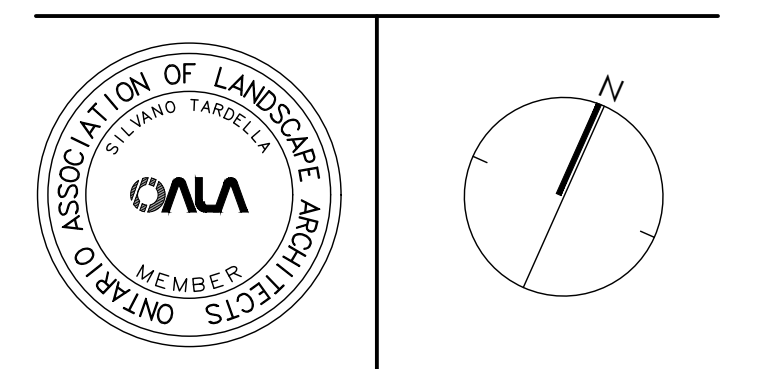

NAK design strategies
 1285 WELLINGTON STREET, OTTAWA, ON K1Y 3A8 CANADA
 T 613.237.2345 F 613.237.4423 NAKDESIGNSTRATEGIES.COM

Trailsedge Phase 5
 Orleans, ON

Title
 Preliminary Streetscape Plan

Date	May 2021	Sheet
Scale	1:500	ST5
Drawn	CP	
Checked	LS	
Job No.	21-116	

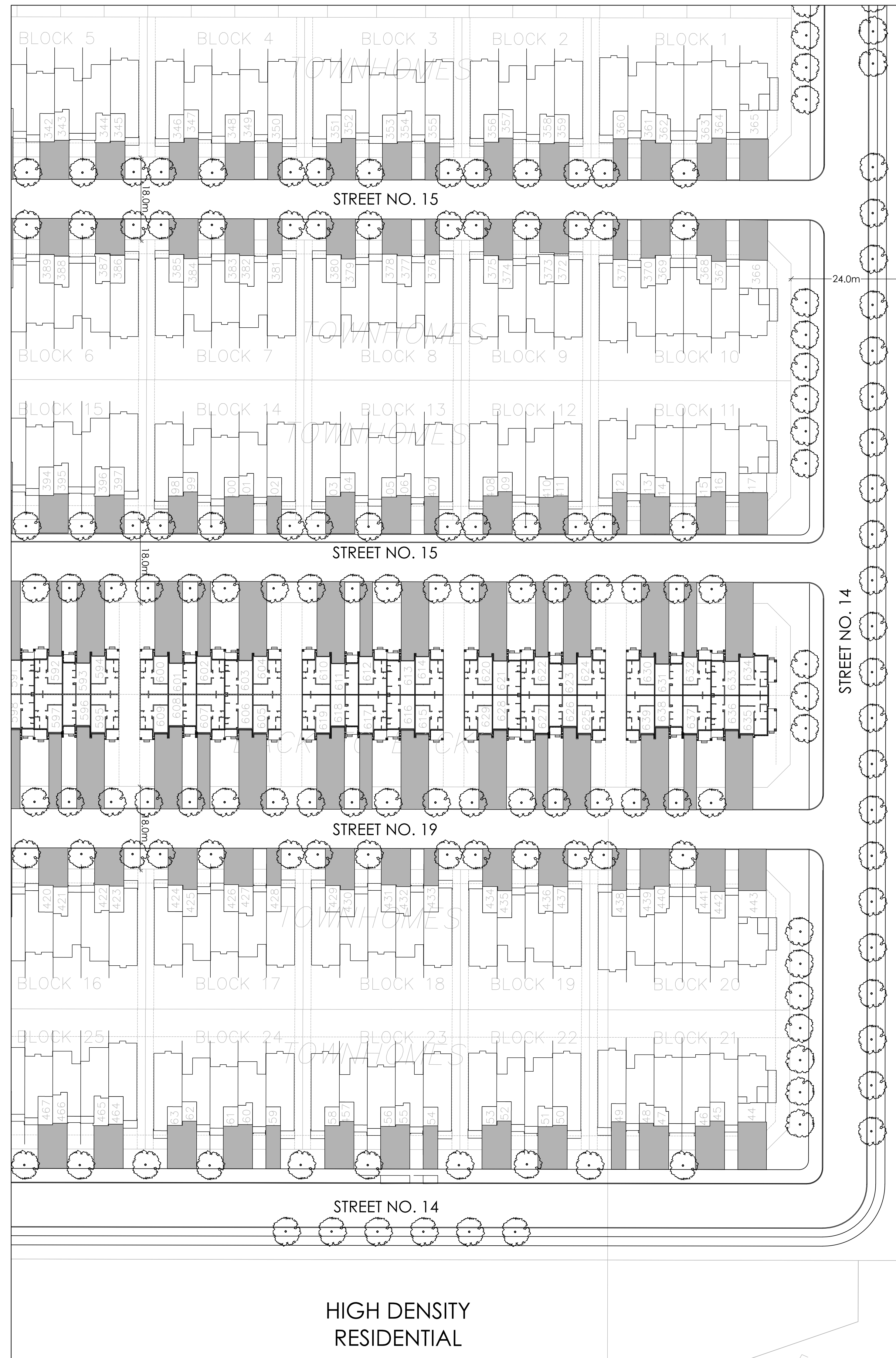

STREET TREE REQUIREMENT:

1 TREE PER INTERIOR (NON-CORNER) LOTS
 2 TREES PER EXTERIOR (CORNER) LOTS

INTERIOR (NON-CORNERS) SINGLE LOTS (888): 888 TREES
 EXTERIOR (CORNERS) SINGLE LOTS (95): 190 TREES

TOTAL NUMBER OF TREES REQUIRED: 1078
 NUMBER OF STREET TREES SHOWN ON PLAN: 1078
 NUMBER OF WALKWAY BLOCK TREES: 0
 TOTAL ROW TREES SHOWN IN AREA PARKS PLAN: 61
 TOTAL NUMBER OF TREES ON PLAN: 1078

* PRELIMINARY - SUBJECT TO CHANGE DURING DETAILED DESIGN AND SITE PLAN CONTROL APPLICATIONS.

COMMUNITY PARK
 REFER TO AREA PARKS PLAN

No.	Description	Date
2	Revised as per city comments	SEPT, 08/22
1	Issued for Client Review	MAY 07/21
Revision		
City Approval Stamp		

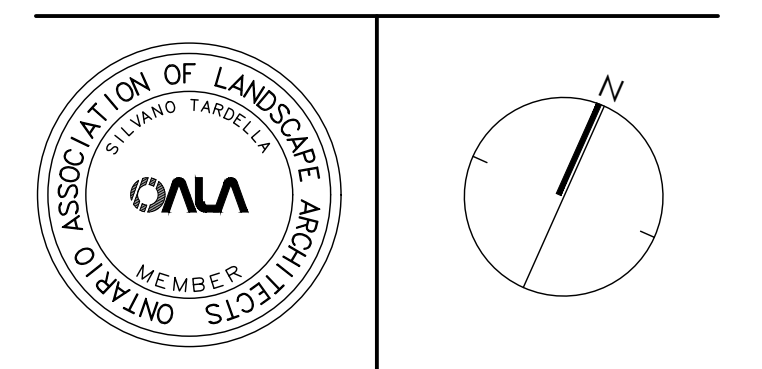

NAK design strategies
 1285 WELLINGTON STREET, OTTAWA, ON K1Y 3A8 CANADA
 T 613.237.2345 F 613.237.4423 NAKDESIGNSTRATEGIES.COM

Trailside Phase 5
 Orleans, ON

Title
 Preliminary Streetscape Plan

Date	May 2021	Sheet	ST6
Scale	1:500		
Drawn	CP		
Checked	LS		
Job No.	21-116		

STREET TREE REQUIREMENT:

1 TREE PER INTERIOR (NON-CORNER) LOTS
 2 TREES PER EXTERIOR (CORNER) LOTS

INTERIOR (NON- CORNERS) SINGLE LOTS (888): 888 TREES
 EXTERIOR (CORNERS) SINGLE LOTS (95): 190 TREES

TOTAL NUMBER OF TREES REQUIRED: 1078
 NUMBER OF STREET TREES SHOWN ON PLAN: 1078
 NUMBER OF WALKWAY BLOCK TREES: 0
 TOTAL ROW TREES SHOWN IN AREA PARKS PLAN: 61
 TOTAL NUMBER OF TREES ON PLAN: 1078

* PRELIMINARY - SUBJECT TO CHANGE DURING DETAILED DESIGN AND SITE PLAN CONTROL APPLICATIONS.

18.0m RESIDENTIAL ROAD ALLOWANCE WITH SIDEWALK
 SINGLE DETACHED HOMES

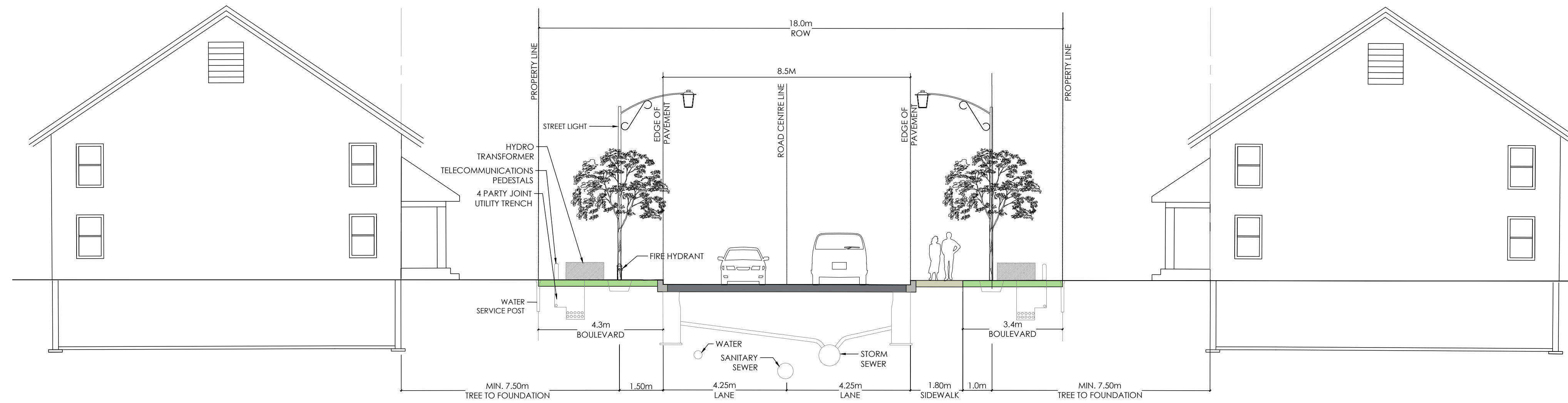

18.0m RESIDENTIAL ROAD ALLOWANCE WITHOUT SIDEWALK
 BACK-TO-BACK TOWNHOMES/TOWNHOMES

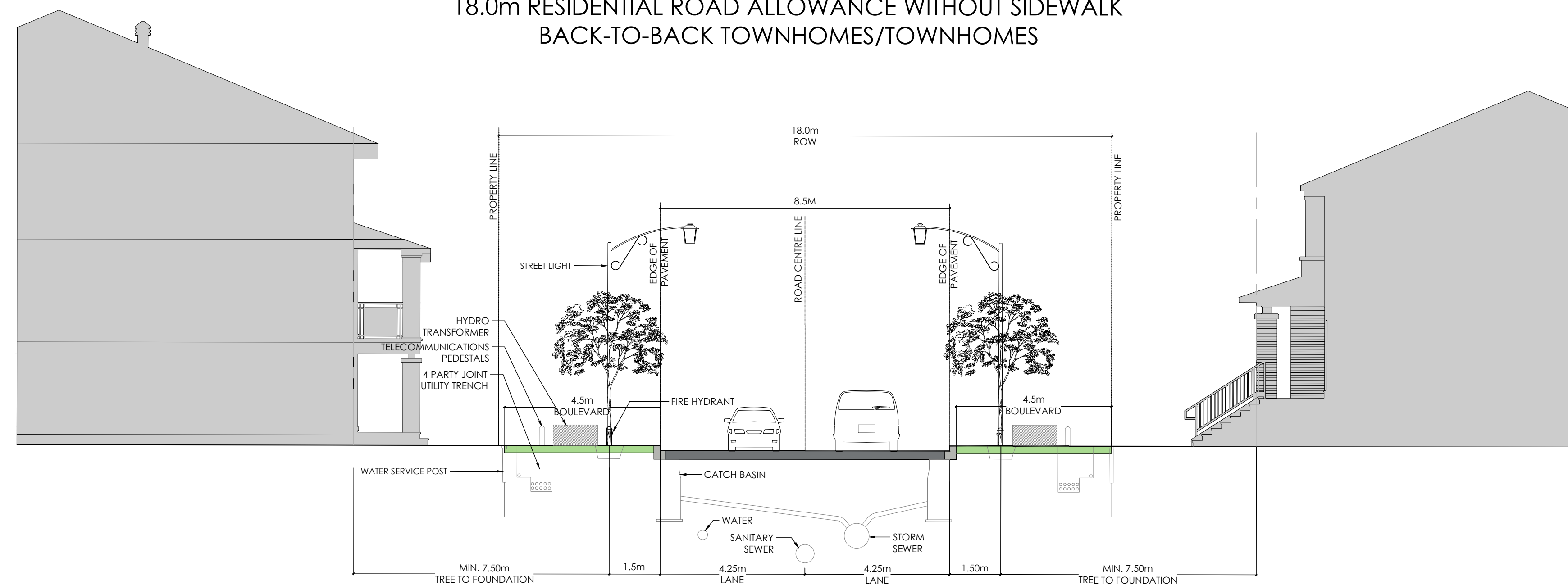

-		
-		
-		
-		
-		
2	Revised as per city comments	SEPT, 08/22
1	Issued for Client Review	MAY 07/21
No.	Description	Date
Revision		
City Approval Stamp		

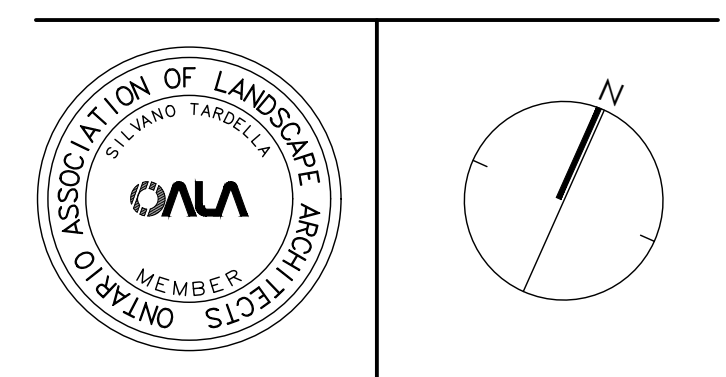

NAK design strategies
 1285 WELLINGTON STREET, OTTAWA, ON K1Y 3A8 CANADA
 T 613.237.2345 F 613.237.4423 NAKDESIGNSTRATEGIES.COM
 Project

Trailsedge Phase 5
 Orleans, ON

Title	
ROW Cross Sections	
Date: May 2021	Sheet
Scale: 1:100	D-01
Drawn: CP	
Checked: LS	
Job No.: 21-116	

STREET TREE REQUIREMENT:

1 TREE PER INTERIOR (NON-CORNER) LOTS	
2 TREES PER EXTERIOR (CORNER) LOTS	
INTERIOR (NON-CORNER) SINGLE LOTS (888):	888 TREES
EXTERIOR (CORNER) SINGLE LOTS (95):	190 TREES
TOTAL NUMBER OF TREES REQUIRED:	1078
NUMBER OF STREET TREES SHOWN ON PLAN:	1078
NUMBER OF WALKWAY BLOCK TREES:	0
TOTAL ROW TREES SHOWN IN AREA PARKS PLAN:	61
TOTAL NUMBER OF TREES ON PLAN:	1078

* PRELIMINARY - SUBJECT TO CHANGE DURING DETAILED DESIGN AND SITE PLAN CONTROL APPLICATIONS.

24.0m RESIDENTIAL ROAD ALLOWANCE - WITHOUT BUS STOP

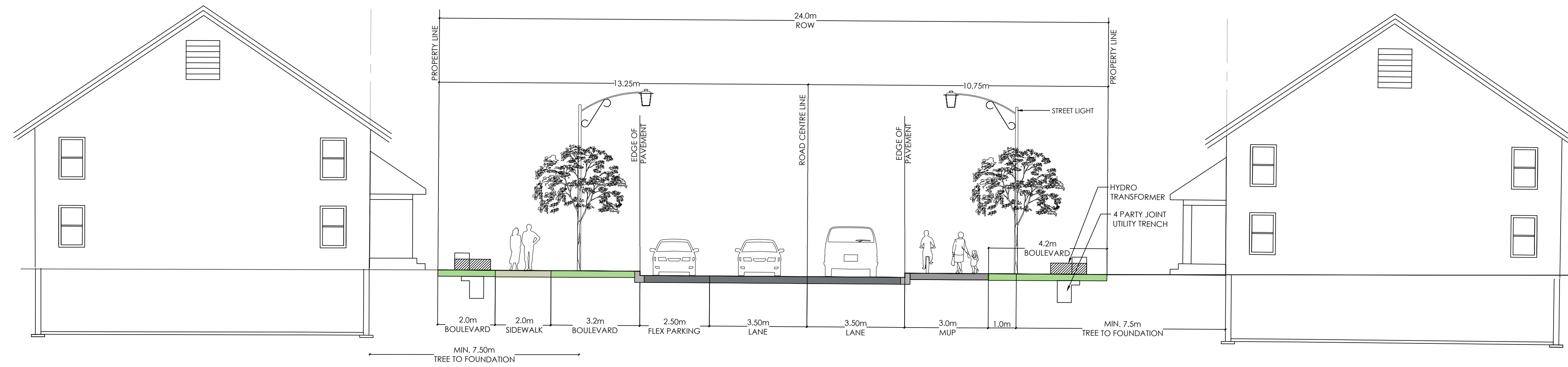

24.0m RESIDENTIAL ROAD ALLOWANCE - WITH BUS STOP

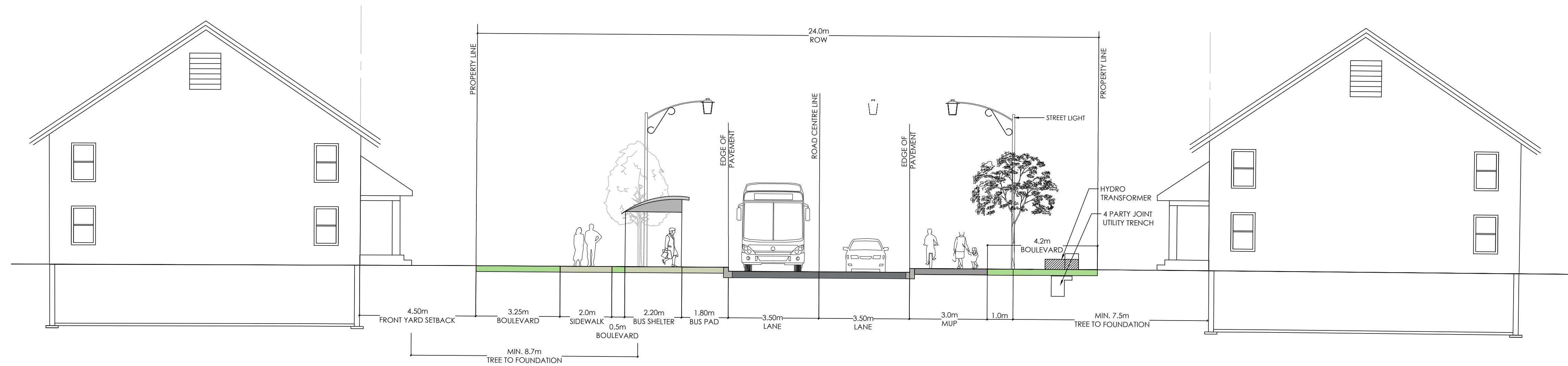

No.	Description	Date
2	Revised as per city comments	SEPT, 08/22
1	Issued for Client Review	MAY 07/21
Revision		
City Approval Stamp		

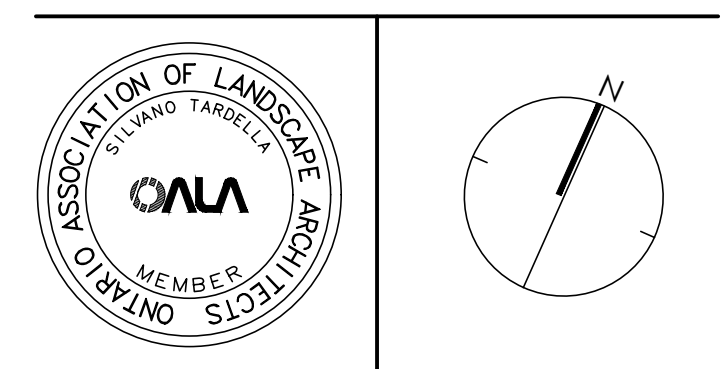

NAK design strategies
 1285 WELLINGTON STREET, OTTAWA, ON K1Y 3A8 CANADA
 T 613.237.2345 F 613.237.4423 NAKDESIGNSTRATEGIES.COM
 Project

Trailsedge Phase 5
 Orleans, ON

Title	
ROW Cross Sections	
Date	Sheet
May 2021	
Scale	
1:100	
Drawn	
CP	
Checked	
LS	
Job No.	
21-116	D-01

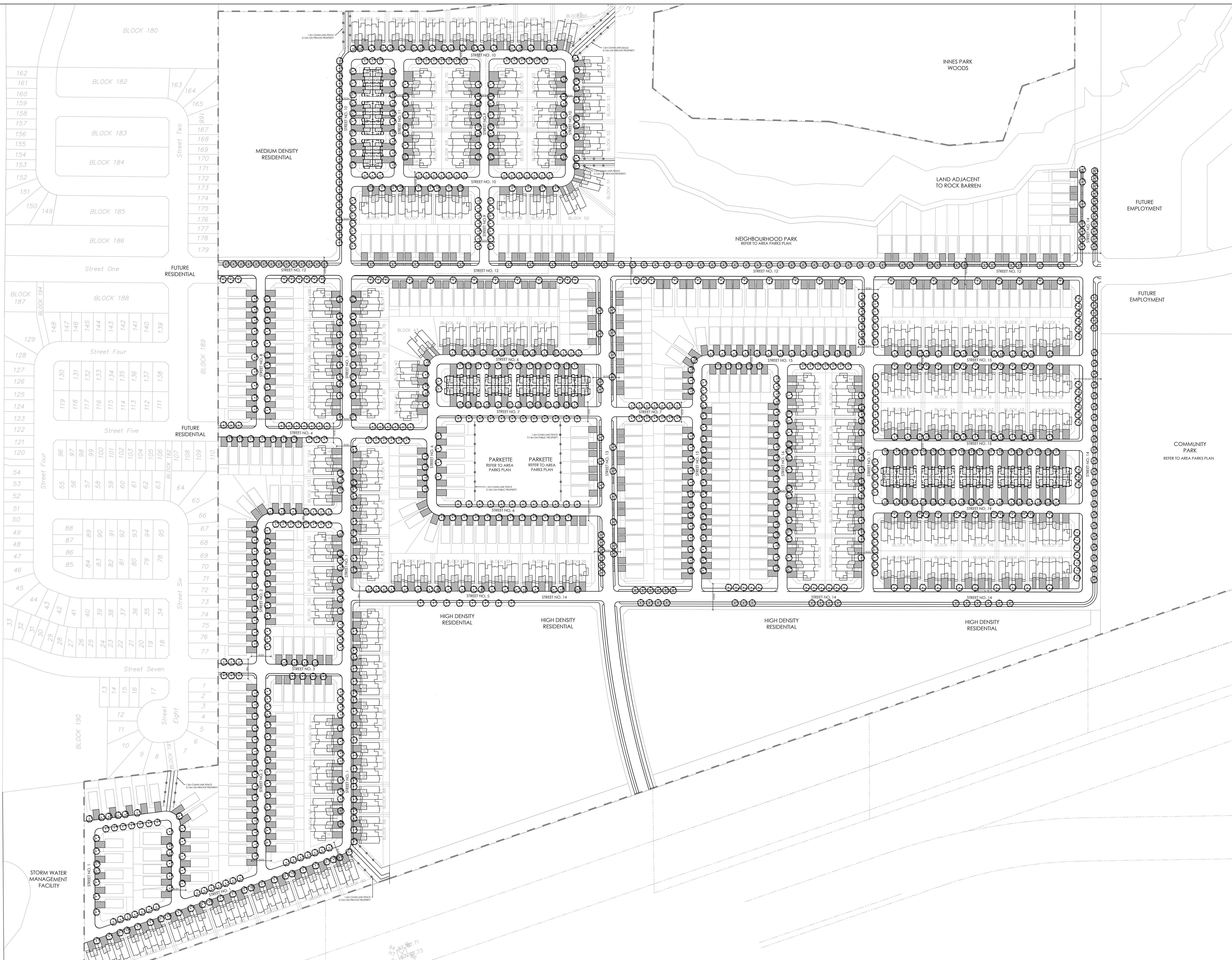

STREET TREE REQUIREMENT:

1 TREE PER INTERIOR (NON-CORNER) LOTS
 2 TREES PER EXTERIOR (CORNER) LOTS

INTERIOR (NON-CORNERS) SINGLE LOTS (888): 888 TREES
 EXTERIOR (CORNERS) SINGLE LOTS (95): 190 TREES

TOTAL NUMBER OF TREES REQUIRED:	1078
NUMBER OF STREET TREES SHOWN ON PLAN:	1078
NUMBER OF WALKWAY BLOCK TREES:	0
TOTAL ROW TREES SHOWN IN AREA PARKS PLAN:	61
TOTAL NUMBER OF TREES ON PLAN:	1078

* PRELIMINARY - SUBJECT TO CHANGE DURING DETAILED DESIGN AND SITE PLAN CONTROL APPLICATIONS.

No.	Description	Date
2	Revised as per city comments	SEPT, 08/22
1	Issued for Client Review	MAY 07/21
Revision		
City Approval Stamp		

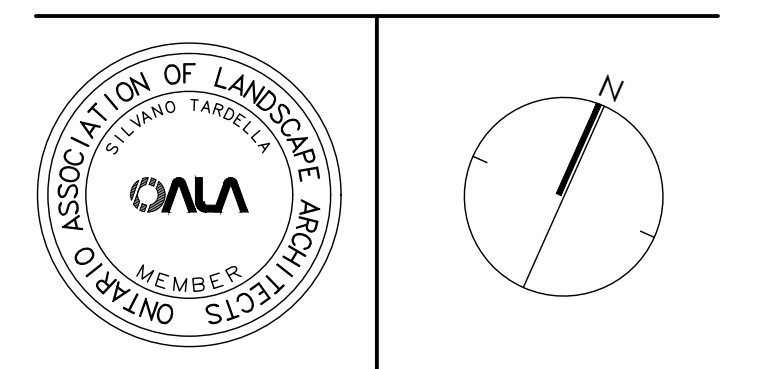

NAK design strategies

1285 WELLINGTON STREET, OTTAWA, ON K1Y 3A8 CANADA
 T 613.237.2345 F 613.237.6423 NAKDESIGNSTRATEGIES.COM

Trailsedge Phase 5
 Orleans, ON

Title
 Preliminary Streetscape Plan

Date	May 2021	Sheet	ST1
Scale	1:500		
Drawn	CP		
Checked	LS		
Job No.	21-116		