

- GENERAL NOTES:**
- It is the responsibility of the appropriate contractor or official to report any errors, omissions or discrepancies on this plan with actual site conditions to the Landscape Architect before proceeding with construction.
 - The contractor is to notify all utility companies and authorities prior to any excavation and ascertain locations of underground services.
 - The contractor is to reinstate all areas and items damaged as a result of construction activity.
 - The contractor is to comply with all pertinent codes and by-laws.
 - The contractor is to maintain a positive surface run-off throughout the entire construction period.
 - The Landscape Architect is not responsible for subsurface conditions.
 - The contractor is to identify all existing trees to remain on site with the Landscape Architect prior to construction.
 - The contractor is to stake the proposed location of all plant material in conjunction with the Landscape Architect prior to excavation.
 - Minimum distances for selected deciduous trees are as follows:
 - Building Foundations 7.5m
 - Sidewalks 1.5m
 - Public Streets 2.5m
 - Underground Infrastructure 2.0m
 - All trees within 1m of underground utility trenches are to be excavated by hand.
 - Remove all protective wrapping from tree trunks after installation.
 - Staking of trees shall only be performed if necessary.
 - Ensure that mulch is pulled back a min. distance of 75mm from base of tree trunk.

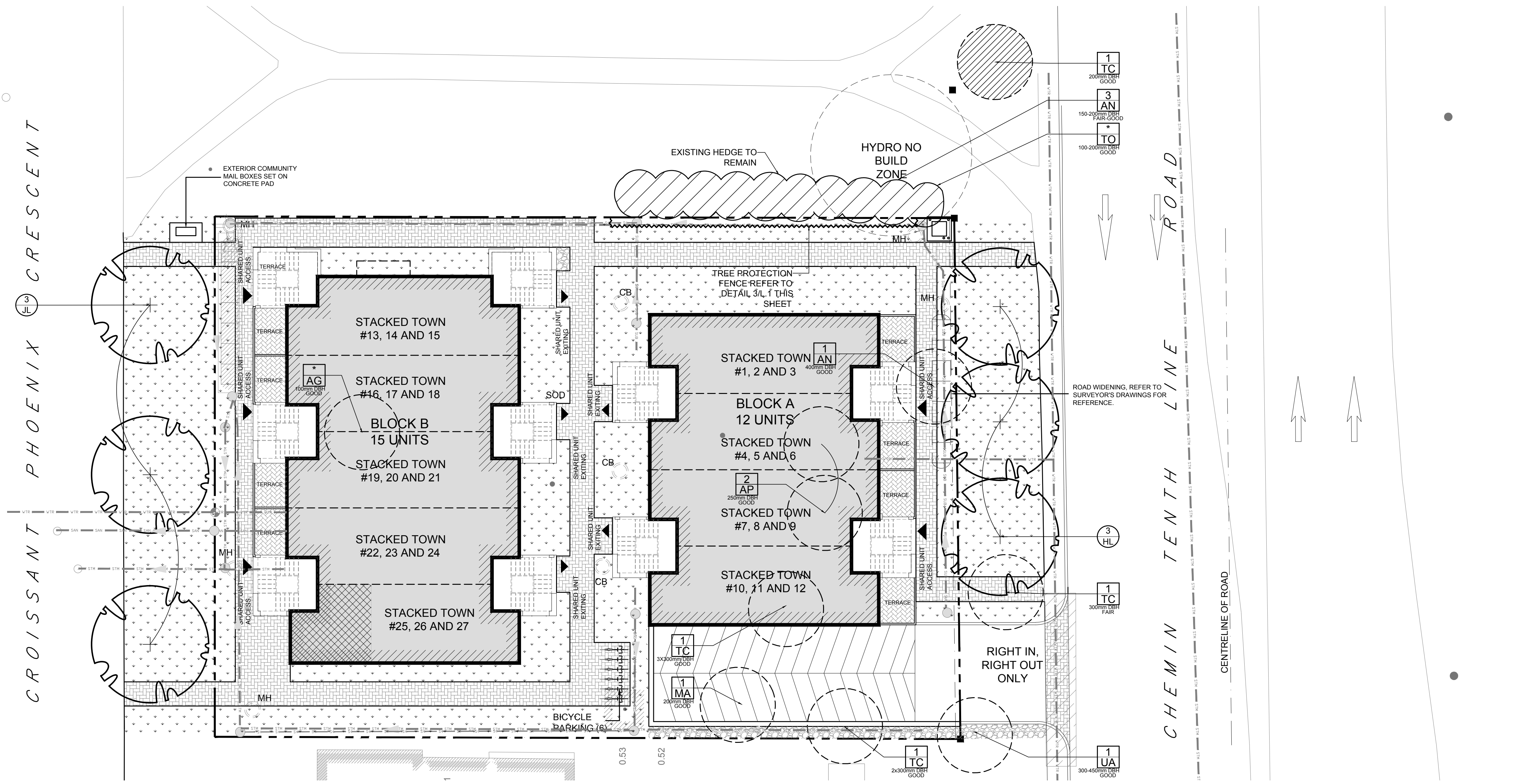

1 L.1 TREE CONSERVATION REPORT & LANDSCAPE PLAN
SCALE 1:150

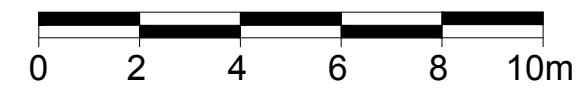
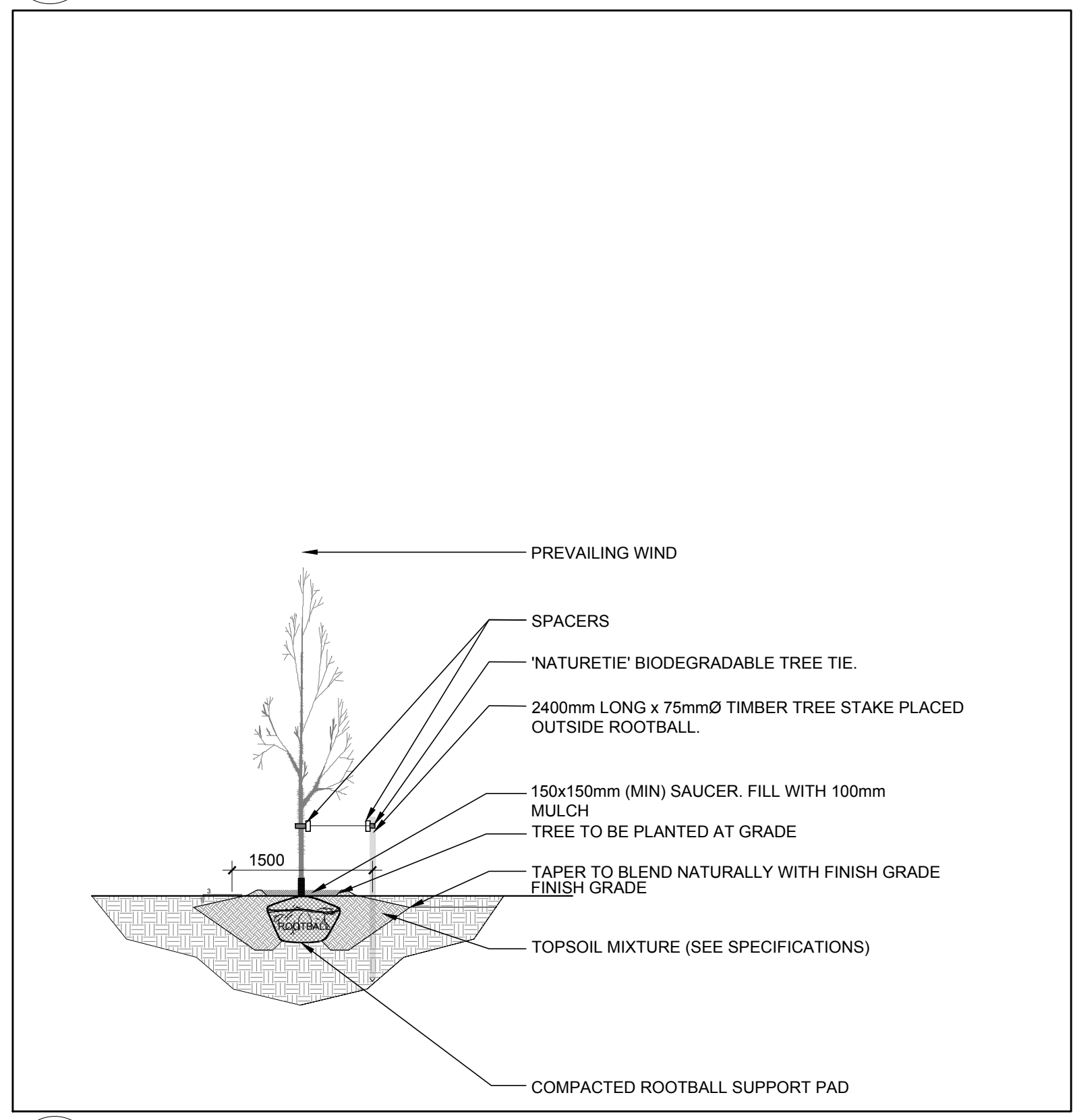

2 L.1 DECIDUOUS TREE PLANTING
SCALE: NTS

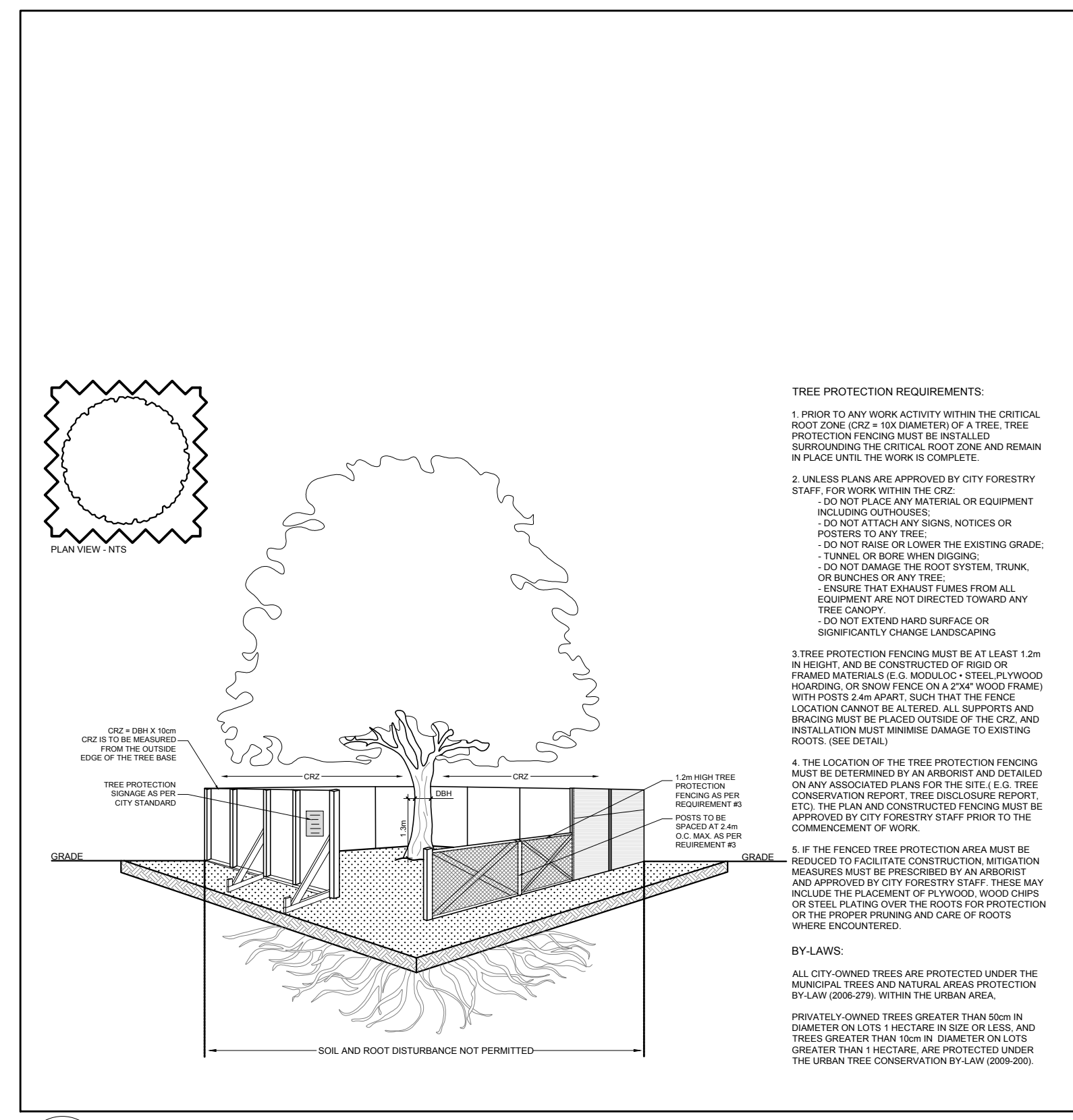

3 L.1 TREE PROTECTION FENCE
SCALE: NTS

PROPOSED PLANT LIST						
KEY	QTY	BOTANICAL NAME	COMMON NAME	SIZE	CONDITION	REMARKS
TREES						
HL	3	Gleditsia triacanthos 'Draves'	Street Keeper Honey Locust	60mm cal.	B&B	
JL	3	Syringa reticulata	Japanese Tree Lilac	60mm cal.	B&B	Single leader

EXISTING TREE LIST						
KEY	QTY	BOTANICAL NAME	COMMON NAME	SIZE	CONDITION	REMARKS
TREES						
AG	-	Acer ginnala	Amur Maple	100mm dbh	Good	To be removed
AN	4	Acer negundo	Manitoba Maple	150-400mm dbh	Fair-Good	See plan
AP	2	Acer platanoides	Freeman's Maple	250mm dbh	Good	To be removed
MA	1	Mallus sp.	Crabapple	200mm dbh	Good	To be removed
TC	4	Tilia cordata	Littleleaf Linden	200-300mm dbh	Fair-Good	See plan
TO	1	Thuja occidentalis	White Cedar	100-200mm dbh	Good	To remain
UA	1	Ulmus americana	American Elm	2x400-450mm dbh	Good	To be removed

*DENOTES NUMEROUS

CLIENT: **BRIDOR** Developments

994-B St. Augustin Rd
Ottawa, ON K2A 1Y9
Tel: (613) 443-3371

CONSULTANTS

ARCHITECTS: **P2 concepts**
739 RIDGEWOOD AVE., UNIT 201
OTTAWA, ONTARIO, K1V 6A8

CIVIL ENGINEERS: **BLANCHARD LETENDRE ENGINEERING**
787 Notre-Dame St. Suite 42
Ottawa, ON K2A 1Y9
Tel: (613) 693-2700

LEGEND

- PROPOSED PRECAST CONCRETE PAVERS TYPE I
- PROPOSED PRECAST CONCRETE PAVERS TYPE II
- PROPOSED DECIDUOUS TREE
- PROPOSED SOD
- PROPOSED RIVERSTONE MULCH
- PROPOSED TREE PROTECTION FENCE
- EXISTING TREE TO REMAIN
- EXISTING HEDGE TO REMAIN
- EXISTING TREE TO BE REMOVED

4	REVISED PER NEW CIVIL DRAWING	07/13/2022	ML	JL
3	LEGEND REVISED	09/23/2021	ML	JL
2	RE-ISSUED FOR SITE PLAN CONTROL	04/19/2021	ML	JL
1	ISSUED FOR SITE PLAN CONTROL	03/09/2021	ML	JL

No. Issue Date DR CK

JAMES B. LENOX & ASSOCIATES INC.
LANDSCAPE ARCHITECTS
3332 CARLING AVE. OTTAWA, ONTARIO K2H 5A8
Tel: (613) 722-5168 Fax: (1866) 343-3942

PROJECT

STACKED TOWNHOUSES
1592 TENTH LINE ROAD, OTTAWA ON

DRAWING

TREE CONSERVATION REPORT & LANDSCAPE PLAN

STAMP

SCALE AS SHOWN

START DATE FEBRUARY 2021

PROJECT NO.

PROJECT NORTH

DRAWING NO. **L.1**

PLOT SIZE ARCH-D