

EXISTING BOYS AND GIRLS CLUB

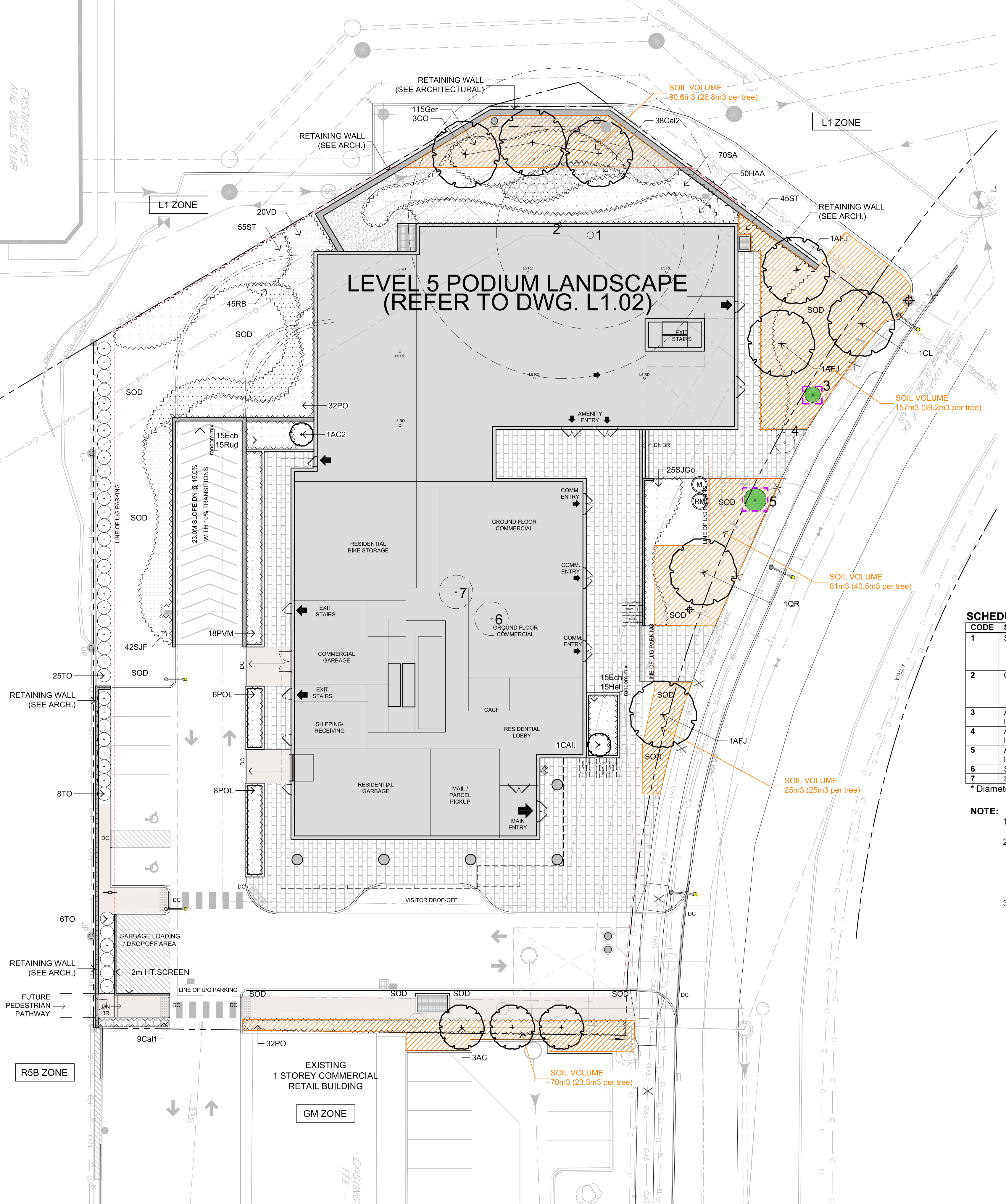

LEVEL 5 PODIUM LANDSCAPE (REFER TO DWG. L1.02)

GM ZONE

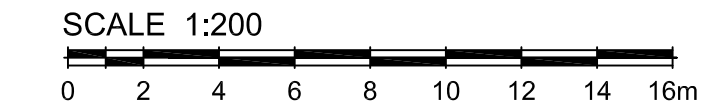

- GENERAL NOTES
1 This drawing shall be read in conjunction with all relevant Architectural, Engineering and related Drawings and Documents.
2 Refer to Engineering Drawings for Grading and Servicing.
3 Refer to Architectural Drawings for Site layout.
4 Contractor shall provide the location(s) of all services/utilities by consulting Municipal Authorities and Utility companies and shall be responsible for adequate protection from damage during construction.
5 Plant material shall be No. 1 Grade and shall comply with the Metric Guide Specifications For Nursery Stock (latest edition), published by the Canadian Nursery Trades Association.
6 Plant Material locations are Schematic / Approximate only. Contractor shall stake out locations on site prior to work.
7 Contractor shall guarantee all plant material for a period of one (1) full year from the date of final acceptance.
8 Shrubs shall be planted in a continuous prepared bed of 450mm depth planting soil mix covered over with a woven polypropylene weed control fabric (LANDSCAPE FABRIC-Green-Line by Thrace-LINQ) and 75mm depth composted pine mulch to finish grade, as specified.
9 Perennials and Ornamental Grasses shall be planted in a continuous prepared bed of 450mm depth planting soil mix covered over with 75mm depth composted pine mulch to finish grade. (NO WEED CONTROL FABRIC), as specified.
10 Sod areas to receive 125mm topsoil. Sod shall be No. 1 quality conforming to the Canadian Nursery Sod Growers Specification.
11 Reinstale all areas damaged or disturbed beyond the limit of Work.
12 Plant Material substitutions shall not be permitted without written approval from the Consultant.
13 Provide protection for existing trees to be retained. Install fencing to dripline (canopy) of each tree or groupings of trees (if close together). No excavation, filling, storage of materials, disposal of chemicals or waste, vehicle traffic or other activity which could cause root zone disturbance or compaction, shall take place within the protected area.
14 Where limits of trees are removed to accommodate construction work, they shall be done in accordance with accepted arboricultural practice.
15 When root systems become exposed due to excavation, carefully trim damaged roots and provide temporary mulch until backfill is undertaken. Keep roots moist at all times.
16 Construct wells or retaining walls if grades around trees are to be modified. Root feed all existing trees after construction.
17 Contractor shall advise Consultant a minimum of 48hrs prior to proceeding landscape work and any required Field Reviews.
18 THIS PLAN HAS BEEN PREPARED FOR MUNICIPAL SITE PLAN APPROVAL ONLY AND MAY NOT BE USED FOR ANY OTHER PURPOSE.

SCHEDULE OF EXISTING TREES (Inventory conducted July 31, 2020)

Table with columns: CODE, SPECIES, DBH*(cm), CONDITION / TREATMENT / REMARKS. Lists trees like Siberian Elm, Cottonwood, American Yellowwood, etc.

NOTE:
1. No tree species at risk, as identified under the Province of Ontario Endangered Species Act (ESA), were found on subject property or within 25m of adjacent properties.
2. In conformance to the guidelines outlined in the City of Ottawa Protocol for Wildlife Protection During Construction, no clearing of vegetation shall occur between April 15 and August 15, unless a qualified biologist has determined that no bird nesting is occurring within 5 days prior to clearing.
3. A tree permit is required prior to removal of trees. Please contact the planner associated with the file or the Planning Forester, Mark Richardson (mark.richardson@ottawa.ca) for information on obtaining the permit.

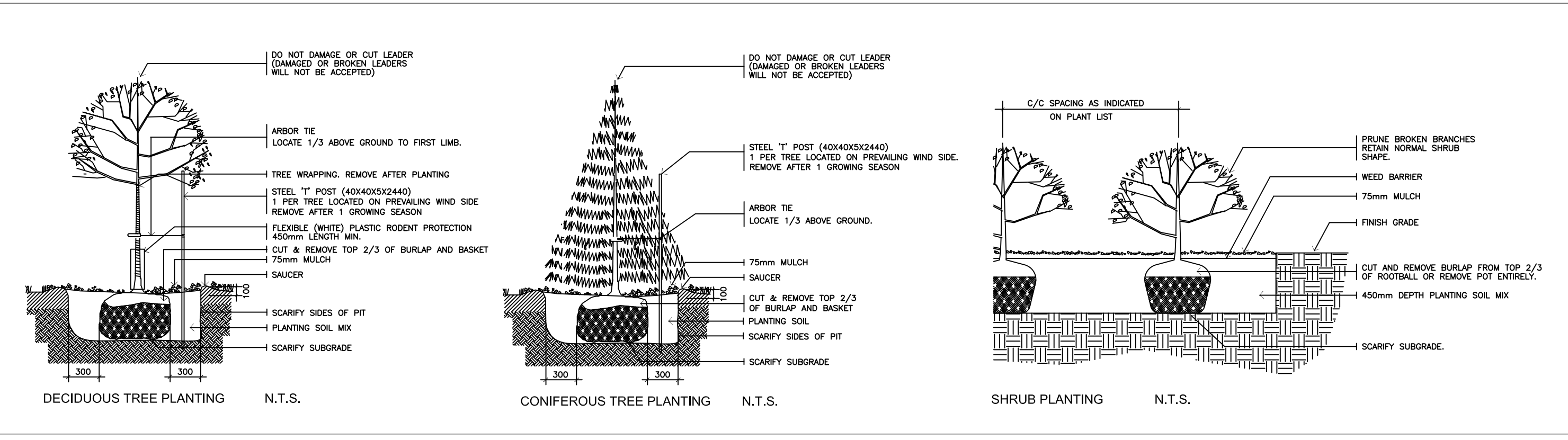

1 L1.01 PLANTING DETAILS NTS

PROJECT DEVELOPER: BRIGIL CONSTRUCTION, 98, Lois St. Gatineau Qc., J8Y 3R7
ARCHITECT: RLA/ARCHITECTURE, 56 Beech St., Ottawa, ON K1S 3J6
CIVIL ENGINEER: STANTEC ENGINEERING LTD., 400-1331 Clyde Ave., Ottawa, ON K2C 3G4
URBAN PLANNER: FoTenn Consultants Inc., 300-396 Cooper St., Ottawa, ON K2P 2H7
ONTARIO LAND SURVEYOR: ANNIS O'SULLIVAN VOLLEBECK LTD., 500-14 Concourse Gate, Nepean, ON K2E 7S6
LANDSCAPE ARCHITECT: LEVSTEK CONSULTANTS INC., 5871 Hugh Cresc., Ottawa, ON K0A 2W0
LEGAL DESCRIPTION: Plan of Survey of Part of Lot 20, Concession 2 (Ottawa Front) Township of Nepean, Now City of Ottawa Part of Dumaaurier Ave. (as closed by By-Law 372.78 Inst. NS41961) and Part of the 1' Reserve Registered Plan 479600, City of Ottawa Regional Municipality of Ottawa-Carleton

TREE CANOPY COVER DATA (PROJECTION ASSUMED AT 40 YR. MATURITY)
LARGE DECIDUOUS TREES: 10m Dia. Spread 78m2 per x 10 = 780m2
SMALL DECIDUOUS TREES: 5m Dia. Spread 20m2 per x 3 = 60m2
TOTAL TREE CANOPY COVER: 840m2
SITE AREA minus BLDG. FOOTPRINT: 2625.0m2 (4195.0m2) - (1570.0m2)
% TREE CANOPY COVER: 32.0

PLANT MATERIAL SCHEDULE (Ground Level)

Table with columns: CODE, BOTANICAL NAME, COMMON NAME, QTY., SIZE, REMARKS. Lists various plant species like Amelanchier canadensis, Acer, etc.

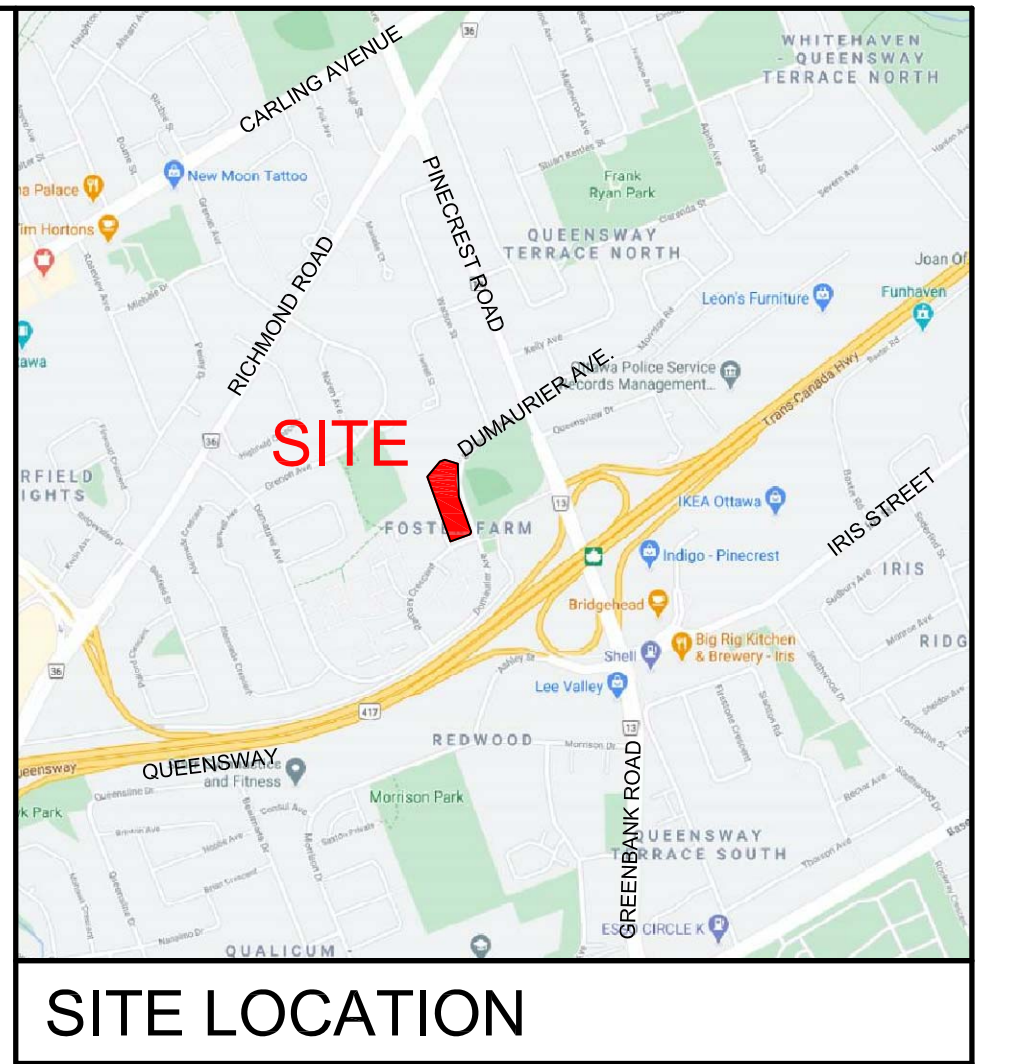

LEGEND / SYMBOLOGY
EXISTING TREE TO BE RETAINED (Refer to Existing Tree Inventory) CRZ (Critical Root Zone)
EXISTING TREE TO BE REMOVED (Refer to Existing Tree Inventory) CRZ (Critical Root Zone)
PROPOSED DECIDUOUS TREE DETAIL 1/1.1.01
PROPOSED CONIFEROUS TREE DETAIL 1/1.1.01
PROPOSED CEDAR HEDGE DETAIL 1/1.1.01
PROPOSED SHRUBS, PERENNIALS, ORNAMENTAL GRASSES DETAIL 1/1.1.01
PROPOSED UNIT PAVING DETAIL 3/1.2.01 + 4/L2.01
PROPOSED CONCRETE PAVING
PROPOSED P.C CONCRETE SEGMENTAL PLANTER WALL DETAIL 5/1.2.01
PROPOSED AGGREGATE: 1-1/2" - 2-1/2" NATURAL APPROVED SOURCE, Nestlé Aggregates Ltd. (Renfrew ON)
PROPOSED BICYCLE PARKING SPACES PROVIDED: 10
PROPOSED BICYCLE RACK PROPOSED CITY-2 DETAIL 2/1.2.01
PROPOSED TREE PROTECTION BARRIER DETAIL 1/1.2.01
PROPOSED SOIL VOLUME (SV) DATA

FOR APPROVAL ONLY

Revision table with columns: no., date, revision. Shows dates from Sept. 1924 to Mar. 2021.

North Arrow and Stamp of the Association of Landscape Architects of Ontario (ALA).

Contractor shall check and verify all dimensions on site and report all errors and/or omissions to the Consultant.
Work to be done in accordance with all applicable codes and by-laws.
Do not scale Drawing.
Copyright reserved. This Drawing is the exclusive property of Levstek Consultants Inc. and shall not be used without consent.

Consultant: LEVSTEK CONSULTANTS LANDSCAPE ARCHITECTS, 5871 Hugh Crescent, Ottawa, Ontario - K0A 2W0
Client: brigil

Project: 2858 DUMAURIER AVE OTTAWA ONTARIO
Drawing Title: LANDSCAPE PLAN
Drawn: MGB
Scale: 1:200
Project No.: 1183
Drawing No.: L1.01

THIS DRAWING IS COLOUR DEPENDENT. NON-COLOUR COPIES MAY ALTER INTERPRETATION.

007-42-21-0110

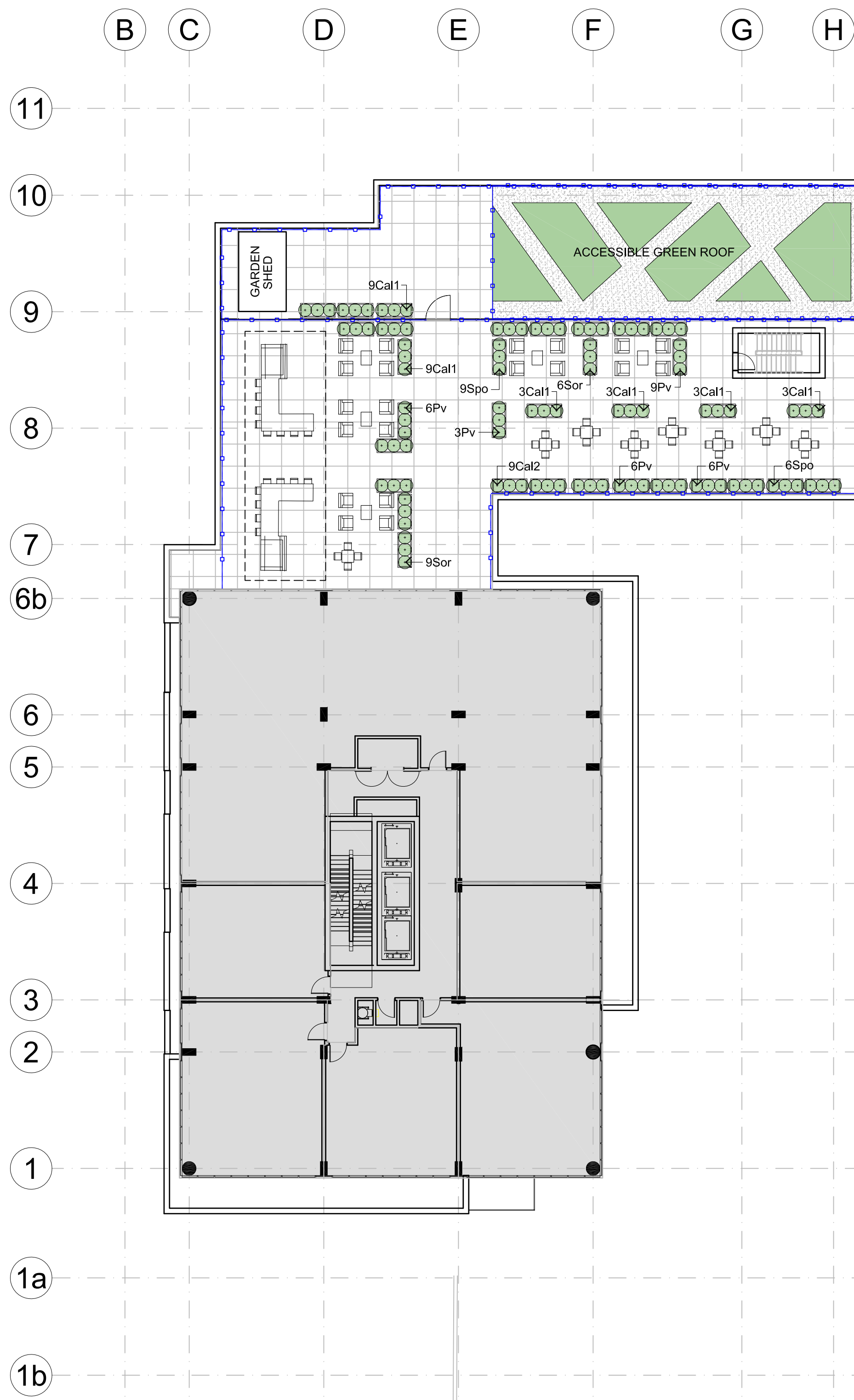

LEVEL 5 PODIUM LANDSCAPE

PLANT MATERIAL SCHEDULE (Level 5 Podium)

CODE	BOTANICAL NAME	COMMON NAME	QTY.	SIZE	REMARKS
ORNAMENTAL GRASSES					
Cal1	CALAMAGROSTIS x acutiflora Karl Foerster	KARL FOERSTER REED GRASS	30	15cm pot	plant 75cm o/c
Cal2	CALAMAGROSTIS canadensis	CANADA BLUE JOINT	9	15cm pot	plant 75cm o/c
Pv	PANICUM virgatum	SWITCH GRASS	30	15cm pot	plant 75cm o/c
Sor	SORGHASTRUM nutans	INDIAN GRASS	15	15cm pot	plant 75cm o/c
Spa	SPOROBOLUS heterolepis	PRAIRIE DROPSEED	15	15cm pot	plant 75cm o/c

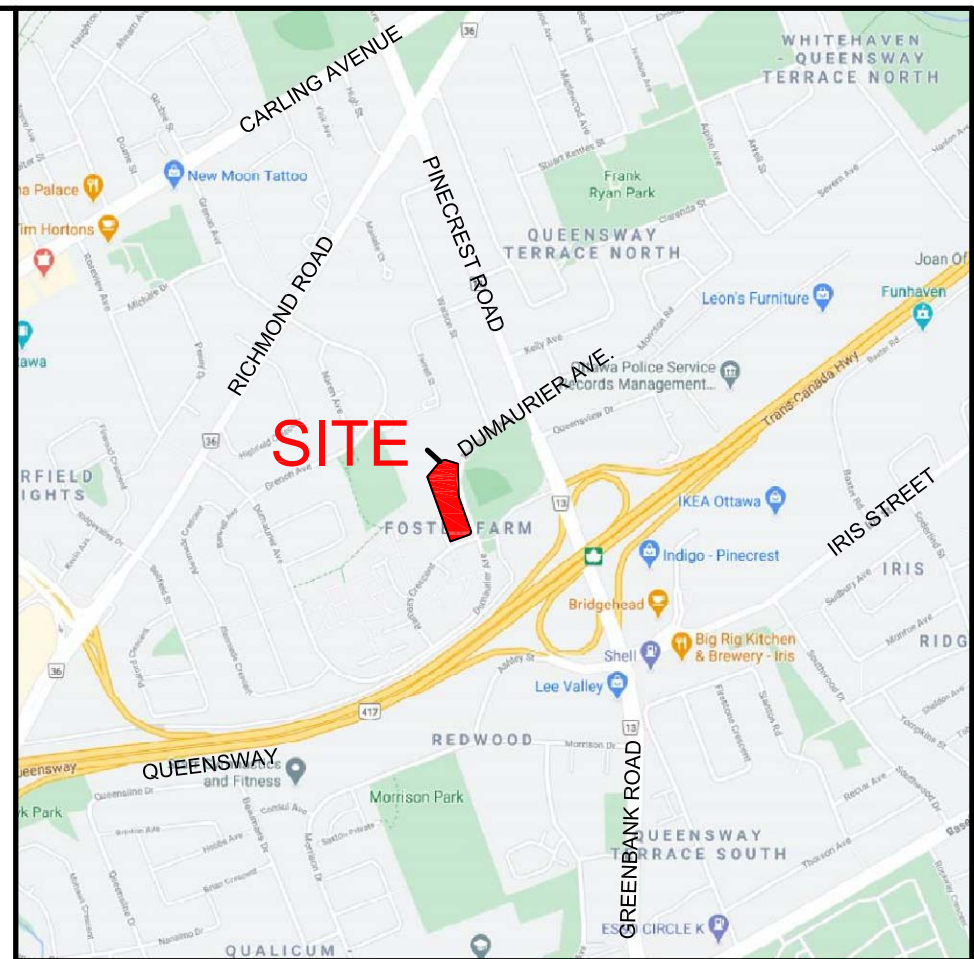

SITE LOCATION

LEGEND / SYMBOL

- PROPOSED SHRUB / PERENNIAL / GRASS
- PROPOSED DECORATIVE AGGREGATE
Type: 10-15mm DIA WASHED GRANITE (Peagravel)
- PROPOSED WEATHERING STEEL (COR-TEN) PLANTER
- PROPOSED UNIT PAVING TYPE A
- PROPOSED 1.0m HT. GLASS GUARD / FENCE (REFER TO ARCHITECTURAL)

FOR APPROVAL ONLY

no.	date	revision
6	SEPT.19/4	RE-ISSUE FOR SITE PLAN APPROVAL
5	JULY 9/24	RE-ISSUE FOR SITE PLAN APPROVAL
4	AUG.24/23	ISSUE FOR UDRP
3	MAR.28/23	RE-ISSUE PER CITY COMMENTS (1)
2	JUNE 15/21	ISSUE FOR SITE PLAN APPROVAL
1	MAR.28/21	ISSUE FOR REVIEW

North Arrow

Stamp

Contractor shall check and verify all dimensions on site and report all errors and/or omissions to the Consultant.
 Work to be done in accordance with all applicable codes and by-laws.
 Do not scale Drawing.
 Copyright reserved. This Drawing is the exclusive property of Levstek Consultants Inc. and shall not be used without consent.

Consultant
LEVSTEK CONSULTANTS
 LANDSCAPE ARCHITECTS
 1871 Hugh Creech Rd. Ottawa - Ontario - K0A 2W0
 613-826-5519

Client
brigil
 Project
 2858 DUMAURIER AVE
 OTTAWA ONTARIO

Drawing Title
LEVEL 5 PODIUM LANDSCAPE
 Drawn
 MGB
 Scale
 AS NOTED
 Drawing No.
 1183
 Project No.
 1183
 Drawing No.
 L1.02

007-12-21-0110

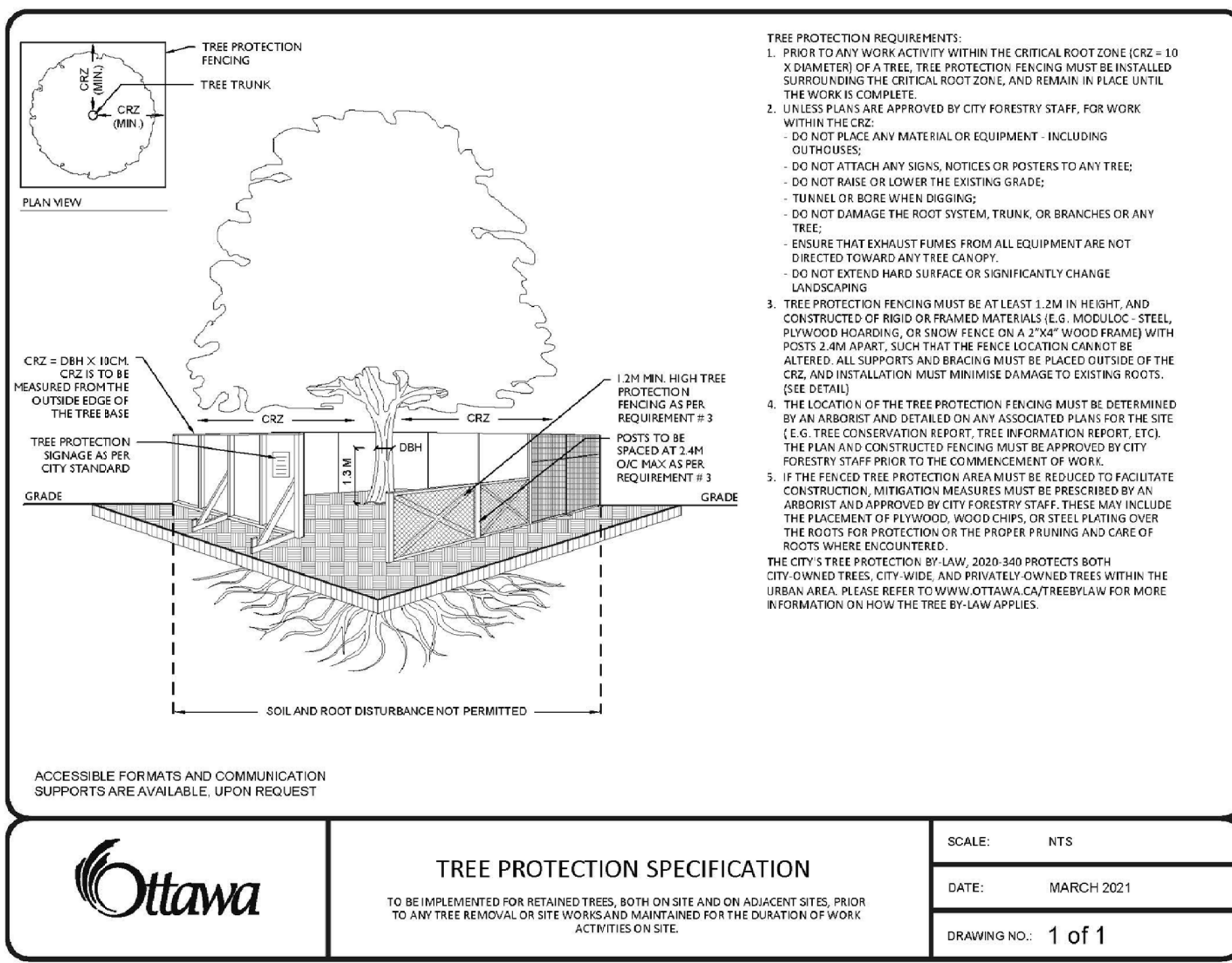

1 L2.01 TREE PROTECTION BARRIER NTS

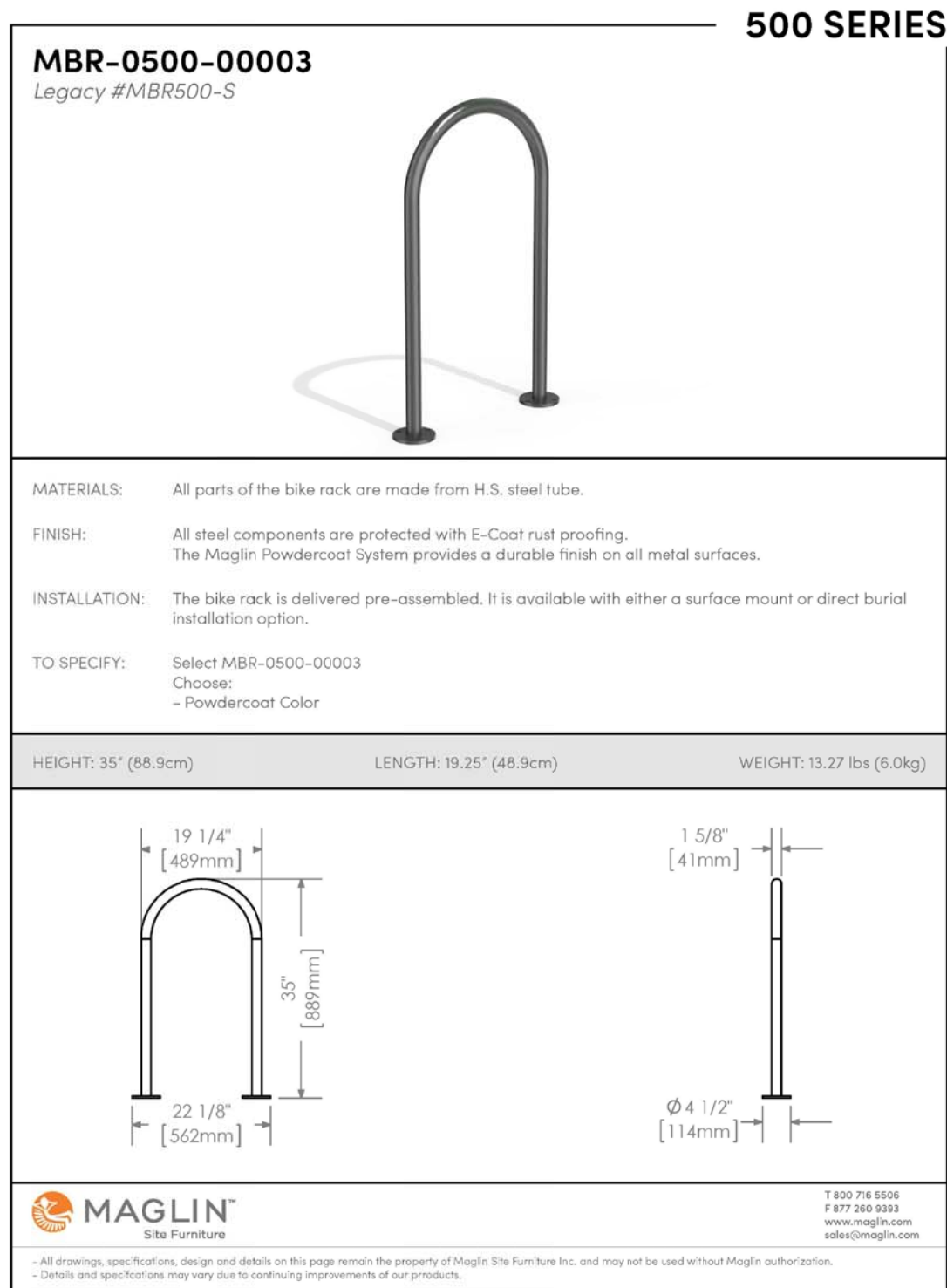

2 L2.01 BICYCLE RACK NTS

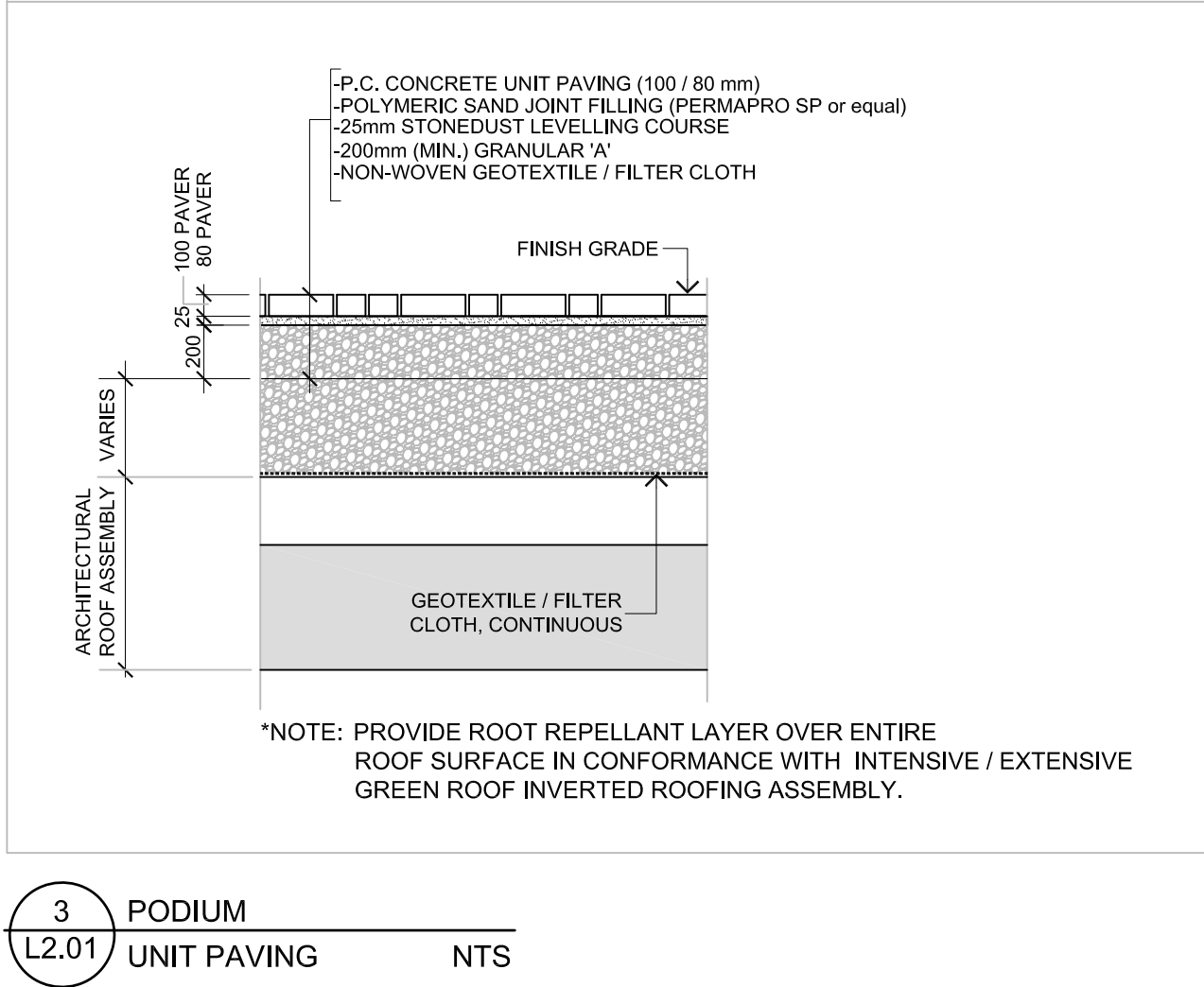

3 L2.01 PODIUM UNIT PAVING NTS

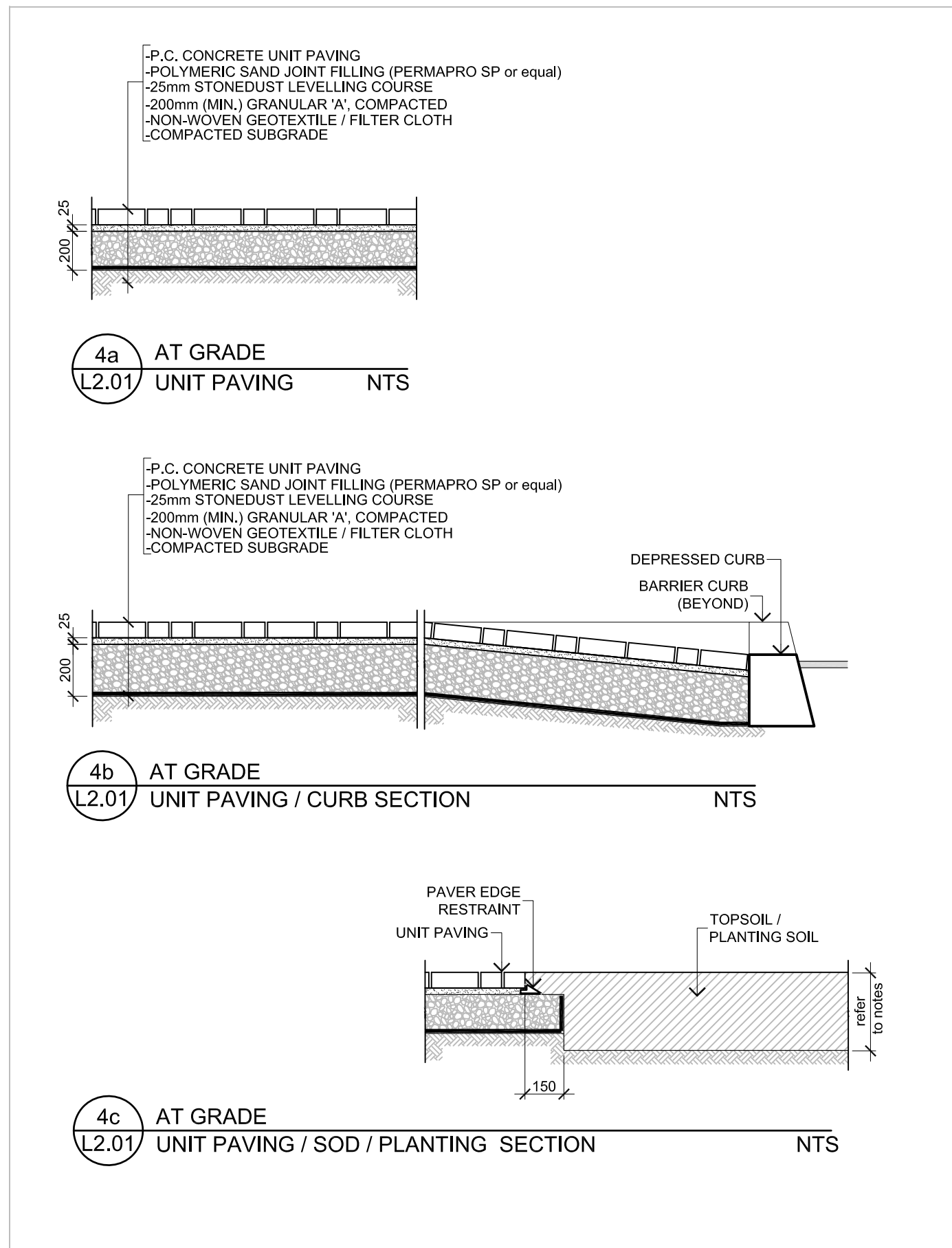

4 L2.01 AT GRADE UNIT PAVING DETAILS NTS

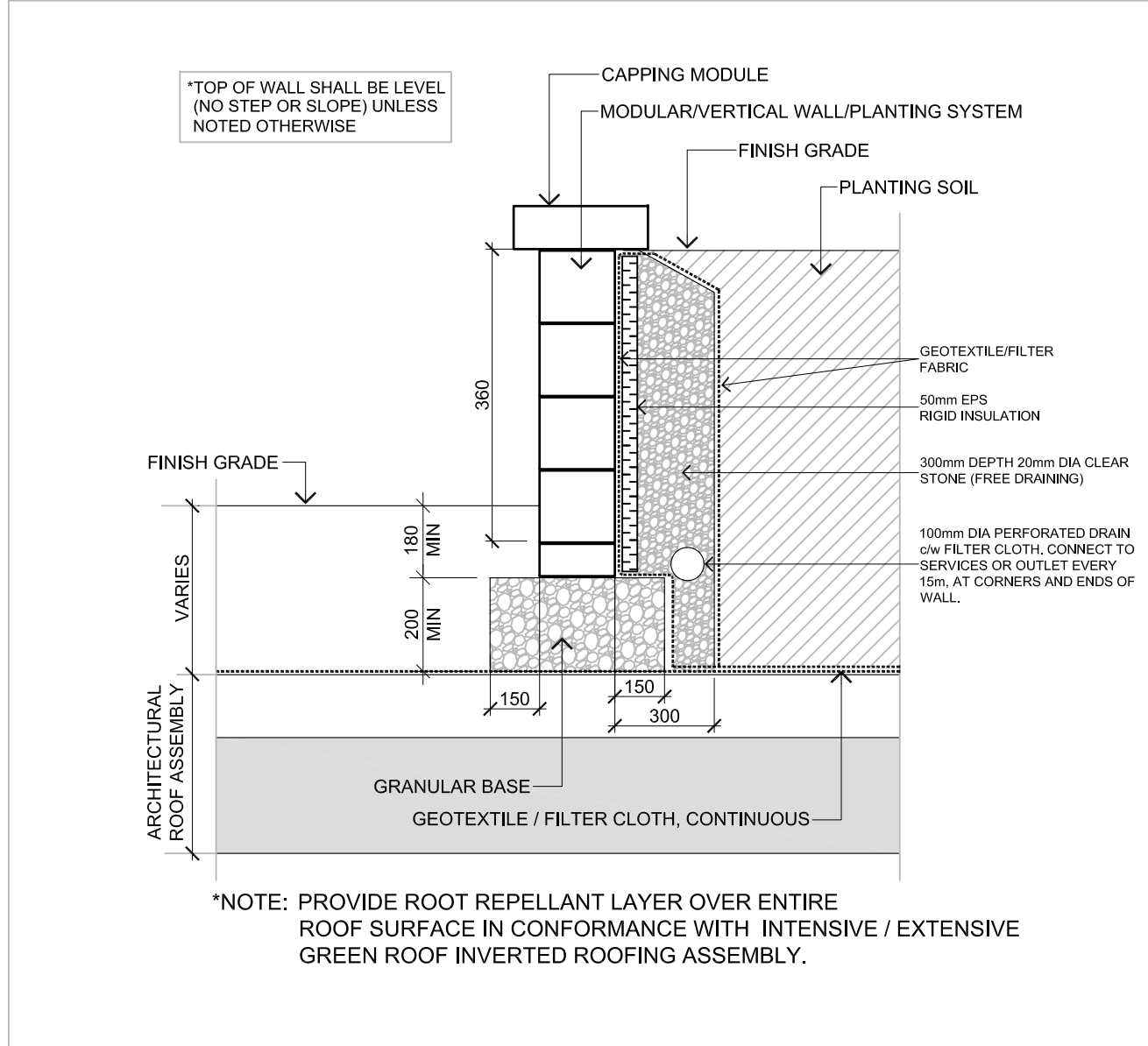

5 L2.01 PODIUM P.C. CONCRETE PLANTER WALL NTS

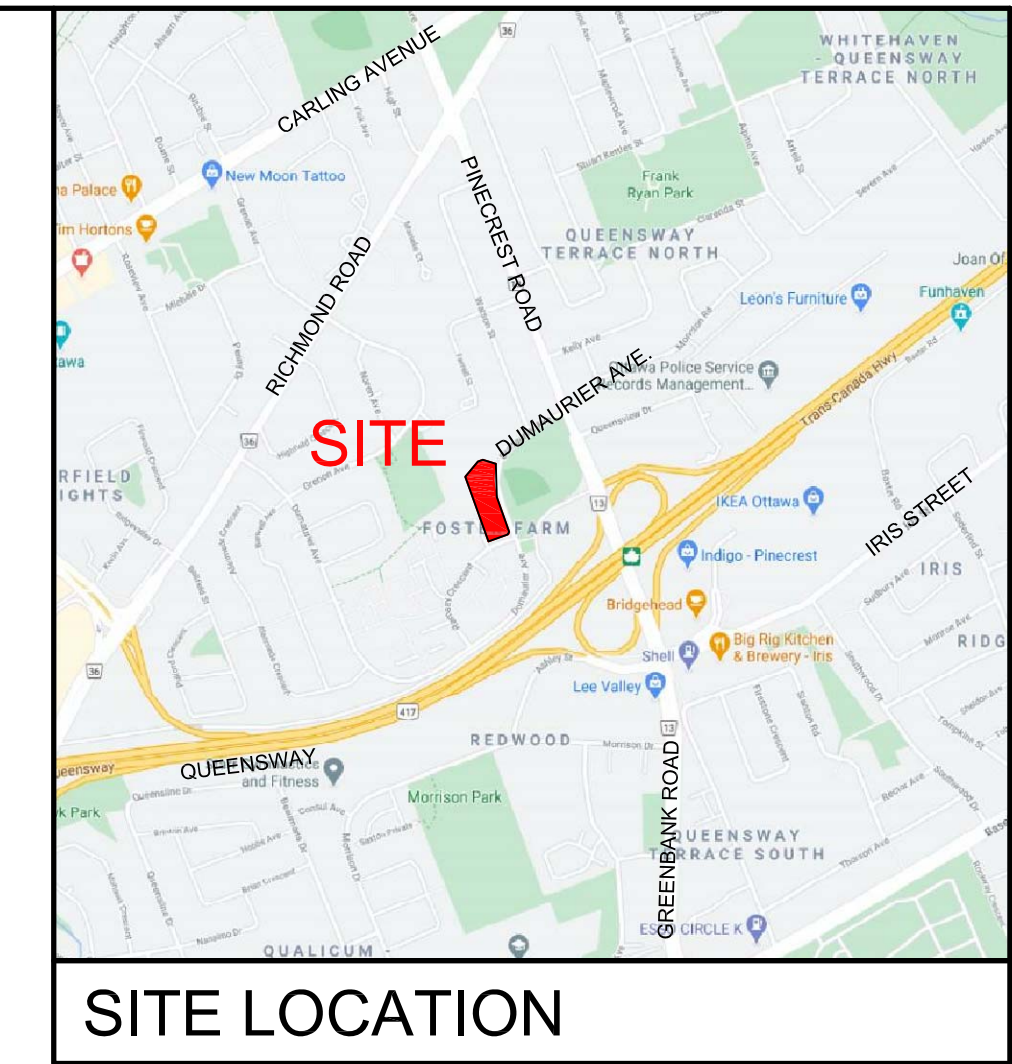

FOR APPROVAL ONLY

no.	date	revision
1	SEPT.1924	RE-ISSUE FOR SITE PLAN APPROVAL

North Arrow

Stamp

Contractor shall check and verify all dimensions on site and report all errors and/or omissions to the Consultant.

Work to be done in accordance with all applicable codes and by-laws.

Do not scale Drawing.

Copyright reserved. This Drawing is the exclusive property of Levstek Consultants Inc. and shall not be used without consent.

Consultant

LEVSTEK CONSULTANT'S
LANDSCAPE ARCHITECTS

5871 Hugh Crescent - Ottawa - Ontario - K0A 2N0
613 - 828 - 6318

Client

brigil

Project

2858 DUMAURIER AVE
OTTAWA ONTARIO

LANDSCAPE DETAILS

Drawn	MGB	Project No.	1183	Drawing No.	L2.01
Scale	AS SHOWN				

007-12-21-0110