

Responsibility / Copyright Reserved

The location of under/overground utilities and structures are not necessarily shown on the contract drawings, and/or where shown. The accuracy of the position of such utilities and structures is not guaranteed. The Contractor shall verify and be responsible to determine the exact location of all such utilities and structures and assumes all liability for any damage to them.

The Copyrights to all designs and drawings are the property of ARK Engineering and Development. Reproduction or use for any purpose other than that authorized by ARK Engineering and Development is forbidden.

Legend

- EXISTING SPOT ELEVATION
- PROPOSED ELEVATION
- PROPOSED SWALE ELEVATION
- PROPOSED DITCH ELEVATION
- PROPOSED SWALE AND/OR DITCH
- PROPOSED VERTICAL ELEVATION OF ROAD HIGH POINT
- PROPOSED VERTICAL ELEVATION OF ROAD LOW POINT
- % SLOPE PROPOSED DIRECTION OF FLOW
- PROPOSED HOUSE PERIMETER ELEVATION
- FF = 101.70 PROPOSED FINISHED FIRST FLOOR ELEVATION
- USF = 98.80 PROPOSED MINIMUM UNDERSIDE OF FOOTING AT FRONT OF HOUSE
- MAJOR SYSTEM DRAINAGE
- EXISTING TERRACING 3:1 MAX.
- PROPOSED RIP-RAP TREATMENT AS PER OPSD 810.010

Key Plan

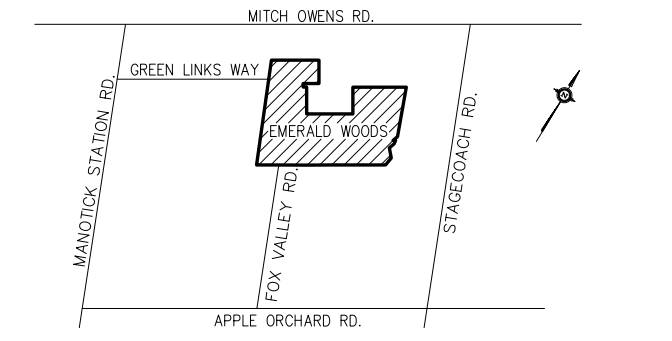

Revision

0.	SUBMITTED FOR APPROVAL	JUN 21/21
1.	REVISED	JAN 21/22

Seal

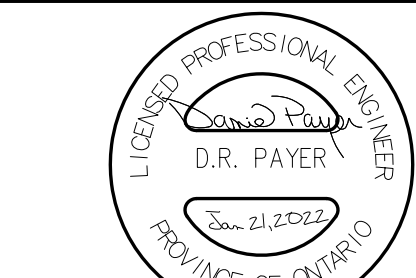

Client / Project

9287043 CANADA CORPORATION
EMERALD SUBDIVISION

Drawing Name

GRADING PLAN

Scale

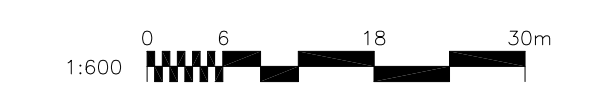

Revision
REV-1

Sheet
5 of 15

Drawing No.
GP-3

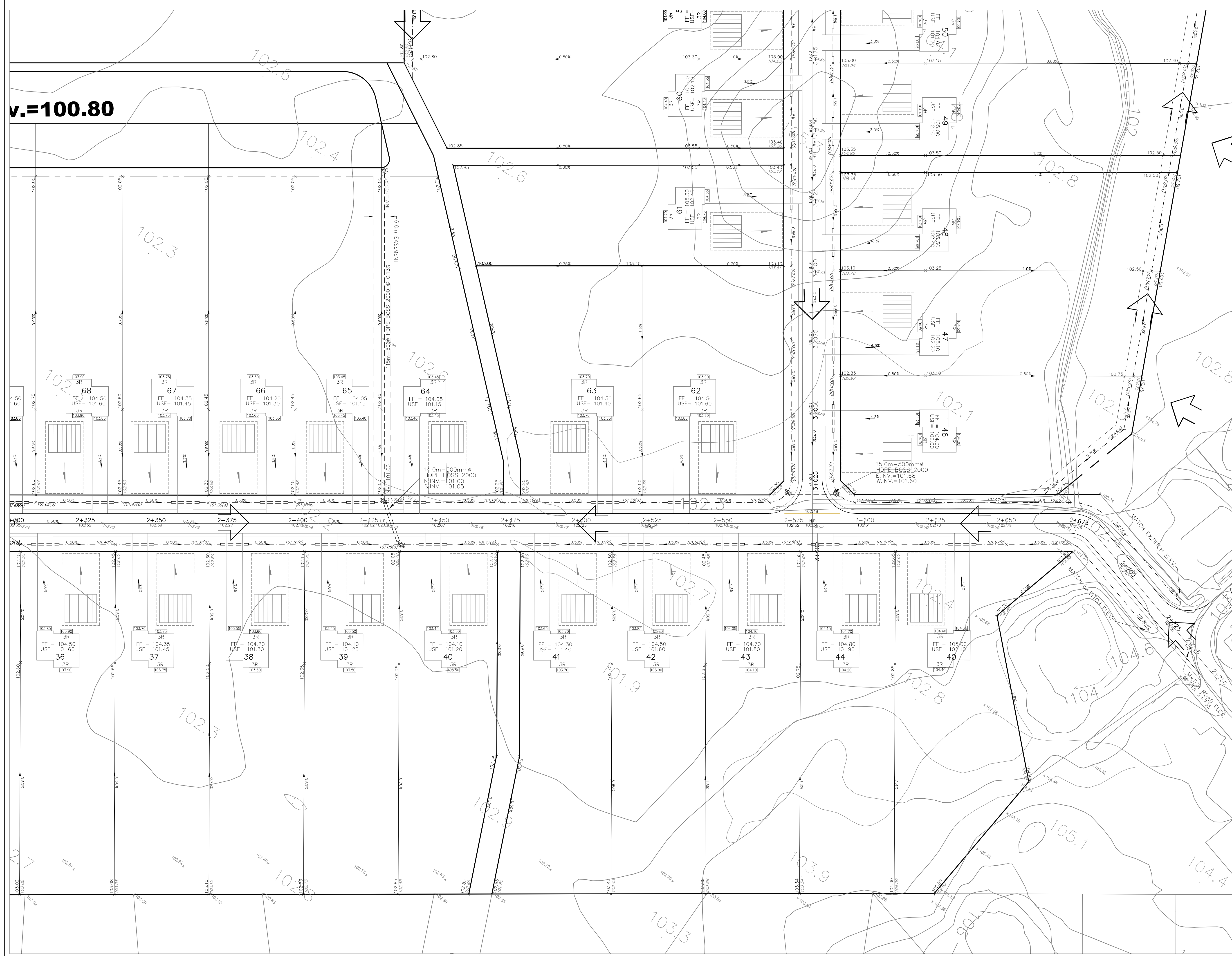

v.=100.80