

PROJECT TEAM

ARCHITECT
HOBIN ARCHITECTURE
PATRICK BISSON
T 613-238-7200

PLANNING
FOTENH CONSULTANTS INC.
STEPHANIE MORRIS
T 613-730-5709

CIVIL
J.L. RICHARDS
LUCIE DALRYMPLE
T 613-913-4368

LANDSCAPE ARCHITECT
CSW LANDSCAPE ARCHITECTS
SHERI EDWARDS
T 613-729-4536

TRANSPORTATION
PARSONS
MARK BAKER
T 613-222-8234

ENVIRONMENTAL
GRADIENT WIND ENGINEERING
JOSHUA FOSTER
T 613-836-0634

SURVEYOR
STANTEC
BRIAN WEBSTER
T 613-229-7644

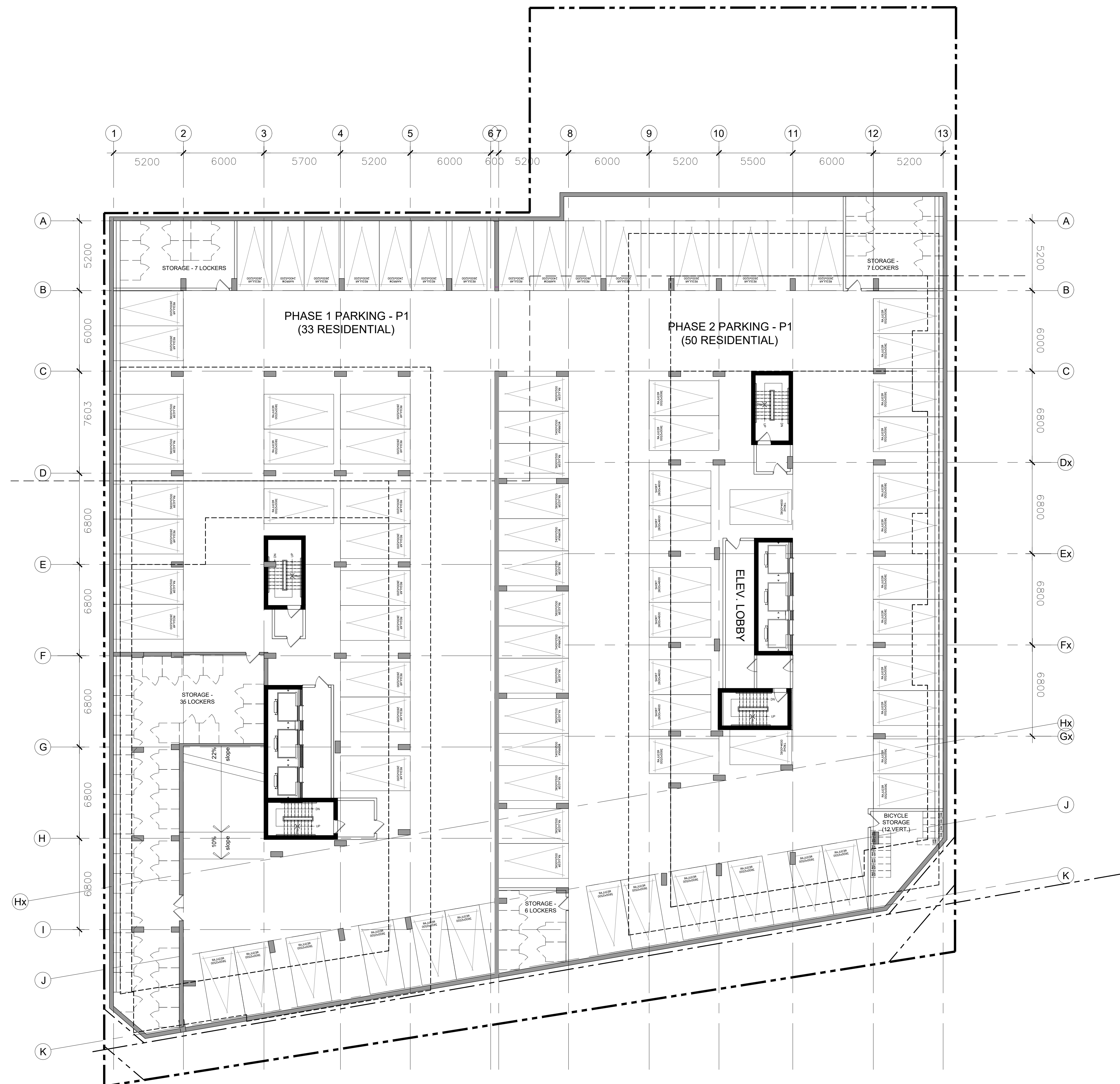

no.	date	revision

It is the responsibility of the appropriate contractor to check and verify all dimensions on site and report all errors and/or omissions to the architect.

All contractors must comply with all pertinent codes and by-laws.

Do not scale drawings.

This drawing may not be used for construction until signed.

Copyright reserved.

Hobin Architecture Incorporated
63 Parnell Street
Ottawa, Ontario
Canada K1S 3K7
T: 613-238-7200
F: 613-235-2005
E: mail@hobinarc.com
hobinarc.com



HOBIN ARCHITECTURE

PROJECT/LOCATION:
TAGGART REALTY
1081 CARLING AVE.
OTTAWA, ON

DRAWING TITLE:
PARKING LEVEL P4

DRAWN BY: PB	DATE: 22.10.19	SCALE: 1:150
PROJECT: 2117		DRAWING NO.:
PROJECT:		A201
DRAWING NO.:		REVISION NO.:

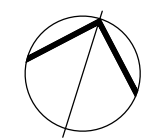

PROJECT TEAM

ARCHITECT
HOBIN ARCHITECTURE
PATRICK BISSON
T 613-238-7200

PLANNING
FOTENH CONSULTANTS INC.
STEPHANIE MORRIS
T 613-790-5709

CIVIL
J.L. RICHARDS
LUCIE DALRYMPLE
T 613-913-4368

LANDSCAPE ARCHITECT
CSW LANDSCAPE ARCHITECTS
SHERI EDWARDS
T 613-729-4536

TRANSPORTATION
PARSONS
MARK BAKER
T 613-222-8234

ENVIRONMENTAL
GRADIENT WIND ENGINEERING
JOSHUA FOSTER
T 613-836-0634

SURVEYOR
STANTEC
BRIAN WEBSTER
T 613-229-7644

no.	date	revision

It is the responsibility of the appropriate contractor to check and verify all dimensions on site and report all errors and/or omissions to the architect.

All contractors must comply with all pertinent codes and by-laws.

Do not scale drawings.

This drawing may not be used for construction until signed.

Copyright reserved.

Hobin Architecture Incorporated
63 Parnell Street
Ottawa, Ontario
Canada K1S 3K7
T: 613-238-7200
F: 613-235-2005
E: mail@hobinarc.com
hobinarc.com



PROJECT/LOCATION:
TAGGART REALTY
1081 CARLING AVE.
OTTAWA, ON

DRAWING TITLE:
PARKING LEVEL P3

DRAWN BY: PB	DATE: 22.10.19	SCALE: 1:150
PROJECT: 2117		DRAWING NO.: A202
REVISION NO.:		

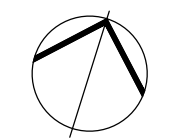
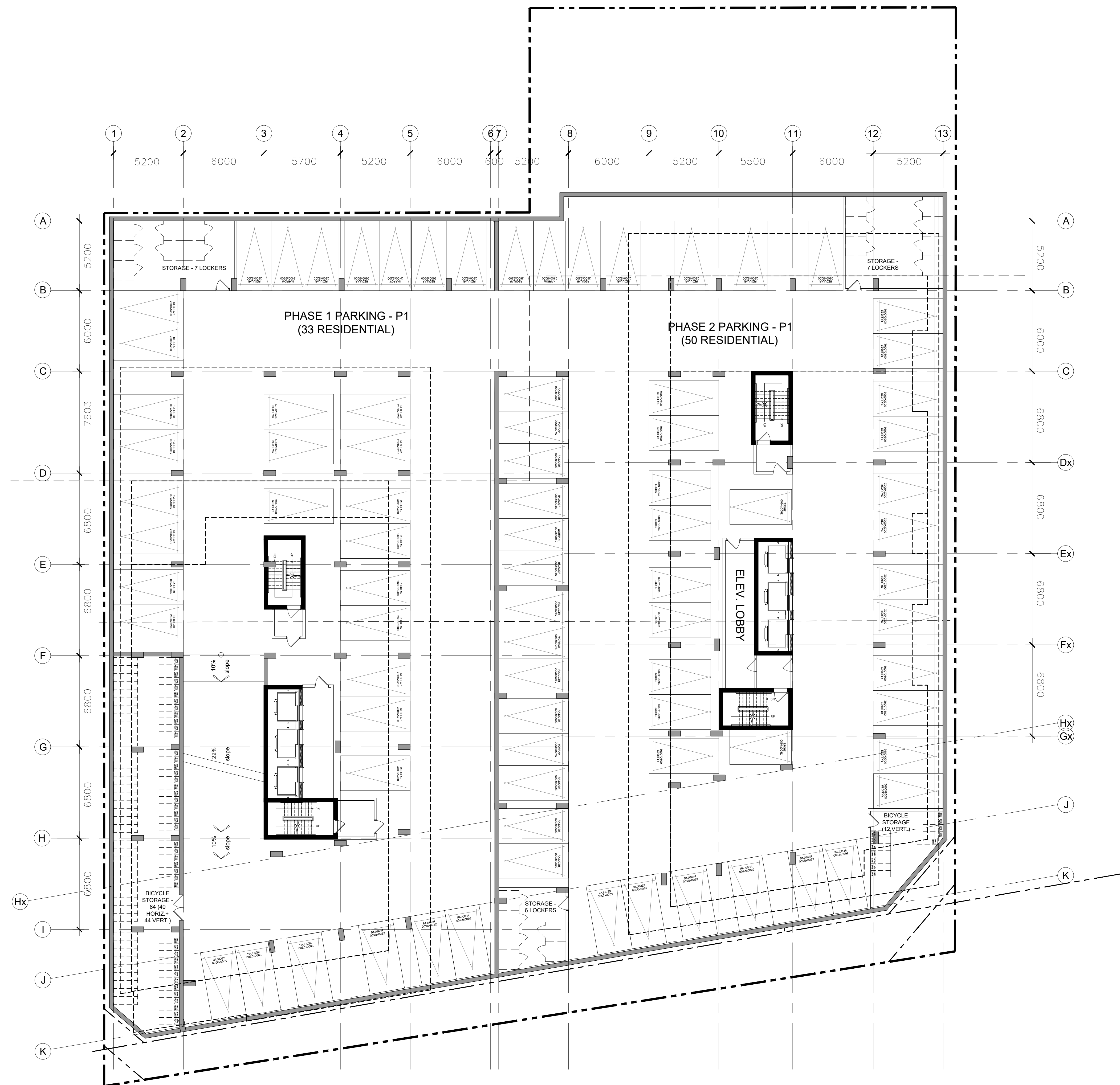

1 PARKING LEVEL P3
A0.01 1:150

None

PROJECT TEAM

ARCHITECT
HOBIN ARCHITECTURE
PATRICK BISSON
T 613-238-7200

PLANNING
FOTENH CONSULTANTS INC.
STEPHANIE MORRIS
T 613-790-5709

CIVIL
J.L. RICHARDS
LUCIE DALRYMPLE
T 613-913-4368

LANDSCAPE ARCHITECT
CSW LANDSCAPE ARCHITECTS
SHERI EDWARDS
T 613-729-4536

TRANSPORTATION
PARSONS
MARK BAKER
T 613-222-8234

ENVIRONMENTAL
GRADIENT WIND ENGINEERING
JOSHUA FOSTER
T 613-836-0634

SURVEYOR
STANTEC
BRIAN WEBSTER
T 613-229-7644

no.	date	revision

It is the responsibility of the appropriate contractor to check and verify all dimensions on site and report all errors and/or omissions to the architect.

All contractors must comply with all pertinent codes and by-laws.

Do not scale drawings.

This drawing may not be used for construction until signed.

Copyright reserved.

Hobin Architecture Incorporated
63 Parnell Street
Ottawa, Ontario
Canada K1S 3K7
T: 613-238-7200
F: 613-235-2065
E: mail@hobinarc.com
hobinarc.com

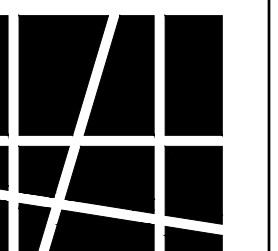

HOBIN
ARCHITECTURE

PROJECT/LOCATION:
TAGGART REALTY
1081 CARLING AVE.
OTTAWA, ON

DRAWING TITLE:
PARKING LEVEL P2

DRAWN BY: PB **DATE:** 22.10.19 **SCALE:** 1:150

PROJECT: 2117

DRAWING NO.: A203

REVISION NO.:

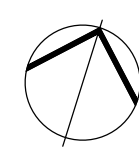
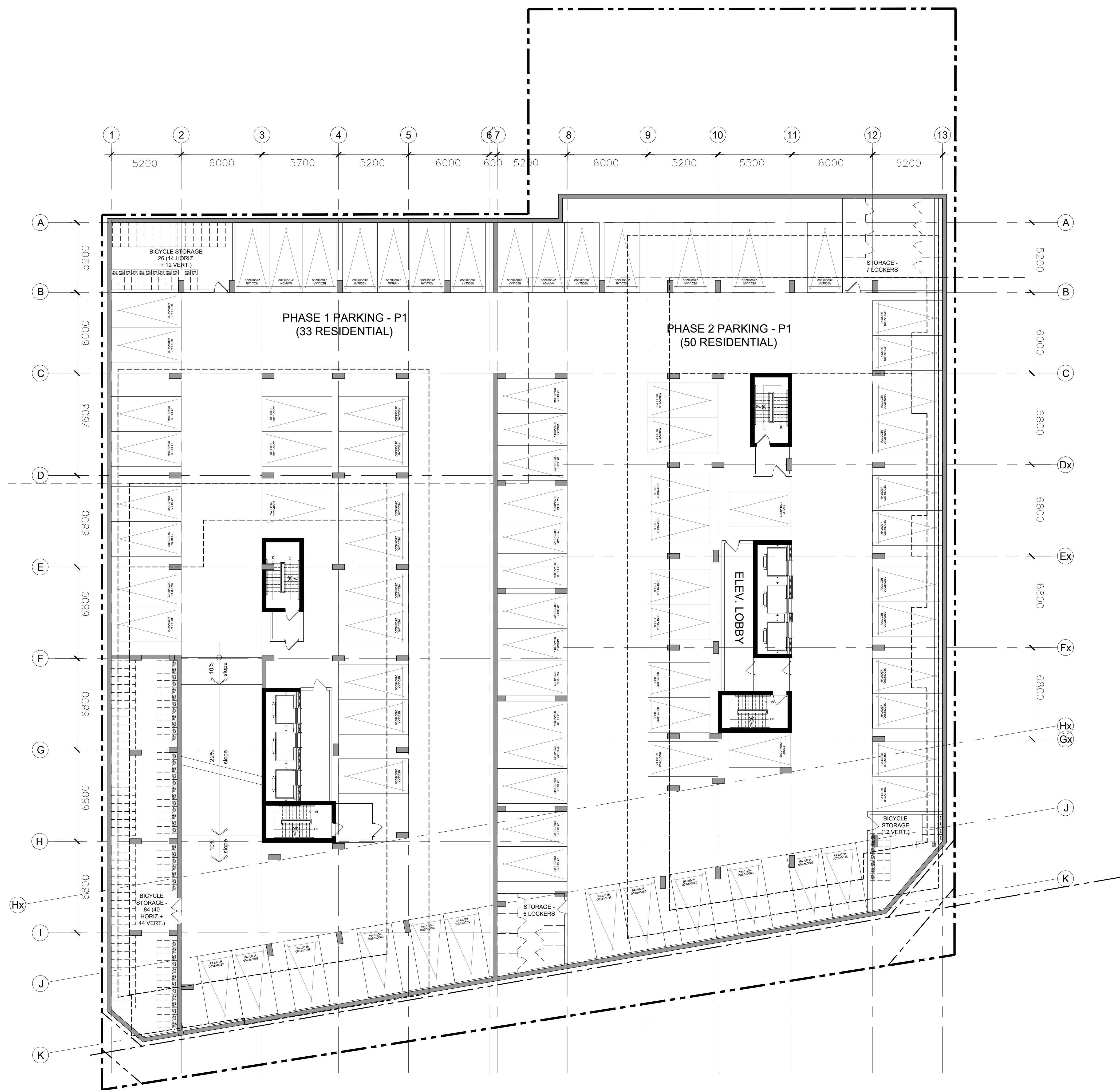

PROJECT TEAM

ARCHITECT
HOBIN ARCHITECTURE
PATRICK BISSON
T: 613-238-7200

PLANNING
FOTENI CONSULTANTS INC.
STEPHANIE MORRIS
T: 613-790-5709

CIVIL
J.L. RICHARDS
LUCIE DALRYMPLE
T: 613-913-4368

LANDSCAPE ARCHITECT
CSW LANDSCAPE ARCHITECTS
SHERI EDWARDS
T: 613-729-4536

TRANSPORTATION
PARSONS
MARK BAKER
T: 613-222-8234

ENVIRONMENTAL
GRADIENT WIND ENGINEERING
JOSHUA FOSTER
T: 613-836-0634

SURVEYOR
STANTEC
BRIAN WEBSTER
T: 613-229-7644

no.	date	revision

It is the responsibility of the appropriate contractor to check and verify all dimensions on site and report all errors and/or omissions to the architect.

All contractors must comply with all pertinent codes and by-laws.

Do not scale drawings.

This drawing may not be used for construction until signed.

Copyright reserved.

Hobin Architecture Incorporated

63 Parnell Street
Ottawa, Ontario
Canada K1S 3K7

T: 613-238-7200
F: 613-235-2065
E: mail@hobinarc.com

hobinarc.com
HOBIN
ARCHITECTURE

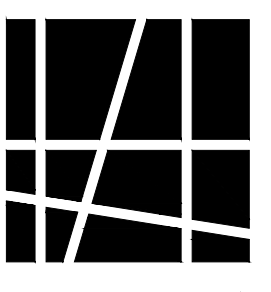

PROJECT/LOCATION:
TAGGART REALTY
1081 CARLING AVE.
OTTAWA, ON

DRAWING TITLE:
PARKING LEVEL P1

DRAWN BY: PB	DATE: 22.10.19	SCALE: 1:150
-----------------	-------------------	-----------------

PROJECT: 2117

DRAWING NO.:

A204

REVISION NO.:

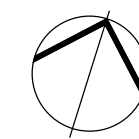
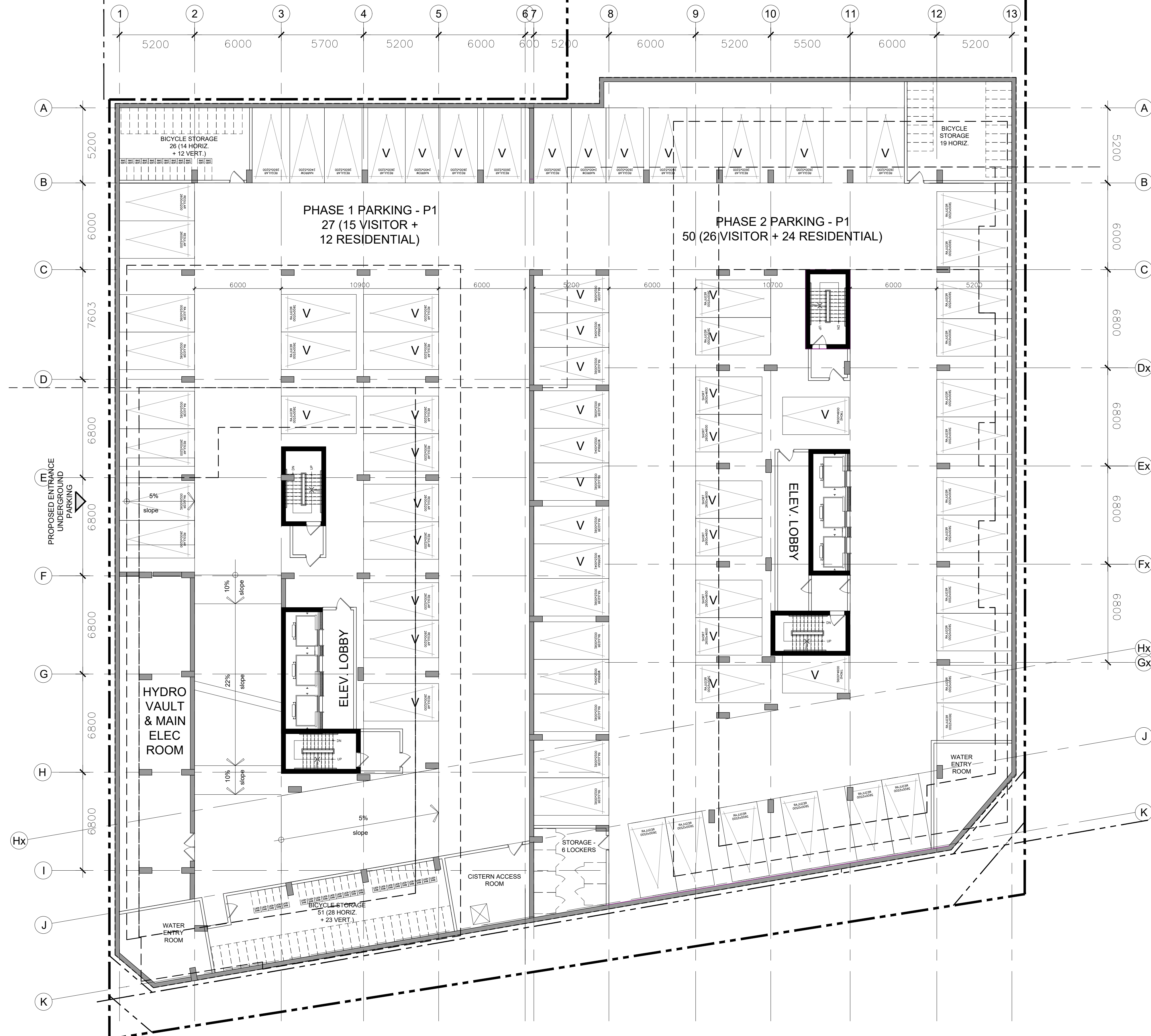

1 PARKING LEVEL P1
A0.01 1:150

None

PROJECT TEAM

ARCHITECT
HOBIN ARCHITECTURE
PATRICK BISSON
T 613-238-7200

PLANNING
FOTENNI CONSULTANTS INC.
STEPHANIE MORRIS
T 613-730-5709

CIVIL
J.L. RICHARDS
LUCIE DALRYMPLE
T 613-913-4368

LANDSCAPE ARCHITECT
CSW LANDSCAPE ARCHITECTS
SHERI EDWARDS
T 613-729-4536

TRANSPORTATION
PARSONS
MARK BAKER
T 613-222-8234

ENVIRONMENTAL
GRADIENT WIND ENGINEERING
JOSHUA FOSTER
T 613-836-0634

SURVEYOR
STANTEC
BRIAN WEBSTER
T 613-229-7644

no.	date	revision

It is the responsibility of the appropriate contractor to check and verify all dimensions on site and report all errors and/or omissions to the architect.

All contractors must comply with all pertinent codes and by-laws.

Do not scale drawings.

This drawing may not be used for construction until signed.

Copyright reserved.

Hobin Architecture Incorporated
63 Parnell Street
Ottawa, Ontario
Canada K1S 3K7
T: 613-238-7200
F: 613-235-2065
E: mail@hobinarc.com
hobinarc.com

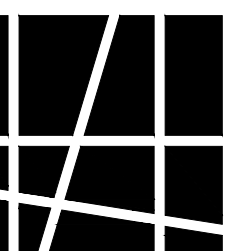

HOBIN
ARCHITECTURE

PROJECT/LOCATION:
TAGGART REALTY
1081 CARLING AVE.
OTTAWA, ON

DRAWING TITLE:
TYPICAL TOWER
LEVEL 1 PLAN

DRAWN BY: PB

DATE: 22.10.19

SCALE: 1:150

PROJECT: 2117

DRAWING NO.:

A207

REVISION NO.:

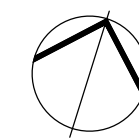
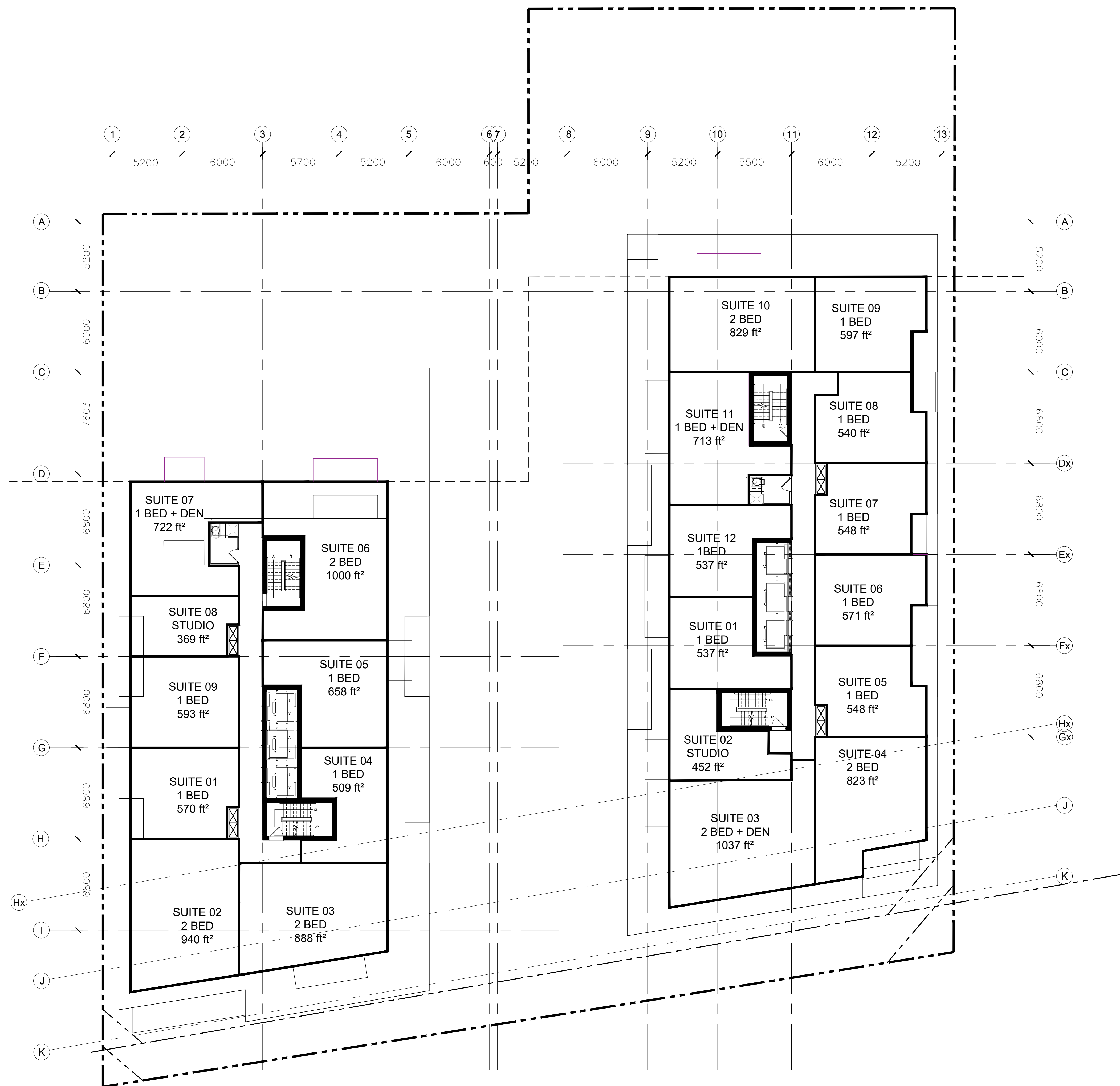

1 TYPICAL TOWER LEVEL 1 PLAN
A0.01 1:150

PROJECT TEAM

ARCHITECT
HOBIN ARCHITECTURE
PATRICK BISSON
T: 613-238-7200

PLANNING
FOTENN CONSULTANTS INC.
STEPHANIE MORRIS
T: 613-730-5709

CIVIL
J.L. RICHARDS
LUCIE DALRYMPLE
T: 613-913-4368

LANDSCAPE ARCHITECT
CSW LANDSCAPE ARCHITECTS
SHERI EDWARDS
T: 613-729-4536

TRANSPORTATION
PARSONS
MARK BAKER
T: 613-222-8234

ENVIRONMENTAL
GRADIENT WIND ENGINEERING
JOSHUA FOSTER
T: 613-836-0634

SURVEYOR
STANTEC
BRIAN WEBSTER
T: 613-229-7644

no.	date	revision

It is the responsibility of the appropriate contractor to check and verify all dimensions on site and report all errors and/or omissions to the architect.

All contractors must comply with all pertinent codes and by-laws.

Do not scale drawings.

This drawing may not be used for construction until signed.

Copyright reserved.

Hobin Architecture Incorporated
63 Parnell Street
Ottawa, Ontario
Canada K1S 3K7
T: 613-238-7200
P: 613-235-2005
E: mail@hobinarc.com
hobinarc.com

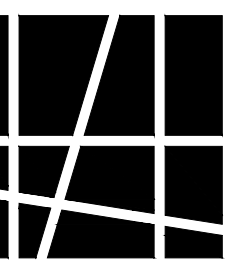

HOBIN
ARCHITECTURE

PROJECT/LOCATION:
TAGGART REALTY
1081 CARLING AVE.
OTTAWA, ON

DRAWING TITLE:

TYPICAL TOWER
LEVEL 2 PLAN

DRAWN BY: DATE: SCALE:

PB 22.08.15 1:150

PROJECT:

2117

DRAWING NO.:

A208

REVISION NO.:

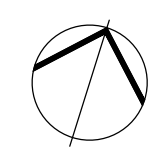
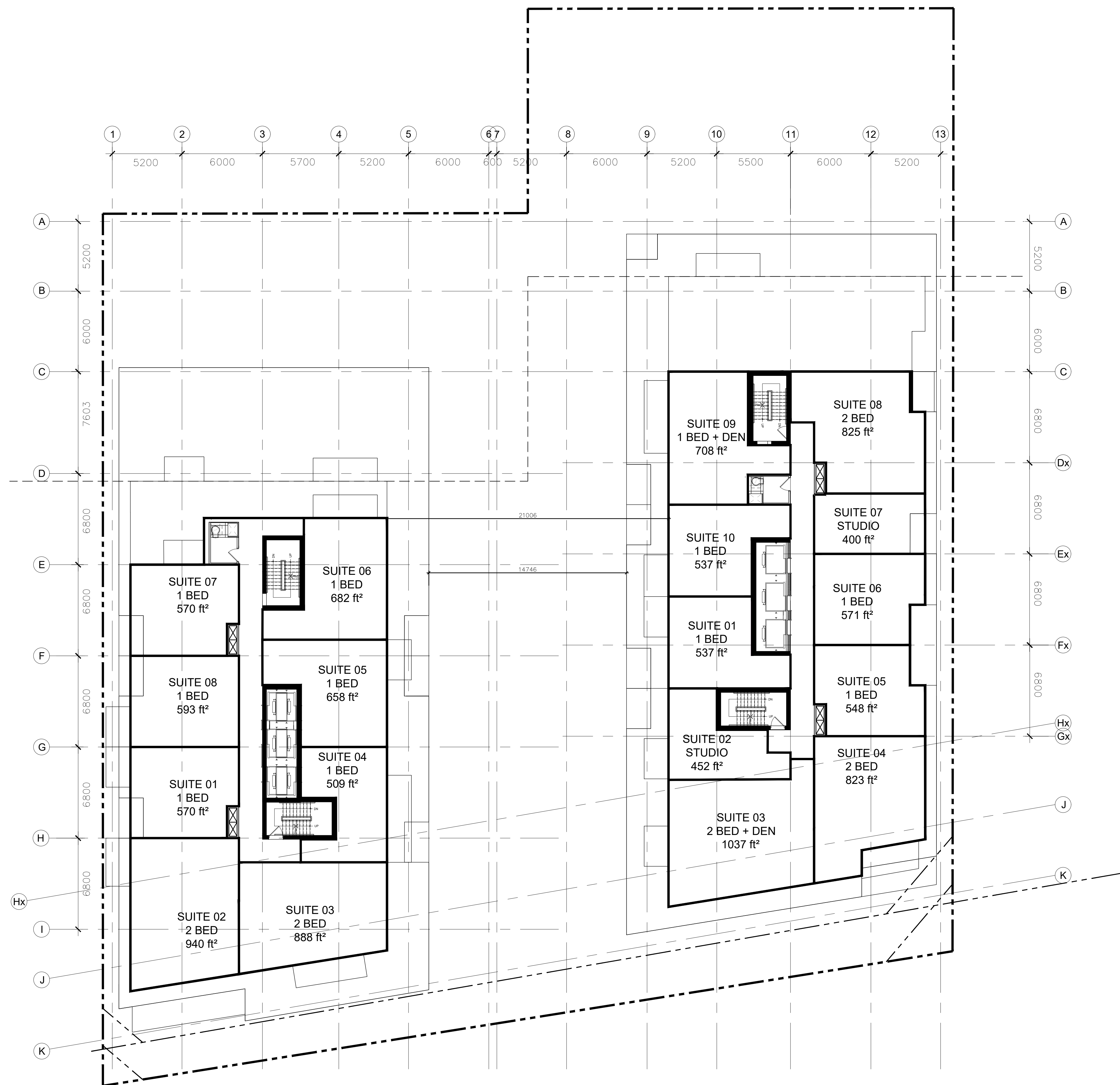

1 TYPICAL TOWER LEVEL 2 PLAN
A0.01 1:150