

PROJECT TEAM

ARCHITECT
HOBIN ARCHITECTURE
PATRICK BISSON
T 613-238-7200

PLANNING
FOTENI CONSULTANTS INC.
STEPHANIE MORRIS
T 613-730-5709

CIVIL
J.L. RICHARDS
LUCIE DALRYMPLE
T 613-913-4368

LANDSCAPE ARCHITECT
CSW LANDSCAPE ARCHITECTS
SHERI EDWARDS
T 613-729-4536

TRANSPORTATION
PARSONS
MARK BAKER
T 613-222-8234

ENVIRONMENTAL
GRADIENT WIND ENGINEERING
JOSHUA FOSTER
T 613-836-6634

SURVEYOR
STANLEY
BRIAN WEBSTER
T 613-229-7744

DRAFT

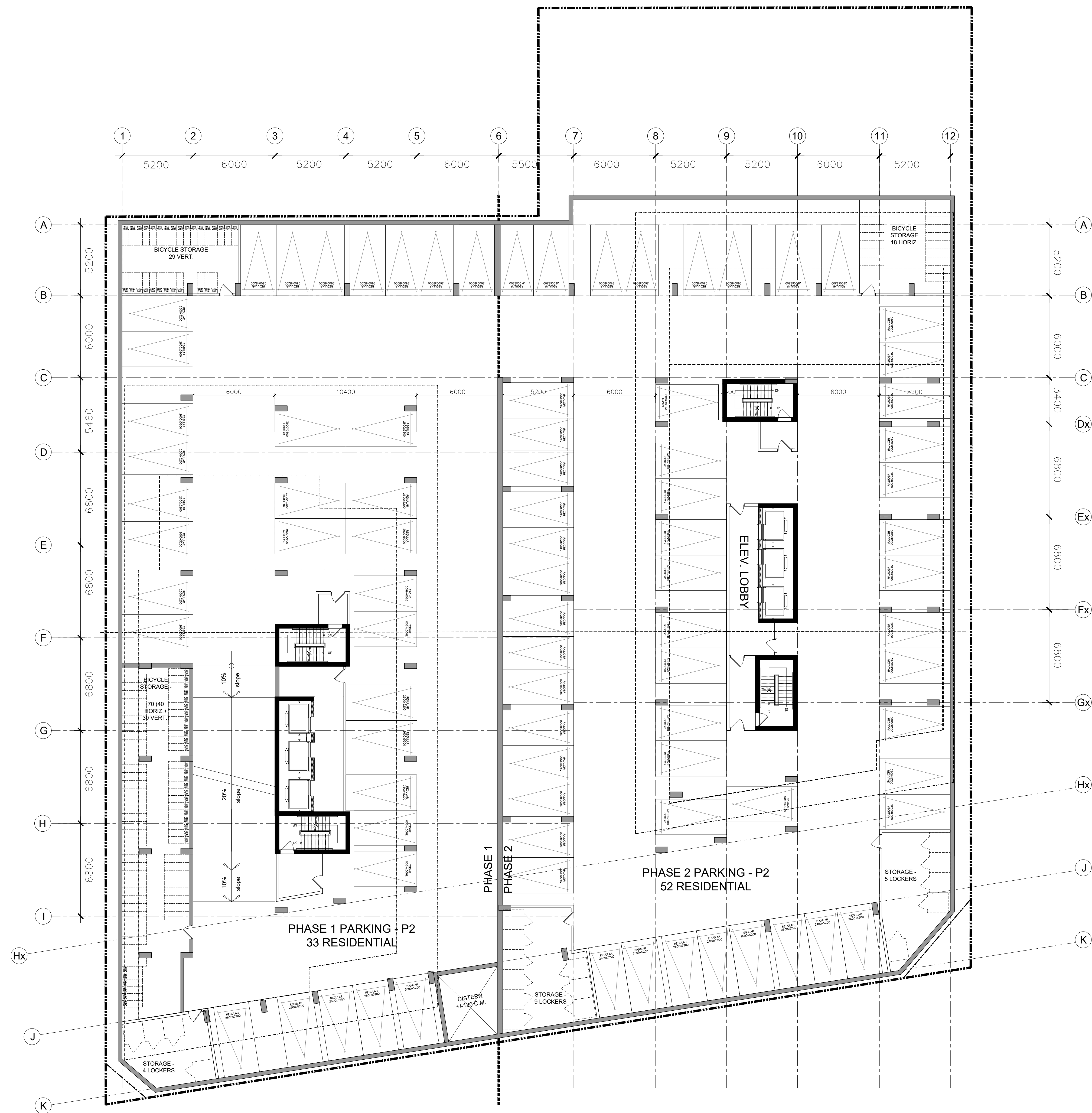

no.	date	revision
2	21-08-27	ISSUED FOR REZONING
1	21-06-08	CITY OF OTTAWA PRECONSULTATION

It is the responsibility of the appropriate contractor to check and verify all dimensions on site and report all errors and/or omissions to the architect.

All contractors must comply with all pertinent codes and by-laws.

Do not scale drawings.

This drawing may not be used for construction until signed.

Copyright reserved.

Hobin Architecture Incorporated
63 Parnell Street
Ottawa, Ontario
Canada K1S 3K7
T: 613-238-7200
F: 613-235-2005
E: mail@hobinarc.com
hobinarc.com

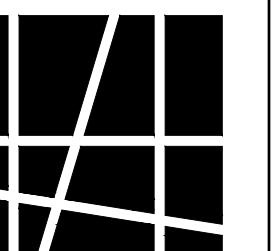

HOBIN
ARCHITECTURE

PROJECT/LOCATION:
TAGGART REALTY
1081 CARLING AVE.
OTTAWA, ON

DRAWING TITLE:
PARKING LEVEL P2

DRAWN BY: PB **DATE:** 21.08.27 **SCALE:** 1:150

PROJECT: 2117

DRAWING NO.: A203

REVISION NO.:

