

LEGEND:

- EXISTING PROPERTY LINE TO REMAIN
- - - PROPOSED EASEMENT
- ▾ PROPOSED TERRACING (3:1 MIN.)
- ▾ PROPOSED DOOR ENTRANCE/EXIT
- +50.00 PROPOSED ELEVATION
- +50.00HP PROPOSED HIGH POINT ELEVATION
- +50.00SW PROPOSED SWALE ELEVATION
- +50.00EX MATCH INTO EXISTING ELEVATION
- +70.19 EXISTING ELEVATION
- ➔ PROPOSED OVERLAND MAJOR FLOW ROUTE
- PROPOSED SILT FENCE AS PER OPSD 219.110
- PROPOSED 100MM PERFORATED SUBMERGENT
- PROPOSED STORM SEWER
- PROPOSED SANITARY SEWER
- PROPOSED WATERMAIN
- EXISTING SANITARY SEWER
- EXISTING WATERMAIN
- PROPOSED CATCHBASIN/HOLE/CATCHBASIN
- PROPOSED CURB STOP
- PROPOSED PIPE INSULATION
- PROPOSED 100 YEAR HIGH WATER LEVEL
- STORM WATERSHED EXTENT
- WS-XX WATERSHED NAME
- AREA RUNOFF COEFFICIENT
- AREA AREA IN HECTARES
- PROPOSED GRASS AREA
- PROPOSED CONCRETE FEATURES/SLAB
- PROPOSED HEAVY DUTY ASPHALT
- PROPOSED LIGHT DUTY ASPHALT
- PROPOSED GRAVEL AREA
- PROPOSED RIP RAP AS PER OPSD 810.010
- PROPOSED WATER METER
- PROPOSED ACCESS GATE
- PROPOSED GROWING FIELD

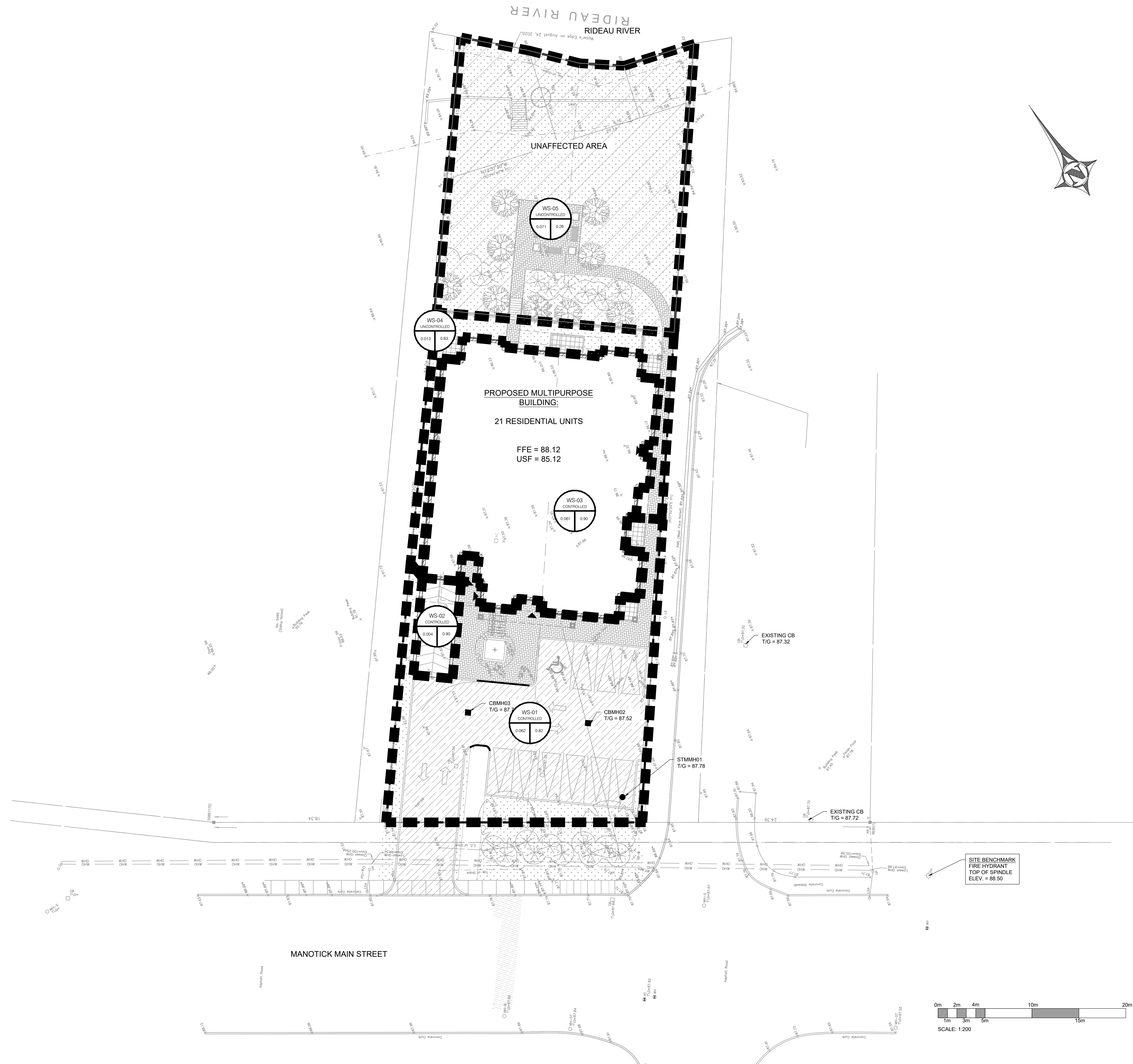

COPYRIGHT RESERVED
THE CONTRACTOR SHALL VERIFY AND BE RESPONSIBLE OF ALL DIMENSIONS. DO NOT SCALE THE DRAWING. ANY ERRORS OR OMISSIONS SHALL BE REPORTED TO BLANCHARD LETENDRE ENGINEERING LTD. WITHOUT DELAY. THE CONTRACTOR'S ALL DESIGN AND DRAWINGS ARE THE PROPERTY OF BLANCHARD LETENDRE ENGINEERING LTD. REPRODUCTION OR USE FOR ANY PURPOSE OTHER THAN THAT AUTHORIZED BY BLANCHARD LETENDRE ENGINEERING LTD. IS STRICTLY PROHIBITED.

ENGINEERING STAMP

#3	
#7	
#6	
#5	
#4	
#3	ISSUED FOR SPA 12/10/2021
#2	ISSUED FOR SPA 06/08/2021
#1	ISSUED FOR SPA 10/03/2021
NO. REVISION	DATE (DDMMYYYY)

BLANCHARD LETENDRE ENGINEERING
757, Notre Dame, Local 42, Embury, Ontario, K3A 1M1
(416) 693-0700

CLIENT:
12213559 CANADA INC.
996-B ST. AUGUSTIN RD.
EMBRUN, ON

PROJECT:
NEW MULTIPURPOSE DEVELOPMENT
5497 MANOTICK MAIN ST.
MANOTICK, ON

DRAWING:
POST DEVELOPMENT STORAGE AREA

PAPER FORMAT:	24x36
DRAWN BY:	BF + GB
CHECKED BY:	GB
DATE:	07-2021
SCALE:	1:200
PROJECT NUMBER:	20-261

PAGE:
C401