

Copyright Reserved

The Contractor shall verify and be responsible for all dimensions. DO NOT scale the drawing - any errors or omissions shall be reported to Stantec without delay.
The Copyrights to all designs and drawings are the property of Stantec. Reproduction or use for any purpose other than that authorized by Stantec is forbidden.

Legend

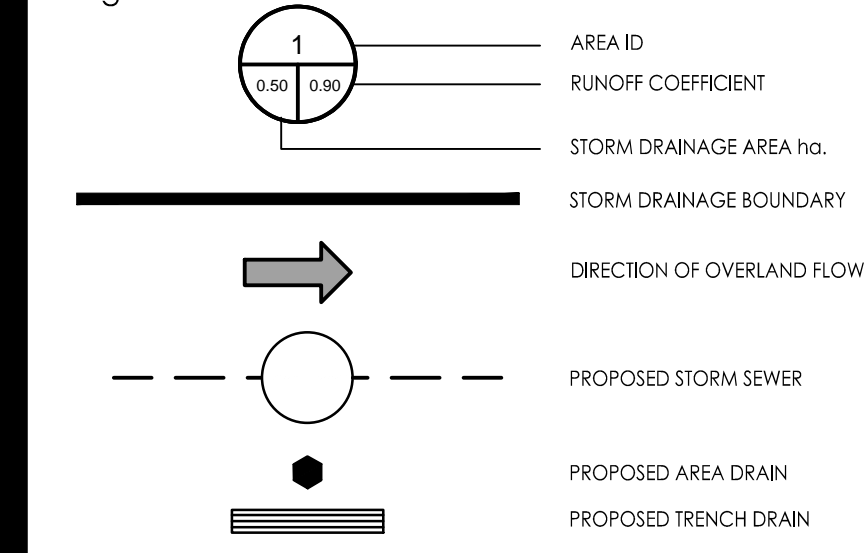

Notes

- ALL CATCH BASINS TO BE CONNECTED TO INTERNAL PLUMBING AND COLLECTED IN STORM WATER MANAGEMENT CISTERN. INSTALLATION BY OTHERS.
- INTERNAL PLUMBING AND SUMP PUMPS TO BE DESIGNED BY THE MECHANICAL CONSULTANT.
- STORMWATER MANAGEMENT TO BE PROVIDED THROUGH A 7.0m³ CISTERN LOCATED BELOW THE PARKING SLAB. CISTERN TO BE DESIGNED BY THE MECHANICAL CONSULTANT.
- ROOF TO BE EQUIPPED WITH RESTRICTED RELEASE ROOF DRAINS FOR ROOFTOP STORAGE. SCUPPERS TO ALLOW EMERGENCY OVERFLOW OVER 6" (150mm) STORAGE DEPTH.
- PROPOSED BUILDING SERVICE SIZES TO BE CONFIRMED WITH THE MECHANICAL CONSULTANT.

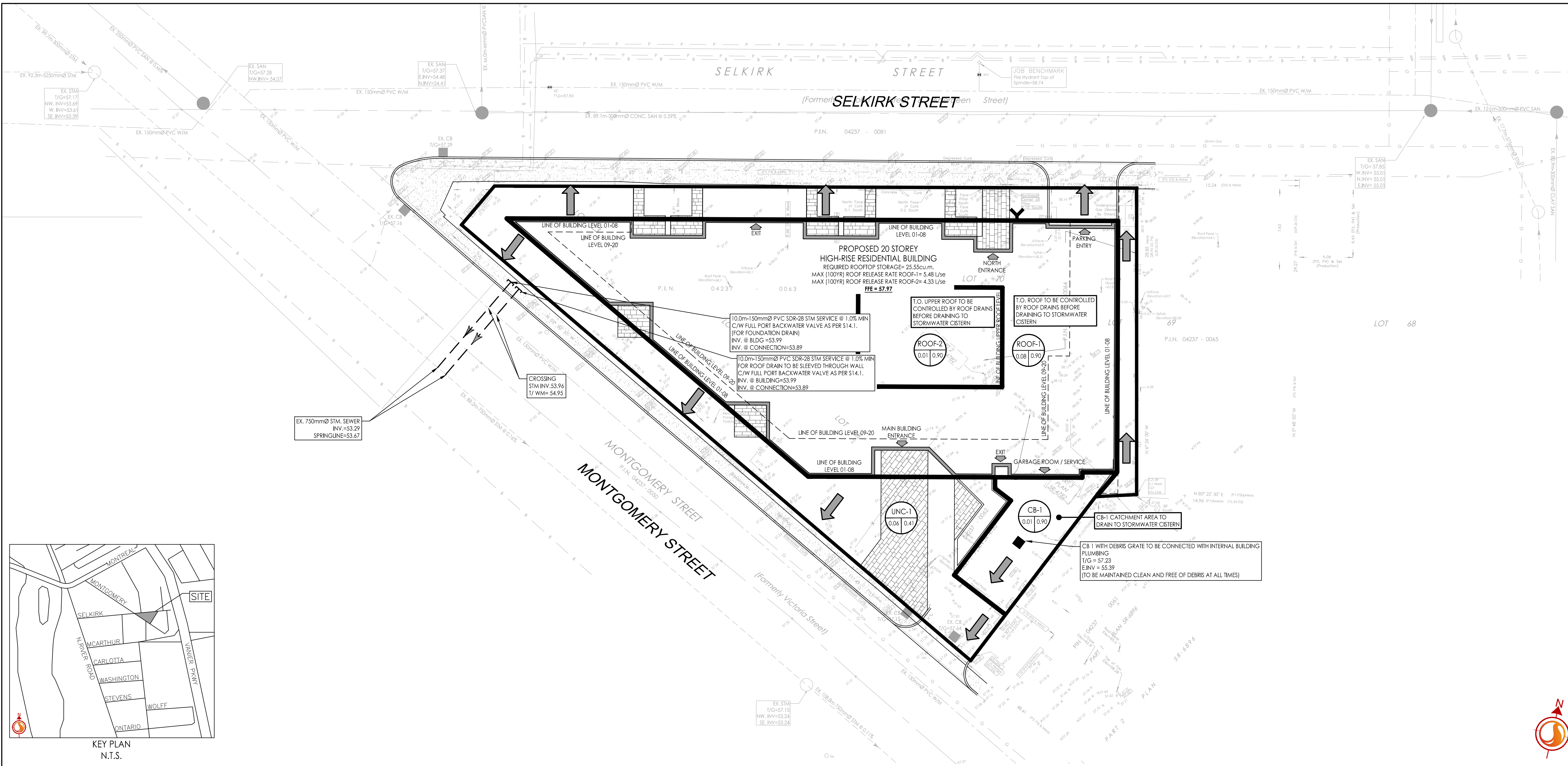

SCHEDULE OF ROOFTOP CONTROLS				
DRAIN TYPE	CATCHMENT AREA ID	# OF DRAINS	100YR PONDING DEPTH (m)	100YR RELEASE RATE TO CISTERN(L/s)
WATTS DRAIN (25% OPEN)	ROOF-1	6	0.140	5.48
WATTS DRAIN (25% OPEN)	ROOF-2	6	0.080	4.33

Revision	By	Appd.	YY.MM.DD
2 FOR SUBMISSION	AJ	ALG	21.12.17
1 FOR REVIEW	AJ	ALG	21.12.10

Permit-Seal

Client/Project

PROPOSED RESIDENTIAL DEVELOPMENT
337 MONTGOMERY STREET
OTTAWA, ON

Title
STORM DRAINAGE PLAN

Project No. 160401698
Drawing No. SD-1
Scale 1:200
Sheet 3 of 3
Revision 2