

TOPOGRAPHIC PLAN OF SURVEY OF
**LOTS 23, 25, 27, 29, 70 AND
 PART OF LOTS 30 AND 69**
 REGISTERED PLAN 49
 CITY OF OTTAWA
 FARLEY, SMITH & DENIS SURVEYING LTD. 2021

Scale 1: 150

Metric Note
 Distances and coordinates on this plan are in metres and can be converted to feet by dividing by 0.3048.

Distance Note
 Distances shown on this plan are ground distances and can be converted to grid distances by multiplying by the combined scale factor of 0.99995.

Bearing Note
 Bearings are grid, and are referred to the northerly limit of Montgomery Street having a bearing of N 55°50'10"W as shown on Plan SR-423 and are referred to the Central Meridian of MTM Zone 9 (76°30' West Longitude) Nad-83 (Original).

For bearing comparisons, a rotation of 0°39'20" counter-clockwise has been applied to bearings on Plan SR-4782.

Elevation Notes
 1. Elevations shown are geodetic and are referred to Geodetic Datum CGVD-1928-1978. (See FSD File No. 13-20)
 2. It is the responsibility of the user of this information to verify that the job benchmark has not been altered or disturbed and that its relative elevation and description agrees with the information shown on this drawing.

Utility Notes
 1. This drawing cannot be accepted as acknowledging all of the utilities and it will be the responsibility of the user to contact the respective utility authorities for confirmation.
 2. Only visible surface utilities were located.
 3. Underground utility data derived from City of Ottawa utility sheet reference: D-16-29, D-16-30, D-16-34, D-16-35 8699p8p8, 9310p8p03, 10088p8p5, 15983planEX1, e376-14 & va-208p8p.
 4. Sanitary and storm sewer grades and inverts were derived from field measurements.
 5. A field location of underground plant by the pertinent utility authority is mandatory before any work involving breaking ground, probing, excavating etc.

Notes & Legend

—○—	Denotes	Survey Monument Planted
—■—		Survey Monument Found
SIB		Standard Iron Bar
SSIB		Short Standard Iron Bar
IB		Iron Bar
CC		Cut Cross
Mass		Measured
(P1)		Plan SR-6896
(P2)		Plan SR-4782
(P3)		Plan by (1692) dated January 30, 2020 (File No. 13-20)
(P4)		Plan by (1692) dated October 29, 2019 (File No. 504-19)
(P5)		Plan by (857) dated March 18, 1983 (Ref. No. 13(a)-49GR)
(P6)		Plan by (647) dated October 30, 1962
(D1)		Inst. NS119443
(D2)		Inst. VA22924
(D3)		Inst. NS291453
○ M-H		Maintenance Hole (Storm)
○ M-H-S		Maintenance Hole (Sanitary)
○ VC		Valve Chamber (Watermain)
—ST—		Underground Storm Sewer
—S—		Underground Sanitary Sewer
—W—		Underground Water
—OW—		Overhead Wires
—U—		Underground Power
—B—		Underground Bell
—TW—		Underground Fibre Optic
—G—		Underground Gas
○ UP		Utility Pole
○ AN		Anchor
○ CB		Catch Basin
○ FH		Fire Hydrant
○ W		Water Valve
○ SP		Water Stand Post
—IN—		Invert
—S—		Sign
—T/G—		Top of Grate
—M—		Gas Meter
—G—		Gate
—D—		Diameter
—CLF—		Chain Link Fence
—BF—		Board Fence
—CRW—		Concrete Retaining Wall
—SRW—		Stone Retaining Wall
—WRW—		Wood Retaining Wall
—EA—		Edge of Asphalt
—C/A—		Centreline
+65.00		Location of Elevations
+65.00		Top of Concrete Curb/Retaining Wall Elevation
—		Property Line
○		Deciduous Tree - The symbol shown denotes location and trunk diameter only. Size of its root system/overhead canopy may be smaller/larger than the symbol size depicted on this plan.

Surveyor's Certificate
 I certify that:
 1. This survey and plan are correct and in accordance with the Survey Act, the Surveyors Act and the Regulations made under them.
 2. The survey was completed on the 29th day of July, 2021.
 Date: Aug 06/21
 Emad Alrefaai
 Ontario Land Surveyor

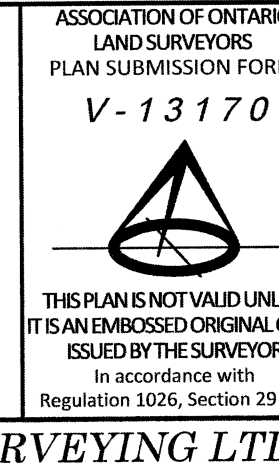

FARLEY, SMITH & DENIS SURVEYING LTD.

ONTARIO LAND SURVEYORS
 CANADIAN LAND SURVEYORS
 Unit 275, 30 COLONNADE ROAD, OTTAWA, ONTARIO K2E 7J6
 TEL: (613) 727-8226 E-mail: fssurvey@bellnet.ca

WARNING: NO PERSON MAY COPY, REPRODUCE, DISTRIBUTE OR ALTER THIS PLAN IN WHOLE OR IN PART WITHOUT THE WRITTEN PERMISSION OF FARLEY, SMITH & DENIS SURVEYING LTD.
 © FARLEY, SMITH & DENIS SURVEYING LTD., 2021.