

- Tree planting Guidelines**
- Where silty clay soils are encountered at a proposed building location, small and medium sized trees can be planted as close as 4.5 metres from the proposed dwelling provided sufficient soil volume is available around the proposed tree location (a minimum of 25 m³ for small trees and 30 m³ for medium trees must be available in the upper 1.5 metres below finished grade).
 - Where silty clay is present at a proposed building location and where the thickness of the silty clay deposit exceeds 0.4 metres, large trees should be planted no closer than 10 metres from the proposed building.
 - Excluding the areas where the silty clay deposits exceed 0.4 metres, the remainder of the subsurface soils encountered at the site are not considered particularly sensitive to depletion of moisture by trees. There are no planting restrictions from a geotechnical perspective for small and medium trees with respect to planting distance from the proposed buildings. Large trees should be planted no closer than 10 metres from a proposed dwelling where no silty clay is present on the lot.
 - Tree planting guidelines provided by a landscape architect, arborist, urban forest manager or other qualified professional with respect to species, distance to building requirements, moisture requirements etc should be obtained and followed in addition to the geotechnical recommendations.

General Grading Notes:

All grade elevations shown on softscaped or grassed surfaces are finished grades including topsoil. Rough grading is to be completed to allow for 100 mm of Topsoil on all disturbed areas.

During detailed grading of individual lots, the designer is to ensure that the area within 3 metres of the proposed drilled well is graded away from the well with a minimum ground surface slope of 2%.

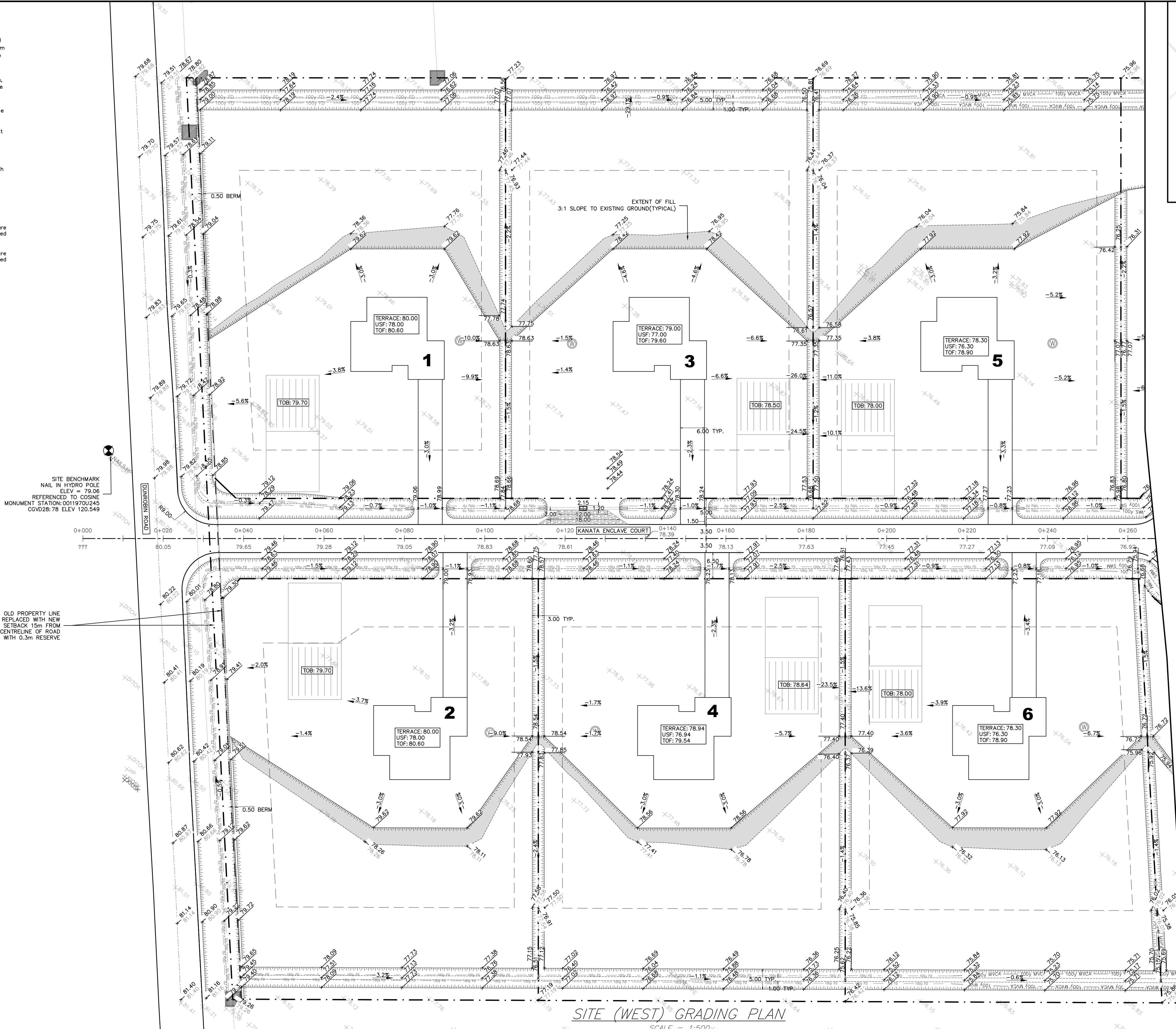

SITE (WEST) GRADING PLAN
SCALE = 1:500

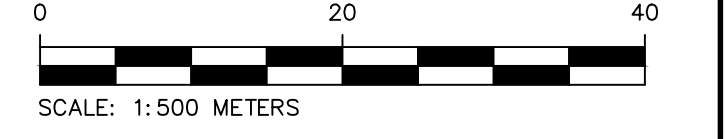
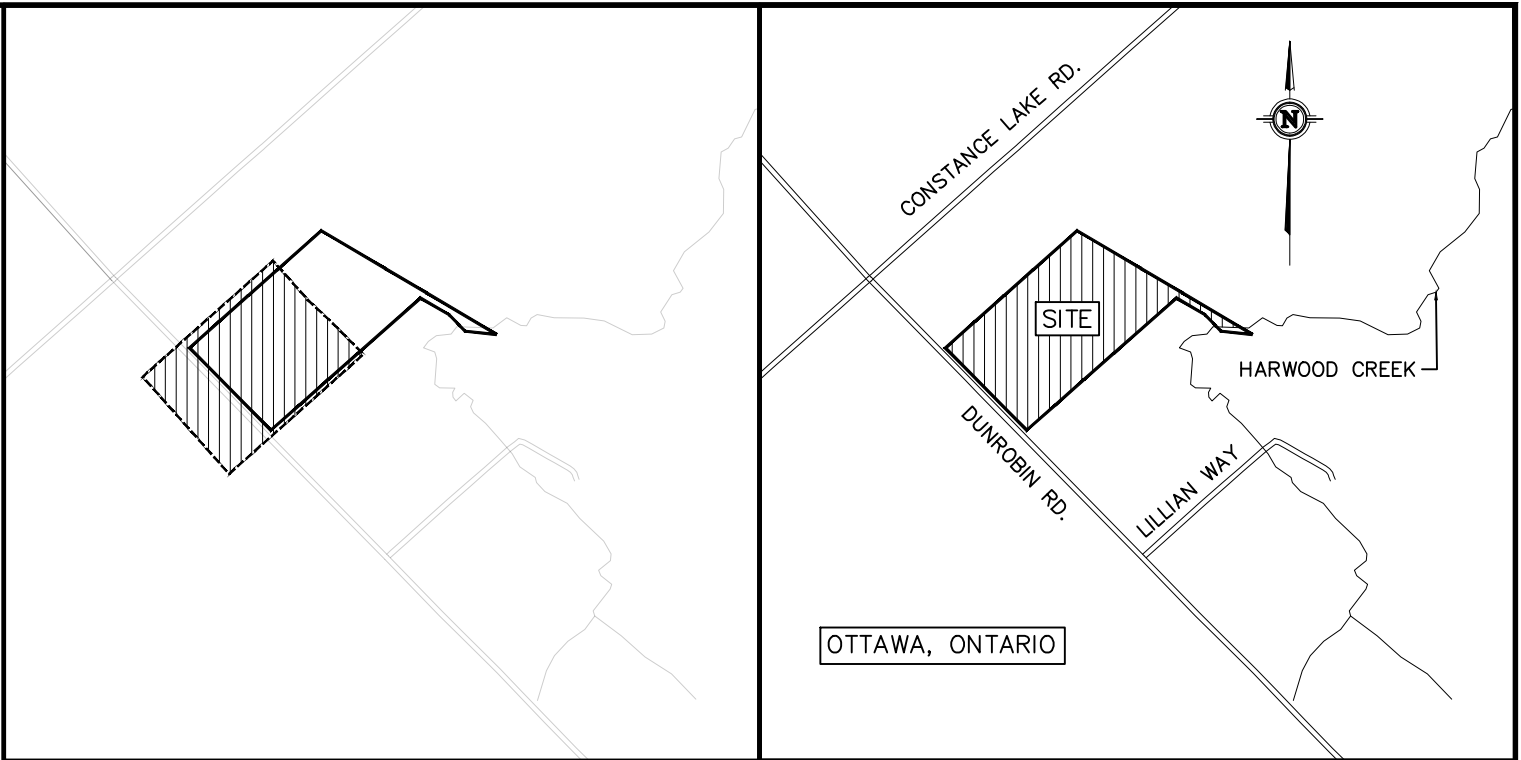

LEGEND

--- x ---	PROPOSED ELEVATION (PROP/EX)
---	PROPOSED GRADE
--- x --- INV	PROPOSED ELEVATION (PROP/INVERT)
---	PROPERTY LINE
---	TOP OF SLOPE
---	CATCHMENT BOUNDARY
---	OVERLAND FLOW DIRECTION
---	SILT FENCE
---	CATCHMENT LABEL
---	CONTROLLED AREA
---	UN-CONTROLLED AREA
---	BOTTOM OF SLOPE
W	PROPOSED WELL LOCATION
---	STRAW BALE CHECK DAM
---	100YR MVCA FLOODPLAIN
---	100YR SWM FACILITY PONDING
---	100YR FLOW DEPTH

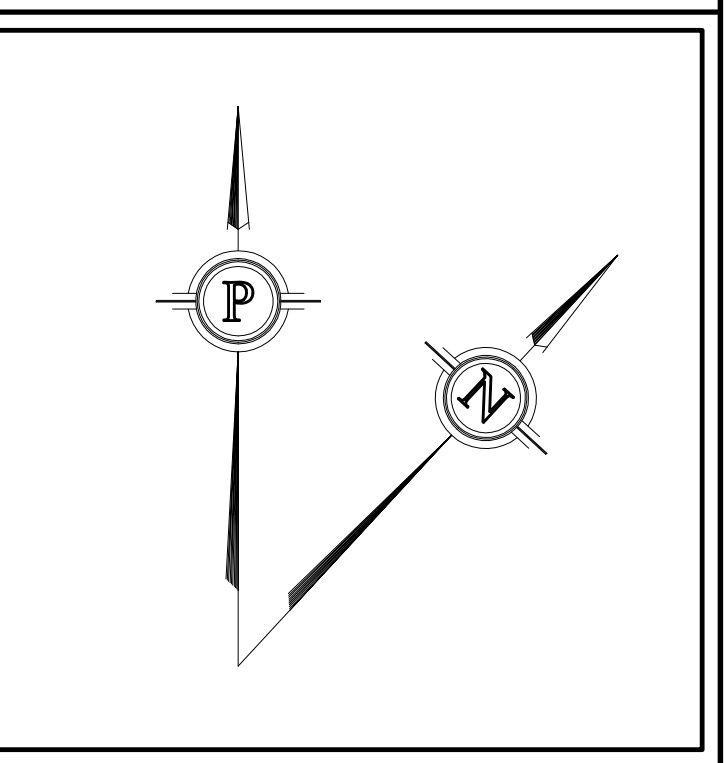

- NOTES:**
- ALL DIMENSIONS ARE IN METRES, UNLESS OTHERWISE SPECIFIED; ALL ELEVATIONS ARE IN METRES.
 - THIS IS NOT A LEGAL SURVEY.
 - EXISTING SERVICES INFORMATION SHOWN ARE BASED ON BEST CURRENT INFORMATION. CONTRACTOR TO VERIFY EXACT LOCATION AND REPORT ANY DISCREPANCIES TO KOLLAARD ASSOCIATES INC.
 - CLIENT IS RESPONSIBLE FOR ACQUIRING ALL NECESSARY PERMITS.
 - CONTRACTOR TO VERIFY THAT APPROPRIATE PERMITS HAVE BEEN ACQUIRED PRIOR TO ANY CONSTRUCTION.
 - CONTRACTOR IS RESPONSIBLE FOR LOCATION AND PROTECTION OF UTILITIES.
 - ALL DIMENSIONS TO BE VERIFIED ON SITE BY CONTRACTOR PRIOR TO CONSTRUCTION.
 - THIS DRAWING IS NOT FOR CONSTRUCTION UNTIL ALL APPROVALS HAVE BEEN GRANTED.

- INSPECTION OF ROUGH GRADE BY KOLLAARD ASSOCIATES INC. AND MUNICIPALITY MUST BE CONDUCTED PRIOR TO PLACEMENT OF TOPSOIL OR SOD.
- HYDRO SERVICE TO BE INSTALLED ACCORDING TO THE SPECIFICATIONS OF SERVICE PROVIDER AND THE MECHANICAL ENGINEER.
- ALL MATERIALS AND CONSTRUCTION TO BE IN ACCORDANCE WITH MUNICIPAL STANDARDS AND ONTARIO PROVINCIAL STANDARDS AND SPECIFICATIONS.
- ANY CHANGES MADE TO THIS PLAN MUST BE VERIFIED AND APPROVED BY KOLLAARD ASSOCIATES, INC.
- THIS DRAWING IS PART OF KOLLAARD ASSOCIATES DESIGN REPORT #200977.

No.	REVISION	DATE	BY

CONSULTANTS

Kollaard Associates
Engineers

BOX 189
210 PRESCOTT STREET
KEMPVILLE, ONTARIO
K0G 1L0
FACSIMILE (613) 258-0475

(613) 860-0923

DESIGN: AJ/SD
DRAWN: AJ
CHECKED: SD
APPROVED: SD

PROFESSIONAL ENGINEER
MAY 5, 2023
S.E. deWit
100079612
PROVINCE OF ONTARIO

CLIENT NAME	ZBIGNIEW HAUDEROWICZ	PROJECT No.	200977
PROJECT NAME	PROPOSED RESIDENTIAL SUBDIVISION	DATE	2023/05/05
PROJECT LOCATION	2050 DUNROBIN ROAD OTTAWA, ONTARIO	SCALE	1:500
DRAWING	SITE (WEST) GRADING PLAN	DRAWING No.	GR-W

D02-02-22-0018