

CLIENT:

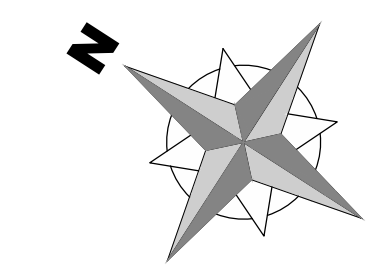

SILVER STREET

SHILLINGTON AVENUE

ALEXANDER PARK

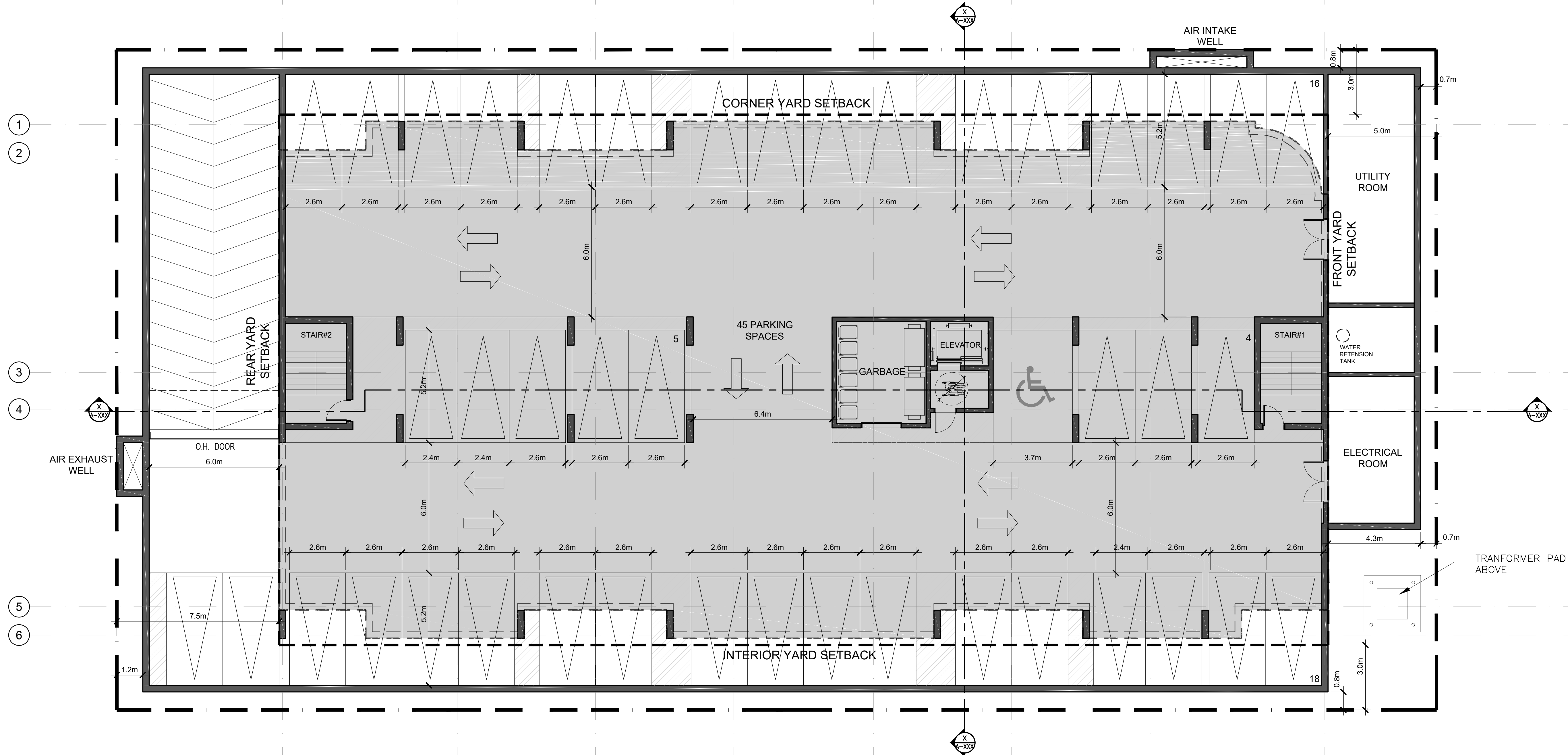

- LEGEND:**
- PROPOSED NEW BUILDING
 - NEW UNIT PAVERS
 - PROPERTY LINE
 - ADJACENT LOT PROPERTY LINES
 - EXISTING OVERHEAD HYDRO LINE
 - NEW WOOD FENCE
 - EXISTING HYDRO POLE TO REMAIN
 - ENTRANCE ARROWS
 - NEW BIKE RACKS
 - NEW PARKING
 - EXISTING CONCRETE CURB
 - LIGHT STANDARD
 - WALL MOUNTED LIGHTING FIXTURE
 - EXTERIOR SOFFIT LIGHTING FIXTURE
 - EXTERIOR WALL MOUNTED LIGHT FIXTURE

11			
10			
09			
08			
07			
06			
05			
04	FOR REVIEW	PE	JAN. 26 2022
03	FOR REVIEW	PE	JAN. 18 2022
02	FOR REVIEW	PE	NOV. 25 2021
01	FOR REVIEW	PE	OCT. 18 2021
No.	REVISIONS	BY	DATE

PARKING LEVEL
GFA 1669 sqm

STAMP NORTH ARROW



DESIGNED BY: P.E. DRAWN BY: P.E. APPROVED BY:

PROJECT
1275 SHILLINGTON AVENUE
OTTAWA

DRAWING TITLE
UNDERGROUND PARKING
FLOOR PLAN

PROJECT NO.
0453
DATE
OCT. 18, 2021

A-100