

- SPECIFICATIONS:**
1. TOPSOIL MIX, SEE SPEC.
  2. IF ROOT BALL HAS WIRE BASKET, CUT BASKET IN FOUR PLACES AND FOLD DOWN 8" INTO PLANTING PIT.
  3. DO NOT STAKE THROUGH ROOT BALL.
  4. WATER THOROUGHLY AFTER INSTALLATION.
  5. CUT AND REMOVE TOP 1/3 OF ROPE AND BURLAP FROM ROOT BALL.
  6. REMOVE STAKES AND TWINE TIES TWO YEARS AFTER INSTALLATION.
  7. SCARIFY SUBGRADE PIT BOTTOM AND SIDES TO MIN. 6".
  8. DOUBLE STAKE TREE WITH ORIENTATION N.W. TO S.E.

**DECIDUOUS TREE PLANTING n.t.s.**

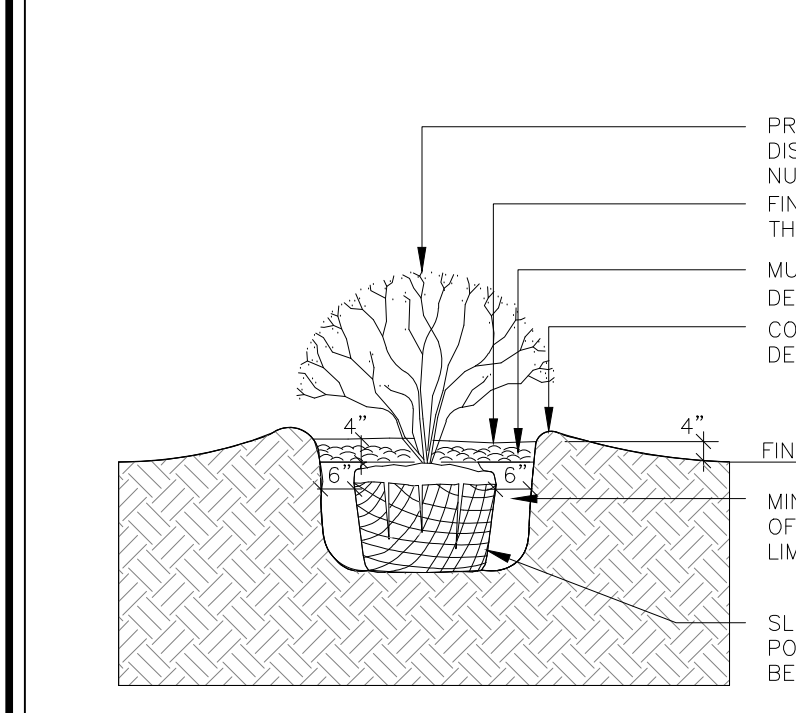

- SPECIFICATIONS:**
1. TOPSOIL MIX, SEE SPEC.
  2. SYNTHETIC BURLAP IS NOT ALLOWED.
  3. WATER THOROUGHLY AFTER INSTALLATION.
  4. CUT & REMOVE TOP 1/3 OF ROPE AND BURLAP FROM ROOT BALL. IF CONTAINER IS NON-ORGANIC REMOVE COMPLETELY
  5. SCARIFY SUBGRADE FIT BOTTOM AND SIDES TO MIN. 6"

**SHRUB PLANTING n.t.s.**

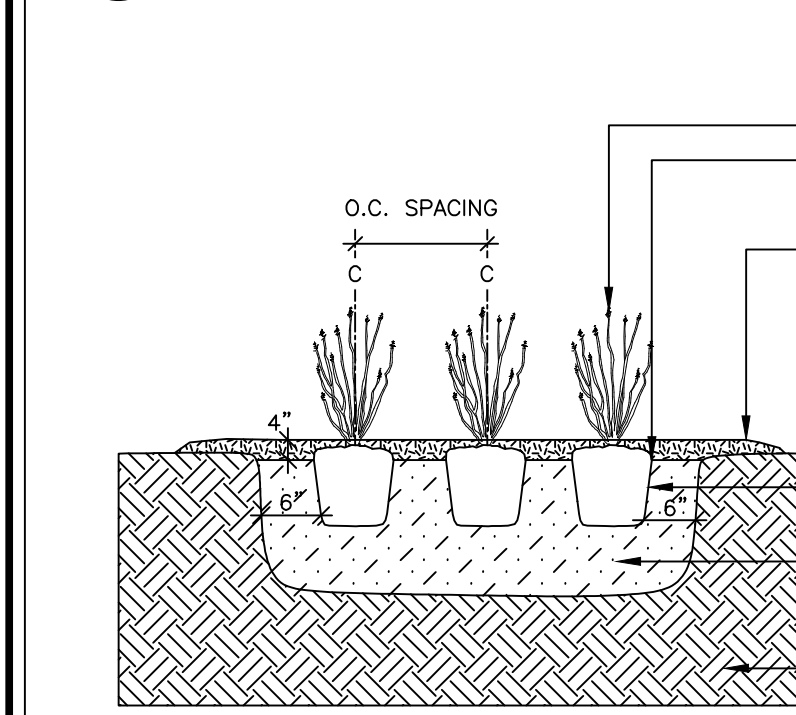

- SPECIFICATIONS:**
1. TOPSOIL MIX, SEE SPEC.
  2. WATER THOROUGHLY AFTER INSTALLATION.
  3. IF CONTAINER IS NON-ORGANIC REMOVE COMPLETELY

**PERENNIAL & ORNAMENTAL GRASS PLANTING n.t.s.**

Key	No	Botanical Name	Common Name	Size	Cdn	Notes	Revisions
CAK	33	Calamagrostis acutifolia 'Karl Forester'	Feather Reed Grass	1 gal pot	WB	plant 32" o.c.	
HBW	22	Hosta 'Blue Wedgewood'	Blue Wedgewood Hosta	1 gal pot	WB	plant 24" o.c.	
HHF	15	Hemerocallis 'Flava'	Purple Daylily	1 gal pot	WB	plant 24" o.c.	
HHP	50	Hemerocallis x 'Purple D'oro'	Purple D'oro Hybrid Daylily	1 gal pot	WB	plant 18" o.c.	
HRH	27	Hemerocallis hybrida 'Ruby Spider'	Ruby Spider Daylily	1 gal pot	WB	plant 24" o.c.	
HHS	23	Hemerocallis x 'Stella D'oro'	Stella D'oro Hybrid Daylily	1 gal pot	WB	plant 18" o.c.	
HSF	15	Hosta 'Summer Fragrance'	Summer Fragrance Hosta	1 gal pot	WB	plant 36" o.c.	
PT	118	Pachysandra terminalis	Japanese spurge	9 cm pot	WB	plant 16" o.c.	

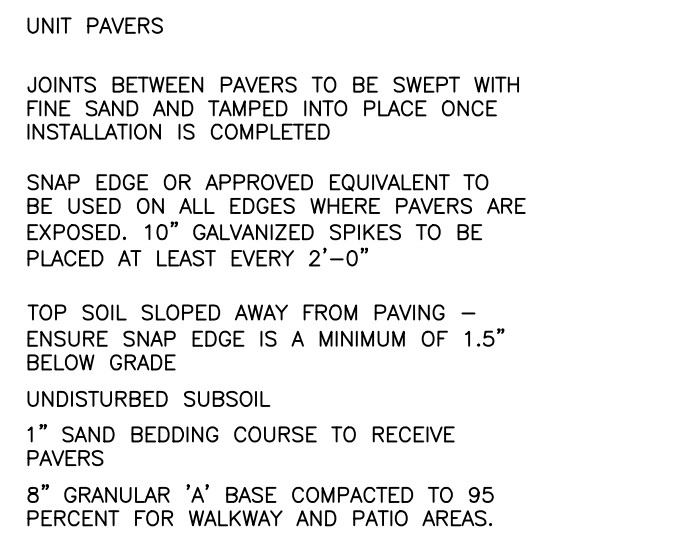

**UNIT PAVING - PATIO & WALKWAYS n.t.s.**

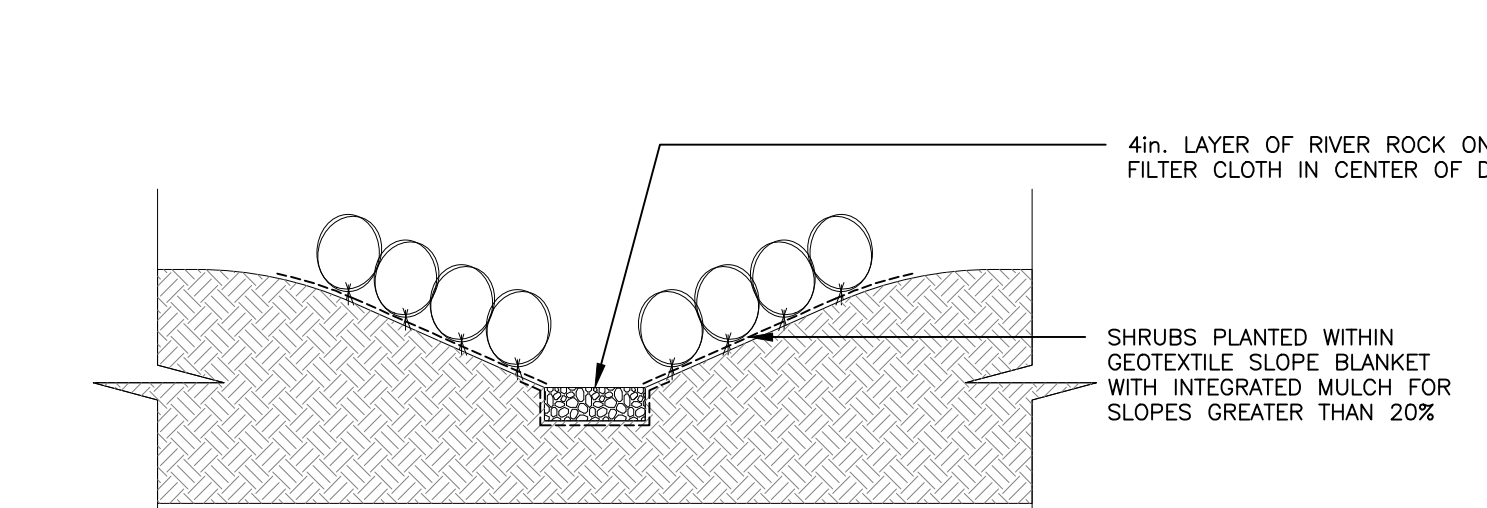

**SLOPE PLANTING n.t.s.**

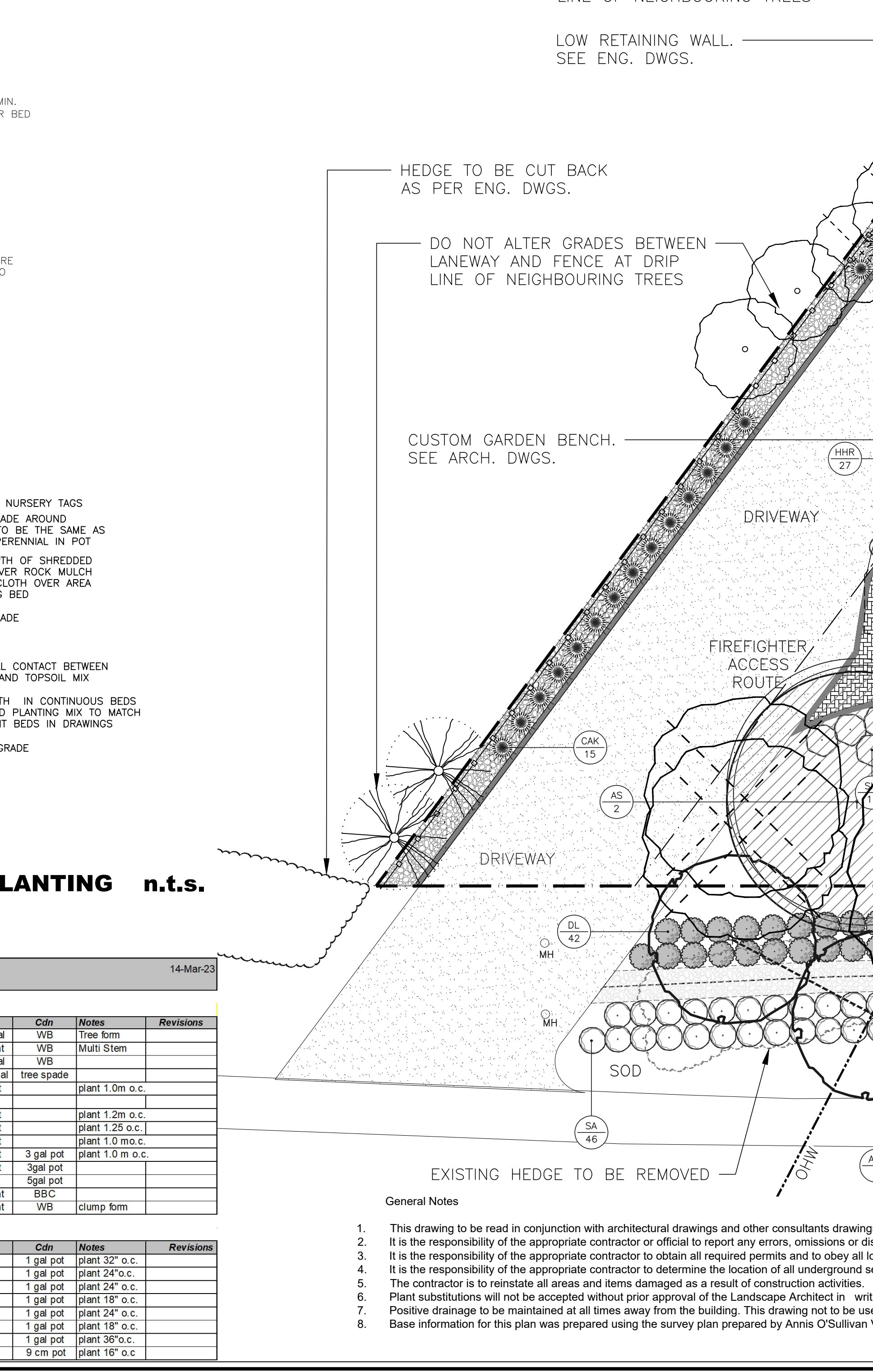
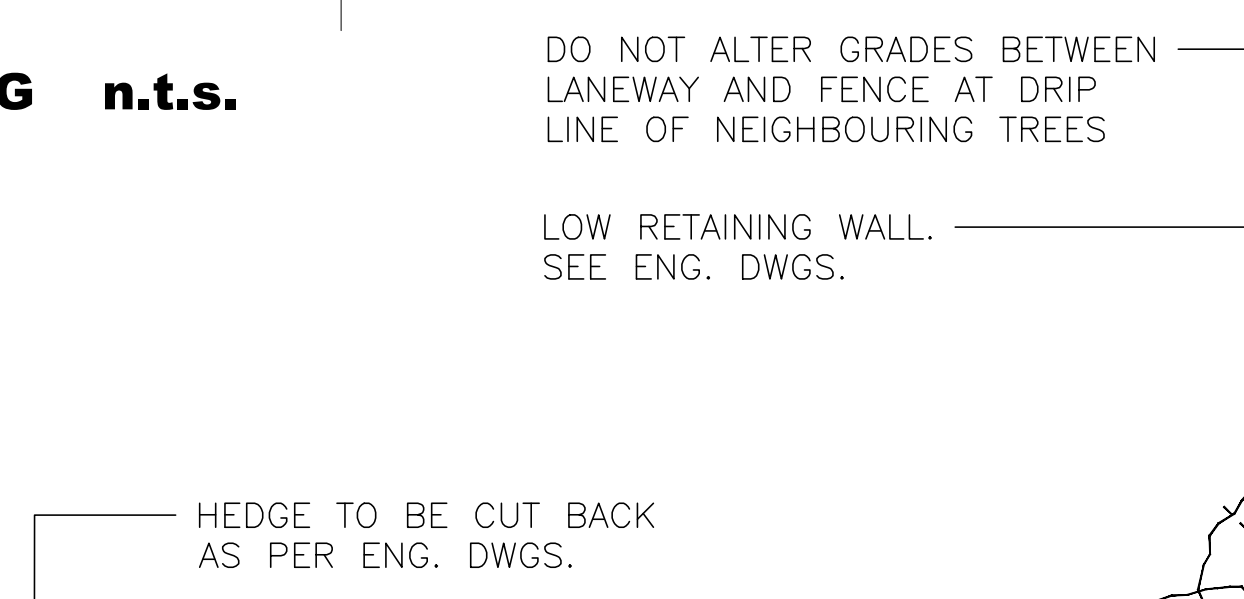

**LEGEND**

- EXISTING EVERGREEN TREE
- EXISTING DECIDUOUS TREE
- EXISTING EVERGREEN TREE TO BE REMOVED
- EXISTING DECIDUOUS TREE TO BE REMOVED
- PROPOSED DECIDUOUS TREE BY TREE SPADE
- PROPOSED DECIDUOUS TREE
- PROPOSED SHRUBS
- PROPOSED PERENNIALS
- RIVER ROCK MULCH ON BLACK FILTER CLOTH
- ASPHALT
- INTERLOCK
- RETAINING WALL. REFER TO ENG. DWGS.
- PROPOSED 7FT HIGH WOOD FENCE

No.	Date	Revision note
1	June 20/22	Issued for review
2	July 05/22	Issued for review
3	August 29/22	Issued for submission
4	Jan. 16/23	Issued for review
5	Feb 21/23	Issued for review
6	Feb 28/23	Issued for review
7	Mar 10/23	Issued for review
8	Mar 15/23	Issued for resubmission
9	Mar 16/23	Issued for resubmission

**John K. Szczepaniak**  
 LANDSCAPE ARCHITECT  
 REGULATED  
 TEL: (613) 731-2777 FAX: (613) 731-6989  
 E-MAIL: jszla@rogers.com

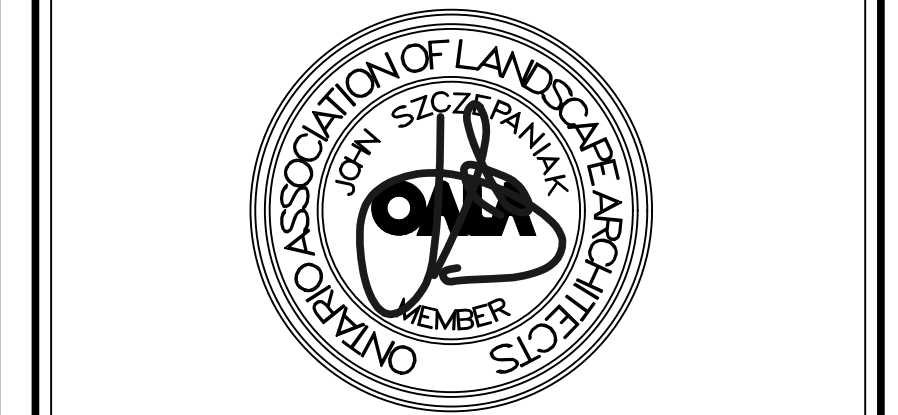

**3055 Richmond Road**  
 3055 Richmond Road,  
 Ottawa

**Landscape Plan**

CHK: JKS  
 DRW: EK  
 DATE: April 25, 2022  
 ID: 2021-05  
 SCALE: 1:100

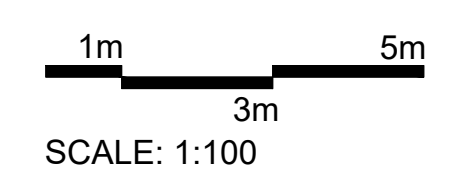
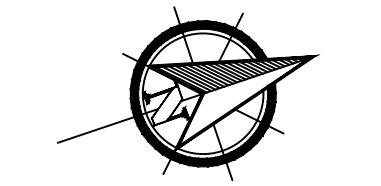

- General Notes**
1. This drawing is to be read in conjunction with architectural drawings and other consultants drawings. Specifically refer to the tree conservation prepared and report prepared by IFS Associates and servicing and grading plan prepared by W.Elias and Associates Consulting Engineers.
  2. It is the responsibility of the appropriate contractor or official to report any errors, omissions or discrepancies in this plan with actual conditions or other consultant's plans prior to commencing work. The Landscape Architect is not responsible for subsurface conditions.
  3. It is the responsibility of the appropriate contractor to obtain all required permits and to obey all local bylaws and regulations.
  4. It is the responsibility of the appropriate contractor to determine the location of all underground services before the start to include: telephone cables, cable television, hydro cables, lights and power lines, weeping tiles, storm and sanitary sewers, natural gas lines, irrigation lines, etc.
  5. The contractor is to reinstaete all areas and items damaged as a result of construction activities.
  6. Plant substitutions will not be accepted without prior approval of the Landscape Architect in writing.
  7. Positive drainage to be maintained at all times away from the building. This drawing not to be used for grading, refer to engineer's drawing for grading.
  8. Base information for this plan was prepared using the survey plan prepared by Annis O'Sullivan Vollebeck Ltd. November 2021.

3055 RICHMOND ROAD, OTTAWA, ONTARIO, CANADA