

SERVICE CONNECTIONS TO CARRUTHERS AVE. CONNECT 150mm $\phi$  STORM SERVICE TO 300mm $\phi$  STORM SEWER (MAIN INV.=62.35). CONNECTION AS PER CITY STANDARD DWG. S11.1. (SANITARY AND STORM LATERALS TO BE INSULATED AS PER CITY STANDARD S35)

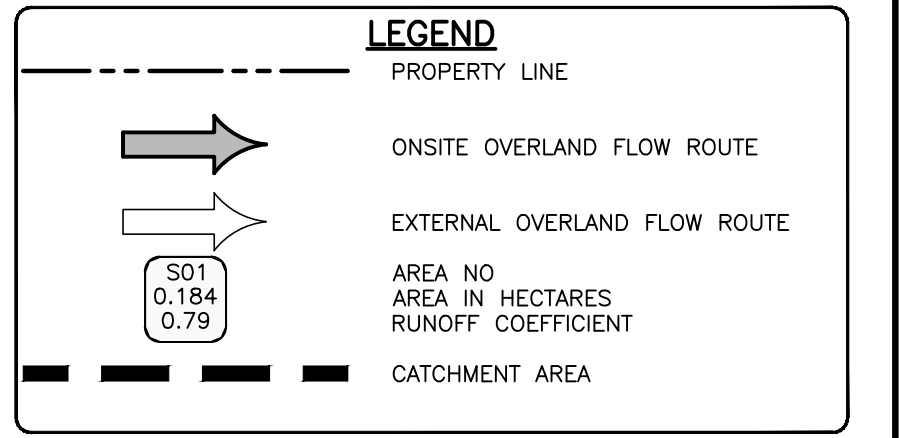
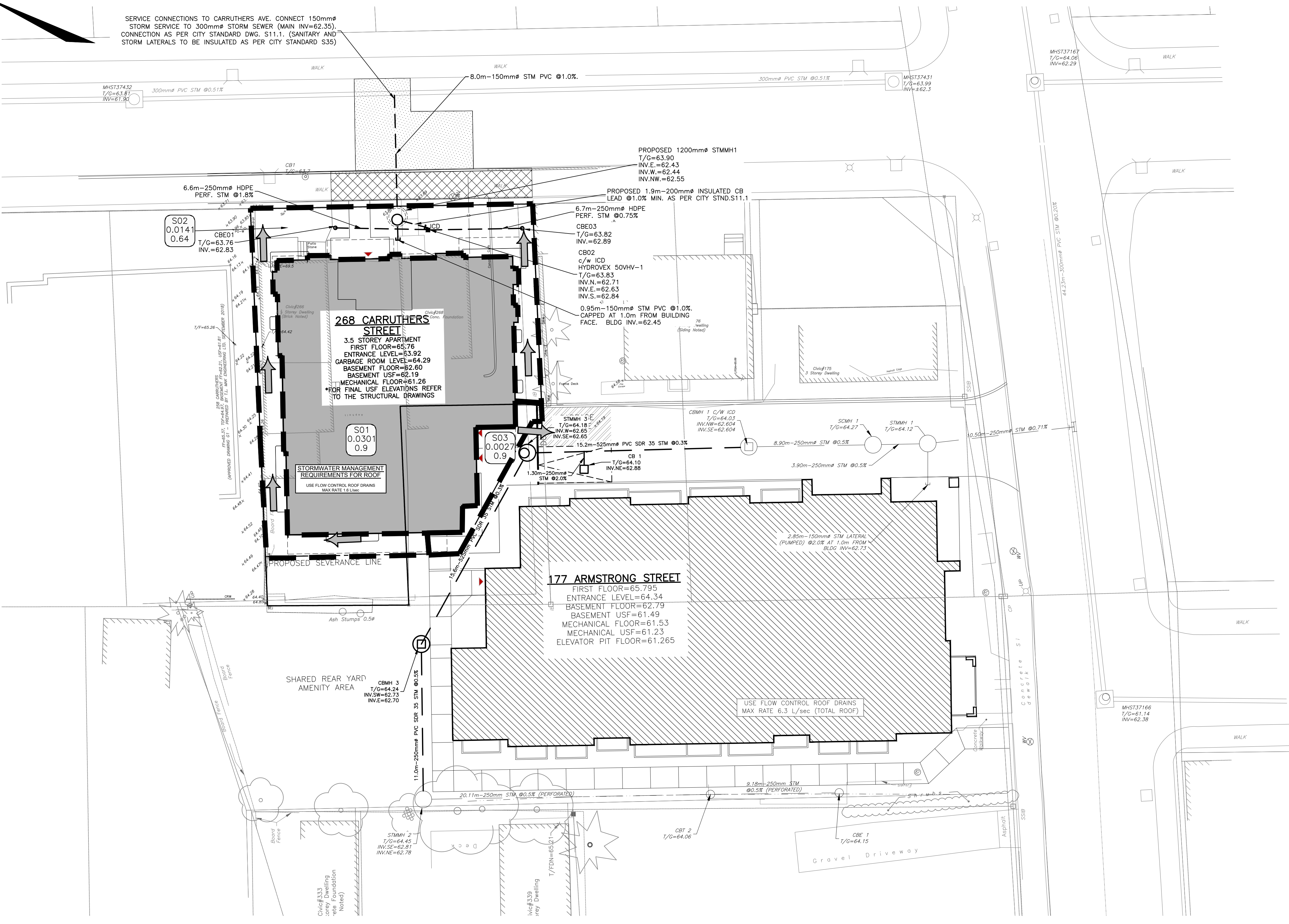

**CAUTION**  
THE POSITION OF ALL POLE LINES, CONDUITS, WATERMANS, SEWERS AND OTHER UNDERGROUND AND OVERGROUND UTILITIES AND STRUCTURES IS NOT NECESSARILY SHOWN ON THE CONTRACT DRAWINGS, AND WHERE SHOWN, THE ACCURACY OF THE POSITION OF SUCH UTILITIES AND STRUCTURES IS NOT GUARANTEED. BEFORE STARTING WORK, DETERMINE THE EXACT LOCATION OF ALL SUCH UTILITIES AND STRUCTURES AND ASSUME ALL LIABILITY FOR DAMAGE TO THEM.

**BENCHMARKING NOTES FOR SITE**  
1. REFER TO LEGAL SURVEY PLAN PREPARED BY FARLEY, SMITH & DENIS SURVEYING INC. DATED APRIL 22, 2022.  
2. ELEVATIONS SHOWN ARE GEODETIC AND ARE REFERRED TO GEODETIC DATUM CGVD-1928 11978.  
3. ELEVATIONS DERIVED FROM MONUMENT NO. 01919690092 HAVING A PUBLISHED ELEVATION OF 84.092 METRES. LOCATION:  $\pm$ 340 METRES NORTH OF COLONNADE ROAD,  $\pm$ 15.3 METRES EAST OF THE EASTERLY FOG LINE ON PRINCE OF WALES DRIVE.  
4. IT IS THE RESPONSIBILITY OF THE USER OF THIS INFORMATION TO VERIFY THAT THE BENCHMARK HAS NOT BEEN ALTERED OR DISTURBED AND THAT ITS RELATIVE ELEVATION AND DESCRIPTION AGREES WITH THE INFORMATION SHOWN ON THIS DRAWING.

REV	REVISION DESCRIPTION	DATE	BY	APPD
6	REVISED AS PER CITY COMMENTS	08/01/24	AC	BMT
5	ISSUED FOR SPC RESPONSE	15/12/23	AC	BMT
4	REVISED AS PER NEW SITE PLAN	17/11/23	AKJ	BMT
3	REVISED AS PER CITY COMMENTS	29/06/23	SAB	BMT
2	REVISED AS PER CITY COMMENTS	21/03/23	SAB	BMT
1	ISSUED FOR SITE PLAN APPROVAL	09/11/22	SAB	BMT

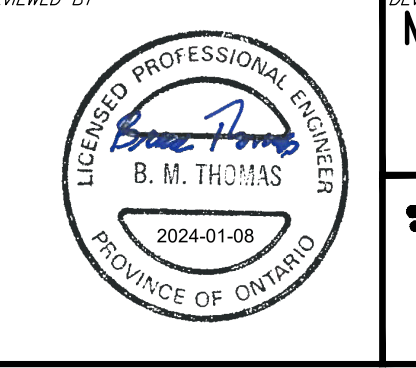
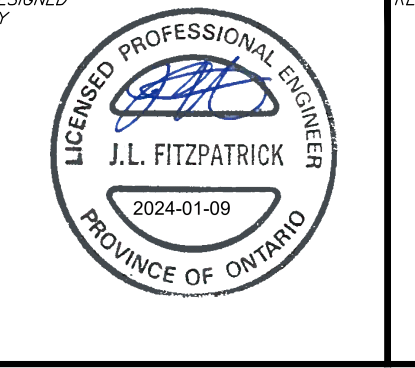

**DEVELOPER**  
McCormick Park Developments  
1600 LAPERIERE AVENUE, SUITE 205  
OTTAWA, ON. K1M 2H9  
613.421.1515

**exp.**  
exp Services Inc.  
1-1-813.688.1899 | F-1-613.225.7330  
3025 Casselman Drive, Unit 100  
Ottawa, ON K2B 8H6  
Canada  
www.exp.com

• BUILDINGS • EARTH & ENVIRONMENT • ENERGY •  
• INDUSTRIAL • INFRASTRUCTURE • SUSTAINABILITY •

DESIGN	PROJECT	PROJECT No.
SAB	CARRUTHERS AVENUE DEVELOPMENT	OTT-22014656-AG
BMT	266-268 CARRUTHERS	SURVEY
BMT	OTTAWA, ONTARIO.	FMW/FSD
BMT		DATE
SAB		JUNE 2022
BMT		DRAWING No.
BMT	STORM DRAINAGE PLAN	C400
BMT		