

LEGEND	
	PROPOSED ELEVATION
	EXISTING ELEVATION
	EMERGENCY OVERLAND FLOW
	LIGHT DUTY SILT FENCE BARRIER AS PER OPSD 219.110
	TEMPORARY LIGHT-DUTY STRAW BALE BARRIER AS PER OPSD 219.180
	FLOODPLAIN
	Top of Slope (AOV, Matrix)
	New Top of Slope (Novatech)
	Existing Gravel Shoulder
	Existing Paved Shoulder
	Existing Ditch

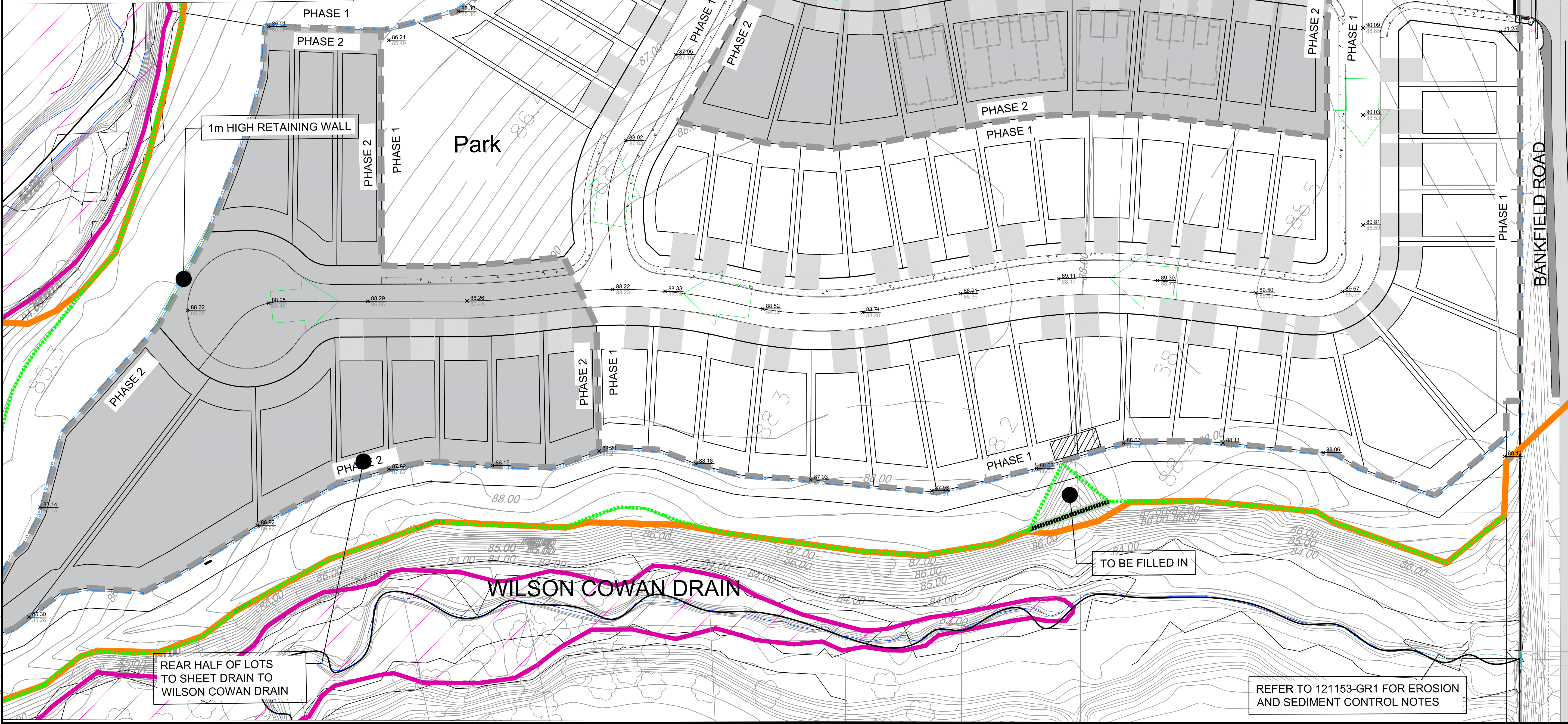

NOTE:
THE POSITION OF ALL POLE LINES, CONDUITS, WATERMAINS, SEWERS AND OTHER UNDERGROUND AND OVERGROUND UTILITIES AND STRUCTURES IS NOT NECESSARILY SHOWN ON THE CONTRACT DRAWINGS, AND WHERE SHOWN, THE ACCURACY OF THE POSITION OF SUCH UTILITIES AND STRUCTURES IS NOT GUARANTEED. BEFORE STARTING WORK, DETERMINE THE EXACT LOCATION OF ALL SUCH UTILITIES AND STRUCTURES AND ASSUME ALL LIABILITY FOR DAMAGE TO THEM.

No.	REVISION	DATE	BY
5.	ISSUED FOR RE-SUBMISSION REVIEW	MAR 3/25	BHB
4.	ISSUED FOR RE-SUBMISSION REVIEW	DEC 13/24	BHB
3.	ISSUED FOR RE-SUBMISSION REVIEW	OCT 23/24	BHB
2.	ISSUED FOR RE-SUBMISSION REVIEW	APR 11/24	BHB
1.	ISSUED FOR REVIEW	JAN 6/23	BHB

SCALE
1:500
0 5 10 15 20

DESIGN
BPR
BHB
BPR
BHB
BHB

FOR REVIEW ONLY

NOVATECH
Engineers, Planners & Landscape Architects
Suite 200, 240 Michael Cowpland Drive
Ottawa, Ontario, Canada K2M 1P6
Telephone (613) 254-9643
Facsimile (613) 254-5867
Website www.novatech-eng.com

LOCATION CITY OF OTTAWA - 4386 RIDEAU VALLEY DRIVE (N) STINSON LANDS SUBDIVISION	
DRAWING NAME	PROJECT No. 121153-00
CONCEPTUAL GRADING, EROSION, & SEDIMENT CONTROL PLAN 2	REV REV # 5
	DRAWING No. 121153-GR2

M:\2021\121153\CAD\Drawings\121153-GR2_V3.dwg GR2, Dec 18, 2024 - 8:47am, brundie