

EXISTING TREE LIST						
KEY	QTY	BOTANICAL NAME	COMMON NAME	SIZE	CONDITION	REMARKS
DECIDUOUS TREES						
EL	1	Ulmus americana	American Elm	100mm dia.	Good	To remain

PROPOSED PLANT LIST						
KEY	QTY	BOTANICAL NAME	COMMON NAME	SIZE	CONDITION	SPACING
DECIDUOUS TREES						
HL	4	Gleditsia triacanthos	Honey Locust	60mm dia.	B&B	

- GENERAL NOTES:**
- It is the responsibility of the appropriate contractor or official to report any errors, omissions or discrepancies on this plan with actual site conditions to the Landscape Architect before proceeding with construction.
 - The contractor is to notify all utility companies and authorities prior to any excavation and ascertain locations of underground services.
 - The contractor is to reinstate all areas and items damaged as a result of construction activity.
 - The contractor is to comply with all pertinent codes and by-laws.
 - The contractor is to maintain a positive surface run-off throughout the entire construction period.
 - The Landscape Architect is not responsible for subsurface conditions.
 - The contractor is to identify all existing trees to remain on site with the Landscape Architect prior to construction.
 - The contractor is to stake the proposed location of all plant material in conjunction with the Landscape Architect prior to excavation.
 - All trees within 1m of underground utility trenches are to be excavated by hand.
 - Remove all protective wrapping from tree trunks after installation.
 - Staking of trees shall only be performed if necessary.
 - Ensure that mulch is pulled back a min. distance of 75mm from base of tree trunk.

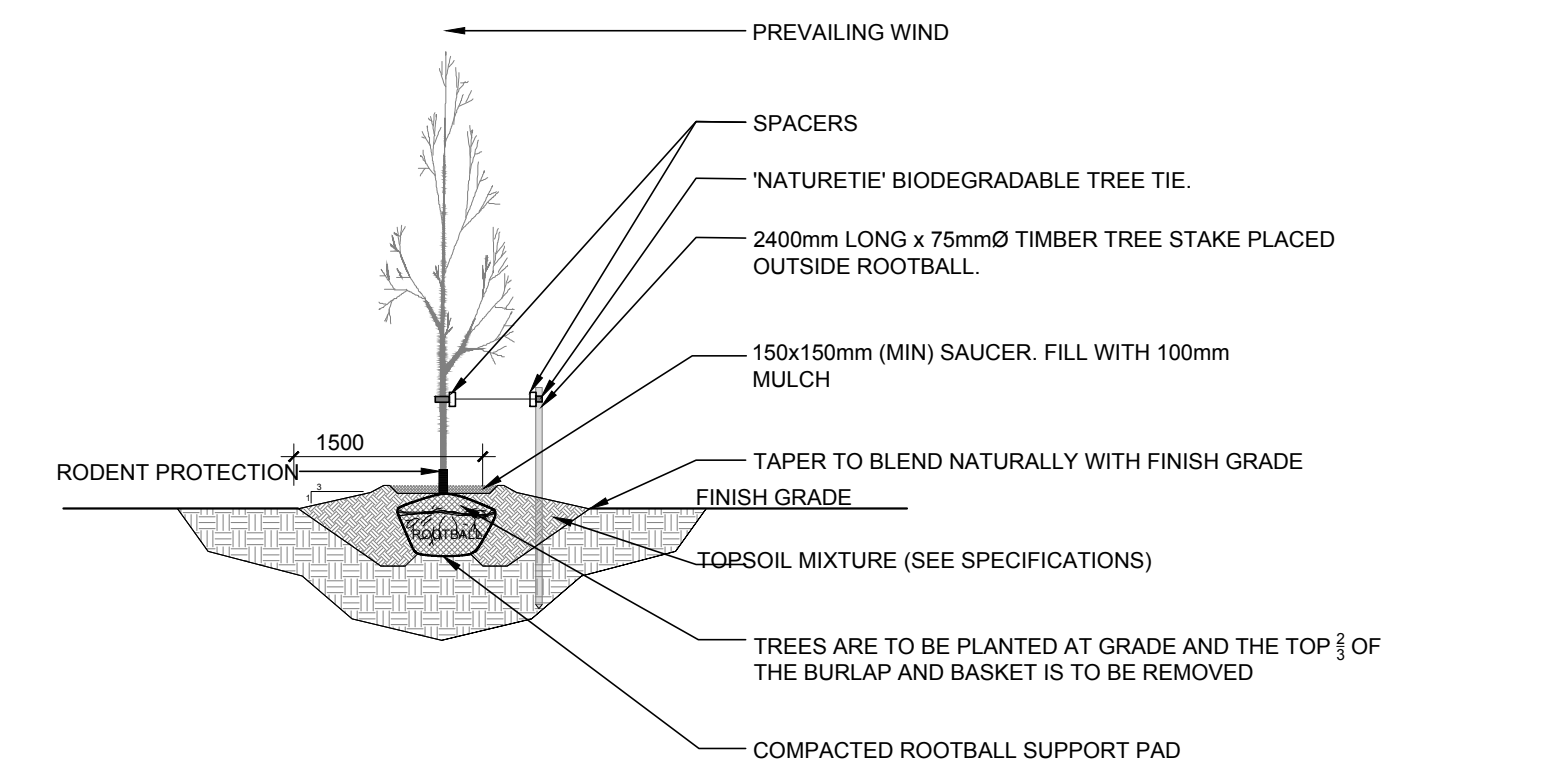

1 TREE CONSERVATION REPORT & LANDSCAPE PLAN
L.1 SCALE 1:100

2 DECIDUOUS TREE PLANTING
L.1 N.T.S.

CONSULTANTS

ARCHITECTS:
CHMEL ARCHITECTS
200-109 Bank Street, ON K1P5K6
Tel: (416) 248-3885

CIVIL ENGINEERS:
ANLEY GROUP
2724 FERRIS BL. GOSHEN, ON K1T 3T7
Tel: (416) 622-1052

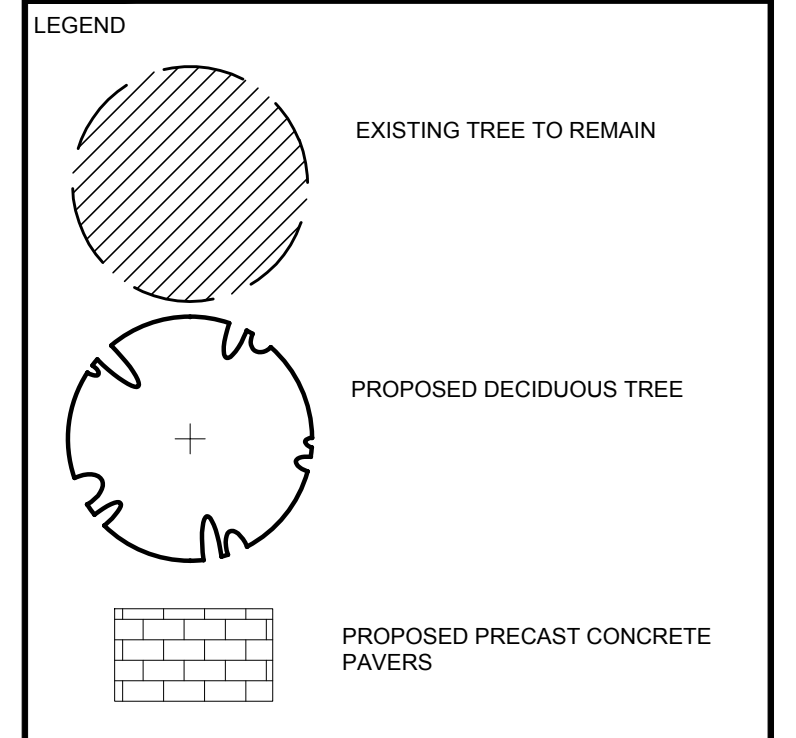

No.	Issue	Date	LC	JL
1	ISSUED FOR SITE PLAN APPROVAL	04/18/2023	LC	JL

JAMES B. LENNOX & ASSOCIATES INC.
LANDSCAPE ARCHITECTS
3332 CARLING AVE. OTTAWA, ONTARIO K2H 5A8
Tel: (613) 722-5168 Fax: (866) 343-3942

PROJECT
SOMERSET APARTMENTS
352 SOMERSET STREET, OTTAWA, ON.

DRAWING
LANDSCAPE PLAN

STAMP

SCALE
AS SHOWN

START DATE
APRIL, 2023

PROJECT NO.

PROJECT NORTH

DRAWING NO.
L.1

PLOT SIZE ARCH-D