

EXISTING TREE LIST

KEY	QTY	BOTANICAL NAME	COMMON NAME	SIZE	CONDITION	REMARKS
EL	1	Ulmus americana	American Elm	100mm dia.	Good	To remain
GT	1	Gleditsia triacanthos	Honey Locust	350mm dia.	Good	To remain

PROPOSED PLANT LIST

KEY	QTY	BOTANICAL NAME	COMMON NAME	SIZE	CONDITION	SPACING
JL	2	Syringa reticulata	Japanese Tree Lilac	60mm dia.	B&B	

GENERAL NOTES:

- It is the responsibility of the appropriate contractor or official to report any errors, omissions or discrepancies on this plan with actual site conditions to the Landscape Architect before proceeding with construction.
- The contractor is to notify all utility companies and authorities prior to any excavation and ascertain locations of underground services.
- The contractor is to reinstate all areas and items damaged as a result of construction activity.
- The contractor is to comply with all pertinent codes and by-laws.
- The contractor is to maintain a positive surface run-off throughout the entire construction period.
- The Landscape Architect is not responsible for subsurface conditions.
- The contractor is to identify all existing trees to remain on site with the Landscape Architect prior to construction.
- The contractor is to stake the proposed location of all plant material in conjunction with the Landscape Architect prior to excavation.
- All trees within 1m of underground utility trenches are to be excavated by hand.
- Remove all protective wrapping from tree trunks after installation.
- Staking of trees shall only be performed if necessary.
- Ensure that mulch is pulled back a min. distance of 75mm from base of tree trunk.

CLIENT
VP CAPITAL PARKING
VP TRS HOLDINGS INC.
400 Beaver Street, Ottawa, ON

CONSULTANTS
ARCHITECTS:
CHMEL ARCHITECTS
2701 10th Street, Ottawa, ON K1P 1P6
Tel: (613) 224-3385

CIVIL ENGINEERS:
ANLEY GROUP
2701 10th Street, Ottawa, ON K1P 1P6
Tel: (613) 822-1022

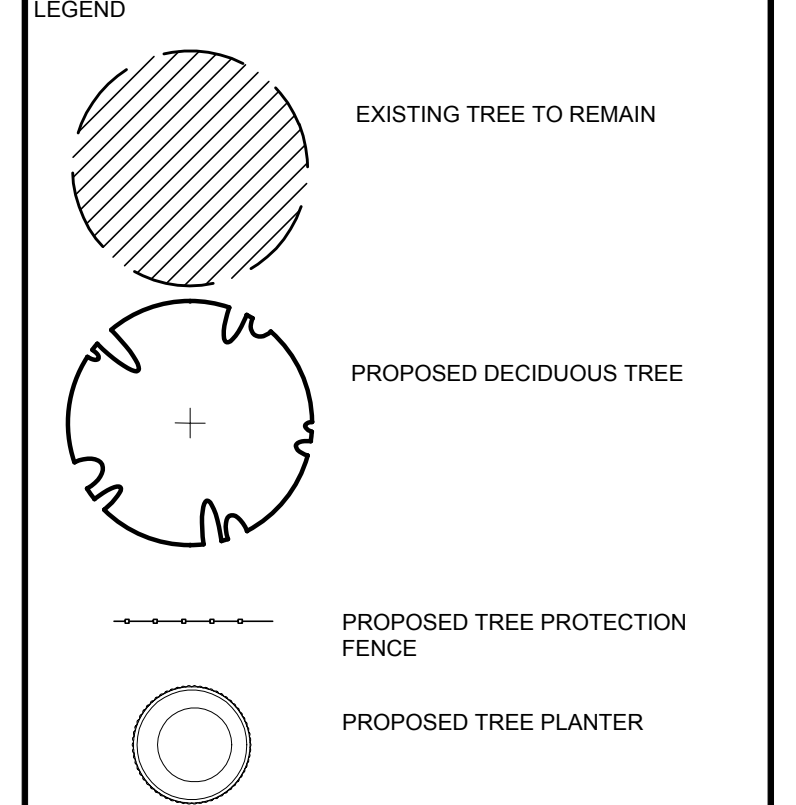

1 TREE CONSERVATION REPORT & LANDSCAPE PLAN
L.1 SCALE 1:100



- NOTES:**
- INSTALL FENCE PRIOR TO ANY CONSTRUCTION ACTIVITY.
 - NO CONSTRUCTION ACTIVITIES INCLUDING MATERIAL STORAGE OR DISPOSAL, OR PARKING IS TO TAKE PLACE WITHIN THE DESIGNATED PROTECTION AREA.
 - ANY ROOTS ENCOUNTERED, ARE TO BE CLEANLY CUT WITH A SAW OR PRUNERS (DO NOT USE BACKHOE OR OTHER HEAVY EQUIPMENT). ROOTS ARE TO BE COVERED IMMEDIATELY WITH TOPSOIL, BURLAP OR MULCH AND KEPT DAMP.
- PROTECTION MEASURES TO BE TAKEN DURING CONSTRUCTION:**
- UNDER THE GUIDANCE OF AN ARBORIST, ERECT A FENCE AT THE CRITICAL ROOT ZONE (CRZ) OF TREES WHERE THE CRZ IS ESTABLISHED AS BEING 12 CENTIMETRES FROM THE TRUNK OF A TREE FOR EVERY CENTIMETRE OF TRUNK DIAMETER AT BREAST HEIGHT. THE CRZ IS CALCULATED AS DBH X 12 CM.
 - DO NOT PLACE ANY MATERIAL OR EQUIPMENT WITHIN THE CRZ OF THE TREE
 - DO NOT ATTACH ANY SIGNS, NOTICES OR POSTERS TO ANY TREE.
 - DO NOT RAISE OR LOWER THE EXISTING GRADE WITHIN THE CRZ WITHOUT APPROVAL.
 - TUNNEL OR BORE WHEN DIGGING WITHIN THE CRZ OF A TREE.
 - DO NOT DAMAGE THE ROOT SYSTEM, TRUNK, OR BRANCHES OF ANY TREE.
 - ENSURE THAT EXHAUST FUMES FROM ALL EQUIPMENT ARE NOT DIRECTED TOWARDS ANY TREE CANOPY.

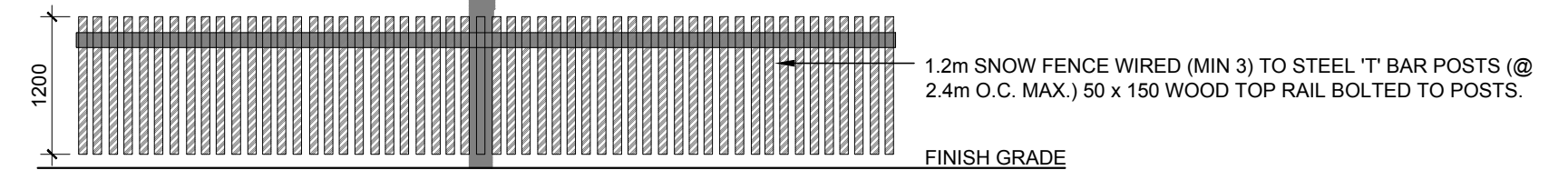
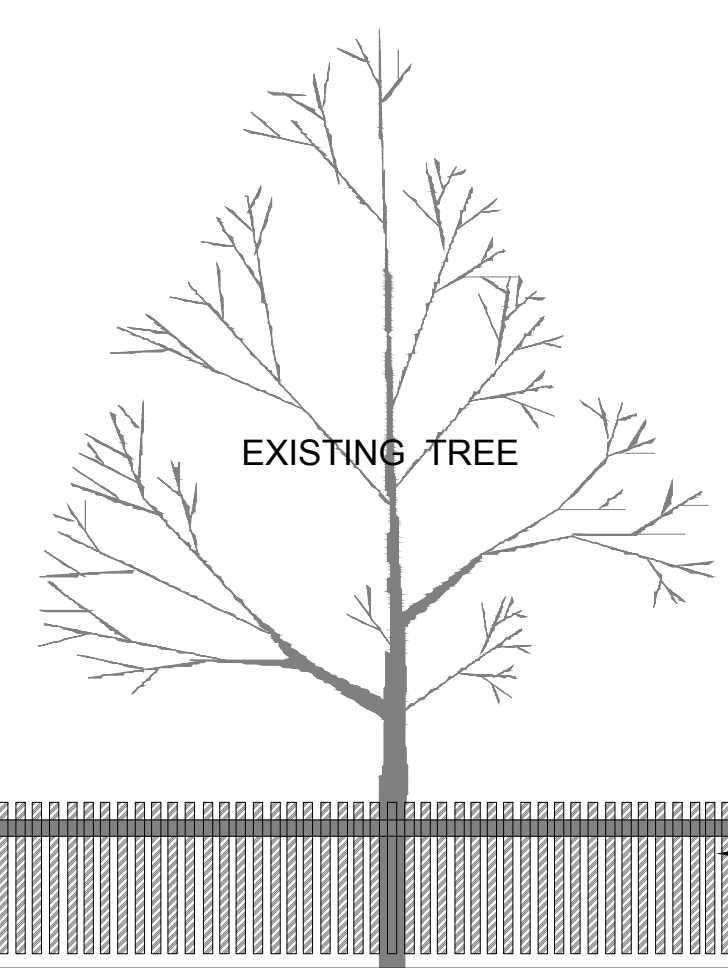

3 TREE PROTECTION FENCE (TEMPORARY DURING CONSTRUCTION)
L.1 N.T.S.

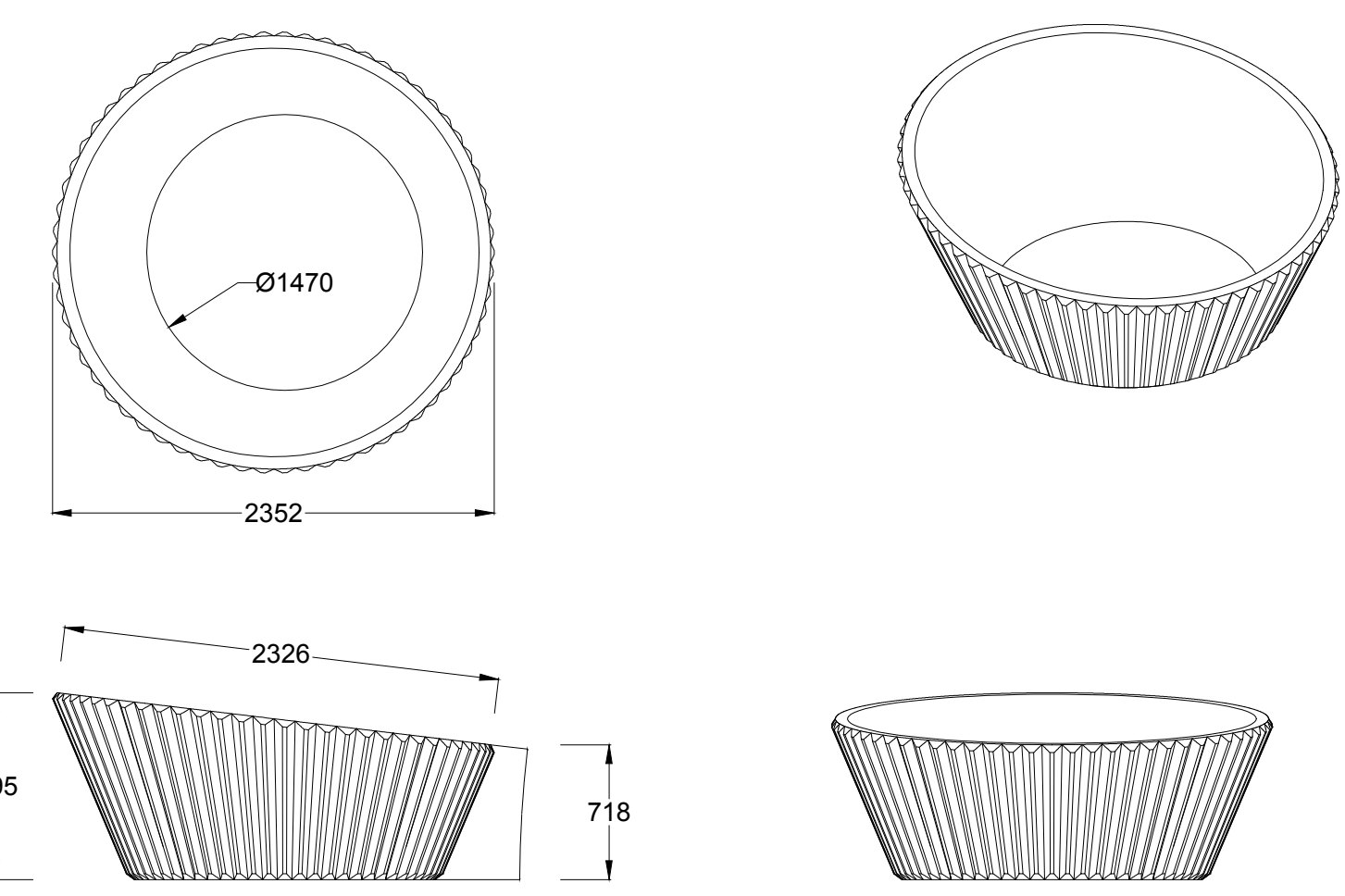

4 REINFORCED CAST STONE TREE PLANTER BY "LANDSCAPE FORMS"
L.1 N.T.S.

No.	Issue	Date	DR	CK
2	REVISED AS PER CITY COMMENTS	08/11/2023	LC	JL
1	ISSUED FOR SITE PLAN APPROVAL	04/18/2023	LC	JL

JAMES B. LENNOX & ASSOCIATES INC.
LANDSCAPE ARCHITECTS
3332 CARLING AVE. OTTAWA, ONTARIO K2H 1S6
Tel. (613) 722-5168 Fax. (613) 343-3942

PROJECT
SOMERSET APARTMENTS
352 SOMERSET STREET, OTTAWA, ON.

DRAWING
LANDSCAPE PLAN

SCALE AS SHOWN
START DATE APRIL, 2023
PROJECT NO.

PROJECT NORTH	DRAWING NO. L.1
---------------	---------------------------

PLOT SIZE ARCH-D