

**EXISTING TREE LIST**

KEY	BOTANICAL NAME	COMMON NAME	SIZE	CRITICAL ROOT ZONE	OWNERSHIP	CONDITION	ACTION
1-AF	<i>Acer x freemanii</i>	Freeman's Maple	90mm DBH	900mm	City of Ottawa	POOR	TO REMAIN
1-AN	<i>Acer negundo</i>	Manitoba Maple	90mm DBH	1500mm	226 Preston	GOOD	TO REMAIN
1-RC	<i>Rhamnus cathartica</i>	Common Buckthorn	150mm DBH	1000mm	119 Balsam	GOOD	TO REMAIN
1-SR	<i>Syringa reticulata</i>	Japanese Tree Lilac	150mm DBH	900mm	119 Balsam	GOOD	TO REMAIN
1-UW	<i>Ulmus wilsoniana 'Prospector'</i>	Prospector Elm	110mm DBH	1100mm	City of Ottawa	POOR	TO REMAIN

**PROPOSED PLANT LIST**

KEY	QTY.	BOTANICAL NAME	COMMON NAME	SIZE	CONDITION	REMARKS
<b>TREES</b>						
SB	1	<i>Amelanchier canadensis</i>	Serviceberry	60mm cal.	B&B	Single leader

**GENERAL NOTES:**

- It is the responsibility of the appropriate contractor or official to report any errors, omissions or discrepancies on this plan with actual site conditions to the Landscape Architect before proceeding with construction.
- The contractor is to notify all utility companies and authorities prior to any excavation and ascertain locations of underground services.
- The contractor is to reinstate all areas and items damaged as a result of construction activity.
- The contractor is to comply with all pertinent codes and by-laws.
- The contractor is to maintain a positive surface run-off throughout the entire construction period.
- The Landscape Architect is not responsible for subsurface conditions.
- The contractor is to identify all existing trees to remain on site with the Landscape Architect prior to construction.
- The contractor is to stake the proposed location of all plant material in conjunction with the Landscape Architect prior to excavation.
- Minimum distances for selected deciduous trees are as follows:
  - Building Foundations 7.5m
  - Sidewalks 1.5m
  - Public Streets 2.5m
  - Underground Infrastructure 2.0m
- All trees within 1m of underground utility trenches are to be excavated by hand.
- Remove all protective wrapping from tree trunks after installation.
- Staking of trees shall only be performed if necessary.
- Ensure that mulch is pulled back a min. distance of 75mm from base of tree trunk.

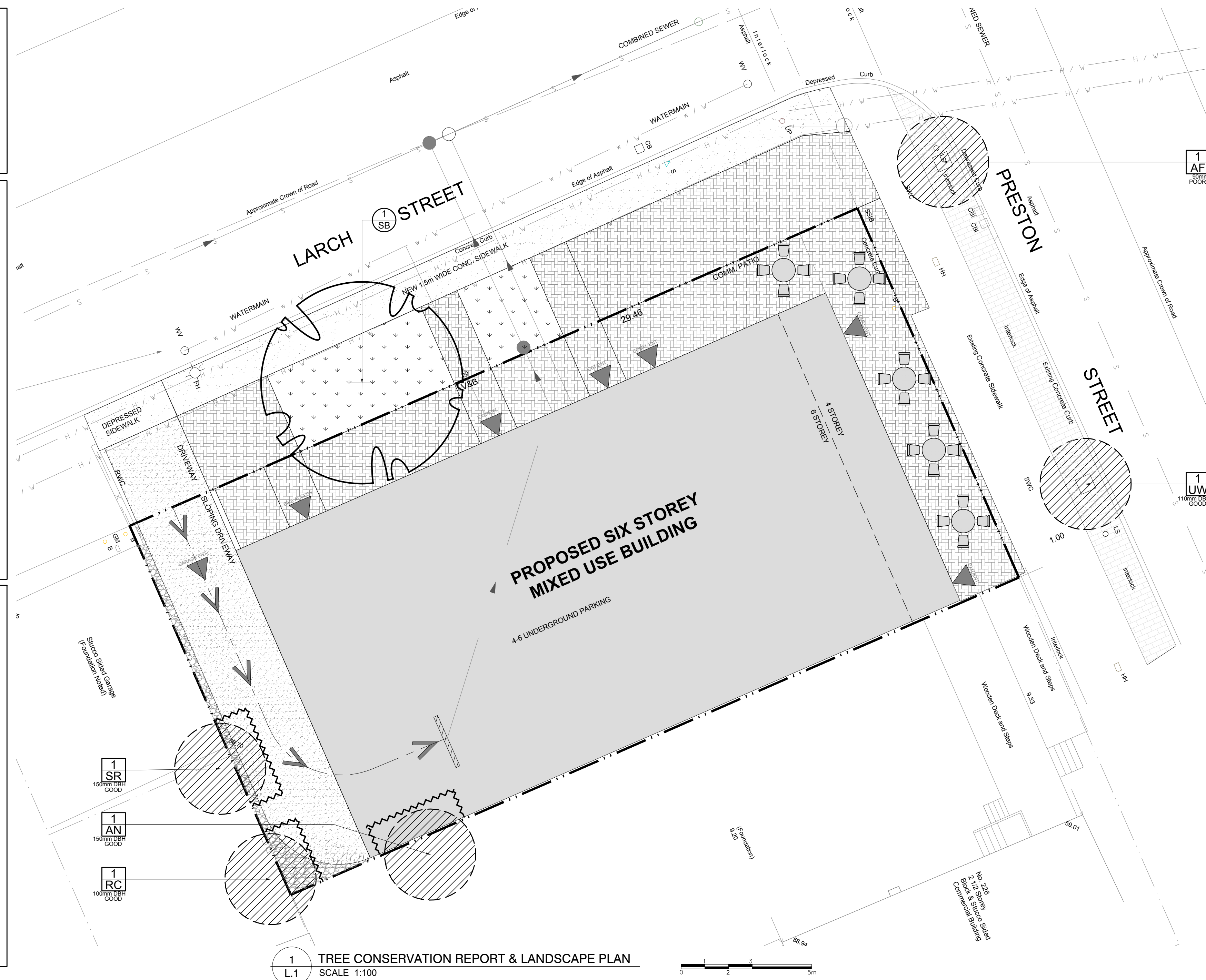

**1** TREE CONSERVATION REPORT & LANDSCAPE PLAN  
SCALE: 1:100

CLIENT: **OTTAWA CARLETON CONSTRUCTION**

CONSULTANTS: **OTTAWA CARLETON CONSTRUCTION**

SURVEYORS: **JENNIS, O'SULLIVAN, VOLLEBECK LTD.**  
14 Concourse Gate, Suite 505  
Nepean, Ont. K2E 7S6  
Ottawa, ON K2B 9H6  
Phone: (613) 272-0850 / Fax: (613) 272-1079  
Email: jennis@jovell.com

CIVIL ENGINEERS: **exp Services Inc.**  
E: +1 813 888 1899 / E: +1 813 225 7330  
2650 Queensway Drive, Unit 100  
Ottawa, ON K2B 9H6  
Canada  
www.exp.com

**LEGEND**

- EXISTING TREE TO REMAIN
- EXISTING PRECAST CONCRETE PAVERS TO REMAIN
- PROPOSED DECIDUOUS TREE
- PROPOSED RIVERSTONE
- PROPOSED SOD
- PROPOSED PRECAST CONCRETE PAVERS
- TREE PROTECTION FENCE
- PROPOSED TABLE WITH CHAIRS

No.	Issue	Date	DR	CK
2	REVISED PER NEW SITE PLAN	03/15/2023	ML	JL
1	ISSUED FOR DISCUSSION & REVIEW	11/16/2022	ML	JL

**JAMES B. LENNOX & ASSOCIATES INC.**  
**LANDSCAPE ARCHITECTS**  
3332 CARLING AVE. OTTAWA, ONTARIO K2H 5A8  
Tel. (613) 722-5168 Fax. (1866) 343-3942

PROJECT: **PROPOSED SIX STOREY MIXED USE BUILDING**  
224 PRESTON STREET, OTTAWA ON

DRAWING: **TREE CONSERVATION REPORT & LANDSCAPE PLAN**

STAMP: **ASSOCIATION OF LANDSCAPE ARCHITECTS OF ONTARIO**

SCALE: AS SHOWN

START DATE: NOVEMBER 2022

PROJECT NO.: 23MIS2308

PROJECT NORTH

DRAWING NO.: **L.1**

PLOT SIZE ARCH-D

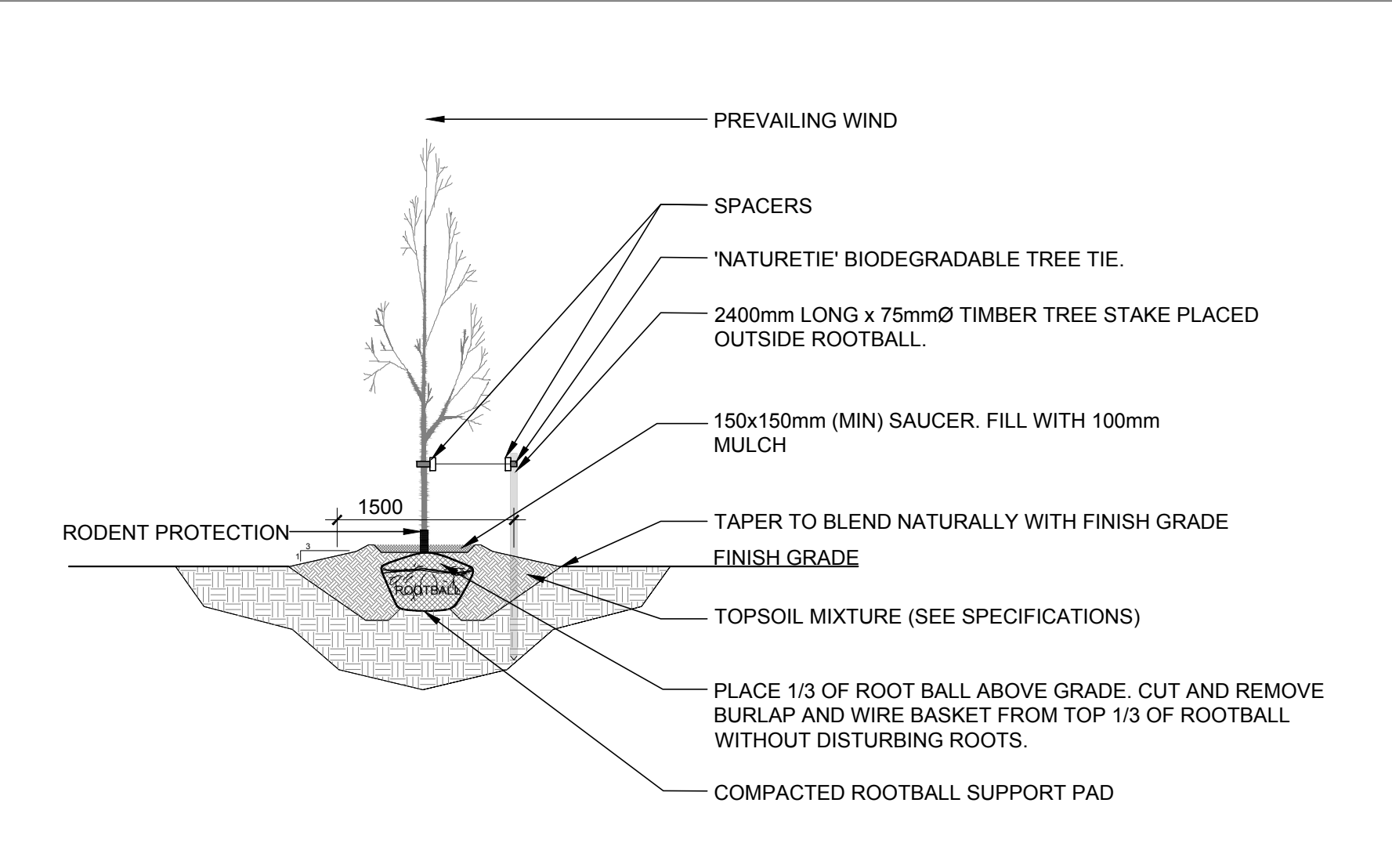

**2** DECIDUOUS TREE PLANTING  
SCALE: NTS

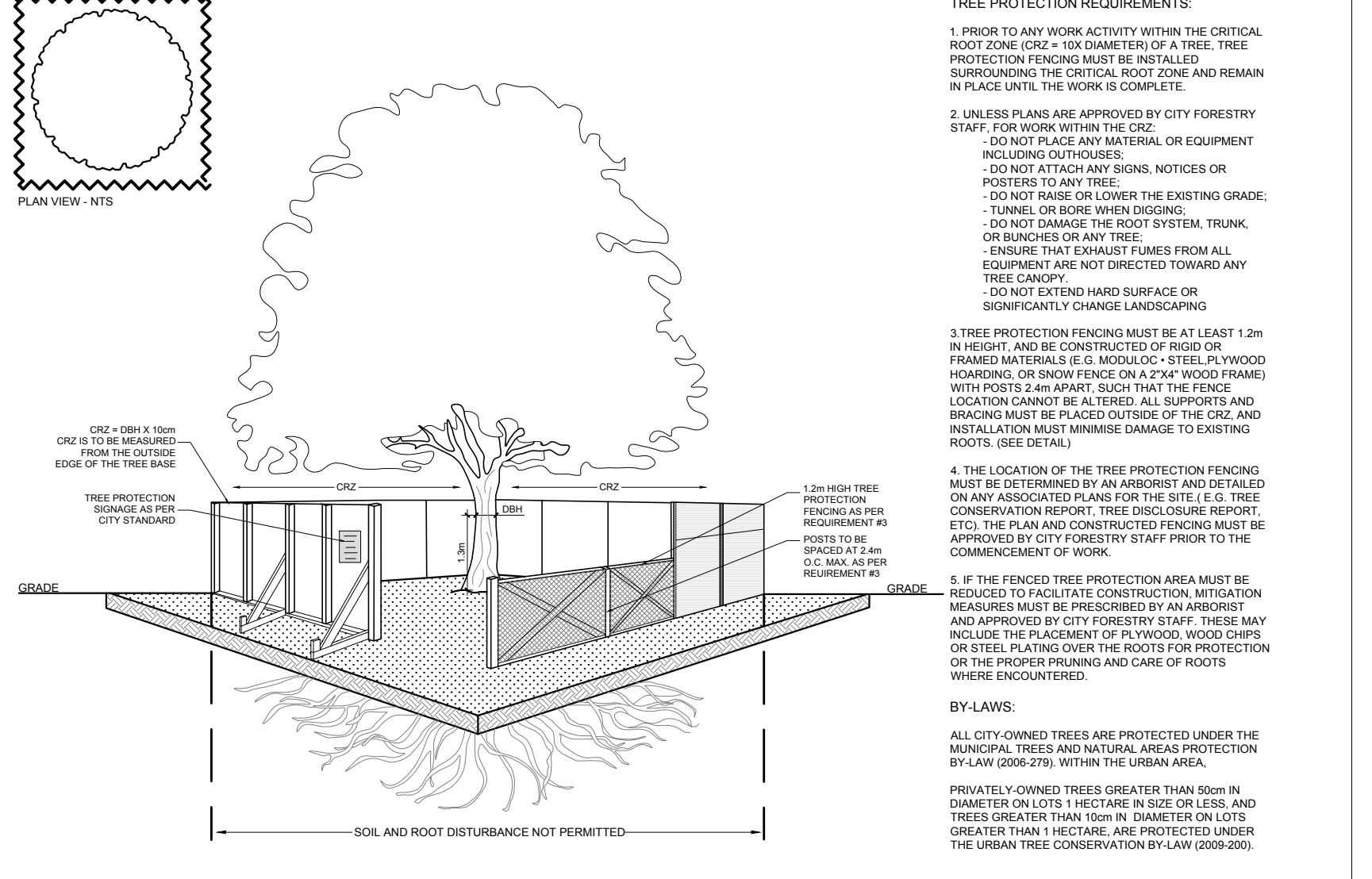

**3** TREE PROTECTION FENCE  
SCALE: NTS

**TREE PROTECTION REQUIREMENTS:**

- PRIOR TO ANY WORK ACTIVITY WITHIN THE CRITICAL ROOT ZONE (CRZ) OF A TREE, TREE PROTECTION FENCING MUST BE INSTALLED SURROUNDING THE CRITICAL ROOT ZONE AND REMAIN IN PLACE UNTIL THE WORK IS COMPLETE.
  - DO NOT PLACE ANY MATERIAL OR EQUIPMENT INCLUDING OUTHOUSES.
  - DO NOT ATTACH ANY SIGNS, NOTICES OR POSTERS TO ANY TREE.
  - DO NOT RAISE OR LOWER THE EXISTING GRADE.
  - TUNNELS OR BORING WHEN DIGGING.
  - DO NOT DAMAGE THE ROOT SYSTEM, TRUNK, OR BRANCHES OF ANY TREE.
  - SIGNAGE THAT IS NOT STAKED FROM ALL EQUIPMENT ARE NOT DIRECTED TOWARD ANY TREE CANOPY.
  - DO NOT EXTEND HARD SURFACE OR SIGNIFICANTLY CHANGE LANDSCAPING.
- UNLESS PLANS ARE APPROVED BY CITY FORESTRY STAFF FOR WORK WITHIN THE CRZ:
  - DO NOT PLACE ANY MATERIAL OR EQUIPMENT INCLUDING OUTHOUSES.
  - DO NOT ATTACH ANY SIGNS, NOTICES OR POSTERS TO ANY TREE.
  - DO NOT RAISE OR LOWER THE EXISTING GRADE.
  - TUNNELS OR BORING WHEN DIGGING.
  - DO NOT DAMAGE THE ROOT SYSTEM, TRUNK, OR BRANCHES OF ANY TREE.
  - SIGNAGE THAT IS NOT STAKED FROM ALL EQUIPMENT ARE NOT DIRECTED TOWARD ANY TREE CANOPY.
  - DO NOT EXTEND HARD SURFACE OR SIGNIFICANTLY CHANGE LANDSCAPING.
- TREE PROTECTION FENCING MUST BE AT LEAST 1.2m IN HEIGHT, AND BE CONSTRUCTED OF RIGID OR FRAMED MATERIALS (E.G. WOOD/CLC/STEEL) PYLONWOOD HOARDING, OR SNOW FENCE (ON A 2"x4" WOOD FRAME) WITH PILES 2.4m APART, SUCH THAT THE FENCE LOCATION CANNOT BE ALTERED. ALL SUPPORTS AND BRACING MUST BE PLACED OUTSIDE OF THE CRZ, AND INSTALLATION MUST MINIMIZE DAMAGE TO EXISTING ROOTS (SEE DETAIL).
- THE LOCATION OF THE TREE PROTECTION FENCING MUST BE DETERMINED BY AN ARBORIST AND DETAILED ON ANY ASSOCIATED PLANS FOR THE SITE (E.G. TREE CONSERVATION REPORT, TREE DISCLOSURE REPORT, ETC.). THE PLAN AND CONSTRUCTED FENCING MUST BE APPROVED BY CITY FORESTRY STAFF PRIOR TO THE COMMENCEMENT OF WORK.
- IF THE FENCED TREE PROTECTION AREA MUST BE REMOVED TO FACILITATE CONSTRUCTION, MITIGATION MEASURES MUST BE PRESCRIBED BY AN ARBORIST AND APPROVED BY CITY FORESTRY STAFF. THESE MAY INCLUDE THE PLACEMENT OF PYLONWOOD, WOOD CHIPS OR STEEL PLATING OVER THE ROOTS FOR PROTECTION OR THE PROPER PRUNING AND CARE OF ROOTS WHERE ENCOUNTERED.

**BY-LAWS:**  
ALL CITY OWNED TREES ARE PROTECTED UNDER THE MUNICIPAL TREES AND NATURAL AREAS PROTECTION BY-LAW 2008-278, WITHIN THE URBAN AREA.  
PRIVATELY OWNED TREES GREATER THAN 100mm IN DIAMETER ON LOTS 1 HECTARE IN SIZE OR LESS, AND TREES GREATER THAN 100mm IN DIAMETER ON LOTS GREATER THAN 1 HECTARE, ARE PROTECTED UNDER THE URBAN TREE CONSERVATION BY-LAW (2008-205).