

**EROSION AND SEDIMENT CONTROLS DURING CONSTRUCTION.**

- DURING ALL SOIL DUMP ACTIVITIES, EROSION AND SEDIMENTATION SHALL BE CONTROLLED BY THE FOLLOWING TECHNIQUES:
1. LIMIT THE EXTENT OF EXPOSED SOILS AT ANY GIVEN TIME.
  2. REVEGETATION OF EXPOSED AREAS AS SOON AS POSSIBLE.
  3. MINIMIZATION OF AREA TO BE CLEARED AND DISRUPTION TO ADJACENT AREAS.
  4. PROVIDE TEMPORARY EROSION CONTROL BLANKET ON PROPOSED SLOPES GREATER THAN 7% UNTIL SUFFICIENT LANDSCAPE COVER HAS BEEN ESTABLISHED AT THE END OF EACH PHASE OF SOIL DUMP ACTIVITY.
  5. THE PRODUCT USED AS EROSION CONTROL BLANKET SHALL BE RATED FOR SLOPES UP TO AND STEEPER THAN 3H:1V.
  6. A SILT FENCE TO BE INSTALLED TO LOCATIONS SHOWN ON THIS DRAWING PRIOR TO COMMENCEMENT OF INFILTRATION TRENCH CONSTRUCTION AND SHALL BE MAINTAINED SUFFICIENT LANDSCAPE COVER HAS BEEN ESTABLISHED.
  7. A VISUAL INSPECTION SHALL BE COMPLETED DAILY ON SEDIMENT CONTROL BARRIERS AND ANY DAMAGE REPAIRED IMMEDIATELY. CARE WILL BE TAKEN TO PREVENT DAMAGE DURING CONSTRUCTION OPERATIONS.
  8. IN SOME CASES SOME BARRIERS MAY BE REMOVED TEMPORARILY TO ACCOMMODATE THE CONSTRUCTION OPERATIONS. THE AFFECTED BARRIERS WILL BE REINSTATED AT NIGHT WHEN CONSTRUCTION IS COMPLETED.
  9. DURING THE COURSE OF CONSTRUCTION IF THE ENGINEER BELIEVES THAT ADDITIONAL PREVENTION METHODS ARE REQUIRED TO CONTROL EROSION AND SEDIMENTATION, THE CONTRACTOR WILL INSTALL ADDITIONAL SILT FENCES OR OTHER METHODS AS REQUIRED TO THE SATISFACTION OF THE ENGINEER.
  10. CONSTRUCTION AND MAINTENANCE REQUIREMENTS FOR EROSION AND SEDIMENT CONTROLS TO COMPLY WITH ONTARIO PROVINCIAL STANDARD SPECIFICATION (OPSS) OPSS 805, AND CITY OF OTTAWA SPECIFICATIONS.
  11. SEDIMENT AND EROSION CONTROL MEASURES MAY BE MODIFIED IN THE FIELD AT THE DISCRETION OF THE CITY OF OTTAWA SITE INSPECTOR OR CONSERVATION AUTHORITY.

**LIGHT DUTY SILT-FENCE NOTES:**

1. WOVEN WIRE FENCE TO BE FASTENED SECURELY TO WOOD POSTS WITH WIRE TIES OR STAPLES.
2. POSTS TO BE SPACED AT 2.3 METRES CENTRE TO CENTRE.
3. WHEN TWO SECTIONS OF FILTER CLOTH ADJOIN EACH OTHER THEY SHALL BE OVERLAPPED BY A MINIMUM OF 500mm.
4. MAINTENANCE SHALL BE PERFORMED AS NEEDED AND MATERIAL REMOVED WHEN "BULGES" DEVELOP IN THE SILT FENCE.
5. WOOD POSTS TO BE HARDWOOD TYPE (50mm x 50mm).
6. GEOTEXTILE TO BE EMBEDDED 200mm INTO GROUND.
7. GEOTEXTILE TO CONFORM TO OPSS 805 STANDARDS.
8. SILT FENCE MUST BE INSTALLED BEFORE COMMENCEMENT OF CONSTRUCTION AND IN ACCORDANCE WITH DETAIL. SILT FENCE CAN BE REMOVED AFTER LANDSCAPING IS COMPLETE.
9. SEDIMENTS MUST BE CLEARED AWAY WHEN THEY REACH HALF THE HEIGHT OF THE FENCE.

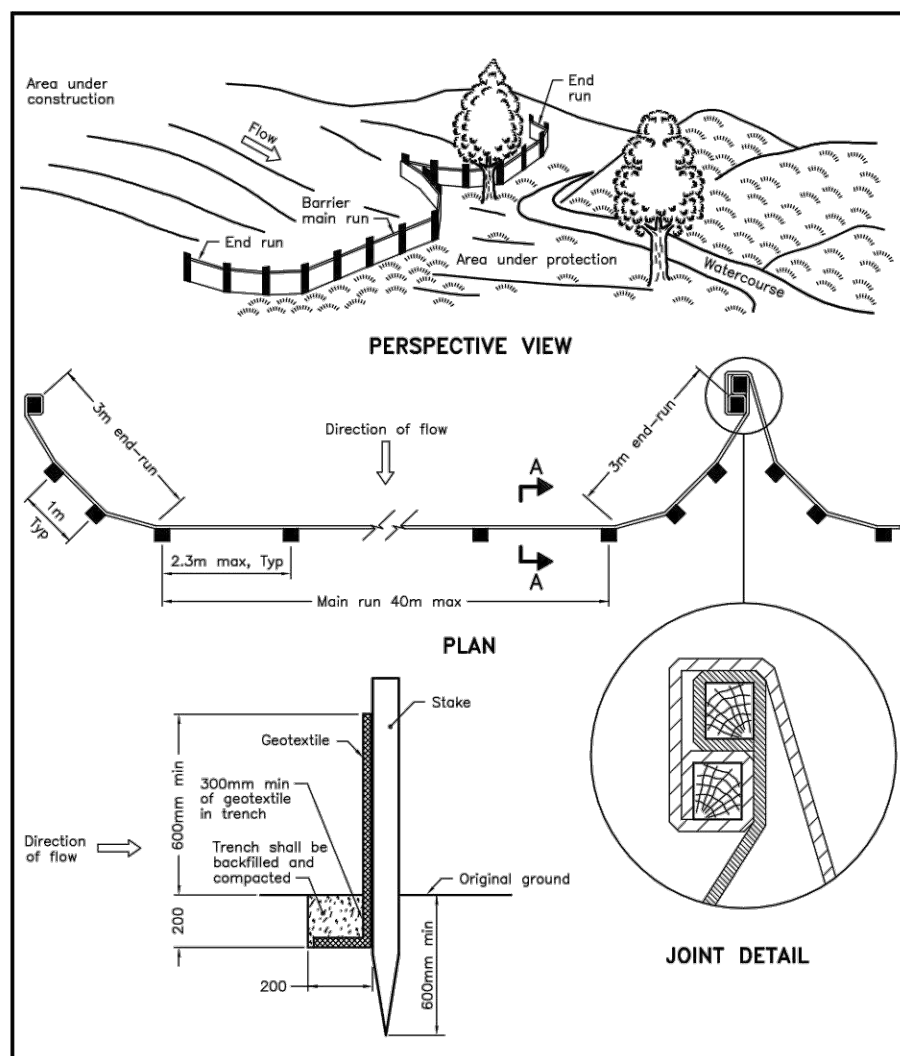

NOTE:  
A All dimensions are in millimetres unless otherwise shown.

ONTARIO PROVINCIAL STANDARD DRAWING		Nov 2015	Rev 2
LIGHT-DUTY SILT FENCE BARRIER			
		OPSD 219.110	



**LEGEND**

	PROPERTY LINE
	EXISTING BOTTOM OF SLOPE
	EXISTING TOP OF SLOPE
	EXISTING CENTER LINE OF DITCH
	EXISTING GATE
	EXISTING CHAIN LINK FENCE
	EXISTING OVERHEAD HYDRO LINE
	EXISTING UTILITY POLE
	PROPOSED SLOPE MAX. 3:1
	PROPOSED GRADES
	PROPOSED DRAINAGE PATTERN
	PROPOSED SOIL DUMP AREA
	PROPOSED LANDSCAPING (GRASS)
	PROPOSED 50mm DIA. CLEAR STONE
	PROPOSED 300mm DIA. HDPE PIPE
	PROPOSED TEMPORARY LIGHT-DUTY SILT FENCE

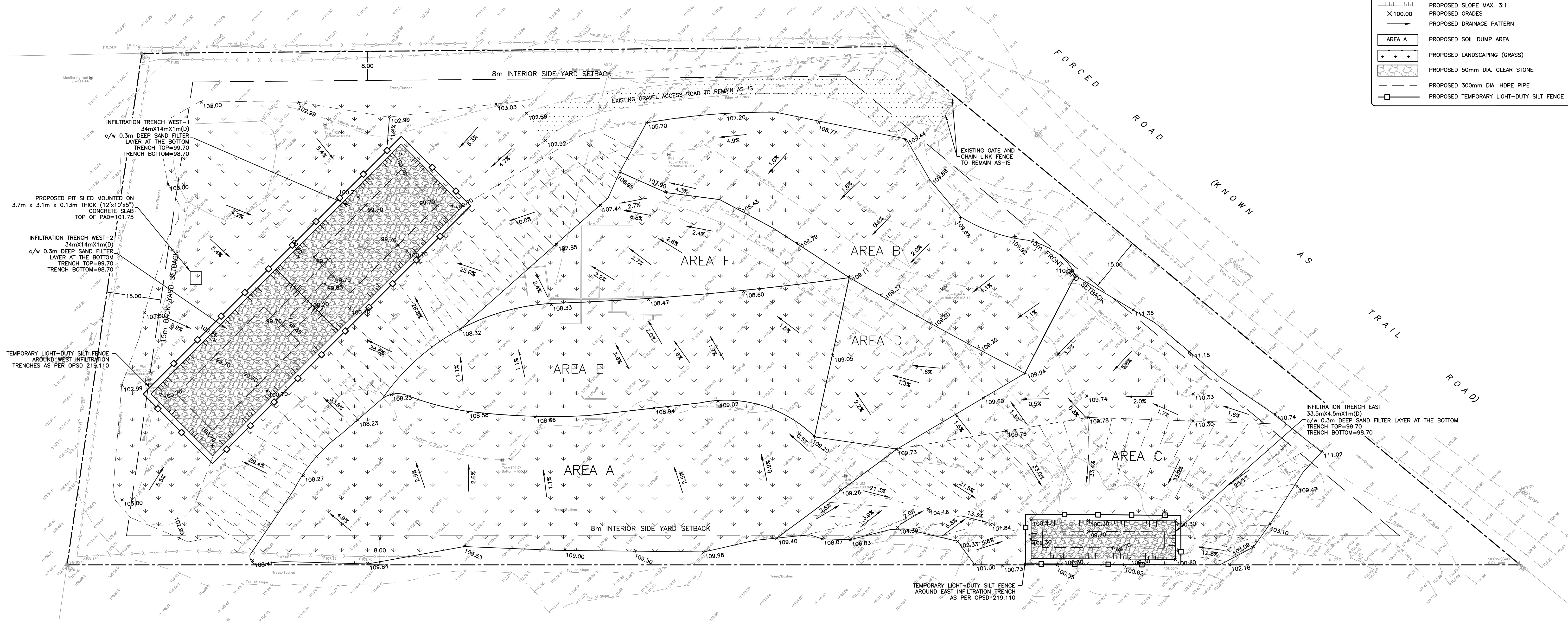

**CAUTION**  
THE POSITION OF ALL POLE LINES, CONDUITS, WATERMANS, SEWERS AND OTHER UNDERGROUND UTILITIES AND STRUCTURES IS NOT NECESSARILY SHOWN ON THE CONTRACT DRAWINGS, AND WHERE SHOWN, THE ACCURACY OF THE POSITION OF SUCH UTILITIES AND STRUCTURES IS NOT GUARANTEED. BEFORE STARTING WORK, DETERMINE THE EXACT LOCATION OF ALL SUCH UTILITIES AND STRUCTURES AND ASSUME ALL LIABILITY FOR DAMAGE TO THEM.

**PRELIMINARY  
NOT FOR CONSTRUCTION**

REV	REVISION DESCRIPTION	DATE	BY	APPD
1	ISSUED FOR CLIENT REVIEW	20/10/22	AJ	AA

SCALE	DESIGNED BY	REVIEWED BY	CLIENT
0 5m 10m 20m			DRAIN-ALL LTD
HORIZONTAL 1:500			3385 HAWTHORNE ROAD, OTTAWA, ON.
			K1G 4G2 613.739.1070

exp Services Inc.	PROJECT	ENGINEERING SERVICES FOR
1-416-338-1899   1-613-225-7330	DESIGN	4380 TRAIL ROAD,
2550 Woodbine Ave. Unit 100	CHECKED	OTTAWA, ONTARIO.
Ottawa, ON K2B 8R6	AA	DATE 27/04/2022
Canada	CAD	TITLE
www.exp.com	AJ	ULTIMATE EROSION AND SEDIMENT
• BUILDINGS • EARTH & ENVIRONMENT • ENERGY •	PROJECT MANAGER	CONTROL PLAN
• INDUSTRIAL • INFRASTRUCTURE • SUSTAINABILITY •	AA	DRAWING No.

PROJECT No.	OTT-21023795-A0
SURVEY	FSD
DATE	27/04/2022
DRAWING No.	C300

Filepaths: \\191.21.127.38\cadd\09\_mechanical\05\_electrical\01\21023795 - all\_civil\exp\exp.dwg  
 User: Store07/27/2022 8:54:54 AM  
 Plot: 27/04/2022 8:56:50 AM  
 Reference: \\191.21.127.38\cadd\09\_mechanical\05\_electrical\01\21023795 - all\_civil\exp\exp.dwg  
 Reference: \\191.21.127.38\cadd\09\_mechanical\05\_electrical\01\21023795 - all\_civil\exp\exp.dwg

#?????