

**PART OF LOT 5
CONCESSION 4 (OTTAWA FRONT)
(Geographic Township of Gloucester)
CITY OF OTTAWA**

Surveyed by Annis, O'Sullivan, Vollebakk Ltd.

Scale 1 : 250



Metric

DISTANCES SHOWN ON THIS PLAN ARE IN METRES AND CAN BE CONVERTED TO FEET BY DIVIDING BY 0.3048

Surveyor's Certificate

I CERTIFY THAT:

1. This survey and plan are correct and in accordance with the Surveys Act, the Surveyors Act and the regulations made under them.
2. The survey was completed on March 2, 2022.

Mac 11/22
Date

Terrell J. Allison
Terrell J. Allison
Ontario Land Surveyor

BENCHMARK
Top of Spindle of Fire Hydrant Elev.=87.89

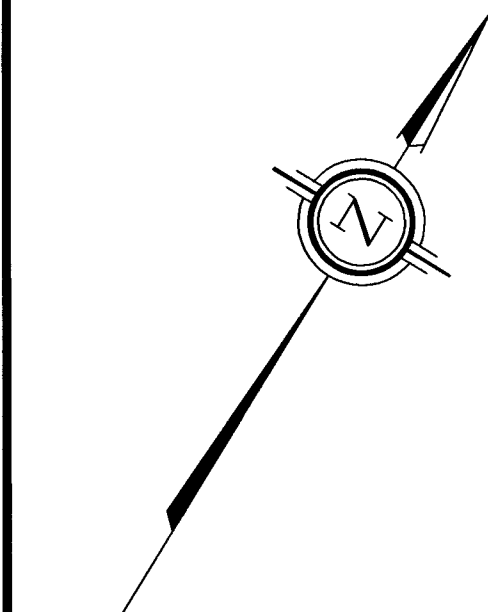

○ MH-S
TVG-86.54

ROAD ALLOWANCE BETWEEN CONCESSIONS 3 AND 4 (OTTAWA FRONT)

KNOWN AS CHEMIN RENAUD ROAD

PIN 04404 - 0253

PART 2 PLAN 4R-28739
PIN 04352 - 2295
BY-LAW NO. 2015-260

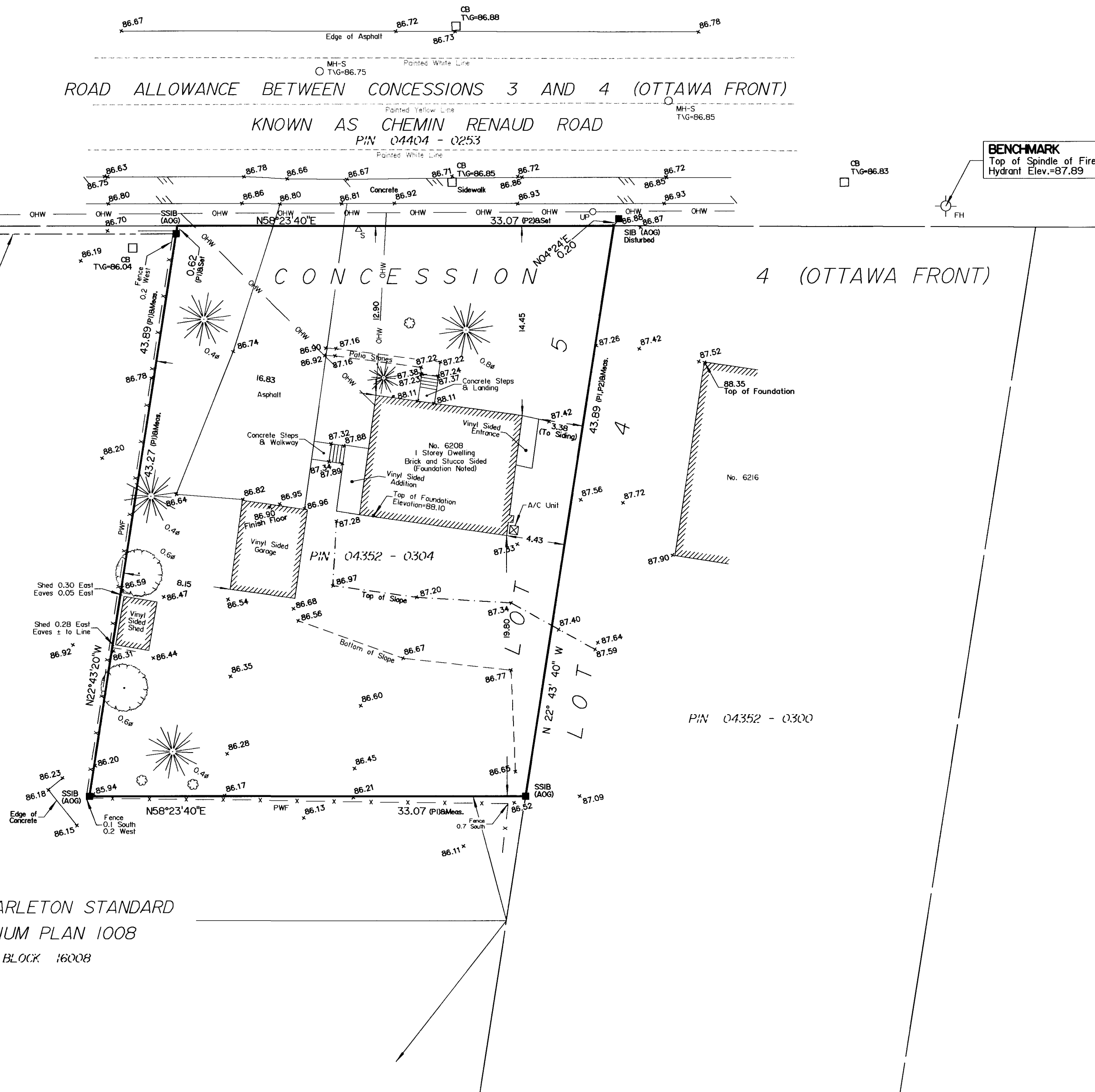

Notes & Legend

Denotes	
□	Survey Monument Planted
■	Survey Monument Found
SIB	Standard Iron Bar
SSIB	Short Standard Iron Bar
IB	Iron Bar
Meas.	Measured
(AOG)	Annis, O'Sullivan, Vollebakk Ltd.
(PI)	Ottawa Carleton Standard Condominium Plan No. 1008
(P2)	Plan 4R-28739
○ MH-S	Maintenance Hole (Sanitary)
— OHW —	Overhead Wires
○ UP	Utility Pole
□ CB	Catch Basin
○ FH	Fire Hydrant
○	Deciduous Tree
★	Coniferous Tree
△ S	Sign
P&W	Post and Wire
φ	Diameter
+ 86.00	Location of Elevations
C/L	Centreline
—	Property Line

ASSOCIATION OF ONTARIO
LAND SURVEYORS
PLAN SUBMISSION FORM
V-24434

THIS PLAN IS NOT VALID UNLESS IT IS AN EMBOSSED ORIGINAL COPY ISSUED BY THE SURVEYOR IN ACCORDANCE WITH Regulation 1026, Section 29 (3)

ELEVATION NOTES

1. Elevations shown are geodetic and are referred to the CGVD28 geodetic datum.
2. It is the responsibility of the user of this information to verify that the job benchmark has not been altered or disturbed and that its relative elevation and description agrees with the information shown on this drawing.

UTILITY NOTES

1. This drawing cannot be accepted as acknowledging all of the utilities and it will be the responsibility of the user to contact the respective utility authorities for confirmation.
2. Only visible surface utilities were located.
3. A field location of underground plant by the pertinent utility authority is mandatory before any work involving breaking ground, probing, excavating etc.

OTTAWA-CARLETON STANDARD
CONDOMINIUM PLAN 1008
CONDO BLOCK 16008

© Annis, O'Sullivan, Vollebakk Ltd, 2022. *THIS PLAN IS PROTECTED BY COPYRIGHT*

ANNIS, O'SULLIVAN, VOLLEBEKK LTD.
165 Bay Street
Embrun, Ont. K0A 1W1
Phone: (613) 443-3364
Email: Embrun@aovlltd.com

Ontario
Land Surveyors

Job No. E-2002-22

BIN