

- TREE PROTECTION**
- The Landscape Architect or Certified Arborist is to determine the location of the tree protection fencing and detail it on any associated plans for the site (e.g. tree conservation report, tree disclosure report, etc.).
 - Under the guidance of a Landscape Architect or Certified Arborist, erect a fence at the critical root zone (CRZ) of trees. Diameter at breast height (DBH) is the trunk diameter measured at 1.3m height on the tree trunk. The CRZ is calculated as DBH x 10. Refer to the Tree Protection Fence detail.
 - Refer to the Tree Protection Plan for fence location. City Forestry Staff are to approve both the plan and the installed fence prior to work commencement.
 - Do not place any material or equipment within 2m of the CRZ of any tree, including outhouses.
 - Do not attach any signs, notices, or posters to any tree.
 - Do not disturb, raise, or lower the existing grade within the CRZ without approval.
 - Only tunnel or bore when digging within the CRZ of a tree. Hand work only where required within the CRZ, absolutely no machinery permitted.
 - Do not damage the root system, trunk, or branches, or any tree.
 - Do not extend hard surface or significantly change landscaping.
 - Ensure that exhaust fumes from all equipment are directed away from any tree canopy.
 - When trees marked for removal overlap with the CRZ of trees marked for preservation: cut roots at the edge of the CRZ and grind down stumps after tree removals, do not pull out stumps. Ensure there is not root pulling or disturbance of the ground within the CRZ.
 - Prior to work taking place, notify and consult the Landscape Architect and City Forestry Staff if roots must be cut. Roots 20mm or larger should be cut at right angles with clean, sharp horticultural tools without tearing, crushing, or pulling. Refer to City of Ottawa Specification S.P. F-8011 Tree Protection, Excavation of Root Zone.
 - If damaged or objectionable branches are observed, consult the Landscape Architect, before any work is conducted. Do not prune leaders. Do not prune more than 1/4 of crown.
 - Set up a water and fertilizing program, if trees are being affected by site works, to the satisfaction of the Landscape Architect.
 - The Landscape Architect is to prescribe mitigation measures if the protected fenced area must be reduced to facilitate construction. Measures may include the placement of plywood, wood chips, or steel plating over the roots for protection. City Forestry Staff are to approve said measures prior to fence movement.
 - City of Ottawa By-law: Protects municipal trees and municipal natural areas in the City of Ottawa and trees on private property in the urban area of the City of Ottawa (2020-340).

- GENERAL**
- Read and interpret this drawing/ drawing set in conjunction with all the contract details and specifications, including related civil, utility, structural, architectural, mechanical, electrical, environmental, geotechnical, and survey information.
 - The Contractor is to determine the exact location, size, material, and elevation of all existing utilities prior to commencing construction. Protect and assume responsibility for all existing utilities regardless of being shown on the drawings.
 - It is essential to use the plans and details in conjunction with the specifications and notes.
 - Do not scale drawings. Work to dimensions only.
 - Protect all existing and retained vegetation for the duration of construction according to the contract details and specifications.
 - Reinstate all areas and items damaged or disturbed, beyond the Limit of Work, because of construction activities, including but not limited to construction staging areas, haul roads, stockpile areas, etc. to the satisfaction of the Consultant. Unless otherwise noted, Contractor is to reinstate all areas to pre-construction condition or better to the satisfaction of the Contract Administrator.

EXISTING TREE INVENTORY - SINGLES

NOTE: INDIVIDUAL TREE LOCATIONS ARE APPROXIMATE. EXACT LOCATION TO BE DETERMINED ON SITE

Key	Botanical Name	Common Name	DBH (cm)	CRZ (m)	Condition	Owner	Remarks	Recomm.
1	Acer rubrum	Red Maple	45.0	4.50	F	Neighbor	Bare. Low vigor and several small cavities	PROTECT
2	Picea glauca	White Spruce	21.0	2.10	G	Neighbor	Mechanical damage	PROTECT
3	Picea glauca	White Spruce	35.0	3.50	F	Neighbor	Lean	PROTECT
4	Picea glauca	White Spruce	0.0	0.00	VP	Neighbor	Dead standing	PROTECT
5	Larix laricina	Tamarack	36.0	3.60	G	Neighbor	None	PROTECT
6	Picea glauca	White Spruce	34.0	3.40	VP	Neighbor	Tree topped at 5meters	PROTECT
7	Thuja occidentalis	Eastern White Cedar	18.0	1.80	P	Neighbor	One sided, nearly dead	PROTECT
8	Pinus strobus	Eastern White Pine	39.0	3.90	P	Neighbor	One stem dead	PROTECT
9	Acer rubrum	Red Maple	12.0	1.20	P	Neighbor	Target carker	PROTECT
10	Acer negundo	Manitoba Maple	48.0	4.80	VP	Neighbor	Multiple large wounds, internat rot	PROTECT
11	Populus deltoides	Eastern Cottonwood	17.0	1.70	G	Neighbor	None	PROTECT
12	Populus deltoides	Eastern Cottonwood	28.0	2.80	G	Neighbor	None	PROTECT
13	Malus spp	Crab Apple	19.0	1.90	VP	Neighbor	Granular placed on roots	PROTECT
14	Acer negundo	Manitoba Maple	27.0	2.70	VP	Neighbor	Spiral seam cavity. Mechanical damage. Granular placed on roots	PROTECT
15	Acer saccharum	Sugar Maple	55.0	5.50	P	Client	One sided, black bark, grass growing out of a cavity near a large branch union	Conflict

EXISTING TREE INVENTORY - GROUPS

Key	Botanical Name	Common Name	% Compos.	DBH Min-Max	DBH Avg	Owner	Remarks	Recomm.
Area A - Trees								
A	Acer saccharum	Sugar Maple	5%	55 - 60	57.50	Client		Conflict
A	Fraxinus americana	White Ash	10%	40 - 50	45.00	Client		Conflict
A	Populus deltoides	Eastern Cottonwood	80%	15	10.00	Client		Conflict
A	Juglans nigra	Black Walnut	5%	40 - 50	45.00	Client		Conflict
Area A - Understorey								
A	Rhamnus cathartica	European Buckthorn	10%	5.00	5.00	Client		Conflict
A	Rhus typhina	Staghorn Sumac	85%	5.00	5.00	Client		Conflict
Area B								
B	Rhamnus cathartica	European Buckthorn	10%	5.00	5.00	Client		Conflict
B	Rhus typhina	Staghorn Sumac	85%	5.00	5.00	Client		Conflict
Area C								
C	Acer rubrum	Red Maple	5%	55 - 60	57.50	Client		Conflict
C	Acer saccharum	Sugar Maple	5%	55 - 60	57.50	Client		Conflict
C	Betula papyrifera	Paper Birch	65%	10	10.00	Client		Conflict
C	Cornus alternifolia	Pagoda Dogwood	5%	5	5.00	Client		Conflict
C	Pinus strobus	Eastern White Pine	15%	30 - 40	35.00	Client		Conflict
C	Salix sp.	Willow	5%	15.00	15.00	Client		Conflict
Area D								
D	Betula papyrifera	Paper Birch	40%	10.00	10.00	Client		Conflict
D	Populus deltoides	Eastern Cottonwood	60%	15.00	15.00	Client		Conflict

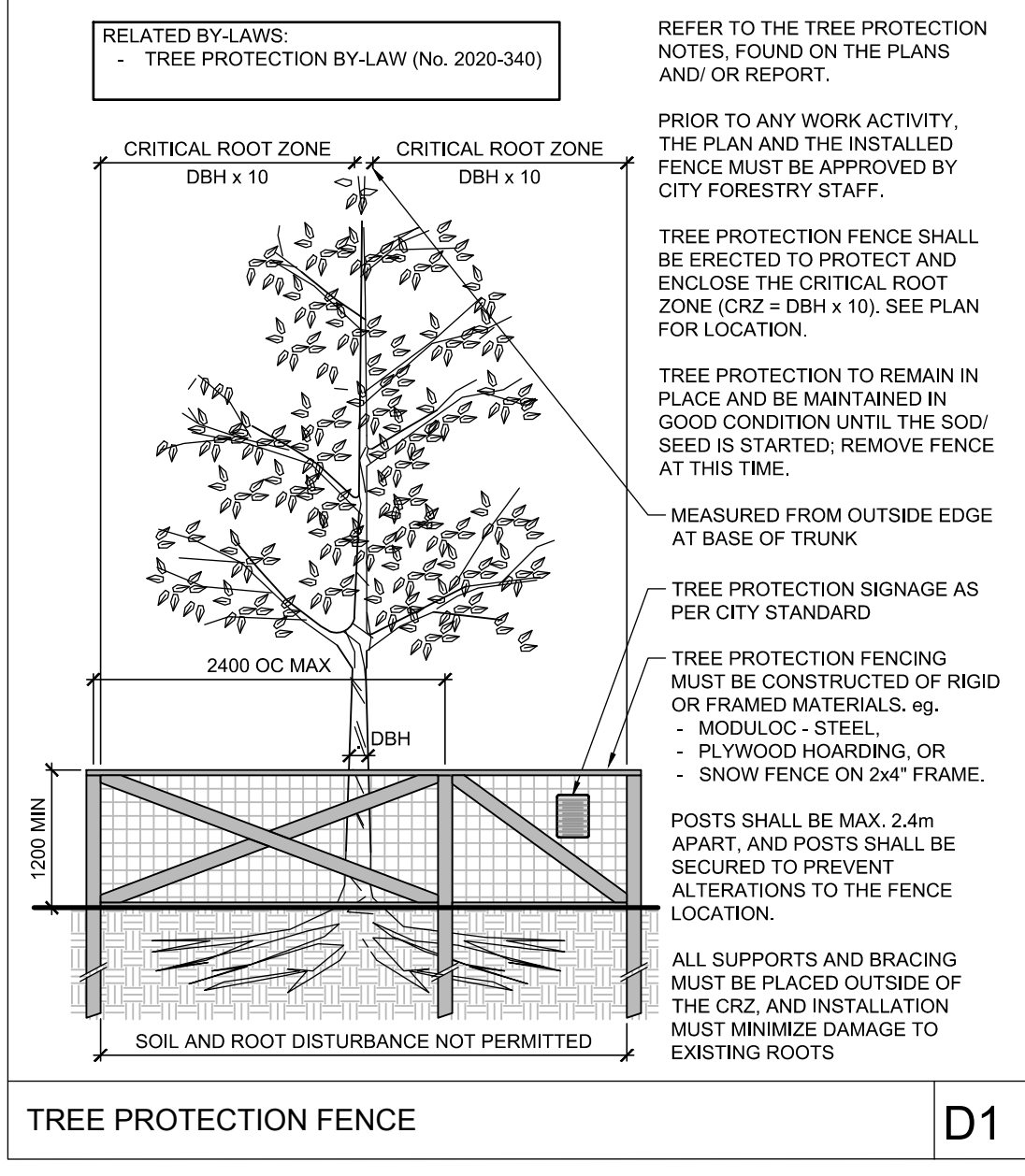

NOTE: THE POSITION OF ALL POLE LINES, CONDUITS, WATERMANS, SEWERS AND OTHER UNDERGROUND AND OVERGROUND UTILITIES AND STRUCTURES IS NOT NECESSARILY SHOWN ON THE CONTRACT DRAWINGS, AND WHERE SHOWN, THE ACCURACY OF THE POSITION OF SUCH UTILITIES AND STRUCTURES IS NOT GUARANTEED. BEFORE STARTING WORK, DETERMINE THE EXACT LOCATION OF ALL SUCH UTILITIES AND STRUCTURES AND ASSUME ALL LIABILITY FOR DAMAGE TO THEM.

NOT FOR CONSTRUCTION

OWNER INFORMATION
2628976 ONTARIO INC.
231 BRITTANY DRIVE, SUITE D
OTTAWA, ONTARIO, K1K 0R8
LALIT AGGARWAL
PHONE: (613)-746-1647
lsa@manorpark.com

No.	REVISION	DATE	BY
1.	ISSUED FOR SITE PLAN CONTROL	JUNE 13/23	RJ

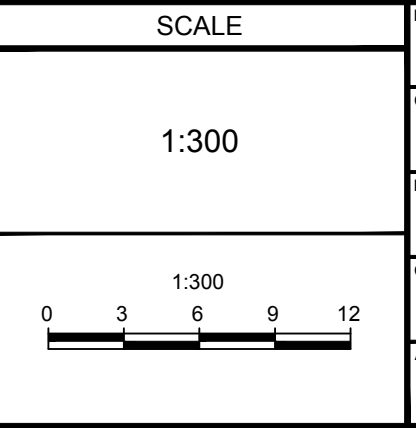

FOR REVIEW ONLY

DESIGN	RI
CHECKED	RI
DRAWN	MT
CHECKED	RI
APPROVED	MT
APPROVED	RJ

NOVATECH
Engineers, Planners & Landscape Architects
Suite 200, 240 Michael Cowpland Drive
Ottawa, Ontario, Canada K2M 1P6
Telephone: (613) 254-9643
Facsimile: (613) 254-5867
Website: www.novatech-eng.com

LOCATION
CITY OF OTTAWA
3317 NAVAN ROAD

DRAWING NAME
TREE CONSERVATION REPORT

PROJECT No. 118076
REV # 1
DRAWING No. 118076-TCR

C:\temp\p\118076-TCR.dwg, TCR, Jun 08, 2023, 2:27pm, rlflem

PLANNING/DESIGN/03890001/0000

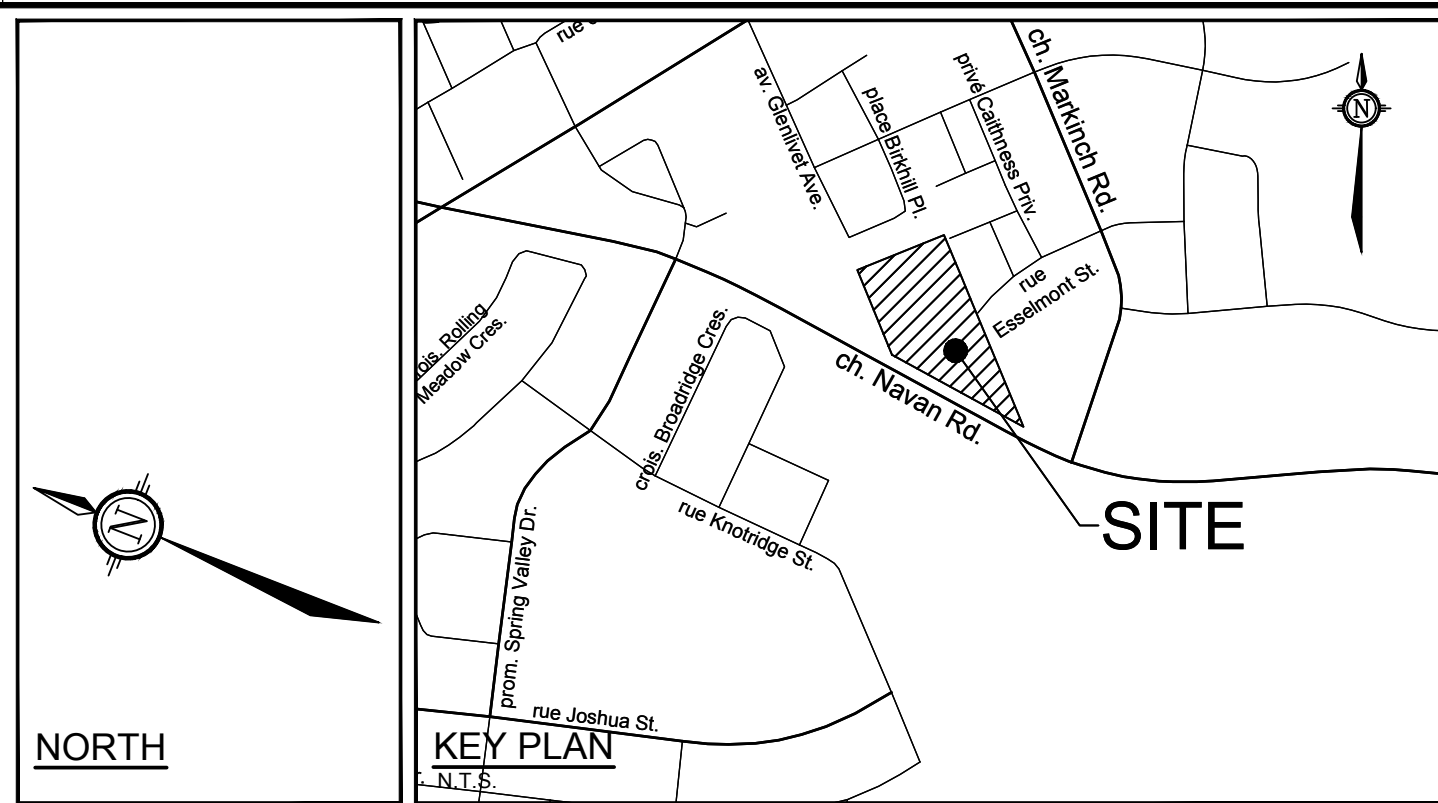
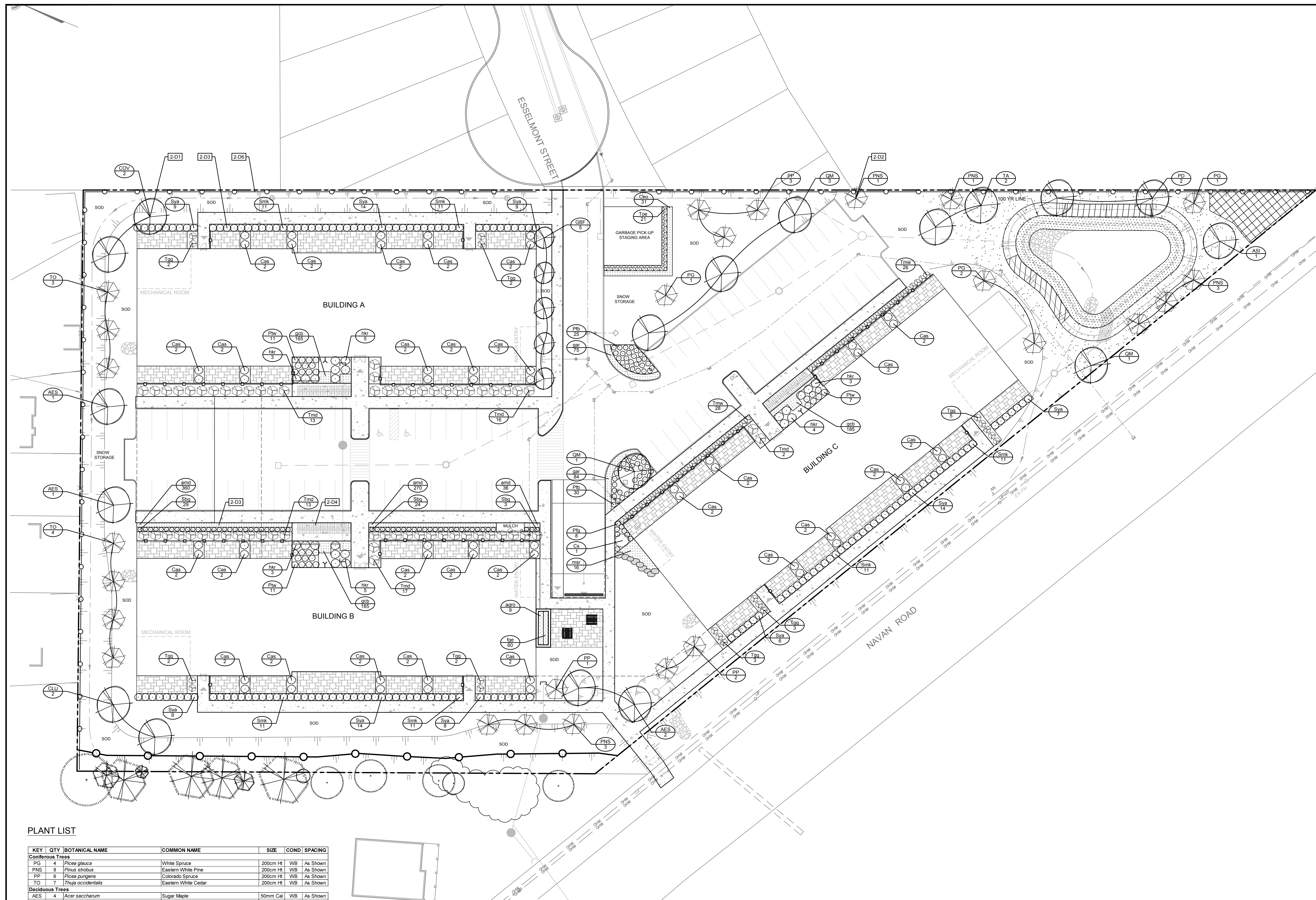

- ### LEGEND
- 3-D1 DETAIL SHEET NO. NOVATECH OR CITY E.G. L1, L2, ETC. - DETAIL NUMBER SEE LIST FOR CODE.
 - PROPERTY LIMIT
 - PROPOSED CONCRETE
 - PROPOSED PAVERS
 - SEED MIX A
 - SEED MIX B
 - NATIVE SHRUB MIX
 - TABLE LAND SHRUB MIX (SMALL)
 - GRASSES / PERENNIALS
 - PROPOSED DECIDUOUS TREE
 - PROPOSED CONIFEROUS TREE
 - PROPOSED SHRUBS
 - SPECIES (SEE PLANT LIST)
 - QUANTITY
 - ACCESSIBLE PICNIC TABLE
 - BOULDERS
 - TREE PROTECTION FENCE
 - WOOD PRIVACY FENCE 1.8m HT
 - DECORATIVE FENCE 1.2m HT
 - LIMIT OF UNDERGROUND GARAGE

- ### GENERAL
- Read and interpret this drawing/ drawing set in conjunction with all the contract details and specifications, including related civil, utility, structural, mechanical, electrical, environmental, geotechnical, and survey information.
 - The Contractor is to determine the exact location, size, material, and elevation of all existing utilities prior to commencing construction. Protect and assume responsibility for all existing utilities regardless of being shown on the drawings.
 - It is essential to use the plans and details in conjunction with the specifications and notes.
 - Do not scale drawings. Work to dimensions only.
 - Protect all existing and retained vegetation for the duration of construction according to the contract details and specifications.
 - Reinstatement areas and items damaged or disturbed, beyond the Limit of Work, because of construction activities, including but not limited to construction staging areas, haul roads, stockpile areas, etc. to the satisfaction of the Consultant. Unless otherwise noted, Contractor is to reinstate all areas to pre-construction condition or better to the satisfaction of the Contract Administrator.
- ### PLANTING
- Plant material to be No. 1 Grade and is to comply with Canadian Standards for Nursery Stock (latest edition) published by the Canadian Nursery Landscape Association.
 - Use structurally sound plant material with strong fibrous root system free of disease, defects, and injuries. Use trees with straight trunks, well and characteristically branched for species. Obtain approval from consultant of plant material at source prior to digging. All trees and shrubs to be container grown, potted, W/B or B/B, as indicated on Plant List. Bare root plants are only acceptable for certain species and as approved by the Landscape Architect.
 - Plant material substitutions are not permitted without the written approval from the Consultant, with 48 hours notice, prior to shipping plant material.
 - Plant locations are schematic / approximate only. Contractor is to stake out locations on site for approval by the Landscape Architect prior to installation.
 - The illustrated number of plants shown in the Planting Plan supersedes the estimated number in the Plant List. Contractor to report any discrepancies to the Landscape Architect prior to installation. Contractor will assume full responsibility if the Landscape Architect is not notified.
 - Ensure trees are thoroughly watered following planting. Monitor material and ensure adequate moisture until acceptance.
 - In heavy clay or poorly drained soils, set root ball with root collar 75-100mm higher than finished grade.
 - Approved topsoil depths are as follows:
 - Plant Beds - 450mm continuous depth. Applies to shrubs, perennials, vines, and groundcovers.
 - Sod/ Seed Areas - 100mm depth.
 - Sod to be No. 1 Kentucky Bluegrass Sod grown from minimum mixture of 3 Kentucky Bluegrass cultivars. Quality and source are to comply with Canadian Standards for Nursery Stock, Section 17, (latest edition) published by the Canadian Nursery Landscape Nursery Landscape Association.
 - Apply the following mineral fertilizer unless soil tests show other requirements:
 - Plant Beds - (8-32-16), i.e. 8% Nitrogen, 32% Phosphorus, 16% Potash per manufacturer specifications.
 - Sod Areas - (8-32-16), i.e. 8% Nitrogen, 32% Phosphorus, 16% Potash at a rate of 350kg/ha.
 - Where applicable, for any plant areas with a mix of species/ cultivars notes, Contractor is to cluster like plants in groups of 3-5 and evenly distribute these in the noted area.

CITY DETAILS

Related details from City of Ottawa Standard Tender Documents Volume No. 2 Standard Detail Drawings.

SC4 - Typical Concrete Sidewalk in Boulevard
SC5 - Sidewalk Construction Joints

NOVATECH DETAILS

Found on Sheet L2.

D1 - Standard Deciduous Tree Planting
D2 - Standard Coniferous Tree Planting
D3 - Shrub and Perennial Planting
D4 - Bike Layout
D5 - Boulder
D6 - Wood Privacy Fence

PRODUCT INFORMATION

Install products as per manufacturer specifications. Shop drawings required.

PAVERS
Edge of pavers to receive edge restraint.
• Melville 60 Pavers by Permacon
Colour: TBD

FENCE
• Elegant Traditional Panel by Iron Eagle Industries
Panel Height: 1219mm (42")
Post Cap: Pyramid
Colour: Black

SITE FURNITURE
Fasten all site furnishing to surface with stainless steel anti-vandal anchors.

PICNIC TABLES
• 200 Series - 210 Accessible Cluster Seating by Maglin
Product Number: MTB-0210-00042
Frame: Structural I-Beam
Ipe Wood Table Top and Attached Backless Seats (2)
Cedar Color
Surface Mount, Wheelchair Accessible

WASTE RECEPTACLE
• 200 Series - 250 Trash Receptacle by Maglin
Product Number: MTR-0250-00004
Frame: H.S. Steel
Metal Lid
32 Gallon

BOULDERS
Sizes: 1.0-1.5m L x 0.7-1.0m W x 0.6-0.8m H

PLANT LIST

KEY	QTY	BOTANICAL NAME	COMMON NAME	SIZE	COND	SPACING
Coniferous Trees						
PG	4	<i>Picea glauca</i>	White Spruce	200cm Ht	WB	As Shown
PNS	8	<i>Pinus strobus</i>	Eastern White Pine	200cm Ht	WB	As Shown
PP	6	<i>Picea pungens</i>	Colorado Spruce	200cm Ht	WB	As Shown
TO	7	<i>Thuja occidentalis</i>	Eastern White Cedar	200cm Ht	WB	As Shown
Deciduous Trees						
AES	4	<i>Acer saccharum</i>	Sugar Maple	50mm Cal	WB	As Shown
ASI	1	<i>Acer saccharinum</i>	Silver Maple	50mm Cal	WB	As Shown
GBF	5	<i>Corylus glabra 'Fastigata'</i>	Columar Madderhair Tree	50mm Cal	WB	As Shown
CLU	4	<i>Cladonia lida</i>	Yellowwood	50mm Cal	WB	As Shown
PD	2	<i>Populus deltoides</i>	Eastern Cottonwood	50mm Cal	WB	As Shown
QM	5	<i>Quercus macrocarpa</i>	Bur Oak	50mm Cal	WB	As Shown
TA	2	<i>Tilia americana</i>	Basewood	50mm Cal	WB	As Shown
Deciduous Shrubs						
Trnd	55	<i>Taxus media 'Densiformis'</i>	Dense Yew	60cm BB	PT	As Shown
Trmw	54	<i>Taxus media 'Wardii'</i>	Ward's Yew	50cm Tg	PT	As Shown
Tgg	19	<i>Thuja occidentalis 'Golden Globe'</i>	Golden Globe Cedar	3g	PT	As Shown
Toe	21	<i>Thuja occidentalis 'Smaragd'</i>	Emerald Cedar	200cm WB	PT	As Shown
Cas	56	<i>Cornus alba 'Sibirica'</i>	Red Twig Dogwood	60cm Ht	PT	As Shown
CS	1	<i>Cornus sericea</i>	Red Osier Dogwood	60cm Ht	PT	As Shown
Sbg	56	<i>Spiraea betulifolia 'Glow Girl' (Tor Gold)</i>	Glow Girl Birchleaf Spirea	60cm Ht	PT	As Shown
Smk	66	<i>Syringa patula 'Miss Kim'</i>	Miss Kim Lilac	60cm Ht	PT	As Shown
Pbs	55	<i>Potentilla fruticosa 'Pink Beauty'</i>	Pink Beauty Potentilla	40cm Ht	PT	As Shown
Ptg	8	<i>Potentilla fruticosa 'Goldfinger'</i>	Goldfinger Potentilla	40cm Ht	PT	As Shown
Phv	29	<i>Physocarpus opulifolius 'SMPOTW'</i>	Tiny Wine Ninebark	60cm Ht	PT	As Shown
Sya	91	<i>Symphoricarpos albus</i>	Snowberry	50cm Ht	PT	As Shown
Perennials						
amd	666	<i>Armeria maritima 'Dusseldorf Pride'</i>	Dusseldorf Pride Stonecrop	1g	PT	25cm O.C.
ggr	159	<i>Geranium x 'Azure RUSH'</i>	Azure Rush Cranebill	1g	PT	45cm O.C.
gdz	335	<i>Geranium ornatum 'Balerina'</i>	Balerina Dwarf Cranebill	1g	PT	25cm O.C.
hxr	24	<i>Hosta 'Krossa Regal'</i>	Krossa Regal Hosta	1g	PT	60cm O.C.
Ornamental Grasses						
ago	9	<i>Andropogon gerardi 'Red October'</i>	Red October Big Blue Stem	1g	PT	80cm O.C.
ceo	31	<i>Calamagrostis acutiflora 'Eldorado'</i>	Eldorado Feather Reed Grass	1g	PT	45cm O.C.
fge	60	<i>Festuca glauca 'Elijah Blue'</i>	Elijah Blue Fescue	1g	PT	30cm O.C.
mar	22	<i>Miscanthus sinensis 'Silverfeeder'</i>	Silver Feather Grass	1g	PT	1.0m O.C.

Native Shrub Mix

90 m²

%	QTY	BOTANICAL NAME	COMMON NAME	SIZE	COND	SPACING
15%	14	<i>Arctostaphylos uva-ursi</i>	Bearberry	10cm Ht	PT	45cm O.C.
10%	9	<i>Hamamelis virginiana</i>	Witch Hazel	60cm Ht	PT	30cm O.C.
20%	18	<i>Rhus typhina</i>	Staghorn Sumac	60cm Ht	PT	60cm O.C.
15%	14	<i>Rhus aromatica</i>	Fragrant Sumac	60cm Ht	PT	1.5m O.C.
20%	18	<i>Rosa carolina</i>	Pasture Rose	60cm Ht	PT	1.5m O.C.
20%	18	<i>Viburnum lentago</i>	Nannyberry	60cm Ht	PT	1.5m O.C.

Table Land Shrub Mix (Small) - Only plant above the 100 YR line

66 m²

%	QTY	BOTANICAL NAME	COMMON NAME	SIZE	COND	SPACING
15%	5	<i>Diervilla lonicera</i>	Bush Honeysuckle	0.60m Ht	PT	1.5m O.C.
10%	3	<i>Physocarpus opulifolius</i>	Common Ninebark	0.60m Ht	PT	1.5m O.C.
20%	7	<i>Pteridium aquilinum</i>	Bracken Fern	0.60m Ht	PT	1.5m O.C.
15%	5	<i>Rhus aromatica</i>	Fragrant Sumac	0.60m Ht	PT	1.5m O.C.
20%	7	<i>Rosa blanda</i>	Meadow Rose	0.60m Ht	PT	1.5m O.C.
20%	7	<i>Rubus occidentalis</i>	Black Raspberry	0.60m Ht	PT	1.5m O.C.

NOTE:
THE POSITION OF ALL POLE LINES, CONDUITS, WATERMANS, SEWERS AND OTHER UNDERGROUND AND OVERGROUND UTILITIES AND STRUCTURES IS NOT NECESSARILY SHOWN ON THE CONTRACT DRAWINGS, AND WHERE SHOWN, THE ACCURACY OF THE POSITION OF SUCH UTILITIES AND STRUCTURES IS NOT GUARANTEED. BEFORE STARTING WORK, DETERMINE THE EXACT LOCATION OF ALL SUCH UTILITIES AND STRUCTURES AND ASSUME ALL LIABILITY FOR DAMAGE TO THEM.

NOT FOR CONSTRUCTION

OWNER INFORMATION
2628576 ONTARIO INC.
231 BRITANNY DRIVE, SUITE D
OTTAWA, ONTARIO, K1K 0R8
LALIT AGGARWAL
PHONE: (613)-746-1647
lsa@manorpark.com

No.	REVISION	DATE	BY
1.	ISSUED FOR SITE PLAN CONTROL	JUNE 13/23	RJ

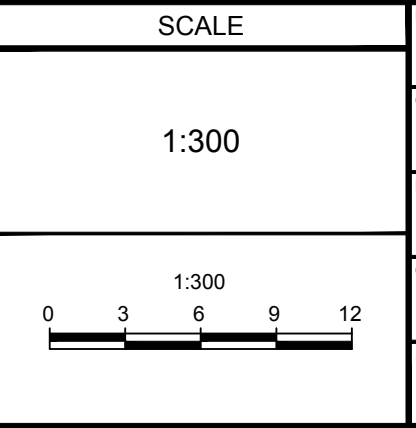

FOR REVIEW ONLY	REVISION
RI	CHECKED
RJ	CHECKED
RI	DRAWN
RJ	CHECKED
RJ	APPROVED
RJ	APPROVED

NOVATECH
Engineers, Planners & Landscape Architects
Suite 200, 240 Michael Cowland Drive
Ottawa, Ontario, Canada K2M 1P6
Telephone: (613) 254-9643
Facsimile: (613) 254-5867
Website: www.novatech-eng.com

LOCATION
CITY OF OTTAWA
3317 NAVAN ROAD
DRAWING NAME
LANDSCAPE PLAN

PROJECT No.	REV	REV #	DRAWING No.
118076		REV # 1	118076-L

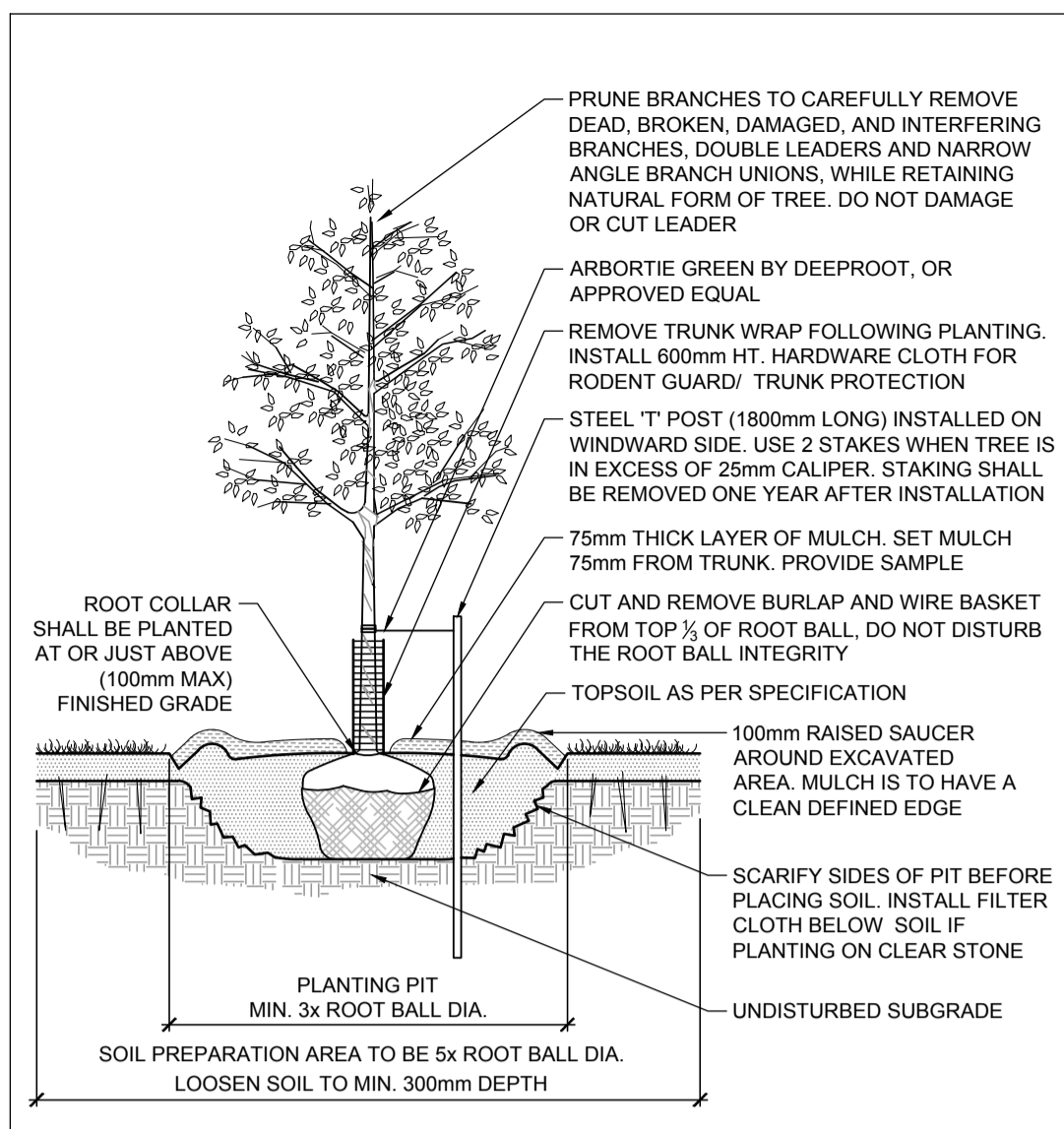

STANDARD DECIDUOUS TREE PLANTING

D1

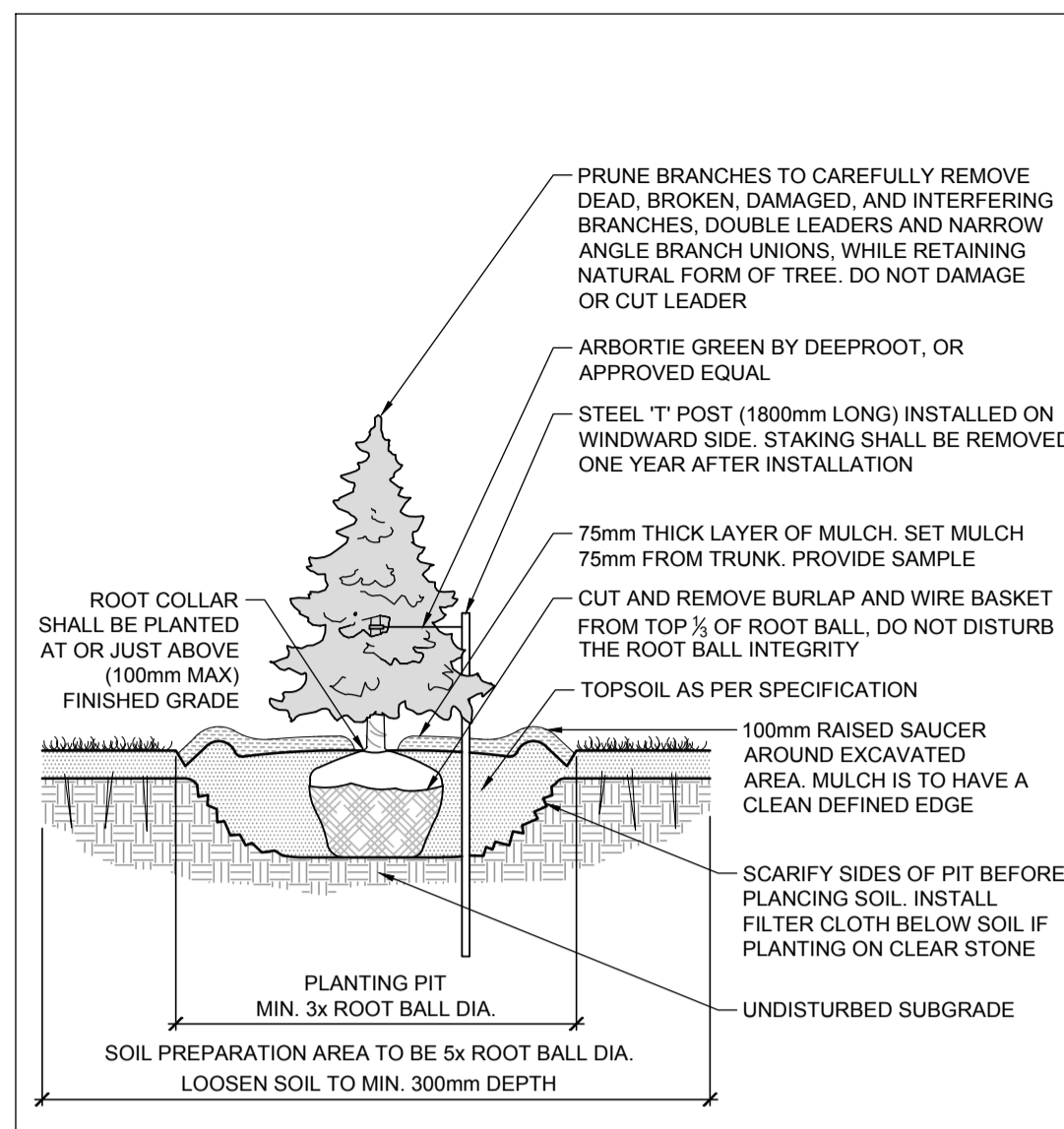

STANDARD CONIFEROUS TREE PLANTING

D2

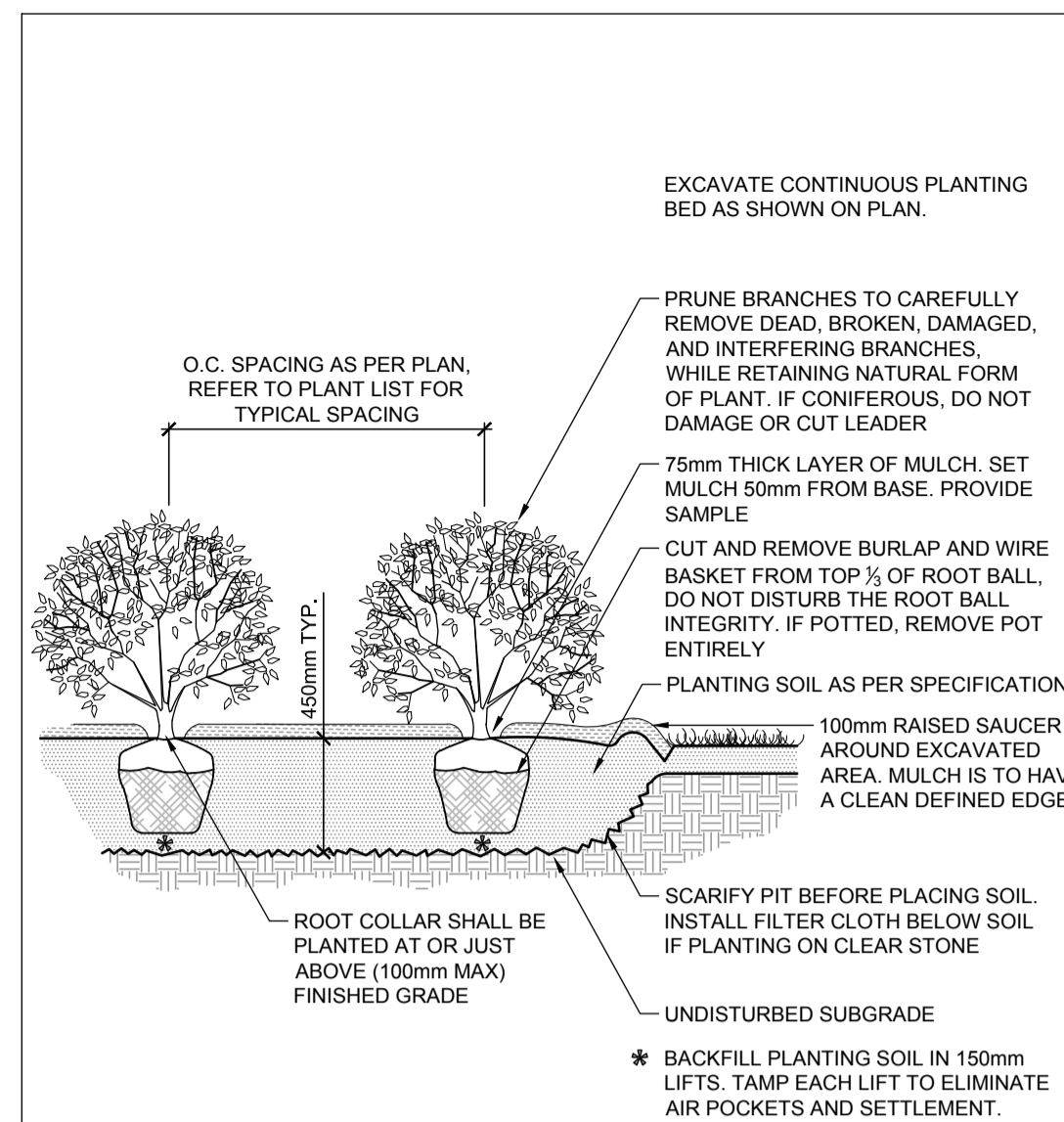

SHRUB AND PERENNIAL PLANTING

D3

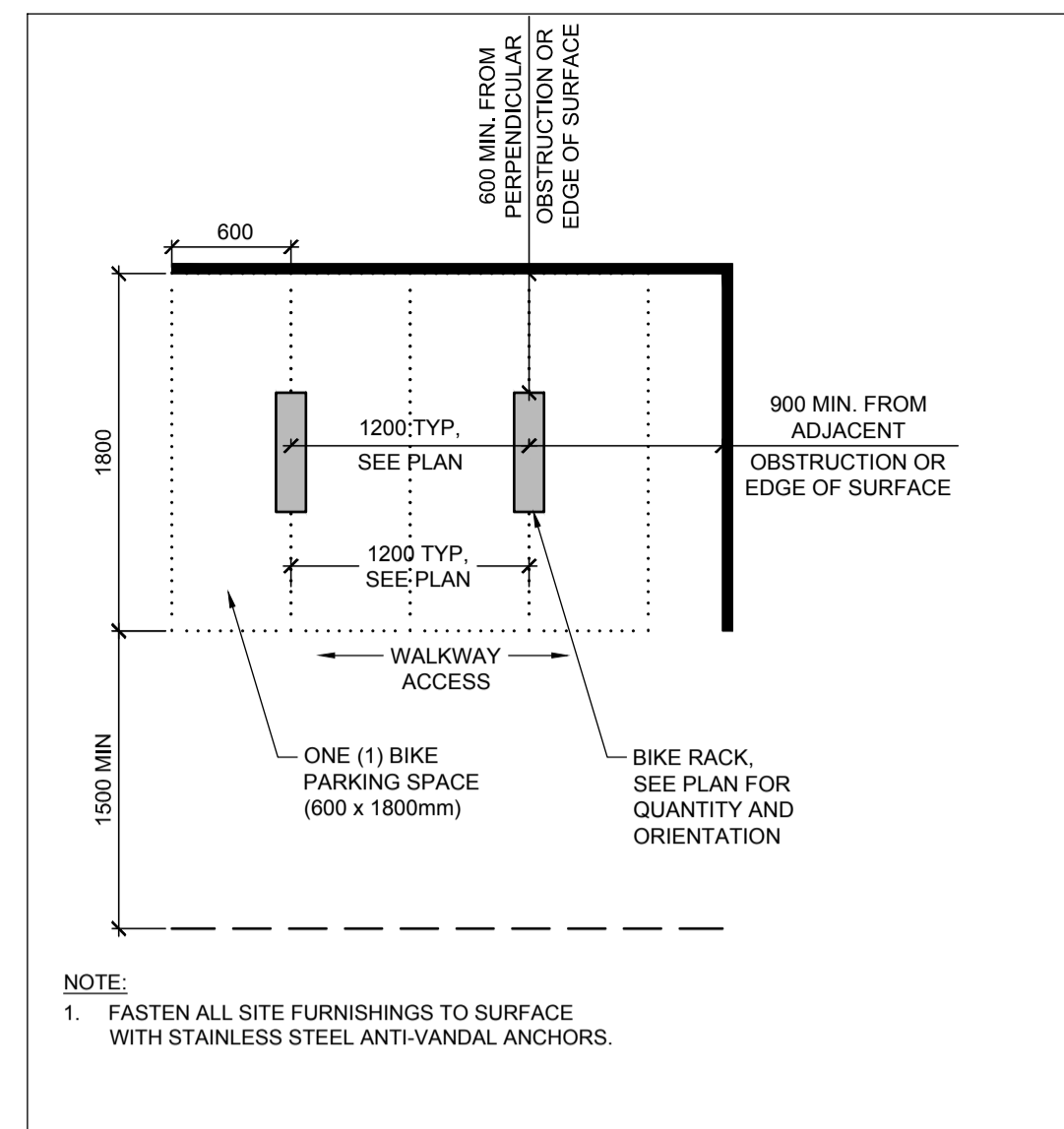

BIKE LAYOUT

D4

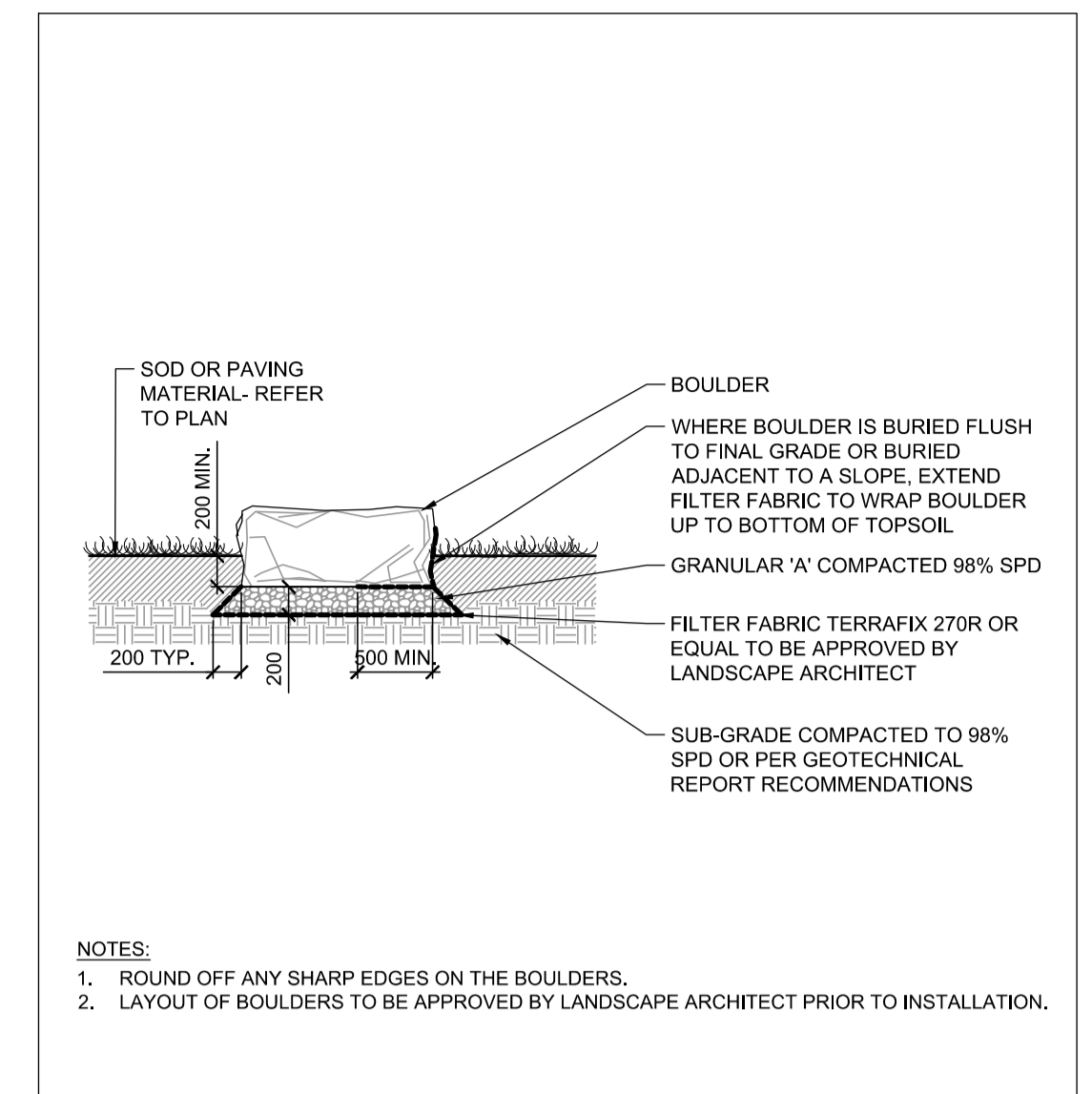

BOULDER

D5

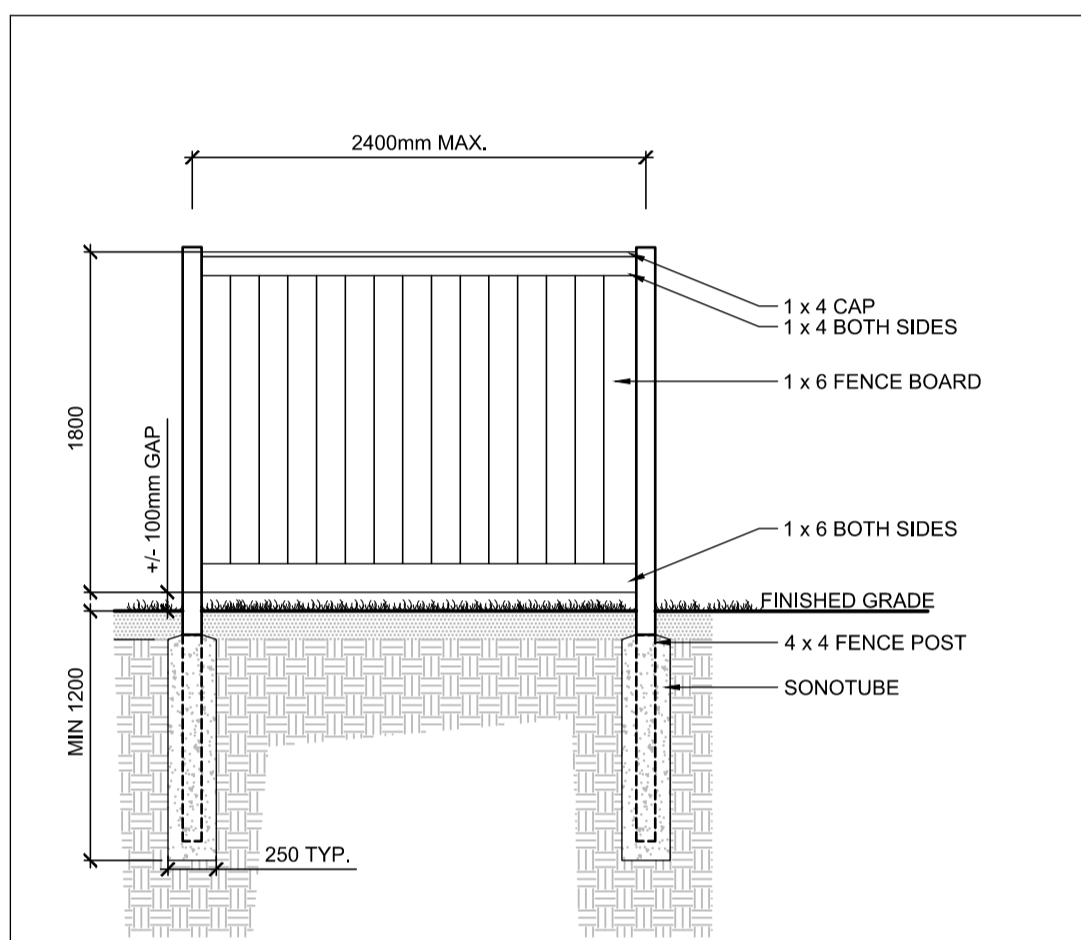

WOOD PRIVACY FENCE

D6

NOTE:
THE POSITION OF ALL POLE LINES, CONDUITS, WATERMANS, SEWERS AND OTHER UNDERGROUND AND OVERGROUND UTILITIES AND STRUCTURES IS NOT NECESSARILY SHOWN ON THE CONTRACT DRAWINGS, AND WHERE SHOWN, THE ACCURACY OF THE POSITION OF SUCH UTILITIES AND STRUCTURES IS NOT GUARANTEED. BEFORE STARTING WORK, DETERMINE THE EXACT LOCATION OF ALL SUCH UTILITIES AND STRUCTURES AND ASSUME ALL LIABILITY FOR DAMAGE TO THEM.

NOT FOR CONSTRUCTION

OWNER INFORMATION
2628576 ONTARIO INC.
231 BRITTANY DRIVE, SUITE D
OTTAWA, ONTARIO, K1K 0R8
LALIT AGGARWAL
PHONE: (613)-746-1647
lsa@manorparkcap.com

No.	REVISION	DATE	BY
1.	ISSUED FOR SITE PLAN CONTROL	JUNE 13/23	RJ

DESIGN	SCALE
RI	
RJ	
RI	
RJ	
RI	
RJ	

FOR REVIEW ONLY	
DESIGN	RI
CHECKED	RJ
DRAWN	RI
CHECKED	RJ
APPROVED	RJ

NOVATECH
Engineers, Planners & Landscape Architects
Suite 200, 240 Michael Cowpland Drive
Ottawa, Ontario, Canada K2M 1P6
Telephone (613) 254-9643
Facsimile (613) 254-5867
Website www.novatech-eng.com

LOCATION CITY or TOWNSHIP NAME OF DEVELOPMENT	
DRAWING NAME DETAILS	PROJECT No. 118076 REV # 1 DRAWING No. 118076-L2

C:\temp\p\p\publish_02180118076-L.dwg, L2, Jun 08, 2023, 2:47pm, ritani