

1:100 METRES

GENERAL NOTES:

- 1. All dimensions are in metres; all elevations are in metres and are geodetic. TBM = Nail in utility pole. Elevation = 122.88.
2. This is not a legal survey. Boundary information was derived from topographic plan of survey of part lot 1, registered plan 528, City of Ottawa, by Annis, O'Sullivan, Volebek Ltd. April 25, 2022.
3. Contractor is responsible for location and protection of utilities.
4. All dimensions to be verified on site by contractor prior to construction.
5. Any changes made to this plan must be verified and approved by Kollaard Associates Inc.
6. Client is responsible for acquiring all necessary permits. This drawing is not for construction until a building permit has been granted.
7. The proposed grades have been set and verified for site grading control only. The grade raise at the building location should be verified with regard to subsurface conditions by qualified geotechnical personnel after completion of the excavation.
8. The underside of footing elevation has been set based on the information available and may not have accounted for actual ground water conditions at the exact house location and should be verified by qualified geotechnical personnel upon completion of the excavation.
9. A geotechnical engineer should be retained to provide recommendations with respect to the sub-grade conditions prior to footing installation.
10. The owner agrees to prepare and implement an erosion and sediment control plan to the satisfaction of the City of Ottawa, appropriate to the site conditions, prior to undertaking any site alterations (filling, grading, removal of vegetation, etc.) and during all phases of site preparation and construction in accordance with the current Best Management Practices for Erosion and Sediment Control such as, but not limited to installing filter cloths across manhole/catchbasin lids to prevent sediments from entering structures and install and maintain a light duty silt fence barrier as required.
11. Inspection of rough grade by Kollaard Associates Inc. and City of Ottawa must be conducted prior to placement of topsoil or sod.
12. Hydro service to be installed according to the specifications of Ontario Hydro and the Mechanical Engineer.
13. All materials and construction to be in accordance with City of Ottawa standards and Ontario Provincial Standards and Specifications.
14. This drawing is part of Kollaard Associates design report # 220338.

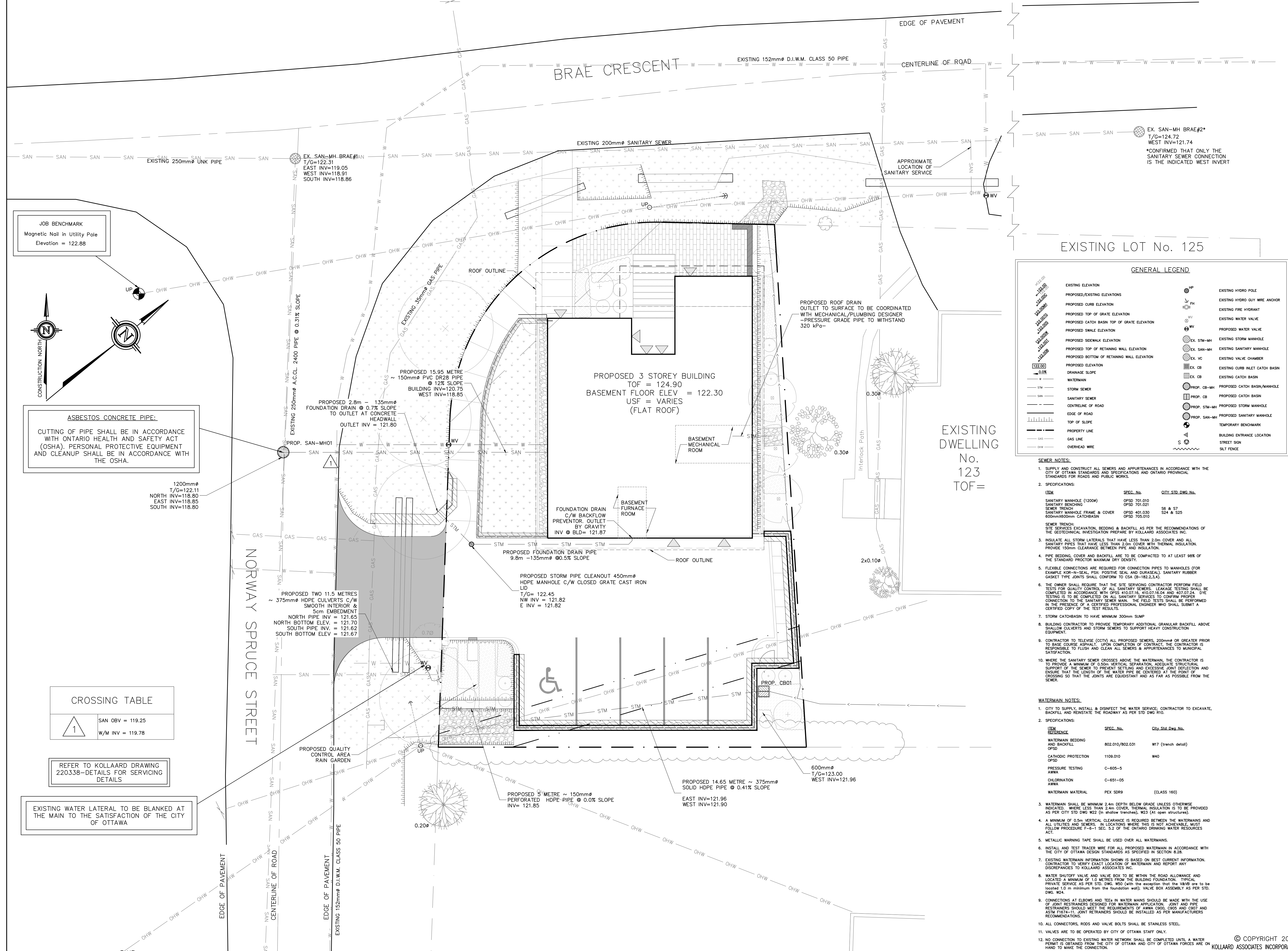

GENERAL LEGEND table with symbols for existing and proposed elevations, curbs, gratings, manholes, catchbasins, and utility lines.

SEWER NOTES table with columns for ITEM, SPEC. No., and CITY STD. DWG. No. detailing sanitary manhole, trench, and bedding specifications.

WATERMAIN NOTES table with columns for ITEM REFERENCE, SPEC. No., and City Std. Dwg. No. detailing watermain bedding, protection, and testing specifications.

JOB BENCHMARK
Magnetic Nail in Utility Pole
Elevation = 122.88

ASBESTOS CONCRETE PIPE:
CUTTING OF PIPE SHALL BE IN ACCORDANCE WITH ONTARIO HEALTH AND SAFETY ACT (OSHA). PERSONAL PROTECTIVE EQUIPMENT AND CLEANUP SHALL BE IN ACCORDANCE WITH THE OSHA.

1200mm#
T/G=122.11
NORTH INV=118.80
EAST INV=118.85
SOUTH INV=118.80

CROSSING TABLE table with columns for SAN and W/M INV.

REFER TO KOLLAARD DRAWING 220338-DETAILS FOR SERVICING DETAILS

EXISTING WATER LATERAL TO BE BLANKED AT THE MAIN TO THE SATISFACTION OF THE CITY OF OTTAWA



CLIENT: BRYDEN GIBSON

PROJECT: PROPOSED 3 STOREY RESIDENTIAL DEVELOPMENT

LOCATION: 121 BREA CRESCENT, STITTSVILLE, ON, K2S 1P1

Professional Engineer stamp for S.E. deWit, dated May 22, 2024.

DRAWING NUMBER: 220338-SER
DRAWING NAME: SITE SERVICING PLAN