



David Schaeffer Engineering Ltd.

120 Iber Road, Unit 103
Stittsville, Ontario K2S 1E9
Tel (613) 836-0856
Fax (613) 836-7183
www.dsel.ca

Date: 2023-12-08
Our File: 17-982

File Number: D07-16-18-0032

Attention: Kiara Gonzales

RE: Minto Brookline Phase 1 – Blocks 103, 104, 106, 119, 120, 122, 123, 124 & 126

DSEL has reviewed the proposed building footprints and grading shown on the attached Site Plans prepared by Minto Communities Inc. (various dates) for the above noted blocks. We confirm that the proposed building footprints and grading are acceptable from an engineering design perspective and do not impact the stormwater management design.

Yours truly,
David Schaeffer Engineering Ltd.



Braden Kaminski, P. Eng
Junior Project Manager

NEW SUBMISSION

RE-SUBMISSION

MODEL CHANGE

MODEL CHANGE PERMIT #

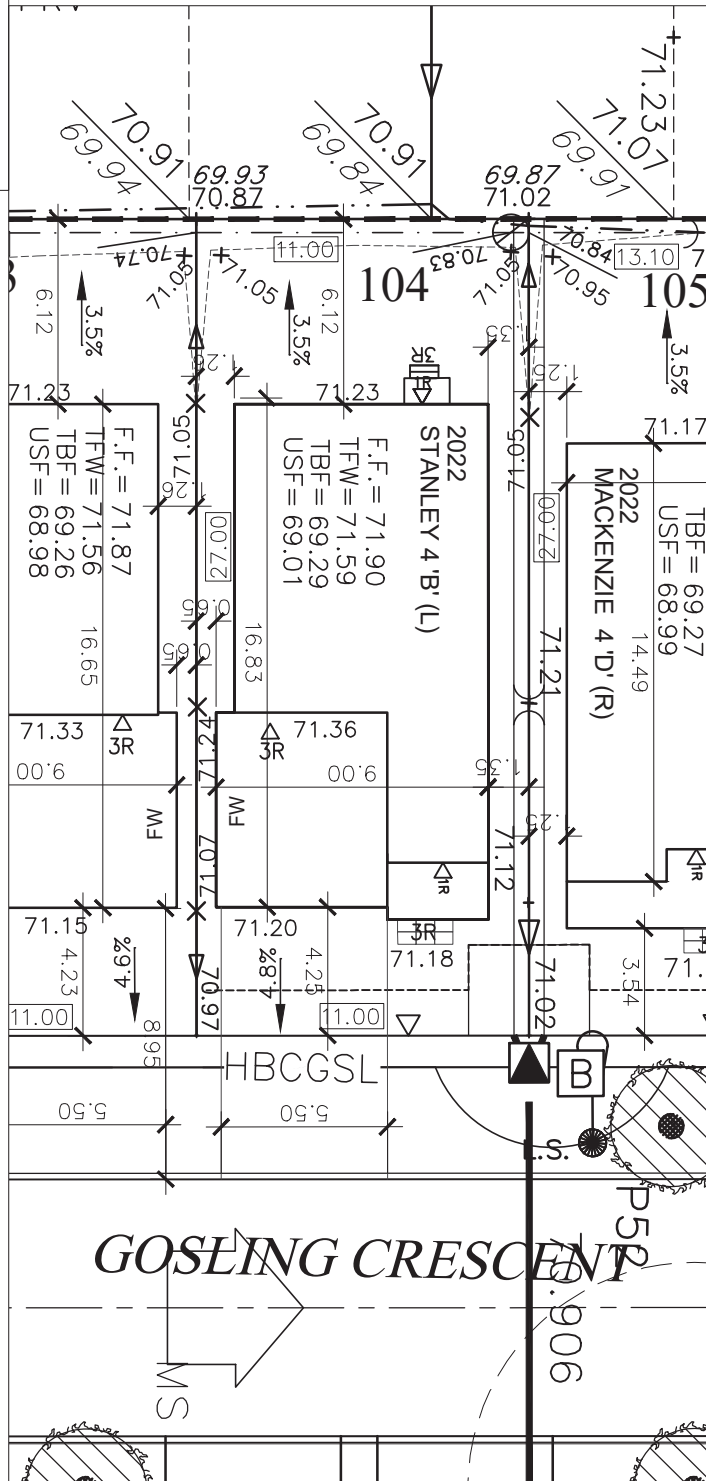
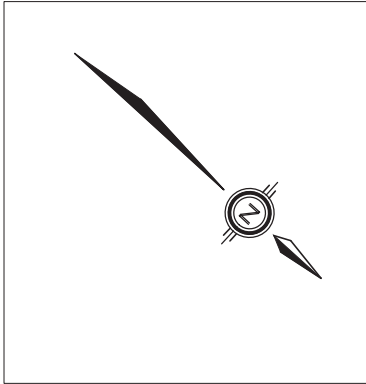

NOTE: THIS APPLICATION EXPIRES 6 (SIX) MONTHS AFTER DATE RECEIVED

1 ISSUED FOR PERMIT JAN 19/23 MC

OFFICE USE ONLY: Civic Address: _____

Owner / Applicant
Minto COMMUNITIES Inc.
 Telephone # 230-7051
 Plan # 4M-xxxx
 Lot # 104
 Block # _____ Unit # _____
 Conc. # _____

Bldg. Ht. 6.05 m
 Lot coverage %
 Scale 1:250

SITE PLAN LEGEND

- EB = EXTRA BRICK
- FTG = SPECIAL FOOTINGS
- FF = FINISHED FLOOR
- USF = UNDERSIDE OF FOOTINGS
- USF REAR = UNDERSIDE FTG WOB
- TBF = TOP OF BASEMENT SLAB
- TFW = TOP OF FOUNDATION WALL
- R = REVERSE (GARAGE ON THE RIGHT)
- SD = SMALL DECK
- SP = SPECIAL
- LOB = LOOKOUT BASEMENT
- WOB = WALK OUT BASEMENT
- FW = FIRE RATED WALL (see SP2 for setback less than 1.2m)
- ▼ SERVICES
- ☐ SH BUS STOP SHELTER

- ⊗ STREET LIGHT
- ☐ CMB COMMUNITY MAILBOX
- ⊗ SWITCH CABINET
- ☐ SD SWITCH DISCONNECT FOR STREET LIGHT
- ▲ PADMOUNT HYDRO TRANSFORMER
- C CABLE PEDESTAL
- B BELL PEDESTAL
- ☐ CABLE GROUND LEVEL BOX
- ☐ BELL GROUND LEVEL BOX
- ⊗ CONIFEROUS TREE
- ⊗ DECIDUOUS TREE
- ⊗ LARGE DECIDUOUS TREE
- FIRE HYDRANT AND VALVE

NEW SUBMISSION

RE-SUBMISSION

MODEL CHANGE

MODEL CHANGE PERMIT #

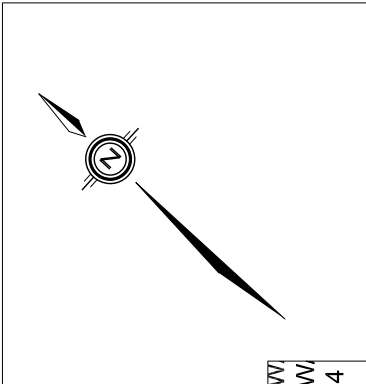

*** REFER TO CANTILEVERED FOUNDATION ENGINEERING SK'S DRAWINGS***

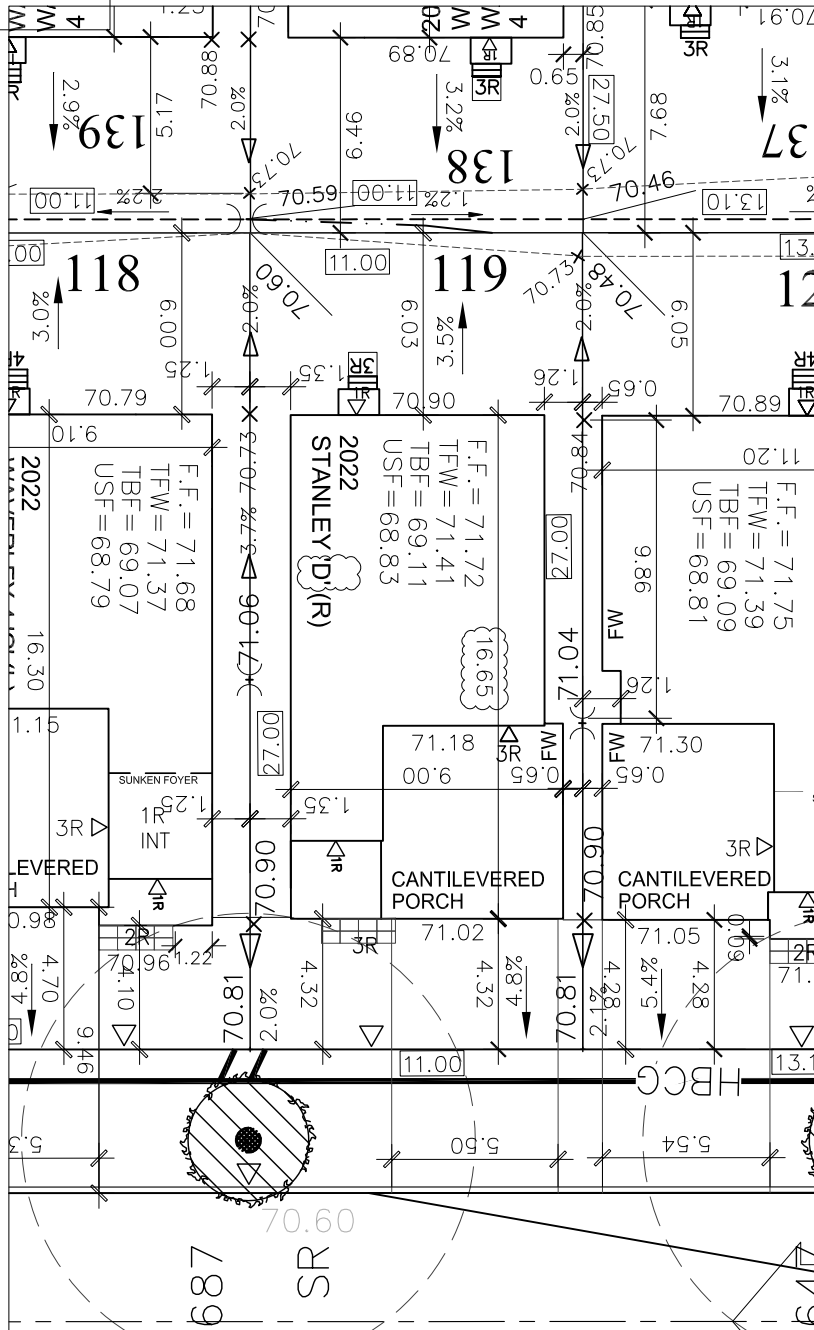

GOSLING CRESCENT

NOTE: THIS APPLICATION EXPIRES 6 (SIX) MONTHS AFTER DATE RECEIVED

2	RE-ISSUED FOR CONSTRUCTION	MAY 01/23	BC
1	ISSUED FOR PERMIT	JAN 25/23	MC

OFFICE USE ONLY: Civic Address: _____

Owner / Applicant
Minto COMMUNITIES Inc.
 Telephone # _____ 230-7051
 Plan # _____
 Lot # _____ **119**
 Block # _____ Unit # _____
 Conc. # _____

Bldg. Ht. _____ 6.05 m
 Lot coverage _____ %
 Scale _____ 1:250

SITE PLAN LEGEND

- EB = EXTRA BRICK
- FTG = SPECIAL FOOTINGS
- FF = FINISHED FLOOR
- USF = UNDERSIDE OF FOOTINGS
- USF REAR = UNDERSIDE FTG WOB
- TBF = TOP OF BASEMENT SLAB
- TFW = TOP OF FOUNDATION WALL
- R = REVERSE (GARAGE ON THE RIGHT)
- SD = SMALL DECK
- SP = SPECIAL
- LOB = LOOKOUT BASEMENT
- WOB = WALK OUT BASEMENT
- FW = FIRE RATED WALL (see SP2 for setback less than 1.2m)
- ▼ SERVICES
- SH BUS STOP SHELTER

- STREET LIGHT
- COMMUNITY MAILBOX
- SWITCH CABINET
- SWITCH DISCONNECT FOR STREET LIGHT
- PADMOUNT HYDRO TRANSFORMER
- CABLE PEDESTAL
- BELL PEDESTAL
- CABLE GROUND LEVEL BOX
- BELL GROUND LEVEL BOX
- CONIFEROUS TREE
- DECIDUOUS TREE
- LARGE DECIDUOUS TREE
- FIRE HYDRANT AND VALVE

NEW SUBMISSION

RE-SUBMISSION

MODEL CHANGE

MODEL CHANGE PERMIT #

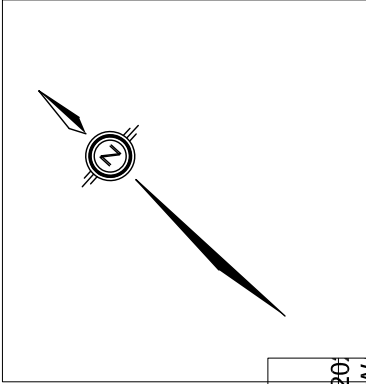

* REFER TO CANTILEVERED FOUNDATION ENGINEERING SK'S DRAWINGS*

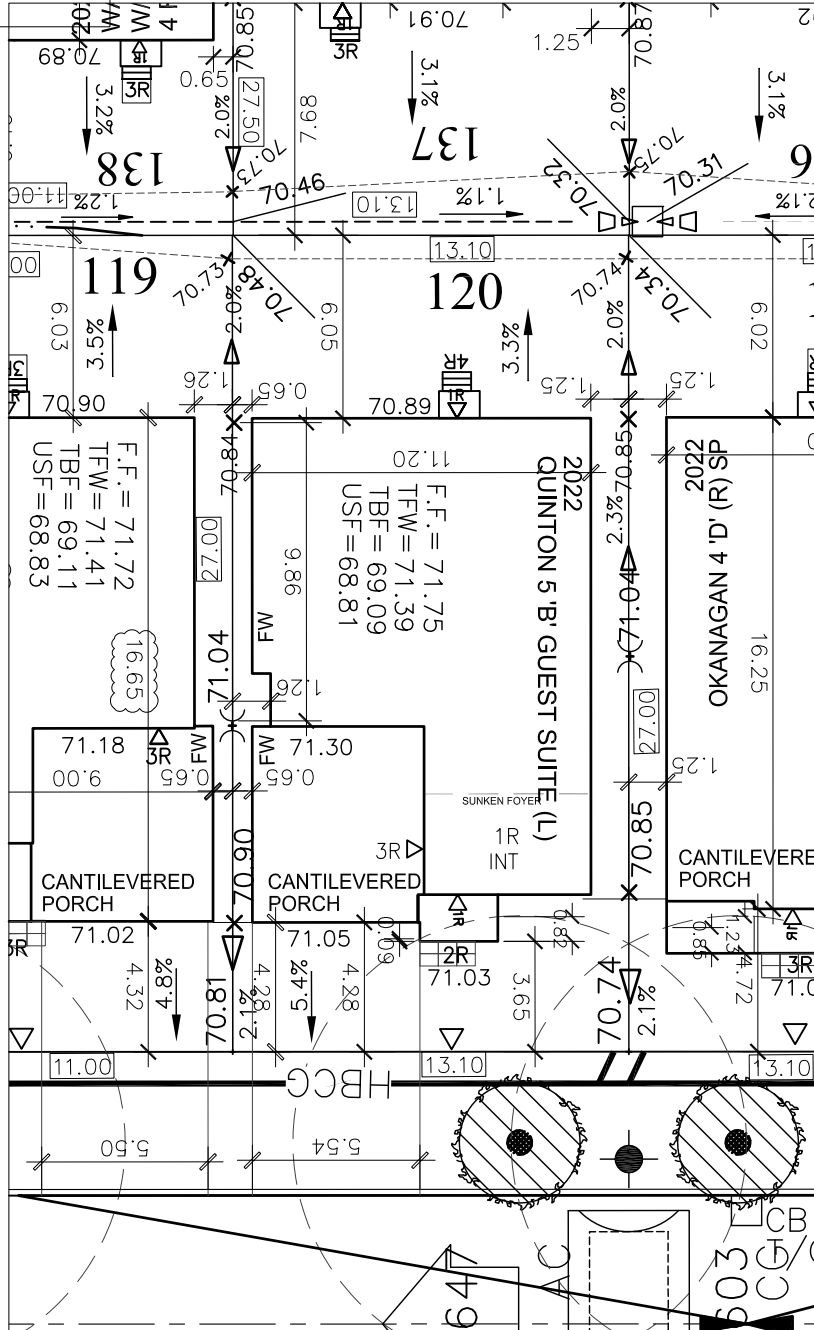

GOSLING CRESCENT

NOTE: THIS APPLICATION EXPIRES 6 (SIX) MONTHS AFTER DATE RECEIVED

1	ISSUED FOR CONSTRUCTION	APR 12/23	MC
1	ISSUED FOR PERMIT	JAN 25/23	MC

OFFICE USE ONLY: Civic Address: _____

Owner / Applicant
Minto COMMUNITIES Inc.

Telephone # _____ 230-7051

Plan # _____

Lot # _____ **120**

Block # _____ Unit # _____

Conc. # _____

Bldg. Ht. _____ 6.05 m

Lot coverage _____ %

Scale _____ 1: 250

SITE PLAN LEGEND

- EB = EXTRA BRICK
- FTG = SPECIAL FOOTINGS
- FF = FINISHED FLOOR
- USF = UNDERSIDE OF FOOTINGS
- USF REAR = UNDERSIDE FTG WOB
- TBF = TOP OF BASEMENT SLAB
- TFW = TOP OF FOUNDATION WALL
- R = REVERSE (GARAGE ON THE RIGHT)
- SD = SMALL DECK
- SP = SPECIAL
- LOB = LOOKOUT BASEMENT
- WOB = WALK OUT BASEMENT
- FW = FIRE RATED WALL (see SP2 for setback less than 1.2m)
- ▼ SERVICES
- SH BUS STOP SHELTER

- STREET LIGHT
- COMMUNITY MAILBOX
- SWITCH CABINET
- SWITCH DISCONNECT FOR STREET LIGHT
- PADMOUNT HYDRO TRANSFORMER
- CABLE PEDESTAL
- BELL PEDESTAL
- CABLE GROUND LEVEL BOX
- BELL GROUND LEVEL BOX
- CONIFEROUS TREE
- DECIDUOUS TREE
- LARGE DECIDUOUS TREE
- FIRE HYDRANT AND VALVE

NEW SUBMISSION

RE-SUBMISSION

MODEL CHANGE

MODEL CHANGE PERMIT #

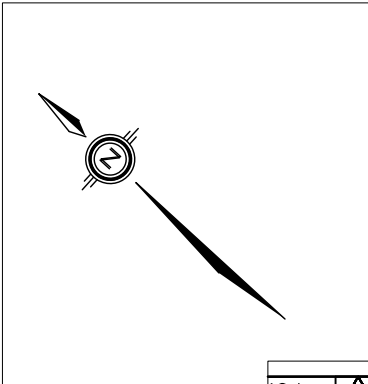

* REFER TO CANTILEVERED FOUNDATION ENGINEERING SK'S DRAWINGS*

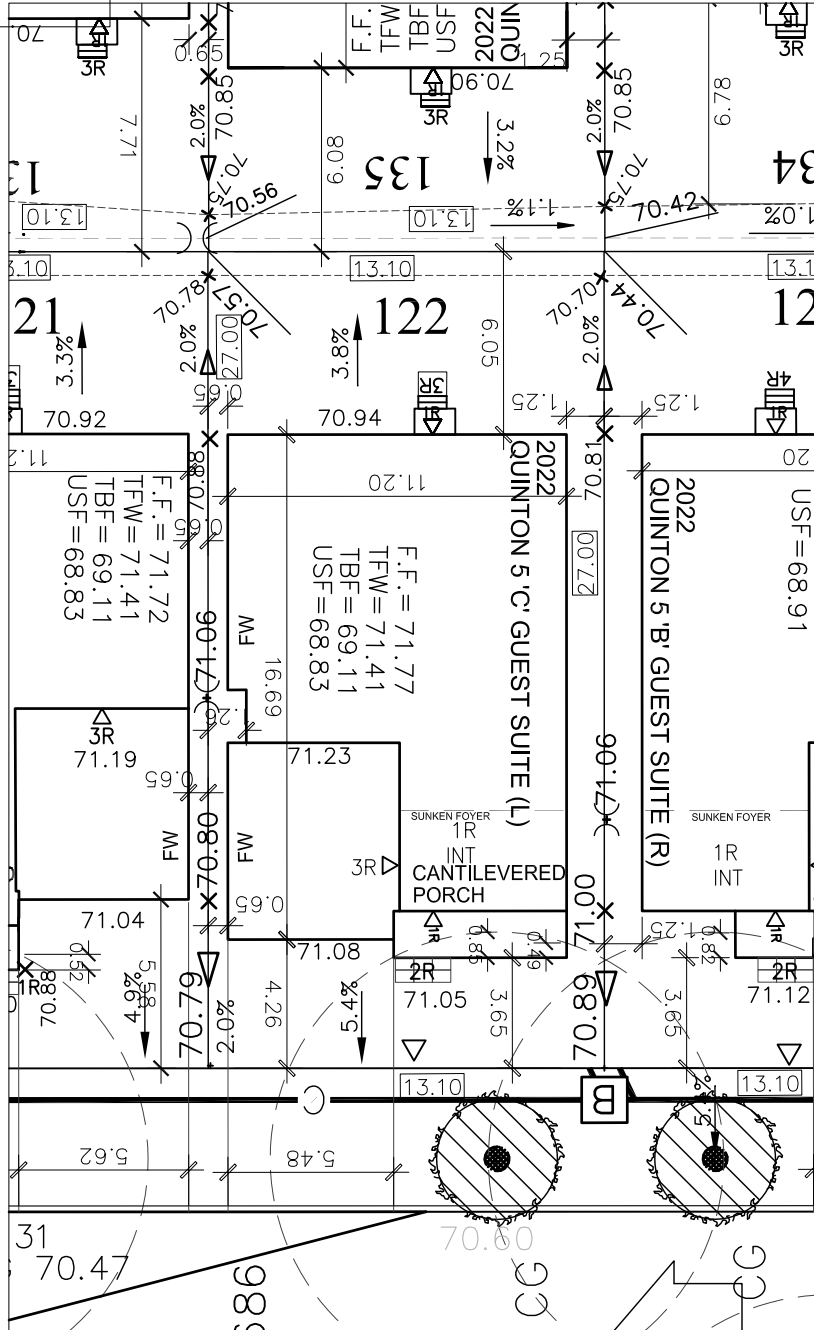

GOSLING CRESCENT

NOTE: THIS APPLICATION EXPIRES 6 (SIX) MONTHS AFTER DATE RECEIVED

2	ISSUED FOR CONSTRUCTION	APR 13/23	MC
1	ISSUED FOR PERMIT	JAN 25/23	MC

OFFICE USE ONLY: Civic Address: _____

Owner / Applicant
Minto COMMUNITIES Inc.

Telephone # 230-7051

Plan # _____

Lot # 122

Block # _____ Unit # _____

Conc. # _____

Bldg. Ht. 6.05 m

Lot coverage _____ %

Scale 1: 250

SITE PLAN LEGEND

- EB = EXTRA BRICK
- FTG = SPECIAL FOOTINGS
- FF = FINISHED FLOOR
- USF = UNDERSIDE OF FOOTINGS
- USF REAR = UNDERSIDE FTG WOB
- TBF = TOP OF BASEMENT SLAB
- TFW = TOP OF FOUNDATION WALL
- R = REVERSE (GARAGE ON THE RIGHT)
- SD = SMALL DECK
- SP = SPECIAL
- LOB = LOOKOUT BASEMENT
- WOB = WALK OUT BASEMENT
- FW = FIRE RATED WALL (see SP2 for setback less than 1.2m)
- ▼ SERVICES
- SH BUS STOP SHELTER

- STREET LIGHT
- COMMUNITY MAILBOX
- SWITCH CABINET
- SWITCH DISCONNECT FOR STREET LIGHT
- PADMOUNT HYDRO TRANSFORMER
- CABLE PEDESTAL
- BELL PEDESTAL
- CABLE GROUND LEVEL BOX
- BELL GROUND LEVEL BOX
- CONIFEROUS TREE
- DECIDUOUS TREE
- LARGE DECIDUOUS TREE
- FIRE HYDRANT AND VALVE

NEW SUBMISSION

RE-SUBMISSION

MODEL CHANGE

MODEL CHANGE PERMIT #

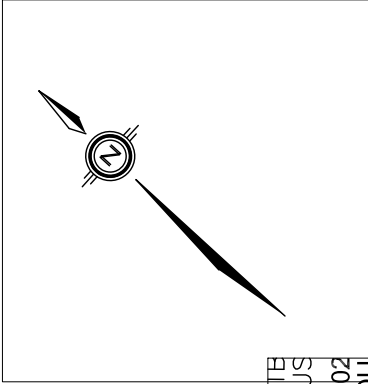

* REFER TO CANTILEVERED FOUNDATION ENGINEERING SK'S DRAWINGS*

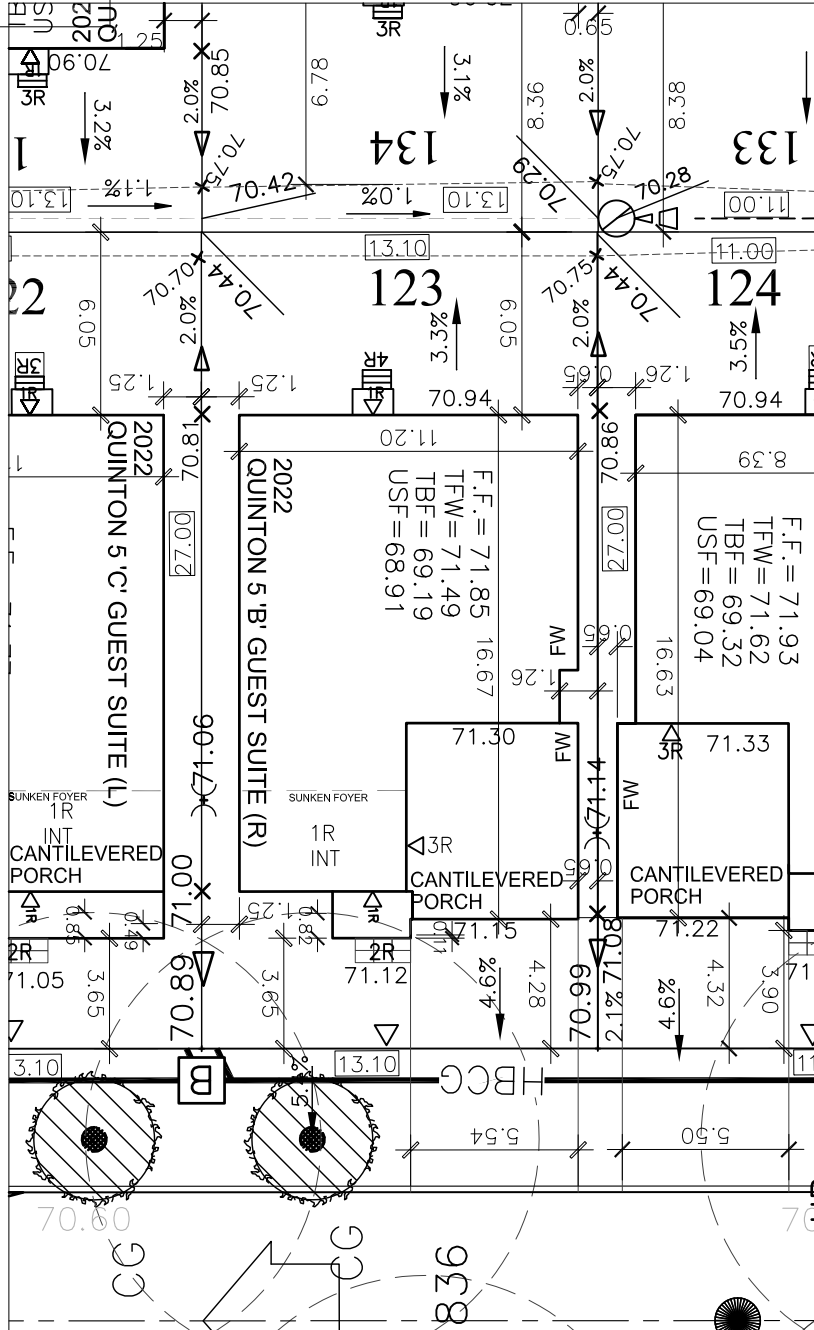

GOSLING CRESCENT

NOTE: THIS APPLICATION EXPIRES 6 (SIX) MONTHS AFTER DATE RECEIVED

2	ISSUED FOR CONSTRUCTION	APR 13/23	MC
1	ISSUED FOR PERMIT	JAN 25/23	MC

OFFICE USE ONLY: Civic Address: _____

Owner / Applicant
Minto COMMUNITIES Inc.

Telephone # 230-7051

Plan # _____

Lot # 123

Block # _____ Unit # _____

Conc. # _____

Bldg. Ht. 6.05 m

Lot coverage _____ %

Scale 1:250

SITE PLAN LEGEND

- EB = EXTRA BRICK
- FTG = SPECIAL FOOTINGS
- FF = FINISHED FLOOR
- USF = UNDERSIDE OF FOOTINGS
- USF REAR = UNDERSIDE FTG WOB
- TBF = TOP OF BASEMENT SLAB
- TFW = TOP OF FOUNDATION WALL
- R = REVERSE (GARAGE ON THE RIGHT)
- SD = SMALL DECK
- SP = SPECIAL
- LOB = LOOKOUT BASEMENT
- WOB = WALK OUT BASEMENT
- FW = FIRE RATED WALL (see SP2 for setback less than 1.2m)
- ▼ SERVICES
- SH BUS STOP SHELTER

- STREET LIGHT
- COMMUNITY MAILBOX
- SWITCH CABINET
- SWITCH DISCONNECT FOR STREET LIGHT
- PADMOUNT HYDRO TRANSFORMER
- CABLE PEDESTAL
- BELL PEDESTAL
- CABLE GROUND LEVEL BOX
- BELL GROUND LEVEL BOX
- CONIFEROUS TREE
- DECIDUOUS TREE
- LARGE DECIDUOUS TREE
- FIRE HYDRANT AND VALVE

NEW SUBMISSION

RE-SUBMISSION

MODEL CHANGE

MODEL CHANGE PERMIT #

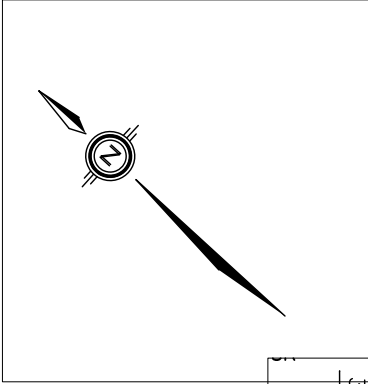

* REFER TO CANTILEVERED FOUNDATION
ENGINEERING SK'S DRAWINGS*

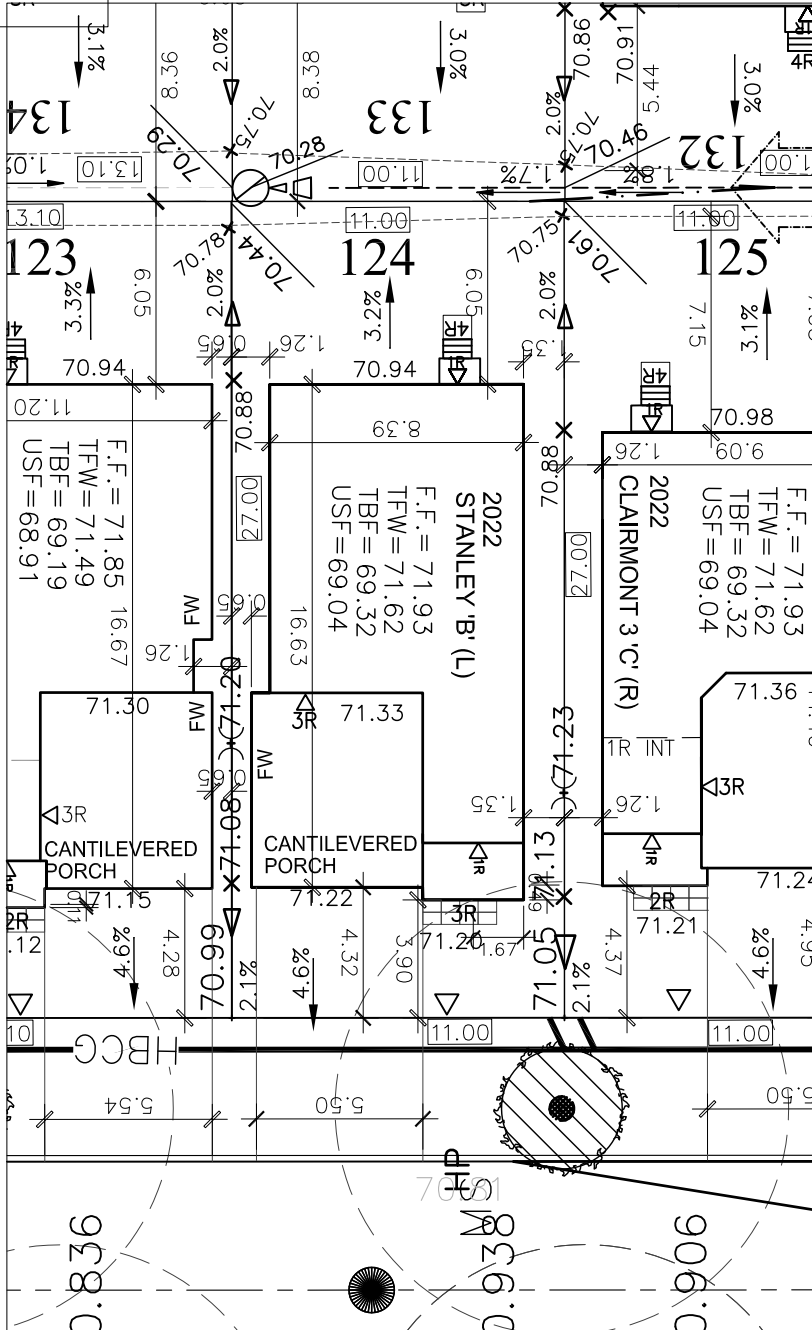

GOSLING CRESCENT

NOTE: THIS APPLICATION EXPIRES 6 (SIX) MONTHS AFTER DATE RECEIVED

2	ISSUED FOR CONSTRUCTION	APR 13/23	MC
1	ISSUED FOR PERMIT	JAN 25/23	MC

OFFICE USE ONLY: Civic Address: _____

Owner / Applicant
Minto COMMUNITIES Inc.

Telephone # 230-7051

Plan # _____

Lot # 124

Block # _____ Unit # _____

Conc. # _____

Bldg. Ht. 6.05 m

Lot coverage _____ %

Scale 1:250

SITE PLAN LEGEND

EB = EXTRA BRICK
 FTG = SPECIAL FOOTINGS
 FF = FINISHED FLOOR
 USF = UNDERSIDE OF FOOTINGS
 USF REAR = UNDERSIDE FTG WOB
 TBF = TOP OF BASEMENT SLAB
 TFW = TOP OF FOUNDATION WALL
 R = REVERSE (GARAGE ON THE RIGHT)
 SD = SMALL DECK
 SP = SPECIAL
 LOB = LOOKOUT BASEMENT
 WOB = WALK OUT BASEMENT
 FW = FIRE RATED WALL (see SP2 for setback less than 1.2m)

▼ SERVICES
 [SH] BUS STOP SHELTER

- STREET LIGHT
- COMMUNITY MAILBOX
- SWITCH CABINET
- SWITCH DISCONNECT FOR STREET LIGHT
- PADMOUNT HYDRO TRANSFORMER
- CABLE PEDESTAL
- BELL PEDESTAL
- CABLE GROUND LEVEL BOX
- BELL GROUND LEVEL BOX
- CONIFEROUS TREE
- DECIDUOUS TREE
- LARGE DECIDUOUS TREE
- FIRE HYDRANT AND VALVE

City of

OTTAWA

Ville de

NEW SUBMISSION

RE-SUBMISSION

MODEL CHANGE

MODEL CHANGE PERMIT #

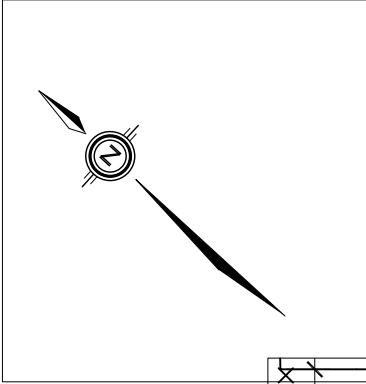

* REFER TO CANTILEVERED FOUNDATION ENGINEERING SK'S DRAWINGS*

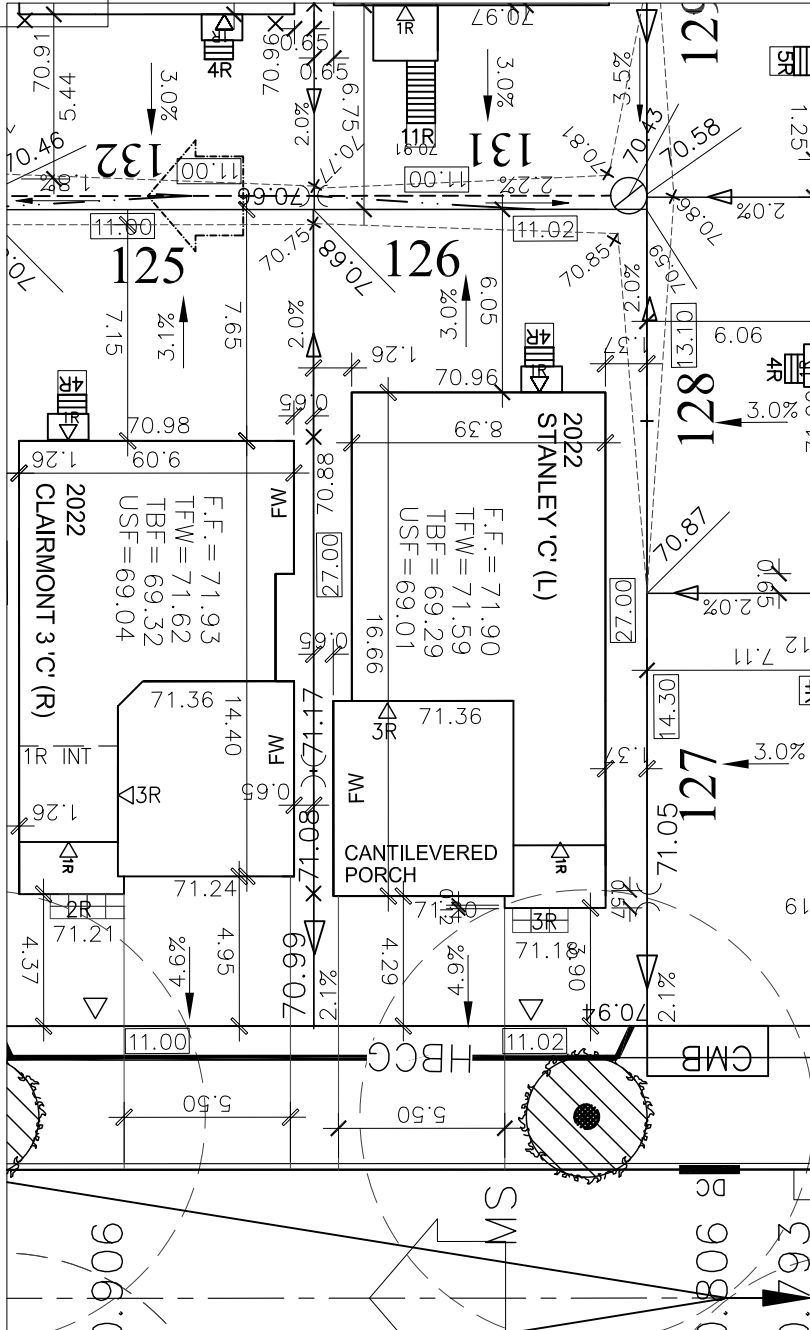

GOSLING CRESCENT

NOTE: THIS APPLICATION EXPIRES 6 (SIX) MONTHS AFTER DATE RECEIVED

1	ISSUED FOR PERMIT	JAN 25/23	MC
---	-------------------	-----------	----

OFFICE USE ONLY: Civic Address: _____

Owner / Applicant
Minto COMMUNITIES Inc.

Telephone # _____ 230-7051

Plan # _____

Lot # _____ **126**

Block # _____ Unit # _____

Conc. # _____

Bldg. Ht. _____ 6.05 m

Lot coverage _____ %

Scale _____ 1:250

SITE PLAN LEGEND

- EB = EXTRA BRICK
- FTG = SPECIAL FOOTINGS
- FF = FINISHED FLOOR
- USF = UNDERSIDE OF FOOTINGS
- USF REAR = UNDERSIDE FTG WOB
- TBF = TOP OF BASEMENT SLAB
- TFW = TOP OF FOUNDATION WALL
- R = REVERSE (GARAGE ON THE RIGHT)
- SD = SMALL DECK
- SP = SPECIAL
- LOB = LOOKOUT BASEMENT
- WOB = WALK OUT BASEMENT
- FW = FIRE RATED WALL (see SP2 for setback less than 1.2m)
- ▼ SERVICES
- SH BUS STOP SHELTER

- STREET LIGHT
- COMMUNITY MAILBOX
- SWITCH CABINET
- SWITCH DISCONNECT FOR STREET LIGHT
- PADMOUNT HYDRO TRANSFORMER
- CABLE PEDESTAL
- BELL PEDESTAL
- CABLE GROUND LEVEL BOX
- BELL GROUND LEVEL BOX
- CONIFEROUS TREE
- DECIDUOUS TREE
- LARGE DECIDUOUS TREE
- FIRE HYDRANT AND VALVE