

NOTE:
A GEOTECHNICAL ENGINEER LICENSED IN THE PROVINCE OF ONTARIO IS TO INSPECT ALL SUBGRADE SURFACES FOR FOOTING AND PAVEMENT STRUCTURES PRIOR TO CONSTRUCTION

NOTE:
ALL EXISTING POST & WIRE FENCE, CULVERTS, UTILITY WIRE / POLES, TREES, SHRUBS ETC. WITHIN LOTS, BLOCKS AND ROADS TO BE REMOVED, UNLESS OTHERWISE NOTED

NOTE RE: PERFORATED PIPE
PERFORATED PIPE IS REQUIRED FOR SWALE SLOPE LESS THAN 1.5%. REFER TO CITY STD. S29, S30 FOR REAR YARD TRENCH AND PIPE DETAIL ONLY

NOTE:
ALL SWALES SHALL BE 0.15m DEEP WITH 3:1 SIDE SLOPES UNLESS OTHERWISE INDICATED

NOTE:
FOR CROSS SECTIONS REFER TO DRAWING No. 86 AND 87.

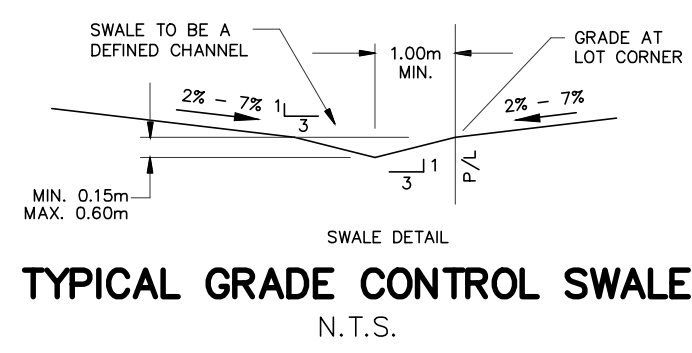

ANY DISTURBED AREA DURING CONSTRUCTION TO BE RESTORED TO THE ORIGINAL CONDITION OR BETTER TO THE SATISFACTION OF THE AUTHORITIES HAVING JURISDICTION

CONTRACTOR TO VERIFY THE PRECISE LOCATIONS AND INVERT ELEVATIONS OF EX. UNDERGROUND SERVICES AND EX. UTILITIES PRIOR TO STARTING CONSTRUCTION

PERMISSION REQUIRED FOR WORK ON ADJACENT LANDS

FOR LOTS REQUIRING AMENDED TOPSOIL REFER TO PATERSON GROUP MEMO PG454-MEMO.20 DATED AUGUST 9, 2022

REFER TO DWG No. 65

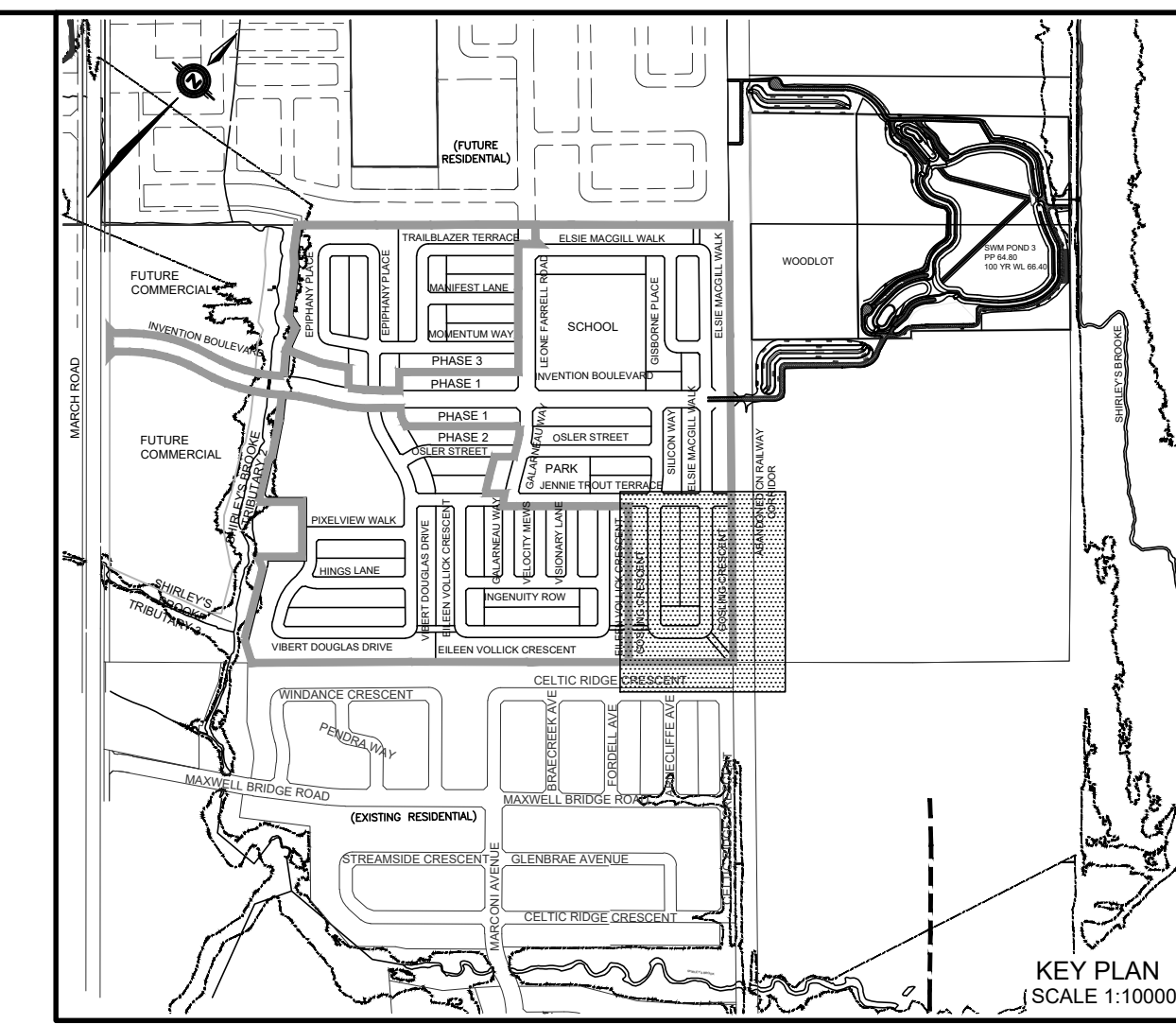

LEGEND

PROPOSED ELEVATION	103.45	OVERLAND FLOW DIRECTION	→
EXISTING ELEVATION	102.73	EXTERNAL OVERLAND FLOW DIRECTION	→
FUTURE ELEVATION	[93.000]	EMERGENCY OVERLAND FLOW DIRECTION	→
PROPOSED SWALE GRADE	1.5%	RETAINING WALL AND ELEVATIONS	T/W=103.10 B/W=102.44
HIGH POINT	102.16	CHAINLINK FENCE (1.5m UNLESS OTHERWISE NOTED)	—
STREET CATCHBASIN		VALVE & VB	—
STREET CATCHBASIN WITH CLOSED LID		VALVE & VC	—
CATCHBASIN MANHOLE		BUILDING ENVELOPE	—
TEE CATCHBASIN		TOP OF FOUNDATION (TOF)	—
ELBOW CATCHBASIN		FINISHED FLOOR ELEVATION (FFE)	—
HYDRANT, VALVE & VB		UNDERSIDE OF FOOTING ELEVATION (UST)	—
VALVE & VC		UNITS REQUIRING WATER PRESSURE REDUCING VALVES	PRV
VALVE & VB		WALKOUT UNITS	W.O.
NOISE BARRIER (3.0m UNLESS OTHERWISE NOTED)		SLAB ON GRADE	—
DECORATIVE FENCE (SEE LANDSCAPE DWGS FOR DETAIL)		UNIT THAT REQUIRES ENGINEERED PAD EXTENSION (REFER TO PATERSON MEMO PG454-MEMO.21 REVISION 6 DATED AUGUST 24, 2022)	—
CONSTRUCTION FENCE		CLAY SEAL (REFER TO GENERAL NOTES, No.18, ON DWG. No. 1, AND GEOTECHNICAL CONSULTANT'S SPECIFICATIONS)	—
PROPERTY BOUNDARY		HYDRO SWITCHGEAR	—
REGULATORY LIMIT		HYDRO TRANSFORMER	—
3:1 TERRACING MAXIMUM SLOPE		STREET LIGHT STANDARD	—
PONDING AREA WITH SPILLWAY ELEVATION (MAXIMUM 0.30m)		TACTILE WALKING SURFACE INDICATOR (AS PER CITY OF OTTAWA STD. S06)	—
250# PVC PERFORATED PIPE (REFER TO CITY STD S29 FOR REAR YARD TRENCH AND PIPE DETAILS ONLY) (SUBRAIN APPLIED FOR SLOPE LESS THAN 1.5%)		PREVIOUS PHASES / PHASES NOT PART OF CURRENT GRADING APPROVAL	—
RAISED CROSSWALK (AS PER CITY OF OTTAWA STD. R15)		UNITS REQUIRING WATER PRESSURE REDUCING VALVES	PRV
FIRE WALL LOCATION - SEE ARCHITECTURAL DRAWINGS FOR DETAILS		PROPOSED COMMUNITY MAILBOX LOCATION	—

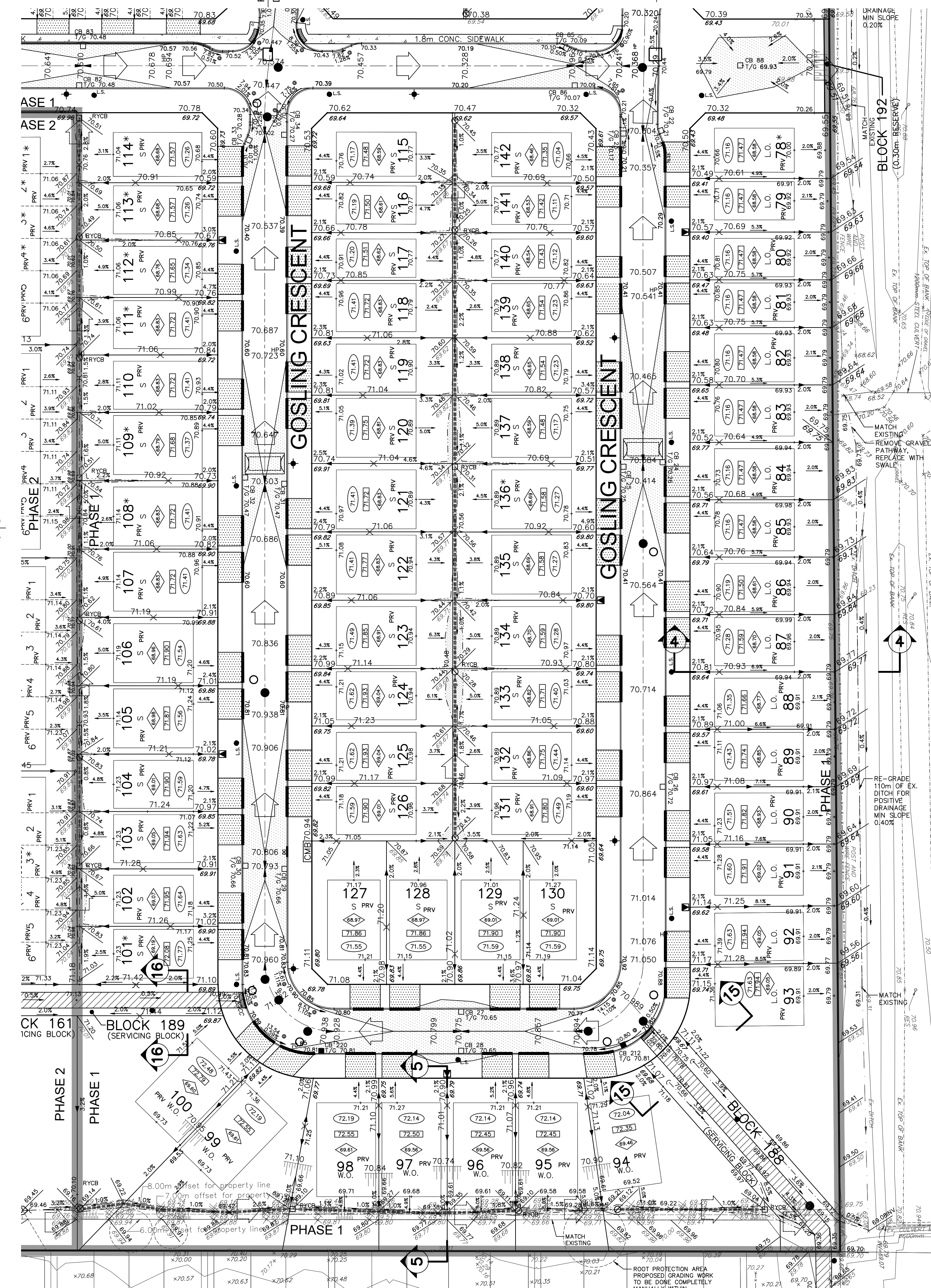

ABANDONED CN RAILWAY CORRIDOR

No.	BY	DATE	DESCRIPTION
27	S.L.M.	24-01-10	UPDATED PATHWAYS
26	B.N.C.	23-12-13	UPDATED PER GEOMETRIC ROAD DESIGN
25	B.N.C.	23-12-08	UPDATED SIDEWALK ALIGNMENT
24	B.N.C.	23-10-30	UPDATED FIREWALL LOCATIONS
23	S.L.M.	23-08-18	PHASE 2 UPDATED GEOMETRIC ROAD DESIGN

TOPOGRAPHIC INFORMATION
STANTEC GEOMATICS LIMITED PROJECT NUMBER 161613877-111 DATED MARCH 30, 2021.

LEGAL INFORMATION
CALCULATED M-PLAN PROVIDED BY STANTEC GEOMATICS LTD, PROJECT NUMBER 161613877-132 PHASE 1, RECEIVED APRIL 11, 2022 & PHASE 2, RECEIVED SEPTEMBER 29, 2021

BENCH MARK
ELEVATIONS ARE REFERRED TO THE CANADIAN GEODETIC VERTICAL DATUM (CGVD-1928:1978) AND ARE DERIVED FROM THE CAN-NET VRS NETWORK MONUMENT: OTTAWA ELEVATION = 95.23 METRES.

MINTO GROUP MINTO BROOKLINE PHASE 1 & 2

120 Iber Road Unit 103
Stittville, Ontario, K2S 1E9
Tel. (613) 836-0856
Fax. (613) 836-7183
www.DSEL.ca

Ottawa CITY OF OTTAWA

GRADING PLAN

© DSEL

DRAWN BY: G.G.G.	CHECKED BY: S.L.M.	PROJECT No.
DESIGNED BY: G.G.G.	CHECKED BY: S.L.M.	17-982
SCALE:		SHEET No.
		64

HORIZ. 1:500