

- LEGEND: SERVICING
- STM — PROPOSED STORM SEWER
 - SAN — PROPOSED SANITARY SEWER
 - W — PROPOSED WATERMAIN
 - CB ○ PROPOSED CATCHBASIN
 - STMH ○ PROPOSED STORM MANHOLE
 - SAMH ● PROPOSED SANITARY MANHOLE
 - CBMH ● PROPOSED CATCHBASIN MANHOLE
 - ◆ PROPOSED FIRE HYDRANT
 - ⊕ PROPOSED VALVE AND BOX
 - ⊙ PROPOSED WATER METER
 - ⊗ PROPOSED REMOTE WATER METER
 - ▨ PROPOSED RIP-RAP

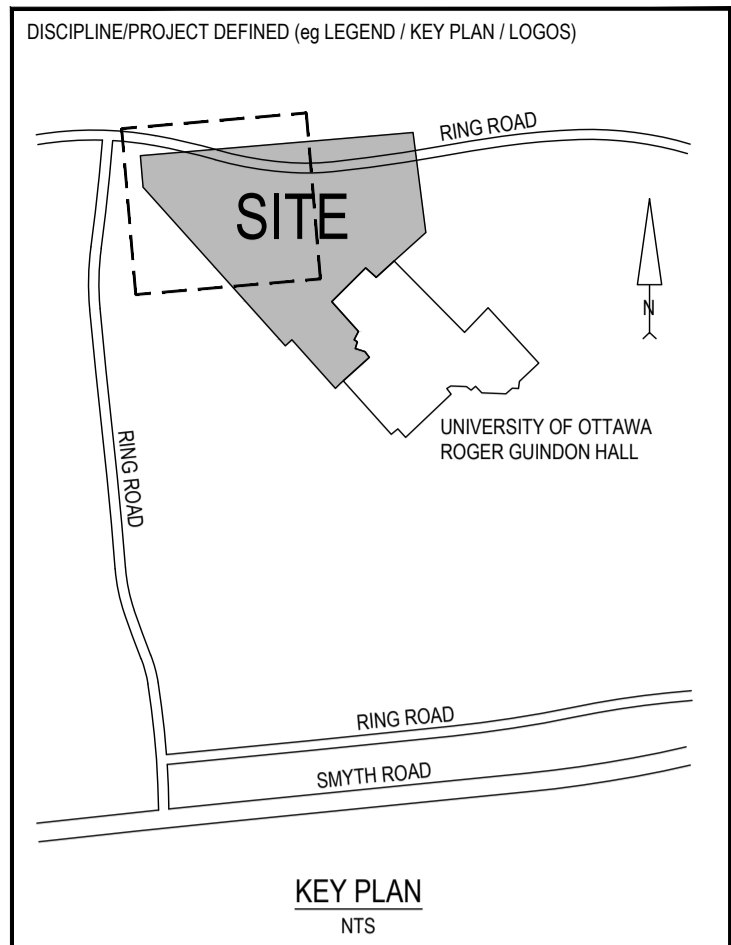

REVISION:

REV	DATE	DESCRIPTION	BY
6	2024-04-18	ISSUED FOR ZBLA AND SPC SUBMISSION	VT
5	2024-02-26	ISSUED FOR SITE PLAN APPROVAL	VT
4	2024-02-02	ISSUED FOR COORDINATION	VT
3	2023-11-30	ISSUED FOR SITE PLAN APPROVAL	VT
2	2023-11-20	ISSUED FOR BUILDING PERMIT	VT
1	2023-10-31	ISSUED FOR PRICING PROPOSAL	VT

SEAL: NORTH

DISCLAIMER: THIS DRAWING AND DESIGN IS COPYRIGHT PROTECTED WHICH SHALL NOT BE USED, REPRODUCED OR REVISED WITHOUT WRITTEN PERMISSION BY WSP. THE CONTRACTOR SHALL CHECK AND VERIFY ALL DIMENSIONS AND UTILITY LOCATIONS AND REPORT ALL ERRORS AND OMISSIONS PRIOR TO COMMENCING WORK.

ORIGINAL SCALE: AS NOTED
 DATE: 2023-09-25
 DESIGNED BY: Y. TENG
 IF THIS BAR IS NOT 25mm LONG, ADJUST YOUR PLOTTING SCALE.
 DRAWN BY: B. NANDLAL
 APPROVED BY: I. JAFFERJEE
 DISCIPLINE: CIVIL

MATCHLINE SEE SHEET C107

MATCHLINE SEE SHEET C108

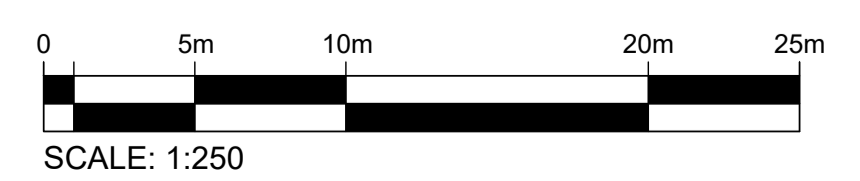

WSP CANADA INC.
 2611 QUEENVIEW DRIVE, SUITE 300
 OTTAWA ONTARIO K2B 8K2 CANADA
 WSP.COM

PROJECT NUMBER: CA0009956.0165-CA
 CLIENT: uOttawa

CLIENT REF. #

PROJECT: ADVANCED MEDICAL RESEARCH CENTRE

TITLE: SERVICING PLAN

DRAWING NUMBER: C106
 REV: 6

C:\Users\jgibson\OneDrive\Desktop\2024-04-18 - 11:50 AM
 FILE: \\10.10.13.mn.2023\project\ca0009956.0165-ca\ottawa-amrc\pursuit\14.0\tech_prof\services\14.60_civil3.dwg
 drawing\working drawing\sheet\ca0009956.0165-ca_civil3.amrc.dwg
 C:\Users\jgibson\OneDrive\Desktop\2024-04-18 - 11:50 AM

C:\Users\jafferjee\OneDrive\Desktop\2024-04-18 - 11:50 AM FILE: \\10.10.13.mer.2023\proj\009956.0165-ca-ottawa-ampc\pursuit\14.0\back_prof\services\14.60_civil3_drawing\working drawing\sheet\ca009956.0165-ca_aml_ammr.dwg

MATCHLINE SEE SHEET C106

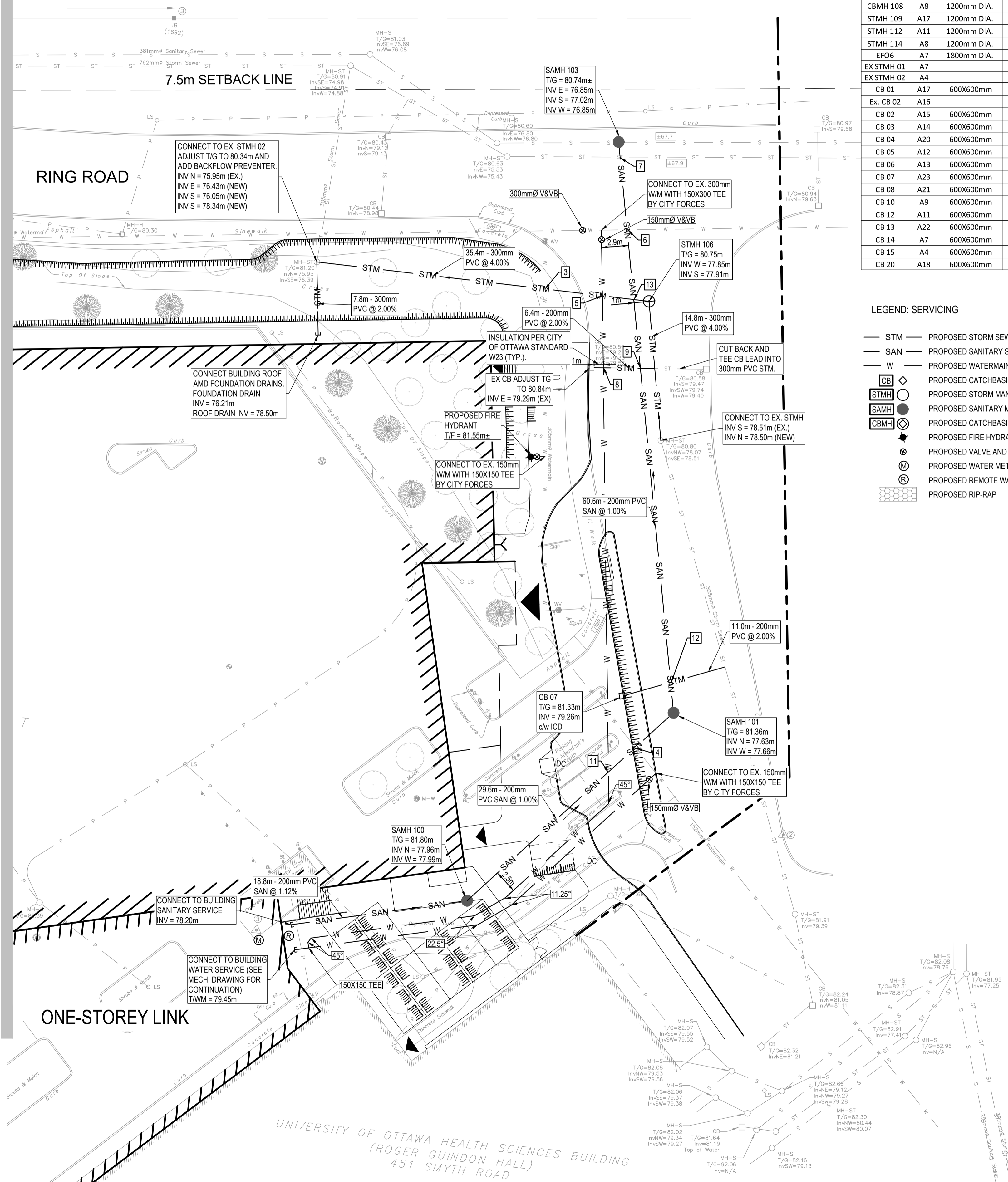

STORM STRUCTURE AND ICD DATA TABLE													
STRUCTURE ID	AREA ID	SIZE	STRUCTURE	COVER	TOP OF GRATE	451 SMYTH ROAD			OUTLET DIAMETER (mm)	TYPE	100-YR HEAD	100-YR FLOW (l/s)	ICD TYPE
						INLET	INLET	OUTLET					
STMH 102	A11	1500mm DIA.	OPSD 701.011	S24.1	79.86		76.270	76.210					
EFO4	A8	1200mm DIA.	OPSD 701.011	S24.1	79.44		75.370	75.340	375	PVC SDR-35			
STMH 106	N/A	1200mm DIA.	OPSD 701.010	S24.1	80.75		77.910	77.850	300	PVC SDR-35			
STMH 108	A13	1200mm DIA.	OPSD 701.010	S24.1	79.98	76.400	76.700	76.370	525	CONC. 100D			
CBMH 102	A10	1200mm DIA.	OPSD 701.010	S28.1	79.14		76.620	76.370	450	CONC. 100D			
CBMH 108	A8	1200mm DIA.	OPSD 701.010	S28.1	79.34		76.400	76.350	250	PVC SDR-35			
STMH 109	A17	1200mm DIA.	OPSD 701.010	S24.1	80.19	76.880	76.880	76.550	525	CONC. 100D			
STMH 112	A11	1200mm DIA.	OPSD 701.010	S24.1	79.89		76.000	75.500	375	PVC SDR-35	1.92	4.09	Hydrovex 50 VHV-1
STMH 114	A8	1200mm DIA.	OPSD 701.010	S24.1	80.26	76.240	76.240	76.210					
EFO6	A7	1800mm DIA.		S24.1	78.58		75.400	75.370	375	PVC SDR-35	1.38	74.96	Orifice (175mm Dia.)
EX STMH 01	A7				79.07	75.220	75.220	75.100	610	EX. CONC.			
EX STMH 02	A4				80.34	76.430	76.050	78.340	305	EX. CONC.			
CB 01	A17	600x600mm	OPSD 705.010	S19	79.88			77.180	200	PVC SDR-35			
Ex. CB 02	A16				79.87			77.060	200	PVC SDR-35			
CB 02	A15	600x600mm	OPSD 705.010	S19	79.89			78.190	200	PVC SDR-35			
CB 03	A14	600x600mm	OPSD 705.010	S19	80.33			78.330	200	PVC SDR-35			
CB 04	A20	600x600mm	OPSD 705.010	S19	78.82			76.900	200	PVC SDR-35			
CB 05	A12	600x600mm	OPSD 705.010	S19	80.10			78.100	200	PVC SDR-35			
CB 06	A13	600x600mm	OPSD 705.010	S19	79.57			77.580	200	PVC SDR-35	2.09	49.49	Orifice (125mm Dia.)
CB 07	A23	600x600mm	OPSD 705.010	S19	81.33			79.260	200	PVC SDR-35			
CB 08	A21	600x600mm	OPSD 705.010	S19	78.30			76.650	200	PVC SDR-35			
CB 10	A9	600x600mm	OPSD 705.010	S19	78.54			76.780	200	PVC SDR-35			
CB 12	A11	600x600mm	OPSD 705.010	S19	79.66			77.700	200	PVC SDR-35			
CB 13	A22	600x600mm	OPSD 705.010	S19	78.02			76.580	200	PVC SDR-35			
CB 14	A7	600x600mm	OPSD 705.010	S19	78.44			76.660	200	PVC SDR-18			
CB 15	A4	600x600mm	OPSD 705.010	S19	79.59			77.500	200	PVC SDR-35			
CB 20	A18	600x600mm	OPSD 705.010	S19	80.20			78.500	200	PVC SDR-35			

LEGEND: SERVICING

- STM — PROPOSED STORM SEWER
- SAN — PROPOSED SANITARY SEWER
- W — PROPOSED WATERMAIN
- CB ○ PROPOSED CATCHBASIN
- STMH ○ PROPOSED STORM MANHOLE
- SAMH ○ PROPOSED SANITARY MANHOLE
- CBMH ○ PROPOSED CATCHBASIN MANHOLE
- PROPOSED FIRE HYDRANT
- ⊕ PROPOSED VALVE AND BOX
- ⊕ PROPOSED WATER METER
- ⊕ PROPOSED REMOTE WATER METER
- ⊕ PROPOSED RIP-RAP

WATERMAIN SCHEDULE					
STATION	DESCRIPTION	FINISHED GRADE	TOP OF WATERMAIN	AS-BUILT WATERMAIN	COVER
150mm W/M Service					
0+000	Connect to Ex. 300mm WM w/ 150x300 Tee	80.700	78.300	78.300	2.400
0+001.0	150mm V&VB	80.690	78.290		2.400
0+060.7	45 DEG. Bend	81.570	79.170		2.400
0+075.6	11.25 DEG. Bend	81.740	79.340		2.400
0+079.3	22.5 DEG. Bend	81.770	79.370		2.400
0+096.8	45 DEG. Bend	81.880	79.480		2.400
0+097.4	45 DEG. Bend	81.880	79.480		2.400
0+098.0	Connect to 150mm WM w/ 150x150 Tee	81.880	79.480		2.400
1+000	Connect to Ex. 150mm WM w/ 150x150 Tee	81.480		79.080	2.400
1+001.0	150mm V&VB	81.570	79.100		2.400
1+020.8	11.25 DEG. Bend	81.720	79.320		2.400
1+024.9	22.5 DEG. Bend	81.750	79.350		2.400
1+043.0	Connect to 150mm WM w/ 150x150 Tee	81.880	79.480		2.400
1+044.5	Cap 1.0m from Foundation Wall	81.900	79.500		2.400

SAN STRUCTURE TABLE						
STRUCTURE ID	TOP OF GRATE ELEVATION	INLET			DESCRIPTION	COVER
		INLET	INLET	OUTLET		
SAMH 100	81.80	77.990	77.960	77.960	1200mm DIA. OPSD-701.010	S24
SAMH 101	81.36	77.660	77.630	77.630	1200mm DIA. OPSD-701.010	S24
SAMH 103	80.74	76.850	77.020	76.850	1200mm DIA. OPSD-701.010	S24

PIPE CROSSING TABLE						
LINE NO.	PIPE	Invert		Clearance	Obvert	
		Invert	Obvert		Invert	Obvert
1	200mm PVC STM	76.560	76.590	1.030	Clearance Above	74.920 75.530
2	250mm PVC STM	76.340	76.590	0.860	Clearance Under	77.450 77.750
3	300mm PVC STM	77.390	77.690	0.410	Clearance Under	78.100 78.400
4	200mm PVC SAN	77.720	77.920	0.930	Clearance Under	78.850 79.000
5	150mm W/M	78.190	78.340	0.240	Clearance Above	77.650 77.950
6	200mm PVC SAN	77.110	77.310	0.740	Clearance Under	78.050 78.350
7	Ex. 375mm PVC STM	75.590	75.970	1.070	Clearance Under	77.040 77.240
8	150mm W/M	78.050	78.200	1.070	Clearance Under	79.270 79.470
9	200mm PVC SAN	77.260	77.460	1.730	Clearance Under	79.190 79.390
10	375mm PVC STM	75.520	75.895	0.905	Clearance Under	76.800 77.100
11	200mm PVC SAN	77.750	77.950	1.000	Clearance Under	78.950 79.100
12	200mm PVC SAN	77.600	77.800	1.360	Clearance Under	79.160 79.360
13	200mm PVC SAN	77.190	77.390	0.400	Clearance Under	77.790 78.090
14	Ex. 300mm PVC STM	77.610	77.915	0.575	Clearance Above	76.510 77.035
15	Ex. 300mm PVC STM	77.530	77.835	0.430	Clearance Above	76.900 77.100
16	Ex. 450mm CONC. STM	75.270	75.720	0.540	Clearance Below	76.260 76.785

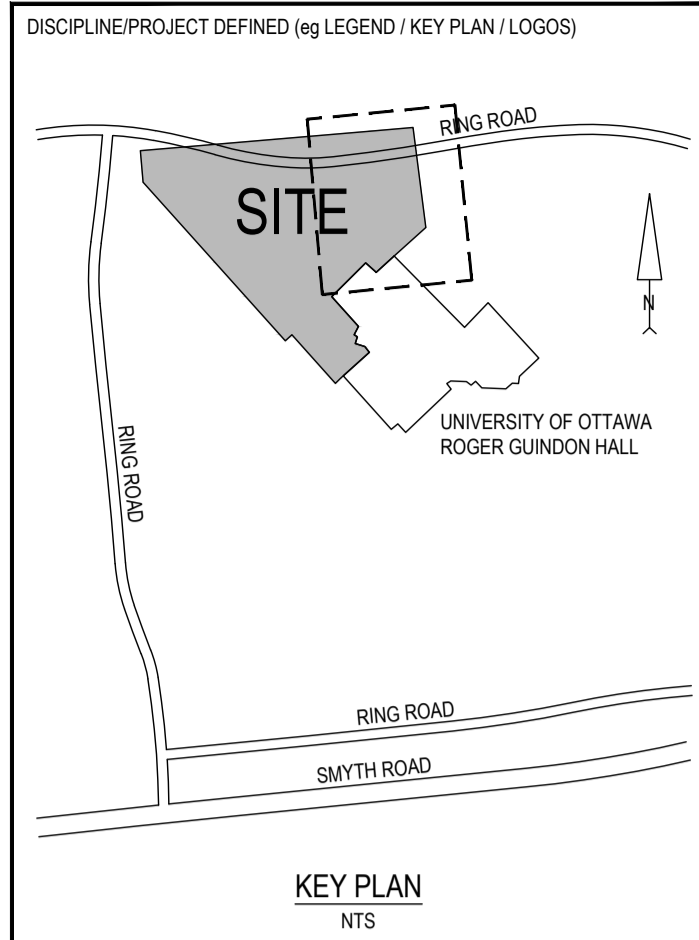

REVISION:			
REV	DATE	DESCRIPTION	BY
6	2024-04-18	ISSUED FOR ZBLA AND SPC SUBMISSION	VT
5	2024-02-26	ISSUED FOR SITE PLAN APPROVAL	VT
4	2024-02-02	ISSUED FOR COORDINATION	VT
3	2023-11-30	ISSUED FOR SITE PLAN APPROVAL	VT
2	2023-11-20	ISSUED FOR BUILDING PERMIT	VT
1	2023-10-31	ISSUED FOR PRICING PROPOSAL	VT

SEAL: NORTH

DISCLAIMER: THIS DRAWING AND DESIGN IS COPYRIGHT PROTECTED WHICH SHALL NOT BE USED, REPRODUCED OR REVISED WITHOUT WRITTEN PERMISSION BY WSP. THE CONTRACTOR SHALL CHECK AND VERIFY ALL DIMENSIONS AND UTILITY LOCATIONS AND REPORT ALL ERRORS AND OMISSIONS PRIOR TO COMMENCING WORK.

DATE: 2023-09-25
 DESIGNED BY: Y. TENG
 DRAWN BY: B. NANDLAL
 APPROVED BY: I. JAFFERJEE
 DISCIPLINE: CIVIL

WSP CANADA INC.
 2611 QUEENSWAY DRIVE, SUITE 300
 OTTAWA ONTARIO K2B 8K2 CANADA
 WSP.COM

PROJECT NUMBER: CA0009956.0165-CA
 CLIENT: uOttawa

CLIENT REF. #

PROJECT: **ADVANCED MEDICAL RESEARCH CENTRE**

TITLE: **SERVICING PLAN**

DRAWING NUMBER: **C107** REV: **6**

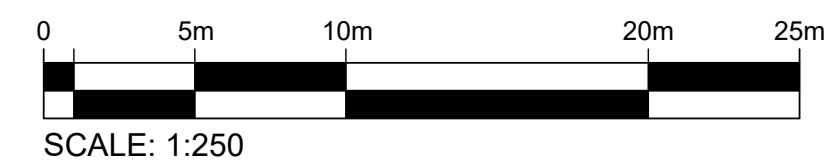

MATCHLINE SEE SHEET C106

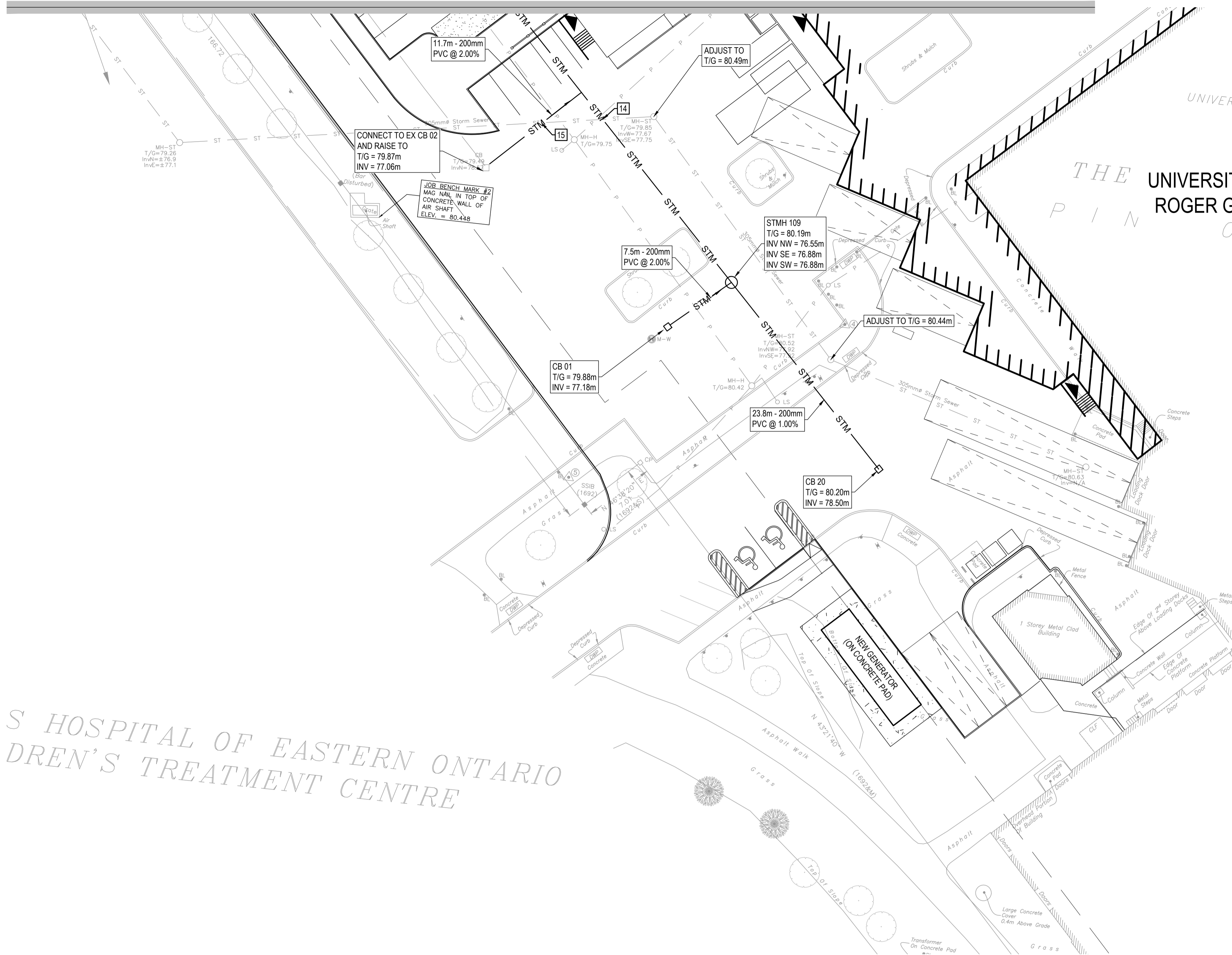

UNIVERSITY OF OTTAWA HEALTH SCIENCES E
(ROGER GUINDON HALL)
451 SMYTH ROAD

THE UNIVERSITY OF OTTAWA
ROGER GUINDON HALL
0 4 2 5 8 - 0

HOSPITAL OF EASTERN ONTARIO
CHILDREN'S TREATMENT CENTRE

LEGEND: SERVICING

- STM — PROPOSED STORM SEWER
- SAN — PROPOSED SANITARY SEWER
- W — PROPOSED WATERMAIN
- CB ◊ PROPOSED CATCHBASIN
- STMH ○ PROPOSED STORM MANHOLE
- SAMH ● PROPOSED SANITARY MANHOLE
- CBMH ⊙ PROPOSED CATCHBASIN MANHOLE
- ⚡ PROPOSED FIRE HYDRANT
- ⊕ PROPOSED VALVE AND BOX
- ⊗ PROPOSED WATER METER
- ⊕ PROPOSED REMOTE WATER METER
- ▨ PROPOSED RIP-RAP

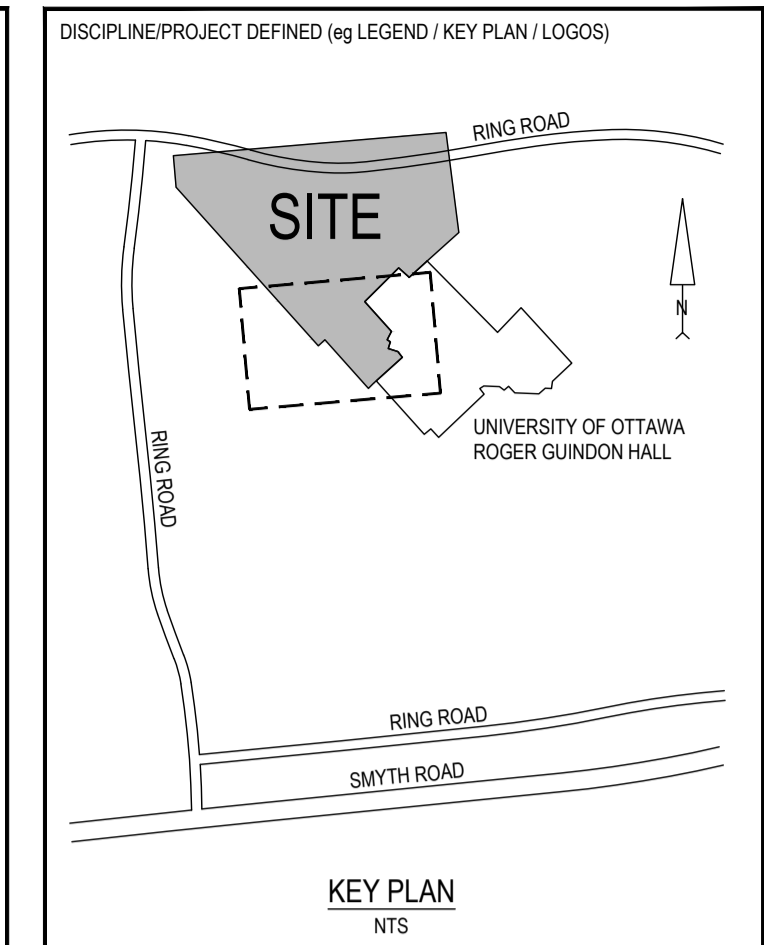
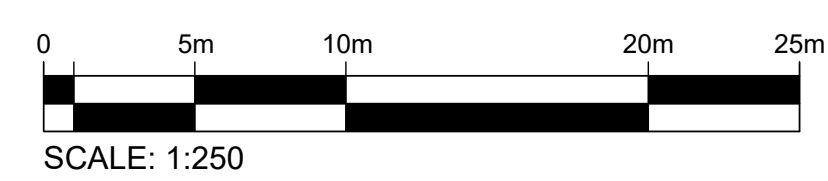

REVISION:

REV	DATE	DESCRIPTION	BY
6	2024-04-18	ISSUED FOR ZBLA AND SPC SUBMISSION	VT
5	2024-02-26	ISSUED FOR SITE PLAN APPROVAL	VT
4	2024-02-02	ISSUED FOR COORDINATION	VT
3	2023-11-30	ISSUED FOR SITE PLAN APPROVAL	VT
2	2023-11-20	ISSUED FOR BUILDING PERMIT	VT
1	2023-10-31	ISSUED FOR PRICING PROPOSAL	VT

SEAL: NORTH

Y. TENG
100226367
2024-04-18
PROVINCE OF ONTARIO

DISCLAIMER: THIS DRAWING AND DESIGN IS COPYRIGHT PROTECTED WHICH SHALL NOT BE USED, REPRODUCED OR REVISED WITHOUT WRITTEN PERMISSION BY WSP. THE CONTRACTOR SHALL CHECK AND VERIFY ALL DIMENSIONS AND UTILITY LOCATIONS AND REPORT ALL ERRORS AND OMISSIONS PRIOR TO COMMENCING WORK.

ORIGINAL SCALE: AS NOTED	DATE: 2023-09-25
DESIGNED BY: Y. TENG	IF THIS BAR IS NOT 25mm LONG, ADJUST YOUR PLOTTING SCALE.
DRAWN BY: B. NANDLAL	25mm
APPROVED BY: I. JAFFERJEE	
DISCIPLINE: CIVIL	

PROJECT NUMBER: CA0009956.0165-CA

CLIENT:

CLIENT REF. #:

PROJECT:

ADVANCED MEDICAL
RESEARCH CENTRE

TITLE:

SERVICING PLAN

DRAWING NUMBER: C108	REV: 6
-------------------------	-----------

C:\Users\wsp_2016\OneDrive - WSP\Documents\2024-04-18 - 11:50 AM - FILE: 0110_13_mz_2023_project\ca0009956.0165-ca\ottawa_amao_pursuit\14.0\tech_prof_services\14_60_civil_drawing\working drawing\sheet\ca0009956.0165-ca_dwg_amao.dwg