

TREE CANOPY CALCULATION AS PER EVOLVING CITY OF OTTAWA REQUIREMENTS:

TOTAL SITE AREA:	3 500 SQ. M.
CALCULATIONS FOR TREE CANOPY	
Proposed Trees (Areas of Polygons)	
Hatched in Green, Excluding Overlap.)	
PRIVATE PROPERTY 325+450+65 =	840 SQ. M.
PUBLIC PROPERTY 390+110+425 =	925 SQ. M.
TOTAL TREE CANOPY PROPOSED =	1 765 SQ. M.
CANOPY COVER AS % OF SITE	1 765 / 3 500 = 50%

*****ADDITIONAL LANDSCAPE PLAN NOTES *****

LANDSCAPING ON CITY OF OTTAWA PROPERTY TO BE TO CITY OF OTTAWA DETAILS / STANDARDS. L1-L6, L17

TREES ON CITY OF OTTAWA PROPERTY TO CARRY A 2 YEAR WARRANTY.

REFER TO SITE PLAN FOR LOCATIONS AND DIMENSIONS OF BUILDING, ROADS, PARKING, CURBS, SETBACKS, EASEMENTS, LEGAL DESCRIPTION.

EXISTING AND PROPOSED SITE SERVICING IS SHOWN ON THE LANDSCAPE PLAN TO PROVIDE AN AWARENESS TO REVIEWERS AND CONTRACTORS OF THEIR INTENDED LOCATION AND SEPARATION OF TREES/SERVICES/PROPOSED LANDSCAPING. DETERMINE AS BUILT LOCATIONS OF SERVICES PRIOR TO PLANTING AND ADJUST ACCORDINGLY TO RESPECT REQUIRED SETBACKS

Drawing Remains the Property of / Copyright Reserved by / Do Not Use or Reproduce Without Approval of Gino J. Aiello Landscape Architect / GJA INC.

Use For Construction If Indicated

Contractor is Responsible for Verification of Site Locations of all Utilities. Report any Discrepancies Between Site and Drawing Immediately to GJA INC.. Do NOT Proceed Until Clarified.

TURF AREAS TO BE SOD C/W 150MM DEPTH TOPSOIL ON APPROVED SUBGRADE | SOD TO BE #1 GRADE TURF/GRASS NURSERY SOD per NSGA - Fine Fescue/Kentucky Bluegrass Sod | PLANTING MIX TO BE APPROVED BY LANDSCAPE ARCHITECT | PLANT MATERIAL TO MEET CNLA STANDARDS/BE APPROVED BY LANDSCAPE ARCHITECT PRIOR TO PLANTING ALL MATERIALS & WORK TO BE MAINTAINED UNTIL FINAL ACCEPTANCE, (MOWING TURF, WEEDING BEDS, WATERING TURF & PLANTS) & INCLUDE 1 YEAR WARRANTY FROM DATE OF FINAL ACCEPTANCE | PROVIDE WATERING OF ALL PLANT MATERIAL AS REQUIRED FOR PROPER ESTABLISHMENT, UNTIL END OF WARRANTY PERIOD | REFER TO CIVIL ENGINEER'S DRAWING FOR ELEVATIONS / GRADING |

The Landscape Plan is to be read in conjunction with the grading, servicing, site and survey plan | Bare root material to be planted in season only | All plant material locations to be staked on site by the landscape contractor and checked by the landscape architect prior to planting | All trees to be preserved on or directly adjacent to the site will be protected | Plant material are to be installed a minimum of: 3.0m away from any part of any hydro transformer, 3.0m corridor between a fire hydrant and the curb, a 2.5m radius beside or behind a fire hydrant, 2.0m from any servicing/utility line or structure |

TREE SCHEDULE 1657 CARLING AVENUE									
CODE	QUANTITY	PUBLIC	BOTANICAL NAME	COMMON NAME	B&B SPECIMEN	NATIVE TO CANADA	FORECASTED SPREAD AS per City of Ottawa Forestry		Canopy Cover Contribution/Tree in Square Metres
							DIAMETER	RADIUS	
AC	2	0	Amelanchier canadensis	Tree Serviceberry	50mm cal	YES	5.0m	2.5m	20.0 sq. m.
AR	1	5	Acer rubrum	Red Maple	60mm cal	YES	10.0m	5.0m	78.5 sq. m.
AS	1	0	Acer saccharum	Sugar Maple	60mm cal	YES	14.0m	7.0m	154.0 sq. m.
AG	1	0	Aesculus flava	Yellow Buckeye	50mm cal	YES	10.0m	5.0m	78.5 sq. m.
BP	2	0	Betula papyrifera	Paper Birch	50mm cal	YES	10.0m	5.0m	78.5 sq. m.
CC	1	0	Carpinus caroliniana	Hornbeam Bluebeech	50mm cal	YES	10.0m	5.0m	78.5 sq. m.
CO	3	2	Celtis occidentalis	Common Hackberry	60mm cal	YES	14.0m	7.0m	154.0 sq. m.
GB	1	6	Ginkgo biloba	Maidenhair Tree	70mm cal	YES	10.0m	5.0m	78.5 sq. m.
GD	1	0	Gymnocladus dioicus	Kentucky Coffee Tree	60mm cal	YES	14.0m	7.0m	154.0 sq. m.
QM	1	0	Quercus macrocarpa	Bur Oak	60mm cal	YES	14.0m	7.0m	154.0 sq. m.
QR	1	0	Quercus rubra	Red Oak	60mm cal	YES	14.0m	7.0m	154.0 sq. m.
TOTAL	13	13							
AB	1	0	Abies balsamea	Balsam Fir	1.5m Ht.	YES	5.0m	2.5m	20.0 sq. m.
AV	3	0	Juniperus virginiana	Eastern Red Cedar	1.5m Ht.	YES	3.0m	1.5m	7.0 sq. m.
LL	2	0	Larix laricina	Eastern Larch / Tamarack	1.5m Ht.	YES	5.0m	2.5m	20.0 sq. m.
PG	1	0	Picea glauca	White Spruce	1.5m Ht.	YES	5.0m	2.5m	20.0 sq. m.
PS	2	0	Pinus strobus	White Pine	1.5m Ht.	YES	10.0m	5.0m	78.5 sq. m.
TOTAL C	9								

SHRUBS 1657 CARLING AVENUE

Code	Qty.	Botanical Name	Common Name	Size	Condition	NATIVE
HK	tbd	Hypericum kalmianum	Kalm St. John's Wort	30cm Ht.	Pot	YES
HP	tbd	Hypericum prolificum	Shrubby St. John's Wort	40cm Ht.	Pot	YES
SA1	tbd	Symphoricarpos albus	Snowberry	50cm Ht.	Pot	YES
SA	tbd	Spiraea alba	Meadowsweet	50cm Ht.	Pot	YES
SB	tbd	Spiraea bumalda 'Dart's Red'	Dart's Red Spirea	40cm Ht.	Pot	YES
Code	Qty.	Botanical Name	Common Name	Condition		
AU	tbd	Arctostaphylos Uva Ursi	Bearberry	30cm spr	Pot	YES
GM	tbd	Geranium macrorrhizum	Bigroot Geranium	9cm Pot		
GR	tbd	Geranium psilostemon 'Gerwat'	Rozanne Geranium	9cm Pot		
PM	tbd	Pinus mugo var. pumilio	Mugho Pine	30cm spr	Pot	
TCm	tbd	Taxus cuspidata 'Monloo'	Emerald Spreader Yew	30cm spr	Pot	
PV	tbd	Panicum virgatum	Switch Grass	10CM POT		YES

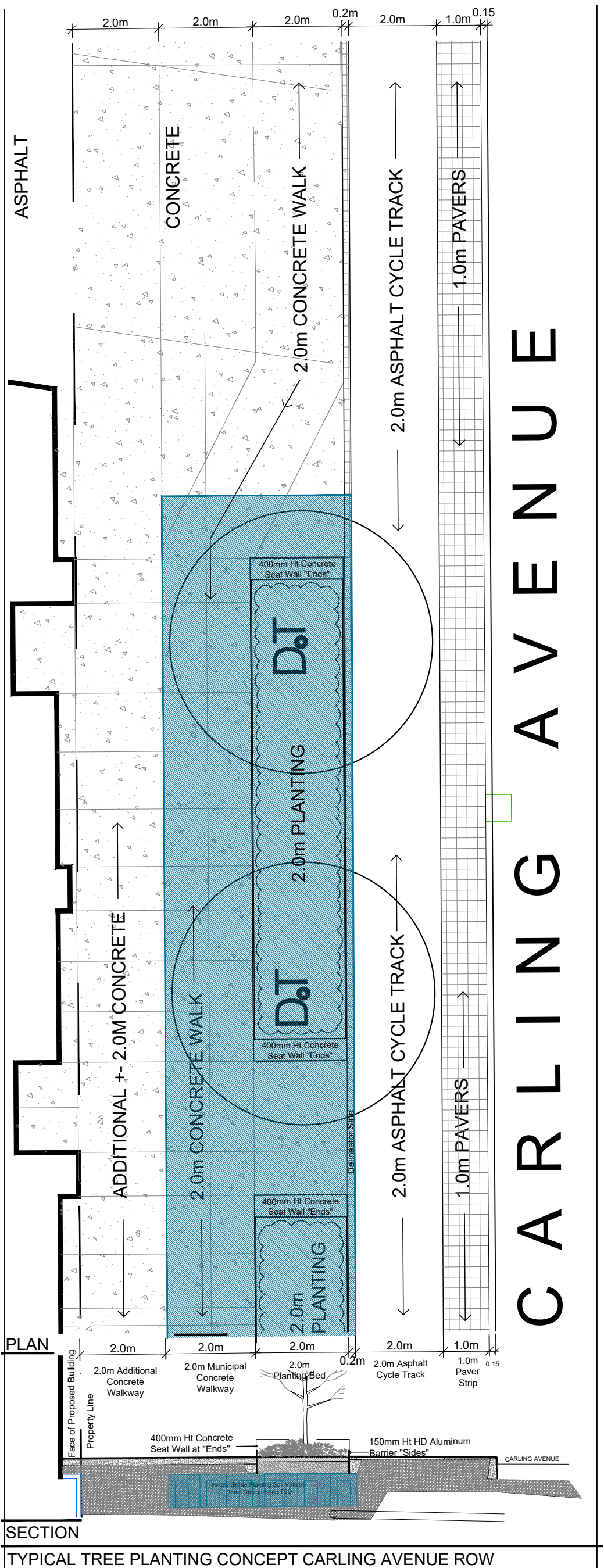
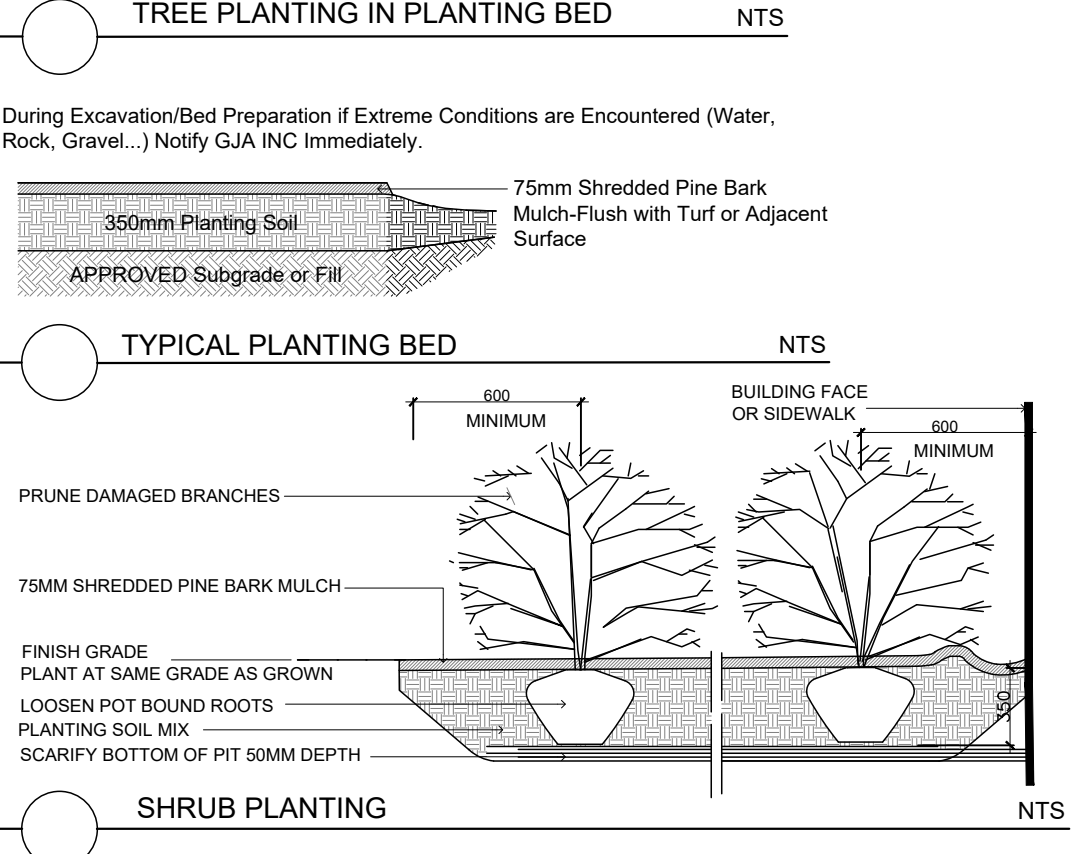
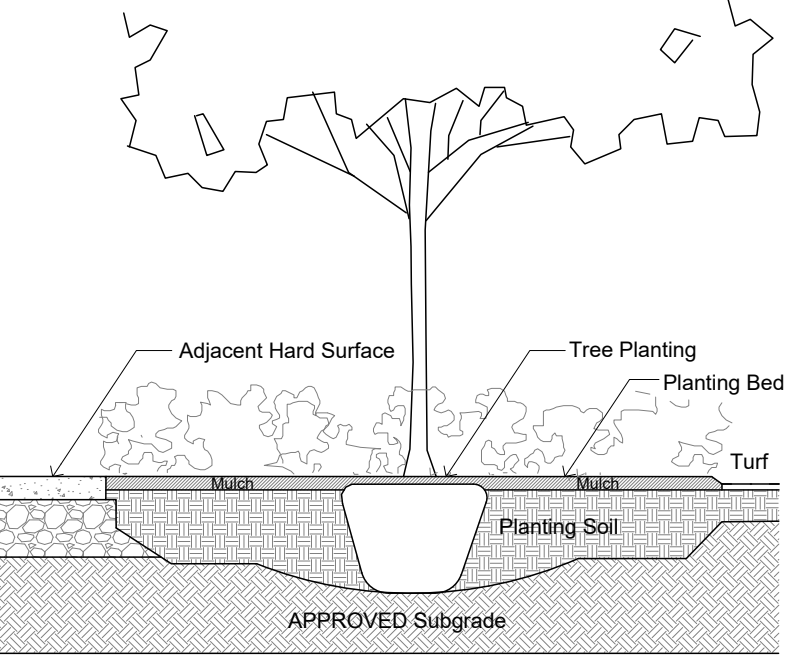
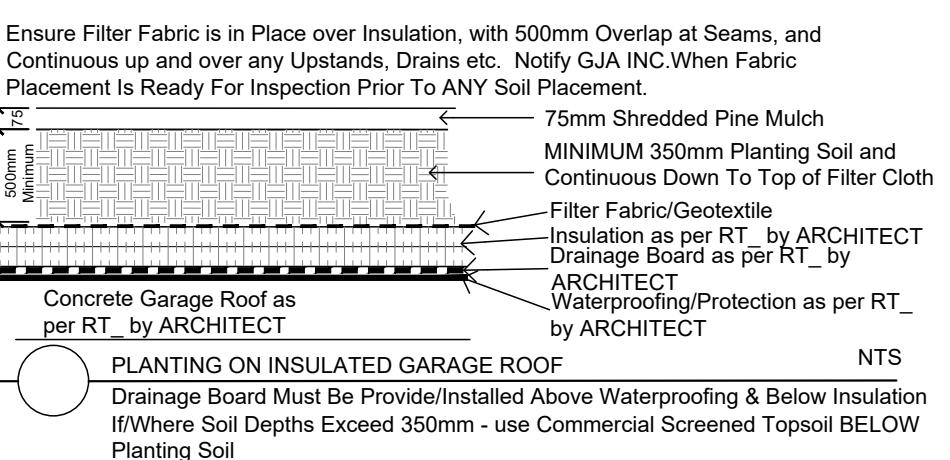

- LEGEND**
- LANDSCAPE REMOVALS
 - Existing Tree to Remove
 - LANDSCAPE PROPOSED
 - Deciduous Tree
 - Coniferous Tree
 - Typical Planting Bed
 - Turf
 - Soil Cell
 - Private Patios
 - Concrete
 - Concrete Seat Wall
 - Privacy Fence
 - SITE / ARCHITECTURE
 - Parking Garage Below
 - Fire Hydrant
 - FD Siamese Connection
 - Light Standard
 - Hydro/Utility Pole
 - BELOW GRADE SERVICES
 - REFER TO CIVIL/CUP
 - WTR U/G Water Service
 - STM U/G Storm Service
 - SAN U/G Sanitary Service
 - GAS U/G Gas Service
 - BC U/G TelCo Service
 - H U/G Hydro Service
 - OHW O/H Hydro Service

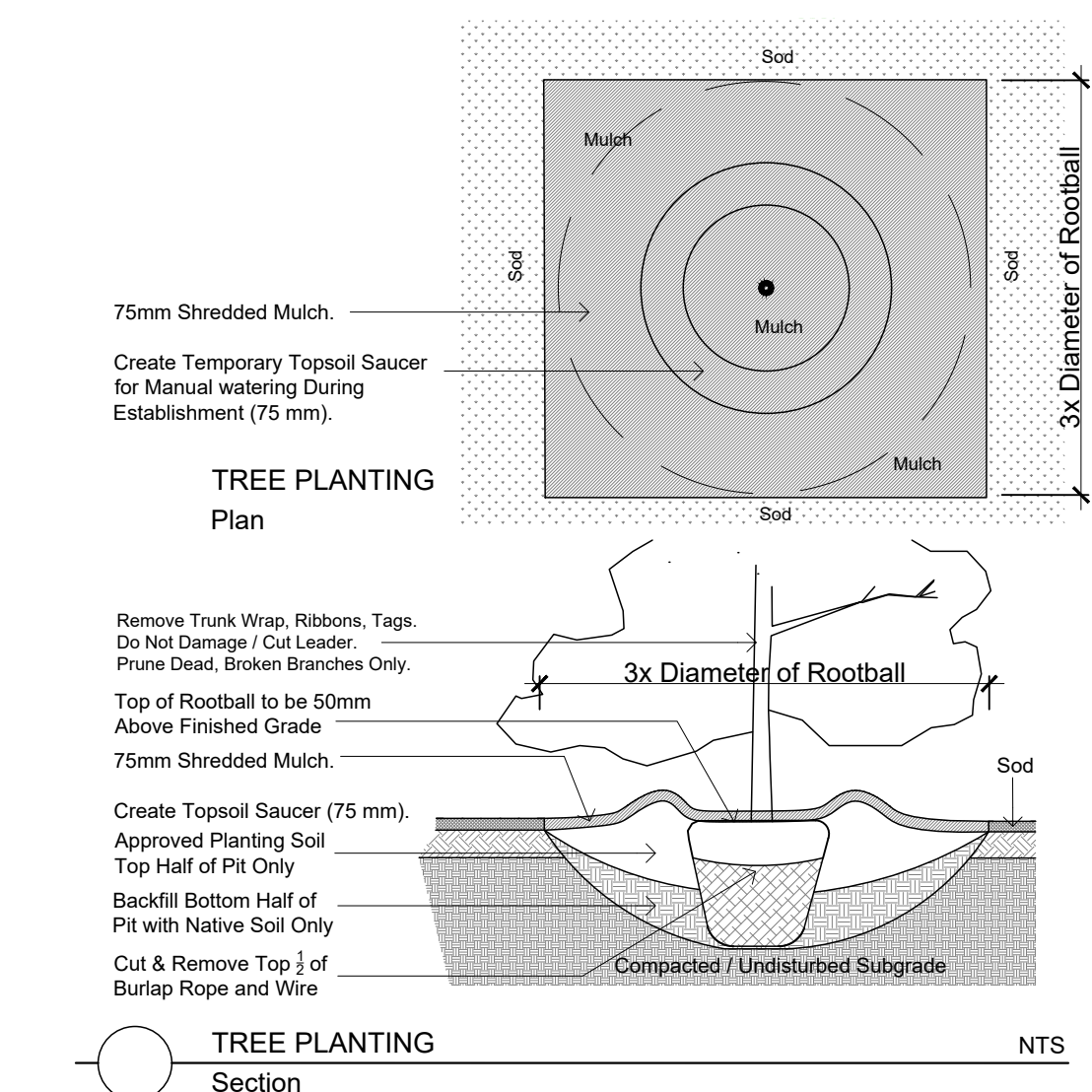
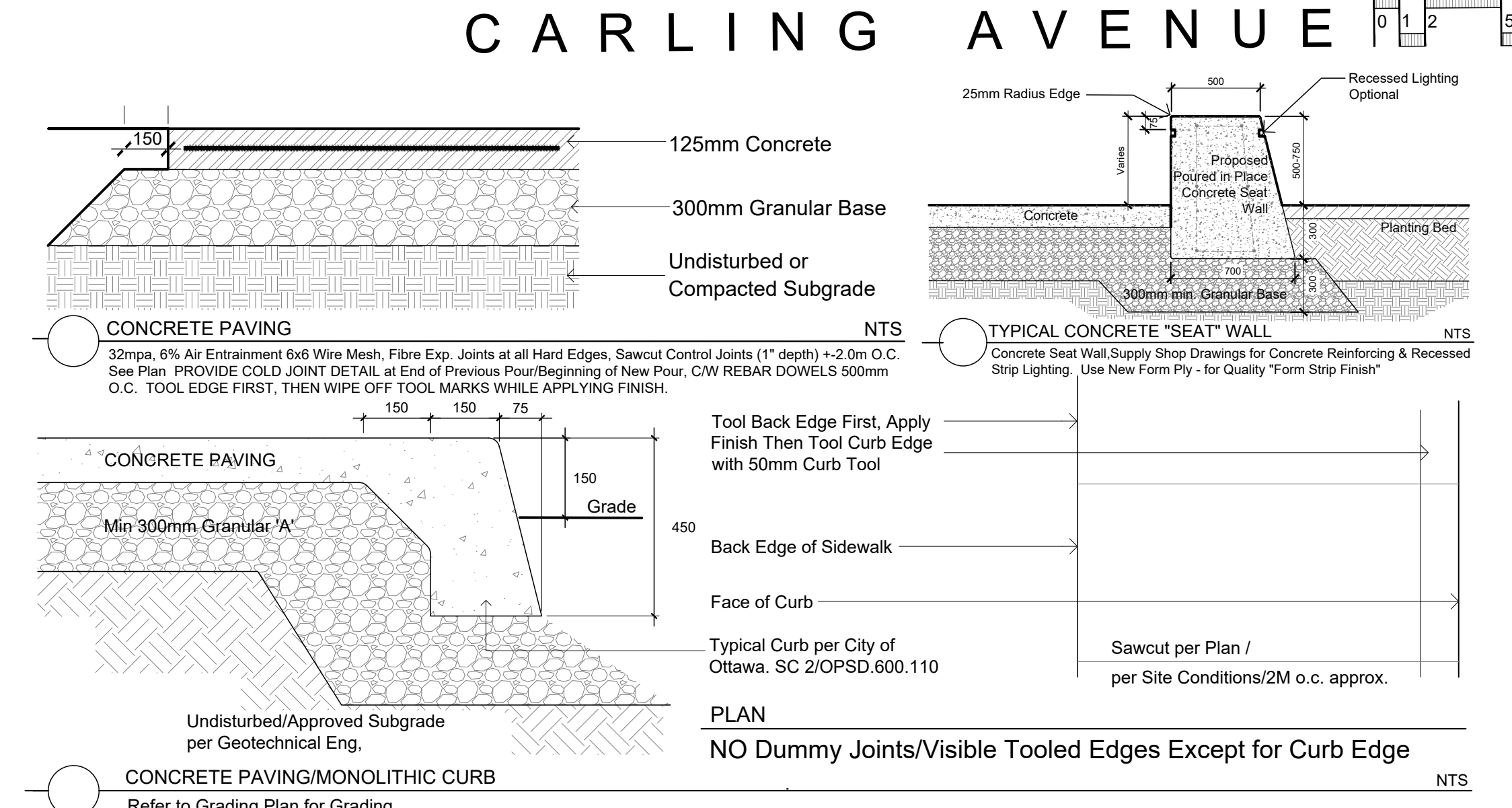

2 MUNICIPAL COMMENTS 2025 03 21

1 MUNICIPAL REVIEW 2025 01 14

0 REVIEW/COORDINATION 2024 11 00

Revision Date

PROPERTY OWNER

INSIDE EDGE PROPERTIES

464 BANK STREET SUITE 200

GJA INC.

GINO J. AIELLO | LANDSCAPE ARCHITECT

GJAL.COM | 613 286 5130 | GINO@GJAL.COM

110 DUNDAS STREET WEST UNIT #11 | OTTAWA, ONTARIO | K1T 5C2

PROPOSED MIXED USE MULTI UNIT RESIDENTIAL / COMMERCIAL BUILDING

1657 CARLING AVENUE

Landscape Plan

L1

Scale: 1:200

PC2024-0317 and D02-02-24-0032