

- GENERAL NOTES:**
- It is the responsibility of the appropriate contractor or official to report any errors, omissions or discrepancies on this plan with actual site conditions to the Landscape Architect before proceeding with construction.
  - The contractor is to notify all utility companies and authorities prior to any excavation and ascertain locations of underground services.
  - The contractor is to reinstate all areas and items damaged as a result of construction activity.
  - The contractor is to comply with all pertinent codes and by-laws.
  - The contractor is to maintain a positive surface run-off throughout the entire construction period.
  - The Landscape Architect is not responsible for subsurface conditions.
  - The contractor is to identify all existing trees to remain on site with the Landscape Architect prior to construction.
  - The contractor is to stake the proposed location of all plant material in conjunction with the Landscape Architect prior to excavation.
  - Minimum distances for selected deciduous trees are as follows:
    - Building Foundations 7.5m
    - Sidewalks 1.5m
    - Public Streets 2.5m
    - Underground Infrastructure 2.0m
  - All trees within 1m of underground utility trenches are to be excavated by hand.
  - Remove all protective wrapping from tree trunks after installation.
  - Staking of trees shall only be performed if necessary.
  - Ensure that mulch is pulled back a min. distance of 75mm from base of tree trunk.

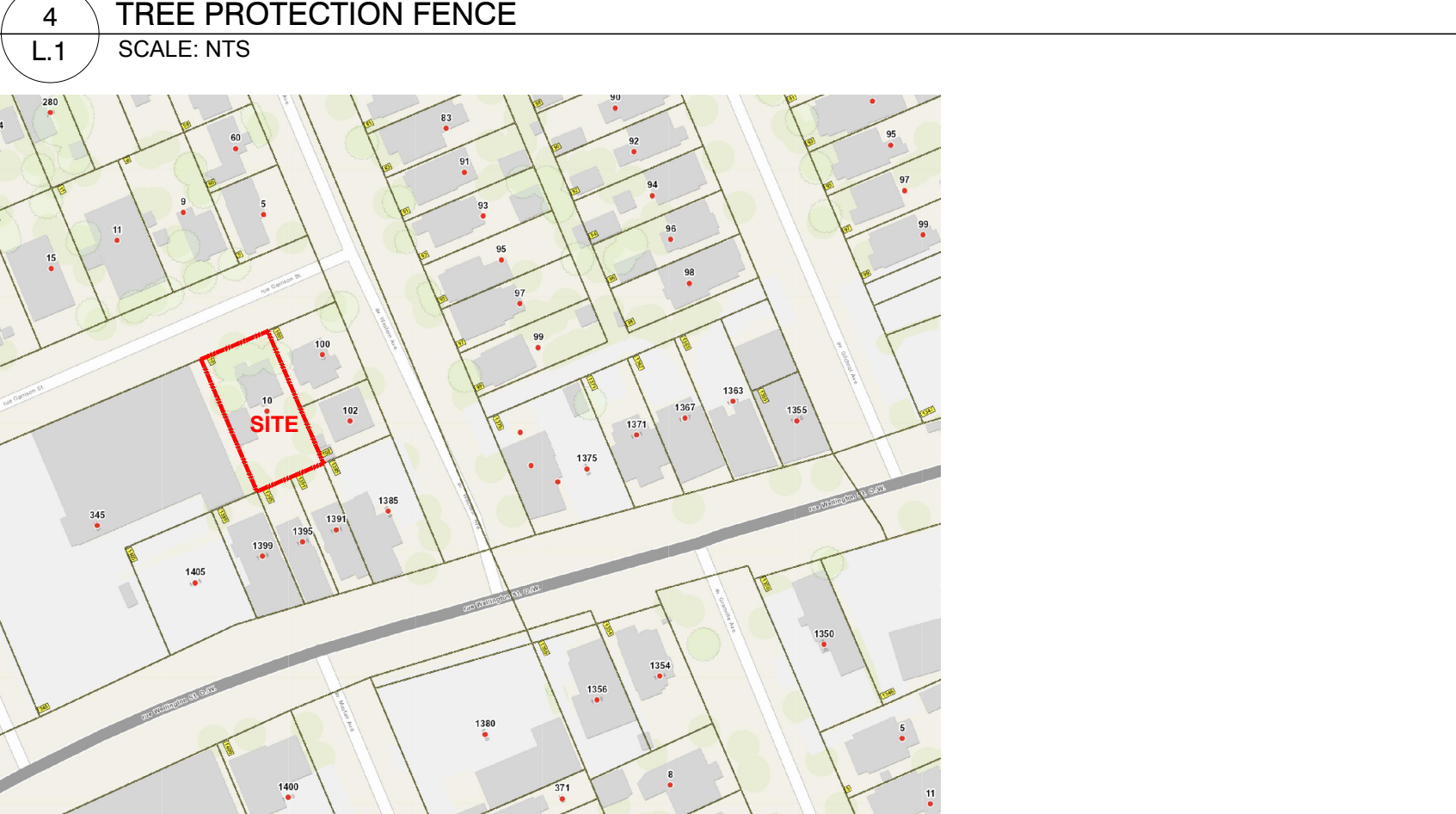
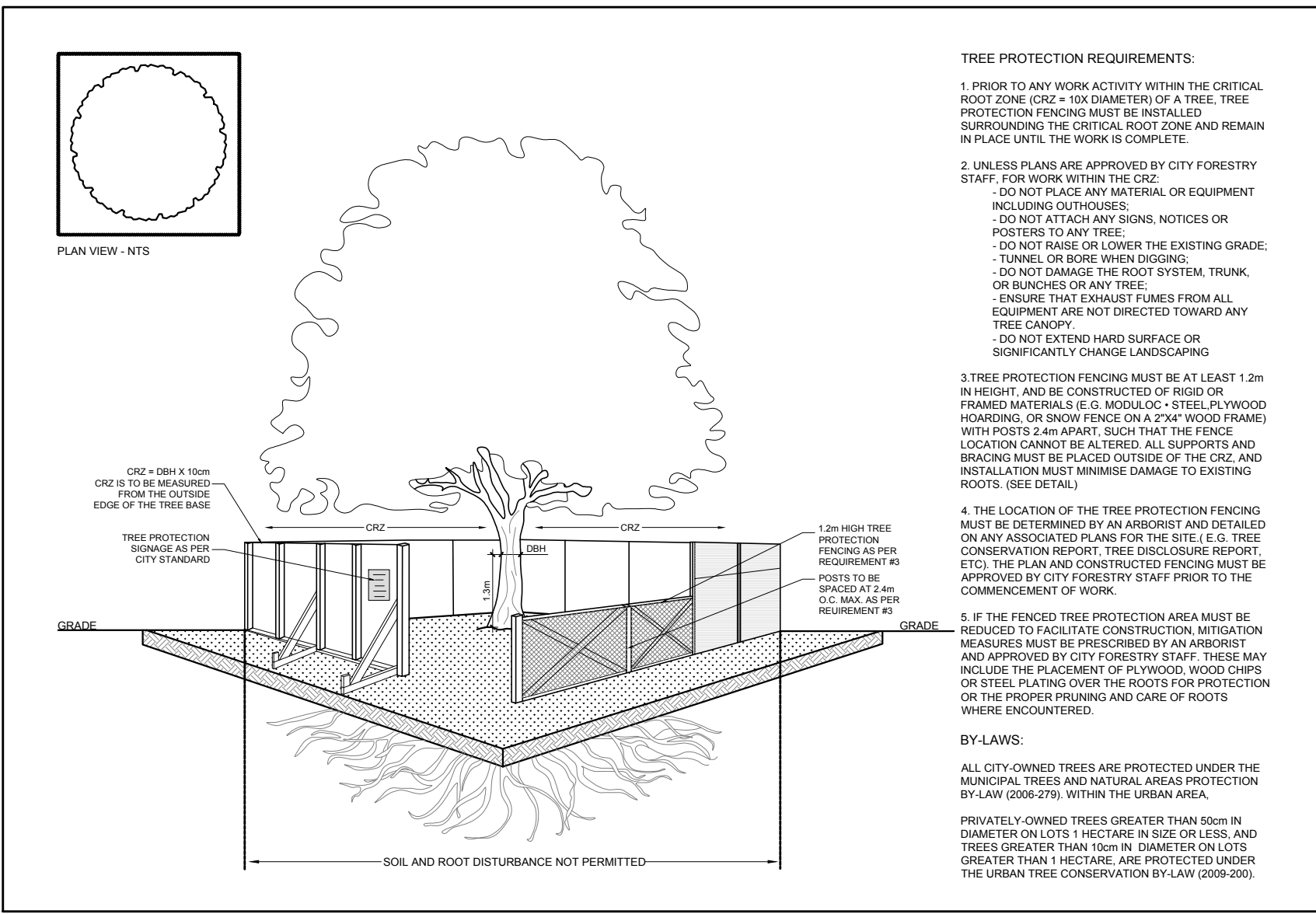
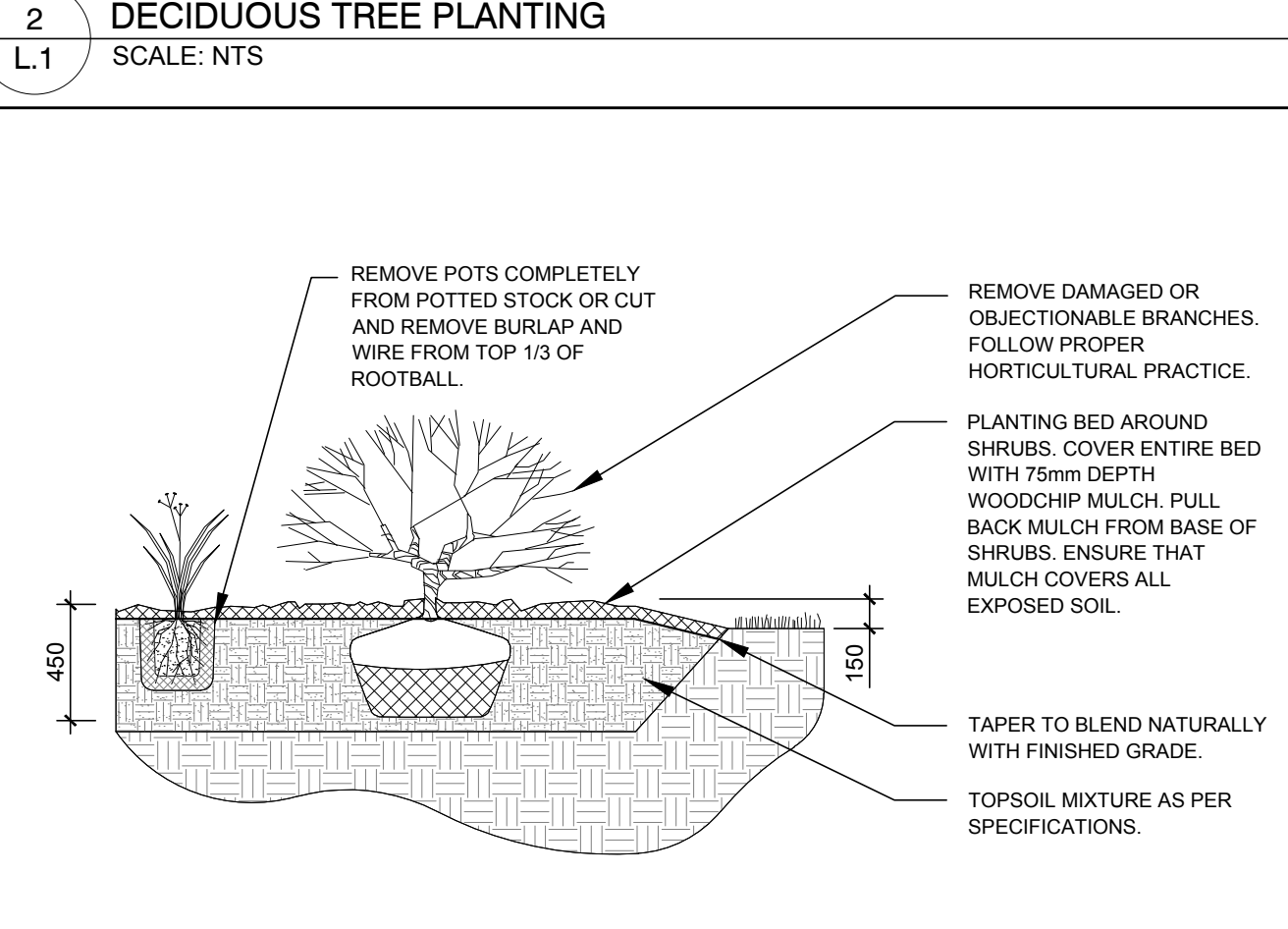
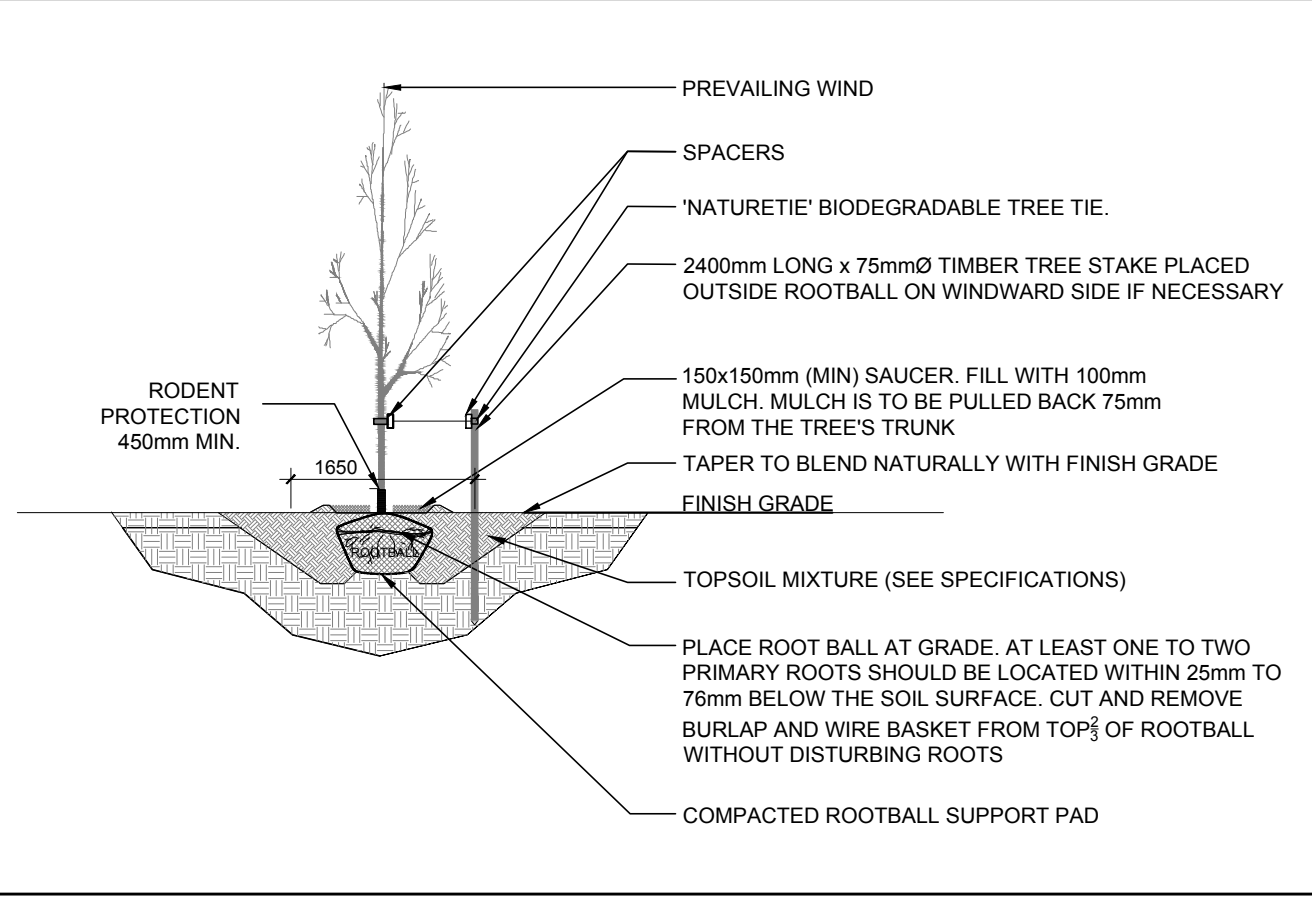

**PROPOSED PLANT LIST** (QTY KEY)

KEY	QTY	BOTANICAL NAME	COMMON NAME	SIZE	CONDITION	REMARKS
<b>TREES</b>						
* SB	1	Amelanchier canadensis	Shadblow Serviceberry	50mm cal.	B&B	Proposed on private property
* SF	1	Amelanchier laevis 'JFS-ARB'	Spring Flurry Serviceberry	50mm cal.	B&B	Proposed on private property
* SK	1	Gleditsia triacanthos 'Skyline'	Skyline Honey Locust	50mm cal.	B&B	Proposed on private property
<b>ORNAMENTAL GRASSES</b>						
BL	16	Leymus arenarius 'Blue Dune'	Blue Lyme Grass	250mm pot.	Potted	Space 800mm o.c.
KF	12	Calamagrostis 'Karl Foerster'	Karl Foerster Grass	250mm pot.	Potted	Space 800mm o.c.
OD	16	Calamagrostis 'Overdam'	Overdam Grass	250mm pot.	Potted	Space 800mm o.c.
* SG	19	Panicum virgatum	Switchgrass	250mm pot.	Potted	Space 800mm o.c.

\*NATIVE TO ONTARIO

**40 YEAR CANOPY CALCULATION:**

-465 m2 site area

-1 medium tree proposed (79m2 ea.), & 2 small trees proposed (7m2 ea)

=93m2 canopy cover =20% canopy cover

\*Medium tree calculated at 10m, small trees at 3m.

**EXISTING TREE LIST** (QTY KEY)

KEY	QTY	BOTANICAL NAME	COMMON NAME	SIZE	CONDITION	REMARKS	OWNERSHIP	COMMENTS
1	1	Picea glauca	White Spruce	240mm DBH	GOOD	To be removed	10 Garrison street	Tree is in good condition
2	1	Picea glauca	White Spruce	260mm DBH	GOOD	To be removed	10 Garrison street	Tree is in good condition
3	1	Acer negundo	Manitoba Maple	4x100mm DBH	GOOD	To be removed	10 Garrison street	Coppiced from the base of tree
4	1	Acer rubrum	Red Maple	500mm DBH	GOOD	To be removed	10 Garrison street	To be re-assessed when in leaf
5	1	Acer negundo	Manitoba Maple	1200mm DBH	FAIR	To remain	345 Carleton ave	To be re-assessed when in leaf. Growing into ex. fence
6	1	Acer saccharum	Sugar Maple	700mm DBH	GOOD	To be removed	10 Garrison street	Leaning over 102 Western property

**1 TREE CONSERVATION REPORT & LANDSCAPE PLAN**  
SCALE: 1:100

CLIENT  
**Farzin Fararooni**

CONSULTANTS  
ARCHITECTS  
**AS DESIGN COMPANY INC.**

CIVIL ENGINEERS  
**Stantec**  
Stantec Consulting Ltd.  
400-1331 Clyde Avenue  
Ottawa ON  
Tel: 416-722-4400  
www.stantec.com

**LEGEND**

- EXISTING TREE TO REMAIN
- EXISTING CEDAR HEDGE TO REMAIN
- EXISTING TREE TO BE REMOVED
- MINIMUM SOIL VOLUME AREA
- PROPOSED DECIDUOUS TREE
- PROPOSED ORNAMENTAL GRASSES
- PROPOSED SOD
- PROPOSED RIVERSTONE MULCH
- PROPOSED PAVERS OR INTERLOCK
- PROPOSED 1.5m Ht. WOOD SCREEN FENCE
- TREE PROTECTION FENCE

5			
4			
3			
2			
1	ISSUED FOR SITE PLAN CONTROL	06/05/2024	ML, JL
No.	Issue	Date	DR. CK

**JAMES B. LENNOX & ASSOCIATES INC.**  
LANDSCAPE ARCHITECTS  
3332 CARLETON AVE. OTTAWA, ONTARIO K2H 5A8  
Tel: (613) 722-5168 Fax: (866) 343-3942

PROJECT  
**PROPOSED THREE STOREY APARTMENT**  
10 GARRISON STREET, OTTAWA ON

DRAWING  
**TREE CONSERVATION REPORT & LANDSCAPE PLAN**

STAMP  
**ASSOCIATION OF LANDSCAPE ARCHITECTS**  
MEMBER

SCALE  
AS SHOWN

START DATE  
APRIL 2024

PROJECT NO.

PROJECT NORTH

DRAWING NO.  
**L.1**

PLOT SIZE ARCH-D