

CAIVAN
ORLEANS VILLAGE PHASE 4

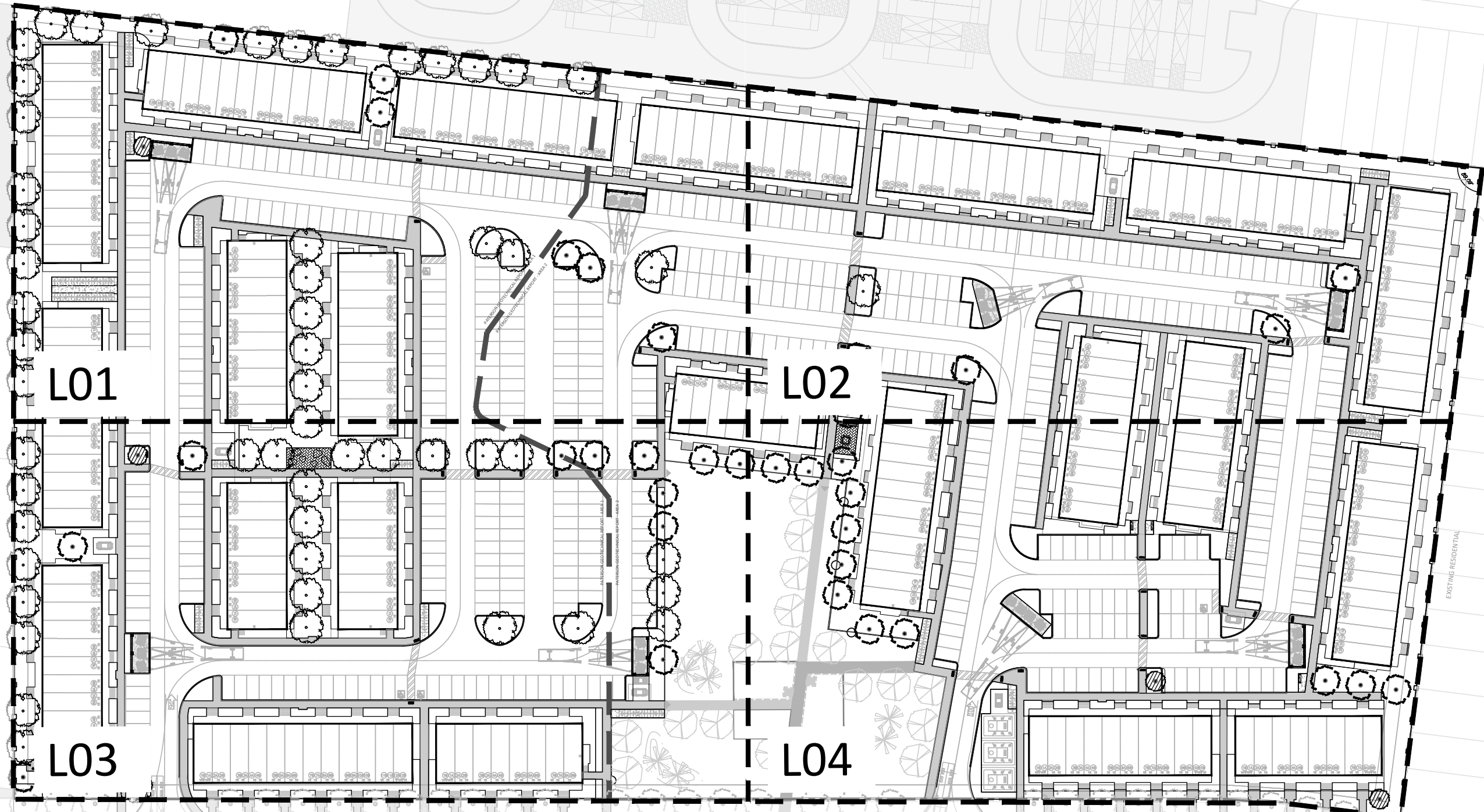

LIST OF DRAWINGS:

- L01 - LANDSCAPE PLAN
- L02 - LANDSCAPE PLAN
- L03 - LANDSCAPE PLAN
- L04 - LANDSCAPE PLAN
- L05 - LANDSCAPE DETAILS
- L06 - LANDSCAPE DETAILS
- L07 - LANDSCAPE DETAILS



AVENUE DELAMARCHE AVENUE

COURS CREVIER WALK

PROPERTY INFORMATION
PIN 04404-1854 (LT), 04404-1880 (LT), 04404-1882 (LT)
and Part of PIN 04404-1855 (LT), being Blocks 147, 173,
175 and Part of Block 148, Registered Plan 4M-1629

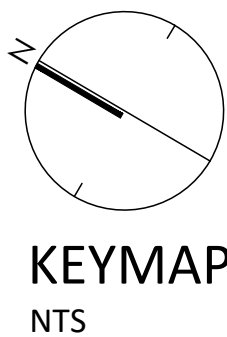

KEYMAP
NTS

PLANT LIST						
KEY	BOTANICAL NAME	COMMON NAME	QTY.	SIZE	REMARKS	OWNER
DECIDUOUS TREES - LARGE (15-30M HEIGHT): TOTAL 56 (PRIVATELY OWNED)						
AR	ACER RUBRUM	RED MAPLE	9	50mm	B&B	Y PRIVATE
CC	CARYA CORDIFORMIS	BITTERNUT HICKORY	8	50mm	B&B	Y PRIVATE
GD	GYMNOCLADUS DIOICUS	KENTUCKY COFFEE TREE	7	50mm	B&B	Y PRIVATE
GT	GLEDTISIA TRICANTHOS VAR. INERMIS 'HALKA'	HALKA HONEY LOCUST	2	50mm	B&B	Y PRIVATE
LT	LIRIODENDRON TULIPIFERA	TULIP TREE	7	50mm	B&B	Y PRIVATE
PO	PLATANUS OCCIDENTALIS	AMERICAN SYCAMORE	8	50mm	B&B	Y PRIVATE
QP	QUERCUS PALUSTRIS	PIN OAK	4	50mm	B&B	Y PRIVATE
QR	QUERCUS RUBRA	RED OAK	6	50mm	B&B	Y PRIVATE
UA	ULMUS AMERICANA	VALLEY FORGE ELM	5	50mm	B&B	Y PRIVATE
DECIDUOUS TREES - MEDIUM (8-14M HEIGHT): TOTAL 34 (PRIVATELY OWNED)						
AG	AESCULUS GLABRA	OHIO BUCKEYE	8	50mm	B&B	Y PRIVATE
ARR	ACER RUBRUM 'REDPOINTE'	REDPOINTE RED MAPLE	2	50mm	B&B	Y PRIVATE
BL	BETULA LENTA	CHERRY BIRCH	7	50mm	B&B	Y PRIVATE
CCA	CARPINUS CAROLINIANA	BLUE BEECH	3	50mm	B&B	Y PRIVATE

OV	OSTRYA VIRGINIANA	IRONWOOD	8	50mm	B&B	Y	PRIVATE
QO	QUERCUA PRINUS	CHESTNUT OAK	6	50mm	B&B	Y	PRIVATE
DECIDUOUS TREES - SMALL (6-8M HEIGHT): TOTAL 4 (PRIVATELY OWNED)							
CCI	CRATAEGUS CRUGSALI 'INERMIS'	THORNLESS HAWTHORN	4	250cm 15 GAL	PT, TREE FORM	Y	PRIVATE
MULTI-STEM SHRUBS: TOTAL 110 (PRIVATELY OWNED)							
Ac	AMELANCHIER CANADENSIS	SERVICEBERRY	18	125cm ht.	PT, CLUMP	Y	PRIVATE
Al	AMELANCHIER LAEVIS	ALLEGHENY SERVICEBERRY	19	125cm ht.	PT, CLUMP	Y	PRIVATE
Ca	CORNUS ALTERNIFOLIA	PAGODA DOGWOOD	19	125cm ht.	PT, CLUMP	Y	PRIVATE
Hv	HAMAMELIS VIRGINIANA	WITCHHAZEL	19	125cm ht.	PT, CLUMP	Y	PRIVATE
Vd	VIBURNUM DENTATUM	ARROWOOD VIBURNUM	17	125cm ht.	PT, CLUMP	Y	PRIVATE
VI	VIBURNUM LENTAGO	NANNYBERRY	18	125cm ht.	PT, CLUMP	Y	PRIVATE
CONIFEROUS SHRUBS: TOTAL 100 (PRIVATELY OWNED)							
Js	JUNIPERUS SCOPULORUM 'WICHITA BLUE'	WITCHITA BLUE JUNIPER	35	3 GAL	POT	Y	PRIVATE
Tc	TAXUS CANADENSIS	CANADIAN YEW	65	3 GAL	POT	Y	PRIVATE
DECIDUOUS SHRUBS : TOTAL 578 (PRIVATELY OWNED)							
Am	ARONIA MELANOCARPA	BLACK CHOKEBERRY	282	3 GAL	POT	Y	PRIVATE
Sa	SYMPHORICARPOS ALBUS	SNOWBERRY	161	3 GAL	POT	Y	PRIVATE

Po	PHYSOCARPUS OPLULIFOLIUS 'DIABOLO'	'DIABOLO' NINEBARK	135	3 GAL	POT	Y	PRIVATE
ORNAMENTAL GRASSES: TOTAL 1475 (PRIVATELY OWNED)							
cl	CHASMANTHIUM LATIFOLIUM	NORTHERN SEA OATS	395	7 GAL	POT	Y	PRIVATE
dc	DESCHAMPSIA CESPITOSA	TUFTED HAIR GRASS	314	7 GAL	POT	Y	PRIVATE
bg	BOUTELOUA GRACILIS	BLUE GRAMA	195	7 GAL	POT	Y	PRIVATE
sh	SPOROBOLUS HETEROLEPSIS	PRARIE DROPSEED	375	7 GAL	POT	Y	PRIVATE
ss	SCHIZACHYRIUM SCOPARIUM	LITTLE BLUESTEM	196	7 GAL	POT	Y	PRIVATE

GENERAL NOTES:

- ALL PLANT MATERIAL SHALL BE NURSERY GROWN STOCK UNLESS OTHERWISE NOTED.
- TREES TO HAVE A MINIMUM 1800 CLEAR STEM ABOVE GRADE.
- CONTRACTOR TO MAKE GOOD ALL EXISTING AREAS DAMAGED BY HIS WORK TO THE SATISFACTION OF THE CONTRACTOR.
- ALL PLANT MATERIAL SHALL BE WARRANTIED FOR TWO YEARS FROM THE DATE OF SUBSTANTIAL COMPLETION.
- CONTRACTOR TO VERIFY LOCATION OF ALL SERVICES PRIOR TO ANY EXCAVATION.
- ANY PROPOSED SUBSTITUTIONS OF PLANT SPECIES SHALL BE MADE WITH PLANTS OF EQUIVALENT OVERALL FORM, HEIGHT, BRANCHING HABIT, FLOWER, LEAF, COLOR, FRUIT AND CULTURE AND ONLY AFTER APPROVAL OF THE LANDSCAPE ARCHITECT.

TREE PLANTING IN MARINE CLAY SOILS

THE LANDSCAPE CONSIDERATIONS CONTAINED WITHIN SEC. 6.8 OF PATERSON GROUP'S GEOTECHNICAL INVESTIGATION, DATED AUGUST 26, 2024.

- THIS LANDSCAPE PLAN CONFORMS WITH THE TREE-TO-FOUNDATION SETBACK, SOIL VOLUME, AND SURFACE-GRADING REQUIREMENTS OUTLINED IN THE CITY OF OTTAWA'S GUIDELINES FOR TREE PLANTING IN SENSITIVE MARINE CLAY SOILS (2017), BASED ON THE FINDINGS OUTLINED IN THE PROJECT GEOTECHNICAL REPORT BY PATERSON GROUP (REPORT PG6152-1 REV 3 DATED AUGUST, 2024).
- ADDITIONAL REQUIREMENTS OUTLINED IN THE CITY OF OTTAWA'S GUIDELINES FOR TREE PLANTING IN SENSITIVE MARINE CLAY SOILS (2017), INCLUDING USE DEPTH, FOUNDATION WALL REINFORCEMENT, AND SUBDIVISION GRADING, SHOULD BE CONFIRMED BY THE PROJECT ENGINEER(S).

TREE SOIL VOLUMES			
TREE TYPE/SIZE	SINGLE TREE SOIL VOLUME	MULTIPLE TREE SOIL VOLUME (m3/TREE)	SOIL VOLUME FOR MARINE CLAY AREAS (SINGLE TREE)
ORNAMENTAL	15	9	
COLUMNAR	15	9	
SMALL	20	12	25
MEDIUM	25	15	30
LARGE	30	18	
CONIFER	25	15	

		SINGLE	MULTIPLE	CLAY SOILS
SMALL				
MEDIUM/ CONIFER				
LARGE				

*SOIL VOLUME CALCULATION BASED ON 1.0m DEPTH

PROPOSED TREE CANOPY PROJECTIONS			
TREE TYPE/SIZE	CROWN AREA PER TREE STANDARD RANGE (m²)	CROWN AREA PER TREE USED FOR CALC. (m²)	SITE CANOPY COVER
LARGE (56)	135-250*	192	CANOPY (W. OVERLAP): 7,060m²
MEDIUM (34)	35-135*	85	
SMALL (4)	5-35*	20	

PROPOSED STREET TREE PROJECTED CANOPY	
PROPOSED STREET TREE CANOPY (BY OTHERS), m² CALCULATION BASED ON PROPOSED TREE SPECIES PROJECTIONS	CANOPY (W. OVERLAP): 610m²

*RANGE OF CROWN AREAS IS IN ACCORDANCE WITH PROPOSED TREES SPECIES	SITE: 40,717m²
**CROWN AREAS ARE ACCORDING TO THE AVERAGE MATURE CANOPY SIZE OF THE RESPECTIVE SPECIES. CANOPY SIZING HAS BEEN DETERMINED IN REFERENCE TO VARIOUS ARBORICULTURAL AND BOTANICAL SOURCES, SUCH AS: ONTARIO MINISTRY OF NATURAL RESOURCES & FORESTRY (OMNRF); US FOREST SERVICE: FARRAR, J.L. TREES IN CANADA, UNIVERSITY OF GUELPH ARBORETUM, VARIOUS PUBLICATIONS	TOTAL PERCENT COVER: 18.84%
***NOTE: SITE AREA AND TREE COUNTS DO NOT INCLUDE PARK BLOCK.	

Contractor shall check all dimensions on the work and report any discrepancy to the Landscape Architect before proceeding. All drawings and specifications are the property of the Landscape Architect and must be returned at the completion of the work. This drawing is not to be used for construction until signed by the Landscape Architect.

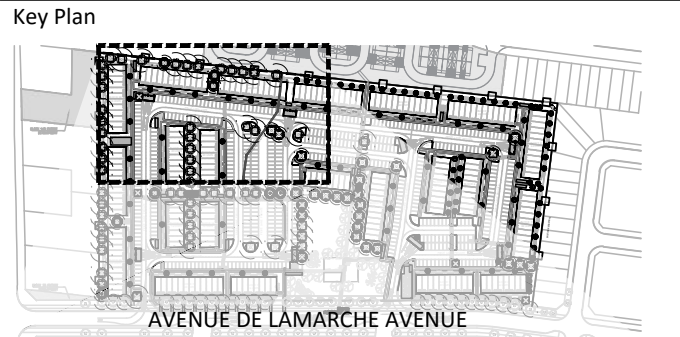

LEGEND	
--- --	PROPERTY LINE
- - - -	GEOTECHNICAL FOUNDATION SETBACK (4.5m)
FENCING	
—●—●—●—●—	WASTE ENCLOSURE FENCE
—○—○—○—○—	WOOD PRIVACY FENCE
PLANTING	
	LARGE DECIDUOUS TREE
	MEDIUM DECIDUOUS TREE
	SMALL DECIDUOUS TREE
	TREE CANOPY PROJECTION
	TREE FORM SHRUB
	DECIDUOUS/CONIFEROUS SHRUBS
	GRASSES/PERENNIALS
	SODDING

PAVING	
	ASPHALT PAVING
	CIP CONCRETE PAVING
	HEAVY DUTY CONCRETE PAVING
	RIVERSTONE PAVING
	UNIT PAVING
PLANTING KEY	
	TREE SPECIES QUANTITY
	SHRUB SPECIES QUANTITY
DETAIL KEY	
	DETAIL NO. 1
	SHEET NO. 1

-		
-		
-		
4	Issued for Second Submission	Apr.01/25
3	Issued for Revised First Submission	Dec.17/24
2	Issued for Revised First Submission	Nov.04/24
1	Issued for First Submission	Sept.03/24
No.	Description	Date

Revision	
City Approval Stamp	

PROPERTY INFORMATION
PIN 04404-1854 (LT), 04404-1880 (LT), 04404-1882 (LT) and Part of PIN 04404-1855 (LT), being Blocks 147, 173, 175 and Part of Block 148, Registered Plan 4M-1629

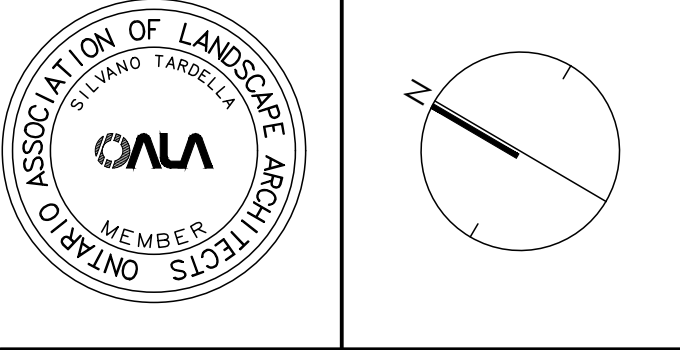

NAK
design strategies

1285 WELLINGTON STREET, OTTAWA, ON K1Y 3A8 CANADA
T 613.237.2345
Project

NAKDESIGNSTRATEGIES.COM

ORLEANS VILLAGE PHASE 4
OTTAWA, ON

Title	LANDSCAPE PLAN
Date	2024-08-12
Scale	1:250
Drawn	SW
Checked	SC
Job No.	22-145
L01	

PLANT LIST						
KEY	BOTANICAL NAME	COMMON NAME	QTY.	SIZE	REMARKS	OWNER
DECIDUOUS TREES - LARGE (15-30M HEIGHT): TOTAL 56 (PRIVATELY OWNED)						
AR	ACER RUBRUM	RED MAPLE	9	50mm	B&B	Y PRIVATE
CC	CARYA CORDIFORMIS	BITTERNUT HICKORY	8	50mm	B&B	Y PRIVATE
GD	GYMNOCLADUS DIOICUS	KENTUCKY COFFEE TREE	7	50mm	B&B	Y PRIVATE
GT	GLEDTISIA TRICANTHOS VAR. INERMIS 'HALKA'	HALKA HONEY LOCUST	2	50mm	B&B	Y PRIVATE
LT	LIRIODENDRON TULIPIFERA	TULIP TREE	7	50mm	B&B	Y PRIVATE
PO	PLATANUS OCCIDENTALIS	AMERICAN SYCAMORE	8	50mm	B&B	Y PRIVATE
QP	QUERCUS PALUSTRIS	PIN OAK	4	50mm	B&B	Y PRIVATE
QR	QUERCUS RUBRA	RED OAK	6	50mm	B&B	Y PRIVATE
UA	ULMUS AMERICANA	VALLEY FORGE ELM	5	50mm	B&B	Y PRIVATE
DECIDUOUS TREES - MEDIUM (8-14M HEIGHT): TOTAL 34 (PRIVATELY OWNED)						
AG	AESCULUS GLABRA	OHIO BUCKEYE	8	50mm	B&B	Y PRIVATE
ARR	ACER RUBRUM 'REDPOINTE'	REDPOINTE RED MAPLE	2	50mm	B&B	Y PRIVATE
BL	BETULA LENTA	CHERRY BIRCH	7	50mm	B&B	Y PRIVATE
CCA	CARPINUS CAROLINIANA	BLUE BEECH	3	50mm	B&B	Y PRIVATE

QV	OSTRYA VIRGINIANA	IRONWOOD	8	50mm	B&B	Y	PRIVATE
QO	QUERCUA PRINUS	CHESTNUT OAK	6	50mm	B&B	Y	PRIVATE
DECIDUOUS TREES - SMALL (6-8M HEIGHT): TOTAL 4 (PRIVATELY OWNED)							
CCI	CRATAEGUS CRUGSALI 'INERMIS'	THORNLESS HAWTHORN	4	250cm 15 GAL	PT, TREE FORM	Y	PRIVATE
MULTI-STEM SHRUBS: TOTAL 110 (PRIVATELY OWNED)							
Ac	AMELANCHIER CANADENSIS	SERVICEBERRY	18	125cm ht.	PT, CLUMP	Y	PRIVATE
Al	AMELANCHIER LAEVIS	ALLEGHENY SERVICEBERRY	19	125cm ht.	PT, CLUMP	Y	PRIVATE
Ca	CORNUS ALTERNIFOLIA	PAGODA DOGWOOD	19	125cm ht.	PT, CLUMP	Y	PRIVATE
Hv	HAMAMELIS VIRGINIANA	WITCHHAZEL	19	125cm ht.	PT, CLUMP	Y	PRIVATE
Vd	VIBURNUM DENTATUM	ARROWOOD VIBURNUM	17	125cm ht.	PT, CLUMP	Y	PRIVATE
VI	VIBURNUM LENTAGO	NANNYBERRY	18	125cm ht.	PT, CLUMP	Y	PRIVATE
CONIFEROUS SHRUBS: TOTAL 100 (PRIVATELY OWNED)							
Js	JUNIPERUS SCOPULORUM 'WICHITA BLUE'	WITCHITA BLUE JUNIPER	35	3 GAL	POT	Y	PRIVATE
Tc	TAXUS CANADENSIS	CANADIAN YEW	65	3 GAL	POT	Y	PRIVATE
DECIDUOUS SHRUBS : TOTAL 578 (PRIVATELY OWNED)							
Am	ARONIA MELANOCARPA	BLACK CHOKEBERRY	282	3 GAL	POT	Y	PRIVATE
Sa	SYMPHORICARPOS ALBUS	SNOWBERRY	161	3 GAL	POT	Y	PRIVATE

Po	PHYSOCARPUS OPULIFOLIUS 'DIABOLO'	'DIABOLO' NINEBARK	135	3 GAL	POT	Y	PRIVATE
ORNAMENTAL GRASSES: TOTAL 1475 (PRIVATELY OWNED)							
cl	CHASMANTHIUM LATIFOLIUM	NORTHERN SEA OATS	395	7 GAL	POT	Y	PRIVATE
dc	DESCHAMPSIA CESPITOSA	TUFTED HAIR GRASS	314	7 GAL	POT	Y	PRIVATE
bg	BOUTELOUA GRACILIS	BLUE GRAMA	195	7 GAL	POT	Y	PRIVATE
sh	SPOROBOLUS HETEROLEPSIS	PRARIE DROPSEED	375	7 GAL	POT	Y	PRIVATE
ss	SCHIZACHYRIUM SCOPARIUM	LITTLE BLUESTEM	196	7 GAL	POT	Y	PRIVATE

GENERAL NOTES:

- ALL PLANT MATERIAL SHALL BE NURSERY GROWN STOCK UNLESS OTHERWISE NOTED.
- TREES TO HAVE A MINIMUM 1800 CLEAR STEM ABOVE GRADE.
- CONTRACTOR TO MAKE GOOD ALL EXISTING AREAS DAMAGED BY HIS WORK TO THE SATISFACTION OF THE CONTRACTOR.
- ALL PLANT MATERIAL SHALL BE WARRANTIED FOR TWO YEARS FROM THE DATE OF SUBSTANTIAL COMPLETION.
- CONTRACTOR TO VERIFY LOCATION OF ALL SERVICES PRIOR TO ANY EXCAVATION.
- ANY PROPOSED SUBSTITUTIONS OF PLANT SPECIES SHALL BE MADE WITH PLANTS OF EQUIVALENT OVERALL FORM, HEIGHT, BRANCHING HABIT, FLOWER, LEAF, COLOR, FRUIT AND CULTURE AND ONLY AFTER APPROVAL OF THE LANDSCAPE ARCHITECT.

TREE PLANTING IN MARINE CLAY SOILS

THE LANDSCAPE CONSIDERATIONS CONTAINED WITHIN SEC. 6.8 OF PATERSON GROUP'S GEOTECHNICAL INVESTIGATION, DATED AUGUST 26, 2024.

- THIS LANDSCAPE PLAN CONFORMS WITH THE TREE-TO-FOUNDATION SETBACK, SOIL VOLUME, AND SURFACE-GRADING REQUIREMENTS OUTLINED IN THE CITY OF OTTAWA'S GUIDELINES FOR TREE PLANTING IN SENSITIVE MARINE CLAY SOILS (2017), BASED ON THE FINDINGS OUTLINED IN THE PROJECT GEOTECHNICAL REPORT BY PATERSON GROUP (REPORT PG6152-1 REV 3 DATED AUGUST, 2024).
- ADDITIONAL REQUIREMENTS OUTLINED IN THE CITY OF OTTAWA'S GUIDELINES FOR TREE PLANTING IN SENSITIVE MARINE CLAY SOILS (2017), INCLUDING USF DEPTH, FOUNDATION WALL REINFORCEMENT, AND SUBDIVISION GRADING, SHOULD BE CONFIRMED BY THE PROJECT ENGINEER(S).

TREE SOIL VOLUMES			
TREE TYPE/SIZE	SINGLE TREE SOIL VOLUME	MULTIPLE TREE SOIL VOLUME (m3/TREE)	SOIL VOLUME FOR MARINE CLAY AREAS (SINGLE TREE)
ORNAMENTAL	15	9	
COLUMNAR	15	9	
SMALL	20	12	25
MEDIUM	25	15	30
LARGE	30	18	
CONIFER	25	15	

TREE SOIL VOLUMES			
TREE TYPE/SIZE	SINGLE TREE SOIL VOLUME	MULTIPLE TREE SOIL VOLUME (m3/TREE)	SOIL VOLUME FOR MARINE CLAY AREAS (SINGLE TREE)
ORNAMENTAL	15	9	
COLUMNAR	15	9	
SMALL	20	12	25
MEDIUM	25	15	30
LARGE	30	18	
CONIFER	25	15	

	SINGLE	MULTIPLE	CLAY SOILS
SMALL			
MEDIUM/ CONIFER			
LARGE			

*SOIL VOLUME CALCULATION BASED ON 1.0m DEPTH

PROPOSED TREE CANOPY PROJECTIONS			
TREE TYPE/SIZE	CROWN AREA PER TREE STANDARD RANGE (m²)	CROWN AREA PER TREE USED FOR CALC. (m²)	SITE CANOPY COVER
LARGE (56)	135-250*	192	CANOPY (W. OVERLAP): 7,060m²
MEDIUM (34)	35-135*	85	
SMALL (4)	5-35*	20	
PROPOSED STREET TREE PROJECTED CANOPY			CANOPY (W. OVERLAP): 610m²
PROPOSED STREET TREE CANOPY (BY OTHERS), m² CALCULATION BASED ON PROPOSED TREE SPECIES PROJECTIONS			
*RANGE OF CROWN AREAS IS IN ACCORDANCE WITH PROPOSED TREES SPECIES			SITE: 40,717m²
**CROWN AREAS ARE ACCORDING TO THE AVERAGE MATURE CANOPY SIZE OF THE RESPECTIVE SPECIES. CANOPY SIZING HAS BEEN DETERMINED IN REFERENCE TO VARIOUS ARBORICULTURAL AND BOTANICAL SOURCES, SUCH AS: ONTARIO MINISTRY OF NATURAL RESOURCES & FORESTRY (OMNRF); US FOREST SERVICE: FARRAR, J.L. TREES IN CANADA, UNIVERSITY OF GUELPH ARBORETUM, VARIOUS PUBLICATIONS			TOTAL PERCENT COVER: 18.84%
***NOTE: SITE AREA AND TREE COUNTS DO NOT INCLUDE PARK BLOCK.			

Contractor shall check all dimensions on the work and report any discrepancy to the Landscape Architect before proceeding. All drawings and specifications are the property of the Landscape Architect and must be returned at the completion of the work. This drawing is not to be used for construction until signed by the Landscape Architect.

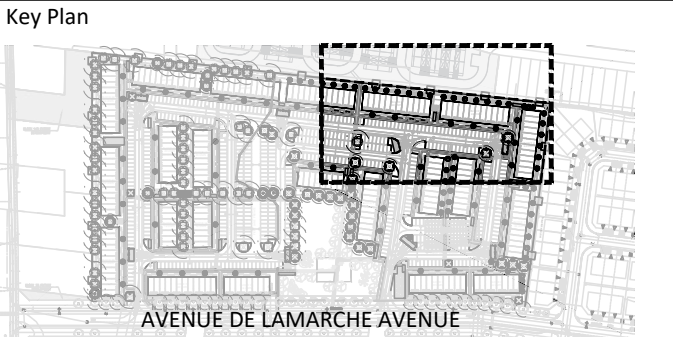

LEGEND

--- PROPERTY LINE
--- GEOTECHNICAL FOUNDATION SETBACK (4.5m)
FENCING
--- WASTE ENCLOSURE FENCE
--- WOOD PRIVACY FENCE
PLANTING
● LARGE DECIDUOUS TREE
● MEDIUM DECIDUOUS TREE
● SMALL DECIDUOUS TREE
○ TREE CANOPY PROJECTION
○ TREE FORM SHRUB
⊗ DECIDUOUS/CONIFEROUS SHRUBS
⊗ GRASSES/PERENNIALS
■ SODDING
PAVING
■ ASPHALT PAVING
■ CIP CONCRETE PAVING
■ HEAVY DUTY CONCRETE PAVING
■ RIVERSTONE PAVING
■ UNIT PAVING
PLANTING KEY
XX-00 TREE SPECIES QUANTITY
XX-00 SHRUB SPECIES QUANTITY
DETAIL KEY
1- L1 DETAIL NO. SHEET NO.

No.	Description	Date
4	Issued for Second Submission	Apr.01/25
3	Issued for Revised First Submission	Dec.17/24
2	Issued for Revised First Submission	Nov.04/24
1	Issued for First Submission	Sept.03/24
Revision		
City Approval Stamp		

PROPERTY INFORMATION
PIN 04404-1854 (LT), 04404-1880 (LT), 04404-1882 (LT) and Part of PIN 04404-1855 (LT), being Blocks 147, 173, 175 and Part of Block 148, Registered Plan 4M-1629

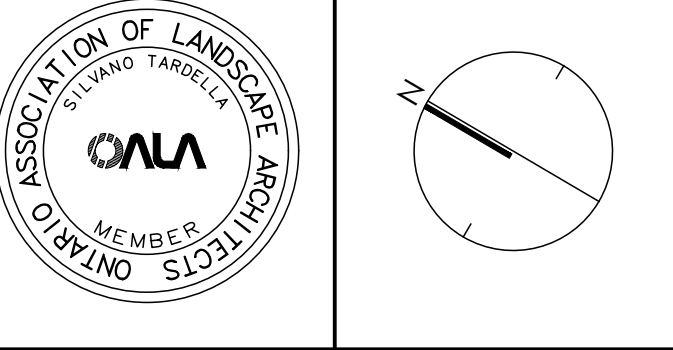

NAK design strategies
1285 WELLINGTON STREET, OTTAWA, ON K1Y 3A8 CANADA
T 416.237.2345
Project

ORLEANS VILLAGE PHASE 4
OTTAWA, ON

Title	LANDSCAPE PLAN
Date	2024-08-12
Scale	1:250
Drawn	SW
Checked	SC
Job No.	22-145
L02	

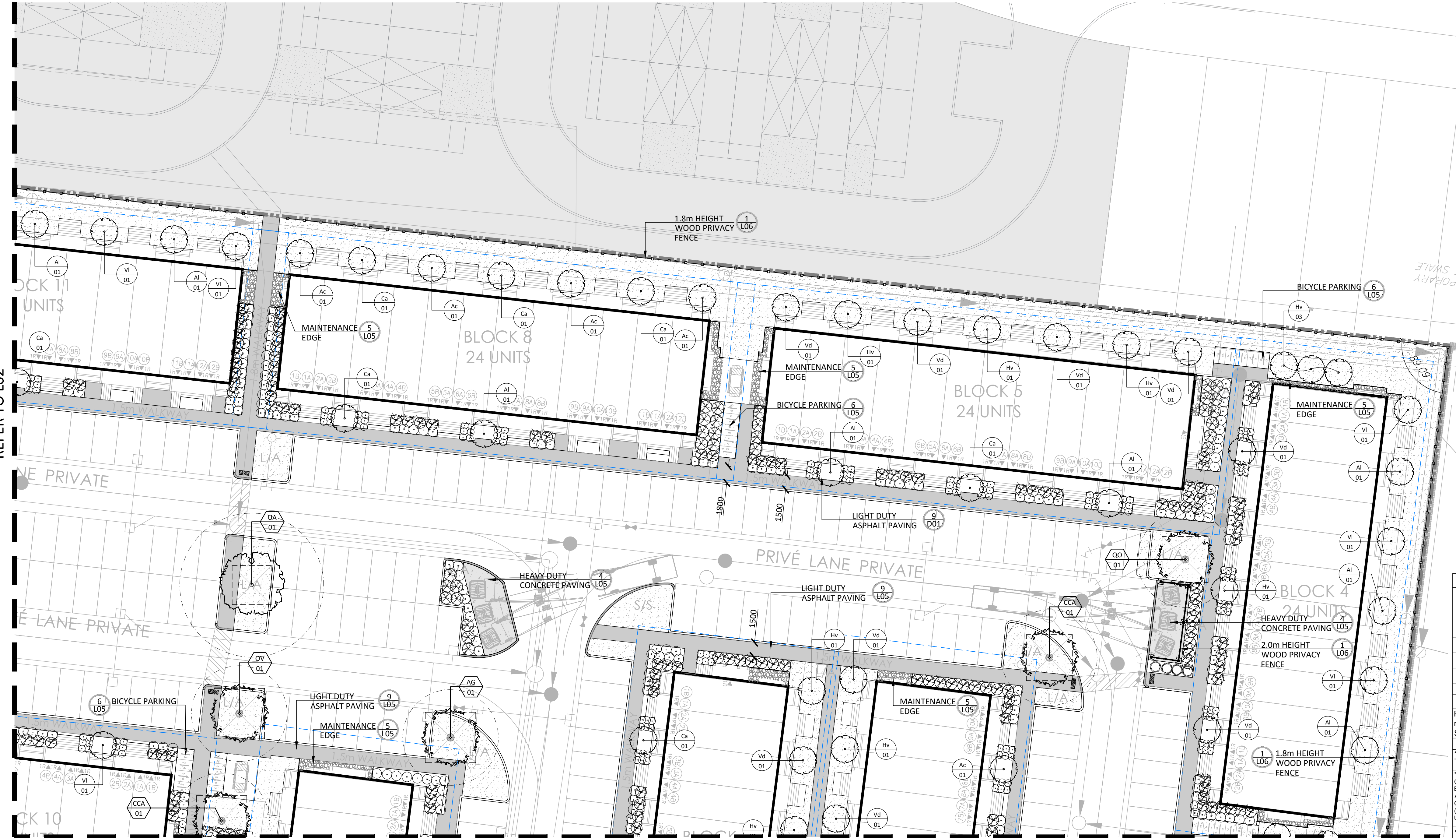

PLANT LIST						
KEY	BOTANICAL NAME	COMMON NAME	QTY.	SIZE	REMARKS	OWNER
DECIDUOUS TREES - LARGE (15-30M HEIGHT): TOTAL 56 (PRIVATELY OWNED)						
AR	ACER RUBRUM	RED MAPLE	9	50mm	B&B	Y PRIVATE
CC	CARYA CORDIFORMIS	BITTERNUT HICKORY	8	50mm	B&B	Y PRIVATE
GD	GYMNOCLADUS DIOICUS	KENTUCKY COFFEE TREE	7	50mm	B&B	Y PRIVATE
GT	GLEDTISIA TRICANTHOS VAR. INERMIS 'HALKA'	HALKA HONEY LOCUST	2	50mm	B&B	Y PRIVATE
LT	LIRIODENDRON TULIPIFERA	TULIP TREE	7	50mm	B&B	Y PRIVATE
PO	PLATANUS OCCIDENTALIS	AMERICAN SYCAMORE	8	50mm	B&B	Y PRIVATE
QP	QUERCUS PALUSTRIS	PIN OAK	4	50mm	B&B	Y PRIVATE
QR	QUERCUS RUBRA	RED OAK	6	50mm	B&B	Y PRIVATE
UA	ULMUS AMERICANA	VALLEY FORGE ELM	5	50mm	B&B	Y PRIVATE
DECIDUOUS TREES - MEDIUM (8-14M HEIGHT): TOTAL 34 (PRIVATELY OWNED)						
AG	AESCULUS GLABRA	OHIO BUCKEYE	8	50mm	B&B	Y PRIVATE
ARR	ACER RUBRUM 'REDPOINTE'	REDPOINTE RED MAPLE	2	50mm	B&B	Y PRIVATE
BL	BETULA LENTA	CHERRY BIRCH	7	50mm	B&B	Y PRIVATE
CCA	CARPINUS CAROLINIANA	BLUE BEECH	3	50mm	B&B	Y PRIVATE

OV	Ostrya virginiana	IRONWOOD	8	50mm	B&B	Y	PRIVATE
QO	Quercus prinus	CHESTNUT OAK	6	50mm	B&B	Y	PRIVATE
DECIDUOUS TREES - SMALL (6-8M HEIGHT): TOTAL 4 (PRIVATELY OWNED)							
CCI	Crataegus crusgali 'inermis'	THORNLESS HAWTHORN	4	250cm 15 GAL	PT, TREE FORM	Y	PRIVATE
MULTI-STEM SHRUBS: TOTAL 110 (PRIVATELY OWNED)							
Ac	Amelanchier canadensis	SERVICEBERRY	18	125cm ht.	PT, CLUMP	Y	PRIVATE
Al	Amelanchier laevis	ALLEGHENY SERVICEBERRY	19	125cm ht.	PT, CLUMP	Y	PRIVATE
Ca	Cornus alternifolia	PAGODA DOGWOOD	19	125cm ht.	PT, CLUMP	Y	PRIVATE
Hv	Hamamelis virginiana	WITCHHAZEL	19	125cm ht.	PT, CLUMP	Y	PRIVATE
Vd	Viburnum dentatum	ARROWOOD VIBURNUM	17	125cm ht.	PT, CLUMP	Y	PRIVATE
Vi	Viburnum lentago	NANNYBERRY	18	125cm ht.	PT, CLUMP	Y	PRIVATE
CONIFEROUS SHRUBS: TOTAL 100 (PRIVATELY OWNED)							
Js	Juniperus scopulorum 'Wichita Blue'	WITCHITA BLUE JUNIPER	35	3 GAL	POT	Y	PRIVATE
Tc	Taxus canadensis	CANADIAN YEW	65	3 GAL	POT	Y	PRIVATE
DECIDUOUS SHRUBS : TOTAL 578 (PRIVATELY OWNED)							
Am	Aronia melanocarpa	BLACK CHOKEBERRY	282	3 GAL	POT	Y	PRIVATE
Sa	Symphoricarpos albus	SNOWBERRY	161	3 GAL	POT	Y	PRIVATE

Po	Physocarpus opulifolius 'Diabolo'	'DIABOLO' NINEBARK	135	3 GAL	POT	Y	PRIVATE
ORNAMENTAL GRASSES: TOTAL 1475 (PRIVATELY OWNED)							
cl	Chasmanthium latifolium	NORTHERN SEA OATS	395	7 GAL	POT	Y	PRIVATE
dc	Deschampsia cespitosa	TUFTED HAIR GRASS	314	7 GAL	POT	Y	PRIVATE
bg	Bouteloua gracilis	BLUE GRAMA	195	7 GAL	POT	Y	PRIVATE
sh	Sporobolus heterolepis	PRARIE DROPSEED	375	7 GAL	POT	Y	PRIVATE
ss	Schizachyrium scoparium	LITTLE BLUESTEM	196	7 GAL	POT	Y	PRIVATE

GENERAL NOTES:

- ALL PLANT MATERIAL SHALL BE NURSERY GROWN STOCK UNLESS OTHERWISE NOTED.
- TREES TO HAVE A MINIMUM 1800 CLEAR STEM ABOVE GRADE.
- CONTRACTOR TO MAKE GOOD ALL EXISTING AREAS DAMAGED BY HIS WORK TO THE SATISFACTION OF THE CONTRACTOR.
- ALL PLANT MATERIAL SHALL BE WARRANTIED FOR TWO YEARS FROM THE DATE OF SUBSTANTIAL COMPLETION.
- CONTRACTOR TO VERIFY LOCATION OF ALL SERVICES PRIOR TO ANY EXCAVATION.
- ANY PROPOSED SUBSTITUTIONS OF PLANT SPECIES SHALL BE MADE WITH PLANTS OF EQUIVALENT OVERALL FORM, HEIGHT, BRANCHING HABIT, FLOWER, LEAF, COLOR, FRUIT AND CULTURE AND ONLY AFTER APPROVAL OF THE LANDSCAPE ARCHITECT.

TREE PLANTING IN MARINE CLAY SOILS

THE LANDSCAPE CONSIDERATIONS CONTAINED WITHIN SEC. 6.8 OF PATERSON GROUP'S GEOTECHNICAL INVESTIGATION, DATED AUGUST 26, 2024.

- THIS LANDSCAPE PLAN CONFORMS WITH THE TREE-TO-FOUNDATION SETBACK, SOIL VOLUME, AND SURFACE-GRADING REQUIREMENTS OUTLINED IN THE CITY OF OTTAWA'S GUIDELINES FOR TREE PLANTING IN SENSITIVE MARINE CLAY SOILS (2017), BASED ON THE FINDINGS OUTLINED IN THE PROJECT GEOTECHNICAL REPORT BY PATERSON GROUP (REPORT PG6152-1 REV 3 DATED AUGUST, 2024).
- ADDITIONAL REQUIREMENTS OUTLINED IN THE CITY OF OTTAWA'S GUIDELINES FOR TREE PLANTING IN SENSITIVE MARINE CLAY SOILS (2017), INCLUDING USF DEPTH, FOUNDATION WALL REINFORCEMENT, AND SUBDIVISION GRADING, SHOULD BE CONFIRMED BY THE PROJECT ENGINEER(S).

TREE SOIL VOLUMES			
TREE TYPE/SIZE	SINGLE TREE SOIL VOLUME	MULTIPLE TREE SOIL VOLUME (m3/TREE)	SOIL VOLUME FOR MARINE CLAY AREAS (SINGLE TREE)
ORNAMENTAL	15	9	
COLUMNAR	15	9	
SMALL	20	12	25
MEDIUM	25	15	30
LARGE	30	18	
CONIFER	25	15	

	SINGLE	MULTIPLE	CLAY SOILS
SMALL			
MEDIUM/ CONIFER			
LARGE			

*SOIL VOLUME CALCULATION BASED ON 1.0m DEPTH

PROPOSED TREE CANOPY PROJECTIONS			
TREE TYPE/SIZE	CROWN AREA PER TREE STANDARD RANGE (m²)	CROWN AREA PER TREE USED FOR CALC. (m²)	SITE CANOPY COVER
LARGE (56)	135-250*	192	CANOPY (W. OVERLAP): 7,060m²
MEDIUM (34)	35-135*	85	
SMALL (4)	5-35*	20	

PROPOSED STREET TREE PROJECTED CANOPY		CANOPY (W. OVERLAP): 610m²
PROPOSED STREET TREE CANOPY (BY OTHERS), m² CALCULATION BASED ON PROPOSED TREE SPECIES PROJECTIONS		
**CROWN AREAS ARE ACCORDING TO THE AVERAGE MATURE CANOPY SIZE OF THE RESPECTIVE SPECIES. CANOPY SIZING HAS BEEN DETERMINED IN REFERENCE TO VARIOUS ARBORICULTURAL AND BOTANICAL SOURCES, SUCH AS: ONTARIO MINISTRY OF NATURAL RESOURCES & FORESTRY (OMNRF); US FOREST SERVICE: FARRAR, J.L. TREES IN CANADA, UNIVERSITY OF GUELPH ARBORETUM, VARIOUS PUBLICATIONS		
***NOTE: SITE AREA AND TREE COUNTS DO NOT INCLUDE PARK BLOCK.		

Contractor shall check all dimensions on the work and report any discrepancy to the Landscape Architect before proceeding. All drawings and specifications are the property of the Landscape Architect and must be returned at the completion of the work. This drawing is not to be used for construction until signed by the Landscape Architect.

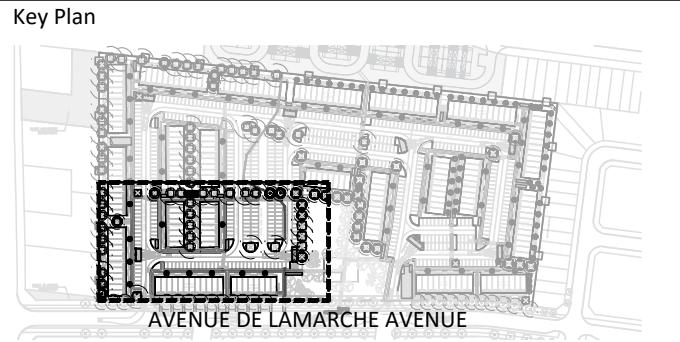

LEGEND

--- PROPERTY LINE
--- GEOTECHNICAL FOUNDATION SETBACK (4.5m)

FENCING

--- WASTE ENCLOSURE FENCE
--- WOOD PRIVACY FENCE

PLANTING

○ LARGE DECIDUOUS TREE
○ MEDIUM DECIDUOUS TREE
○ SMALL DECIDUOUS TREE
○ TREE CANOPY PROJECTION
○ TREE FORM SHRUB
○ DECIDUOUS/CONIFEROUS SHRUBS
○ GRASSES/PERENNIALS
○ SODDING

PAVING

■ ASPHALT PAVING
■ CIP CONCRETE PAVING
■ HEAVY DUTY CONCRETE PAVING
■ RIVERSTONE PAVING
■ UNIT PAVING

PLANTING KEY

XX TREE SPECIES
XX QUANTITY
XX SHRUB SPECIES
XX QUANTITY

DETAIL KEY

1 DETAIL NO.
L1 SHEET NO.

No.	Description	Date
4	Issued for Second Submission	Apr.01/25
3	Issued for Revised First Submission	Dec.17/24
2	Issued for Revised First Submission	Nov.04/24
1	Issued for First Submission	Sept.03/24
Revision		
City Approval Stamp		

PROPERTY INFORMATION
PIN 04404-1854 (LT), 04404-1880 (LT), 04404-1882 (LT) and Part of PIN 04404-1855 (LT), being Blocks 147, 173, 175 and Part of Block 148, Registered Plan 4M-1629

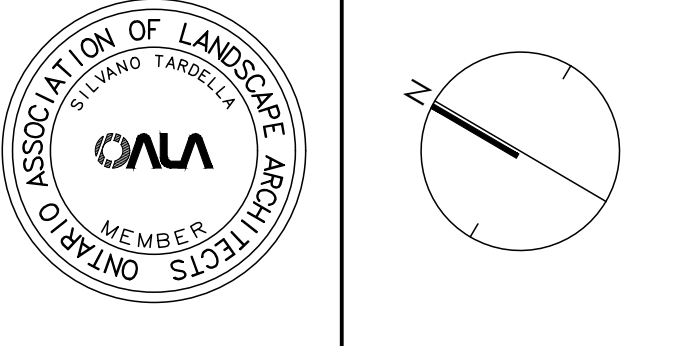

NAK
design strategies

1285 WELLINGTON STREET, OTTAWA, ON K1Y 3A8 CANADA
T 613.237.2345
Project

ORLEANS VILLAGE PHASE 4
OTTAWA, ON

Title	LANDSCAPE PLAN
Date	2024-08-12
Scale	1:250
Drawn	SW
Checked	SC
Job No.	22-145
L03	

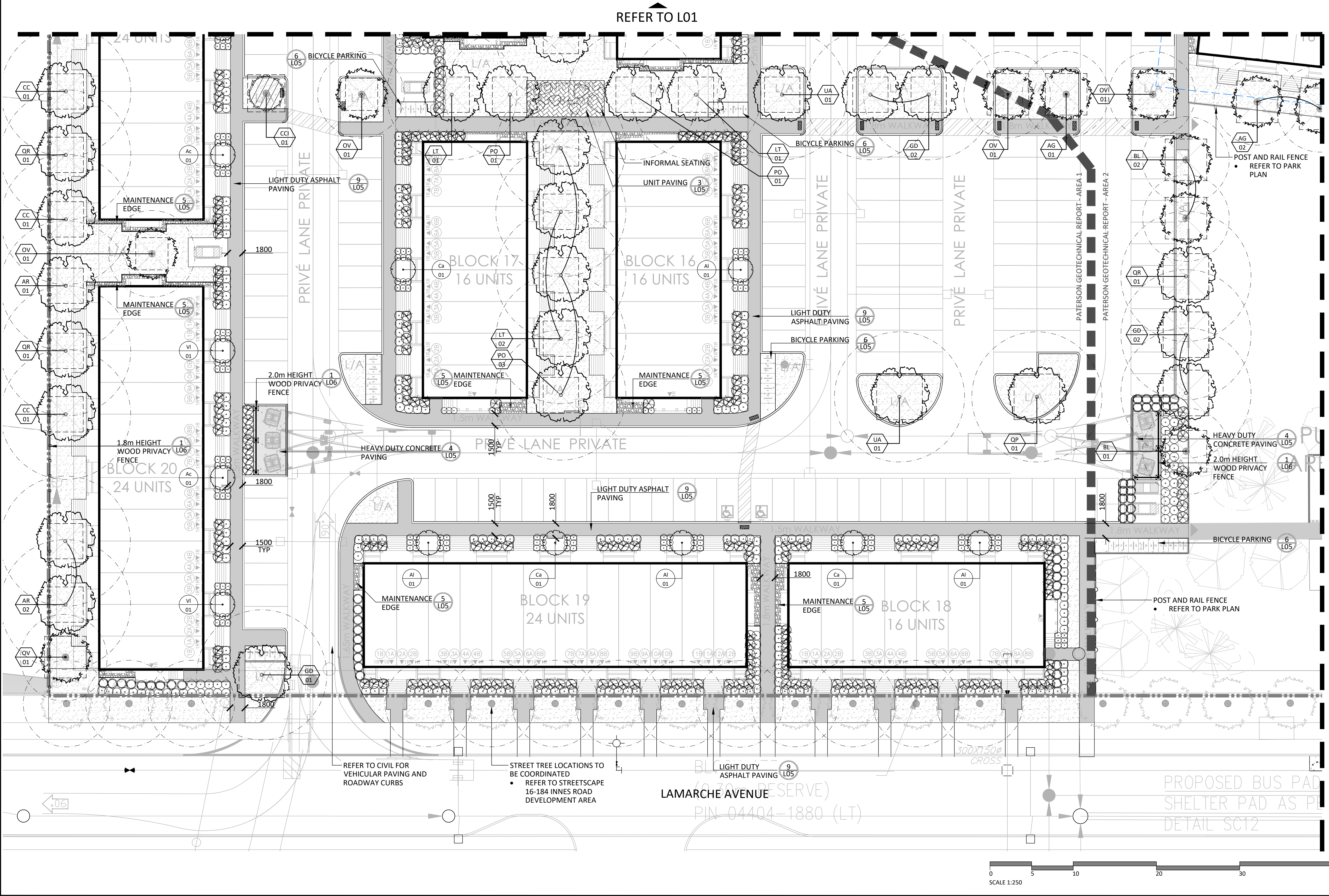

PLANT LIST						
KEY	BOTANICAL NAME	COMMON NAME	QTY.	SIZE	REMARKS	NATIVE OWNER
DECIDUOUS TREES - LARGE (15-30M HEIGHT): TOTAL 56 (PRIVATELY OWNED)						
AR	ACER RUBRUM	RED MAPLE	9	50mm	B&B	Y PRIVATE
CC	CARYA CORDIFORMIS	BITTERNUT HICKORY	8	50mm	B&B	Y PRIVATE
GD	GYMNOCLADUS DIOICUS	KENTUCKY COFFEE TREE	7	50mm	B&B	Y PRIVATE
GT	GLEDTISIA TRICANTHOS VAR. INERMIS 'HALKA'	HALKA HONEY LOCUST	2	50mm	B&B	Y PRIVATE
LT	LIRIODENDRON TULIPIFERA	TULIP TREE	7	50mm	B&B	Y PRIVATE
PO	PLATANUS OCCIDENTALIS	AMERICAN SYCAMORE	8	50mm	B&B	Y PRIVATE
QP	QUERCUS PALUSTRIS	PIN OAK	4	50mm	B&B	Y PRIVATE
QR	QUERCUS RUBRA	RED OAK	6	50mm	B&B	Y PRIVATE
UA	ULMUS AMERICANA	VALLEY FORGE ELM	5	50mm	B&B	Y PRIVATE
DECIDUOUS TREES - MEDIUM (8-14M HEIGHT): TOTAL 34 (PRIVATELY OWNED)						
AG	AESCULUS GLABRA	OHIO BUCKEYE	8	50mm	B&B	Y PRIVATE
ARR	ACER RUBRUM 'REDPOINTE'	REDPOINTE RED MAPLE	2	50mm	B&B	Y PRIVATE
BL	BETULA LENTA	CHERRY BIRCH	7	50mm	B&B	Y PRIVATE
CCA	CARPINUS CAROLINIANA	BLUE BEECH	3	50mm	B&B	Y PRIVATE

QV	OSTRYA VIRGINIANA	IRONWOOD	8	50mm	B&B	Y	PRIVATE
QO	QUERCUA PRINUS	CHESTNUT OAK	6	50mm	B&B	Y	PRIVATE
DECIDUOUS TREES - SMALL (6-8M HEIGHT): TOTAL 4 (PRIVATELY OWNED)							
CCI	CRATAEGUS CRUSGALI 'INERMIS'	THORNLESS HAWTHORN	4	250cm 15 GAL	PT, TREE FORM	Y	PRIVATE
MULTI-STEM SHRUBS: TOTAL 110 (PRIVATELY OWNED)							
Ac	AMELANCHIER CANADENSIS	SERVICEBERRY	18	125cm ht.	PT, CLUMP	Y	PRIVATE
Al	AMELANCHIER LAEVIS	ALLEGHENY SERVICEBERRY	19	125cm ht.	PT, CLUMP	Y	PRIVATE
Ca	CORNUS ALTERNIFOLIA	PAGODA DOGWOOD	19	125cm ht.	PT, CLUMP	Y	PRIVATE
Hv	HAMAMELIS VIRGINIANA	WITCHHAZEL	19	125cm ht.	PT, CLUMP	Y	PRIVATE
Vd	VIBURNUM DENTATUM	ARROWOOD VIBURNUM	17	125cm ht.	PT, CLUMP	Y	PRIVATE
Vi	VIBURNUM LENTAGO	NANNYBERRY	18	125cm ht.	PT, CLUMP	Y	PRIVATE
CONIFEROUS SHRUBS: TOTAL 100 (PRIVATELY OWNED)							
Js	JUNIPERUS SCOPULORUM 'WICHITA BLUE'	WITCHITA BLUE JUNIPER	35	3 GAL	POT	Y	PRIVATE
Tc	TAXUS CANADENSIS	CANADIAN YEW	65	3 GAL	POT	Y	PRIVATE
DECIDUOUS SHRUBS : TOTAL 578 (PRIVATELY OWNED)							
Am	ARONIA MELANOCARPA	BLACK CHOKEBERRY	282	3 GAL	POT	Y	PRIVATE
Sa	SYMPHORICARPOS ALBUS	SNOWBERRY	161	3 GAL	POT	Y	PRIVATE

Po	PHYSOCARPUS OPLULIFOLIUS 'DIABOLO'	'DIABOLO' NINEBARK	135	3 GAL	POT	Y	PRIVATE
ORNAMENTAL GRASSES: TOTAL 1475 (PRIVATELY OWNED)							
cl	CHASMANTHIUM LATIFOLIUM	NORTHERN SEA OATS	395	7 GAL	POT	Y	PRIVATE
dc	DESCHAMPSIA CESPITOSA	TUFTED HAIR GRASS	314	7 GAL	POT	Y	PRIVATE
bg	BOUTELOUA GRACILIS	BLUE GRAMA	195	7 GAL	POT	Y	PRIVATE
sh	SPOROBOLUS HETEROLEPSIS	PRARIE DROPSEED	375	7 GAL	POT	Y	PRIVATE
ss	SCHIZACHYRIUM SCOPARIUM	LITTLE BLUESTEM	196	7 GAL	POT	Y	PRIVATE

GENERAL NOTES:

- ALL PLANT MATERIAL SHALL BE NURSERY GROWN STOCK UNLESS OTHERWISE NOTED.
- TREES TO HAVE A MINIMUM 1800 CLEAR STEM ABOVE GRADE.
- CONTRACTOR TO MAKE GOOD ALL EXISTING AREAS DAMAGED BY HIS WORK TO THE SATISFACTION OF THE CONTRACTOR.
- ALL PLANT MATERIAL SHALL BE WARRANTIED FOR TWO YEARS FROM THE DATE OF SUBSTANTIAL COMPLETION.
- CONTRACTOR TO VERIFY LOCATION OF ALL SERVICES PRIOR TO ANY EXCAVATION.
- ANY PROPOSED SUBSTITUTIONS OF PLANT SPECIES SHALL BE MADE WITH PLANTS OF EQUIVALENT OVERALL FORM, HEIGHT, BRANCHING HABIT, FLOWER, LEAF, COLOR, FRUIT AND CULTURE AND ONLY AFTER APPROVAL OF THE LANDSCAPE ARCHITECT.

TREE PLANTING IN MARINE CLAY SOILS

THE LANDSCAPE CONSIDERATIONS CONTAINED WITHIN SEC. 6.8 OF PATERSON GROUP'S GEOTECHNICAL INVESTIGATION, DATED AUGUST 26, 2024.

- THIS LANDSCAPE PLAN CONFORMS WITH THE TREE-TO-FOUNDATION SETBACK, SOIL VOLUME, AND SURFACE-GRADING REQUIREMENTS OUTLINED IN THE CITY OF OTTAWA'S GUIDELINES FOR TREE PLANTING IN SENSITIVE MARINE CLAY SOILS (2017), BASED ON THE FINDINGS OUTLINED IN THE PROJECT GEOTECHNICAL REPORT BY PATERSON GROUP (REPORT PG6152-1 REV 3 DATED AUGUST, 2024).
- ADDITIONAL REQUIREMENTS OUTLINED IN THE CITY OF OTTAWA'S GUIDELINES FOR TREE PLANTING IN SENSITIVE MARINE CLAY SOILS (2017), INCLUDING USF DEPTH, FOUNDATION WALL REINFORCEMENT, AND SUBDIVISION GRADING, SHOULD BE CONFIRMED BY THE PROJECT ENGINEER(S).

TREE SOIL VOLUMES			
TREE TYPE/SIZE	SINGLE TREE SOIL VOLUME	MULTIPLE TREE SOIL VOLUME (m³/TREE)	SOIL VOLUME FOR MARINE CLAY AREAS (SINGLE TREE)
ORNAMENTAL	15	9	
COLUMNAR	15	9	
SMALL	20	12	25
MEDIUM	25	15	30
LARGE	30	18	
CONIFER	25	15	

		SINGLE	MULTIPLE	CLAY SOILS
SMALL				
MEDIUM/ CONIFER				
LARGE				

*SOIL VOLUME CALCULATION BASED ON 1.0m DEPTH

PROPOSED TREE CANOPY PROJECTIONS			
TREE TYPE/SIZE	CROWN AREA PER TREE STANDARD RANGE (m²)	CROWN AREA PER TREE USED FOR CALC. (m²)	SITE CANOPY COVER
LARGE (56)	135-250*	192	CANOPY (W. OVERLAP): 7,060m²
MEDIUM (34)	35-135*	85	
SMALL (4)	5-35*	20	

PROPOSED STREET TREE PROJECTED CANOPY		CANOPY (W. OVERLAP): 610m²
PROPOSED STREET TREE CANOPY (BY OTHERS), m² CALCULATION BASED ON PROPOSED TREE SPECIES PROJECTIONS		
*RANGE OF CROWN AREAS IS IN ACCORDANCE WITH PROPOSED TREES SPECIES		SITE: 40,717m²
**CROWN AREAS ARE ACCORDING TO THE AVERAGE MATURE CANOPY SIZE OF THE RESPECTIVE SPECIES. CANOPY SIZING HAS BEEN DETERMINED IN REFERENCE TO VARIOUS ARBORICULTURAL AND BOTANICAL SOURCES, SUCH AS: ONTARIO MINISTRY OF NATURAL RESOURCES & FORESTRY (OMNRF); US FOREST SERVICE: FARRAR, J.L. TREES IN CANADA, UNIVERSITY OF GUELPH ARBORETUM, VARIOUS PUBLICATIONS		TOTAL PERCENT COVER: 18.84%
***NOTE: SITE AREA AND TREE COUNTS DO NOT INCLUDE PARK BLOCK.		

Contractor shall check all dimensions on the work and report any discrepancy to the Landscape Architect before proceeding. All drawings and specifications are the property of the Landscape Architect and must be returned at the completion of the work. This drawing is not to be used for construction until signed by the Landscape Architect.

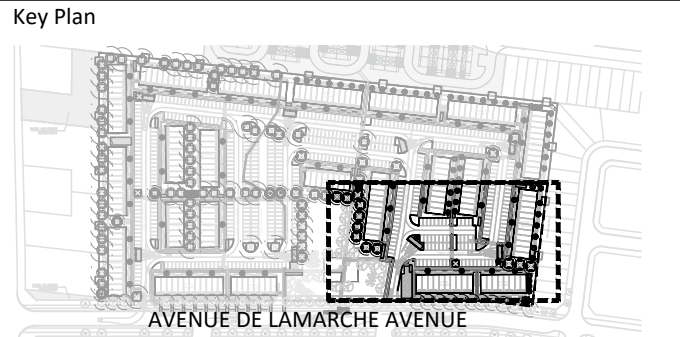

LEGEND	
	PROPERTY LINE
	GEOTECHNICAL FOUNDATION SETBACK (4.5m)
FENCING	
	WASTE ENCLOSURE FENCE
	WOOD PRIVACY FENCE
PLANTING	
	LARGE DECIDUOUS TREE
	MEDIUM DECIDUOUS TREE
	SMALL DECIDUOUS TREE
	TREE CANOPY PROJECTION
	TREE FORM SHRUB
	DECIDUOUS/CONIFEROUS SHRUBS
	GRASSES/PERENNIALS
	SODDING
PAVING	
	ASPHALT PAVING
	CIP CONCRETE PAVING
	HEAVY DUTY CONCRETE PAVING
	RIVERSTONE PAVING
	UNIT PAVING
PLANTING KEY	
	TREE SPECIES
	QUANTITY
	SHRUB SPECIES
	QUANTITY
DETAIL KEY	
	DETAIL NO.
	SHEET NO.

PROPERTY INFORMATION
PIN 04404-1854 (LT), 04404-1880 (LT), 04404-1882 (LT) and Part of PIN 04404-1855 (LT), being Blocks 147, 173, 175 and Part of Block 148, Registered Plan 4M-1629

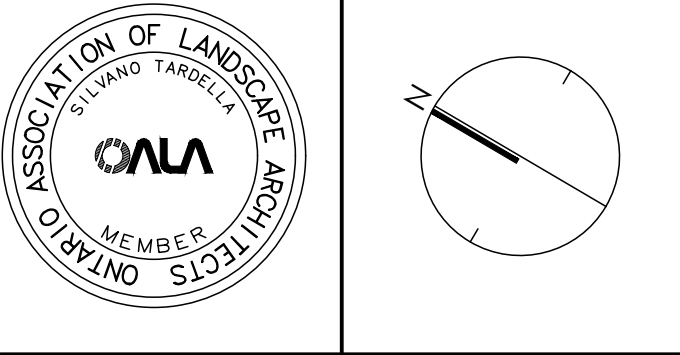

NAK
design strategies
1285 WELLINGTON STREET, OTTAWA, ON K1Y 3A8 CANADA
T 613.237.2345
Project

ORLEANS VILLAGE PHASE 4
OTTAWA, ON

Title
LANDSCAPE PLAN

Date 2024-08-12
Scale 1:250
Drawn SW
Checked SC
Job No. 22-145

L04

PLAN N° --

CITY FILE N° D07-12-24-0103

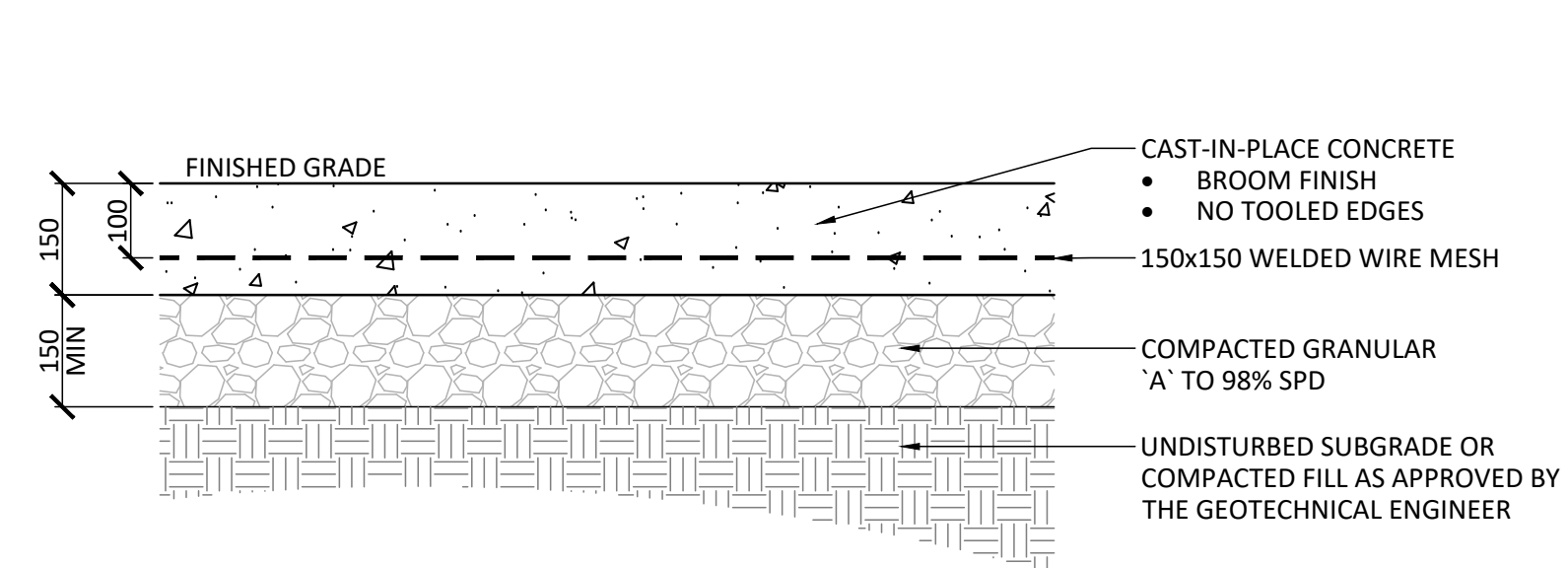

1 PEDESTRIAN CONCRETE PAVING
1:10

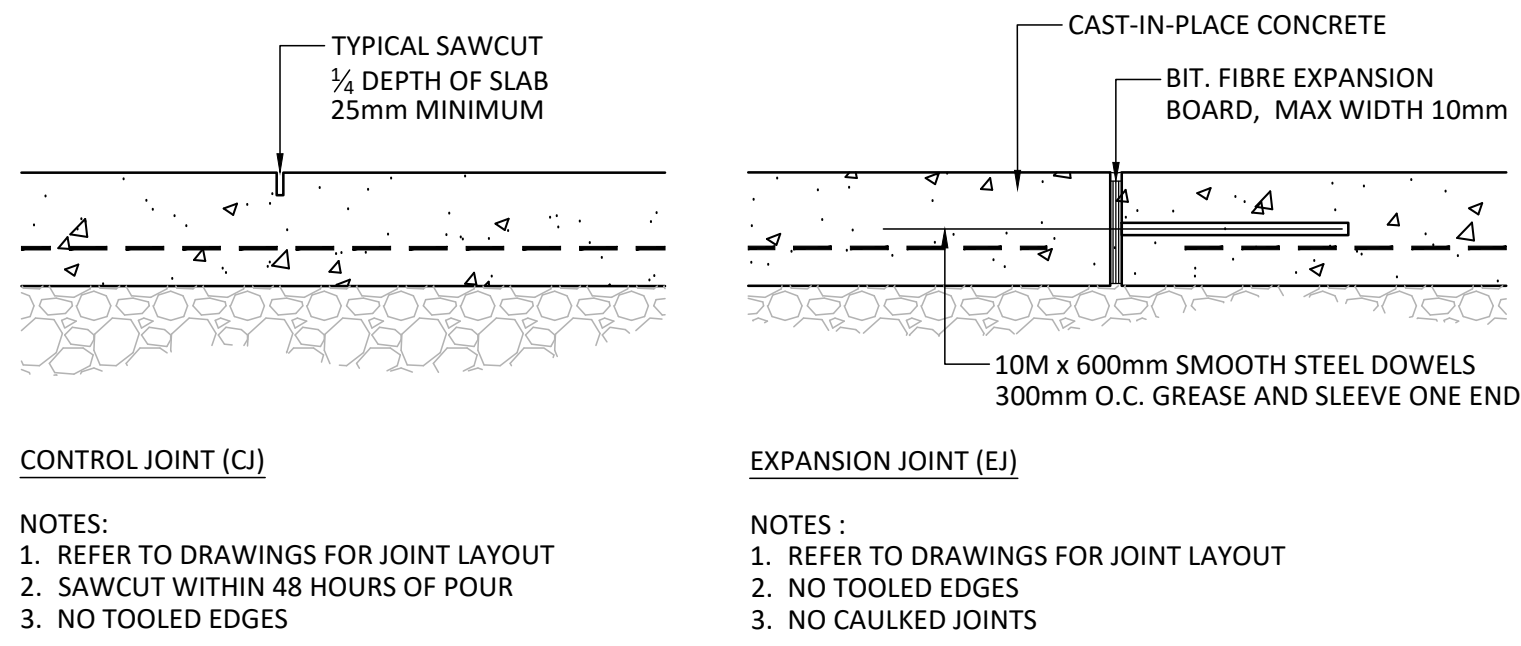

2 PEDESTRIAN CONCRETE JOINTING
1:10

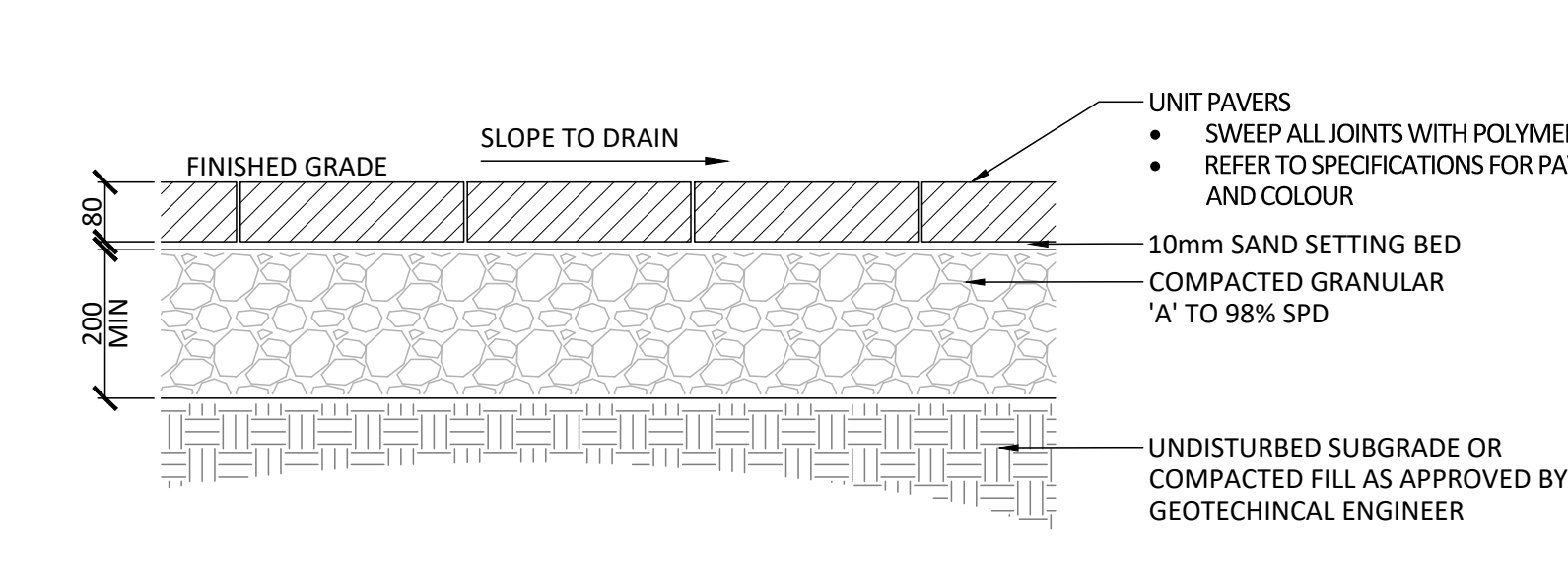

3 UNIT PAVING
1:10

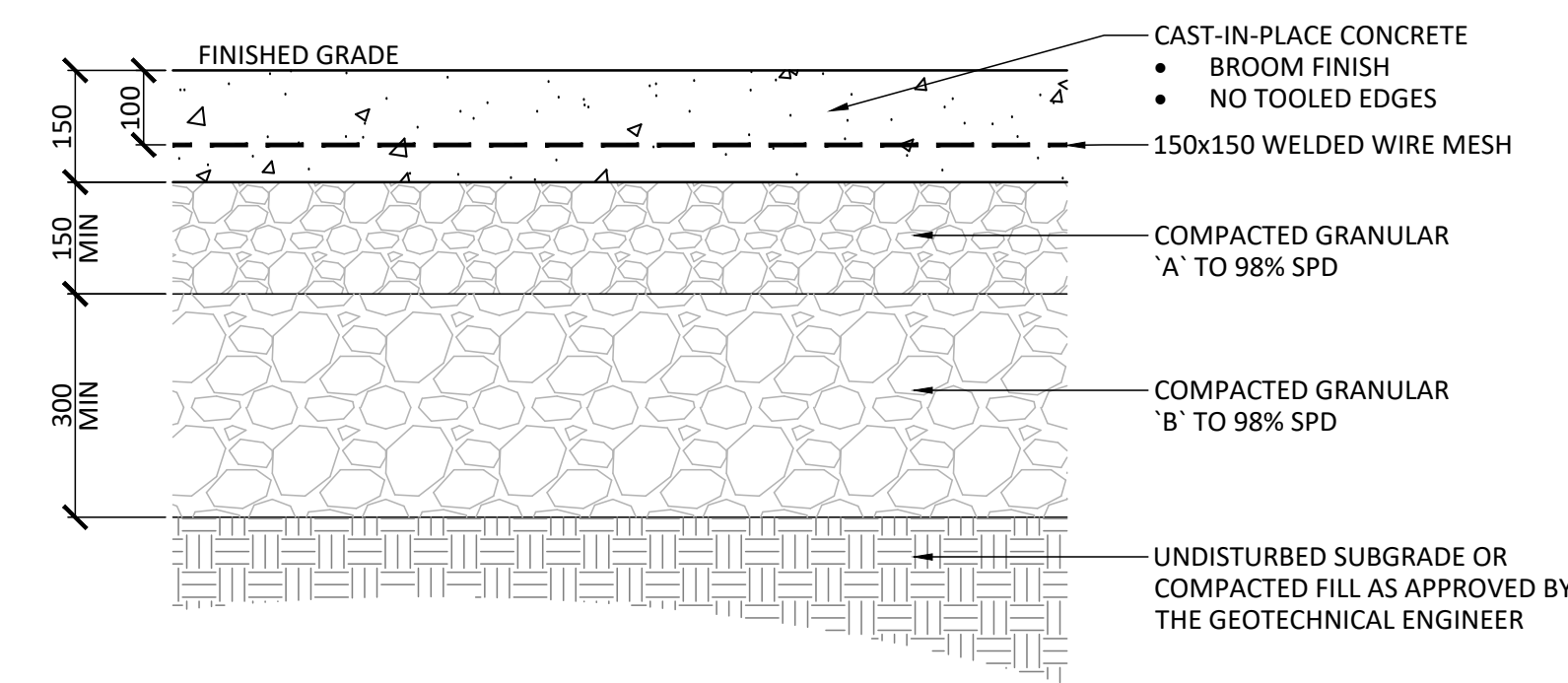

4 HEAVY DUTY CONCRETE PAVING
1:10

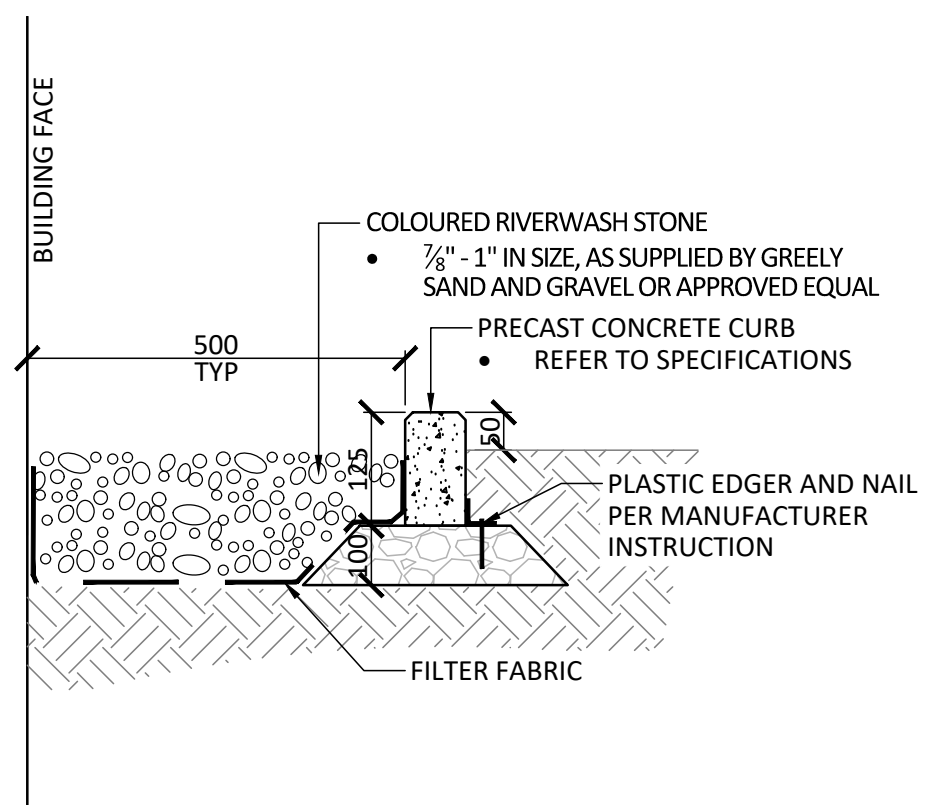

5 MAINTENANCE EDGE
1:10

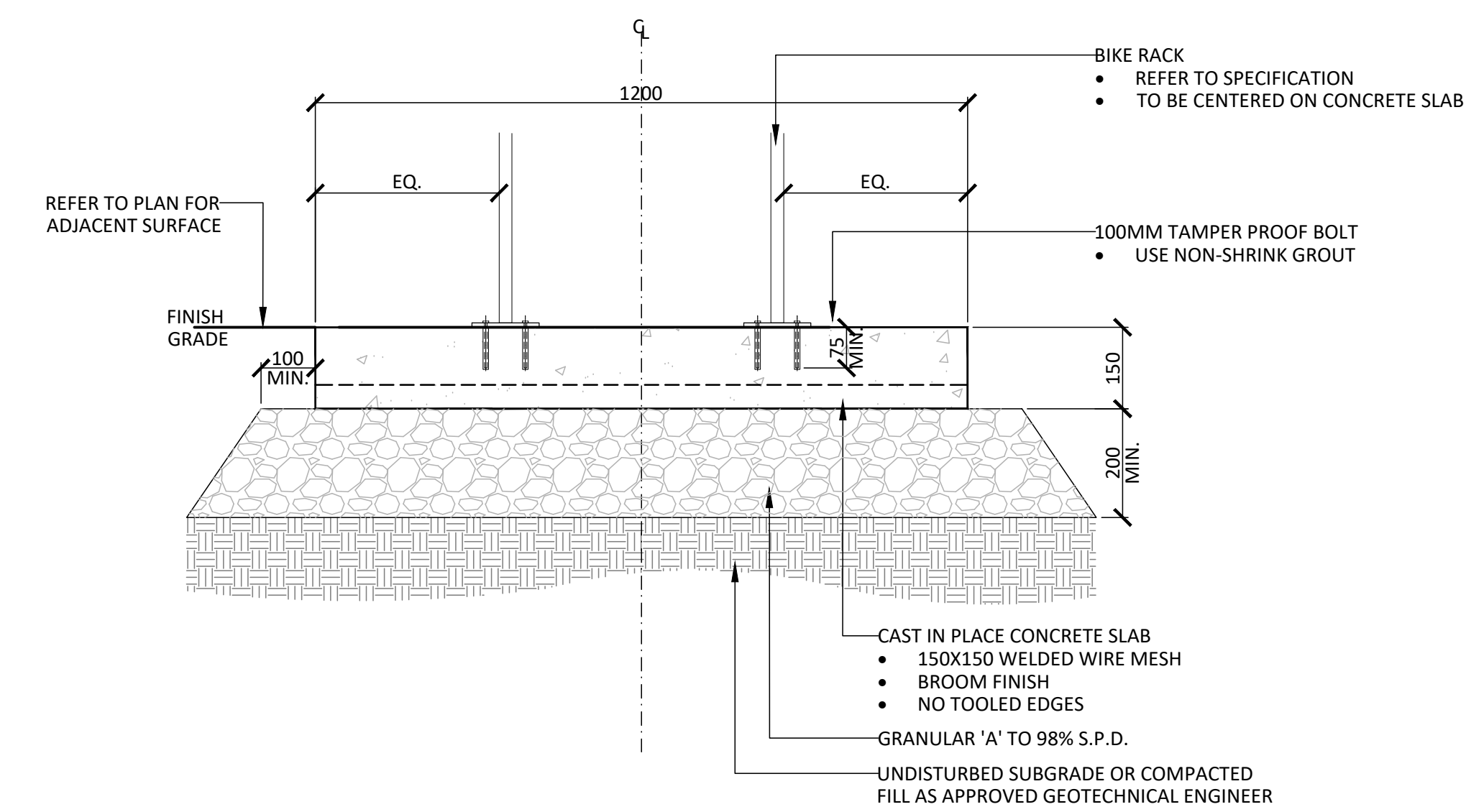

6 BICYCLE PARKING
1:10

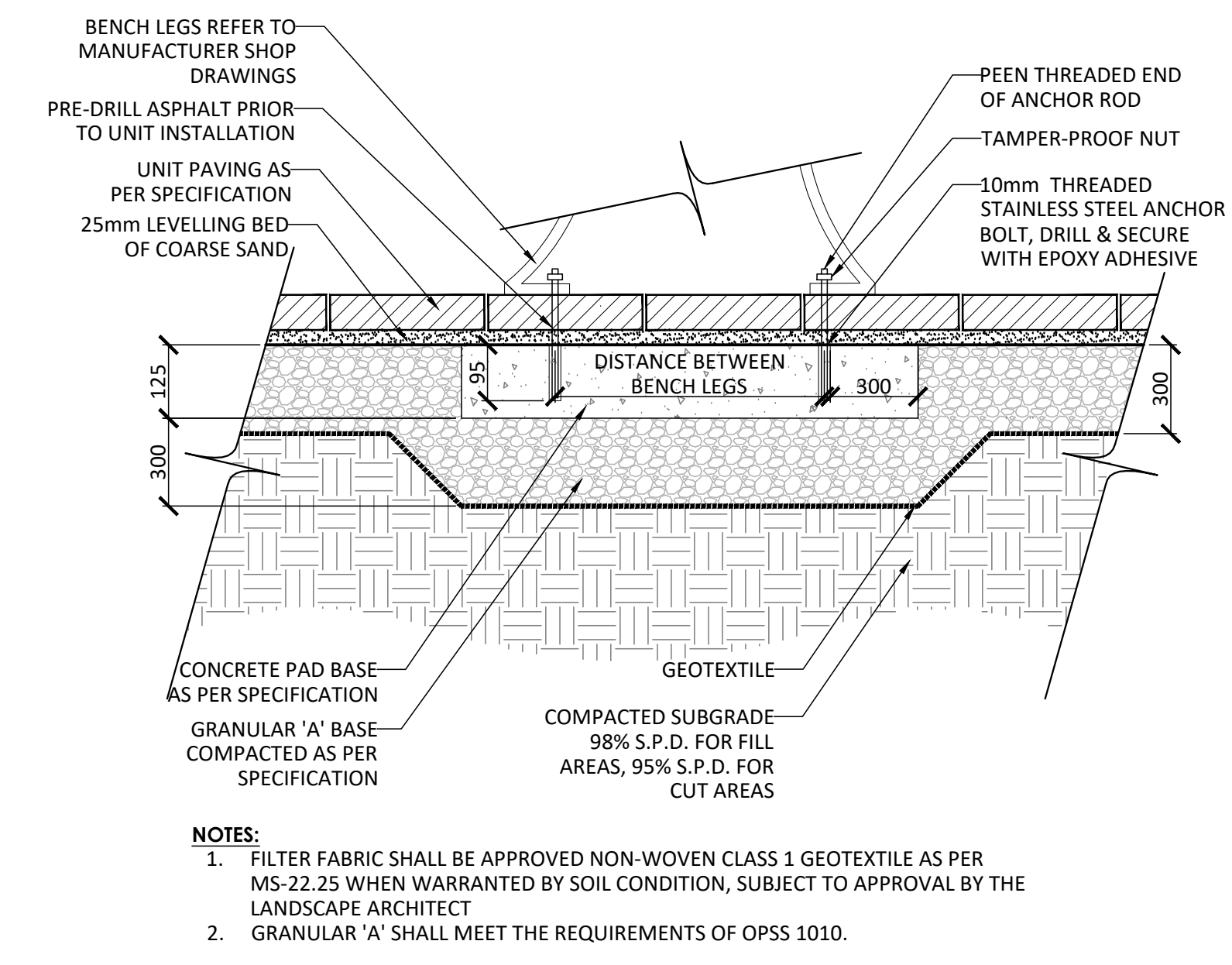

7 BENCH ON UNIT PAVING WITH CONCRETE PAD
1:20

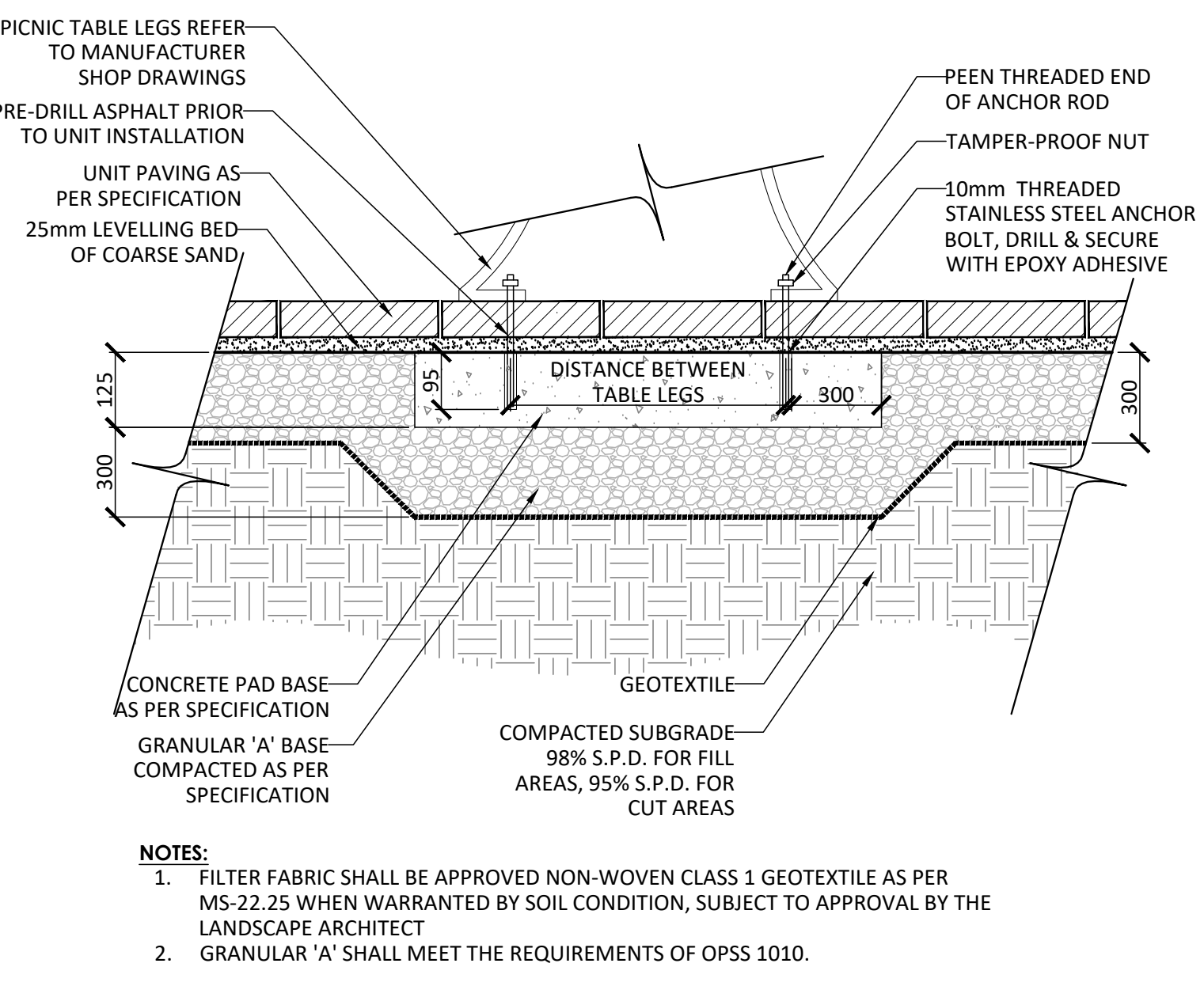

8 PICNIC TABLE ON UNIT PAVING WITH CONCRETE PAD
1:20

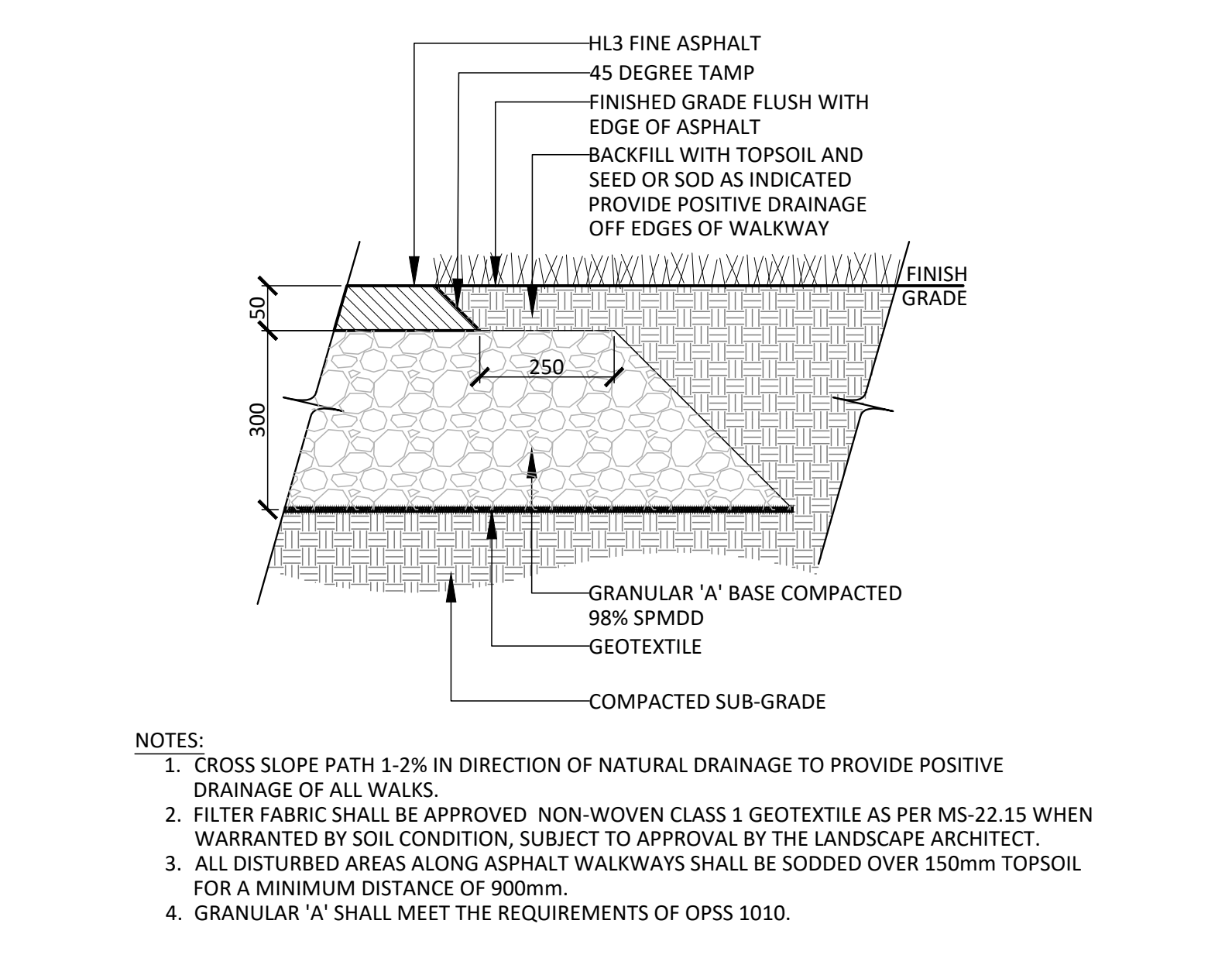

9 LIGHT DUTY ASPHALT PAVING
1:10

Contractor shall check all dimensions on the work and report any discrepancy to the Landscape Architect before proceeding. All drawings and specifications are the property of the Landscape Architect and must be returned at the completion of the work. This drawing is not to be used for construction until signed by the Landscape Architect.

Key Plan

-	
-	
-	
4	Issued for Second Submission
3	Issued for Revised First Submission
2	Issued for Revised First Submission
1	Issued for First Submission
No.	Description
Revision	Date
City Approval Stamp	

PROPERTY INFORMATION
PIN 04404-1854 (LT), 04404-1880 (LT), 04404-1882 (LT) and Part of PIN 04404-1855 (LT), being Blocks 147, 173, 175 and Part of Block 148, Registered Plan 4M-1629

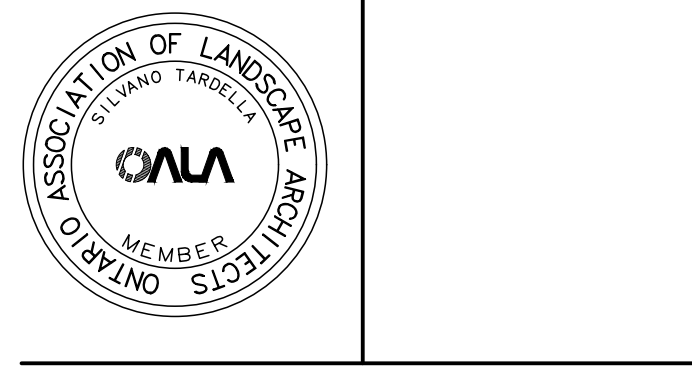

NAK
design strategies
1285 WELLINGTON STREET, OTTAWA, ON K1Y 3A8 CANADA
T 413.237.2345
Project

ORLEANS VILLAGE PHASE 4

Title	
LANDSCAPE DETAILS	
Date	2024-08-12
Scale	AS NOTED
Drawn	SW
Checked	SC
Job No.	22-145
L05	

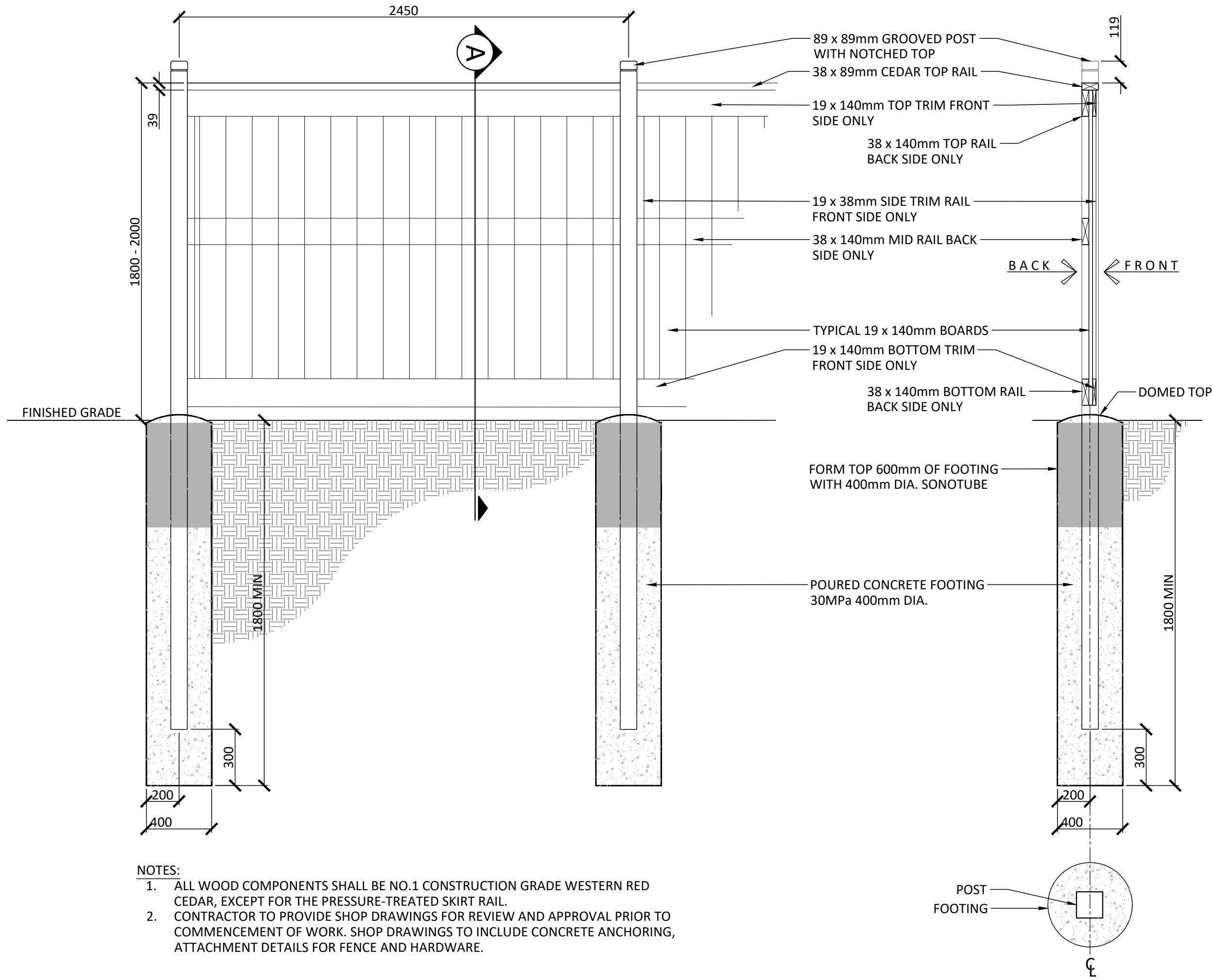

1 1.8m - 2.0m HEIGHT WOOD PRIVACY FENCE
1:20

Contractor shall check all dimensions on the work and report any discrepancy to the Landscape Architect before proceeding. All drawings and specifications are the property of the Landscape Architect and must be returned at the completion of the work. This drawing is not to be used for construction until signed by the Landscape Architect.

Key Plan

-	
-	
-	
4	Issued for Second Submission
3	Issued for Revised First Submission
2	Issued for Revised First Submission
1	Issued for First Submission
No.	Description
	Date

Revision
City Approval Stamp

PROPERTY INFORMATION
PIN 04404-1854 (LT), 04404-1880 (LT), 04404-1882 (LT)
and Part of PIN 04404-1855 (LT), being Blocks 147, 173,
175 and Part of Block 148, Registered Plan 4M-1629



NAK
design strategies

1285 WELLINGTON STREET, OTTAWA, ON K1Y 3A8 CANADA
T 613.237.2345 NAKDESIGNSTRATEGIES.COM
Project

ORLEANS VILLAGE PHASE 4

Title
LANDSCAPE DETAILS

Date 2024-08-12
Scale AS NOTED
Drawn SW
Checked SC
Job No. 22-145

L06

PLAN N° --

CITY FILE N° D07-12-24-0103

Key Plan

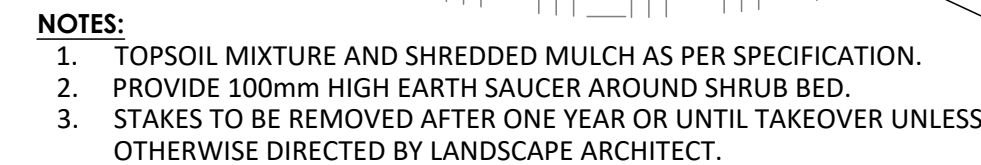

1:25

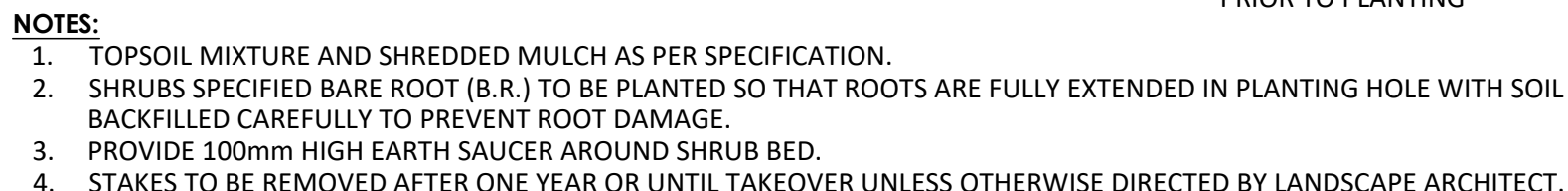

24

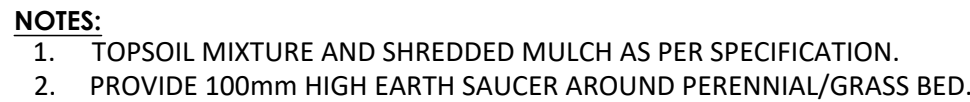

PER

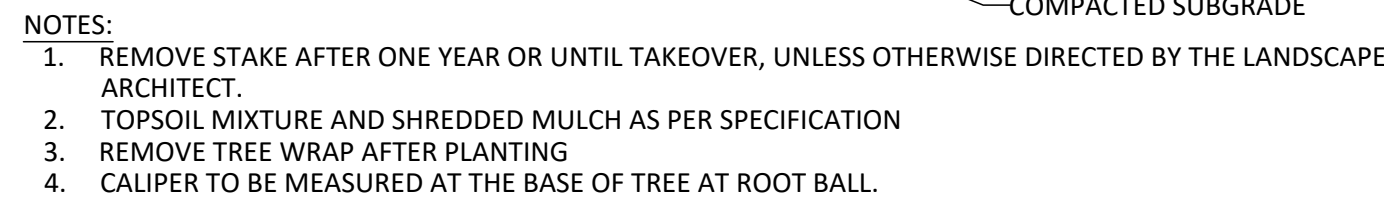

4)

1. CONTRACTOR TO VERIFY LOCATION OF ALL SERVICES PRIOR TO ANY EXCAVATION.
2. LOCATIONS OF ALL PLANT MATERIALS TO BE STAKED BY THE CONTRACTOR AND VERIFIED IN THE FIELD BY LANDSCAPE ARCHITECT PRIOR TO THE EXCAVATION OF PITS.
3. ALL PLANT MATERIAL SHALL BE NURSERY GROWN STOCK UNLESS OTHERWISE NOTED.
4. DECIDUOUS TREES TO HAVE A MINIMUM 1800 CLEAR STEM ABOVE GRADE.
5. ALL PLANT MATERIAL SHALL BE WARRANTIED FOR TWO YEARS FROM THE DATE OF PERFORMANCE ACCEPTANCE AS DETERMINED BY THE LANDSCAPE ARCHITECT.
6. ALL STEEL T-BARS TO BE REMOVED AT THE ONE YEAR INTERIM INSPECTION UNLESS OTHERWISE DIRECTED BY THE LANDSCAPE ARCHITECT.
7. CONTRACTOR TO MAKE GOOD ALL EXISTING AREAS DAMAGED BY HIS WORK TO THE SATISFACTION OF THE LANDSCAPE ARCHITECT.
8. PERIODIC REVIEWS OF PLANTING SHALL BE CARRIED OUT BY THE LANDSCAPE ARCHITECT.
9. ANY PROPOSED SUBSTITUTIONS OF PLANT SPECIES SHALL BE MADE WITH PLANTS OF EQUIVALENT OVERALL FORM, HEIGHT, BRANCHING HABIT, FLOWER, LEAF, COLOR, FRUIT AND CULTURE AND ONLY AFTER APPROVAL OF THE LANDSCAPE ARCHITECT.

1. PLACE THE SHRUB AS UPRIGHT AS POSSIBLE, INCLUDING ON SLOPES.
2. PLANT SHRUBS AT THE PROPER DEPTH AS INDICATED ON THE DRAWINGS.
3. PACK THE SOIL WELL AROUND THE PLANT BASE TO REMOVE AIR POCKETS, BUT DO NOT COMPACT SOIL. PRESS SOIL GENTLY BUT FIRMLY TO PREVENT SHOCKING THE ROOTS.
4. PLACE SPECIES ACCORDING TO THE QUANTITIES AND SPACING AS INDICATED ON THE DRAWINGS.
5. PLANT SHRUBS AT THE PROPER DEPTH THE ROOT COLLARS SHOULD BE AT GROUND LEVEL.
6. MULCH THE SOIL SURFACE AS INDICATED ON DRAWINGS.
7. WATER PLANTS THOROUGHLY FOLLOWING PLANTING.
8. REFER TO SPECIFICATIONS FOR MAINTENANCE REQUIREMENTS.

1. SODDED AREAS SHALL HAVE A MINIMUM 150mm TOPSOIL.
2. FIRM THE SOIL BY GENTLY TAMPING OR ROLLING THE TOPSOIL. DO NOT COMPACT THE SOIL. EXCESSIVE FORCE WILL DESTROY THE SOIL STRUCTURE AND INHIBIT GERMINATION.
3. CUT THE GRASS TO 50mm WHENEVER IT REACHES THE HEIGHT OF 70mm. REMOVE CLIPPINGS THAT WILL SMOOTHER GRASS.
4. SODDED AREAS WILL BE ACCEPTED BY THE PROJECT MANAGER FOLLOWING PERFORMANCE ACCEPTANCE, PROVIDED:
 - SEEDS ARE PROPERLY ESTABLISHED.
 - TURF IS FREE OF DEAD SPOTS AND WEEDS.
 - NO SURFACE SOIL IS VISIBLE WHEN GRASS HAS BEEN CUT TO A HEIGHT OF 50mm
 - TURF AREAS HAVE BEEN CUT NO LESS THAN TWICE, THE LAST CUT BEING CARRIED OUT WITHIN 24 HOURS PRIOR TO THE ACCEPTANCE INSPECTION.

PROPERTY INFORMATION
PIN 04404-1854 (LT), 04404-1880 (LT), 04404-1882 (LT)
and Part of PIN 04404-1855 (LT), being Blocks 147, 173,
175 and Part of Block 148, Registered Plan 4M-1629



Project

LANDSCAPE DETAILS

L07

PLAN N° --

CITY FILE N° D07-12-24-0103