

X:\Clients\164402005 Design\Drawings\164402005 DB.dwg  
2025-10-24 12:25 PM JVS - JVS  
ORIGINAL SHEET - ARCH-D

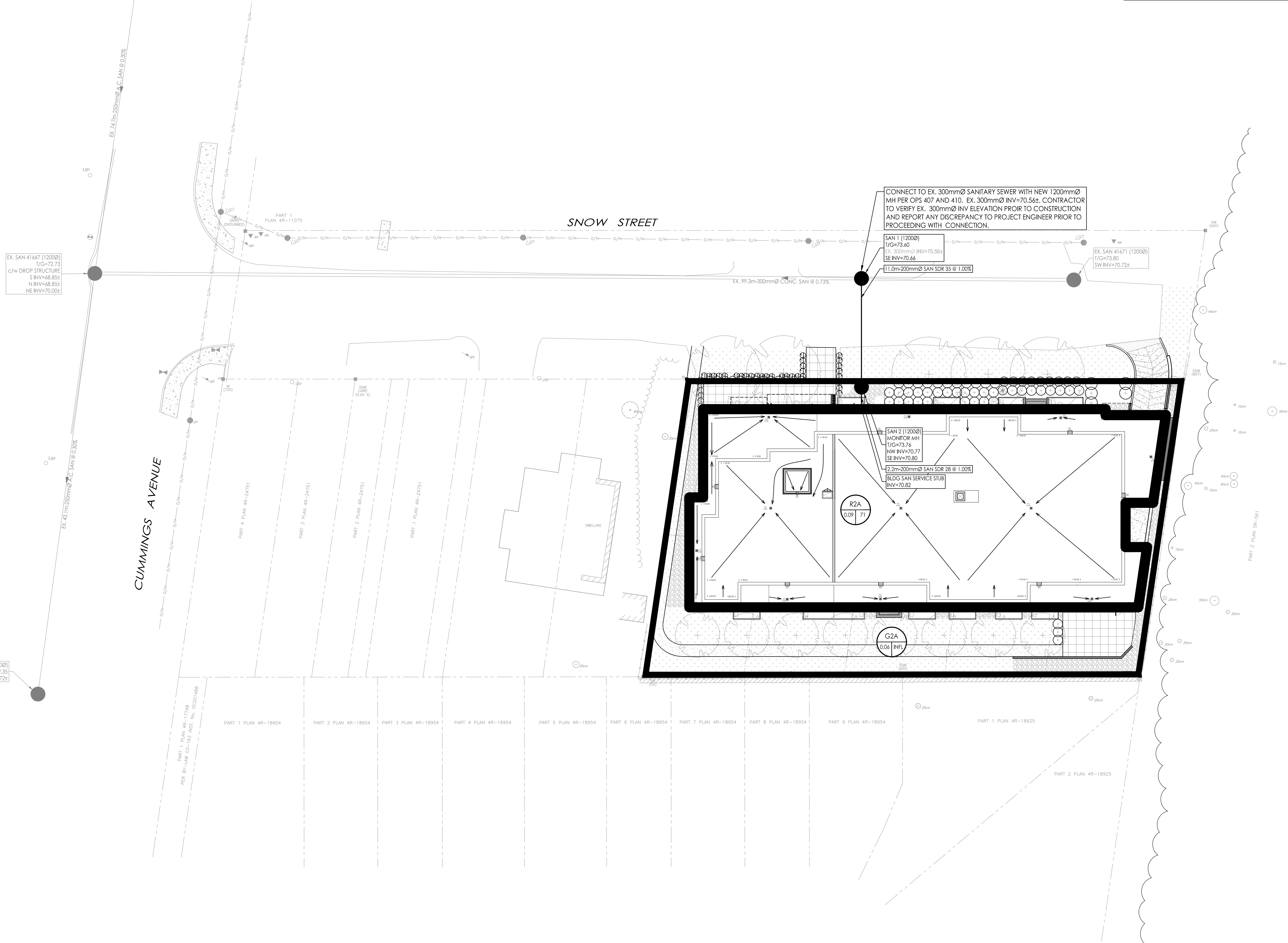

Stantec Consulting Ltd.  
400 - 1331 Clyde Avenue  
Ottawa ON  
Tel. 613.722.4420  
www.stantec.com

Copyright Reserved

The Contractor shall verify and be responsible for all dimensions. DO NOT scale the drawing - any errors or omissions shall be reported to Stantec without delay.

The Copyrights to all designs and drawings are the property of Stantec. Reproduction or use for any purpose other than that authorized by Stantec is forbidden.

R2A

0.08 67

G2A

0.07 INFL

SANITARY DRAINAGE AREA ID#

SANITARY DRAINAGE AREA NO.

SANITARY DRAINAGE AREA ID#

INFILTRATION RATE OF 0.33 L/s/Ha APPLIED

SANITARY DRAINAGE AREA NO.

SANITARY DRAINAGE AREA

PROPOSED SANITARY MH AND SEWER

EXISTING SANITARY MH AND SEWER

Notes

SANITARY STATS

POPULATION COUNT

APARTMENT BUILDING

9 - STUDIO APTS @ 1.4PPU = 13 PEOPLE

20 - 1 BEDROOM APTS @ 1.4PPU = 28 PEOPLE

14 - 2 BEDROOM APTS @ 2.1PPU = 30 PEOPLE

TOTAL POPULATION APARTMENT BUILDING = 71 PEOPLE

1	REVISED PER CITY COMMENTS	MJS	DT	25.10.24
0	ISSUED FOR SPA	MJS	DT	25.02.27
Revision		By	Appd.	YY.MM.DD
File Name: 164402005 DB.dwg		MJS	DT	MJS 24.11.06
		Dwn.	Chkd.	Dsgn. YY.MM.DD

Permit-Seal

Client/Project

1146 SNOW STREET INC.  
5669 POWER ROAD

1146 SNOW STREET  
4 STOREY 43 UNIT APARTMENT BUILDING  
OTTAWA, ON

Title

SANITARY DRAINAGE PLAN

Project No.

160402005

Drawing No.

SA-1

Scale

1:200

Sheet

9 of 9

Revision

1

Revision

1