



RICHCRAFT

RICHCRAFT HOMES RENAUD & RAPPEL



LIST OF DRAWINGS:

- L1.0 - LANDSCAPE PLAN
- L2.0 - LANDSCAPE DETAILS

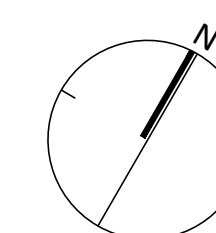

KEYMAP
NTS

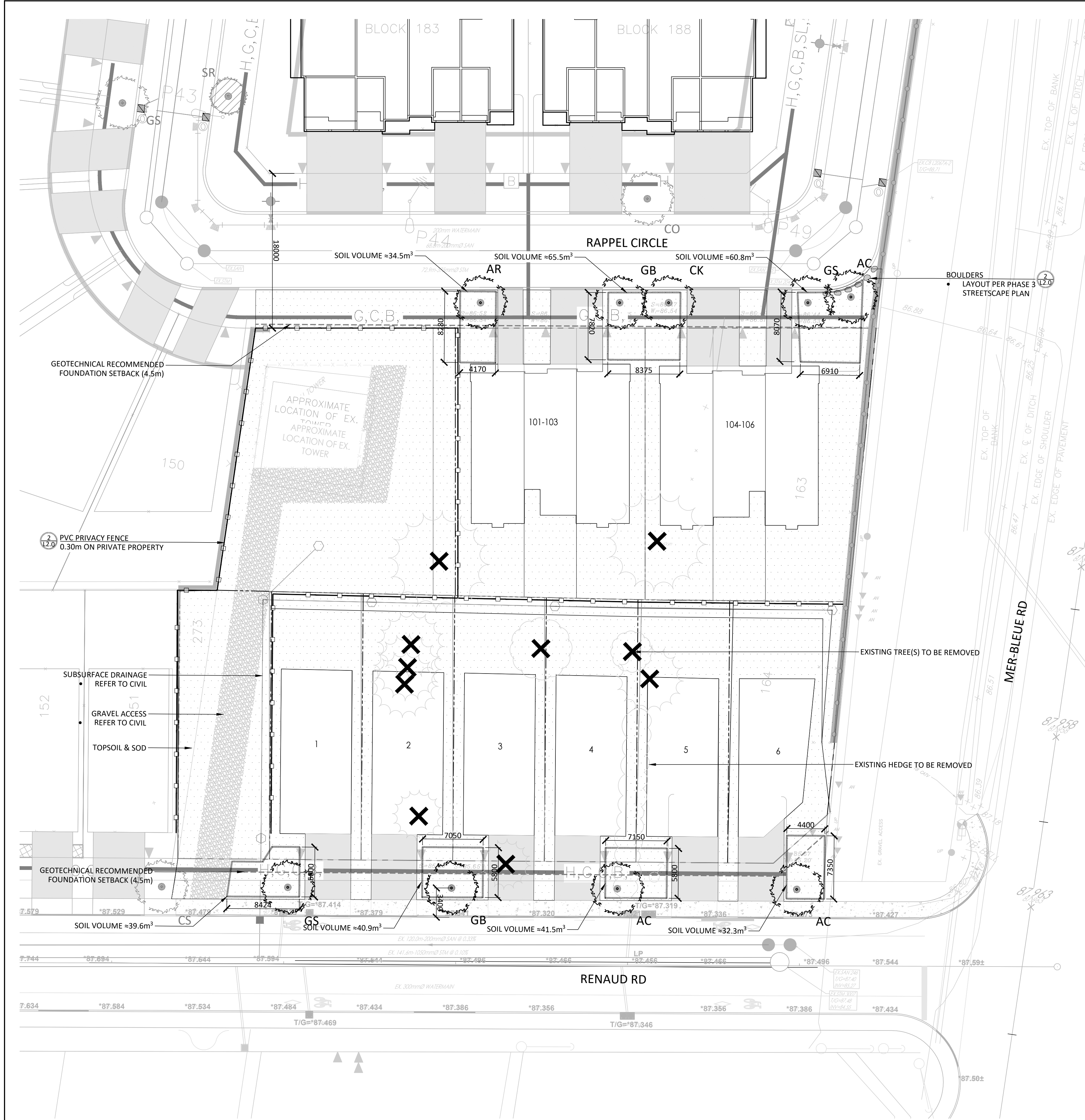

STREET TREE REQUIREMENT BASED ON DRAFT CONDITIONS FOR FINAL APPROVAL:

- 1 TREE PER INTERIOR SINGLE (NON-CORNER) LOTS
- 2 TREES PER EXTERIOR SINGLE (CORNER) LOTS
- 1 TREE PER EXTERIOR TOWNHOUSE (CORNER) LOT
- 2 TREES PER 3 MULTIPLE-UNITS TOWNHOUSE

- INTERIOR SINGLE (NON-CORNER) LOTS (5): 5 TREES
- EXTERIOR SINGLE (CORNER) LOTS (1): 2 TREES
- EXTERIOR TOWNHOUSE (CORNER) LOT (1): 1 TREES
- 3 MULTIPLE-UNITS TOWNHOUSE (2): 4 TREES

TOTAL NUMBER OF TREES REQUIRED: 12
NUMBER OF STREET TREES SHOWN ON PLAN: 9
DIFFERENCE: -3

- TRAILESDGE EAST PH.1: +22 TREES
- TRAILESDGE EAST PH.2&3: -40 TREES
- TRAILESDGE EAST PARK: +94 TREES (DECIDUOUS, 50mm CAL.)

STREET TREE PLANTING GUIDELINE

- NOTE: APPROVED CROSS SECTIONS SHALL TAKE PRECEDENCE
- 4.5m - STREET LIGHT (SMALL TREE <7m MATURE HT.)
 - 2.5m - STREET LIGHT (MEDIUM/LARGE TREE >7m MATURE HT.)
 - 3.0m - HYDRO TRANSFORMER
 - 1.5m - PATH, DRIVEWAY, FENCE, SOUND WALL
 - 4.5m - CONIFERS MINIMUM SETBACK FROM CURB
 - 2.5m - FIRE HYDRANTS
 - 1.5m - WATER SERVICE / CURB STOP
 - 1.0m - BELL / CABLE PEDESTALS

TREE PLANTING IN MARINE CLAY SOILS

THE LANDSCAPE CONSIDERATIONS CONTAINED WITHIN SEC. 6.8 OF PATERSON GROUP'S GEOTECHNICAL INVESTIGATION, DATED AUGUST 12, 2022.

- THIS LANDSCAPE PLAN CONFORMS WITH THE TREE-TO-FOUNDATION SETBACK, SOIL VOLUME, AND SURFACE-GRADING REQUIREMENTS OUTLINED IN THE CITY OF OTTAWA'S GUIDELINES FOR TREE PLANTING IN SENSITIVE MARINE CLAY SOILS (2017), BASED ON THE FINDINGS OUTLINED IN THE PROJECT GEOTECHNICAL REPORT BY PATERSON GROUP (REPORT PG0861-3 REVISION 5, DATED AUGUST 12, 2022).
- ADDITIONAL REQUIREMENTS OUTLINED IN THE CITY OF OTTAWA'S GUIDELINES FOR TREE PLANTING IN SENSITIVE MARINE CLAY SOILS (2017), INCLUDING USF DEPTH, FOUNDATION WALL REINFORCEMENT, AND SUBDIVISION GRADING, SHOULD BE CONFIRMED BY THE PROJECT ENGINEER(S).
- THE CONTRACTOR SHOULD REPORT ANY DISCREPANCIES TO THE CONTRACT ADMINISTRATOR BEFORE PLANTING TREES.

TREE SOIL VOLUMES			
TREE TYPE/SIZE	SINGLE TREE SOIL VOLUME	MULTIPLE TREE SOIL VOLUME (m3/TREE)	SOIL VOLUME FOR MARINE CLAY AREAS (SINGLE TREE)
ORNAMENTAL	15	9	
COLUMNAR	15	9	
SMALL	20	12	25
MEDIUM	25	15	30
LARGE	30	18	
CONIFER	25	15	

DECIDUOUS TREES - MEDIUM (8-14M HEIGHT)

KEY	QTY	BOTANICAL NAME	COMMON NAME	MATURE Ht. (M)	SIZE	REMARKS
AR	1	ACER RUBRUM 'BRANDYWINE'	BRANDYWINE MAPLE	12	50mm	B&B
GB	2	GINKGO BILOBA 'AUTUMN GOLD'	AUTUMN GOLD GINKGO	14	50mm	B&B
GS	2	GLEDITSIA TRIACANTHOS VAR. INERMIS 'IMPERIAL'	IMPERIAL HONEYLOCUST	12	50mm	B&B
CK	1	CLADASTRIS KENTUCKEA	YELLOWWOOD	12	50mm	B&B

DECIDUOUS TREES - SMALL (6-8M HEIGHT)

AC	3	AMELANCHIER CANADENSIS	SERVICEBERRY	6	50mm	B&B
----	---	------------------------	--------------	---	------	-----

Contractor shall check all dimensions on the work and report any discrepancy to the Landscape Architect before proceeding. All drawings and specifications are the property of the Landscape Architect and must be returned at the completion of the work. This drawing is not to be used for construction until signed by the Landscape Architect.

Key Plan

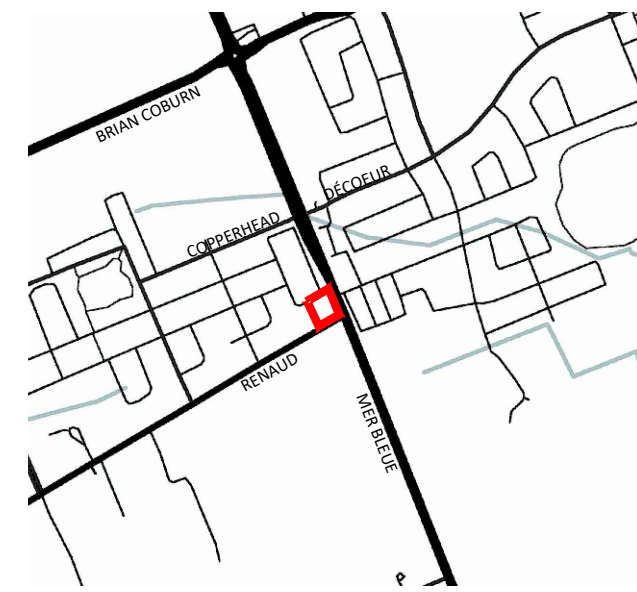

LEGEND

- PROPERTY LINE
- DECORATIVE FENCE
- PRIVACY FENCE

PLANTING

- STREET TREE PHASE 3
- DECIDUOUS STREET TREE
- SOD
- SOIL VOLUME DELINEATION (CALCULATIONS TO 1m DEPTH)

-		
5	Re-issued for ZBA	Jul.7/25
4	Re-issued for ZBA	May.7/25
3	Re-issued for ZBA	Apr.30/25
2	Re-issued for ZBA	Feb.25/25
1	Issued for ZBA	Jan.16/25
No.	Description	Date
Revision		
City Approval Stamp		

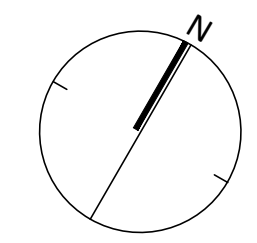

NAK
design strategies

1285 WELLINGTON STREET, OTTAWA, ON K1Y 3A8 CANADA
T 613.237.2345
Project

RENAUD & RAPPEL
6615 RENAUD ROAD

Title

LANDSCAPE PLAN

Date	January, 2025	Sheet
Scale	1:250	
Drawn	PG	
Checked	JH	
Job No.	18-135	

L1.0

