

CAIVAN STITTSVILLE WEST

CAIVAN
COMMUNITIES

NAK
design strategies

LIST OF DRAWINGS:

- ST1 - PRELIMINARY STREETSCAPE PLAN
- ST2 - PRELIMINARY STREETSCAPE PLAN
- ST3 - PRELIMINARY STREETSCAPE PLAN
- ST4 - PRELIMINARY STREETSCAPE PLAN
- ST5 - PRELIMINARY STREETSCAPE PLAN
- ST6 - PRELIMINARY STREETSCAPE PLAN
- D1 - DETAILS

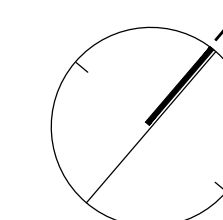

KEYMAP
NTS

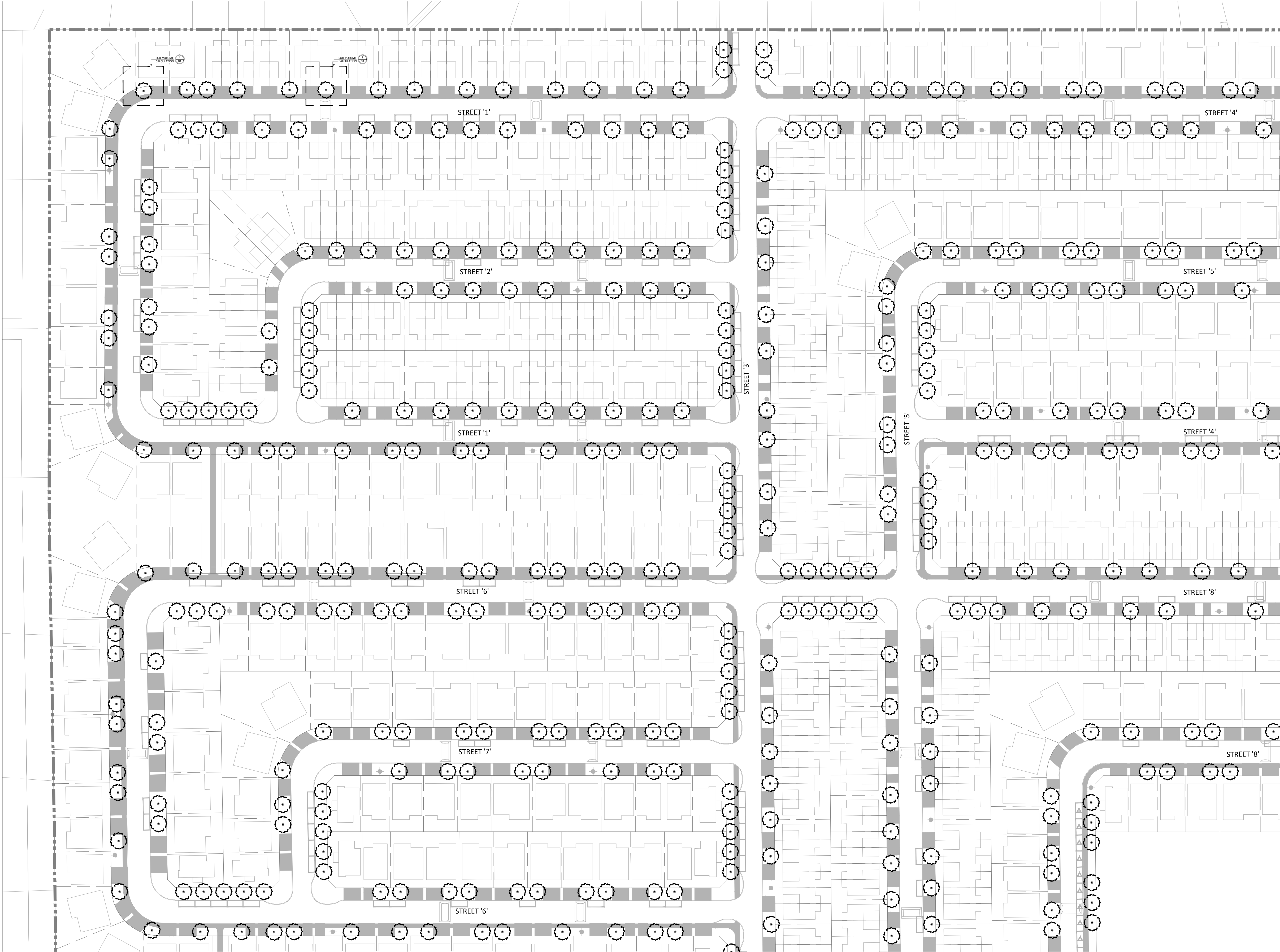

PROPOSED TREE CANOPY PROJECTIONS			
TREE TYPE/SIZE	CROWN AREA PER TREE STANDARD RANGE (m²)	CROWN AREA PER TREE USED FOR CALC. (m²)	SITE CANOPY COVER
MEDIUM/ LARGE (1229)	35-250*	±138	***CANOPY (W. OVERLAP): 162,886m²
*RANGE OF CROWN AREAS IS IN ACCORDANCE WITH PROPOSED TREES SPECIES			SITE: 502,685m²
**CROWN AREAS ARE ACCORDING TO THE AVERAGE MATURE CANOPY SIZE OF THE RESPECTIVE SPECIES. CANOPY SIZING HAS BEEN DETERMINED IN REFERENCE TO VARIOUS ARBORICULTURAL AND BOTANICAL SOURCES, SUCH AS: ONTARIO MINISTRY OF NATURAL RESOURCES & FORESTRY (OMNR); US FOREST SERVICE; FARRAR, J.L. TREES IN CANADA. UNIVERSITY OF GUELPH ARBORETUM, VARIOUS PUBLICATIONS			TOTAL PERCENT COVER: 32%

- ***NOTES:
- CANOPY COVERAGE BASED ON AVERAGE EXPECTED MATURE DIAMETER OF ~12.5m, AREA OF ~138m² (COMBINATION OF MEDIUM AND LARGE SIZE TREES). CALCULATION ACCOUNTS FOR CANOPY OVERLAP BETWEEN TREES AND EXCLUDES CANOPY OVERLAP TO NON-RESIDENTIAL LANDS.
 - GRAPHICS ARE NOT TO SCALE.

TREE SOIL VOLUMES		
TREE TYPE/SIZE	SINGLE TREE SOIL VOLUME	MULTIPLE TREE SOIL VOLUME (m3/TREE)
ORNAMENTAL	15	9
COLUMNAR	15	9
SMALL	20	12
MEDIUM	25	15
LARGE	30	18
CONIFER	25	15

- TYPICAL STREET TREE PLANTING REQUIREMENTS
- 1 TREE PER INTERIOR SINGLE (NON-CORNER) LOTS
 - 2 TREES PER EXTERIOR SINGLE (CORNER) LOTS
 - 1 TREE PER EXTERIOR TOWNHOUSE (CORNER) LOT
 - 2 TREES PER 3 MULTIPLE-UNITS TOWNHOUSE
 - 2 TREES PER 4 MULTIPLE-UNITS TOWNHOUSE
 - 3 TREES PER 5 MULTIPLE-UNITS TOWNHOUSE
 - 3 TREES PER 6 MULTIPLE-UNITS TOWNHOUSE

INTERIOR SINGLE (NON-CORNER) LOTS (597): 597 TREES
EXTERIOR SINGLE (CORNER) LOTS (65): 130 TREES
EXTERIOR TOWNHOUSE (CORNER) LOT (40): 40 TREES
3 MULTIPLE-UNITS TOWNHOUSE (18): 36 TREES
4 MULTIPLE-UNITS TOWNHOUSE (18): 36 TREES
5 MULTIPLE-UNITS TOWNHOUSE (87): 261 TREES
6 MULTIPLE-UNITS TOWNHOUSE (46): 138 TREES

TOTAL NUMBER OF TREES REQUIRED:	1,238
NUMBER OF STREET TREES SHOWN ON PLAN:	1,229
NUMBER OF WALKWAY BLOCK TREES:	00
TOTAL NUMBER OF TREES ON PLAN:	1,229
DIFFERENCE:	-9

*PRELIMINARY - STREET TREE LOCATIONS ARE SUBJECT TO CHANGE DURING DETAILED DESIGN AND SITE PLAN CONTROL APPLICATIONS.

Contractor shall check all dimensions on the work and report any discrepancy to the Landscape Architect before proceeding. All drawings and specifications are the property of the Landscape Architect and must be returned at the completion of the work. This drawing is not to be used for construction until signed by the Landscape Architect.

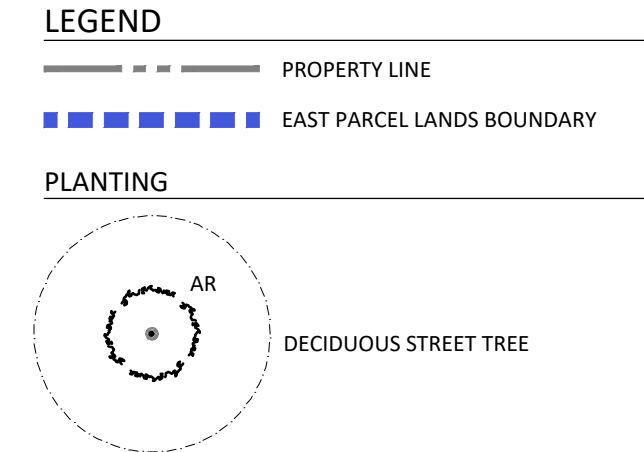
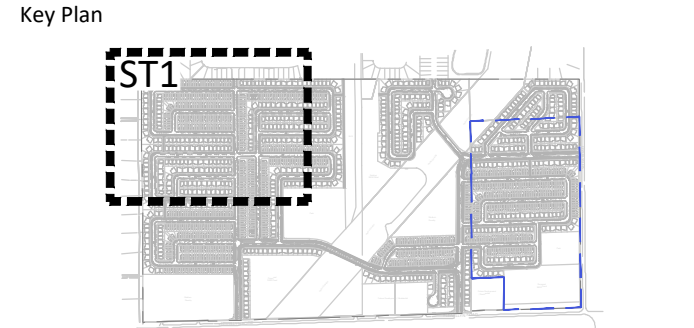

-		
6	East Parcel Lands Identified	Jun 17/25
5	Issued for Preliminary Streetscape Resubmission	Apr.14/25
4	Issued for Preliminary Streetscape Resubmission	Mar.24/25
3	Issued for Preliminary Streetscape Resubmission	Aug.9/24
2	Issued for Preliminary Streetscape Resubmission	Aug.2/24
1	Issued for Preliminary Streetscape Submission	July.18/24
No.	Description	Date
Revision		
City Approval Stamp		

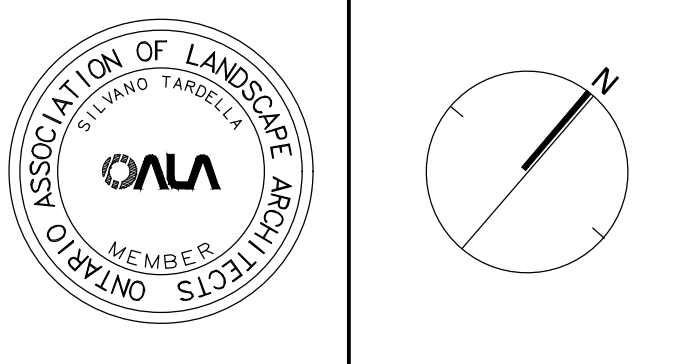

NAK
design strategies

1285 WELLINGTON STREET, OTTAWA, ON K1Y 3A8 CANADA
T 613.237.2345 NAKDESIGNSTRATEGIES.COM

Project

STITTSTVILLE WEST

Title

PRELIMINARY STREETScape PLAN

Date	2024-06-20	Sheet
Scale	1:750	
Drawn	NM	
Checked	SE	
Job No.	21-273	

ST1

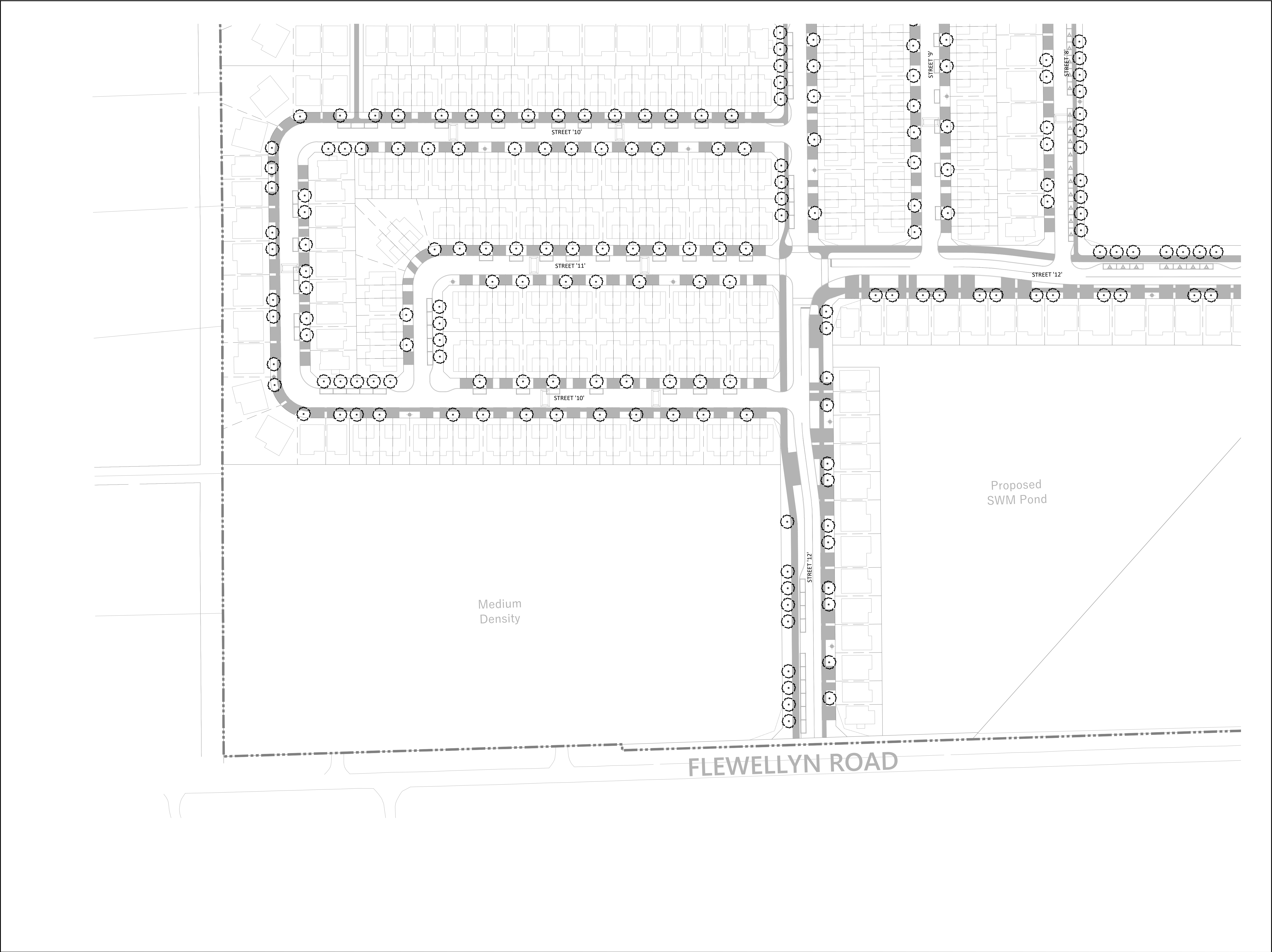

Contractor shall check all dimensions on the work and report any discrepancy to the Landscape Architect before proceeding. All drawings and specifications are the property of the Landscape Architect and must be returned at the completion of the work. This drawing is not to be used for construction until signed by the Landscape Architect.

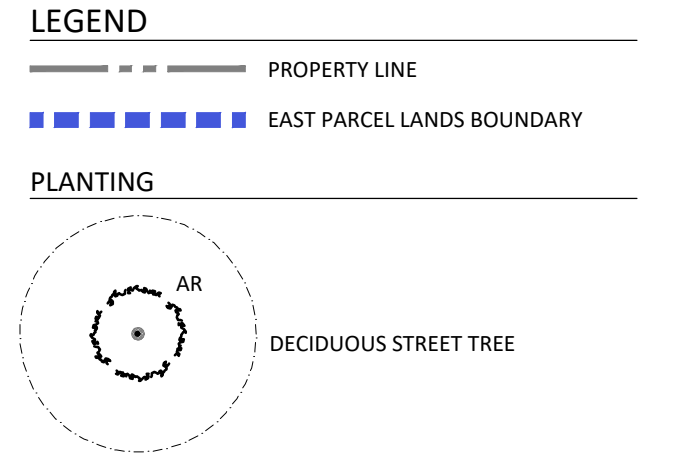
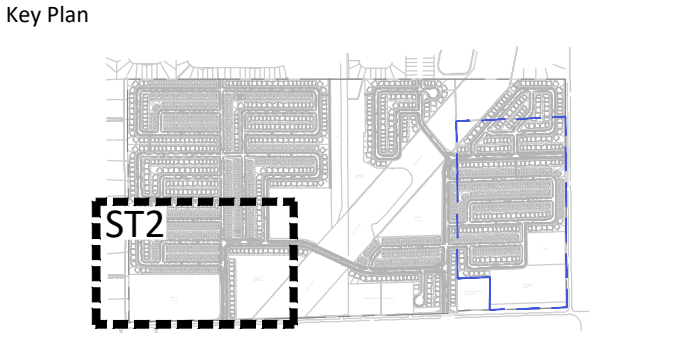

-		
6	East Parcel Lands Identified	Jun 17/25
5	Issued for Preliminary Streetscape Resubmission	Apr.14/25
4	Issued for Preliminary Streetscape Resubmission	Mar.24/25
3	Issued for Preliminary Streetscape Resubmission	Aug.9/24
2	Issued for Preliminary Streetscape Resubmission	Aug.2/24
1	Issued for Preliminary Streetscape Submission	July.18/24
No.	Description	Date
Revision		
City Approval Stamp		

NAK
design strategies

1285 WELLINGTON STREET, OTTAWA, ON K1Y 3A8 CANADA
T 613.237.2345
Project

STITTSVILLE WEST

Title		
PRELIMINARY STREETScape PLAN		
Date	2024-06-20	Sheet
Scale	1:750	ST2
Drawn	NM	
Checked	SE	
Job No.	21-273	

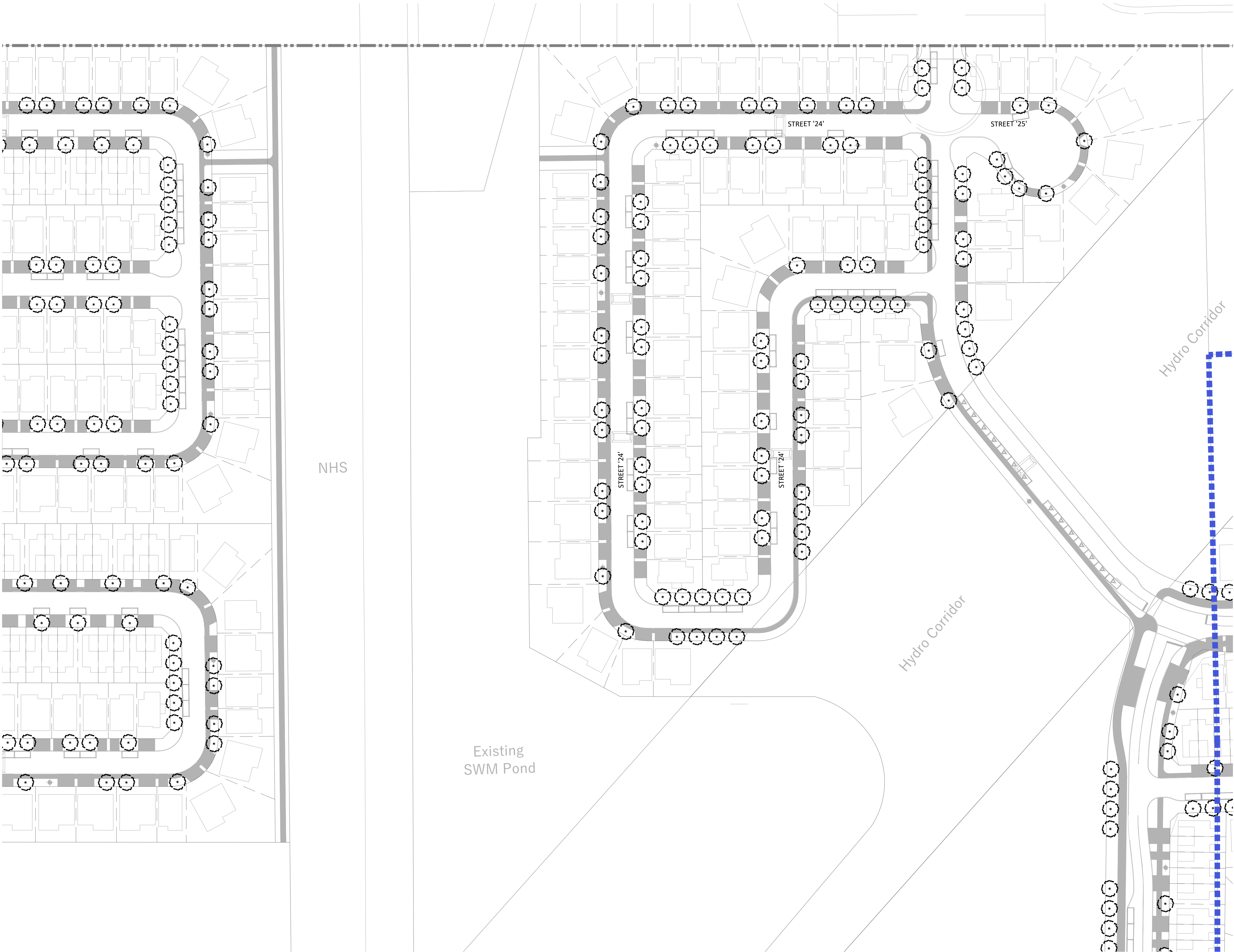

Contractor shall check all dimensions on the work and report any discrepancy to the Landscape Architect before proceeding. All drawings and specifications are the property of the Landscape Architect and must be returned at the completion of the work. This drawing is not to be used for construction until signed by the Landscape Architect.

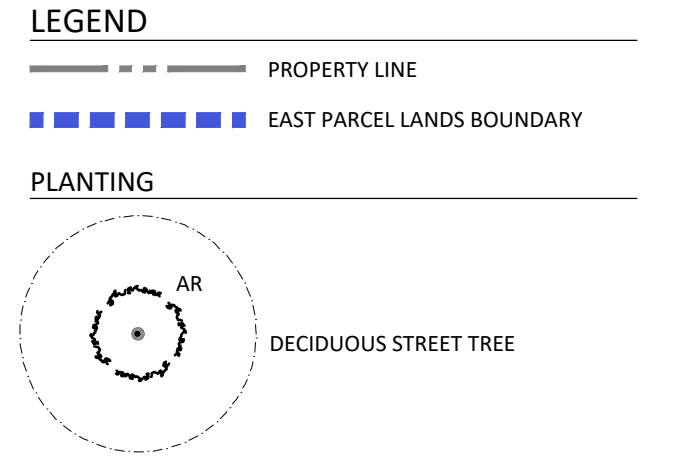
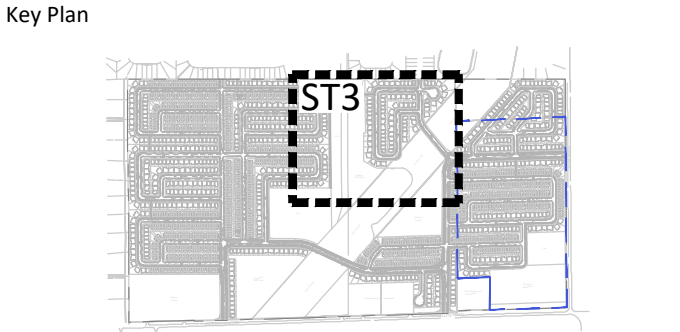

-		
6	East Parcel Lands Identified	Jun 17/25
5	Issued for Preliminary Streetscape Resubmission	Apr.14/25
4	Issued for Preliminary Streetscape Resubmission	Mar.24/25
3	Issued for Preliminary Streetscape Resubmission	Aug.9/24
2	Issued for Preliminary Streetscape Resubmission	Aug.2/24
1	Issued for Preliminary Streetscape Submission	July.18/24
No.	Description	Date
Revision		
City Approval Stamp		

NAK design strategies

1285 WELLINGTON STREET, OTTAWA, ON K1Y 3A8 CANADA
T 613.237.2345 NAKDESIGNSTRATEGIES.COM

Project

STITTSTVILLE WEST

Title

PRELIMINARY STREETScape PLAN

Date	2024-06-20	Sheet
Scale	1:750	ST3
Drawn	NM	
Checked	SE	
Job No.	21-273	

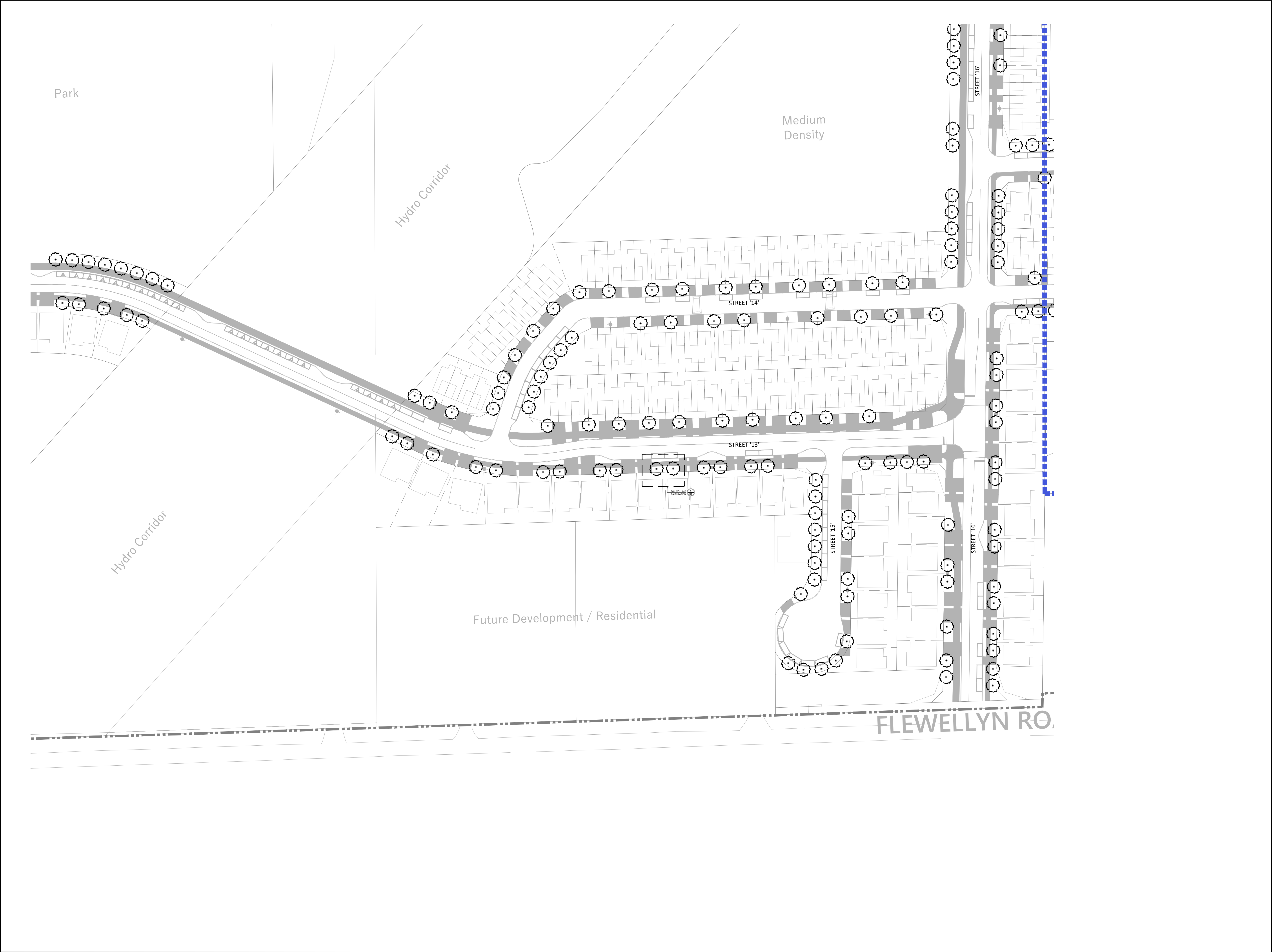

Contractor shall check all dimensions on the work and report any discrepancy to the Landscape Architect before proceeding. All drawings and specifications are the property of the Landscape Architect and must be returned at the completion of the work. This drawing is not to be used for construction until signed by the Landscape Architect.

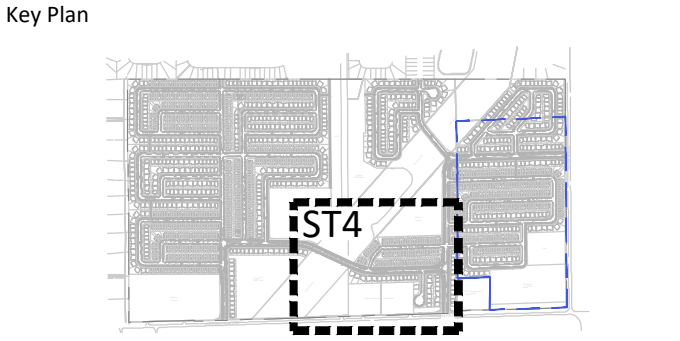

LEGEND

--- PROPERTY LINE

■■■■ EAST PARCEL LANDS BOUNDARY

PLANTING

AR DECIDUOUS STREET TREE

No.	Description	Date
6	East Parcel Lands Identified	Jun 17/25
5	Issued for Preliminary Streetscape Resubmission	Apr.14/25
4	Issued for Preliminary Streetscape Resubmission	Mar.24/25
3	Issued for Preliminary Streetscape Resubmission	Aug.9/24
2	Issued for Preliminary Streetscape Resubmission	Aug.2/24
1	Issued for Preliminary Streetscape Submission	July.18/24
Revision		
City Approval Stamp		

NAK
design strategies
1285 WELLINGTON STREET, OTTAWA, ON K1Y 3A8 CANADA
T 613.237.2345
Project

STITTSTVILLE WEST

Title		
PRELIMINARY STREETScape PLAN		
Date	2024-06-20	Sheet
Scale	1:750	ST4
Drawn	NM	
Checked	SE	
Job No.	21-273	

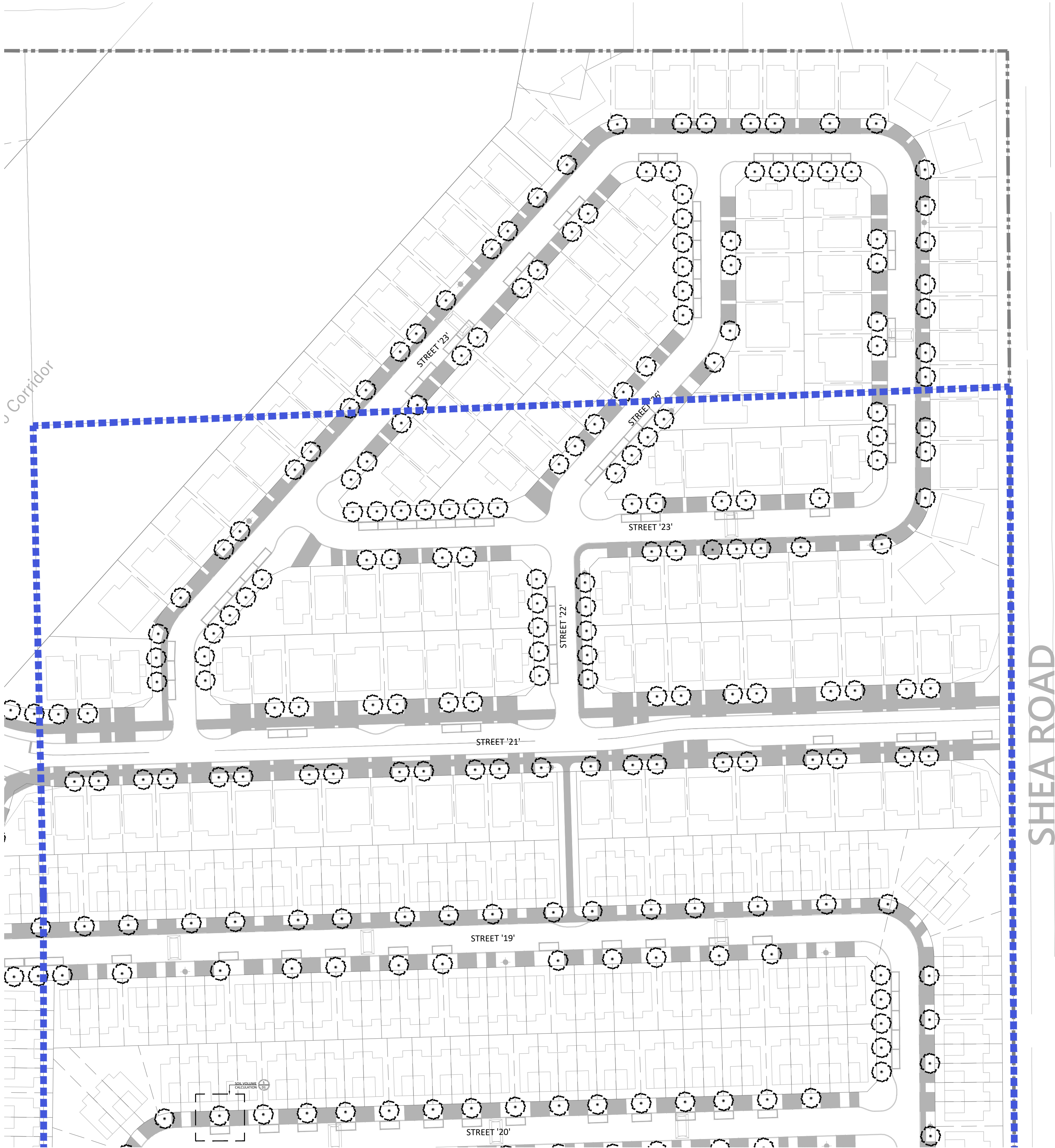

Contractor shall check all dimensions on the work and report any discrepancy to the Landscape Architect before proceeding. All drawings and specifications are the property of the Landscape Architect and must be returned at the completion of the work. This drawing is not to be used for construction until signed by the Landscape Architect.

Key Plan

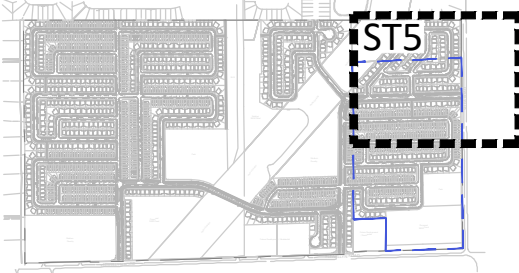

LEGEND

- PROPERTY LINE
- EAST PARCEL LANDS BOUNDARY

PLANTING

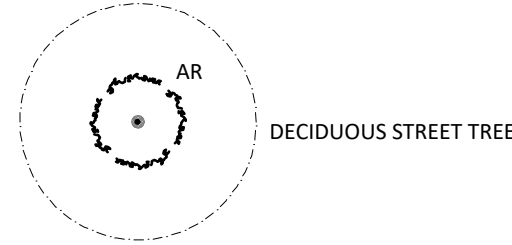

No.	Description	Date
6	East Parcel Lands Identified	Jun 17/25
5	Issued for Preliminary Streetscape Resubmission	Apr.14/25
4	Issued for Preliminary Streetscape Resubmission	Mar.24/25
3	Issued for Preliminary Streetscape Resubmission	Aug.9/24
2	Issued for Preliminary Streetscape Resubmission	Aug.2/24
1	Issued for Preliminary Streetscape Submission	July.18/24
Revision		
City Approval Stamp		

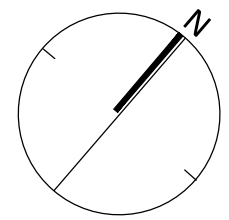

NAK
design strategies

1285 WELLINGTON STREET, OTTAWA, ON K1Y 3A8 CANADA
T 613.237.2345
Project

STITTSTVILLE WEST

Title
PRELIMINARY STREETScape PLAN

Date	2024-06-20	Sheet
Scale	1:750	ST5
Drawn	NM	
Checked	SE	
Job No.	21-273	

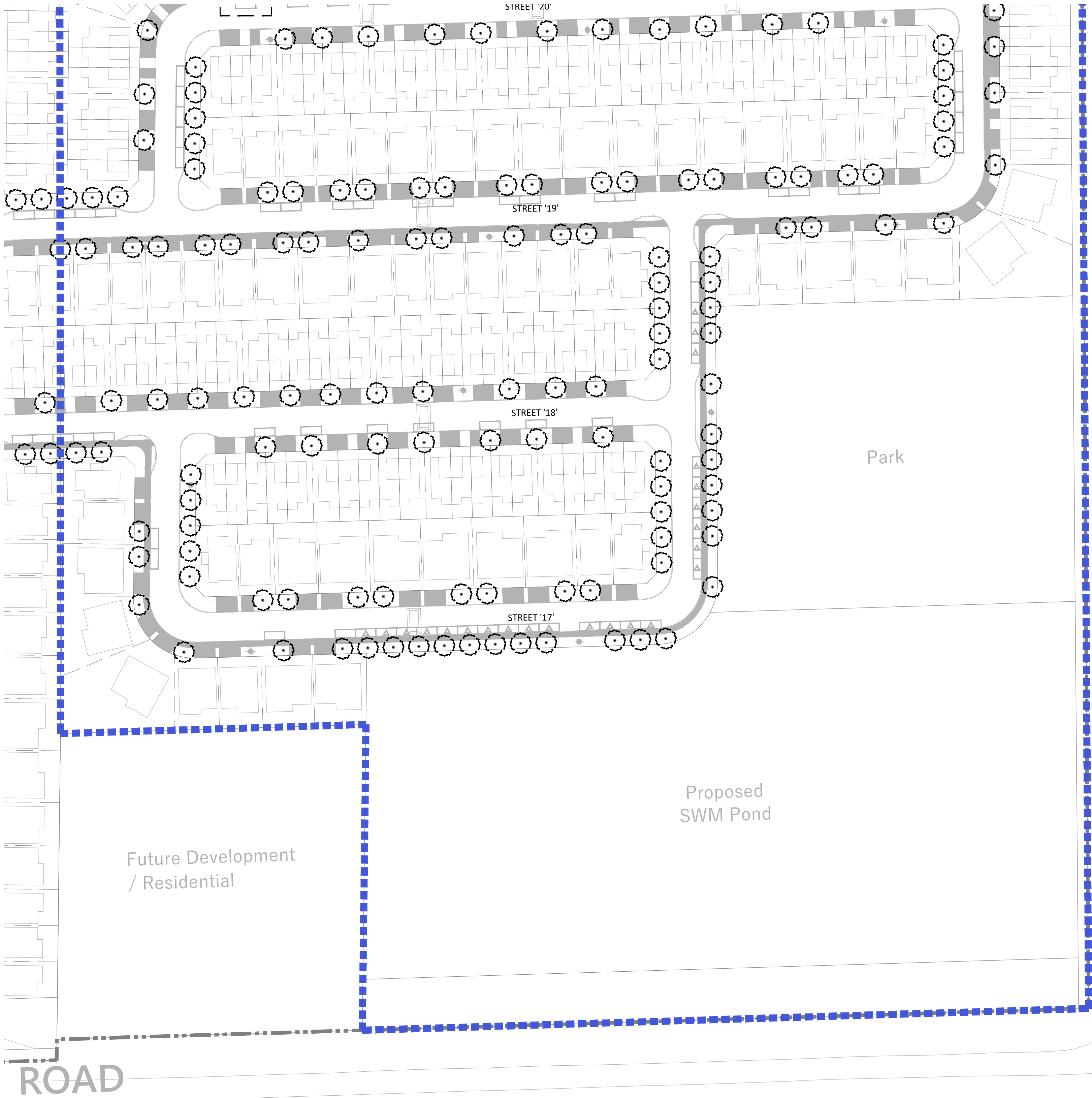

Contractor shall check all dimensions on the work and report any discrepancy to the Landscape Architect before proceeding. All drawings and specifications are the property of the Landscape Architect and must be returned at the completion of the work. This drawing is not to be used for construction until signed by the Landscape Architect.

Key Plan

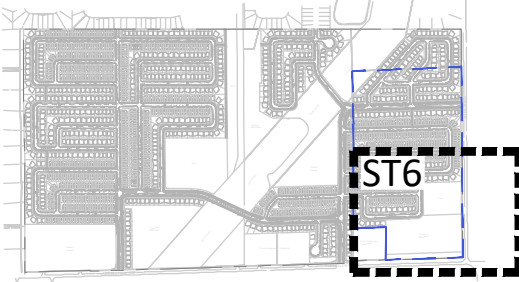

LEGEND

- PROPERTY LINE
- EAST PARCEL LANDS BOUNDARY

PLANTING

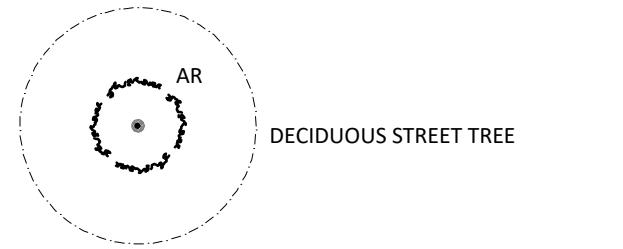

DECIDUOUS STREET TREE

-		
6	East Parcel Lands Identified	Jun 17/25
5	Issued for Preliminary Streetscape Resubmission	Apr.14/25
4	Issued for Preliminary Streetscape Resubmission	Mar.24/25
3	Issued for Preliminary Streetscape Resubmission	Aug.9/24
2	Issued for Preliminary Streetscape Resubmission	Aug.2/24
1	Issued for Preliminary Streetscape Submission	July.18/24
No.	Description	Date

Revision
City Approval Stamp

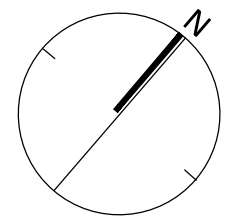

NAK
design strategies

1285 WELLINGTON STREET, OTTAWA, ON K1Y 3A8 CANADA
T 613.237.2345
Project

STITTSVILLE WEST

Title
PRELIMINARY STREETScape PLAN

Date	2024-06-20	Sheet
Scale	1:750	ST6
Drawn	NM	
Checked	SE	
Job No.	21-273	

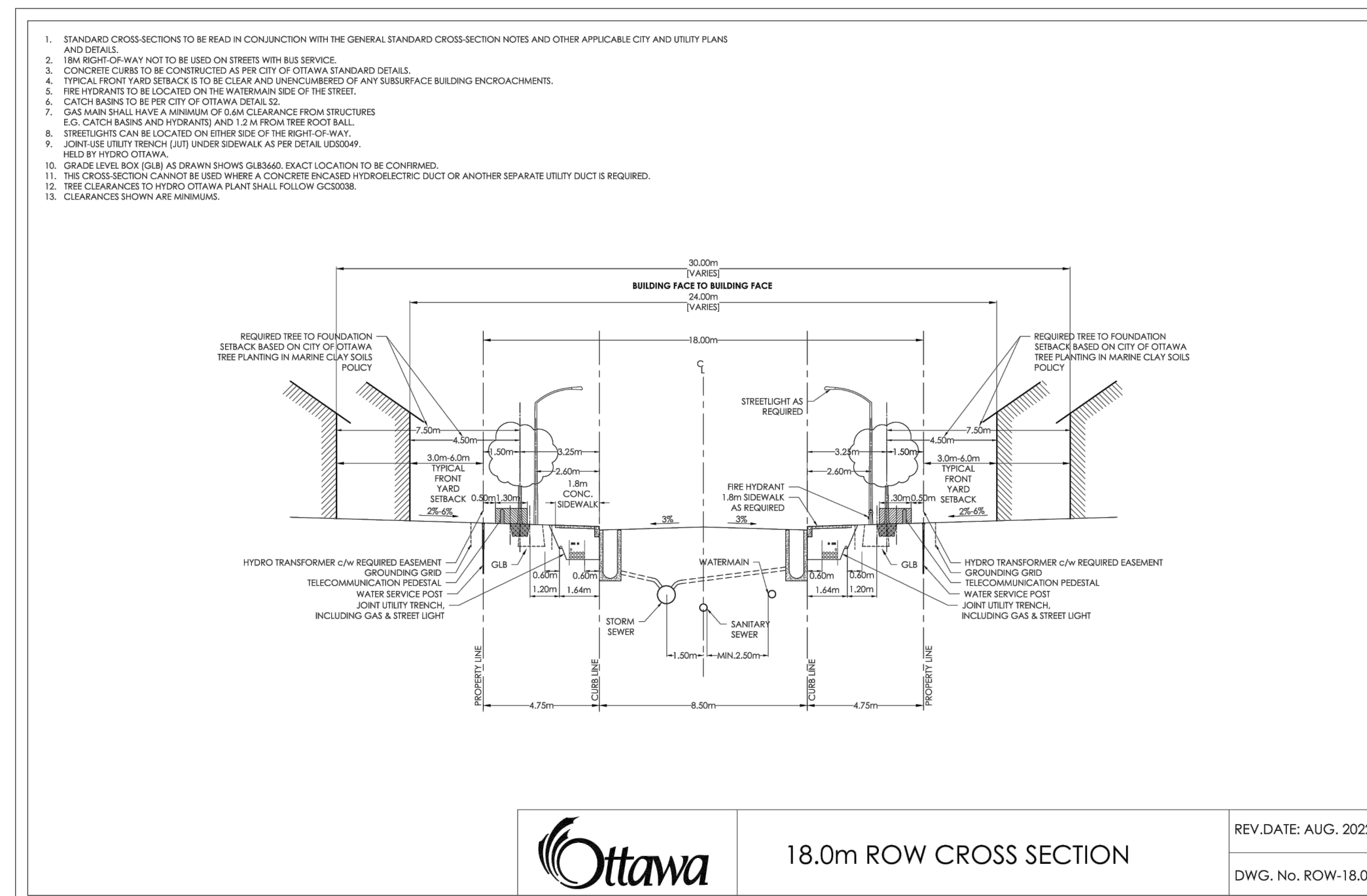
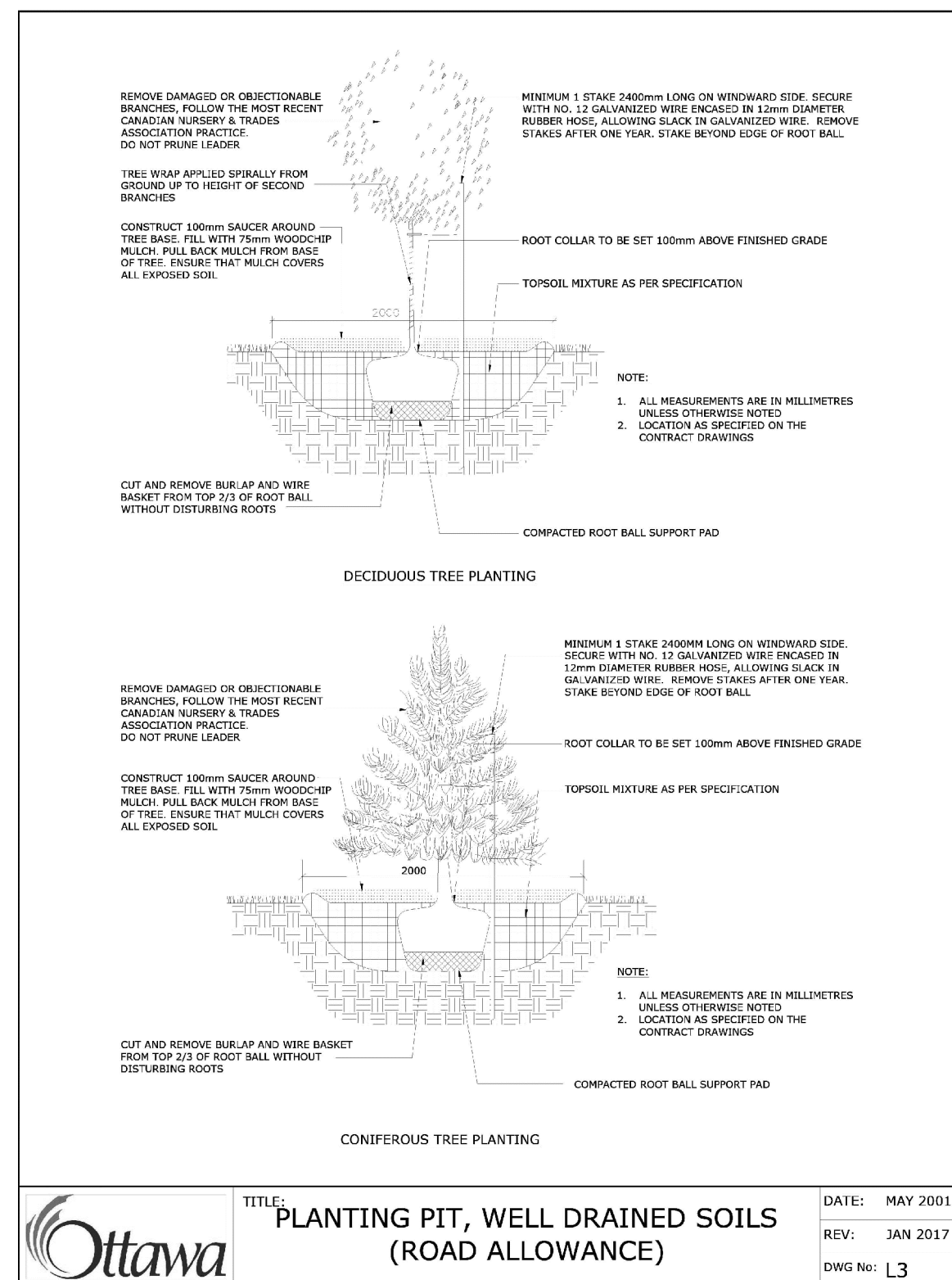

TREE SOIL VOLUMES		
TREE TYPE/SIZE	SINGLE TREE SOIL VOLUME	MULTIPLE TREE SOIL VOLUME (m3/TREE)
ORNAMENTAL	15	9
COLUMNAR	15	9
SMALL	20	12
MEDIUM	25	15
LARGE	30	18
CONIFER	25	15

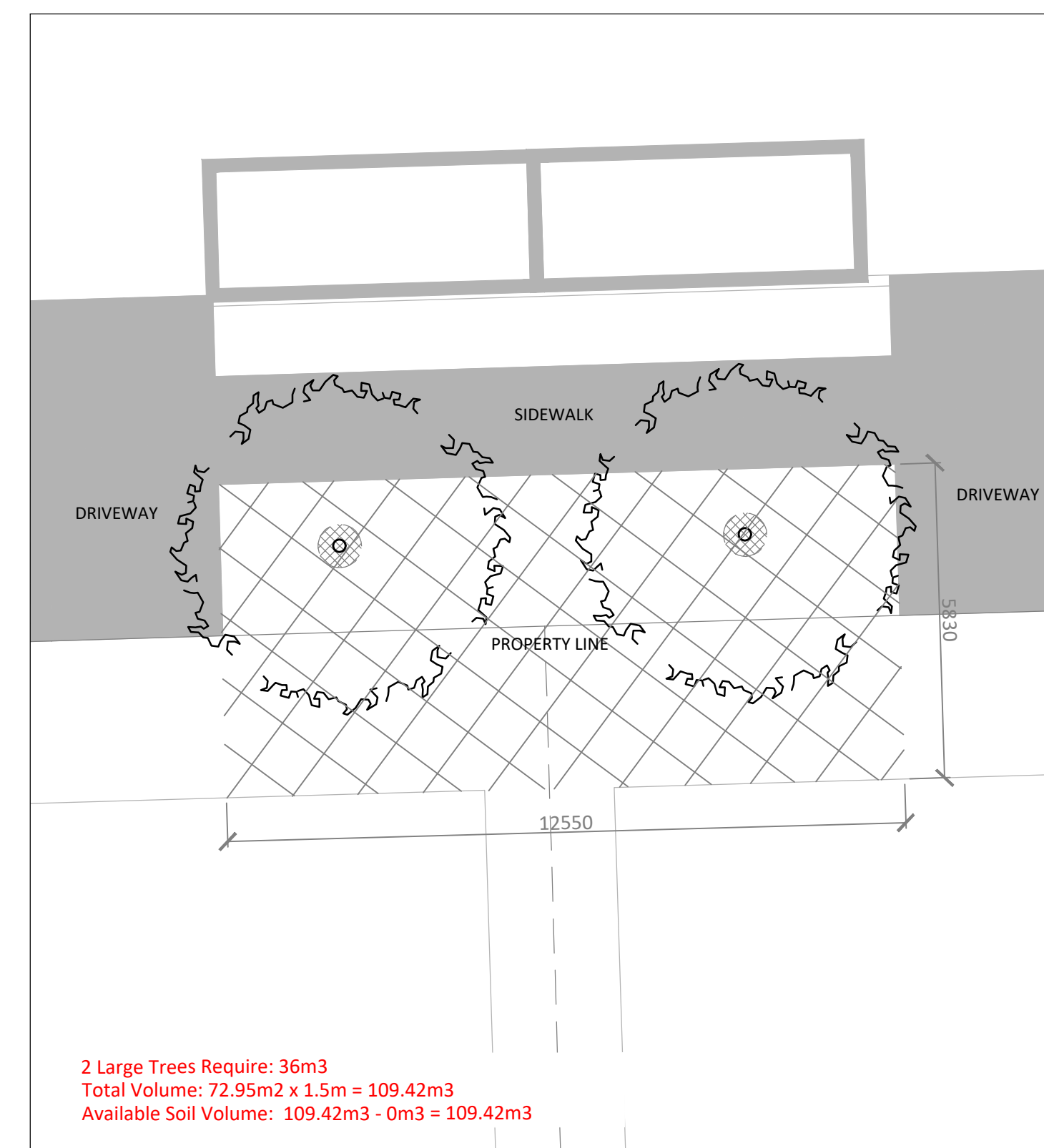
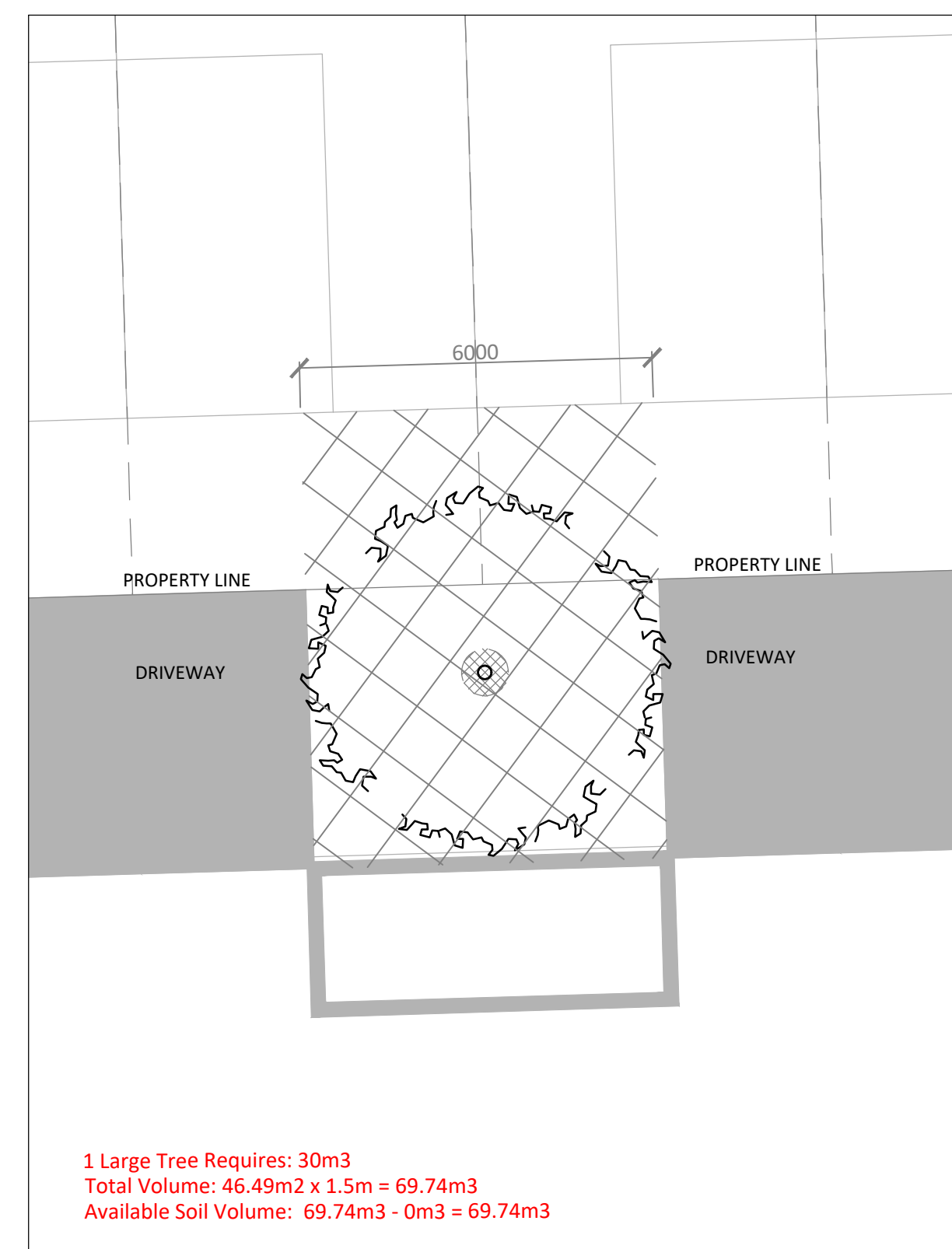
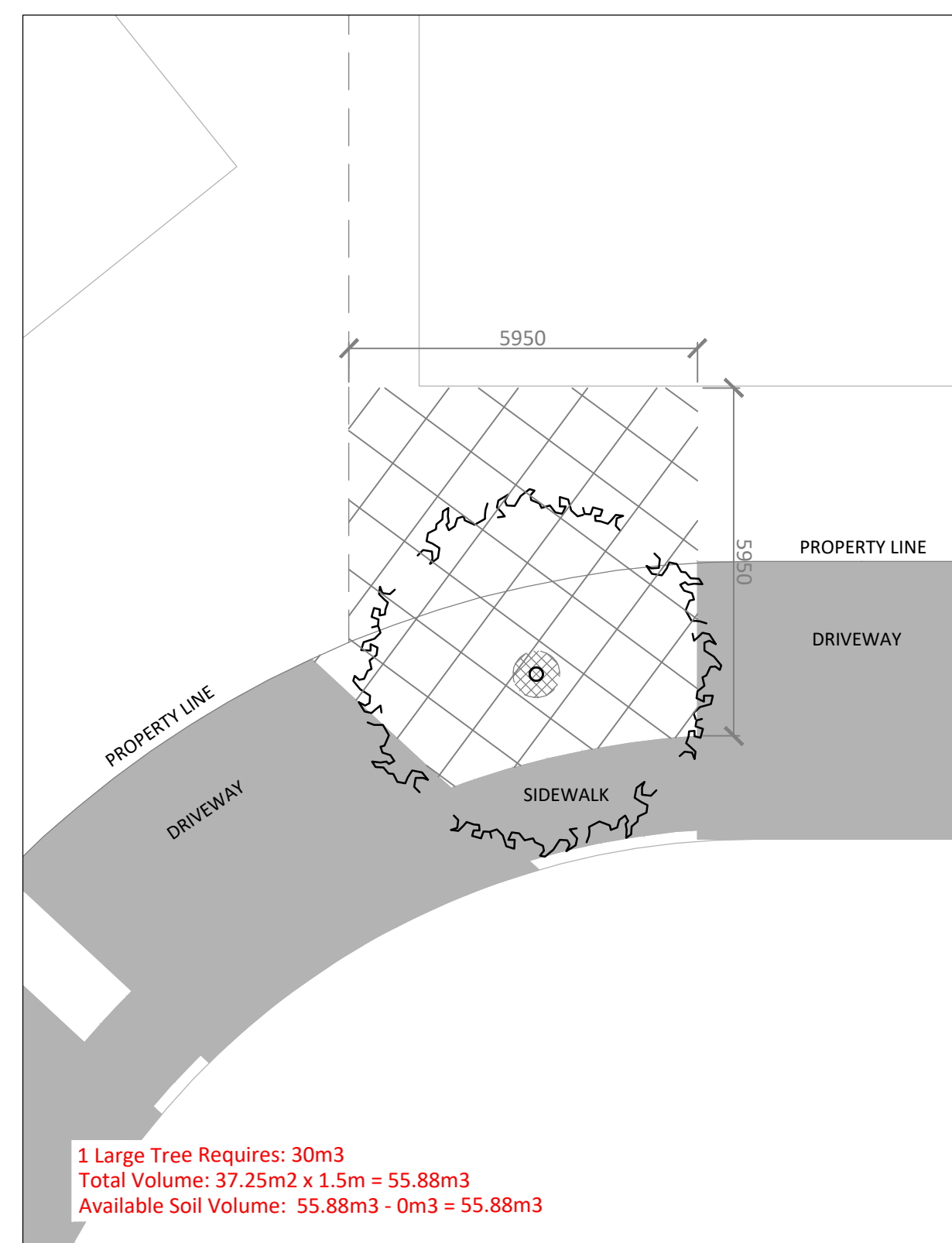
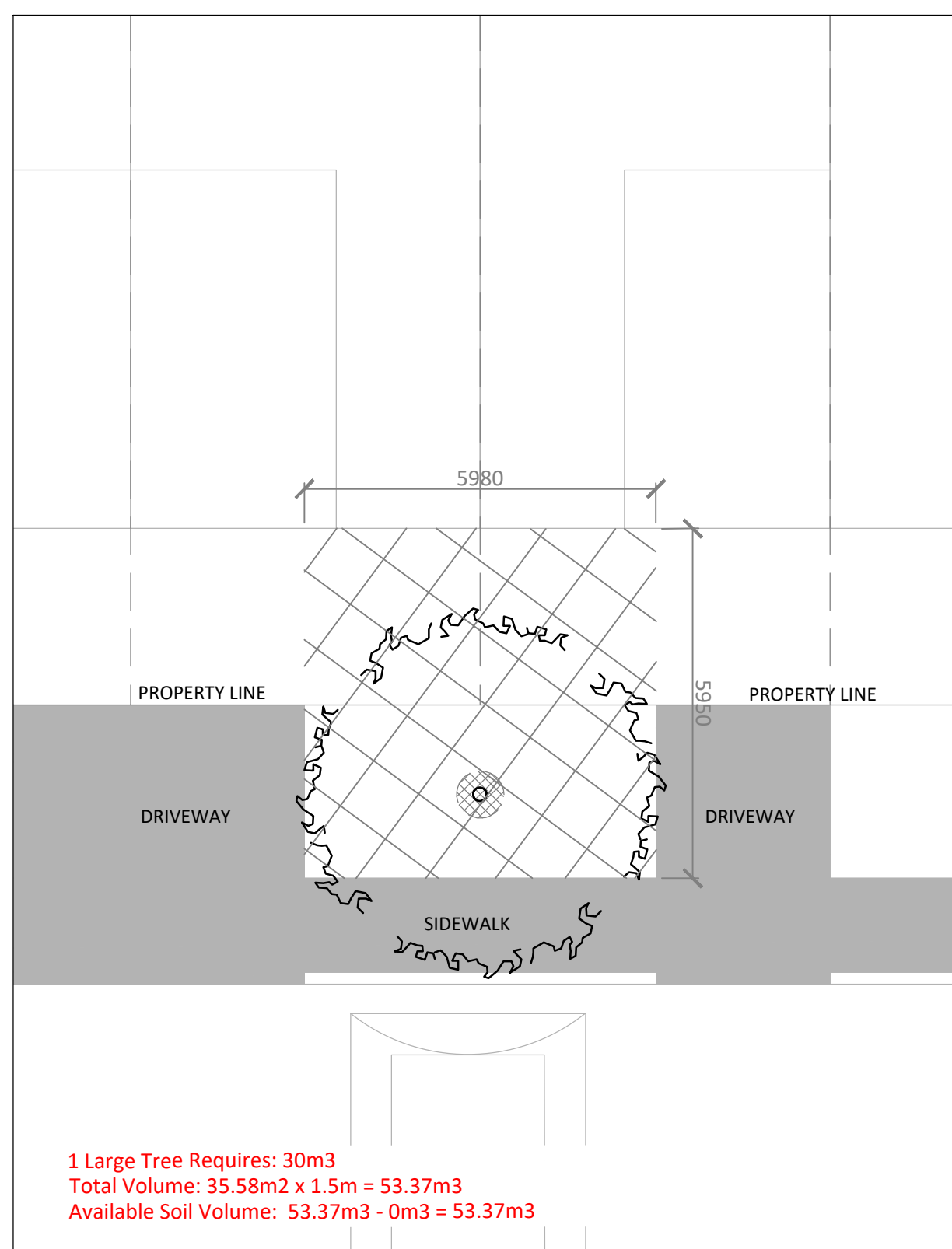

Contractor shall check all dimensions on the work and report any discrepancy to the Landscape Architect before proceeding. All drawings and specifications are the property of the Landscape Architect and must be returned at the completion of the work. This drawing is not to be used for construction until signed by the Landscape Architect.

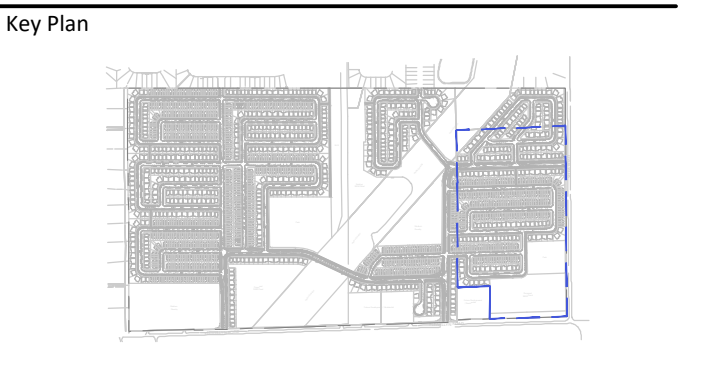

-		
6	East Parcel Lands Identified	Jun 17/25
5	Issued for Preliminary Streetscape Resubmission	Apr.14/25
4	Issued for Preliminary Streetscape Resubmission	Mar.24/25
3	Issued for Preliminary Streetscape Resubmission	Aug.9/24
2	Issued for Preliminary Streetscape Resubmission	Aug.2/24
1	Issued for Preliminary Streetscape Submission	July.18/24
No.	Description	Date
Revision		
City Approval Stamp		



STITTSVILLE WEST

Title

Date	2024-06-20	Sheet	D1
Scale	1:750		
Drawn	NM		
Checked	SE		
Job No.	21-273		