

DISCLAIMER:
THE SITE PLANS OF THE PRIVATELY-OWNED PROPERTIES ARE SHOWN FOR ILLUSTRATIVE PURPOSES ONLY. THE TREE SIZES AND GENERAL LOCATIONS SHOWN ARE CONCEPTUAL AND INTENDED ONLY FOR THE PURPOSE OF ASSESSING THE LIKELY TREE CANOPY COVER TARGETS STATED IN THE OFFICIAL PLAN. DETAILED CANOPY COVER AND SOIL VOLUME CALCULATIONS WILL BE COMPLETED AS SITE PLAN CONTROL APPLICATIONS ARE ADVANCED AND WILL BE REFLECTED AS PER THE TERMS OF REFERENCE FOR THE PREPARATION OF LANDSCAPE PLANS PUBLISHED BY THE CITY OF OTTAWA.

NOTES:
DO NOT SCALE DRAWINGS;
NOTES ARE APPLICABLE TO ALL DRAWINGS IN THE SET;
Fotenn Consultants Inc. IS NOT RESPONSIBLE FOR ACCURACY OF BASE INFORMATION;
REFER TO CIVIL ENGINEERING DRAWINGS FOR GRADING & SITE SERVICING INFORMATION;

THE CONTRACTOR IS RESPONSIBLE FOR CONFIRMING SITE CONDITIONS AND REPORTING ANY DISCREPANCIES TO THE LANDSCAPE ARCHITECT;
THE CONTRACTOR IS RESPONSIBLE FOR CONFIRMING EXACT LOCATIONS OF ALL UNDERGROUND SERVICES AND OBTAINING CLEARANCE FROM ALL APPLICABLE UTILITIES. PROPOSED WORKS FOUND TO BE IN CONFLICT WITH UNDERGROUND SERVICES MAY BE ADJUSTED AT THE DIRECTION OF THE LANDSCAPE ARCHITECT;
LANDSCAPE ELEMENTS SHOWN ARE SUBJECT TO THE FINAL LOCATION OF UNDERGROUND SERVICES AND UTILITIES;
DO NOT INSTALL TREES ON PROPERTY / LOT LINES OR WITHIN DRAINAGE EASEMENTS;
PERFORM WORK IN ACCORDANCE WITH DETAILS AND SPECIFICATIONS;
ALL PLANT MATERIAL SHALL BE No. 1 NURSERY STOCK AND SHALL MEET OR EXCEED THE SPECIFICATION OF THE Canadian Standards for Nursery Stock, AS PUBLISHED BY THE Canadian Nursery Landscape Association;
SPECIES SUBSTITUTIONS ARE NOT PERMITTED WITHOUT PRIOR WRITTEN APPROVAL OF THE LANDSCAPE ARCHITECT;
ALL UN-PAVED SURFACES TO RECEIVE 150mm DEPTH TOPSOIL & SOD UNLESS INDICATED OTHERWISE.

STANDARDS FOR TREE PLANTING:
NO PLANTING ON CORNERS OR ANYWHERE WHERE IT WOULD CREATE A SIGHT LINE CONCERN;
MAINTAIN A MINIMUM DISTANCE OF 4.5m FROM ALL BUILDINGS;
MAINTAIN A MINIMUM DISTANCE OF 2.5m FROM THE CURB FOR DECIDUOUS TREES AND 4.5m FOR CONIFEROUS TREES;
MAINTAIN A MINIMUM DISTANCE OF 1.5m FOR DECIDUOUS (4.5m FOR CONIFERS) FROM ANY 1.85m SIDEWALK OR PRIVATE WALKWAY;
MAINTAIN A MINIMUM DISTANCE OF 1.2m FROM ALL DRIVEWAYS;
MAINTAIN A MINIMUM DISTANCE OF 2.5m FROM COMMUNITY MAILBOXES, LIGHT STANDARDS, FIRE HYDRANTS AND NO PLANTING IN FRONT OF HYDRANTS;
MAINTAIN A MINIMUM DISTANCE OF 3.0m FROM ALL HYDRO TRANSFORMERS;
MAINTAIN A MINIMUM DISTANCE OF 1.0m FROM ALL UNDERGROUND SERVICES;

MAINTAIN A MINIMUM DISTANCE OF 1.0m FROM ALL BELL AND CABLE BOXES;
MAINTAIN A MINIMUM DISTANCE OF 10.0 FROM BUS SHELTERS
IMPORTANT NOTICE FOR CONTRACTOR:
THE CITY OF OTTAWA REQUIRES A Certificate of Completion (F1) Landscape Works TO BE SUBMITTED AND SEALED BY THE LANDSCAPE ARCHITECT. CONTRACTORS ARE RESPONSIBLE FOR FAMILIARIZING THEMSELVES WITH THE REQUIREMENTS OF THIS PROCESS AND PROVIDING SUFFICIENT NOTICE TO THE LANDSCAPE ARCHITECT TO CONDUCT SITE REVIEWS **DURING INSTALLATION** OF TREES. THE 1 YEAR WARRANTY PERIOD SHALL NOT COMMENCE UNTIL THE LANDSCAPE ARCHITECT HAS SUBMITTED THE F1 Certificate.
PRIOR TO INSTALLATION OF TREES, THE DEVELOPER WILL CONTACT THE PLANNING AND GROWTH MANAGEMENT AND FORESTRY SERVICES TO REVIEW THE SPECIES AND LOCATION OF TREES.

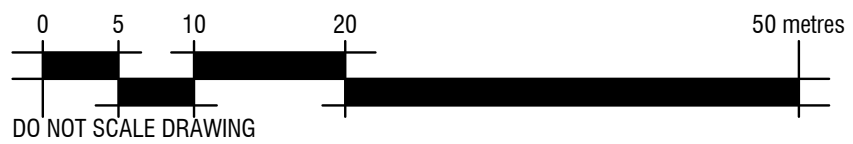
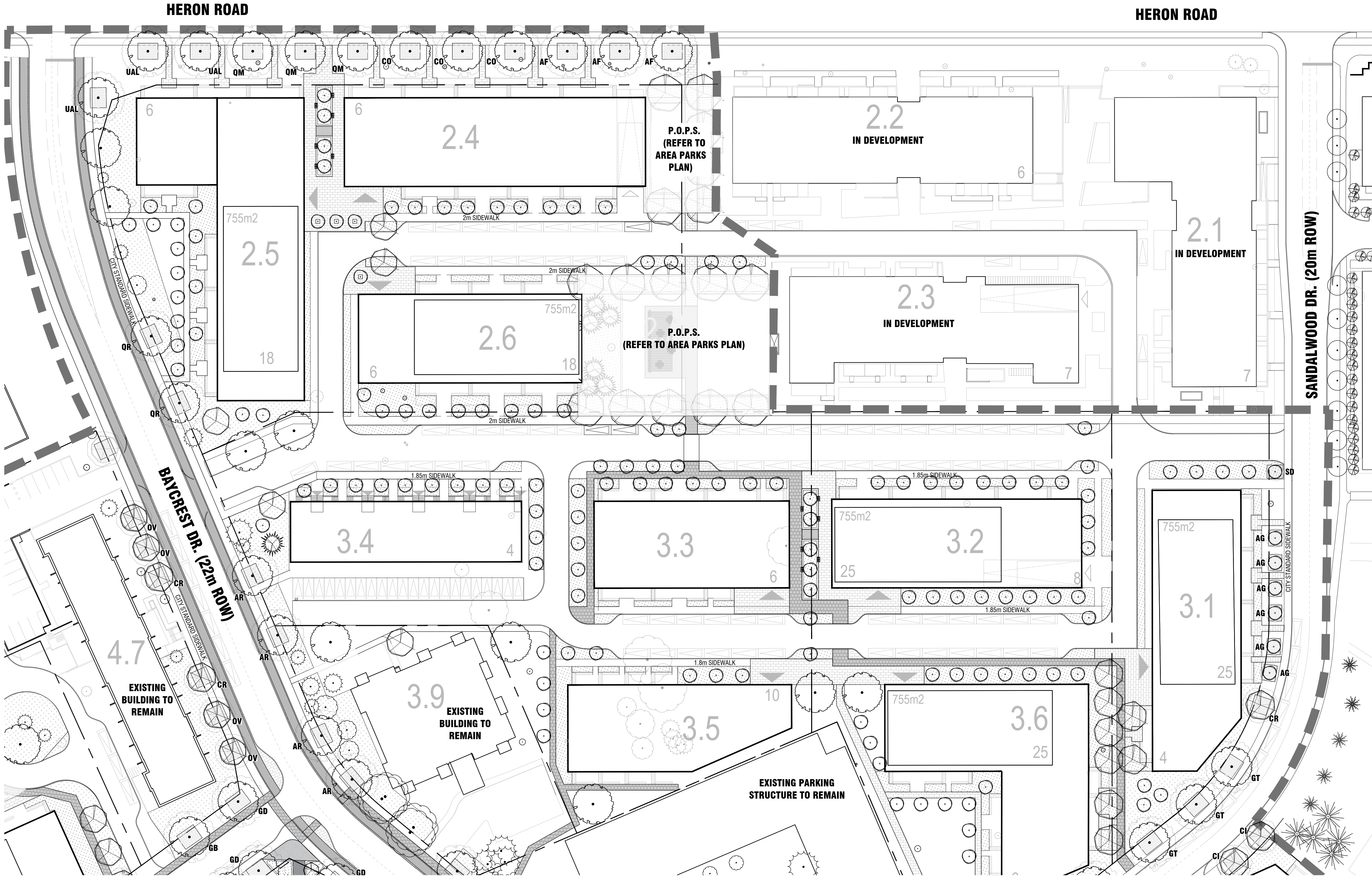

1 SUBDIVISION LANDSCAPE PLAN
L1 1:500

Copyright Reserved
The Copyrights to all designs and drawings are the property of Fotenn Consultants Inc. Unauthorized reproduction or use is forbidden. DO NOT SCALE DRAWING
Copyright réservés
Les droits d'auteur à tous les modèles et dessins sont la propriété de Fotenn Consultants Inc.
Reproduction ou utilisation non autorisée est interdite. NE PAS L'ÉCHELLE DE DESSIN
Client / Client



key plan / plan repère

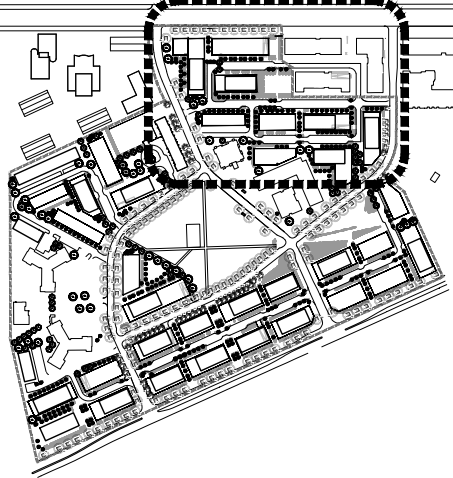

- legend / légende
- LIMIT OF APPLICATION
 - PROPOSED PROPERTY LINES
 - EXISTING TREES TO REMAIN
 - EXISTING TREES TO BE REMOVED - REFER TO TREE CONSERVATION REPORT
 - PROPOSED DECIDUOUS AND CONIFEROUS TREES - REFER TO L5 FOR SPECIES LIST
 - PROJECTED CANOPY AT 40 YEARS
 - REQUIRED SOIL VOLUME ASSUMING 1.5m DEPTH (CONCEPTUAL)
 - UNIT PAVER
 - SPECIALTY PAVING AT WALKING LOOP
 - CIP CONCRETE
 - ASPHALT
 - OPPORTUNITY FOR NATURALIZED OR L.I.D. PLANTING ZONES
 - PLANTING BEDS
 - MULCH
 - DESTINATIONS ALONG WALKING LOOP

rev'n	description / la description	yyyy/mm/dd
03	Reissued for ZBA & DPDS	2025/11/04
02	issue for ZBA & DPDS	2025/07/15
01	issue for coordination	2025/06/03
00	issue for client review	2025/05/26

FOTENN Planning + Design
420 O'Connor Street
Ottawa, ON, CANADA K2P 1W4
613.730.5709
fotenn.com

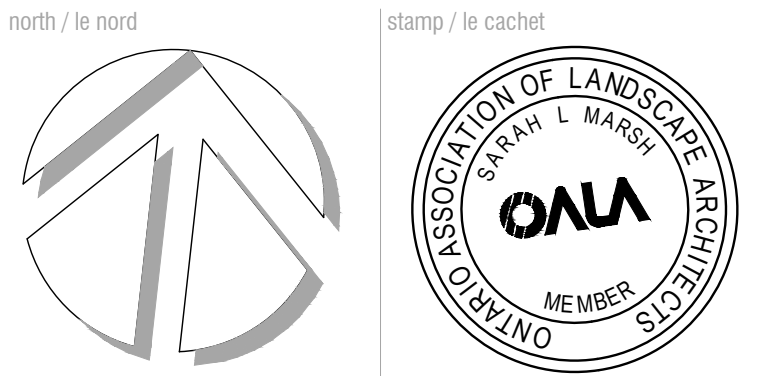

project / projet

HERON GATE MASTERPLAN

drawing / dessin

LANDSCAPE PLAN

designed / conçu EM / SM / DF / SP	drawn / dessiné EM / SM / DF / SP	reviewed / examiné SM / DF
date May 2025	project number / No. du projet	

drawing number / No. du dessin

L1

PLOT INFORMATION: DWG NAME: P:\PROJECTS\Herengate\Heron Gate Master Plan\L1.dwg DrawingPath\Heron Gate Master Plan\L1.dwg PLOT DATE: 2025-11-04 4:19:45 PM SHEET SIZE: ISO Millimeter (A) 594.00 x 841.00 MM PLOTTED BY: Emily Maderna LAST SAVED BY: emaderna

DISCLAIMER:
THE SITE PLANS OF THE PRIVATELY-OWNED PROPERTIES ARE SHOWN FOR ILLUSTRATIVE PURPOSES ONLY. THE TREE SIZES AND GENERAL LOCATIONS SHOWN ARE CONCEPTUAL AND INTENDED ONLY FOR THE PURPOSE OF ASSESSING THE LIKELY TREE CANOPY COVER TARGETS STATED IN THE OFFICIAL PLAN. DETAILED CANOPY COVER AND SOIL VOLUME CALCULATIONS WILL BE COMPLETED AS SITE PLAN CONTROL APPLICATIONS ARE ADVANCED AND WILL BE REFLECTED AS PER THE TERMS OF REFERENCE FOR THE PREPARATION OF LANDSCAPE PLANS PUBLISHED BY THE CITY OF OTTAWA.

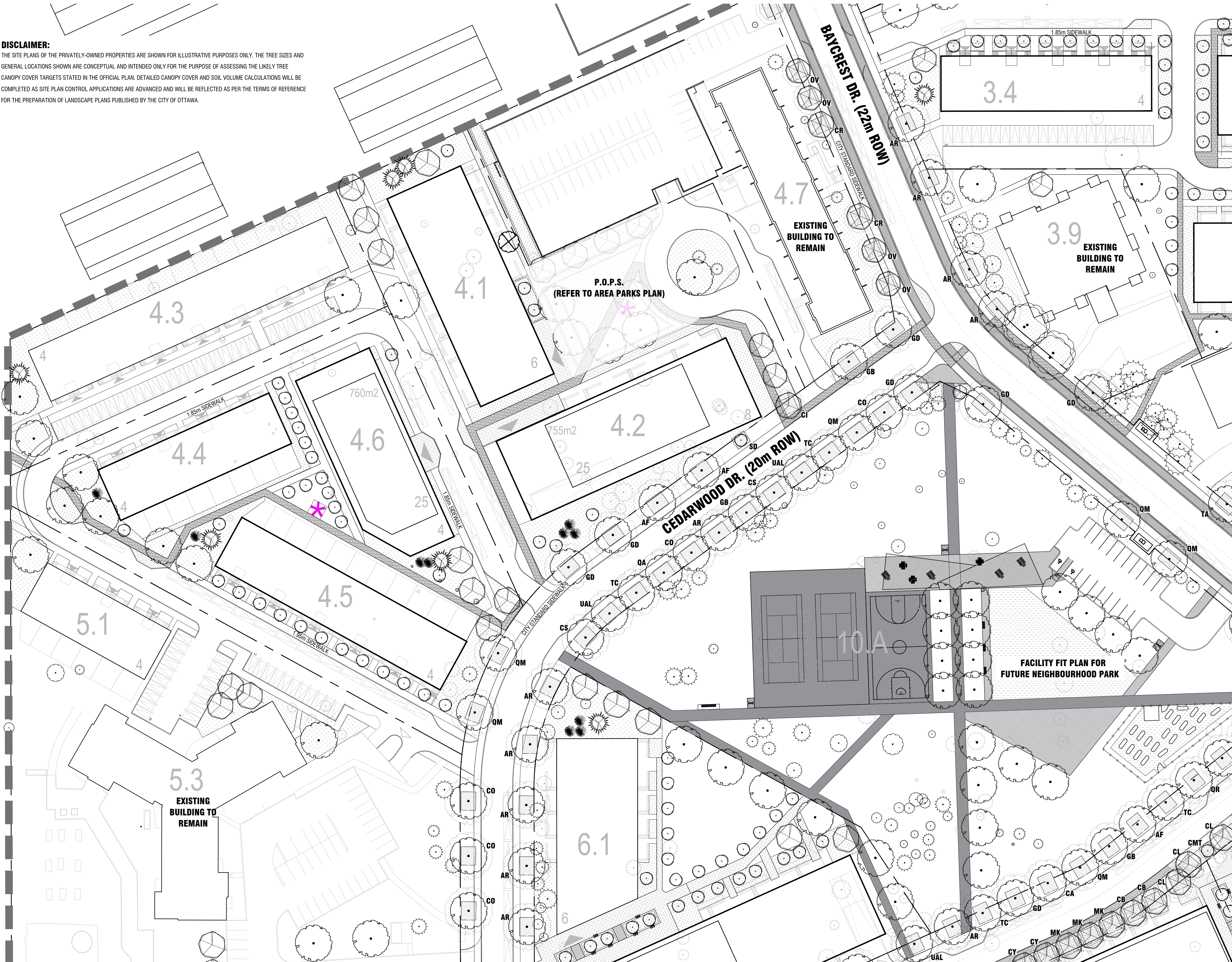

Copyright Reserved
The Copyrights to all designs and drawings are the property of Fotenn Consultants Inc. Unauthorized reproduction or use is forbidden. DO NOT SCALE DRAWING

Copyright réservés
Les droits d'auteur à tous les modèles et dessins sont la propriété de Fotenn Consultants Inc. Reproduction ou utilisation non autorisée est interdite. NE PAS L'ÉCHELLE DE DESSIN

Client / Client



key plan / plan repère

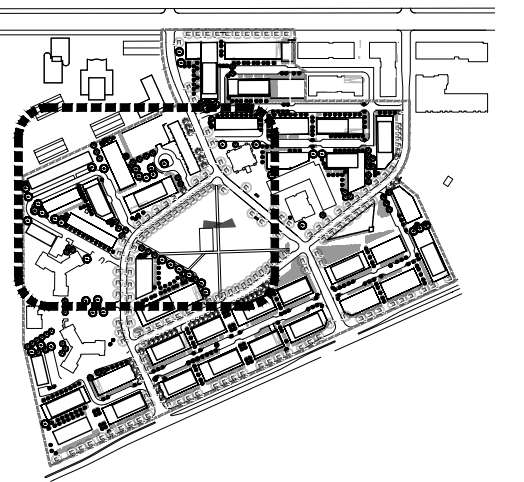

legend / légende

- LIMIT OF APPLICATION
- - - PROPOSED PROPERTY LINES
- Existing trees to remain
- Existing trees to be removed - refer to tree conservation report
- Proposed deciduous and coniferous trees - refer to L5 for species list
- Projected canopy at 40 years
- Required soil volume assuming 1.5m depth (conceptual)
- UNIT PAVER
- SPECIALTY PAVING AT WALKING LOOP
- CIP CONCRETE
- ASPHALT
- OPPORTUNITY FOR NATURALIZED OR L.I.D. PLANTING ZONES
- PLANTING BEDS
- MULCH
- ★ DESTINATIONS ALONG WALKING LOOP

rev'n	description / la description	yyyy/mm/dd
03	Reissued for ZBA & DPDS	2025/11/04
02	issue for ZBA & DPDS	2025/07/15
01	issue for coordination	2025/06/03
00	issue for client review	2025/05/26

FOTENN Planning + Design
420 O'Connor Street
Ottawa, ON, CANADA K2P 1W4
613.730.5709
fotenn.com

north / le nord

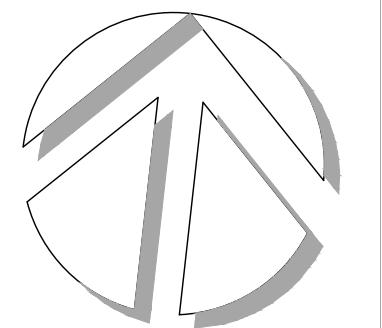

stamp / le cachet

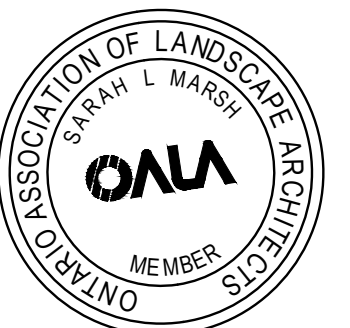

project / projet

HERON GATE MASTERPLAN

drawing / dessin

LANDSCAPE PLAN

designed / conçu	drawn / dessiné	reviewed / examiné
EM / SM / DF / SP	EM / SM / DF / SP	SM / DF
date	project number / No. du projet	

May 2025

drawing number / No. du dessin

L2

1 SUBDIVISION LANDSCAPE PLAN
L2 1:500



PLOT INFORMATION: DWG NAME: P:\PROJECTS\Heron\Heron_Gate_Master_Plan\L2\L2_Drawing\Heron\Heron_Gate_Master_Plan\L2\L2_Drawing.dwg PLOT DATE: 2025-11-04 2:03:59 PM SHEET SIZE: ISO A (210x297mm) SHEET SIZE: ISO A (210x297mm) PLOTTED BY: Emily Madonia LAST SAVED BY: emadonia

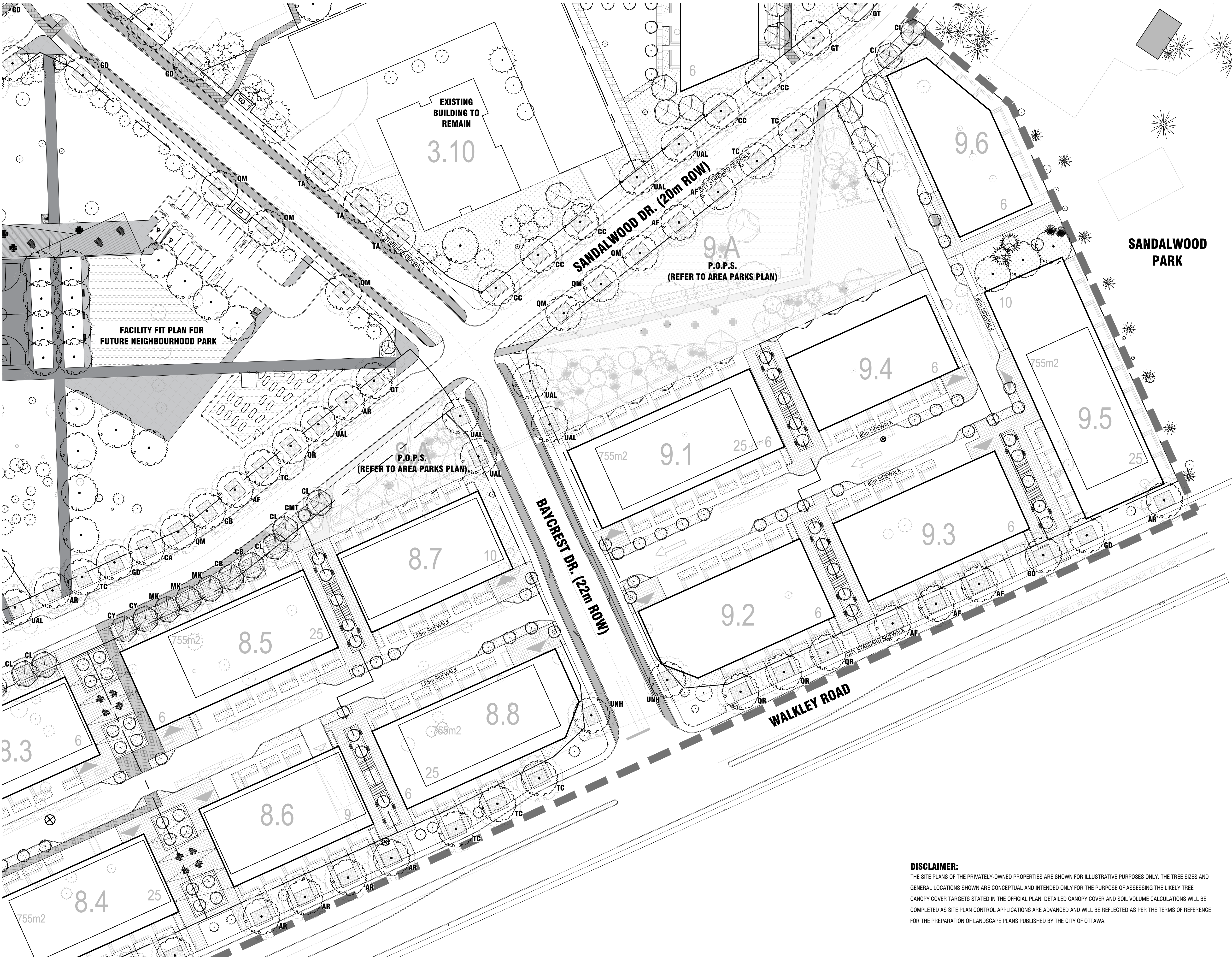

DISCLAIMER:
THE SITE PLANS OF THE PRIVATELY-OWNED PROPERTIES ARE SHOWN FOR ILLUSTRATIVE PURPOSES ONLY. THE TREE SIZES AND GENERAL LOCATIONS SHOWN ARE CONCEPTUAL AND INTENDED ONLY FOR THE PURPOSE OF ASSESSING THE LIKELY TREE CANOPY COVER TARGETS STATED IN THE OFFICIAL PLAN. DETAILED CANOPY COVER AND SOIL VOLUME CALCULATIONS WILL BE COMPLETED AS SITE PLAN CONTROL APPLICATIONS ARE ADVANCED AND WILL BE REFLECTED AS PER THE TERMS OF REFERENCE FOR THE PREPARATION OF LANDSCAPE PLANS PUBLISHED BY THE CITY OF OTTAWA.



Copyright Reserved
The Copyrights to all designs and drawings are the property of Fotenn Consultants Inc. Unauthorized reproduction or use is forbidden. DO NOT SCALE DRAWING
Copyright réservés
Les droits d'auteur à tous les modèles et dessins sont la propriété de Fotenn Consultants Inc.
Reproduction ou utilisation non autorisée est interdite. NE PAS L'ÉCHELLE DE DESSIN

Client / Client



key plan / plan repère

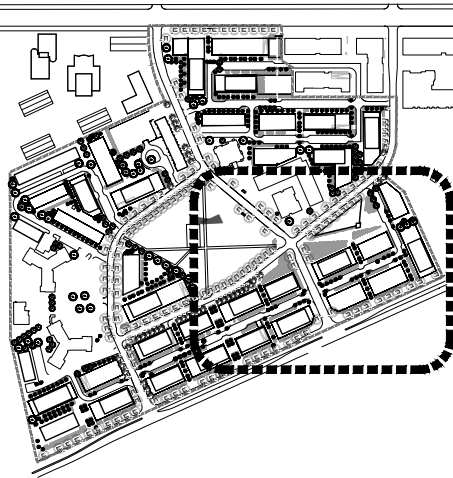

legend / légende

- LIMIT OF APPLICATION
- PROPOSED PROPERTY LINES
- EXISTING TREES TO REMAIN
- EXISTING TREES TO BE REMOVED - REFER TO TREE CONSERVATION REPORT
- PROPOSED DECIDUOUS AND CONIFEROUS TREES - REFER TO L5 FOR SPECIES LIST
- PROJECTED CANOPY AT 40 YEARS
REQUIRED SOIL VOLUME ASSUMING 1.5m DEPTH (CONCEPTUAL)
- UNIT PAVER
- SPECIALTY PAVING AT WALKING LOOP
- CIP CONCRETE
- ASPHALT
- OPPORTUNITY FOR NATURALIZED OR L.I.D. PLANTING ZONES
- PLANTING BEDS
- MULCH
- DESTINATIONS ALONG WALKING LOOP

03	Reissued for ZBA & DPDS	2025/11/04
02	issue for ZBA & DPDS	2025/07/15
01	issue for coordination	2025/06/03
00	issue for client review	2025/05/26
rev'n	description / la description	yyyy/mm/dd

FOTENN Planning + Design
420 O'Connor Street
Ottawa, ON, CANADA K2P 1W4
613.730.5709
fotenn.com

north / le nord

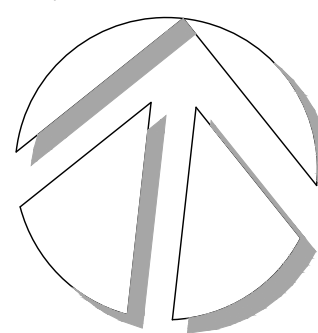

stamp / le cachet



project / projet

HERON GATE MASTERPLAN

drawing / dessin

LANDSCAPE PLAN

designed / conçu EM / SM / DF / SP	drawn / dessiné EM / SM / DF / SP	reviewed / examiné SM / DF
date May 2025	project number / No. du projet	

drawing number / No. du dessin

L3

1
L3
SUBDIVISION LANDSCAPE PLAN
1:500

PLOT INFORMATION: DWG NAME: P:\PROJECTS\heron\heron_gate_masterplan\dwg\landscape\landscape.dwg PLOT DATE: 2025-11-04 2:07:19 PM SHEET SIZE: US Letter A (9.5x14.0) INCHES PLOTTED BY: Emily Maderna LAST SAVED BY: emaderna

PLOT INFORMATION: DWG NAME: P:\PROJECTS\Heron\Heron Gate Master Plan\L4\07_Drawing\HeronGateMasterPlan_L4.dwg PLOT DATE: 2025-11-04 2:20:39 PM SHEET SIZE: ISO A1 (841.00 x 594.00 mm) PLOTTED BY: Emily Maderna LAST SAVED BY: emaderna

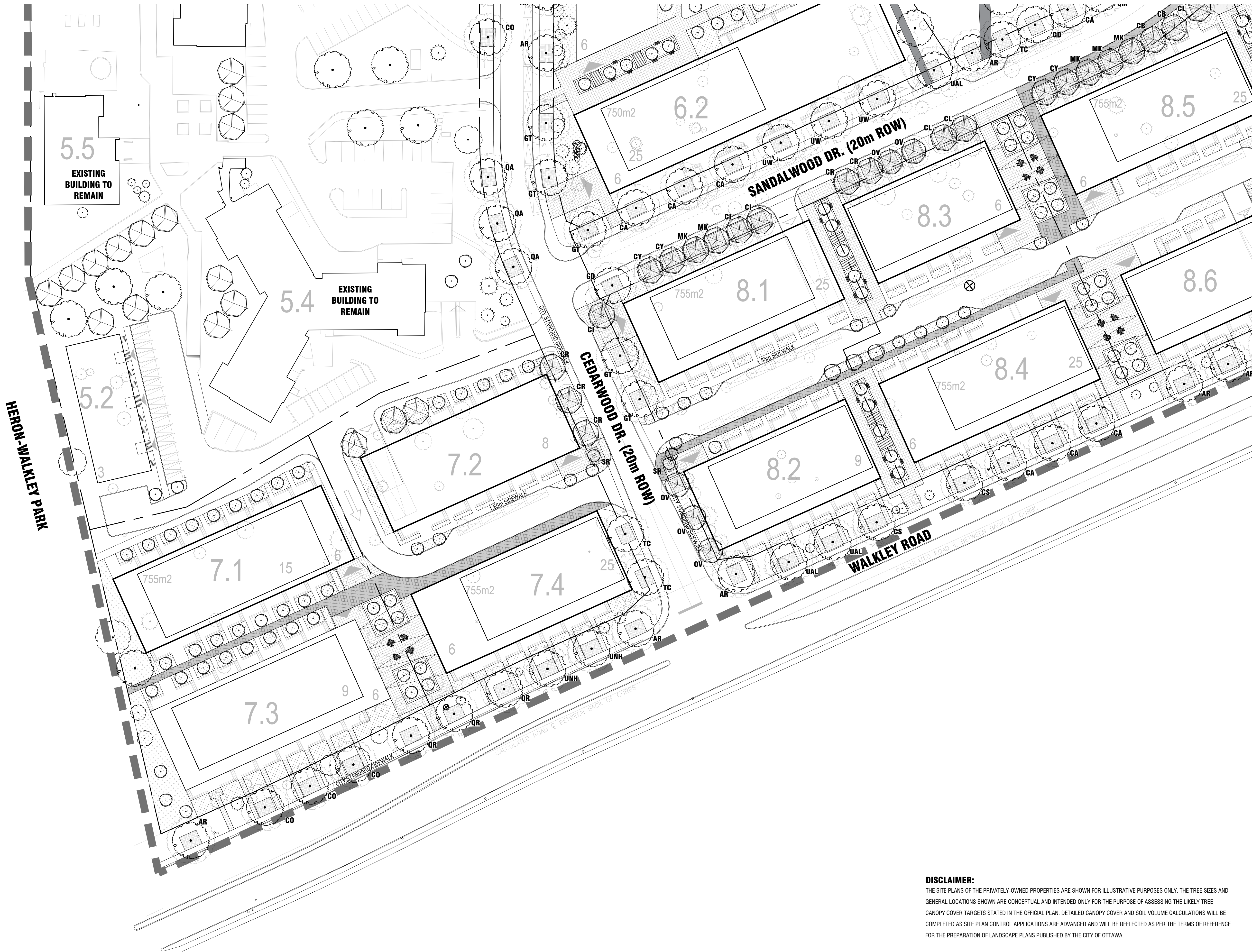

1
L4 **SUBDIVISION LANDSCAPE PLAN**
1:500

DISCLAIMER:
THE SITE PLANS OF THE PRIVATELY-OWNED PROPERTIES ARE SHOWN FOR ILLUSTRATIVE PURPOSES ONLY. THE TREE SIZES AND GENERAL LOCATIONS SHOWN ARE CONCEPTUAL AND INTENDED ONLY FOR THE PURPOSE OF ASSESSING THE LIKELY TREE CANOPY COVER TARGETS STATED IN THE OFFICIAL PLAN. DETAILED CANOPY COVER AND SOIL VOLUME CALCULATIONS WILL BE COMPLETED AS SITE PLAN CONTROL APPLICATIONS ARE ADVANCED AND WILL BE REFLECTED AS PER THE TERMS OF REFERENCE FOR THE PREPARATION OF LANDSCAPE PLANS PUBLISHED BY THE CITY OF OTTAWA.

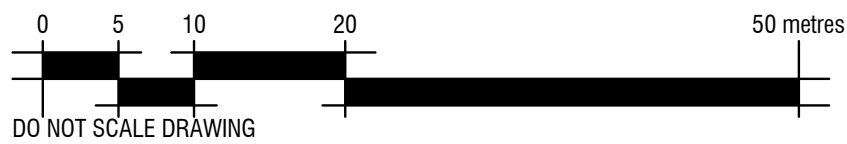

Copyright Reserved
The Copyrights to all designs and drawings are the property of Fotenn Consultants Inc. Unauthorized reproduction or use is forbidden. DO NOT SCALE DRAWING

Copyright réservés
Les droits d'auteur à tous les modèles et dessins sont la propriété de Fotenn Consultants Inc.
Reproduction ou utilisation non autorisée est interdite. NE PAS L'ÉCHELLE DE DESSIN

Client / Client



key plan / plan repère

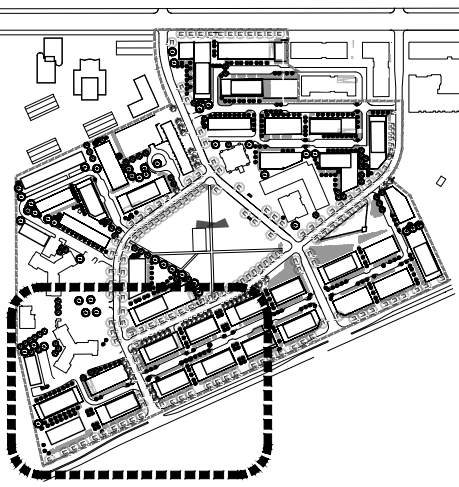

legend / légende

- LIMIT OF APPLICATION
- PROPOSED PROPERTY LINES
- EXISTING TREES TO REMAIN
- EXISTING TREES TO BE REMOVED - REFER TO TREE CONSERVATION REPORT
- PROPOSED DECIDUOUS AND CONIFEROUS TREES - REFER TO L5 FOR SPECIES LIST
- PROJECTED CANOPY AT 40 YEARS
- REQUIRED SOIL VOLUME ASSUMING 1.5m DEPTH (CONCEPTUAL)
- UNIT PAVER
- SPECIALTY PAVING AT WALKING LOOP
- CIP CONCRETE
- ASPHALT
- OPPORTUNITY FOR NATURALIZED OR L.I.D. PLANTING ZONES
- PLANTING BEDS
- MULCH
- DESTINATIONS ALONG WALKING LOOP

rev'n	description / la description	yyyy/mm/dd
03	Reissued for ZBA & DPDS	2025/11/04
02	issue for ZBA & DPDS	2025/07/15
01	issue for coordination	2025/06/03
00	issue for client review	2025/05/26

FOTENN Planning + Design
420 O'Connor Street
Ottawa, ON, CANADA K2P 1W4
613.730.5709
fotenn.com

north / le nord

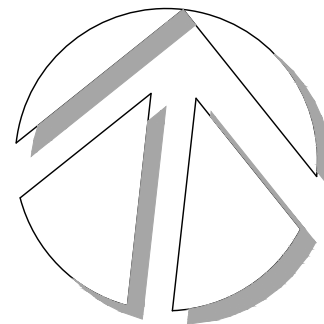

stamp / le cachet



project / projet

HERON GATE MASTERPLAN

drawing / dessin

LANDSCAPE PLAN

designed / conçu	drawn / dessiné	reviewed / examiné
EM / SM / DF / SP	EM / SM / DF / SP	SM / DF
date	project number / No. du projet	
May 2025		

drawing number / No. du dessin

L4

PLOT INFORMATION: DWG NAME: P:\PROJECTS\Heron\Heron Gate Master Plan\A01 Drawing\HeronGateMasterPlan.dwg PLOT DATE: 2025-11-04 2:05:51 PM SHEET SIZE: ISO (11x16.5) INCHES: (295.1x415.0) MM PLOTTED BY: Emily Maderna LAST SAVED BY: emaderna

ROW PLANT SCHEDULE					
CODE	QTY	BOTANICAL NAME	COMMON NAME	SIZE / CONDITION / SPACING	NATIVE
LARGE DECIDUOUS TREES					
AR	20	Acer rubrum	Red Maple	70mm cal. / W.B.	Native
AF	11	Acer x freemanii	Freeman Maple	70mm cal. / W.B.	Native
CC	5	Carya cordiformis	Bitternut Hickory	70mm cal. / W.B.	Native
CA	7	Carya ovata	Shagbark Hickory	70mm cal. / W.B.	Native
CS	4	Catalpa speciosa	Northern Catalpa	70mm cal. / W.B.	Non-Native
CO	11	Celtis occidentalis	Common Hackberry	70mm cal. / W.B.	Native
GB	3	Ginkgo biloba 'Autumn Gold'	Autumn Gold Maidenhair Tree	70mm cal. / W.B.	Non-Native
GT	9	Gleditsia triacanthos 'inermis' 'Shademaster'	Shademaster Honey Locust	70mm cal. / W.B.	Native
GO	10	Gymnocladus dioica	Kentucky Coffeetree	70mm cal. / W.B.	Native
QA	4	Quercus alba	White Oak	70mm cal. / W.B.	Native
QM	13	Quercus macrocarpa	Burr Oak	70mm cal. / W.B.	Native
QR	9	Quercus rubra	Red Oak	70mm cal. / W.B.	Native
TA	3	Tilia americana	American Linden	70mm cal. / W.B.	Native
TC	11	Tilia cordata	Littleleaf Linden	70mm cal. / W.B.	Native
UNH	4	Ulmus americana 'New Harmony'	New Harmony American Elm	70mm cal. / W.B.	Native
UAL	15	Ulmus americana 'Liberty'	Liberty American Elm	70mm cal. / W.B.	Native
UW	3	Ulmus wilsoniana 'Prospector'	Prospector Elm	70mm cal. / W.B.	Non-Native
MEDIUM DECIDUOUS TREES					
CB	2	Carpinus betulus	European Hornbeam	60mm cal. / W.B.	Non-Native
CR	8	Carpinus caroliniana	American Hornbeam	60mm cal. / W.B.	Native
CL	5	Cedrasis lutea	American Yellowwood	60mm cal. / W.B.	Non-Native
CY	4	Corylus columa	Turkish Hazel	60mm cal. / W.B.	Non-Native
CI	6	Crataegus crusgalli inermis	Thornless Cockspur Hawthorn	60mm cal. / W.B.	Native
MK	5	Maackia amurensis	Amur Maackia	60mm cal. / W.B.	Non-Native
OV	9	Ostrya virginiana	Ironwood (American Hophornbeam)	60mm cal. / W.B.	Native
SMALL DECIDUOUS TREES					
AG	6	Amelanchier x grandiflora 'Ballarina'	Ballarina Apple Serviceberry	50mm cal. / W.B. (single stem, tree form)	Native
CHT	1	Crataegus x mordenensis 'Toba'	Toba Hawthorn	50mm cal. / W.B.	Non-Native
SD	2	Sorbus decora	Showy Mountain Ash	50mm cal. / W.B.	Native
SR	2	Syringa reticulata 'Ivory Silk'	Ivory Silk Japanese Tree Lilac	50mm cal. / W.B. (single stem, tree form)	Non-Native

PRIVATELY OWNED TREE SPECIES LIST

LARGE DECIDUOUS TREES

Acer rubrum / Red Maple
 Acer saccharum / Sugar Maple
 Acer x freemanii / Freeman Maple
 Aesculus hippocastanum / European Horsechestnut
 Carya cordiformis / Bitternut Hickory
 Carya ovata / Shagbark Hickory
 Catalpa speciosa / Northern Catalpa
 Celtis occidentalis / Common Hackberry
 Ginkgo biloba 'Autumn Gold' / Autumn Gold Maidenhair Tree
 Gleditsia triacanthos inermis 'Shademaster' / Shademaster Honey Locust
 Gymnocladus dioica / Kentucky Coffeetree
 Quercus alba / White Oak
 Quercus macrocarpa / Burr Oak
 Quercus rubra / Red Oak
 Tilia americana / American Linden
 Tilia cordata / Littleleaf Linden
 Ulmus americana 'Liberty' / Liberty American Elm
 Ulmus americana 'Princeton' / Princeton American Elm
 Ulmus americana 'New Harmony' / New Harmony American Elm
 Ulmus wilsoniana 'Prospector' / Prospector Elm
 Ulmus x 'Morton Glossy' / Triumph™ Elm
 Ulmus x 'Pioneer' / Pioneer Elm

MEDIUM DECIDUOUS TREES

Carpinus betulus / European Hornbeam
 Cladrastis lutea / American Yellowwood
 Corylus columa / Turkish Hazel
 Crataegus crusgalli inermis / Thornless Cockspur Hawthorn
 Fagus sylvatica 'Tricolor' / Tricolor European Beech
 Maackia amurensis / Amur Maackia
 Ostrya virginiana / Ironwood (American Hophornbeam)
 Phellodendron amurense 'Machri' / Seedless Amur Cork Tree
 Sorbus americana / American Mountain Ash

SMALL DECIDUOUS TREES







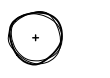

Acer tataricum ginnala / Amur Maple
 Amelanchier x grandiflora 'Ballarina' / Ballarina Apple Serviceberry
 Crataegus x mordenensis 'Snowbird' / Snowbird Hawthorn
 Crataegus x mordenensis 'Toba' / Toba Hawthorn
 Malus x 'Jaminii' / Marilee Crabapple
 Malus x 'Snowdrift' / Snowdrift Crabapple
 Pyrus ussuriensis 'MooOak' / Prairie Gem® Ussurian Pear
 Sorbus decora / Showy Mountain Ash
 Sorbus x thuringiaca 'Fastigiata' / Oakleaf Mountain Ash
 Syringa reticulata 'Ivory Silk' / Ivory Silk Japanese Tree Lilac

LARGE CONIFEROUS TREES

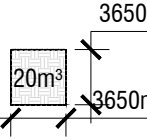
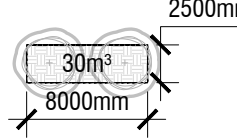
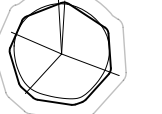
Abies balsamea / Balsam Fir
 Larix laricina / Tamarack
 Picea abies / Norway Spruce
 Picea glauca / White Spruce
 Picea omorika / Serbian Spruce
 Picea pungens / Colorado Spruce
 Pinus nigra / Austrian Pine
 Pinus resinosa / Red Pine
 Pinus strobus / White Pine
 Tsuga canadensis / Canadian Hemlock (Eastern Hemlock)

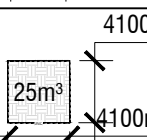
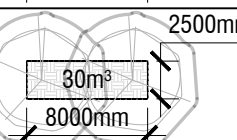
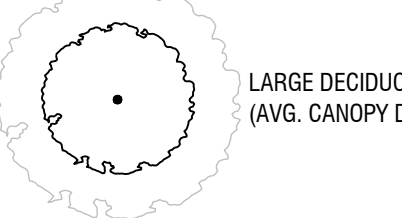
MEDIUM CONIFEROUS TREES

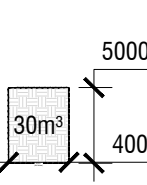
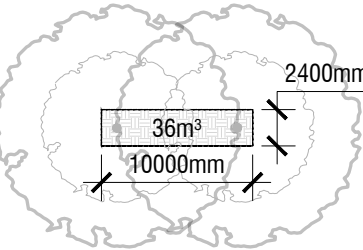
Thuja occidentalis / Eastern White Cedar

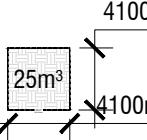
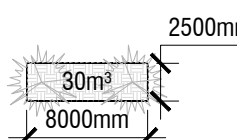
PROPOSED TREE CANOPY PROJECTIONS (40 YEAR) & SOIL VOLUME REQUIREMENTS			
CANOPY PROJECTIONS (NTS)	AVERAGE CROWN AREA PER TREE (m²)	SOIL VOLUME REQUIREMENT*	CONTINUOUS SPACE SOIL VOLUME (I.e. 2 TREES/1 GREENSPACE)
 SMALL DECIDUOUS TREE (AVG. CANOPY DIAMETER = 4.5m)	 16m²	 3650mm 20m³	 2500mm 30m³ 8000mm
 MEDIUM DECIDUOUS TREE (AVG. CANOPY DIAMETER = 8.5m)	 57m²	 4100mm 25m³	 2500mm 80m³ 8000mm
 LARGE DECIDUOUS TREE (AVG. CANOPY DIAMETER = 10m)	 176m²	 5000mm 30m³	 2400mm 36m³ 10000mm
 LARGE CONIFEROUS TREES (AVG. CANOPY DIAMETER = 6m)	6.5m²	 4100mm 25m³	 2500mm 30m³ 8000mm

TOTAL CANOPY COVERAGE PERCENTAGES

BLOCK	ROW	Park	Block 2	Block 3	Block 4	Block 5	Block 6	Block 7	Block 8	Block 9	Site Total:
%	54.1%	51.8%	23.2%	19.6%	20.6%	15.3%	43.4%	16.9%	14.1%	20.9%	28.0%

CALCULATIONS BY BLOCK

Block: ROW Site Size (m²): 46795		
CANOPY PROJECTIONS	QTY	TOTAL TREE CANOPY COVERAGE (m²)
SMALL	9	144
MEDIUM	40	2,280
LARGE	145	22,185
CONIFERS	25	700
Site Canopy Coverage		25,309
Total Percent Coverage		54.1%

Block: Park Block Site Size (m²): 15267		
CANOPY PROJECTIONS	QTY	TOTAL TREE CANOPY COVERAGE (m²)
SMALL	3	48
MEDIUM	2	114
LARGE	42	6,426
CONIFERS	47	1,316
Site Canopy Coverage		7,904
Total Percent Coverage		51.8%

Block: Block 2 (2.4-2.6) Site Size (m²): 12585		
CANOPY PROJECTIONS	QTY	TOTAL TREE CANOPY COVERAGE (m²)
SMALL	44	704
MEDIUM	19	1,083
LARGE	5	765
CONIFERS	13	364
Site Canopy Coverage		2,916
Total Percent Coverage		23.2%

Block: Block 3 Site Size (m²): 31818		
CANOPY PROJECTIONS	QTY	TOTAL TREE CANOPY COVERAGE (m²)
SMALL	104	1,664
MEDIUM	14	798
LARGE	20	3,060
CONIFERS	26	728
Site Canopy Coverage		6,250
Total Percent Coverage		19.6%

Block: Block 4 Site Size (m²): 26011		
CANOPY PROJECTIONS	QTY	TOTAL TREE CANOPY COVERAGE (m²)
SMALL	35	560
MEDIUM	14	798
LARGE	21	3,213
CONIFERS	28	784
Site Canopy Coverage		5,355
Total Percent Coverage		20.6%

Block: Block 5 Site Size (m²): 23088		
CANOPY PROJECTIONS	QTY	TOTAL TREE CANOPY COVERAGE (m²)
SMALL	4	64
MEDIUM	17	969
LARGE	13	1,989
CONIFERS	18	504
Site Canopy Coverage		3,526
Total Percent Coverage		15.3%

Block: Block 6 Site Size (m²): 7474		
CANOPY PROJECTIONS	QTY	TOTAL TREE CANOPY COVERAGE (m²)
SMALL	28	448
MEDIUM	5	285
LARGE	12	1,836
CONIFERS	24	672
Site Canopy Coverage		3,241
Total Percent Coverage		43.4%

Block: Block 7 Site Size (m²): 11270		
CANOPY PROJECTIONS	QTY	TOTAL TREE CANOPY COVERAGE (m²)
SMALL	48	768
MEDIUM	0	0
LARGE	6	918
CONIFERS	8	224
Site Canopy Coverage		1,910
Total Percent Coverage		16.9%

Block: Block 8 Site Size (m²): 20190		
CANOPY PROJECTIONS	QTY	TOTAL TREE CANOPY COVERAGE (m²)
SMALL	64	1,024
MEDIUM	5	285
LARGE	9	1,377
CONIFERS	6	168
Site Canopy Coverage		2,854
Total Percent Coverage		14.1%

Block: Block 9 Site Size (m²): 18671		
CANOPY PROJECTIONS	QTY	TOTAL TREE CANOPY COVERAGE (m²)
SMALL	49	784
MEDIUM	17	969
LARGE	8	1,224
CONIFERS	33	924
Site Canopy Coverage		3,901
Total Percent Coverage		20.9%

DISCLAIMER:

THE SITE PLANS OF THE PRIVATELY-OWNED PROPERTIES ARE SHOWN FOR ILLUSTRATIVE PURPOSES ONLY. THE TREE SIZES AND GENERAL LOCATIONS SHOWN ARE CONCEPTUAL AND INTENDED ONLY FOR THE PURPOSE OF ASSESSING THE LIKELY TREE CANOPY COVER TARGETS STATED IN THE OFFICIAL PLAN. DETAILED CANOPY COVER AND SOIL VOLUME CALCULATIONS WILL BE COMPLETED AS SITE PLAN CONTROL APPLICATIONS ARE ADVANCED AND WILL BE REFLECTED AS PER THE TERMS OF REFERENCE FOR THE PREPARATION OF LANDSCAPE PLANS PUBLISHED BY THE CITY OF OTTAWA.

NOTES:

- PROJECTED CANOPY DIAMETERS AND AREAS ARE BASED ON AN AVERAGE OF THE TREES PROPOSED FOR THE SITE
- CANOPY CALCULATION INCLUDES EXISTING TREES BASED ON THEIR MAXIMUM GROWTH POTENTIAL
- CANOPY CALCULATION DOES NOT ACCOUNT FOR EXISTING TREE CANOPY ON ADJACENT SITES
- *SOIL VOLUME REQUIREMENT IS BASED ON THE CAMBIUM INC. GEOTECHNICAL INVESTIGATION 'Heron Gate Village Subdivision Reference' # 22801-001 dated June 2, 2025 AND THE CITY OF OTTAWA'S 'Tree Planting in Sensitive Marine Clay Soils - 2017 Guidelines' DRAFT Version 2.0 DATED JANUARY 11, 2019 WHICH CALCULATES SOIL VOLUME USING A DEPTH OF 1.5m
- THE GEOTECH TECHNICAL REPORT INDICATES THE SOILS WITHIN THE STUDY AREA ARE LOW PLASTICITY CLAY WITH A PLASTICITY INDEX OF 7.8%. NO SPECIFIC TREE PLANTING SETBACKS NOTED IN THE GEOTECH REPORT.

Copyright Reserved
 The Copyrights to all designs and drawings are the property of Fotenn Consultants Inc. Unauthorized reproduction or use is forbidden. DO NOT SCALE DRAWING

Copyright réservés
 Les droits d'auteur à tous les modèles et dessins sont la propriété de Fotenn Consultants Inc.
 Reproduction ou utilisation non autorisée est interdite. NE PAS L'ÉCHELLE DE DESSIN

Client / Client



key plan / plan repère

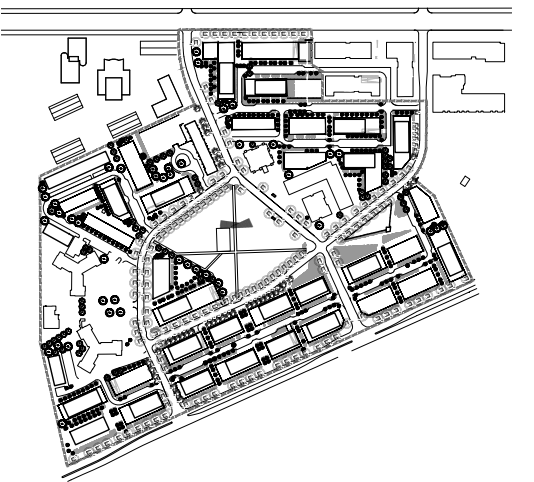

legend / légende

03	Reissued for ZBA & DPDS	2025/11/04
02	issue for ZBA & DPDS	2025/07/15
01	issue for coordination	2025/06/03
00	issue for client review	2025/05/26
rev'n	description / la description	yyyy/mm/dd

FOTENN Planning + Design
 420 O'Connor Street
 Ottawa, ON, CANADA K2P 1W4
 613.730.5709
 fotenn.com

north / le nord

stamp / le cachet

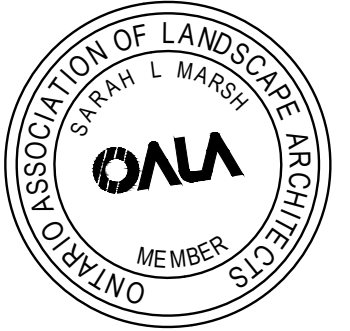

project / projet

HERON GATE MASTERPLAN

drawing / dessin

TREE SPECIES LIST AND CANOPY/SOIL CALCULATIONS

designed / conçu EM / SM / DF / SP	drawn / dessiné EM / SM / DF / SP	reviewed / examiné SM / DF
date May 2025	project number / No. du projet	

drawing number / No. du dessin

L5



-
- 32.00m
[VARIES]
- BUILDING FACE TO BUILDING FACE**
- 24.00m
[VARIES]
- 20.00m
- REQUIRED TREE TO FOUNDATION
SETBACK BASED ON CITY OF OTTAWA
TREE PLANTING IN MARINE CLAY SOILS
POLICY
- 4.50m
3.0m-6.0m
TYPICAL FRONT
YARD
SETBACK
- 0.50m
1.50m
2.0m CONC. SIDEWALK
- 25-65%
- HYDRO TRANSFORMER c/w REQUIRED EASEMENT
GROUNDING GRID
- TELECOMMUNICATION PEDESTAL
WATER SERVICE POST
JOINT UTILITY TRENCH
INCLUDING GAS & STREET LIGHT
- GLB
- 0.65m
1.20m 1.04m 1.62m
- 3%
- STREETLIGHT AS REQUIRED
- FIRE HYDRANT
2.0m SIDEWALK
AS REQUIRED
- 4.25m
1.50m
3.0m-6.0m
TYPICAL FRONT
YARD
SETBACK
- 25-65%
- REQUIRED TREE TO FOUNDATION
SETBACK BASED ON CITY OF OTTAWA
TREE PLANTING IN MARINE CLAY SOILS
POLICY
- 4.50m
7.50m
- HYDRO TRANSFORMER c/w REQUIRED EASEMENT
GROUNDING GRID
- TELECOMMUNICATION PEDESTAL
WATER SERVICE POST
JOINT UTILITY TRENCH
INCLUDING GAS & STREET LIGHT
- GLB
- 0.70m
1.62m 1.04m 1.20m
- 3%
- WATERMAIN
- STORM SEWER
- SANITARY SEWER
- 1.50m -MIN 2.50m
- PROPERTY LINE
- 5.75m
- CURB LINE
- 8.50m
- CURB LINE
- 5.75m
- PROPERTY LINE



DWG. No. ROW-20.0

FOTENN Planning + Design
420 O'Connor Street
Ottawa, ON, CANADA K2P 1W4
613.730.5708
fotenn.com

stamp / le cachet



HERON GATE MASTERPLAN

SECTIONS

drawing number / No. du dessin

L6

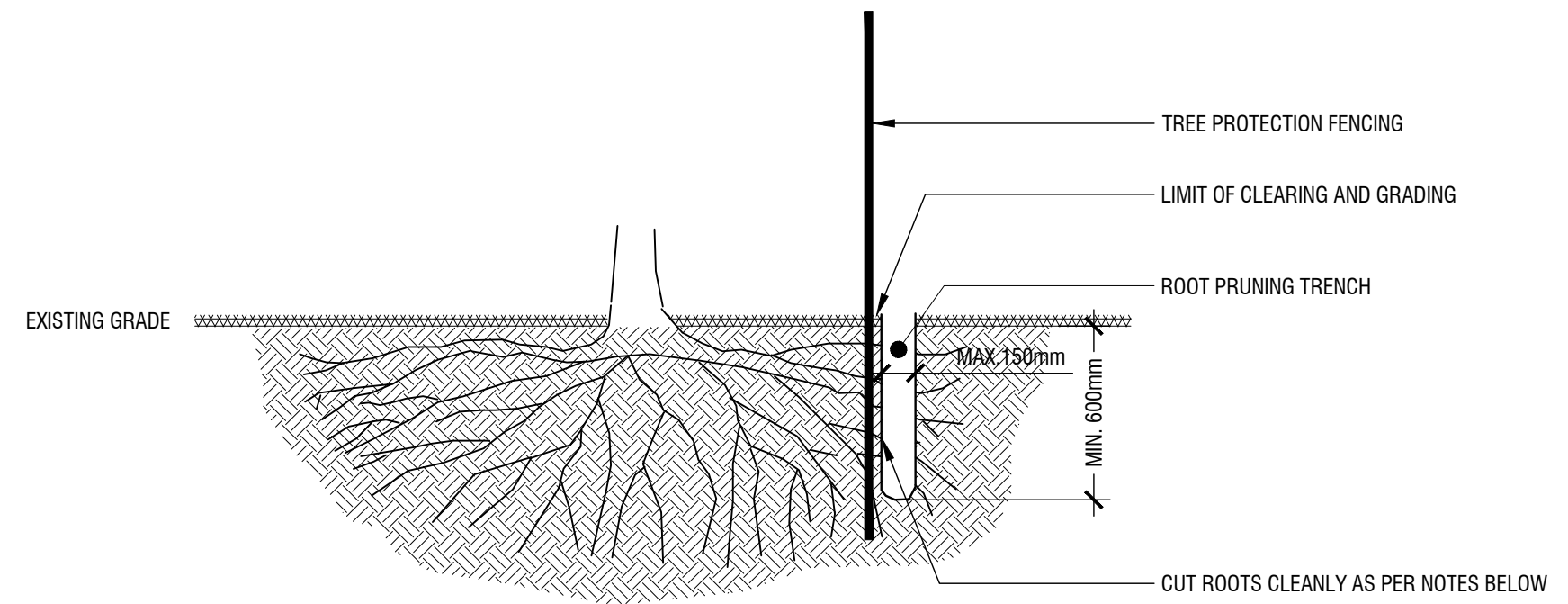

- PROPER ROOT PRUNING TECHNIQUE REQUIRED BY TREE ROOTS ENCOUNTERED DURING EXCAVATION.
- EXCAVATIONS WITHIN DRIPLINE SHOULD BE BY DIRECTIONAL MICRO-TUNNELLING AND BORING. OUTSIDE THE DRIPLINE, ROOTS SHOULD BE CUT CLEANLY (AS PER ABOVE DRAWING) WITH PRUNING SHEARS OR A SAW WIPED WITH ALCOHOL, BEFORE EACH CUT.
- AFTER ROOTS ARE CLEANLY CUT, THE AREA SHOULD BE BACKFILLED WITH SUITABLE MATERIAL (TO BE APPROVED BY LANDSCAPE ARCHITECT) TO PREVENT DESICCATION;
- WHERE APPROPRIATE, THE TREES SHALL UNDERGO AN OVERALL PRUNING TO RESTORE TREE APPEARANCE AND / OR RESTORE THE BALANCE BETWEEN TOP GROWTH AND ROOTS. DO NOT PRUNE LEADERS.

L7	n.t.s.
----	--------

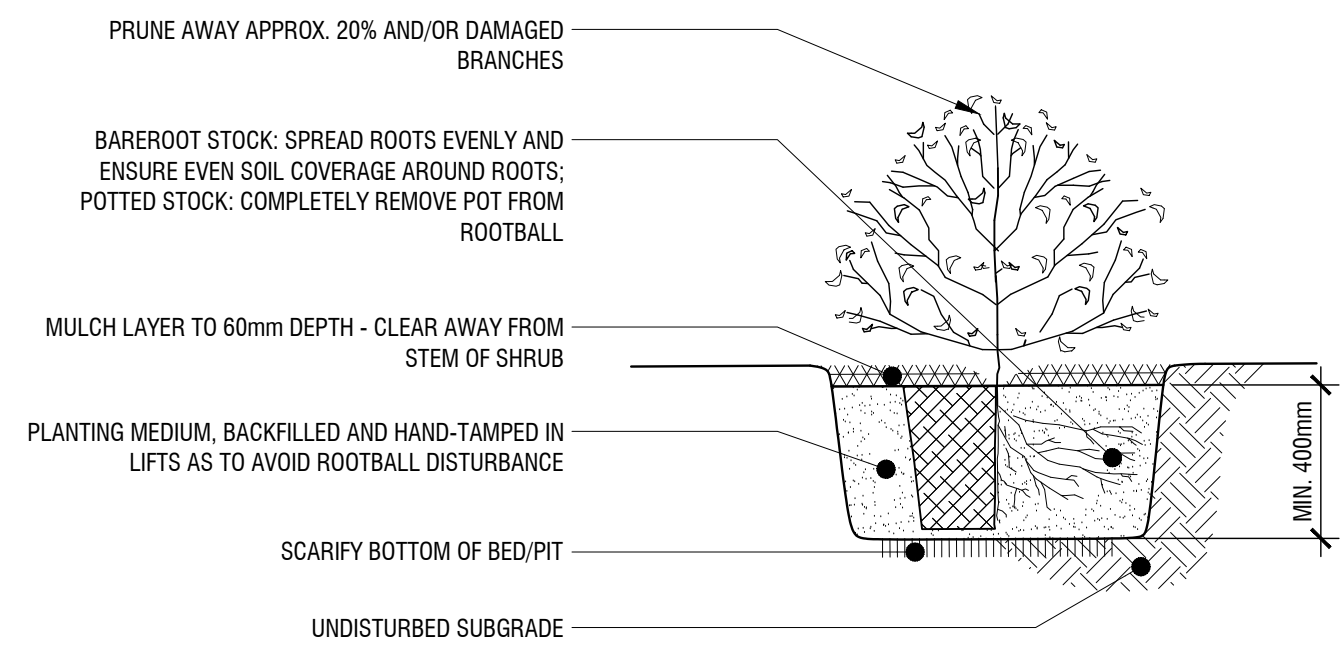
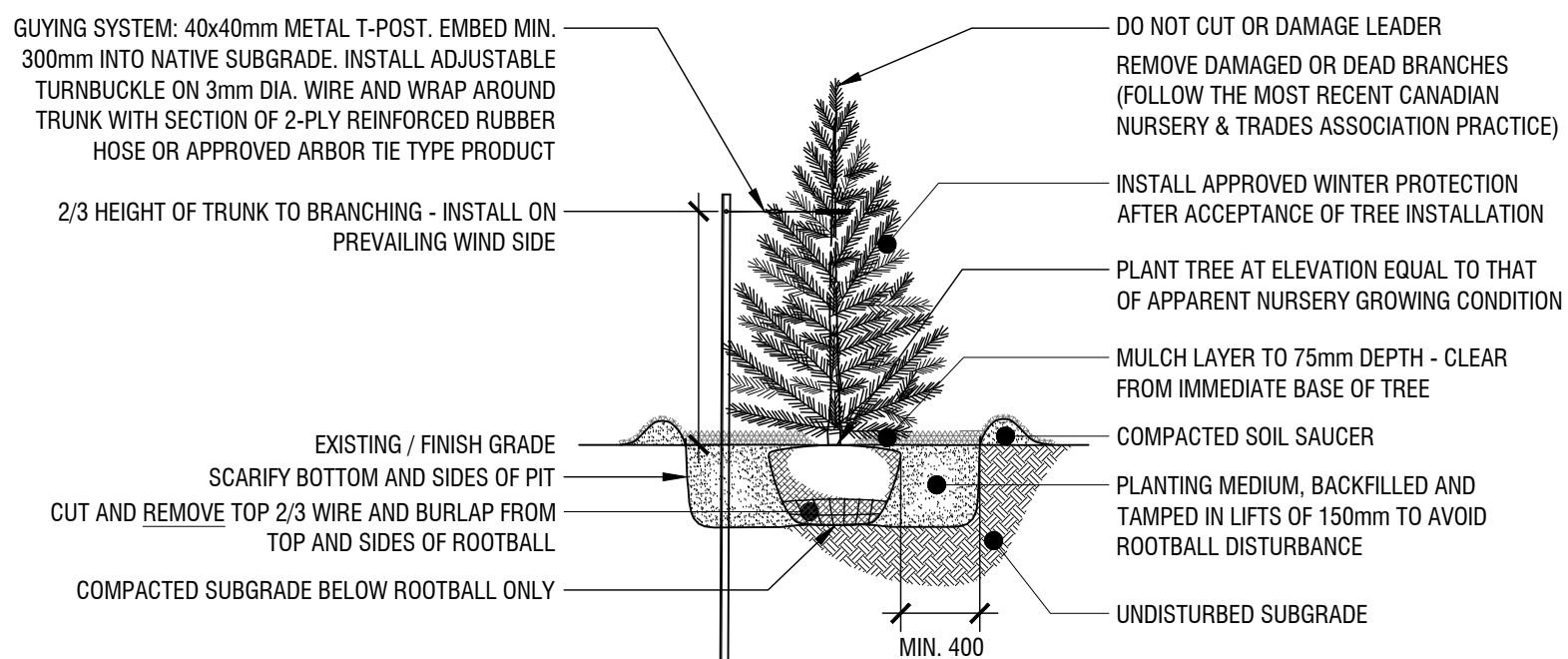

L7	n.t.s.
----	--------

L7	n.t.s.
----	--------

L7	n.t.s.
----	--------