

HAWTHORNE AVENUE

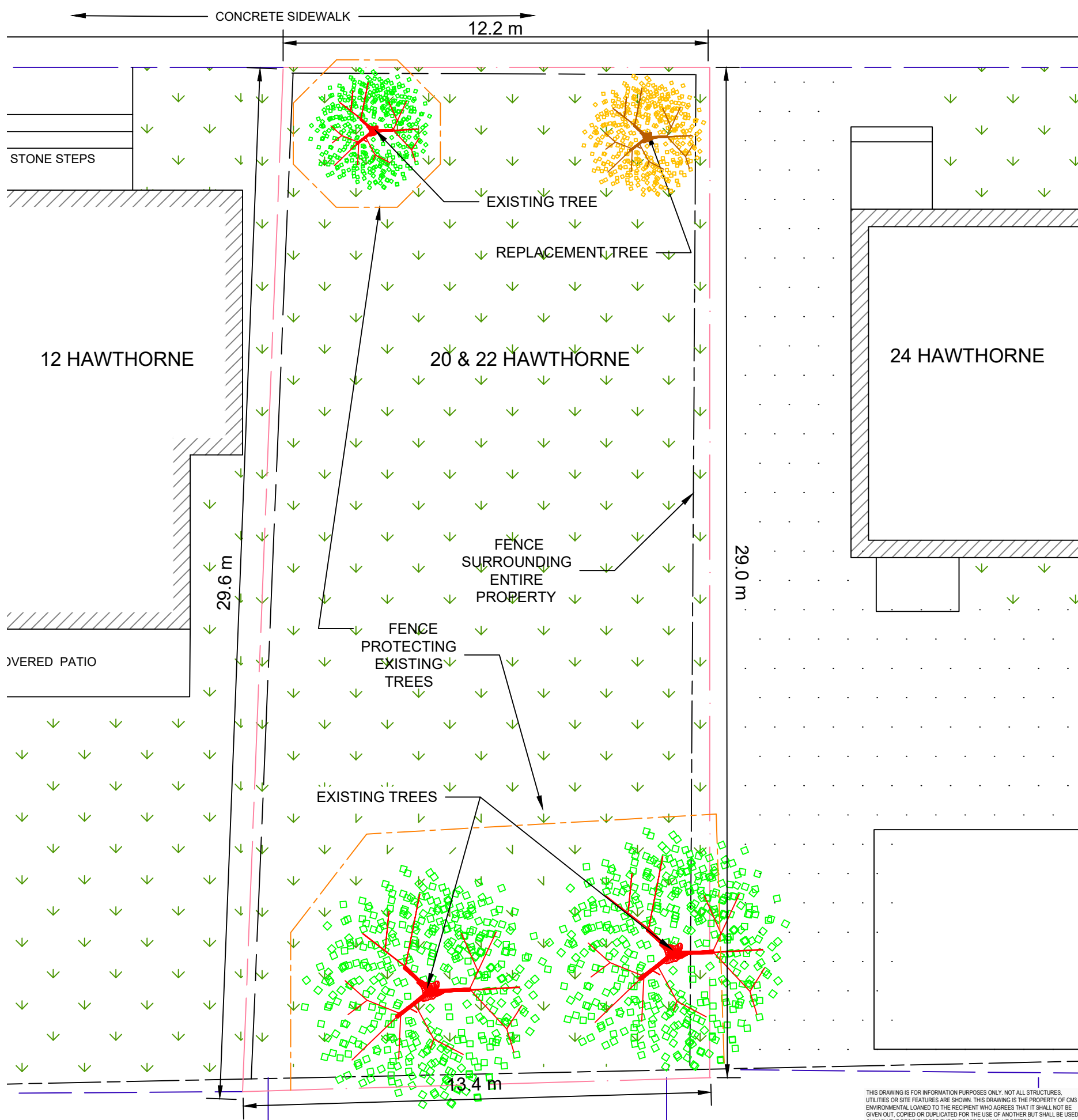

THIS DRAWING IS FOR INFORMATION PURPOSES ONLY. NOT ALL STRUCTURES, UTILITIES OR SITE FEATURES ARE SHOWN. THIS DRAWING IS THE PROPERTY OF CM3 ENVIRONMENTAL LOANED TO THE RECIPIENT WHO AGREES THAT IT SHALL NOT BE GIVEN OUT, COPIED OR DUPLICATED FOR THE USE OF ANOTHER BUT SHALL BE USED ONLY BY THE RECIPIENT FOR THE PURPOSE TO WHICH IT REFERS.

LEGEND

- PROPERTY BOUNDARY
- SUBJECT SITE
- v FUTURE GRASS AREA
- CHAIN LINK FENCE
- SNOW FENCE WITH 2 X 4 FRAME

NOTES:

-THE ENTIRE LOT WILL BE RE-SEEDDED FOLLOWING REMEDIATION-
 -ONE TREE AT THE NORTHEAST CORNER OF THE SUBJECT PROPERTY WILL BE REMOVED AND REPLACED FOLLOWING THE REMEDIATION
 -ALL OTHER EXISTING TREES ARE PLANNED TO REMAIN AND WILL BE PROTECTED DURING DEMOLITION AND CONSTRUCTION WORK WITH 1.2 m HIGH SNOW FENCE ON A 2 X 4 FRAME PLACED AS PER CITY SPECIFICATIONS/APPROVALS

-A 1.52 m HIGH CHAIN LINK FENCE WITH VINYL WEAVE WILL BE INSTALLED AROUND THE SUBJECT SITE (20 & 22 HAWTHORNE)



CM3 ENVIRONMENTAL
 5710 AKINS ROAD, OTTAWA, ON
 K2S 1B8

MARILYN STEINBERG

DEMOLITION PLAN
 FOR
 20 & 22 HAWTHORNE AVENUE
 OTTAWA, ONTARIO

Project:	BDC	Drawn By:	KS
Date:	OCT 2019	Reviewed By:	BC
Scale:	1:125	Figure:	2

Scale 1:125

