

EROSION AND SEDIMENT CONTROL NOTES:

- THE CONTRACTOR SHALL IMPLEMENT BEST MANAGEMENT PRACTICES, TO PROVIDE FOR PROTECTION OF THE AREA DRAINAGE SYSTEM AND THE RECEIVING WATERCOURSE, DURING CONSTRUCTION ACTIVITIES. THE CONTRACTOR ACKNOWLEDGES THAT FAILURE TO IMPLEMENT APPROPRIATE EROSION AND SEDIMENT CONTROL MEASURES MAY BE SUBJECT TO PENALTIES IMPOSED BY ANY APPLICABLE REGULATORY AGENCY.
- THE OWNER (AND/OR CONTRACTOR) AGREES TO PREPARE AND IMPLEMENT AN EROSION AND SEDIMENT CONTROL PLAN AT LEAST EQUAL TO THE STATED MINIMUM REQUIREMENTS AND TO THE SATISFACTION OF THE TOWNSHIP OF NORTH DUNDAS, APPROPRIATE TO THE SITE CONDITIONS, PRIOR TO UNDERTAKING ANY SITE ALTERATIONS (FILLING, GRADING, REMOVAL OF VEGETATION, ETC.) AND DURING ALL PHASES OF SITE PREPARATION AND CONSTRUCTION IN ACCORDANCE WITH THE CURRENT BEST MANAGEMENT PRACTICES FOR EROSION AND SEDIMENT CONTROL.
- THE CONTRACTOR IS TO ENSURE THAT THE SITE ACCESS POINTS AND ADJACENT STREETS TO THE ACCESS POINTS ARE MAINTAINED AND KEPT CLEAN OF CONSTRUCTION MATERIALS SUCH AS, BUT NOT LIMITED TO MUD, DIRT, CLAY AND GRANULARS ON A DAILY BASIS OR AS NECESSARY, TO THE SATISFACTION OF THE TOWNSHIP OF NORTH DUNDAS.
- EVERY EFFORT WILL BE MADE TO ENSURE THAT ALL DISTURBED AREAS ARE TOPSOILED AND SEEDED AS SOON AS REASONABLY POSSIBLE.
- THE SEDIMENT AND EROSION CONTROL PLAN IS A LIVING DOCUMENT WHICH MAY BE AMENDED BY ONSITE REQUIREMENTS AT THE APPROVAL OF THE TOWNSHIP AND THE CONSERVATION AUTHORITY.

MINIMUM EROSION AND SEDIMENT CONTROL PLAN REQUIREMENTS:

- TIME THE DEMOLITION AND EXCAVATION ACTIVITIES SO THAT THEY OCCUR NO SOONER THAN IS NECESSARY FOR SUBSEQUENT CONSTRUCTION ACTIVITIES.
- LANDSCAPE THE SITE AS SOON AS PRACTICALLY POSSIBLE.
- USE SILT FENCES AROUND ANY STOCKPILES OF SOIL.
- PRIOR TO CONSTRUCTION, SILT FENCE BARRIERS (OPSD 219.110) WILL BE PLACED ALONG THE PROPERTY LINES AS ON THE DRAWING.
- THE SILT FENCE SHOULD BE REMOVED ONLY WHEN THE SITE IS STABILIZED.
- INSTALL FILTER SOCK ACROSS ALL EXISTING AND PROPOSED CATCH BASINS AND CATCH BASIN MANHOLES PRIOR TO CONSTRUCTION.

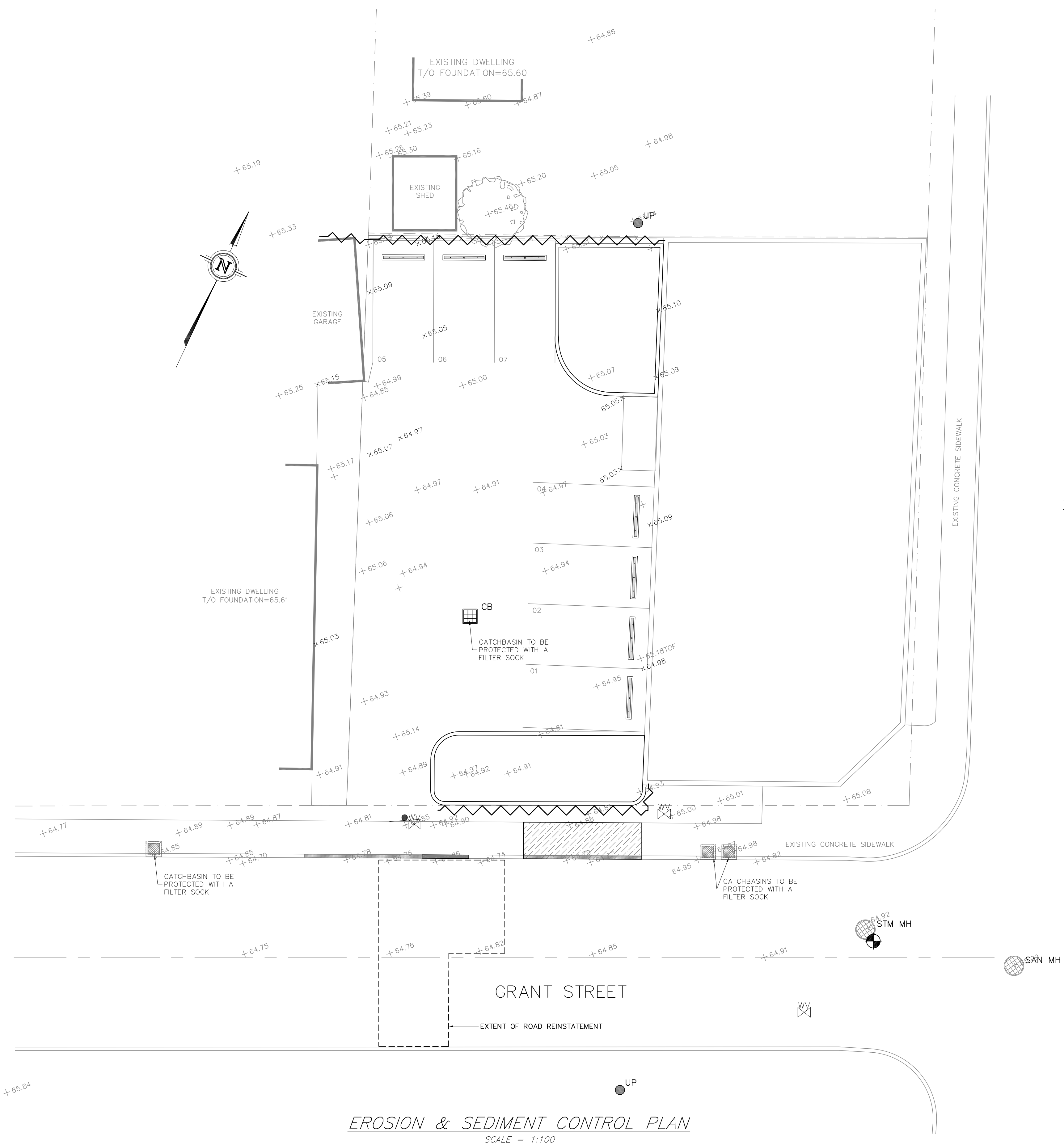
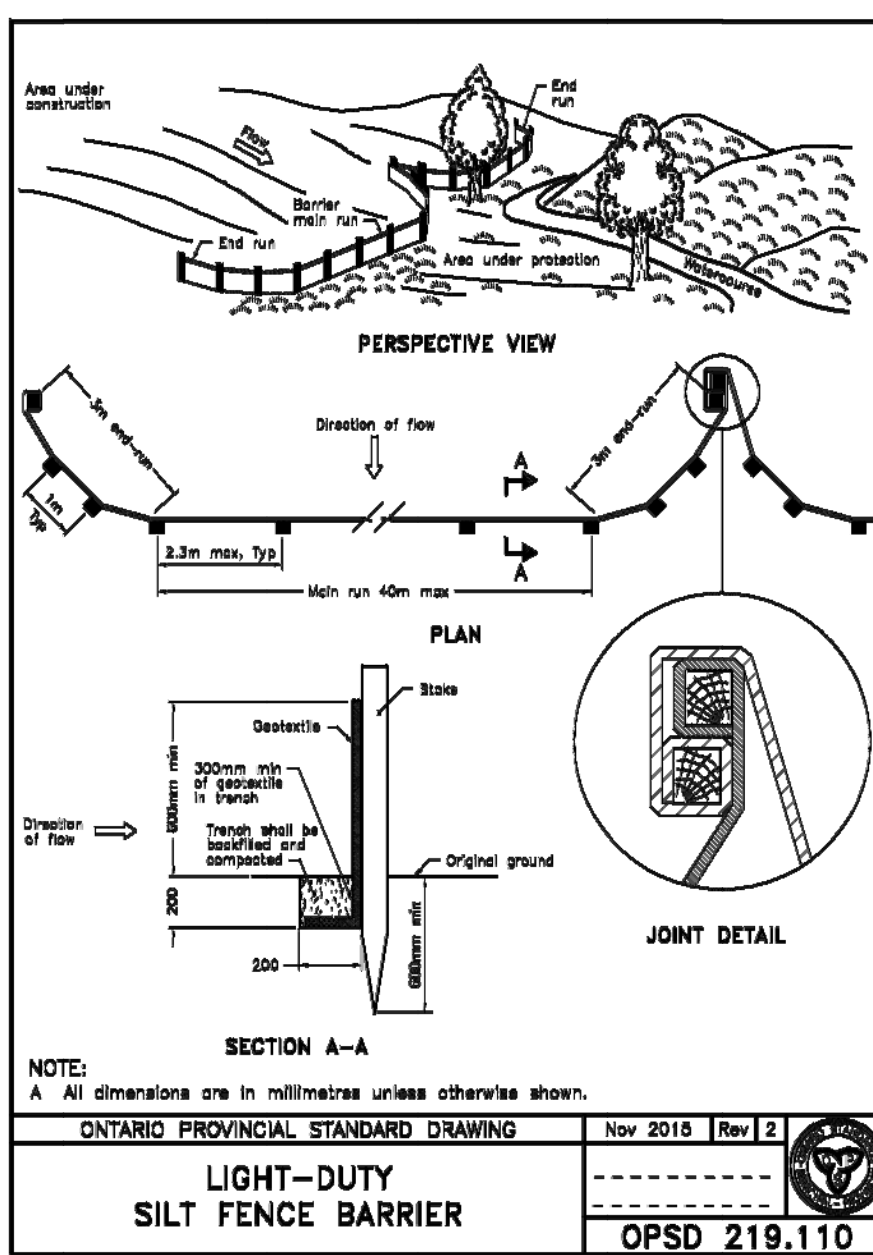

EROSION & SEDIMENT CONTROL PLAN

SCALE = 1:100

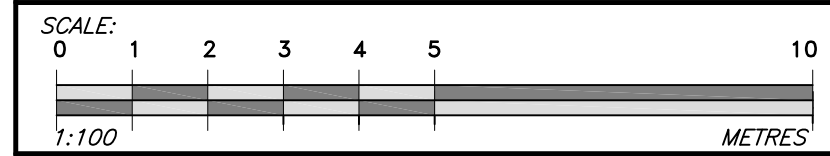
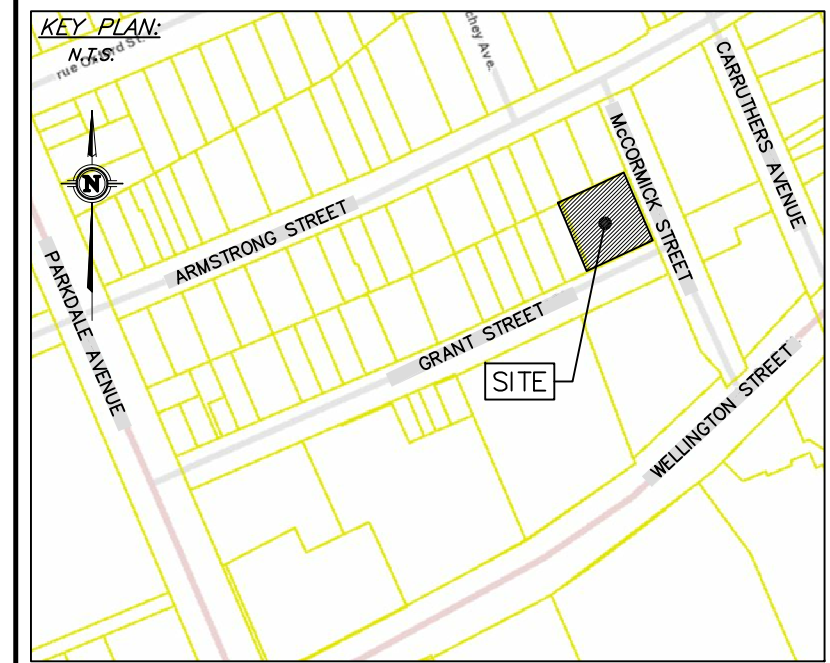

GENERAL NOTES:

- ALL DIMENSIONS ARE IN METRES; ALL ELEVATIONS ARE IN METRES AND ARE GEODETIC.
- TBM = TOP OF GRATE (T/O) OF STORM MANHOLE. ELEVATION = 64.92.
- THIS IS NOT A LEGAL SURVEY. BOUNDARY INFORMATION WAS DERIVED FROM FAIRBANK MORTGAG & WOODLAND REF NO. 7-102.
- CONTRACTOR IS RESPONSIBLE FOR LOCATION AND PROTECTION OF UTILITIES.
- ALL DIMENSIONS TO BE VERIFIED ON SITE BY CONTRACTOR PRIOR TO CONSTRUCTION.
- ANY CHANGES MADE TO THIS PLAN MUST BE VERIFIED AND APPROVED BY KOLLAARD ASSOCIATES INC.
- CLIENT IS RESPONSIBLE FOR ACQUIRING ALL NECESSARY PERMITS. THIS DRAWING IS NOT FOR CONSTRUCTION UNTIL A BUILDING PERMIT HAS BEEN GRANTED.
- THE OWNER AGREES TO PREPARE AND IMPLEMENT AN EROSION AND SEDIMENT CONTROL PLAN TO THE SATISFACTION OF THE CITY OF OTTAWA, APPROPRIATE TO THE SITE CONDITIONS, PRIOR TO UNDERTAKING ANY SITE ALTERATIONS (FILLING, GRADING, REMOVAL OF VEGETATION, ETC.) AND DURING ALL PHASES OF SITE PREPARATION AND CONSTRUCTION IN ACCORDANCE WITH THE CURRENT BEST MANAGEMENT PRACTICES FOR EROSION AND SEDIMENT CONTROL, SUCH AS, AND NOT LIMITED TO INSTALLING FILTER CLOTHS ACROSS MANHOLE/CATCHBASIN LIDS TO PREVENT SEDIMENTS FROM ENTERING STRUCTURES AND INSTALL AND MAINTAIN A LIGHT DUTY SILT FENCE BARRIER AS REQUIRED.
- ALL MATERIALS AND CONSTRUCTION TO BE IN ACCORDANCE WITH CITY OF OTTAWA STANDARDS AND ONTARIO PROVINCIAL STANDARDS AND SPECIFICATIONS, SEWER AND WATERMAIN MATERIAL TYPES, DISINFECTION, CATHODIC PROTECTION, CITY OF OTTAWA INSULATION SPECIFICATIONS FOR WATERMAIN, PIPE BEDDING, REINSTATEMENT OF DISTURBED AREAS AND LEAKAGE TESTING.
- REFERENCE TO KOLLAARD FILE NO. 210499 FOR STORM WATER MANAGEMENT DESIGN.

No.	REVISION	DATE	BY
1	REVISIONS PER CITY REVIEW COMMENTS	SEPT 02, 2021	ML
0	ISSUED FOR SPC APPLICATION	MAY 31, 2021	ML
#	REVISION ITEM / DESCRIPTION	REV. DATE	INT.

Kollaard Associates Engineers

(613) 860-0923

info@kollaard.ca

P.O. BOX 189, 210 PRESCOTT ST. KEMPTVILLE, ONTARIO K0G 1J0 FAX (613) 258-0475 http://www.kollaard.ca

CLIENT:

GRANT STREET GARAGE (GEOFF WATSON)

PROJECT:

PROPOSED PARKING LOT

LOCATION:

1-3 GRANT STREET, CITY OF OTTAWA, ON

DESIGNED BY: ML CHECKED BY: SD

DRAWN BY: ML APPROVED BY: SD

DATE: MAY 15, 2021

KOLLAARD FILE NUMBER: 210499

DRAWING NUMBER: 210499-ESC

DRAWING NAME: EROSION & SEDIMENT CONTROL PLAN