

TREE LIST

| Tree# | BOTANICAL NAME | COMMON NAME | CALIPER (cm) | CONDITION | APPROXIMATE AGE | HIGH QUALITY TREE | RARE TREE | COMMENTS | TO BE PRESERVED |
|-------|----------------------|----------------|------------------------|---------------|-----------------|-------------------|-----------|---|-----------------|
| 1 | Quercus rubra | Red Oak | approx 10 | Poor | 15 | NO | NO | Tree completely surrounded by landscape shrubs. Canopy is damaged and half dead. Tree is off property. | NO |
| 2 | Gleditsia tricanthos | Honeylocust | 11.5 | Good | 15-20 | NO | NO | Tree is well-maintained and in good condition | NO |
| 3 | Gleditsia tricanthos | Honeylocust | 14.0 | Good | 15-20 | NO | NO | Tree is well-maintained and in good condition | NO |
| 4 | Pinus mugo | Mugo Pine | M5 | Moderate | 30 | NO | NO | Tree is surrounded by Manitoba Maple suckers and honeysuckle shrubs. Tree seems to be in good condition, though is very mature. | NO |
| 5 | Pinus mugo | Mugo Pine | MS(5) range from 8-15 | Moderate | 30 | NO | NO | Tree is very mature, though in relatively good condition. | NO |
| 6 | Pinus mugo | Mugo Pine | MS(3) range from 8-15 | Moderate | 30 | NO | NO | Tree is very mature, though in relatively good condition. | NO |
| 7 | Pinus mugo | Mugo Pine | MS(5) range from 10-15 | Moderate | 30 | NO | NO | Tree is very mature, though in relatively good condition. | NO |
| 8 | Acer negundo | Manitoba Maple | MS(4) range from 29-37 | moderate-good | 30 | NO | NO | Tree is very mature and very large for this species. One of the stems is injured, but overall the tree is healthy. | NO |
| 9 | Acer negundo | Manitoba Maple | 25.0 | moderate-poor | 20 | NO | NO | The tree is leaning slightly, one stem having been removed already. The remaining base from the removed stem is decaying with some cavities. There are injuries on the remaining trunk. | NO |
| 10 | Acer negundo | Manitoba Maple | MS(2) 33 and 29 | moderate-poor | 99 | NO | NO | Co-dominant stems are weakly joined, with the smaller of the two stems showing signs of injury. | NO |
| 11 | Acer x freemanii | Freeman Maple | 13.0 | Good | 15 | NO | NO | Tree is well-maintained and in good condition | NO |

SITE NOTES:

- WHILE THE SITE IS NEAR TO A 'CONTRIBUTING' GREENSPACE (AS PER MAP 1 OF THE OTTAWA GREENSPACE MASTER PLAN), THE TREES ON THE SITE AND THE SITE ITSELF ARE NOT PARTICULARLY VALUABLE. THE MAJORITY OF THE SITE IS CURRENTLY PAVED AND USED AS A PARKING LOT.
- THERE IS A SMALL WATERCOURSE THAT CUTS ACROSS THE NORTH CORNER OF THE SITE, BETWEEN THE OVERHANGS IDENTIFIED IN VEGETATION NOTES 'C' AND 'D'. THE DRAIN PASSES THROUGH A LARGE CULVERT, AND IS NOT IDENTIFIED AS A MUNICIPAL DRAIN ON THE CITY OF OTTAWA EMAPS SITE. THE CURRENT SITE PLAN INCLUDES RETAINING THE WATERCOURSE, AND CONSTRUCTING A RETAINING WALL TO PRESERVE ITS ALIGNMENT. REFER TO SITE PLAN FOR MORE DETAILS.
- THERE ARE CURRENTLY NO TREES ON THE SITE INTENDED TO BE PRESERVED (TREE #1 IS ON THE ADJACENT SITE). THIS IS DUE TO THE INTENSITY OF THE DEVELOPMENT. THESE WILL BE REPLACED WITH 22 PROPOSED NEW TREES (REFER TO LANDSCAPE PLAN). THE NEW SPECIES WILL BE SELECTED BASED ON THEIR URBAN TOLERANCE, DUE TO THE INTENSITY OF THE PROPOSED DEVELOPMENT. THE DECIDUOUS TREE SELECTION WILL BE NATIVE TO NORTH AMERICA, AS THERE ARE SPECIES TOLERANT OF URBAN CONDITIONS AVAILABLE, HOWEVER THE CONIFEROUS SELECTIONS MAY BE ALIEN, BUT SELECTED FOR HARDINESS AND TOLERANCE.
- IMPACT ON ADJACENT SITE WILL BE MINIMAL, DUE TO LITTLE CHANGE IN QUANTITY OF IMPERVIOUS SURFACES AND A NET GAIN IN TREE QUANTITY. REFER TO LANDSCAPE PLAN FOR PROTECTION OF BRANCHES FROM TREES ON ADJACENT PROPERTIES.

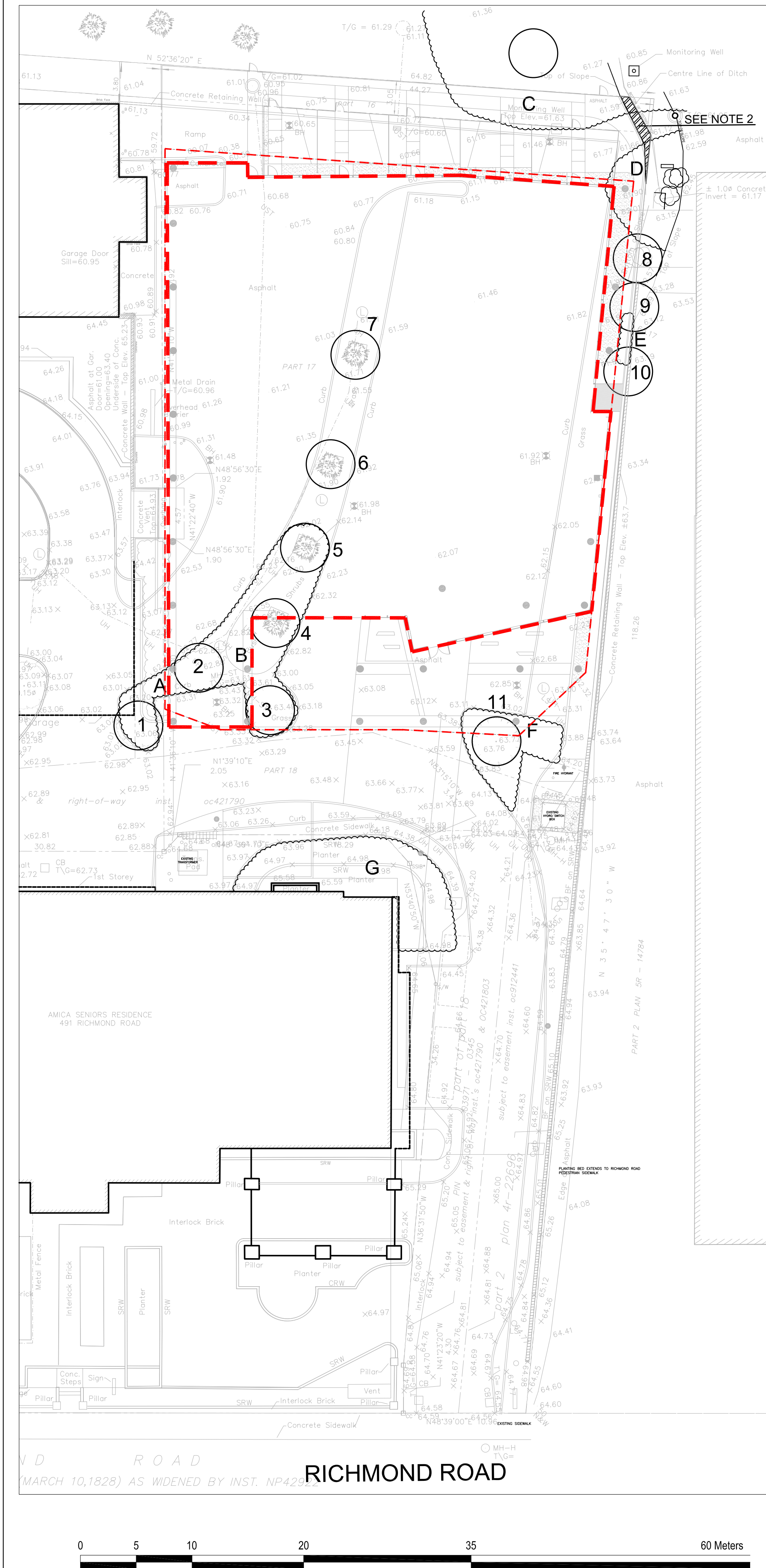

VEGETATION NOTES:

- A) LANDSCAPE SHRUBS ON ADJACENT PROPERTY. WELL-MAINTAINED.
- B) OVERGROWN HONEYSUCKLE BUSHES AND MANITOBA MAPLE VOLUNTEERS. OBSCURES TREE '4'.
- C) WEEDY PERENNIAL/ ANNUALS, MANITOBA MAPLE VOLUNTEERS. THE CANOPY OF A LARGE ELM ON THE ADJACENT PROPERTY OVERHANGS THE SITE.
- D) THE CANOPY OF A LARGE MANITOBA MAPLE ON THE ADJACENT PROPERTY OVERHANGS THE SITE.
- E) 5 SMALL *THUJA OCCIDENTALIS* (ALL WITH DBH <10cm DBH), IN POOR CONDITION.
- F) LANDSCAPE SHRUBS IN MODERATE CONDITION, INCLUDING LILAC, RUGOSA ROSE.
- G) LANDSCAPE SHRUBS, IN GOOD CONDITION, INCLUDING PRIVET HEDGE, AND RUGOSA ROSE.

ADDITIONAL INFORMATION

- 1) OWNER:
MINTO COMMUNITIES AND CANDEREL
- 2) APPLICANT:
CSW LTD,
1960 SCOTT ST, SUITE 200
OTTAWA, ON
K1Z 8L8
613-729-4536
- 3) AUTHOR:
LISA MACDONALD, BIA, CSLA,
CERTIFIED ARBORIST (ON-1513A)
CORUSH SUNDERLAND WRIGHT, LTD,
1960 SCOTT ST, SUITE 200
OTTAWA, ON
K1Z 8L8
613-729-4536 X 228
- 4) CONTRACTOR:
MINTO COMMUNITIES
- 5) MUNICIPAL ADDRESS OF THE SITE:
485 RICHMOND RD,
OTTAWA, ON
- 6) OFFICIAL PLAN & ZONING DESIGNATION
GENERAL URBAN AREA
TM[157] F(2.3) S149
- 7) SITE APPLICATION NO: N/A
- 8) SCHEDULE:
FALL 2013
- 9) FUTURE APPLICATIONS:
THIS DEVELOPMENT WILL NOT BE PHASED.

LEGEND:

- EXISTING TREE
- EXISTING VEGETATION (OTHER)
- FOOTPRINT OF PROPOSED NEW BUILDING
- PODIUM OVERHANG



AERIAL PHOTO



| No. | Issuance | Date (YYYY.MM.DD) |
|-----|-------------------------------|-------------------|
| 1 | Issued for Site Plan Approval | 2012.07.27 |
| 2 | Revised | 2012.09.24 |
| 3 | Revised | 2012.10.23 |
| 4 | Revised | 2013.03.05 |
| 5 | Revised | 2013.05.07 |

WALLMAN ARCHITECTS

30 Duncan Street, Suite 202
Toronto, Ontario M5V 2C3
t 416 340 1870
f 416 340 1871
info@wallmanarchitects.com

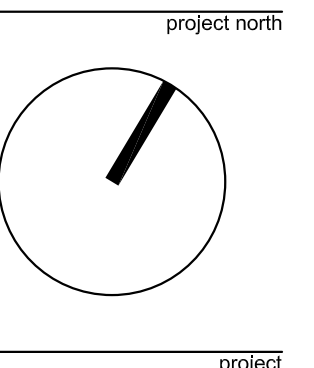

485 RICHMOND ROAD
OTTAWA, ONTARIO

MINTO COMMUNITIES INC.

ARBORIST REPORT

| 1577-6A | project number |
|------------|----------------|
| 2012-07-24 | date |
| 1:250 | scale |
| LM | drawn by |
| | sheet |

ARB-1